

**SAMSUNG**



AH85-01006R-01

# Simple User Guide

---

**HW-LS60D**

You can access the User guide on Samsung's on-line customer support center by scanning the QR code on the left. To see the manual on your PC or mobile device, download the manual in document format from Samsung's website. (<http://www.samsung.com/support>)



- Figures and illustrations in this User Manual are provided for reference only and may differ from actual product appearance.

## 01 CHECKING THE COMPONENTS

- Wireless Speaker main unit
  - Stand
  - AC/DC Adapter
  - Power Cord
  - Photo Frame
  - Component for Art Panel (sold separately)
    - Holder-Plate x 4
    - Holder-Guide x 1
  - Wallmount Component
    - Wallmount Guide
    - Bracket-Wall Rear x 1
    - Screw (M5 X L55) x 2
    - Anchor x 2
    - Holder-Screw x 1
    - Spacer x 2
- NOTE**
- To purchase additional components or optional cables, contact a Samsung Service Center or Samsung Customer Care.

## 02 DETACHING THE PROTECTION RUBBER

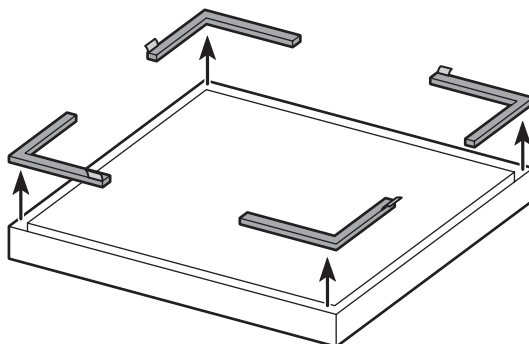

1

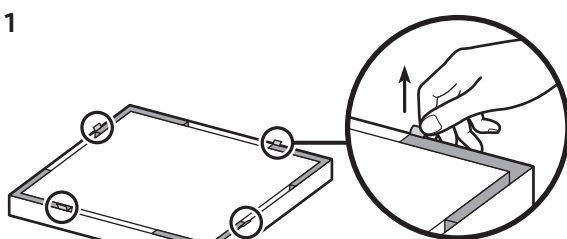

2

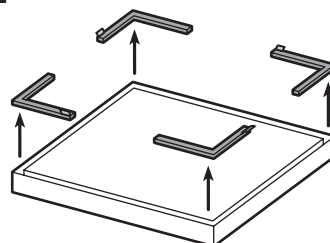

## 03 ATTACHING THE STANDS

English

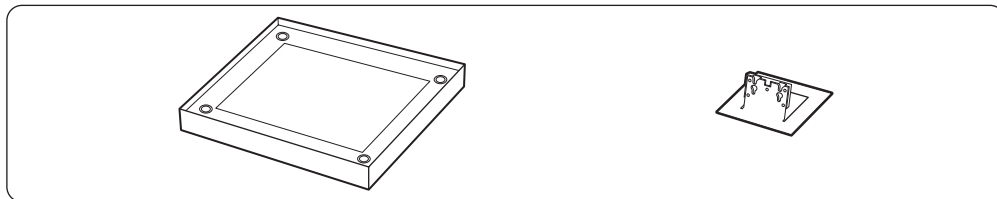

1

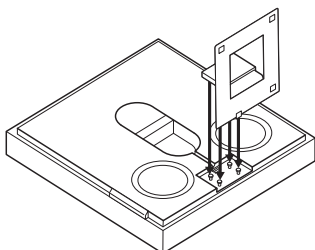

2

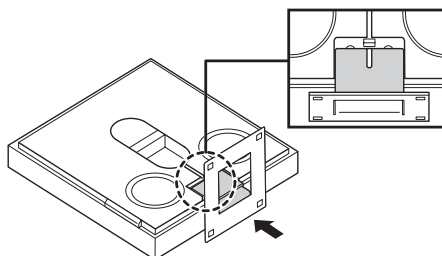

3

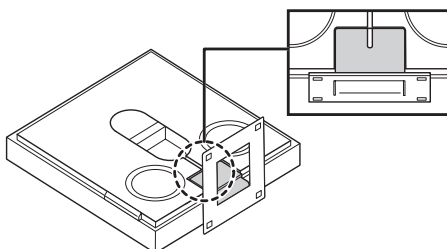

4

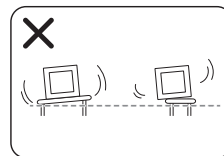
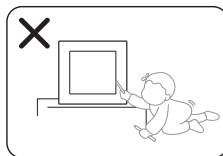
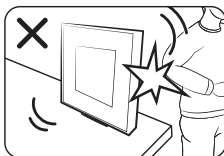
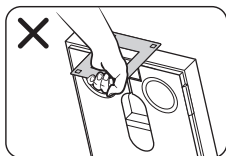
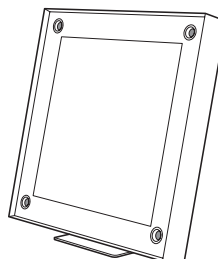

## 04 ATTACHING THE PHOTO FRAME & ART PANEL

### Attaching the PHOTO FRAME

Be sure to secure the photo frame properly. Otherwise, it may fall off and cause damage or physical injury. Any accident resulting from carelessness by the user shall not be covered by the warranty.

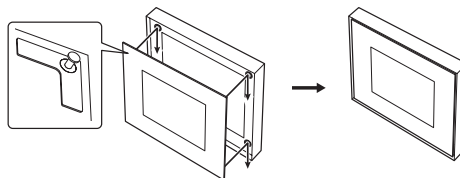

### Detaching the Photo Frame

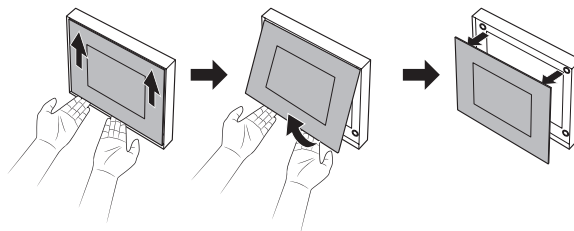

### Replacing the photo in the Photo Frame

For relevant information, visit the Samsung web site (<http://www.samsung.com/support>) and refer to the User Guide of this product.

### Attaching ART PANEL

You can use the below two component parts (provided) to insert your art panel (sold separately) instead of the photo frame.

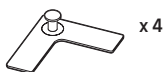

Holder-Plate

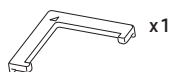

Holder-Guide

- For details on installation, see the user guide of this product at [www.samsung.com](http://www.samsung.com).
- The art panel is available on the Marpple online shop (<https://www.marpple.com/musicframe>), and the availability may differ with your region. For regional retailers, visit your local Samsung web site ([www.samsung.com](http://www.samsung.com)).
- Distribution of the art panel is performed by third-part businesses that has nothing to do with the company. And the panel's quality and safety is solely subject to the third-party businesses. Regional retailers may change depending on their business situation.

## 05 PRODUCT OVERVIEW

### Front

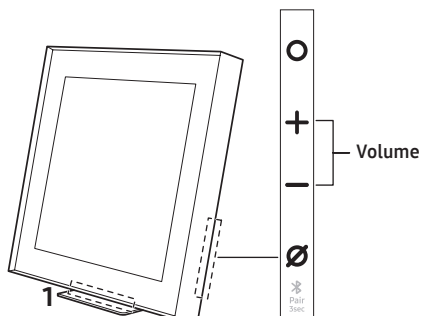

#### ○ (Multi Function) Button

In standby mode, press the ○ (Multi Function) button to turn on the Wireless Speaker. Press the ○ (Multi Function) button to change the mode.

#### ∅ (Mic On/Off) Button

Press the button to turn the microphone on or off. When the microphone is off, the LED indicator will light red.

To switch to **Bluetooth Pairing** state, press and hold the ∅ (Mic On/Off) button on the side of the Wireless Speaker for more than 3 seconds.

#### 1 LED indicator

The LED Indicator flashes, glows, or changes color depending on the Wireless Speaker's current mode or status.

### Rear

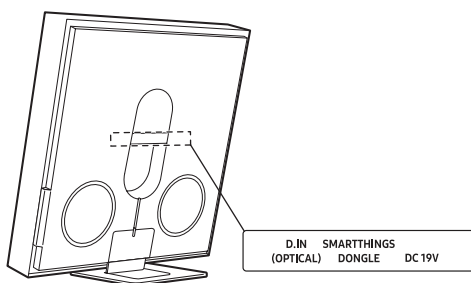

#### D. IN (OPTICAL)

Connect to the digital (optical) output of an external device.

#### SMARTTHINGS DONGLE

Connect the SmartThings dongle (Purchase separately) to use the SmartThings Hub function.

#### DC 19V

Connect the AC/DC power adapter. (Power Supply In)

## 06 CONNECTING THE POWER

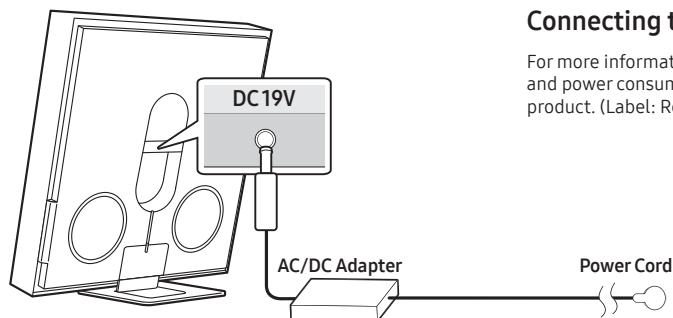

### Connecting the power and units

For more information about the required electrical power and power consumption, refer to the label attached to the product. (Label: Rear of the Wireless Speaker Main Unit)

## 07 CONNECTING THE SMARTTHINGS APP

### 1 Installation

- The SmartThings app allows you to control the functionality of and adjust the settings of the Wireless Speaker.
- Download the SmartThings app from the app store of your mobile device, or simply scan the provided QR code and download the app.
- **QR 1:** Video Guide for SmartThings App Connection
- **QR 2:** Download SmartThings App



QR 1



QR 2

### 2 Device registration

1. Run the SmartThings app on your mobile device.
  2. Follow the on screen instructions and add the product to your mobile device.
- If the automatic pop-up window does not appear, press (+) on the Home screen to register the product.

### 3 Control with SmartThings

1. With the SmartThings app open on your device, select the Wireless Speaker that you have added.
  2. The settings menu of the Wireless Speaker appears, where you can adjust the various settings including Volume, Sound Mode or Advanced Sound Settings.
- For other users who want to control the **Music Frame**, tap **Menu** (≡) on the SmartThing app of their mobile device and go to 'How to use' → 'Share control of devices' for reference.

#### NOTE

The illustration right may differ with the app version.

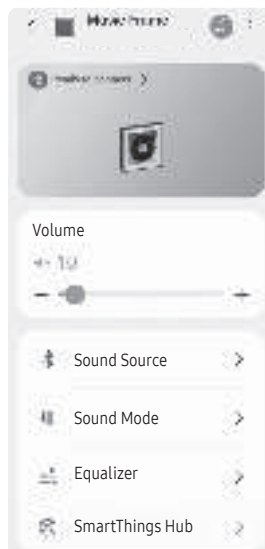

## 08 CONNECTING VIA WIFI WITH TV

Change the input source of the TV by using the Audio menu to Wireless Speaker.

- Samsung TVs released in 2017 or later: (⌂) → Sound → Sound Output → Music Frame (Wi-Fi)

#### NOTE

- Wi-Fi connection is available only on Samsung TV.
- The TV and Wireless Speaker must be connected to the same wireless network (Wi-Fi).
- The menus may differ depending on the year of manufacture, refer to your TV manual.

## 09 USING THE Q-SYMPHONY FUNCTION

- This function is supported only when both the wireless speaker and the TV are connected to the same Wi-Fi network.
- This function is available with new Samsung TV models to be released in 2024.

When the Wireless Speaker connects to a Samsung TV that supports the Q-Symphony function, you can play the sound simultaneously through the Wireless Speaker and the TV. If you use the Q-Symphony function, the surround sound played on the Wireless speaker allows you to enjoy a richer, more three-dimensional surround sound effect.

When the Wireless Speaker is connected, "Q-Symphony" menu appears on the TV. (The message displayed may differ with the TV model.)

(Settings (⚙️) → All Settings (⚙️) → Sound → Sound Output)

English

## 10 CONNECTING VIA BLUETOOTH WITH MOBILE

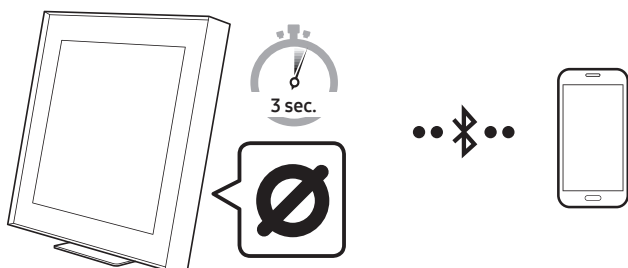

1. Press **⊘ (Mic On/Off)** button for 3 seconds for pairing.
  - It is also available to pair by pressing [ **Ⓜ** ] on the SmartThings App screen of your mobile device.



2. Search for the Bluetooth device on your mobile device.
  - TV can be connected in the same way.

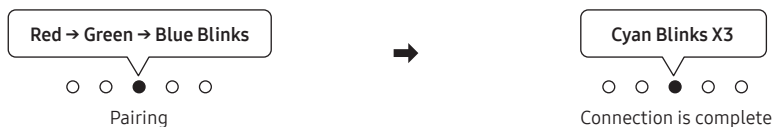

Ready to connect via Bluetooth.

### NOTE

If asked for a PIN code when connecting a Bluetooth device, enter <0000>.

# 11 INSTALLING THE WALL MOUNT

## Installation Precautions

- Install on a vertical wall only.
- Do not install in a place with high temperature or humidity.
- Verify whether the wall is strong enough to support the product's weight. If not, reinforce the wall or choose another installation point.
- Connect cables from the unit to external devices before you install the Soundbar on the wall.
- Make sure the unit is turned off and unplugged before you install it. Otherwise, it may cause an electric shock.
- Make sure you use the provided wall-mount component parts. Under any circumstances, any accident resulting from using third-party parts shall not be covered by the warranty

## Wallmount Components

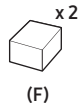
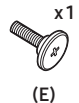
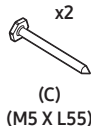
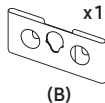
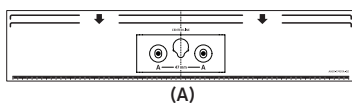

1

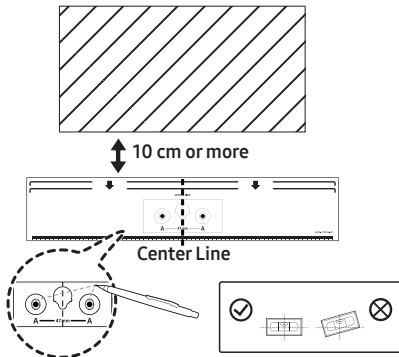

4

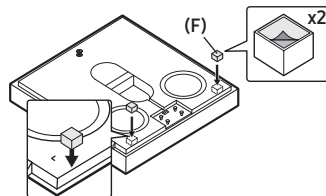

The part (F) must be attached to prevent the product from moving out of the wall-mount installation. On the stand installation, it must be kept safely for later use. When reusing it, use a double-sided adhesive tape for attachment.

2

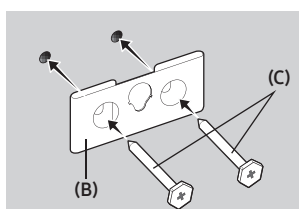

5

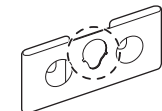
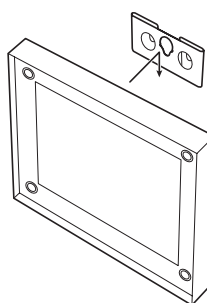

On the wall-mount installation, make sure the screw (E) is secured to the center hole of the bracket (B).

3

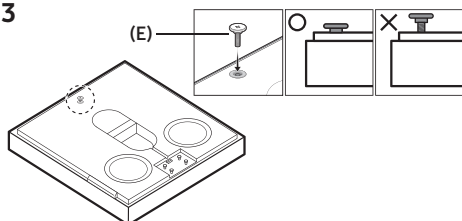

Back View

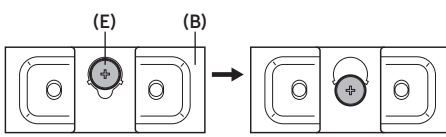



## 12 SPECIFICATIONS AND GUIDE

Model Name	HW-LS60D
------------	----------

### Weight

Without Stand	4.2 kg
---------------	--------

With Stand	4.6 kg
------------	--------

### Dimensions (W x H x D)

Without Stand	353.0 x 353.0 x 54.2 mm
---------------	-------------------------

With Stand	353.0 x 364.8 x 143.4 mm
------------	--------------------------

**Operating Temperature Range:** +10 °C to +40 °C

**Operating Humidity Range:** 10 % to 80 %, non-condensing

**Storage Temperature Range:** -20 °C to +45 °C

**Storage Humidity Range:** 5 % to 95 %, non-condensing

### Supported play formats

Dolby 5.1ch / Dolby Digital Plus /

Dolby ATMOS (Dolby Digital Plus) / LPCM 2ch

### To activate/deactivate Wi-Fi connection

Press and hold the **⌂ (Mic On/Off)** button and the **-** button on the side panel simultaneously for more than 30 seconds. This will turn on or off the Wi-Fi connection.

### To activate/deactivate Bluetooth connection

Press and hold the **⌂ (Mic On/Off)** button and the **+** button on the side panel simultaneously for more than 30 seconds. This will turn on or off the Bluetooth connection.

**Precaution: The Wireless speaker will restart automatically if you turn on/turn off Wi-Fi or Bluetooth.**

### NOTE

- Samsung Electronics Co., Ltd reserves the right to change the specifications without notice.
- Weight and dimensions are approximate.

English

## 13 TROUBLESHOOTING

Before seeking assistance, check the following.

### Wireless Speaker does not turn on.

- Check whether the power cord of the Wireless Speaker is correctly inserted into the outlet.

### Wireless Speaker works erratically.

- After removing the power cord, insert it again.
- Try again after initializing the product.
- If there is no signal, the Wireless Speaker automatically turns off after a certain period of time. Turn on the power.

### The red LED indicator light on the Wireless Speaker stays on.

- The microphone is turned off. Turn on the microphone.

LED indicator	
○ ○ ● ○ ○ - Red on	Mic Off
○ ○ ○ ○ ○	Mic On

### Sound is not output from the Wireless Speaker.

- The volume of the Wireless Speaker is too low or muted. Adjust the volume.
- When any external device (STB, Bluetooth device, mobile device, etc.) is connected, adjust the volume of the external device.
- For sound output of the TV, select Wireless Speaker. (Samsung TV: Home (🏠) → Menu → Settings (⚙️) → All Settings (⚙️) → Sound → Sound Output → Select Wireless Speaker)
- Remove the cable from the Wireless Speaker and then reconnect it.

### Wireless Speaker will not connect via Bluetooth.

- When connecting a new device, switch to "BT PAIRING" for connection. (Press the  (Mic On/Off) button on the body for at least 3 seconds.)
- Reconnect it after removing the Bluetooth speaker list on the device to connect. (Samsung TV: Home (🏠) → Menu → Settings (⚙️) → All Settings (⚙️) → Sound → Sound Output → Bluetooth Speaker List)

### Sound drops out when connected via Bluetooth.

- Some devices can cause radio interference if they are located too close to the Wireless Speaker. e. g. microwaves, wireless routers, etc.
- If your device that is connected via Bluetooth moves too far away from the Wireless Speaker, it may cause the sound to drop out. Move the device closer to the Wireless Speaker.
- If a part of your body is in contact with the Bluetooth transceiver or the product is installed on metal furniture, the sound may drop out. Check the installation environment and conditions for use.

### Wireless Speaker will not connect to Wi-Fi.

- Make sure the wireless router is turned on and then reconnect the wireless router after rebooting.
- The Wireless Speaker will not connect if the wireless signal is too weak. Try moving the router closer to the Wireless Speaker, or eliminating any obstacles that are between the Wireless Speaker and the router, if possible.

### The Wireless Speaker does not turn on automatically with the TV.









- When you turn off the Wireless Speaker while watching TV, power synchronization with the TV is disabled. First turn off the TV.

# SAFETY INFORMATION

## SAFETY WARNINGS

TO REDUCE THE RISK OF ELECTRIC SHOCK, DO NOT REMOVE THE COVER (OR BACK). NO USER-SERVICEABLE PARTS ARE INSIDE. REFER SERVICING TO QUALIFIED SERVICE PERSONNEL.

Refer to the table below for an explanation of symbols which may be on your Samsung product.

	<b>CAUTION</b> <b>RISK OF ELECTRIC SHOCK. DO NOT OPEN</b>	
	This symbol indicates that high voltage is present inside. It is dangerous to make any kind of contact with any internal part of this product.	
	This symbol indicates that this product has included important literature concerning operation and maintenance.	
	Class II product : This symbol indicates that a safety connection to electrical earth (ground) is not required. If this symbol is not present on a product with a power cord, the product MUST have a reliable connection to protective earth (ground).	
	AC voltage : Rated voltage marked with this symbol is AC voltage.	
	DC voltage : Rated voltage marked with this symbol is DC voltage.	
	Caution. Consult Instructions for use : This symbol instructs the user to consult the user manual for further safety related information.	

## WARNING

- To reduce the risk of fire or electric shock, do not expose this appliance to rain or moisture.
- Do not use liquid fumigators containing chemicals, such as mosquito repellent or air freshener, around the product. If steam comes in contact with the product surface or enters the product, it may cause stains or malfunction.

## CAUTION

- TO PREVENT ELECTRIC SHOCK, MATCH WIDE BLADE OF PLUG TO WIDE SLOT, FULLY INSERT.
- This apparatus shall always be connected to a AC outlet with a protective grounding connection.
- To disconnect the apparatus from the mains, the plug must be pulled out from the mains socket, therefore the mains plug shall be readily operable.
- Do not expose this apparatus to dripping or splashing. Do not put objects filled with liquids, such as vases, on the apparatus.
- To turn this apparatus off completely, you must pull the power plug out of the wall socket. Consequently, the power plug must be easily and readily accessible at all times.

## PRECAUTIONS

1. Ensure that the AC power supply in your house complies with the power requirements listed on the identification sticker located on the bottom of your product. Install your product horizontally, on a suitable base (furniture), with enough space around it for ventilation (7~10 cm). Make sure the ventilation slots are not covered. Do not place the unit on amplifiers or other equipment which may become hot. This unit is designed for continuous use.  
To fully turn off the unit, disconnect the AC plug from the wall outlet. Unplug the unit if you intend to leave it unused for a long period of time.
2. During thunderstorms, disconnect the AC plug from the wall outlet. Voltage peaks due to lightning could damage the unit.
3. Do not expose the unit to direct sunlight or other heat sources. This could lead to overheating and cause the unit to malfunction.
4. Protect the product from moisture (i.e. vases), and excess heat (e.g. a fireplace) or equipment creating strong magnetic or electric fields. Unplug the power cable from the AC wall socket if the unit malfunctions. Your product is not intended for industrial use. It is for personal use only. Condensation may occur if your product has been stored in cold temperatures. If transporting the unit during the winter, wait approximately 2 hours until the unit has reached room temperature before using.
5. Make sure to rest the AC/DC Adapter flat on a table or the floor. If you place the AC/DC Adapter so that it is hanging with the AC cord input facing upwards, water or other foreign substances could enter the Adapter and cause the Adapter to malfunction.

您可以掃描左邊的 QR 碼並前往 Samsung 網上客戶支援中心，以查看本使用指南。如要在電腦或流動裝置上查看手冊，可從三星網站下載文件格式的手冊。(http://www.samsung.com/support)



- 此使用者手冊的圖像和插圖僅供參考，可能與實際產品外觀有所不同。

## 01 檢查元件

- 無線揚聲器主機
- 支架
- 交流電/直流電適配器
- 電源線
- 相片框架
- 藝術面板元件 (獨立出售)
  - 支撐板 x 4
  - 支撐導桿 x 1
- 掛牆元件
  - 掛牆安裝導桿
  - 後方牆壁支架 x 1
  - 螺絲 (M5 X L55) x 2
  - 固定器 x 2
  - 支架螺絲 x 1
  - 墊片 x 2

### 注意

- 如欲購買其他元件或連纜線，請聯絡三星服務中心或三星客戶服務中心。

## 02 拆卸防護橡膠墊

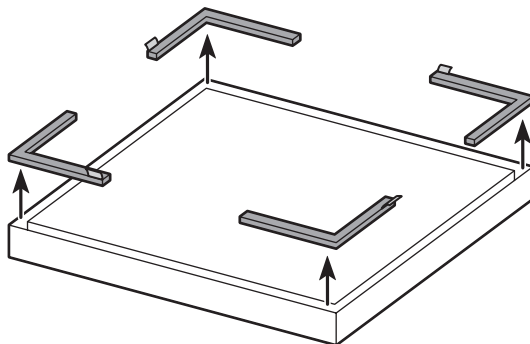

1

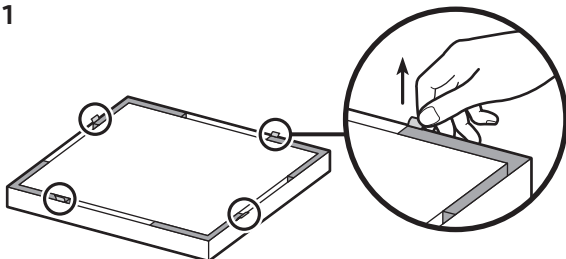

2

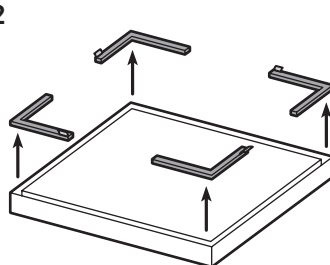

### 03 連接支架

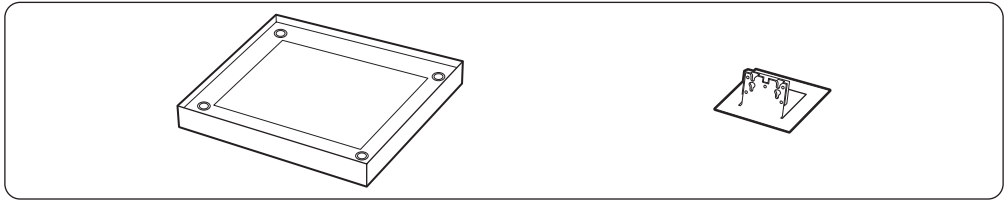

1

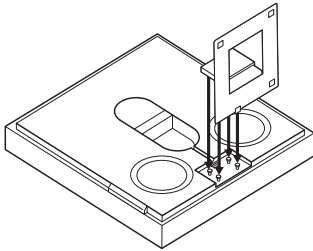

2

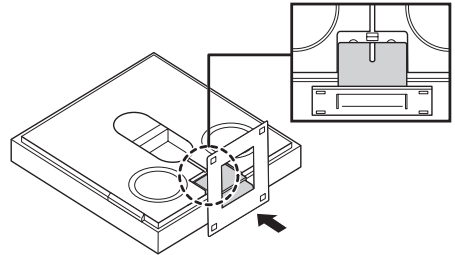

3

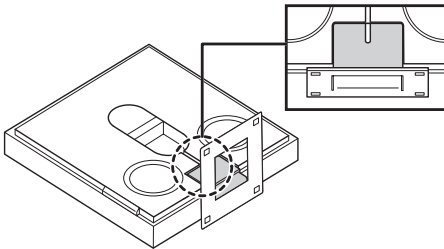

4

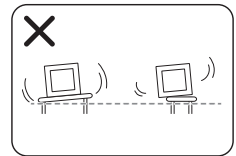
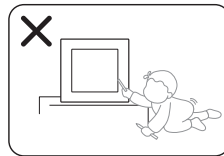
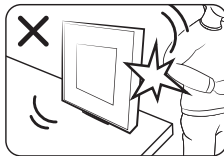
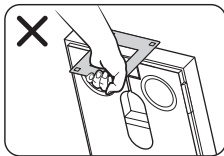
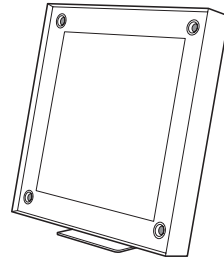

## 04 連接相片框架和藝術面板

### 連接相片框架

請確保相片框架的安全。否則，產品可能會掉落並造成損害或人身傷害。保養均不涵蓋因使用者使用不慎而造成的任何意外。

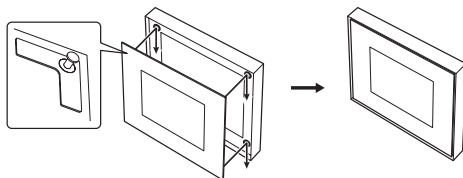

### 拆卸相片框架

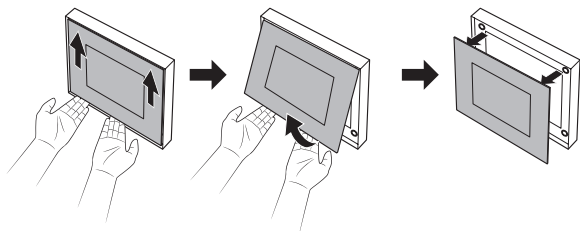

### 替換相片框架中的相片

相關資訊請瀏覽 Samsung 網站 (<http://www.samsung.com/support>)，並參閱本產品的《用戶指南》。

### 連接藝術面板

您可以使用以下兩個提供的元件零件，以插入您的藝術面板 (單獨出售)，而非相片框架。

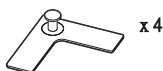

支撐板

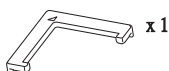

支撐導桿

- 如需安裝詳情，請前往 [www.samsung.com](http://www.samsung.com) 參閱此產品的使用指南。
- 藝術面板可在 Marple 網上商店 (<https://www.marple.com/musicframe>) 找到，且其可用性可能因您的所在地區而異。如需區域零售商的資訊，請瀏覽您當地的 Samsung 網站 ([www.samsung.com](http://www.samsung.com))。
- 藝術面板的分銷是由與本公司無關之第三方企業執行。此外，藝術面板的品質和安全性完全取決於第三方企業。區域零售商可能會根據其業務情況而有所變更。

## 05 產品概覽

### 正面

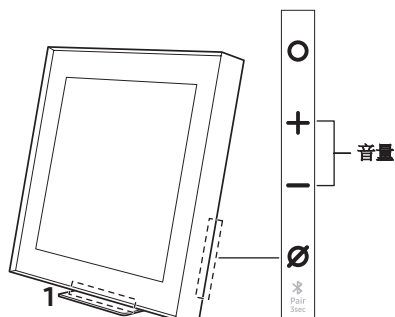

#### ○ (多功能) 按鈕

在待機模式下，按下 ○ (多功能) 按鈕以開啟無線揚聲器。按下 ○ (多功能) 按鈕以變更模式。

#### Ø (麥克風開/關) 按鈕

按下按鈕來開啟或關閉麥克風。

麥克風關閉時，LED 指示燈便會亮起紅色。

如要切換 Bluetooth 配對狀態，請按住無線揚聲器側邊的 Ø (麥克風開/關) 按鈕至少 3 秒。

#### 1 LED 指示燈

LED 指示燈根據無線揚聲器的目前模式或狀態閃爍、發光或改變顏色。

### 背面

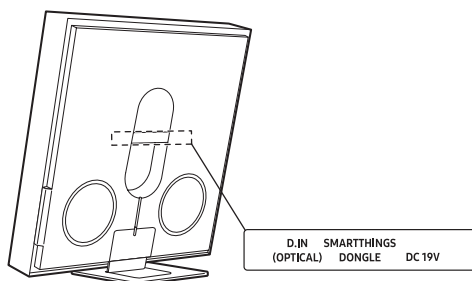

#### D. IN (OPTICAL)

連接至外置裝置的數位 (光纖) 輸出。

#### SMARTTHINGS DONGLE

請連接 SmartThings 分享器 (需另行購買)，以使用 SmartThings Hub 功能。

#### DC 19V

連接交流/直流電適配器。(電源供應輸入)

## 06 連接電源

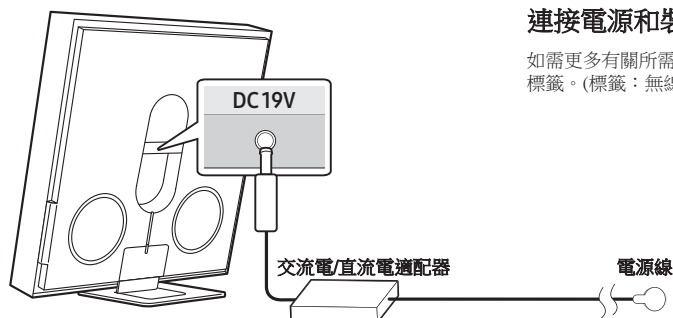

### 連接電源和裝置

如需更多有關所需電源及耗電的資料，請見產品上附有的標籤。(標籤：無線揚聲器主機後側)

## 07 連接 SMARTTHINGS 應用程式

### 1 安裝

- SmartThings 應用程式能讓您為無線揚聲器控制功能和調整設定。
- 請透過您流動裝置的 App Store 下載 SmartThings 應用程式，或是掃描提供的 QR 代碼並下載應用程式。
- QR 1：SmartThings 應用程式連線影片指南
- QR 2：下載 SmartThings 應用程式



QR 1



QR 2

### 2 裝置註冊

1. 請執行您流動裝置上的 SmartThings 應用程式。
2. 按照螢幕指示操作，並將產品加入到流動裝置。
  - 如自動彈出式視窗未有顯示，請按下主頁畫面上的 (+) 以註冊產品。

### 3 SmartThings 的控制

1. 請在裝置上開啟 SmartThings 應用程式後，選擇您所新增的無線揚聲器。
2. 無線揚聲器的設定功能表會隨即顯示，您可在其中調整各種設定，包括 Volume、Sound Mode 或 Advanced Sound Settings。
  - 對於其他想要控制 **Music Frame** 的用戶，請透過其流動裝置輕按 SmartThings 應用程式上的**功能表**(☰)，並前往 [如何使用] → [共享裝置控制]，以查看參考。

#### 注意

右方的圖片可能因應用程式版本而有所不同。



## 08 使用電視透過 WiFi 連接

使用音訊功能表，將電視的輸入來源改為無線揚聲器。

- 2017 年或之後發佈的 Samsung TV：(⦿) → 聲音 → 聲音輸出 → Music Frame (Wi-Fi)

#### 注意

- Wi-Fi 連接只適用於 Samsung TV。
- 電視與無線揚聲器必須連接至相同的無線網絡 (Wi-Fi)。
- 功能表可能會因製造年份而有所不同，請參閱您的電視機操作手冊。



## 09 使用 Q-Symphony 功能

- 僅在無線揚聲器和電視都連接到同一 Wi-Fi 網路時，才支援此功能。
- 2024 年即將發佈的 Samsung 電視型號適用此功能。

將無線揚聲器連接至支援 Q-Symphony 功能的 Samsung TV，即可同時從無線揚聲器和電視播放聲音。使用 Q-Symphony 功能，無線揚聲器播放的環繞音能讓您享受更加豐富、立體的環繞音效。

當連接無線揚聲器時，「Q-Symphony」功能表會出現在電視上。(顯示的訊息可能因電視型號而異。)

(設定 (⚙️) → 所有設定 (⚙️) → 聲音 → 聲音輸出)

## 10 使用流動裝置透過 Bluetooth 連線

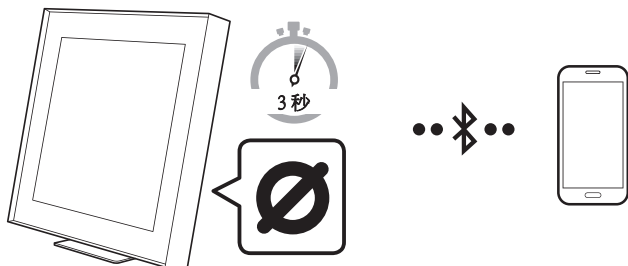

1. 按住 **⏻ (麥克風開/關)** 按鈕 3 秒進行配對。
  - 您亦可以在流動裝置的 SmartThings 應用程式畫面上，按下 **[⌵]** 進行配對。



2. 在您的流動裝置上搜尋 Bluetooth 裝置。
  - 您亦可以用同樣方式連接電視。



Ready to connect via Bluetooth.

### 注意

重新連接 Bluetooth 裝置時如需輸入 PIN 碼，請輸入 <0000>。

# 11 安裝支掛牆支架

## 安裝注意事項

- 僅可安裝於垂直的牆面上。
- 不要在高溫或潮濕的地方安裝。
- 檢查牆壁強度是否足以支撐產品的重量。如果強度不足，應該強化牆壁或選擇其他位置安裝。
- 把 Soundbar 安裝到牆上，先用纜線把設備和外置裝置連接起來。
- 確保設備已經關閉而且電源已經拔除，然後才著手安裝。否則可能會造成觸電。
- 請務必使用提供的掛牆元件零件。無論任何情況，保養均不涵蓋因使用第三方零件所造成的任何意外。

## 掛牆元件

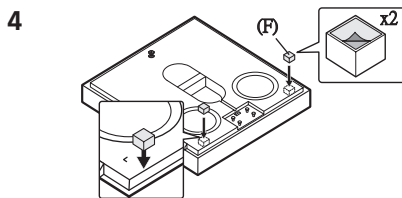
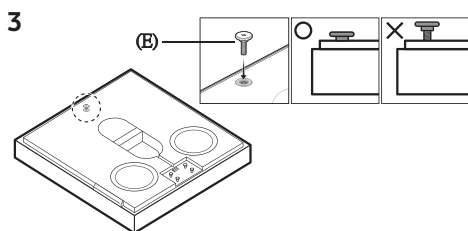
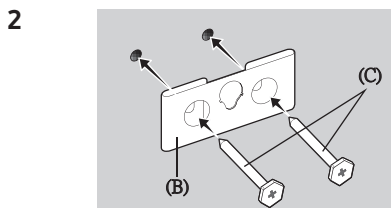
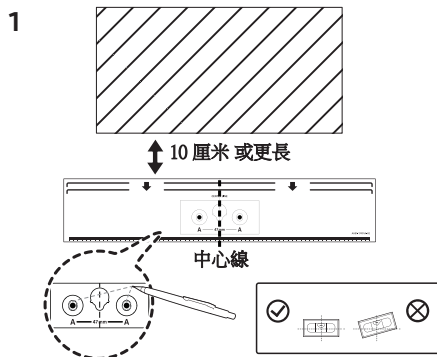
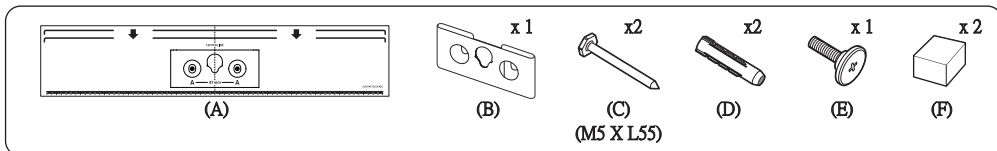

您必須安裝零件 (F)，以防止產品從掛牆安裝中脫出。您必須將其放在支架安裝上，並確保安全以供日後使用。如要重複使用，請使用雙面膠來黏貼。

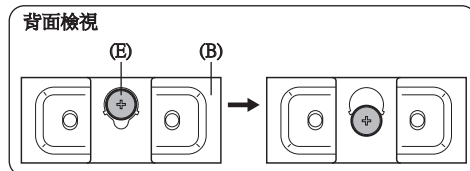
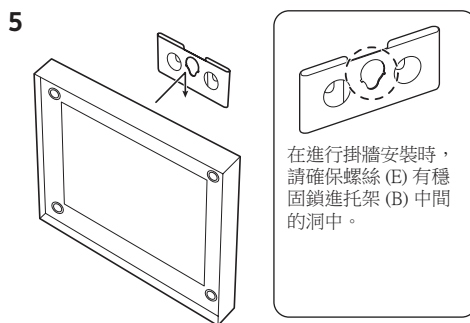

## 12 規格和指南

<b>型號名稱</b>	HW-LS60D
<b>重量</b>	
不帶支架	4.2 kg
帶支架	4.6 kg
<b>尺寸(寬 x 高 x 深)</b>	
不帶支架	353.0 x 353.0 x 54.2 毫米
帶支架	353.0 x 364.8 x 143.4 毫米
<b>操作溫度範圍</b> ：+10 °C 至 +40 °C	
<b>操作濕度範圍</b> ：10 % 至 80 %，非冷凝	
<b>存放溫度範圍</b> ：-20 °C 至 +45 °C	
<b>存放濕度範圍</b> ：5 % 至 95 %，非冷凝	

### 支援的播放格式

Dolby 5.1ch / Dolby Digital Plus /  
Dolby ATMOS (Dolby Digital Plus) / LPCM 2ch

### 啟用/停用 Wi-Fi 連接

同時按住 **⏻ (麥克風開/關)** 按鈕和側面板上的 **-** 按鈕超過 30 秒。這樣便可開啟或關閉 Wi-Fi 連接。

### 啟用/停用 Bluetooth 連線

同時按住 **⏻ (麥克風開/關)** 按鈕和側面板上的 **+** 按鈕超過 30 秒。這樣便可開啟或關閉 Bluetooth 連線。

**預防措施**：如果您開啟/關閉 Wi-Fi 或 Bluetooth，無線揚聲器將自動重新啟動。

### 注意

- Samsung Electronics Co., Ltd 保留更改規格的權利，恕不另行通知。
- 重量和尺寸均為約數。

## 13 故障排除

在尋求幫助前，請檢查以下事項。

### 無線揚聲器未開啟。

- 檢查無線揚聲器的電源線有否正確插入插座。

### 無線揚聲器運作異常。

- 拔下電源插頭，然後重新連接。
- 初始化產品後重試一次。
- 如沒有訊號，無線揚聲器會在一定時間後自動關閉。關閉電源。

### 無線揚聲器上的紅色 LED 指示燈保持亮起。

- 麥克風已關閉。開啟麥克風。

LED 指示燈	
○ ○ ● ○ ○ - 紅燈亮起	麥克風關閉
○ ○ ○ ○ ○	麥克風開啟

### 聲音沒有透過無線揚聲器輸出。

- 無線揚聲器音量太低或靜音。調整音量。
- 如果連接了任何外置裝置 (STB、藍牙裝置、流動裝置等等)，請調整該外置裝置的音量。
- 如需電視的聲音輸出，請選擇無線揚聲器。(Samsung 電視：[首頁] (🏠) → [功能表] → [設定] (⚙️) → [所有設定] (📶) → [聲音] → [聲音輸出] → 選取無線揚聲器)
- 從無線揚聲器移除纜線，然後重新連接。

### 無線揚聲器無法透過 Bluetooth 連線。

- 連接新裝置時，切換至「BT PAIRING」，以進行連接。(按下機身上的  (麥克風開/關) 按鈕至少 3 秒。)
- 從可連接裝置清單移除藍牙揚聲器清單後重新連接。(Samsung 電視：首頁 (🏠) → 功能表 → 設定 (⚙️) → 所有設定 (📶) → 聲音 → 聲音輸出 → Bluetooth 揚聲器清單)

### 透過 Bluetooth 連接時沒有聲音。

- 部份裝置在太靠近無線揚聲器時會造成無線電干擾。例如，微波爐、無線路由器等。
- 如果透過 Bluetooth 連線的裝置離無線揚聲器太遠，可能會造成聲音中斷。請將裝置移到更靠近無線揚聲器的位置。
- 如果您身體的某部位接觸到 Bluetooth 收發器，或者產品安裝於金屬傢俱上，便可能會沒有聲音。請檢查安裝環境和使用條件。

### 無線揚聲器無法連接至 Wi-Fi。

- 確保無線路由器已經啟動，並於重啟後重新連接無線路由器。
- 如果無線訊號過弱，無線揚聲器便有可能無法連接。請嘗試將路由器移到更靠近無線揚聲器的位置，或者盡可能清除無線揚聲器與路由器之間的障礙物。

### 無線揚聲器未透過電視自動開啟。









- 如您在觀看電視時關閉無線揚聲器，會停用與電視之間的電源同步。請先把電視關掉。

# 安全資料

## 安全警告

為減少觸電的危險，切勿移除機蓋（或後蓋）。內部沒有使用者可自行維修的零件。請聯絡合資格的服務人員進行維修。

參閱下表，以取得三星產品上標誌的詮釋。

	<div>注意</div> <div>有電擊危險。切勿打開</div> <div></div>
	此符號表示內部存在高電壓。以任何形式接觸本產品的任何內部零件都會產生危險。
	此符號表示此產品已隨附與操作和維護有關的重要文獻。
	II 類產品：此符號表示無需連接安全接地線（地線）。 如此標誌沒有在帶有電源線的產品上出現，則產品必須正確連接保護地線。
	AC 直流電壓：標有此符號的額定電壓是 AC 直流電壓。
	DC 直流電壓：標有此符號的額定電壓是 DC 直流電壓。
	注意：請參閱使用說明；此符號指示使用者應參閱使用者手冊，以進一步了解與安全相關的資訊。

## 警告

- 為減少觸電的危險，切勿將本產品暴露於雨水或水份之中。
- 請勿在產品周圍使用含有化學物質的液體蒸氣器，例如驅蚊劑或空氣清新劑。如果蒸氣接觸產品表面或進入產品，可能會令產品留有污垢或故障。

## 注意

- 為免觸電，應將插頭的寬葉片完全插進寬插槽。
- 此設備應一律透過具保護效能的接地線連接至 AC 交流電源插座。
- 如要中斷設備與電源的連接，必須從電源插座中拔出插頭，因此電源插頭能正常運作易於使用。
- 切勿將本設備暴露於有滴水或濺水的地方。切勿將花瓶等裝滿液體的物品放在此設備上。
- 如要完全關閉本設備，必須從入牆插座中拔出電源插頭。因此，電源插頭必須一律放在易於接觸的位置。

## 注意事項

- 確定您屋內的交流電源供應符合產品底部識別標籤上列出的電源要求。在合適的底座（傢俱）上水平安裝產品，並且週圍留有足夠的通風空間（7~10 厘米）。確定通風槽不被覆蓋。請勿將裝置放在擴音器或其他可能會變熱的設備上。本裝置是專為連續使用而設計。  
若要完全關閉電源，請從牆上插座拔出交流插頭。如果您打算長時間不使用本裝置，請拔下電源插頭。
- 在雷暴期間，請從入牆插座拔出 AC 交流插頭。雷電引起的電壓峰值可能會損壞裝置。
- 請勿將裝置直接曝曬於陽光下或其他熱源中。這可能會引起過熱並導致裝置故障。
- 防止產品受潮（例如花瓶）、過熱（例如壁爐）或遠離會產生較強磁場或電場的設備。如果裝置發生故障，從牆上交流插座拔出電源纜線。您的產品不適合工業使用。它是僅供個人使用。如果存儲在寒冷的氣溫下，產品可能會出現冷凝。如果在冬季運輸裝置，等待大約 2 小時，直到裝置達到室溫後才使用。
- 請確保交流電/直流電適配器平穩放在桌面上或地上。若您將交流電/直流電適配器的交流電源線插口朝上懸掛，水或其他異物可能進入適配器而導致其無法正常工作。

本頁留白。

本頁留白。

# SAMSUNG

## Contact SAMSUNG WORLD WIDE

If you have any questions or comments relating to Samsung products, please contact the SAMSUNG customer care Centre.

Country/Region	Samsung Service Center 	Web Site
HONG KONG	3698 4698 ( All Product ) 3698 4688 ( B2B ) 3698 4633 ( eStore )	www.samsung.com/hk/support (Chinese) www.samsung.com/hk_en/support (English)
MACAU	0800 333	