

How to Wear



Gently insert the earbud into the ear canal, adjust the earbud to the most comfortable wearing state.



When calling, adjust Mic towards mouth to gain better talking experience.

How to Charge

For first time use, please remove the isolation film on the charging contacts of both earbuds. Then fully charge the charging case and earbuds.

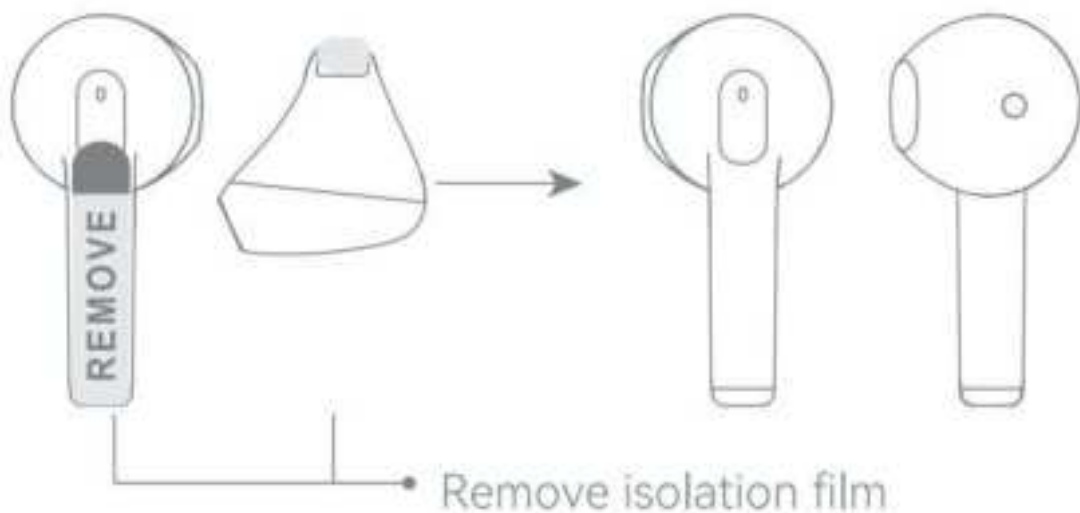

Plug charging cable to charge the earbuds and the charging case at the same time.

When the charging case is not fully charged, the LED flashes quickly. After fully charged, the LED flashes solid red.



Warm tips: the earbuds can't be charged when the charging case has no power and no LED Light.

Power-on

Take the earbuds out from the charging case, they will automatically power on.

Power-off

1. Put the earbuds back into the charging case. if the charging case has power, the earbud will automatically power off. If the charging case has no power, the earbud will maintain the current state.
2. The earbuds power off outside the charging case: they will automatically power off if not connected to the device within 3 minutes.

How to Pair

Automatic connection: Take the earbuds out, they will complete TWS re-connection within 5s and enter the pairing state; or they will enter monaural pairing state after 5s.

Open device Bluetooth and search for "X1 C", then click it to connect.

Put the earbuds back into the charging case and repeat the above operation if the connection fails.

After the first connection, the earbuds can be automatically connected to the last paired device when powering on (Bluetooth needs to be turned on).



When pairing, the green light of the charging case continuously flashes.

Functions



Restore Factory Settings

1. Triple click on both earbuds and press and hold for 3s upon the third click. The earbuds will restore factory settings when there is a prompt tone.
2. After resetting, put the earbuds into the charging case and close the lid, then open the lid and take them out again;
3. Clear phone pairing record and follow the pairing steps to complete Bluetooth connection.

Audio only Outputs from Single Earbud

It's unusual indeed, please refer to the following operation steps if the situation occurs:

1. Put the earbuds back into the charging case, and then take them out again to connect.
2. Refer to the reset steps to reconnect the Bluetooth device.

Other Charging Problems

1. The white LED goes out when the earbuds are fully charged.
2. When the charging case is out of power, the earbuds cannot be charged and keep the original connecting status.
3. The LED flashes solid when the charging case is fully charged.

Package Overview

Earbuds, charging case, Charging cable, user manual.

Earbud model: X1C

Earbud name: True Wireless Earbuds

Basic Parameters(earbuds) Operation range: 10m (open space with no obstacle)

Battery capacity: 30mAh(single earbud)

Charging time: approx. 1.5h

Playing time: approx. 5h

Input parameter: 5V = 50mA

Battery type: li-ion Bluetooth version: V5.3

Basic Parameters(charging case)

Input parameter: 5V = 500mA

Output parameter: 5V = 100mA

Charging time: approx. 2h

Battery capacity: 280mAh Battery type: li-ion

Caveats

Warning

1. Do not disassemble, repair or modify the product for any reason, as this may cause fire or even completely destroy the product.
2. Do not expose the product to environments where the temperature is too low or too high (below 0°C or above 45°C).
3. Keep the indicators away from the eyes of children and animals while using the earphones.
4. Do not use this product during thunderstorms. Thunderstorms may cause the product to malfunction and increase the risk of electric shocks.
5. Do not wipe and clean the earphones or their case with alcohol or other volatile liquids.
6. Avoid any contact with liquids.

Note

1. Please read this user manual carefully before using the product and please properly store it.
2. When using for the first time, please fully charge this product.
3. Please charge the product, in case it has not been used over two weeks.
4. Please use certificated charger.
5. Do not wear earphones for a long term to protect your hearing.
6. Do not wear earphones in any situations with potential risks as wearing them may reduce your perception to the outside world.

FCC Statement:

This device complies with Part 15 of the FCC rules. Operation is subject to the following two conditions: 1) this