

PowerXLTM
products that excel

VORTEX AIR FRYER PRO



Owner's Manual

MODEL: CM-005



ALWAYS READ AND FOLLOW THIS OWNER'S MANUAL
BEFORE USING YOUR APPLIANCE. SAVE FOR FUTURE REFERENCE.

FOR HOUSEHOLD USE ONLY

When using electrical appliances, basic safety precautions should always be followed. Do not use the **PowerXL Vortex Air Fryer Pro**TM until you have read this manual thoroughly.

Visit [TristarCares.com](https://www.TristarCares.com) for tutorial videos, product details, and more.
Guarantee Information Inside



PowerXL Vortex Air Fryer Pro

BEFORE YOU BEGIN

The **PowerXL Vortex Air Fryer Pro™** will provide you many years of delicious family meals and memories around the dinner table. But before you begin, it's very important that you read this entire manual, making certain that you are totally familiar with this appliance's operation and precautions.

Table of Contents

IMPORTANT SAFEGUARDS	4
Parts & Accessories	8
Using the Control Panel	10
Using the Control Panel Accessories	12
Cooking Presets	13
General Operating Instructions	14
General Cooking Guidelines	16
Cleaning & Storage	20
Troubleshooting	21
Frequently Asked Questions	22
Money-Back Guarantee	23

IMPORTANT SAFEGUARDS

WARNING

PREVENT INJURIES! – CAREFULLY READ ALL INSTRUCTIONS BEFORE USE!

When using electrical appliances, always follow these basic safety precautions.

1. **READ ALL INSTRUCTIONS.**
2. This appliance is not intended for use by persons (including children) with reduced physical, sensory, mental capabilities or lack of experience and knowledge unless they are given supervision or instruction concerning use of the appliance by a person responsible for their safety.
3. Close supervision is necessary when any appliance is used by or near children.

Where to Use the Appliance

4. **DO NOT** place on or near a hot gas or electric burner, or in a heated oven.
5. **DO NOT** place your appliance on a cooktop, even if the cooktop is cool, because you could accidentally turn the cooktop on, causing a fire, damaging the appliance, your cooktop, and your home. 
6. **DO NOT** place or use this appliance near water.
7. When cooking, **DO NOT** place the appliance against a wall or within 5 inches of other appliances. **DO NOT** place anything on top of the appliance.
8. A fire may occur if this appliance is covered by or touching flammable material, including curtains, draperies, walls, and the like, when in operation.
9. **DO NOT** use outdoors.
10. **DO NOT** place the appliance in any container or small confined space while the appliance is heated or in operation.
11. **ALWAYS** operate the appliance on a horizontal surface that is level, stable, and noncombustible with

adequate space for airflow.

12. Before using your appliance on any countertop surface or other fragile surface, such as a glass tabletop, **CHECK WITH YOUR COUNTERTOP MANUFACTURER OR INSTALLER** for recommendations about using appliances on your surfaces. Some manufacturers and installers may recommend protecting your surface by placing a hot pad or trivet under the appliance for heat protection. Your manufacturer or installer may recommend that hot pans, pots, or electrical appliances should not be used directly on top of the countertop. If you are unsure, place a trivet or hot pad under the appliance before using it.

Electrical Safety

13. **THIS APPLIANCE HAS A POLARIZED PLUG** (one blade is wider than the other). To reduce the risk of electric shock, this plug is intended to fit into a polarized outlet only one way. If the plug does not fit fully into the outlet, reverse the plug. If it still does not fit, contact a qualified electrician. **DO NOT ATTEMPT** to modify the plug in any way.
14. **DO NOT** operate any appliance if it has a damaged cord or plug, if it is not working properly, or if it has been damaged or dropped. Return appliance to an authorized service facility for examination, repair, or adjustment.
15. This appliance should be serviced **ONLY** by qualified service technicians. Contact Customer Service using the information located on the back of this manual.
16. **NEVER** immerse housing in water. If the Unit falls or accidentally becomes immersed in water, unplug from wall outlet immediately. Do not reach into liquid if the Unit is plugged in and immersed.
17. To protect against electrical shock, **DO NOT** immerse cord, plugs, or expose the electrical components to water or other liquid.
18. **DO NOT** plug in the power cord or operate the appliance controls with wet hands.

IMPORTANT SAFEGUARDS

19. **ALWAYS** make sure the plug is attached to the appliance first, then plug the cord into the wall outlet. To disconnect, press the Power button to turn the appliance off, then remove the plug from the wall outlet.
20. A short power supply cord is provided to reduce the risk of entanglement or tripping over a longer cord. Longer detachable power-supply cords or extension cords are available and may be used if care is exercised in their use. If a longer detachable power-supply cord or extension cord is used:
 - a. The marked electrical rating of the cord set or extension cord should be at least as great as the electrical rating of the appliance.
 - b. The cord should be arranged so that it will not drape over the countertop or tabletop where it can be pulled on by children or tripped over unintentionally.
 - c. If the appliance is of the grounded type, the cord set or extension cord should be a grounding-type 3-wire cord.
21. **KEEP** the appliance and its power cord out of reach of children when it is in operation or in the cooling down process.
22. **NEVER** plug the appliance into an outlet below the surface where the appliance is placed.
23. **DO NOT** let the power cord hang over the edge of a table or counter, or touch hot surfaces.
24. **DO NOT** clean with metal scouring pads. Pieces can break off the pad and touch electrical parts, creating risks of electric shock.

Operational Safety

25. Should the appliance emit black smoke, **UNPLUG IMMEDIATELY** and wait for smoking to stop before handling the appliance. Allow the appliance to cool and wipe excess oil and grease from the appliance.
26. Cooking appliances should be positioned in a stable location with the handles (if any) positioned to avoid the spillage of hot liquids.

27. **NEVER** operate the appliance unattended.
28. **NEVER** connect this appliance to an external timer switch or separate remote-control system.
29. The use of accessory attachments not recommended by the appliance manufacturer may cause injuries.
30. **UNPLUG** the appliance from outlet when not in use and before cleaning. **ALLOW** 30 minutes to cool before handling, putting on or taking off parts, cleaning, or storing.
31. **DO NOT** cover the Air Intake Vent or Hot Air Outlet Vent while the appliance is operating. Doing so will prevent even cooking and may overheat or damage the appliance.
32. When in operation, hot air and steam is released through the Hot Air Outlet Vent. **KEEP YOUR HANDS AND FACE** at a safe distance from the Hot Air Outlet Vent and **KEEP** the Vent clear of obstructions.
33. While cooking, the internal temperature of the appliance reaches several hundred degrees Fahrenheit. To avoid personal injury, **NEVER** place hands inside the appliance unless it is thoroughly cooled.
34. The appliance's outer surfaces and accessories may become hot during use. **WEAR OVEN MITTS** when handling the appliance during and after use, and to protect against hot steam and air released when opening the appliance.
35. **DO NOT** touch hot surfaces. Use handles or knobs.
36. **EXTREME CAUTION MUST BE USED** when moving an appliance containing hot oil or other hot liquids or when removing accessories or disposing of hot grease. This appliance is not intended for deep-frying foods.
37. Oversized foods, metal foil packages, or utensils **MUST NOT** be inserted in the appliance as they may involve a risk of fire or electric shock. **DO NOT** overfill the appliance.

SAVE THESE INSTRUCTIONS – FOR HOUSEHOLD USE ONLY

SAVE THESE INSTRUCTIONS – FOR HOUSEHOLD USE ONLY

IMPORTANT SAFEGUARDS

- 38. **DO NOT** store any materials, other than manufacturer-recommended accessories, in this appliance when not in use.
- 39. **DO NOT** place any of the following materials in the appliance: paper, cardboard, plastic.
- 40. **NEVER** pour oil into the appliance or accessories. Fire and personal injury could result. **NEVER** fill with cooking oil, lard, or any other substance to prevent FIRE or SERIOUS INJURY.

Appliance Hazards

- 41. **DO NOT** use aerosol cooking sprays. These sprays will build up on cookware and become difficult to remove while reducing the nonstick cooking performance.
- 42. **DO NOT** expose the appliance to corrosive chemicals or vapors.
- 43. **DO NOT** use sharp utensils with the appliance. These implements can damage the appliance’s protective non-stick coating.

- 44. When cleaning the appliance interior, use **ONLY** mild, nonabrasive soaps or detergents applied with a sponge or soft cloth.
- 45. This appliance is for home use only. If the appliance is used improperly or for professional or semi-professional purposes or if it is not used according to the instructions in the user manual, the guarantee becomes invalid and Tristar will not be held liable for damages. **DO NOT** use this appliance for anything other than its intended use.

46. SAVE THESE INSTRUCTIONS

**WARNING:**

For California Residents

This product can expose you to Di(2-ethylhexyl)phthalate, which is known to the State of California to cause cancer and birth defects or other reproductive harm. For more information go to www.P65Warnings.ca.gov.

AF1.0

SAVE THESE INSTRUCTIONS – FOR HOUSEHOLD USE ONLY

WARNING:

- **NEVER** rest anything on the door while it is open.
- **DO NOT** leave the door open for an extended period.
- **ALWAYS** ensure that nothing is protruding from the appliance before closing the door.
- **ALWAYS** close the door gently; **NEVER** slam the door closed. **ALWAYS** hold the handle of the door when opening and closing the door.
- The appliance **MUST** be operated with the Drip Tray in place, and the Drip Tray **MUST** be cleaned if it becomes more than half full.
- **NEVER** operate your appliance with the door open.
- **NEVER** put the Air Flow Rack directly on the top of the lower heating elements.
- When the cooking time has completed, cooking will stop and the fan will continue to run for 10 to 20 seconds to cool down the appliance.
- The appliance is equipped with an internal microswitch that automatically shuts down the fan and heating element when the door is opened.

IMPORTANT SAFEGUARDS

GROUNDING INSTRUCTIONS

This appliance must be grounded. In the event of an electrical short circuit, grounding reduces the risk of electric shock by providing an escape wire for the electric current. This appliance is equipped with a cord with a grounding wire and grounding plug. The plug must be plugged into an outlet that is properly installed and grounded. Consult a qualified electrician or serviceman if the grounding instructions are not completely understood or if doubt exists as to whether the appliance is properly grounded. If it is necessary to use an extension cord, use only a 3-wire extension cord that has a 3-pronged grounding plug and a 3-slot receptacle that will accept the plug on the appliance.

1. Plug the power cord into a 3-prong, 120V grounded outlet with no other appliances on the same outlet. Plugging other appliances into the outlet will cause the circuit to overload.
2. Never tug the plug forcefully from the wall outlet.
3. A short power-supply cord is provided to reduce the risks resulting from becoming entangled in or tripping over a longer cord.
4. Longer cord sets or an extension cord should not be used unless the following precautions are followed (see 3, below).
5. If a long cord or extension cord is used:
 - a. The marked electrical rating of the cord set or extension cord should match the rating of the appliance.
 - b. The extension cord must be a grounding-type 3-wire cord.
 - c. The longer cord should be arranged so that it will not drape over the countertop or tabletop where it can be pulled on by children or tripped over.

Automatic Shut-Off

The appliance has a built-in shut-off device that will automatically shut off the appliance when the cooking time has completed. You can manually switch off the appliance by pressing the Power Button. The fan will continue running for 10 to 20 seconds to cool down the appliance.

Overheating Protection

Should the inner temperature control system fail, the overheating protection system will be activated and the appliance will not function. Should this happen, unplug the appliance. Allow time for the appliance to cool completely before restarting or storing.

Electromagnetic Fields

This appliance complies with all standards regarding electromagnetic fields. If handled properly and according to the instructions in the user manual, the appliance is safe to use based on scientific evidence available today.

Parts & Accessories

NOTE: Unpack all contents from the packaging. Contents vary by model. Check all packaging material carefully for parts. Please remove any clear or blue protective film on the components.
*Optional items may be sold separately.

1. Main Unit

2. Control Panel

3. Air Intake Vents

4. Hot Air Outlet Vents
5. Drip Tray

6. Air Flow Racks (3)

7. Rotisserie Fetch Tool

8. Rotisserie Shaft, Forks & Set Screws
- 9.* Adjustable Skewers Rack (2)

10.* Skewers (10)

11.* Rotating Basket

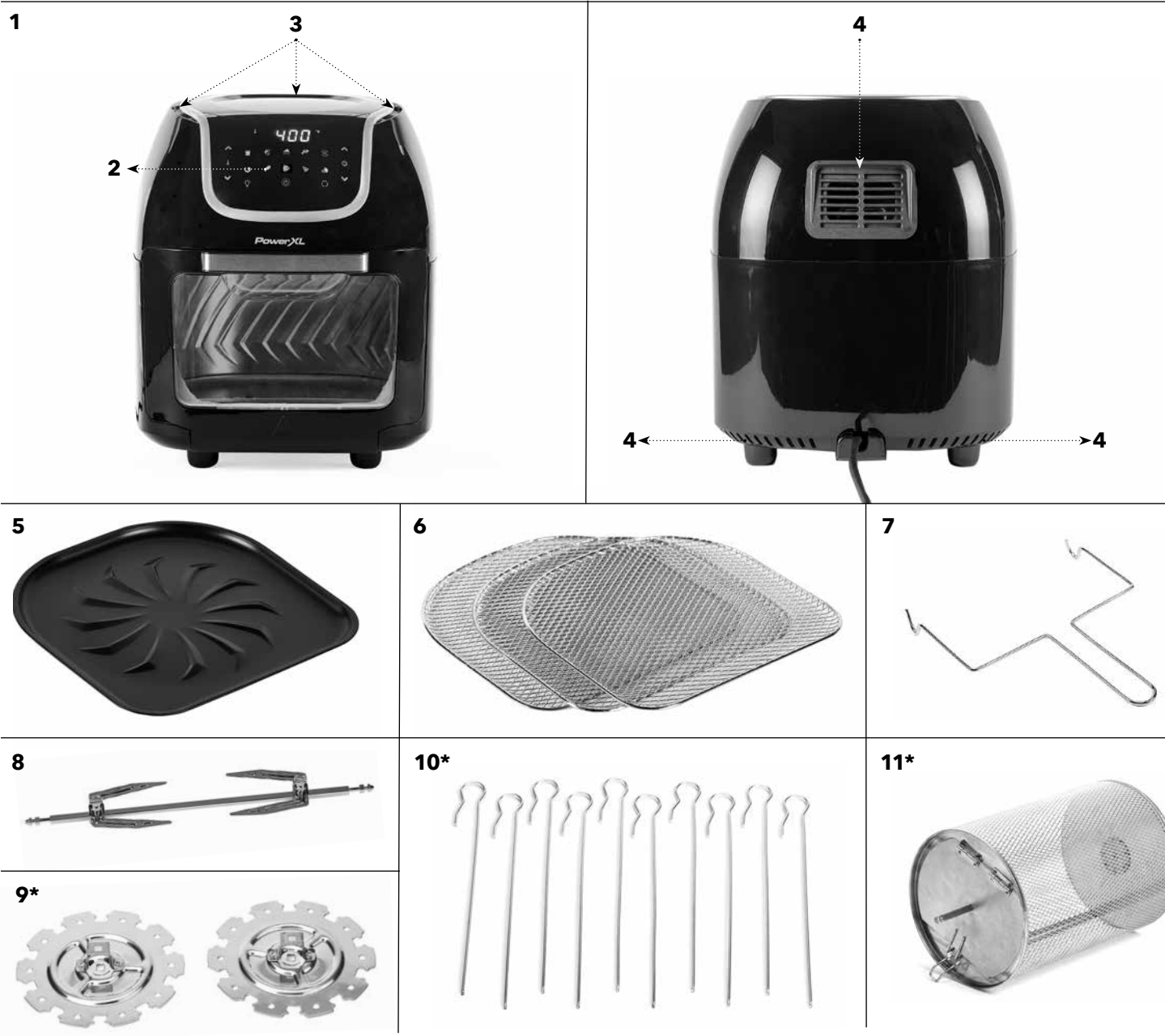

Parts & Accessories

IMPORTANT: Please make sure that your appliance has been shipped with the components that you ordered (some accessories may be sold separately). Check everything carefully before use. If any part is missing or damaged, do not use this product. Contact Customer Service using the number located in the back of the owner's manual.

5. Drip Tray

6. Air Flow Racks

7. Rotisserie Fetch Tool

8. Rotisserie Shaft, Forks & Set Screws
- 9.* Adjustable Skewers Rack*

10. Skewers*

11. Rotating Mesh Basket*

NOTE: Ensure that the roast or chicken rotate freely within the appliance. If the item being cooked is too large, it will not rotate or cook evenly (3.5-4 lb on average). Wrap the meat with kitchen string to help with even rotation.

9. Adjustable Skewers Rack*

10. Skewers*

11. Rotating Mesh Basket*

* May be sold separately

CAUTION: The appliance may get hot. Be careful not to touch the appliance while in use. Keep the appliance away from other objects.

WARNING
The Forks, Shaft, and other metal parts with this appliance are sharp and will get extremely hot during use. Great care should be taken to avoid personal injury. Wear protective oven mitts or gloves.

Appliance Specifications

Model Number	Supply Power	Rated Power	Capacity	Temperature	Display
CM-005	AC 120V 60Hz	1700W	10 qt. (577 cubic inches)	90° F-400° F (32° C-204° C)	LED Touch Screen

Using the Control Panel

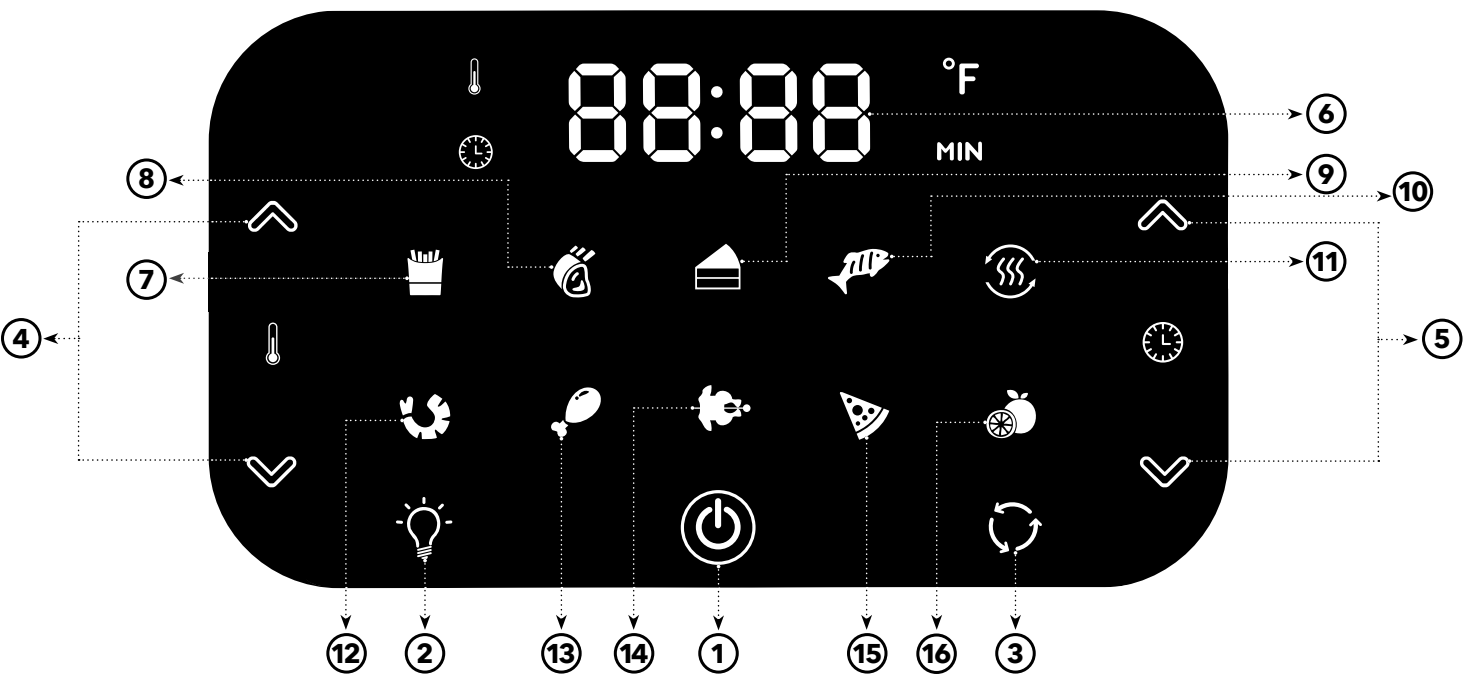

- 1. Power Button:** Once the appliance is plugged in, the Control Panel will light up. Pressing the Power Button will set the appliance to a default temperature of 370° F and time of 15 minutes. Pressing the Power Button again will start the cooking process. Pressing the Power Button during the cooking cycle will shut off the appliance.
- 2. Internal Light:** Selecting this button will help you check cooking progress while appliance is in operation. Note: Opening the door during the cooking process will pause the appliance. Internal light will illuminate if the door opens.
- 3. Rotation Button:** Select this button when cooking anything using the Rotisserie Mode. The icon will blink while in use.
- 4. Temperature Control Buttons:** These buttons enable you to raise or lower cooking temperature by 5° F (2.7° C) intervals ranging from 150° F (66° C) to 400° F (204° C). Dehydration ranges from 90° F (32° C) to 170° F (77° C).

- 5. Time Control Buttons:** These buttons enable you to select an exact cooking time to the minute, from 1 min. to 60 mins. in all modes except when dehydrating, which uses 30-min. intervals and an operating time of 2-24 hrs.
- 6. LED Digital Display:** The Digital Numeric Display will alternate between displaying the temperature and the remaining time during the cooking process.
- 7-16. Cooking Presets:** Selecting any Preset Button sets the time and temperature to the preset's default value. The cooking process starts automatically 5 secs. after the Preset has been selected, or the Power Button can be pressed after the Preset Button to start the appliance immediately. You may use the Time and Temperature Buttons to override the preset settings.

Using the Control Panel

Preset Button Cooking Chart

* Cooking time for whole roasted chicken will vary with weight. Use meat thermometer to check internal temperature as per chart below.

Preset Button	Temperature	Time
7. French Fry	400° F (204° C)	18 mins.
8. Roast	350° F (177° C)	30 mins.
9. Baking	320° F (160° C)	30 mins.
10. Fish	320° F (160° C)	15 mins.
11. Reheat*	240° F (116° C)	12 mins.
12. Shrimp	320° F (160° C)	12 mins.
13. Chicken	370° F (188° C)	40 mins.
14. Rotisserie	375° F (191° C)	30 mins.*
15. Pizza	360° F (182° C)	15 mins.
16. Dehydrator	120° F (49° C)	2 hrs.

Using the Appliance Without Presets

Once you are familiar with the appliance, you may want to experiment with your own cooking times and temperatures.

! WARNING

Never use a cooking vessel filled with cooking oil or any other liquid with this appliance! Fire hazard or personal injury could result.

Internal Temperature Meat Chart

Use this chart and a food thermometer to ensure that meat, poultry, seafood, and other cooked foods reach a safe minimum internal temperature.

*For maximum food safety, the U.S. Department of Agriculture recommends 165° F for all poultry; 160° F for ground beef, lamb, and pork; and 145° F, with a 3-minute resting period, for all other types of beef, lamb, and pork. Also review the USDA Food Safety Standards.

Food	Type	Internal Temp.*
Beef & Veal	Ground	160° F (71° C)
	Steaks, roasts: medium	145° F (63° C)
	Steaks, roasts: rare	125° F (52° C)
Chicken & Turkey	Breasts	165° F (75° C)
	Ground, stuffed	165° F (75° C)
	Whole bird, legs, thighs, wings	165° F (75° C)
Fish & Shellfish	Any type	145° F (63° C)
Lamb	Ground	160° F (71° C)
	Steaks, roasts: medium	140° F (60° C)
	Steaks, roasts: rare	130° F (55° C)
Pork	Chops, ground, ribs, roasts	160° F (71° C)
	Fully cooked ham	140° F (60° C)

Using the Accessories

Placing Air Flow Racks

- 1. Insert the Drip Tray into the bottom of the appliance (**Fig. A**).
- 2. Place Air Flow Racks into the appliance by sliding them through the side grooves and onto the back lip (**Fig. B**).
- 3. Place the Air Flow Racks closer to the top heating element for faster cooking and added crisp.
- 4. Rotate the Air Flow Racks mid-cycle for even cooking.



Fig. A



Fig. B

Using the Accessories

Using The Rotisserie Spit

- 1. With the Forks removed, force the Rotisserie Shaft through the center of the food lengthwise.
NOTE: To support the food on the Rotisserie Spit better, insert the Rotisserie Forks into the food at different angles (see **Fig. C**).
- 2. Slide the Forks (A) onto each side of the Spit and secure them in place by tightening the two Set Screws (B).
- 3. Hold the assembled Rotisserie Spit at a slight angle with the right side higher than the left side and insert the left side of the Spit into the Rotisserie connection inside the appliance (see **Fig. D**).
- 4. With the left side securely in place, lower the right side of the Spit into the Rotisserie connection on the right side of the appliance (see **Fig. E**).
- 5. To remove cooked food, insert a large fork into the food, twist left, and raise to remove the Spit from the left slot and then remove the food from appliance with slight lifting motion. Transfer the food to a carving board or serving plate.

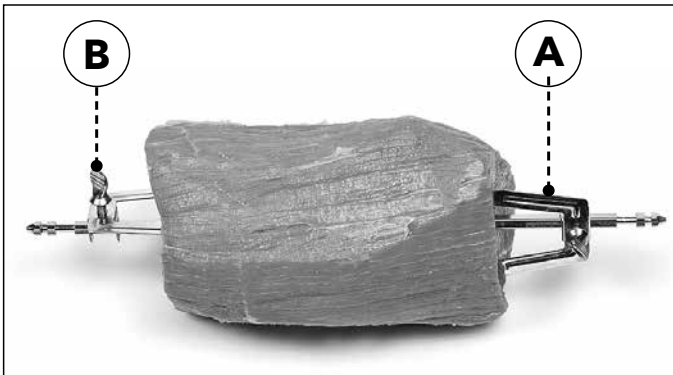

Fig. C



Fig. D

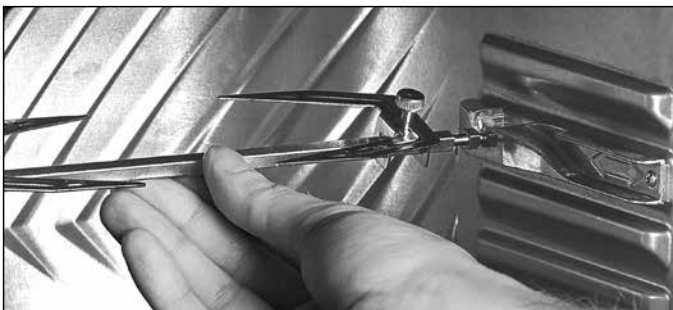

Fig. E

Removing Rotisserie Spit

- 1. Using the Fetch Tool, hook the bottom of the left and right sides of the shaft attached to the Rotisserie Spit (**Fig. F**).
- 2. Pull the Rotisserie Spit slightly to the right to disconnect the accessory from the Rotisserie Socket.
- 3. Carefully pull and remove the Rotisserie Spit from the appliance.



Fig. F

Using the Accessories

Skewer Rack Assembly

1. Insert each Skewer point through holes on the left Skewer Rack (**Fig. G**).
2. Squeeze the clip end of each Skewer as you insert into the opposite Skewer Rack slot to secure.
3. Release clip to securely rest in slot as shown (**Fig. H**).
4. Repeat steps 3-6 in a uniform manner around the Skewer Rack. Make sure Skewers are evenly spaced.
5. Ensure the Skewer Racks are inside the indentations on the Shaft, tighten the Set Screws and ensure they are securely in place.
6. Use caution while inserting the Shaft into the appliance. The Skewer ends are sharp and can poke you.

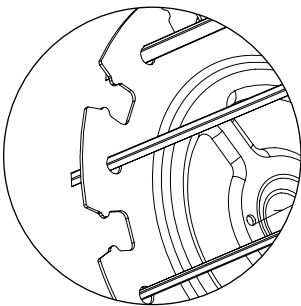

Fig. G - LEFT SIDE

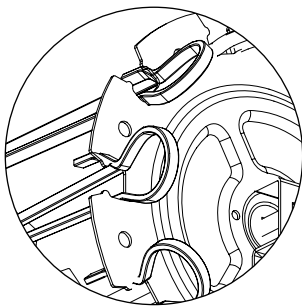
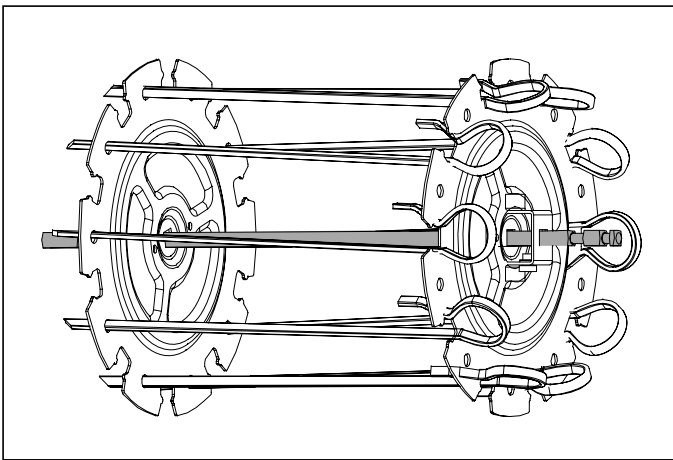

Fig. H - RIGHT SIDE



FINAL ASSEMBLY

Using the Accessories

Placing Skewer Rack or Rotating Mesh Basket into Appliance

1. Insert the left side of the assembled Spit or Basket first into the Rotisserie Shaft socket. Be sure the Rotisserie Shaft is in place to engage rotation (**Fig. I**).
2. Place the right side onto the hanger (**Fig. J**).

IMPORTANT: See the Final Assembly diagram (page 8) to help identify the left and right sides of the Rotisserie Shaft before placing it in the appliance. The right side has two notches, and the left has one.

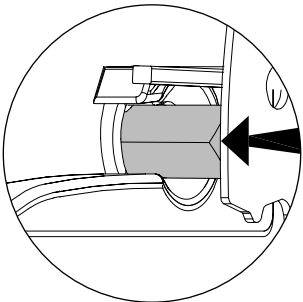
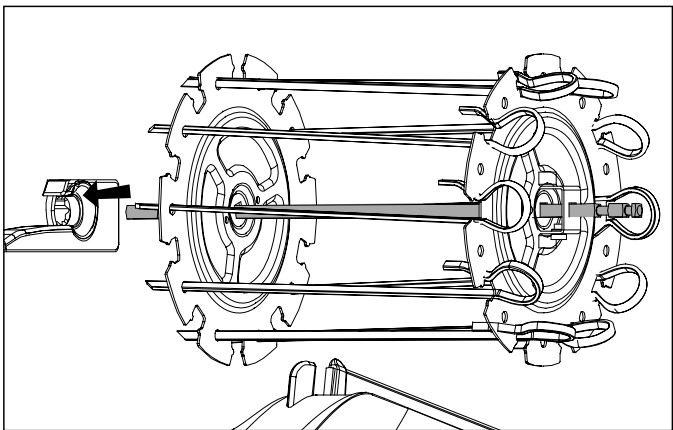

Fig. I - LEFT SIDE

Removing Skewer Rack or Rotating Basket from Appliance

1. Open appliance door to pause cooking cycle or turn appliance off by pressing the Power Button.
2. Insert Rotisserie Fetch Tool beneath the Rotisserie Shaft.
3. Using the Rotisserie Fetch Tool, lift the right side of the Shaft at a slight angle to clear the bracket. Then, shift to the right until the left side of the shaft slides out of the Rotisserie Shaft socket.
4. Carefully remove the rotisserie food from the appliance.
5. Place food on a plate, cutting board, or the Rotisserie Stand to remove food from the Shaft, Spit, or Basket.

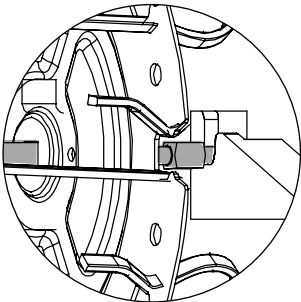
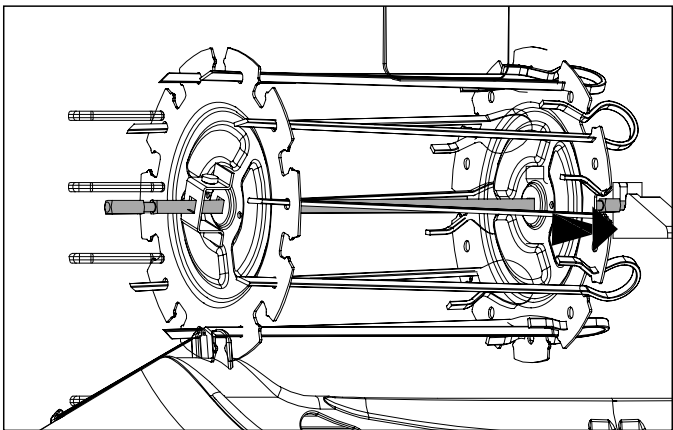

Fig. J - RIGHT SIDE

General Operating Instructions

Before Using The Appliance For The First Time

1.

Read all material, warning stickers and labels.

2.

Remove all packing materials, labels, and stickers.

3.

Wash all parts and accessories used in the cooking process with warm, soapy water.
NOTE: Only the accessories are dishwasher safe.
4.

Wipe the inside and outside of the cooking appliance with a clean, moist cloth.

NOTE: Never wash or submerge the cooking appliance in water.

NOTE: When using this appliance, never fill any cooking vessel with oil or liquid of any kind. This appliance cooks with hot air only.

Preparing For Use

1.

Place the appliance on a stable, level, horizontal, and heat-resistant surface.

2.

Before initial use, wipe the inside and outside of the appliance with a warm, moist cloth and mild detergent. Rinse with a warm, moist cloth. Hand wash all cooking accessories. Before cooking food, preheat the appliance for a few minutes to allow the appliance to burn off the manufacturer’s protective coating of oil. Wipe the appliance with warm, soapy water and a washcloth after the burn-in cycle.

3.

Select the cooking accessory for your recipe.



WARNING

- **NEVER** cover the air vents on the top and back of the cooking appliance or place anything on top of the appliance.
- **NEVER** fill any cooking vessel with oil or liquid of any kind. This appliance cooks with hot air only.
- **NEVER** use the appliance Door as a place to rest hot food or accessories. The hot food or accessory could damage the appliance Door or cause the appliance to tip. Personal injury could result.
- **ALWAYS** use oven mitts when removing hot accessories or food. Always place hot food or accessories on a heat-resistant surface.
NEVER place them directly on the countertop.

General Operating Instructions

Cooking With The Appliance

1.

Put your chosen cooking accessory into the appliance and shut the appliance door. Plug the power cord into a 120V dedicated outlet.

2.

Place the ingredients on your chosen accessory.

3.

When the chosen cooking accessory is in place, close the door and press the Power Button once (see #1 on page 8).

4.

Select a preset function (see #7-16 on page 8) or manually set the Temperature and then the Time (see #4-5 on page 8). Refer to the detailed Control Panel instructions on page 8.

5.

The appliance will automatically start the cooking cycle a few seconds after a preset function is selected or the Time and/or

Temperature are adjusted manually. Alternatively, you can press the Power Button to begin the cooking cycle immediately once the desired cooking time and temperature have been selected. Add 3 mins. to the cooking time when starting with a cold appliance.

NOTE: You may open the appliance door to view the food at any time during the cooking process to check the progress.

NOTE: Consult the charts in this manual or the recipe books to determine the correct settings for the specific item and weight being cooked.

Tips

- Foods that are smaller in size usually require a slightly shorter cooking time than larger ones.

• Flipping or turning foods halfway through the cooking process ensures that all the pieces are evenly fried.

• Misting a bit of vegetable oil on fresh potatoes is suggested for a crispier result. When adding a little oil, do so just before cooking.

• Snacks normally cooked in an oven can also be cooked in the appliance.

• Use premade dough to prepare filled snacks quickly and easily. Premade dough also requires a shorter cooking time than homemade dough.

• Place fragile or filled foods in a baking tin or oven dish in the appliance. A baking tin or oven dish is also suggested when baking a cake or quiche.

• You can use the appliance to reheat foods. Simply set the temperature and time to however warm you want your food.

General Cooking Guidelines

NOTE: Keep in mind that these settings are guidelines. Since ingredients differ in origin, size, shape, and brand, we cannot guarantee the best settings for your ingredients.

Food item	Size	Temperature	Cook Time	Preheat	Shake or Flip	Spray with Oil
FROZEN FOOD						
French fries		400° F (204° C)	18 min		✓	
Sweet potato fries		400° F (204° C)	22 min		✓	
Chicken nuggets		400° F (204° C)	14 min		✓	
CHICKEN						
Breaded cutlets	6 oz	400° F (204° C)	10 min	✓	✓	✓
Wings		400° F (204° C)	25 min	✓	✓	
Chicken breast	6 oz	400° F (204° C)	8 min	✓		
BEEF						
Burgers	6 oz	400° F (204° C)	10 min	✓	✓	
Hot dogs	8 pc	375° F (191° C)	5 min	✓	✓	
NY strip steaks	8 oz	400° F (204° C)	12 min	✓	✓	
Meatballs, 1 inch	1.5 lb	375° F (191° C)	10 min	✓	✓	
PORK						
Pork chops		400° F (204° C)	12 min	✓	✓	
Sausages		350° F (177° C)	15 min	✓	✓	
FISH						
Salmon filets	6 oz	390° F (199° C)	12 min	✓		
Shrimp (16–20 size)	12 oz	390° F (199° C)	10 min	✓	✓	
VEGETABLES						
Asparagus	1 lb	380° F (193° C)	8 min		✓	✓
Broccoli	8 oz	380° F (193° C)	8 min		✓	✓
Corn on the cob	2 pc	380° F (193° C)	8 min		✓	✓
PREPARED FOOD						
Hard boiled eggs, shell on		250° F (121° C)	18 min			
Cake		320° F (160° C)	20 min			
Grilled cheese sandwich	1 pc	375° F (191° C)	6 min	✓	✓	

General Cooking Guidelines

Settings

The table on page 18 will help you select the correct temperature and time for best results. As you become more familiar with the appliance cooking process, you may adjust these settings to suit your own personal tastes.

NOTE: Keep in mind that these settings are guides. Since ingredients differ in origin, size, shape, and brand, we cannot guarantee the exact settings for your ingredients.

Tip

For food you want to flip, set the Timer to half the time needed for the recipe and the Timer bell will alert you when it's time to flip your food. When you hear the timer bell, the preset preparation time has elapsed. Flip your food and reset the appliance to the remaining time and temperature needed to finish cooking the food.

Cleaning & Storage

Cleaning

Remove the power cord from the wall socket and be certain the appliance is thoroughly cooled before cleaning.

Clean the appliance after each use. The cooking accessories are made of durable stainless steel and are dishwasher safe. Never use abrasive cleaning materials or utensils on these surfaces. Parts with caked-on food should be soaked in warm, soapy water for easy removal.

1.

Wipe the outside of the appliance with a warm, moist cloth and mild detergent.
2.

To clean the appliance door, remove it by lifting it to a 45° angle while gently pulling upward. Clean both sides with warm, soapy water on a damp cloth. Do not soak or submerge the door in water or wash in the dishwasher.
3.

Clean the inside of the appliance with hot water, a mild detergent, and a nonabrasive sponge.
4.

If necessary, remove unwanted food residue from the upper screen with a soft cleaning brush.

Storage

1.

Once the fan has stopped running, unplug the appliance and let it cool thoroughly.
2.

Make sure all components are clean and dry.
3.

Place the appliance in the clean, dry place.

Troubleshooting

Problem	Possible Cause	Solution
The appliance does not work	The appliance is not plugged in.	Plug power cord into wall socket.
	The appliance has not been turned on by setting the preparation time and temperature.	Set the temperature and time.
	The appliance is plugged into an outlet that is shared with other devices.	Plug the appliance into a dedicated power outlet.
Food not cooked	The appliance is overloaded.	Use smaller batches for more even cooking.
	The temperature is set too low.	Raise temperature and continue cooking.
Food is not fried evenly	Some foods need to be turned during the cooking process.	Check halfway through process and turn food if needed.
	Foods of different sizes are being cooked together.	Cook similar-sized foods together.
	If using multiple racks, trays need to be rotated.	Rotate trays from top to bottom and vice versa.
White smoke coming from appliance	Oil is being used.	Wipe down to remove excess oil.
	Accessories have excess grease residue from previous cooking.	Clean the components and appliance interior after each use.
French fries are not fried evenly	Wrong type of potato being used..	Use fresh, firm potatoes.
	Potatoes not blanched properly during preparation.	Use cut sticks and pat dry to remove excess starch.
	Too many fries are being cooked at once.	Cook less than 2 ½ cups of fries at a time.
Fries are not crispy	Raw fries have too much water.	Dry potato sticks properly before misting oil. Cut sticks smaller. Add a bit more oil.
Door came off	Door came off the hinge and was not replaced properly.	With the door slightly open (1 in./2.5 cm) from the closed position, align the hinge so the joints fall into the slots and close the door.

Error Codes

Display Shown	Possible Cause	Solution
E1	Broken circuit of the thermal sensor	Call Customer Service
E2	Short circuit of the thermal sensor	Call Customer Service

Frequently Asked Questions

1. Can I prepare foods other than fried dishes with my appliance?

You can prepare a variety of dishes, including steaks, chops, burgers, and baked goods. See the appliance Recipe Guide.

2. Is the appliance good for making or reheating soups and sauces?

Never cook or reheat liquids in the appliance.

4. What do I do if the appliance shuts down while cooking?

As a safety feature, the appliance has an Auto Shut-Off device that prevents damage from overheating. Unplug and allow the appliance to cool down. Plug back in and restart with the Power Button.

5. Does the appliance need time to heat up?

Preheating is needed when you are cooking from a cold start, add 3 mins. to the cook time to compensate.

6. Is it possible to shut off the appliance at any time?

Press the Power Button once.

7. Can I check the food during the cooking process?

You can check on the progress of the cooking cycle at any time. If you open the door, the cooking time and temperature should resume from where they left off when you close the door.

8. Is the appliance dishwasher safe?

Only the accessories are dishwasher safe. The appliance itself containing the heating coil and electronics should never be submerged in liquid of any kind or cleaned with anything more than a hot, moist cloth or nonabrasive sponge with a small amount of mild detergent.

9. What happens if the appliance still does not work after I have tried all the troubleshooting suggestions?

Never attempt a home repair. Contact the retailer and follow the procedures set forth by the guarantee. Failure to do so could render your guarantee null and void.

10. Can the door come off?

Yes. Removing the door will allow you to clean the appliance and windows more easily. Open the door slightly (about 1 in./2.5 cm from the closed position), and gently lift up on the door hinge. The joints will slide out. To reattach the door, position the door to be slightly open as before. Then, align the hinge so that the joins fall into the slots. Close the door. Do not clean the door in the dishwasher.

PowerXL
products that excel

VORTEX AIR FRYER PRO

90-Day Money-Back Guarantee

The **PowerXL Vortex Air Fryer Pro** is covered by a 90-day money-back guarantee. If you are not 100% satisfied with your product, return the product and request a replacement product or refund. Proof of purchase is required. Refunds will include the purchase price, less processing and handling. Follow the instructions in the Return Policy below to request a replacement or refund.

Replacement Guarantee Policy

Our products, when purchased from an authorized retailer, include a 1-year replacement guarantee if your product or component part does not perform as expected, the guarantee extends only to the original purchaser and is not transferable. If you experience an issue with one of our products within 1 year of purchase, return the product or the component part for replacement with a functionally equivalent new product or part. The original proof of purchase is required, and you are responsible to pay to return the appliance to us. In the event a replacement appliance is issued, the guarantee coverage ends six (6) months following the receipt date of the replacement appliance or the remainder of the existing guarantee, whichever is later. Tristar reserves the right to replace the appliance with one of equal or greater value.

Return Policy

If, for any reason, you would like to replace or return the product under the money-back guarantee, your order number can be used as the return merchandise authorization number (RMA). If the product was purchased in a retail store, return the product to the store or use "RETAIL" as the RMA. Return your product to the address provided below for a replacement, which will incur no additional processing and handling fees, or for the refund of your purchase price, less processing and handling. You are responsible for the cost of returning the product. You can locate your order number at www.customerstatus.com. You can call customer service at 973-287-5129 or email info@tvcustomerinfo.com for any additional questions. Pack the product carefully and include in the package a note with (1) your name, (2) mailing address, (3) phone number, (4) email address, (5) reason for return, and (6) proof of purchase or order number, and (7) specify on the note whether you are requesting a refund or replacement. Write the RMA on the outside of the package.

Send the product to the following return address:

PowerXL Vortex Air Fryer Pro
Tristar Products
500 Returns Road
Wallingford, CT 06495

If the replacement or refund request has not been acknowledged after two weeks, please contact Customer Service at 973-287-5129.

Refund

Refunds requested within the money-back guarantee timeframe will be issued to the payment method used at purchase if the item was purchased directly from Tristar. If the item was purchased from an authorized retailer, proof of purchase is required, and a check will be issued for the item and sales tax amount. Processing and handling fees are non-refundable.

PowerXLTM *products that excel*

VORTEX AIR FRYER PRO

We are very proud of the design and quality
of our **PowerXL Vortex Air Fryer ProTM**.

This product has been manufactured to the highest standards.
Should you have any questions, our friendly customer service staff
is here to help you.

For parts, recipes, accessories, and everything
PowerXL, go to tristarcares.com or scan this QR code
with your smartphone or tablet:



To contact us, email us at
customerservice@tristarproductsinc.com
or call us at **973-287-5129**.



Distributed by:
Tristar Products, Inc.
Fairfield, NJ 07004
© 2021 Tristar Products, Inc.
Made in China
PXL-VAF_PRO_10QT_IB_TP_ENG_V4_211207

