

**PYROGRAPHY STATION
TEMPERATURE-ADJUSTABLE**

OPERATION INSTRUCTION

English

Temperature range	250°C~600°C / 482°F~1112°F
Main unit dimensions	L115*W70*H84mm ±5mm
Operating ambient temperature	0°C~40°C / 32°F~104°F

Thank you for purchasing this product. Please read the manual carefully before operating and keep this manual for future reference.
Statement: The company reserves the right to improve & upgrade products, product specifications and design are subject to change without notice.

Made in China

● This product should not be thrown in the garbage. In accordance with the European directive 2012/19/EU, electronic equipment at the end of their life must be collected & returned to an authorized recycling facility. ● Este producto no debe desecharse en la basura. De acuerdo a la directiva europea 2012/19/EU, los equipos electrónicos al final de su vida se deberán recoger y trasladar a una planta de reciclaje autorizada. ● Dieses Produkt sollte nicht mit dem Hausmüll entsorgt werden. In Übereinstimmung mit der europäischen Richtlinie 2012/19/EU müssen elektronische Geräte am Ende ihrer Lebensdauer eingesammelt und einem autorisierten Recyclingbetrieb zugeführt werden.

**PYROGRAPHY STATION
TEMPERATURE-ADJUSTABLE**

OPERATION INSTRUCTION

English

Temperature range	250°C~600°C / 482°F~1112°F
Main unit dimensions	L115*W70*H84mm ±5mm
Operating ambient temperature	0°C~40°C / 32°F~104°F

Thank you for purchasing this product. Please read the manual carefully before operating and keep this manual for future reference.
Statement: The company reserves the right to improve & upgrade products, product specifications and design are subject to change without notice.

Made in China

● This product should not be thrown in the garbage. In accordance with the European directive 2012/19/EU, electronic equipment at the end of their life must be collected & returned to an authorized recycling facility. ● Este producto no debe desecharse en la basura. De acuerdo a la directiva europea 2012/19/EU, los equipos electrónicos al final de su vida se deberán recoger y trasladar a una planta de reciclaje autorizada. ● Dieses Produkt sollte nicht mit dem Hausmüll entsorgt werden. In Übereinstimmung mit der europäischen Richtlinie 2012/19/EU müssen elektronische Geräte am Ende ihrer Lebensdauer eingesammelt und einem autorisierten Recyclingbetrieb zugeführt werden.

I. APPLICATIONS

This station is suitable for pyrography works on wood, gourds, leather, wheat stalks, tree barks, bamboos, furniture, and more.

II. PART LIST

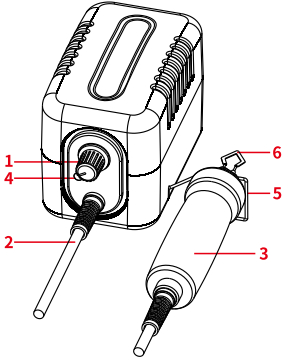

1. Dial (Temperature Adjustment)
2. Cord (Pyrography Pen)
3. Pyrography Pen
4. Operating Indicator Light
5. Stand (Pyrography Pen)
6. Pyrography Wire Nib

III. OPERATION

- 1. Tip Installation**
Align the two pins with the corresponding holes on the pyrography pen. Insert and press the pyrography nib into the pyrography pen.

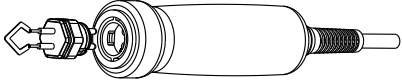

- 2. Tip Removal**
Clamp the pyrography tip and pull it out.



I. APPLICATIONS

This station is suitable for pyrography works on wood, gourds, leather, wheat stalks, tree barks, bamboos, furniture, and more.

II. PART LIST

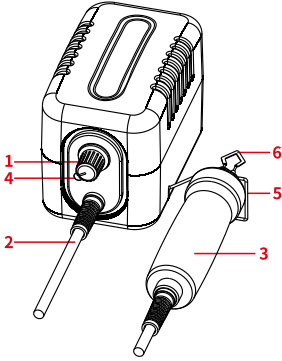

1. Dial (Temperature Adjustment)
2. Cord (Pyrography Pen)
3. Pyrography Pen
4. Operating Indicator Light
5. Stand (Pyrography Pen)
6. Pyrography Wire Nib

III. OPERATION

- 1. Tip Installation**
Align the two pins with the corresponding holes on the pyrography pen. Insert and press the pyrography nib into the pyrography pen.

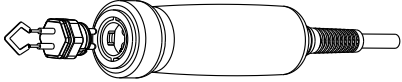

- 2. Tip Removal**
Clamp the pyrography tip and pull it out.



CAUTION: The replacement of the tip MUST be carried out when the tip is cooled. Ensure the tip is pushed to the bottom of its slot when installing.

- Based on your preference, install the pen stand on either the left or on the right side of the main unit. Then, place the pyrography pen in the stand.

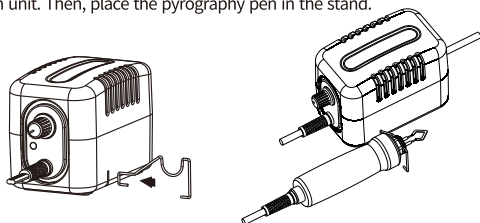

- Turn ON the power switch, and the pyrography nib will begin heating, and the operating indicator light will turn ON. Set the desired temperature and begin your work once the temperature reaches the set temperature.
- Once done using, place the pen back to the pen stand, then turn OFF the power switch. If the station is not in use for an extended period, disconnect the power plug.

Note: rotate the pyrography pen handle while picking up the pyrography pen; make sure the pyrography pen handle is appropriately placed onto the U-shaped pyrography pen stand when placing the pyrography pen.

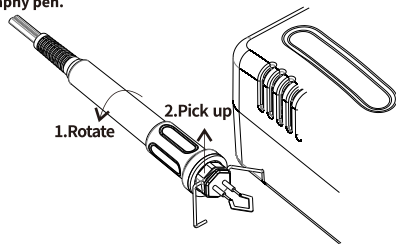

IV. THE USE OF PYROGRAPHY WIRE NIBS

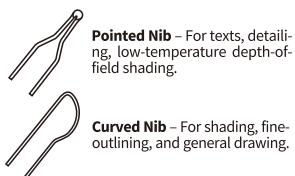

Pointed Nib – For texts, detailing, low-temperature depth-of-field shading.

Curved Nib – For shading, fine-outlining, and general drawing.



Skewed Spear Nib – For feathers, fine-lines, shading, low-temperature depth-of-field shading.

Diamond Flat Shader – For shading, outlining and cutting & carving.

CAUTION: The replacement of the tip MUST be carried out when the tip is cooled. Ensure the tip is pushed to the bottom of its slot when installing.

- Based on your preference, install the pen stand on either the left or on the right side of the main unit. Then, place the pyrography pen in the stand.

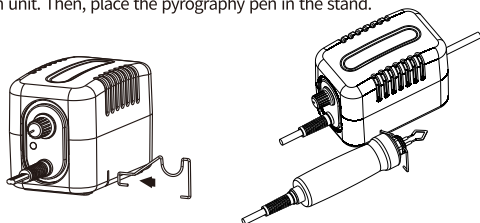

- Turn ON the power switch, and the pyrography nib will begin heating, and the operating indicator light will turn ON. Set the desired temperature and begin your work once the temperature reaches the set temperature.
- Once done using, place the pen back to the pen stand, then turn OFF the power switch. If the station is not in use for an extended period, disconnect the power plug.

Note: rotate the pyrography pen handle while picking up the pyrography pen; make sure the pyrography pen handle is appropriately placed onto the U-shaped pyrography pen stand when placing the pyrography pen.

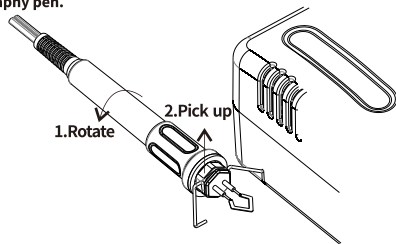

IV. THE USE OF PYROGRAPHY WIRE NIBS

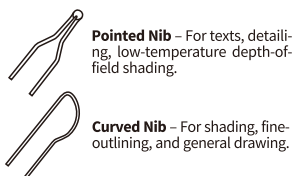

Pointed Nib – For texts, detailing, low-temperature depth-of-field shading.

Curved Nib – For shading, fine-outlining, and general drawing.



Skewed Spear Nib – For feathers, fine-lines, shading, low-temperature depth-of-field shading.

Diamond Flat Shader – For shading, outlining and cutting & carving.



Diamond Point Nib – For detailing and outlining.

Long Round Point Wire Nib – For outlining, feathering, and shading.

Long Sharp Flat Nib – For outlining, burning fine hair, and fine shading.

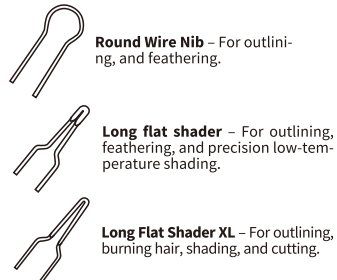

Round Wire Nib – For outlining, and feathering.

Long flat shader – For outlining, feathering, and precision low-temperature shading.

Long Flat Shader XL – For outlining, burning hair, shading, and cutting.

Note: pyrography wire nibs are optional accessories, and they are not included with this product. You can purchase compatible wire nibs in your nearest YIHUA OFFICIAL STORE available.

V. MAINTENANCE AND PRECAUTIONS

After use, clean the residue and oxide off the pyrography pen tip when the tip is cooled. Keep the pyrography pen clean.



Diamond Point Nib – For detailing and outlining.

Long Round Point Wire Nib – For outlining, feathering, and shading.

Long Sharp Flat Nib – For outlining, burning fine hair, and fine shading.

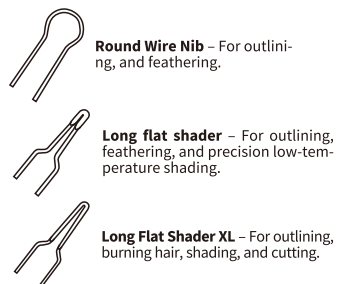

Round Wire Nib – For outlining, and feathering.

Long flat shader – For outlining, feathering, and precision low-temperature shading.

Long Flat Shader XL – For outlining, burning hair, shading, and cutting.

Note: pyrography wire nibs are optional accessories, and they are not included with this product. You can purchase compatible wire nibs in your nearest YIHUA OFFICIAL STORE available.

V. MAINTENANCE AND PRECAUTIONS

After use, clean the residue and oxide off the pyrography pen tip when the tip is cooled. Keep the pyrography pen clean.