



Please feel free to contact us anytime you need.
We are always here for you.

E-Mail: support@umlohome.com



Installation and Usage
[bit.ly/UMLo-V111-y2b](https://umlohome.com)



General Tips, FAQ, etc.
<https://umlohome.com>

Made In China



USER MANUAL

Cordless Stick Vacuum Cleaner

MODEL: V111

V110 / V112 / V115 / V116 / V117

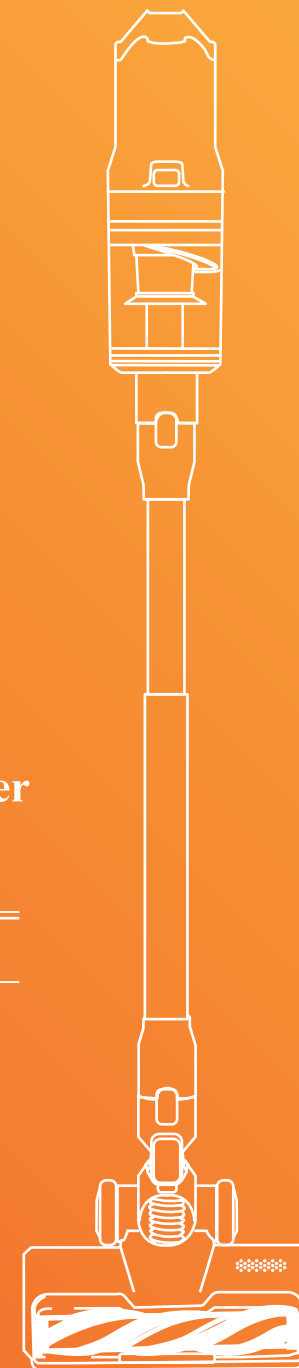

CONTENTS

Important Safety Instructions & Warnings	EN - 01
Product Schematic	EN - 04
Package Checklist	EN - 05
Assembly & Combinations	EN - 07
Ready to Use	EN - 08
How to Empty the Dust Cup	EN - 08
Charging	EN - 09
Storage	EN - 09
Daily Maintenance	EN - 10
Appendix	EN - 13
• Technical Parameters	
• Troubleshooting	
Warranty	EN - 15

Important Safety Instructions & Warnings

BEFORE USING THIS MACHINE READ ALL INSTRUCTIONS AND CAUTIONARY MARKINGS IN THIS MANUAL AND ON THE MACHINE

When using an electrical appliance, basic precautions should always be followed, including the following:



Do not use near open flames



Do not store near heat sources



Do not pick up water or liquids



Do not pick up burning objects



Do not put hands near the brush bar when the machine is in use



Do not place on or near the cooker

- **Do not** use to pick up water or any other liquid, as this may cause electric shock.
- **Do not** use to pick up sharp objects such as glass or screws, etc.
- **Do not** use the appliance to pick up flammable liquid, matches, cigarette ends, hot ashes or any hot, burning or smoking objects.
- **Do not** use if any of its openings are blocked.
- **Do not** store the appliance in direct sunlight or in high humidity conditions.
- **Do not** use this appliance outdoors.
- **Do not** use any damaged accessories or adaptors.
- **Do not** use any parts/accessories or adaptors other than those supplied with this appliance, as this may cause damage.
- **Do not** use the appliance for anything other than its intended use.
- **Do not** use the appliance if it has been dropped or if there are visible signs of damage.
- **Do not** use the adaptor to recharge non-rechargeable batteries.
- **Do not** remove from the adaptor from the mains power supply by pulling the cord; switch off and remove the plug by hand.
- **Do not** expose the appliance to rain.
- **Do not** operate the appliance with wet hands.
- **Do not** immerse the appliance in water or any other liquid.
- Only use with provided power adapter.
- Use of an extension power cord is not allowed.
- Always ensure that the appliance has cooled fully after use before performing any cleaning or user maintenance.
- Switch off the appliance and disconnect it from the mains power supply before changing or fitting accessories.
- Take care when equipping accessories with rotating parts as this could cause entrapment.
- This appliance is intended for domestic use only. It should not be used for commercial purposes.

- Keep the appliance away from other heat emitting appliances.
- Keep the appliance away from heat or sharp edges that could cause damage.
- Keep away from children aged below 8.
- Improper repairs may put the user in danger.
- If any part is damaged due to human error, only a qualified electrician can repair it. Please note the appliance is not under warranty in this case.
- This appliance is not a toy.
- Children should be supervised to ensure that they do not play with the appliance.
- Children whose aged from 8 years and above, people who with reduced physical, sensory or mental capabilities or lack of experience and knowledge can use this appliance, only if they have been given supervision or instruction concerning to use the appliance in a safe way and understand the hazards involved.
- Check the voltage indicated on the rating plate and confirm you connect the appliance to the power supply with correct voltage.

Battery Safety

- If the battery pack becomes exhausted, it should be removed from the product to avoid leakage.
- In the event of the battery pack leaking, do not allow any liquid to come into contact with the skin or eyes.
- If contact has been made, wash the affected area with copious amounts of water and seek medical advice.
- Keep the battery pack out of the reach of children.
- Secondary battery packs need to be charged before use. After extended periods of storage, it may be necessary to charge and discharge the batteries several times to obtain maximum performance.
- Do not leave battery packs on charge for prolonged periods of time.
- Do not use any charger other than that specifically provided for use with the product.
- The supply terminals are not to be short-circuited.
- Do not store above 60°C. Avoid storing in direct sunlight.
- Do not use any battery packs that are not designed for use with the product.
- Do not dispose of the battery pack in a fire.
- Do not crush, puncture, dismantle or otherwise damage the battery pack.
- Do not dismantle, open or shred battery packs.
- Do not expose the battery pack to heat or fire as it may explode.
- Do not subject the battery pack to mechanical shock.
- Do not dispose of the exhausted battery pack in household waste.
- To dispose of the exhausted battery pack, take it to a local recycling station.
- Contact the local government offices for further details.
- This appliance is fitted with a 18.5V 4000mAh Li-ion rechargeable battery.

WARNING

Read all safety warnings and instructions. Failure to follow the warnings and instructions may result in electric shock, fire and/or serious injury.

1. Prevent unintentional starting ensure the switch is in the off-position before connecting pack, picking up, or carrying the appliance.
Carrying the appliance with your finger on the switch or energizing appliance that have the switch on invites accidents.
2. Disconnect the battery pack from the appliance before making any adjustments changing accessories or storing appliance.
Such preventive safety measures reduce the risk of starting the appliance accidentally.
3. Recharge only with the charger specified by the manufacturer. A charger that is suitable for one type of battery pack may create a risk of fire when used with another battery pack.
4. Use appliances only with specifically designated battery packs.
Use of any other battery packs may create a risk of injury and fire.
5. When battery pack is not in use, keep it away from other metal objects, like paper clips, coins, keys, nails, screws or other small metal objects, that can make a connection from one terminal to another.
Shorting the battery terminals together may cause burns or a fire.
6. Under abusive conditions, liquid maybe ejected from the battery; avoid contact.
If contact accidentally occurs, flush with water.
If liquid contacts eyes, additionally seek medical help.
Liquid ejected from the battery may cause irritation or burns.
7. Do not use a battery pack or appliance that is damaged or modified.
Damaged or modified batteries may exhibit unpredictable behavior resulting in fire, explosion or risk of injury.
8. Do not expose a battery pack or appliance to fire or excessive temperature.
Exposure to fire or temperature above 130°C may cause explosion.
The temperature of 130°C can be replaced by the temperature of 265 °F.
9. Follow all charging instructions and do not charge the battery pack or appliance outside of the temperature range specified in the instructions.
Charging improperly or at temperatures outside of the specified range may damage the battery and increase the risk of fire.
10. Have servicing performed by a qualified repair person using only identical replacement parts.
This will ensure that the safety of the product is maintained.
11. Do not modify or attempt to repair the appliance or the battery pack (as applicable) except as indicated in the instructions for use and care.

Product Schematic

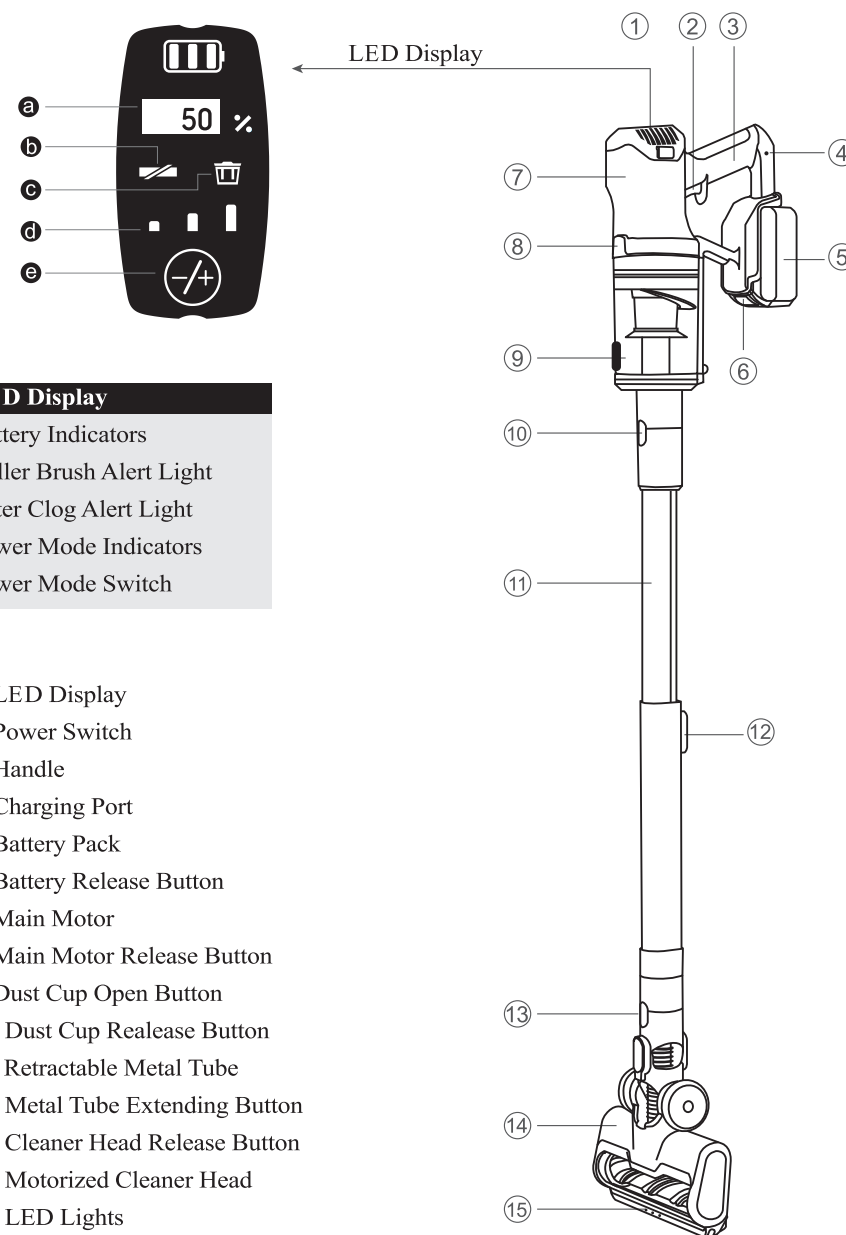

LED Display

- a Battery Indicators
- b Roller Brush Alert Light
- c Filter Clog Alert Light
- d Power Mode Indicators
- e Power Mode Switch

1. LED Display
2. Power Switch
3. Handle
4. Charging Port
5. Battery Pack
6. Battery Release Button
7. Main Motor
8. Main Motor Release Button
9. Dust Cup Open Button
10. Dust Cup Release Button
11. Retractable Metal Tube
12. Metal Tube Extending Button
13. Cleaner Head Release Button
14. Motorized Cleaner Head
15. LED Lights

Package Checklist

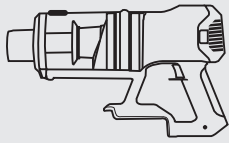

Main Motor (with dust cup) x1

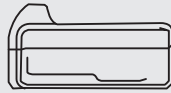

Battery Pack x1



Power Adapter x1

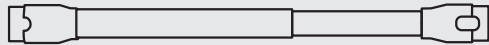

Retractable Metal Tube x1

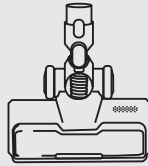

Motorized Cleaner Head x1

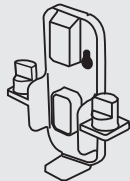

Wall-mount Bracket x1



Stiff Roller Brush x1

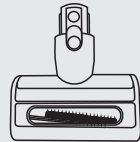

Mini Motorized Cleaner Head x1

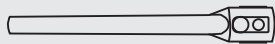

Long Crevice x1

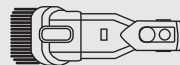

2-in-1 Brush x1



2-in-1 Cleaning Gadget x1



User Manual x1

**USER
GUIDE**

User Guide x1

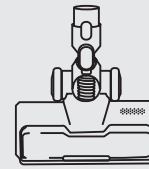

Motorized Cleaner Head:

Can be connected to the metal tube for daily cleaning on the floor or carpet, or to the main motor for cleaning the trunk.



Stiff Roller Brush:

Can be installed into the cleaner head; ideal for both hard floors or carpets.

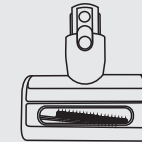

Mini Motorized Cleaner Head:

Perfect for picking up hair or dust mite from fabric surface like sofa, mattresses, bed and pillows, etc.



Long Crevice:

For corners and other hard-to-reach places; Can be connected to the metal tube to clean spider web on the ceilings.

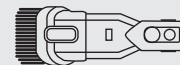

2-in-1 Brush:

Can be switched into a brush or a wide crevice; Suitable for fabric surface and corners.



2-in-1 Cleaning Gadget:

The blade end can be used to cut off hair wrapping around roller brush, while the other brush end be used to clean dirt inside dustbin, strainer or cleaner head.

Assembly & Combinations

To assemble the powerful cordless stick vacuum cleaner, please follow the instructions as shown.

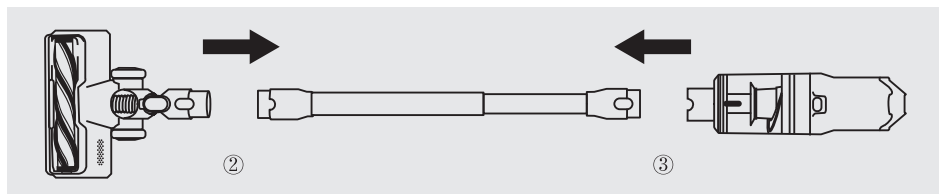
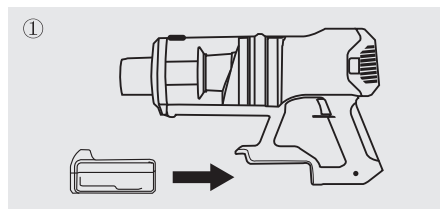

- ✓ Ensure a tight connection of the whole machine by a clear sound of click in each step.
- ✓ If you want to disassemble the vacuum, just press the release button on each part.

If you want to connect it with other attachments and work in different situations, please follow the **COMBINATION** instructions below.

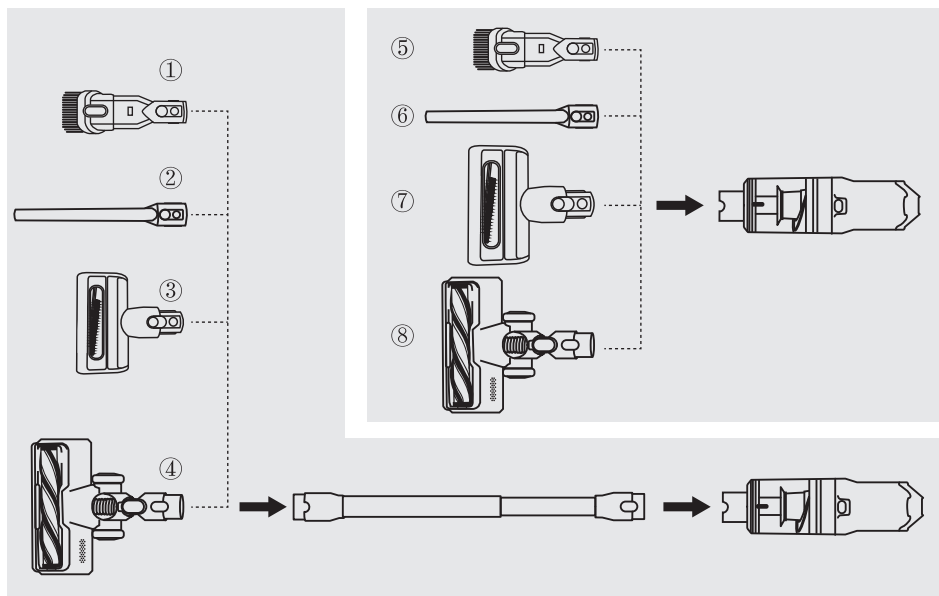

Ready to Use

After assembly, the cordless vacuum is ready to work.

1. Press the power switch to turn on the vacuum.
2. Press the +/- button to switch among the three power modes.

	High	Medium	Low
Suction	Up to 25Kpa	Up to 15Kpa	Up to 8Kpa
Runtime	Up to 15 minutes	Up to 35 minutes	Up to 60 minutes

Runtime may vary in different situations. When vacuuming debris or particles in large size, it might decrease the runtime due to the heavy cleaning tasks.

Notes:

HOUSEHOLD USE ONLY.

DO NOT use outdoors or on wet surfaces.

DO NOT immerse in water.

How to Empty the Dust Cup?

When dust reaches MAX labeled on the dust cup, please empty the dust cup before going on.

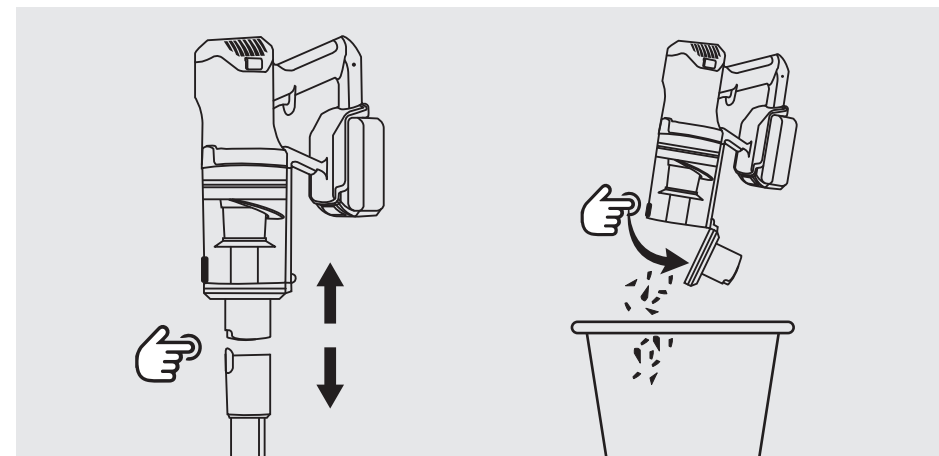

Charging

The battery could be charged only when connected to the main motor. And it is suggested not to disassemble the battery from the main motor regularly.

* It will take about 5 hours to fully charge the battery.

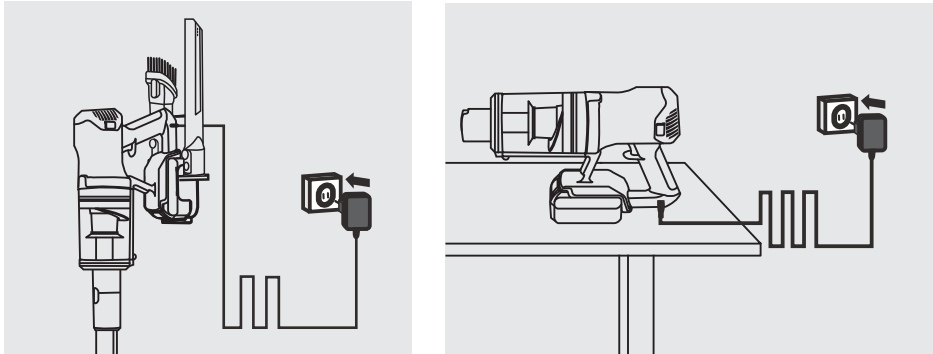

* The machine cannot be turned on during charging.

* Charge the machine only with the adapter provided by UMLo.

Storage

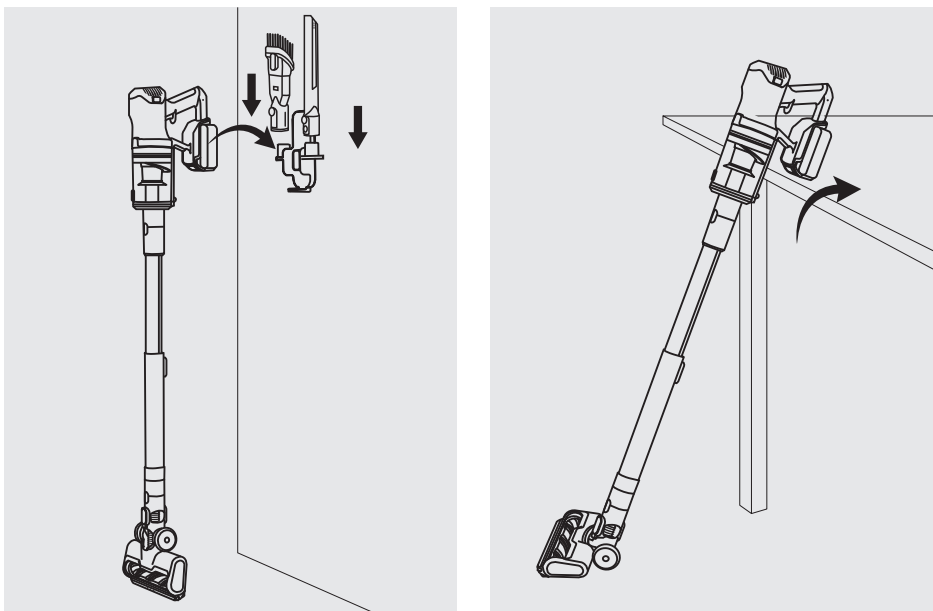

Daily Maintenance

In order to ensure a maximum performance of the vacuum, it is strongly recommended to maintain its components regularly.

Clean Non-electricity Part of the Main Motor:

1. Turn off the vacuum before cleaning.
2. Wipe the surface with a clean cloth.
3. Be cautious not to get water into the inner part of the main motor.

* **Do not place the vacuum cleaner under direct sunlight or in wet place after cleaning.**

Clean Detachable Roller Brush:

There will be alert on LED Display if the roller brush gets tangled or stuck. Please clean it in time.

1. Unlock the side lock on the bottom side of the cleaner head.
2. Remove the side cover and take out the roller brush.
3. Use the 2-in-1 cleaning gadget to clean it.

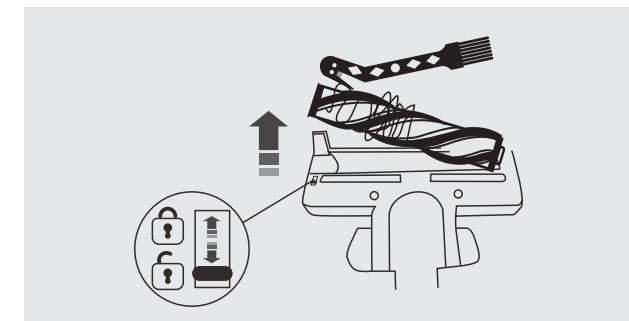

Clean Stainless Steel Strainer & Filter



IMPORTANT

1. Please check and clean the Stainless Steel Strainer/HEPA regularly.
2. Please clean the filter in time if the suction performance decline.
3. Please replace the filter/HEPA if it is broken or it cannot maintain the suction performance of the vacuum cleaner.
4. Please do not bend or squeeze the HEPA.

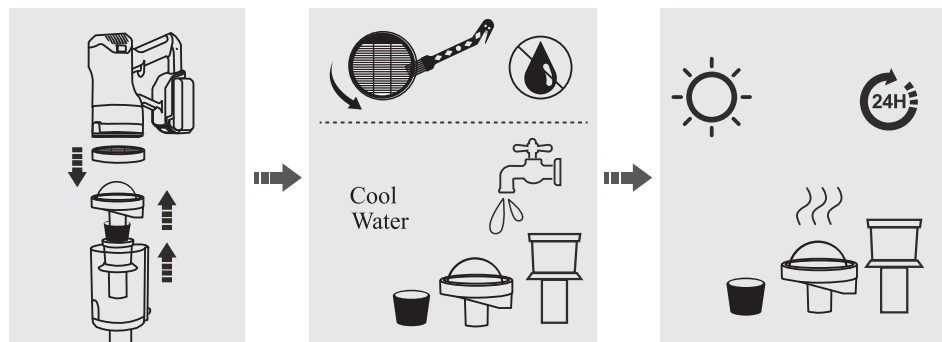

1. Detach the main motor and dust cup, take out the HEPA in the main motor and the filter component in the dust cup. Hold the strainer, rotate the filter holder, then take out the sponge filter.
2. If they are too dirty, you could wash the strainer and the sponge with cool water, and clean the HEPA with the cleaning brush.
3. Ensure the strainer and sponge are completely dry before refitting.

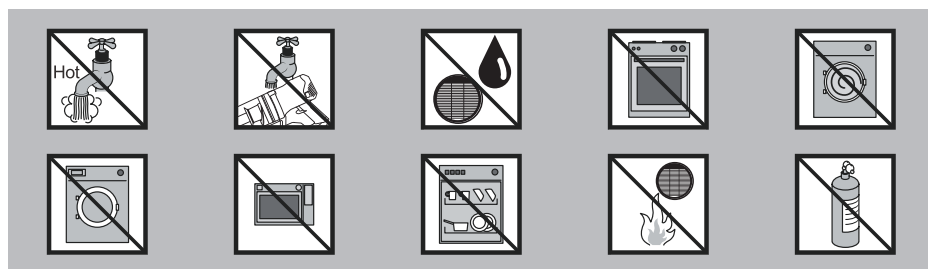

Filter Installation

01. Put the sponge into the strainer.

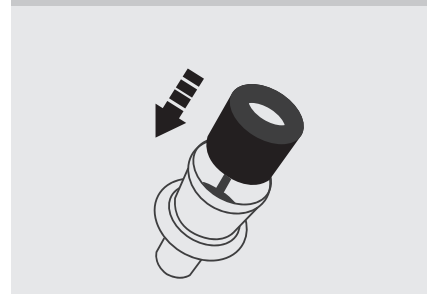

02. Lock the strainer to the filter holder.

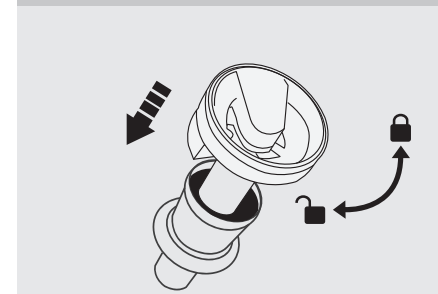

03. Make sure the NOTCH on the filter holder fits into the slot perfectly.

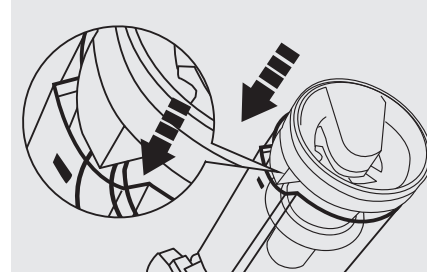

04. Make sure the strainer keep vertical to the dust cup cover.

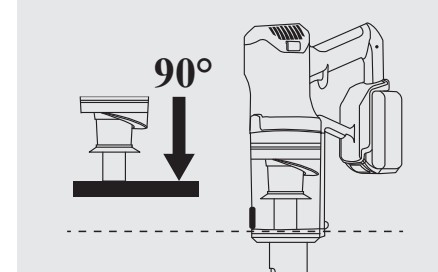

05. Put the HEPA filter into the main motor.

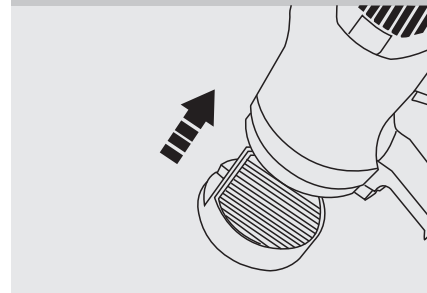

06. Connect the dust cup to the main motor.

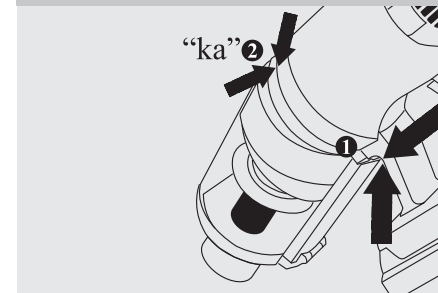

Appendix

Technical Parameters

Brand	UMLo	Model No.	V111
Package Weight (including all attachments)	4.1 KG	Product Net Weight (including main motor, battery pack, motorized cleaner head, roller brush, and metal tube)	2.99 KG
Motor Type	Brushless Motor	Motor Power	265W
Battery Cells	5*2 Cells	Rated Voltage	18.5V
Charging Time	5 Hours	Battery Capacity	4000 mAh
Power Adapter Output	22.5V 800mA	Power Adapter Input	100-240V~ 50-60HZ

Troubleshooting

Q1. Machine stops working or doesn't work	
A1. Low battery or no battery power. A2. There is blockage. A3. Roller brush is tangled by hair.	1. Charge the battery. 2. Remove the blockage in the filter or the retractable metal tube. 3. Clean the roller and also remove the side covers of the roller to remove the tangled hair.

Q2. Roller brush stops spinning	
A1. Roller brush is tangled by hair. A2. Something wrong with the metal tube.	1. Clean the roller brush and remove the hair. 2. Please contact us for after-sale service.

Q3. Weak suction power	
A1. Dustbin, strainer or filter is full of dust. A2. The strainer or filter is not installed. A3. There is blockage. A4. Roller brush is tangled by hair.	1. Clean the dustbin, strainer or filter, replace the filter if necessary. 2. Install the strainer and filter. 3&4. Clean the roller and also remove the side covers of the roller to remove the tangled hair.

Q4. Abnormal motor sound	
A1. There is blockage. A2. Something wrong with the main motor or the mini motorized cleaner head.	1. Remove the blockage. 2. Please contact us for after-sale service.

Q5. Battery cannot be charged	
A1. Wrong adaptor is used. A2. Connection between power cord and battery is loose.	1. Use the correct adaptor offered by UMLO. 2. Make sure the power cord is plugged tightly.

If you have any more questions or problems, please feel free to contact us via

E-mail: support@umlohome.com

WARRANTY

NOTE: THIS WARRANTY TERM GIVES YOU SPECIFIC LEGAL RIGHTS, AND YOU MAY ALSO HAVE OTHER RIGHTS WHICH VARY FROM STATE TO STATE.

12-month Warranty & Lifetime Customer Support

Only apply to eligible purchases made directly from the UMLo authorized distributors.
Warranty coverage applies to the original owner and to the original product only and is not transferable.

How to initiate a warranty claim

If your appliance operates improperly while in use under normal household conditions within the warranty period, please contact our customer support [support@umlohome.com] to fill out the warranty form to initiate a warranty claim.

All rights are reserved by UMLo.