



CTS1-76/CTS1-E-1A

# CT-S1-76/CT-S1 Casiotone

CASIO®

## Quick Start Guide

After reading this document, keep it in a safe place along with the warranty certificate. Be sure to read the “Safety Precautions” in the separate “READ THIS!” sheet, and use the product correctly.

### Included Accessories

- AC adaptor
    - AD-A12150LW (CT-S1-76)
    - AD-E95100L (CT-S1)
  - Power cord (CT-S1-76 only)
  - Music Stand
  - Strap Lock (CT-S1 only)
  - Leaflets
    - READ THIS! Sheet
    - Other (Warranty, etc.)
- Items included as accessories are subject to change without notice.

### Separately Available Accessories

You can get information about accessories that are separately available for this product from your retailer or from the CASIO website.

Please refer to the website below for more detailed operating instructions and product information, including the USER’S GUIDE, Dedicated App (CASIO MUSIC SPACE) download, Operating Precautions, etc.

CT-S1-76



<https://support.casio.com/global/en/emi/manual/CT-S1-76/>

CT-S1



<https://support.casio.com/global/en/emi/manual/CT-S1/>

## Preparation

### Preparing a Power Supply

#### ■ Using the AC Adaptor

- 1 Connect the AC adaptor as shown in the right illustration.
  - Make sure that you use only the AC adaptor specified for this Digital Keyboard.

#### ■ Using Batteries

- 1 Bottom of console  
Open
- 2 Insert AA-size batteries into the battery case (CT-S1-76: 8 batteries/CT-S1: 6 batteries).
- 3 Tabs  
Close
- 4 Specify the battery type.  
See “Specifying the Battery Type” on the reverse side of this sheet.

Computer, smartphone, etc. (commercially available)  
• Connect using a USB cable that is no more than two meters long.

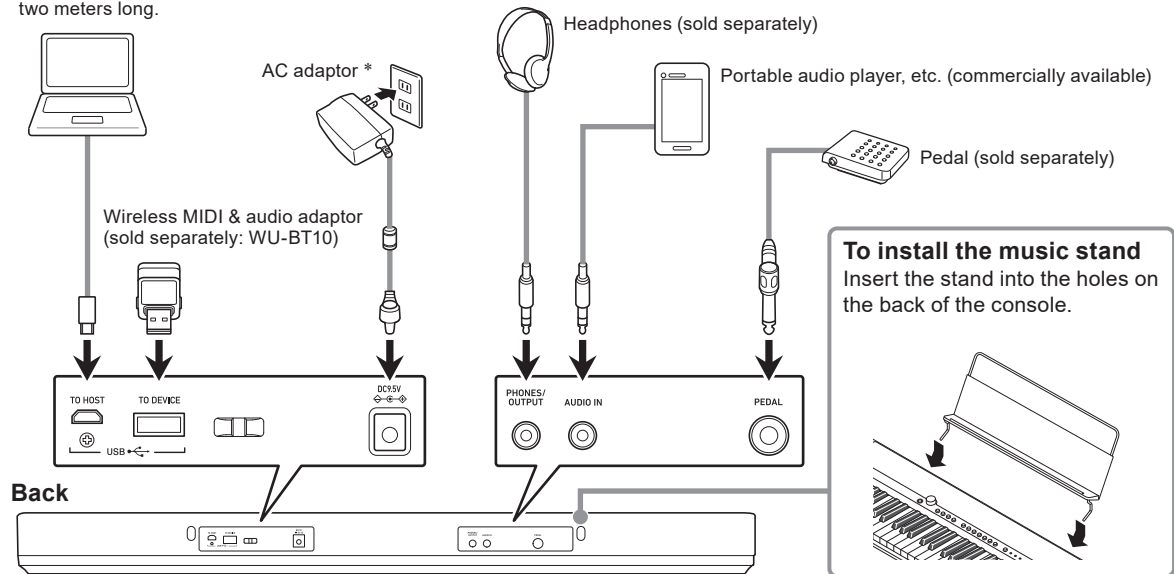

\*For the CT-S1-76, connect the power cord to the AC adaptor.

**To install the music stand**  
Insert the stand into the holes on the back of the console.

- The illustration shows the CT-S1. The CT-S1 has 61 keys; the CT-S1-76 has 76 keys.

## Basic Operation

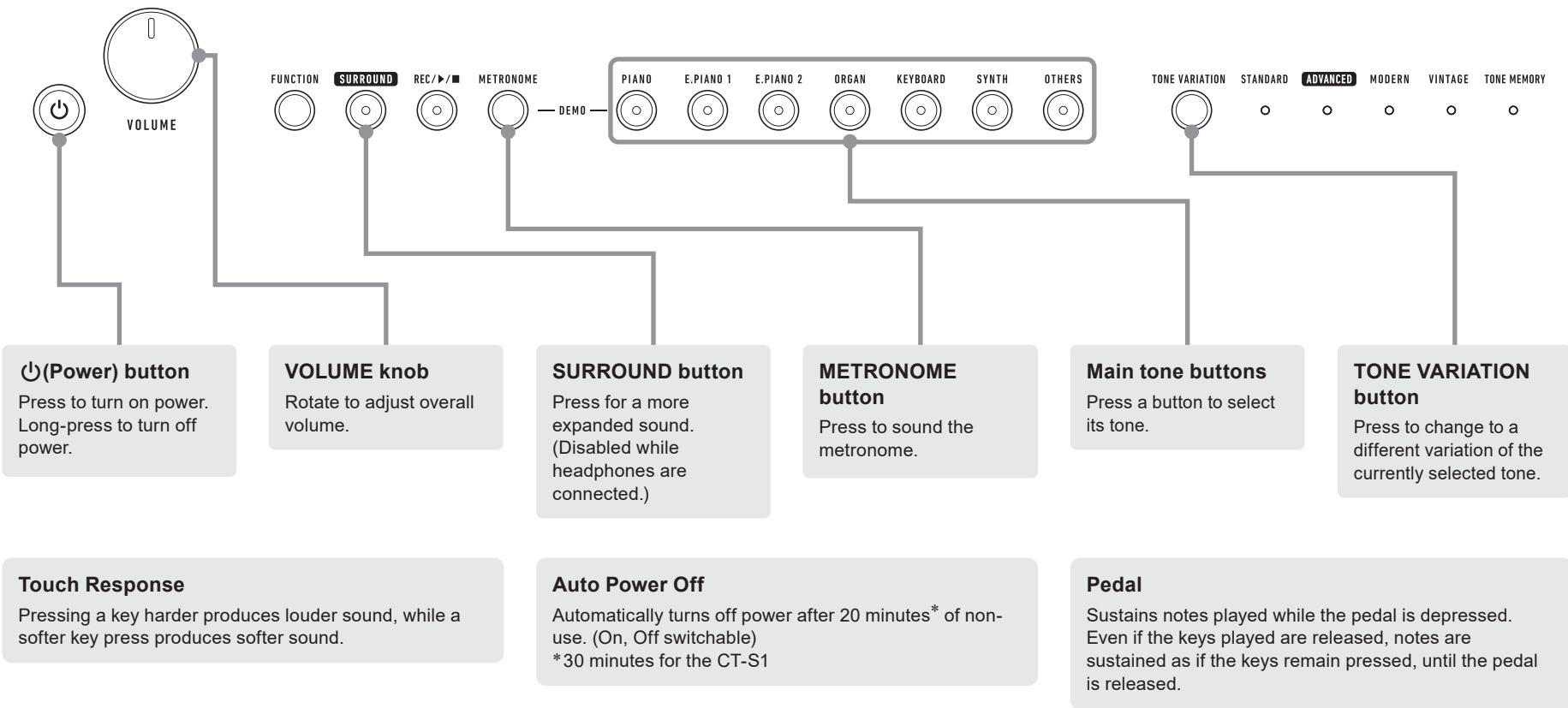

## Useful Functions

For details about operations, refer to the User’s Guide on the CASIO Website.

#### ■ My Setup

Save the current setup (tone, etc.) for later recall.

#### ■ Reverb

Output sounds using room, hall, and other acoustic effects.

#### ■ Octave Shift

Raise or lower the pitch of the keyboard in octave units.

#### ■ Transpose

Raise or lower the overall pitch in semitone steps.

#### ■ Scale Tuning (Temperament)

You can set the scale tuning of the keyboard for music that uses a scale tuning other than equal temperament.

## Practicing with the Metronome

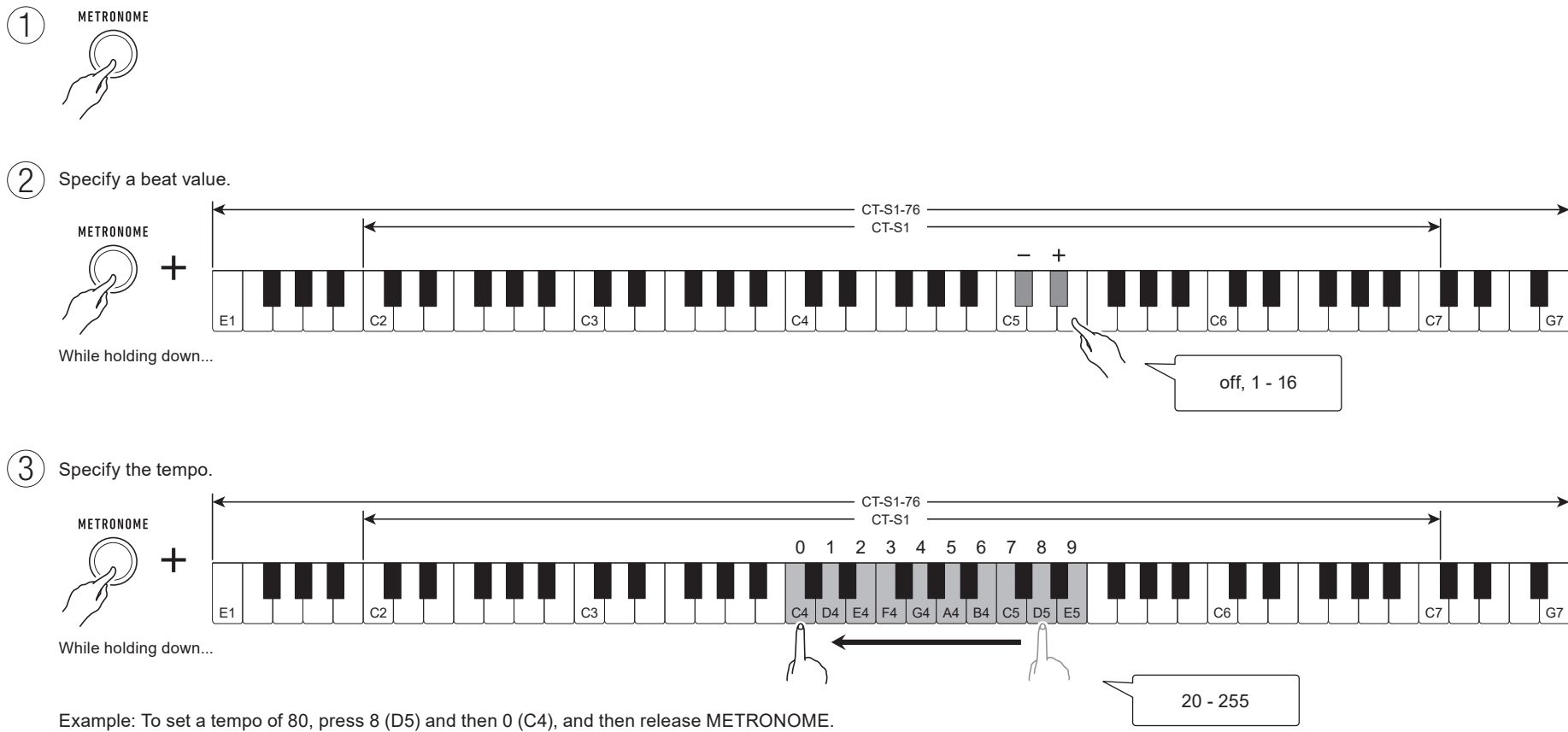

## Selecting a Tone

### To use the main tones to select an instrument

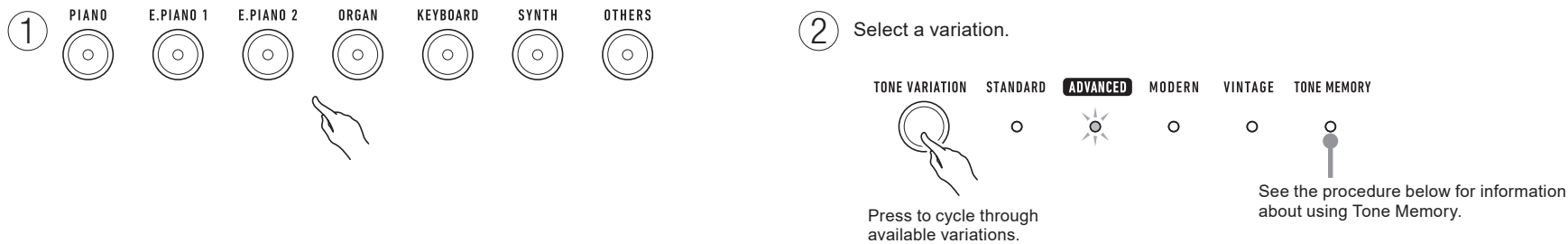

### To select a tone using the keyboard keys

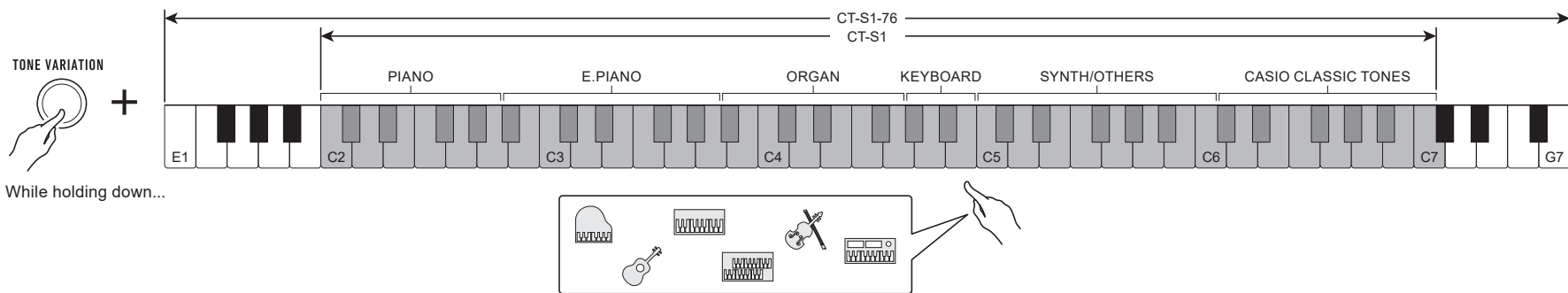

## Registering the Current Main Tone Setup to a Button (Tone Memory)

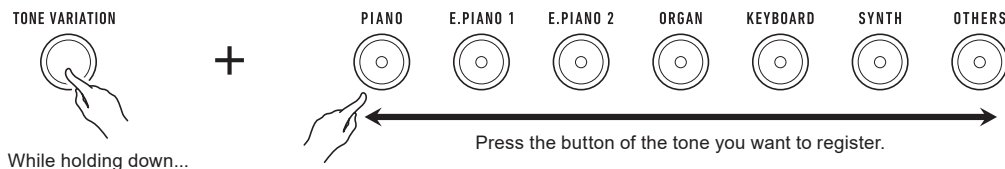

Playing with Two Layered Tones

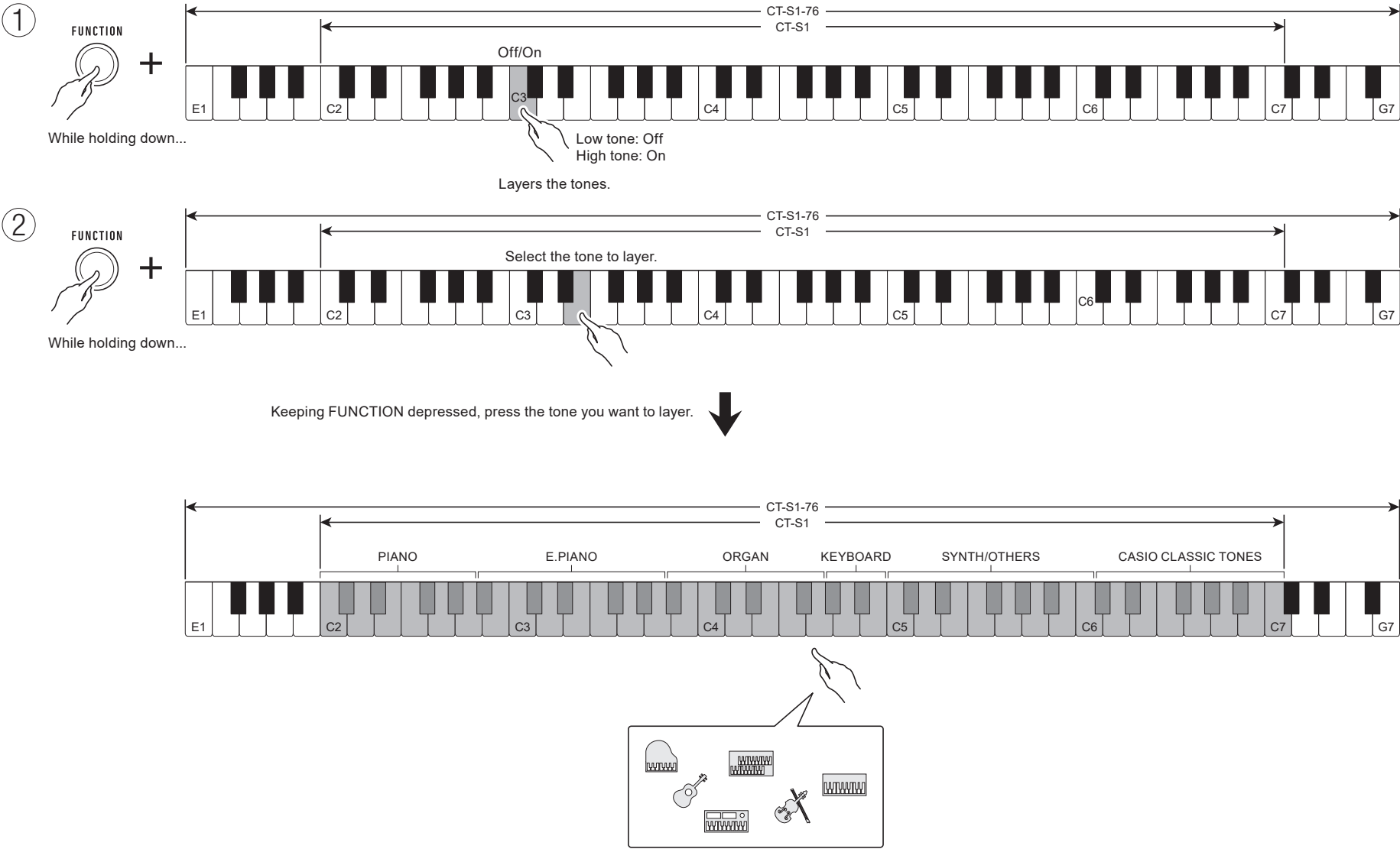

Playing with Touch Response

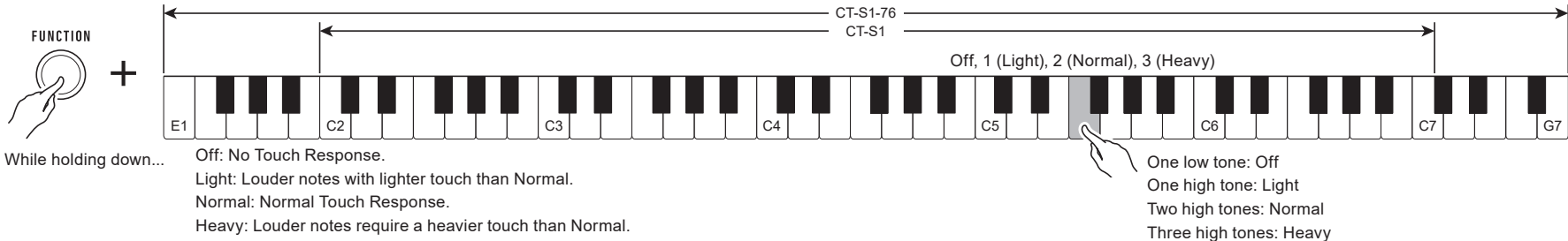

Playing with Sustain

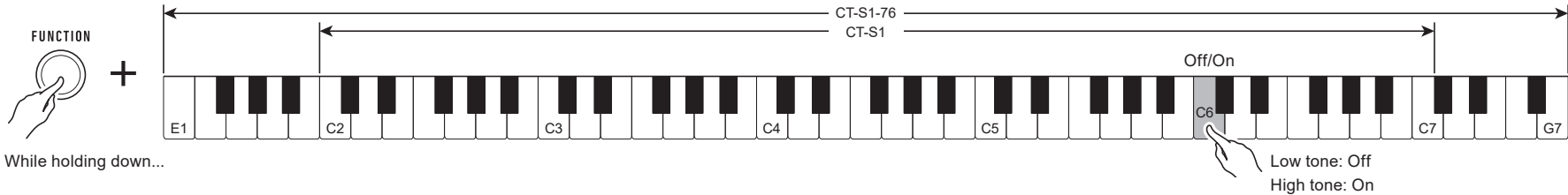

Recording Your Performance

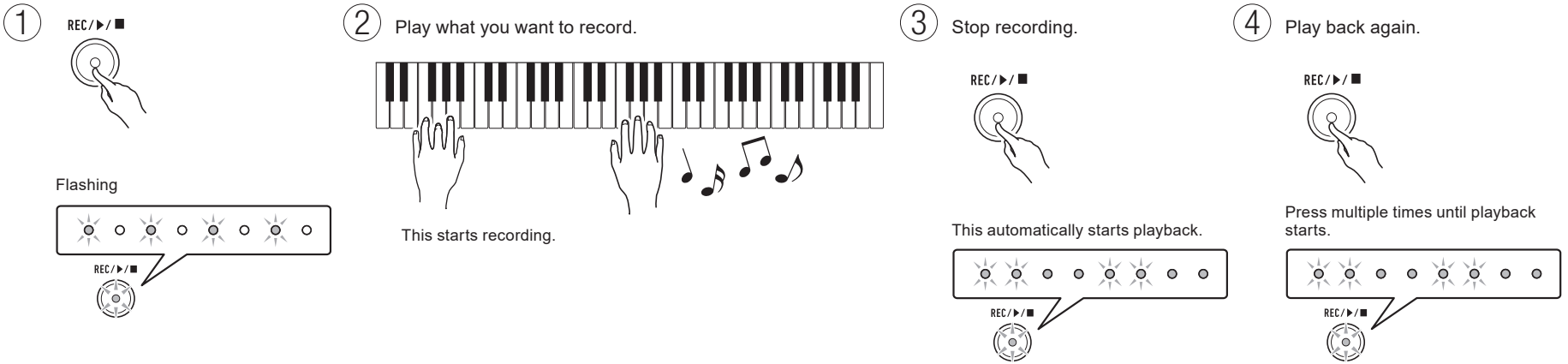

Specifying the Battery Type

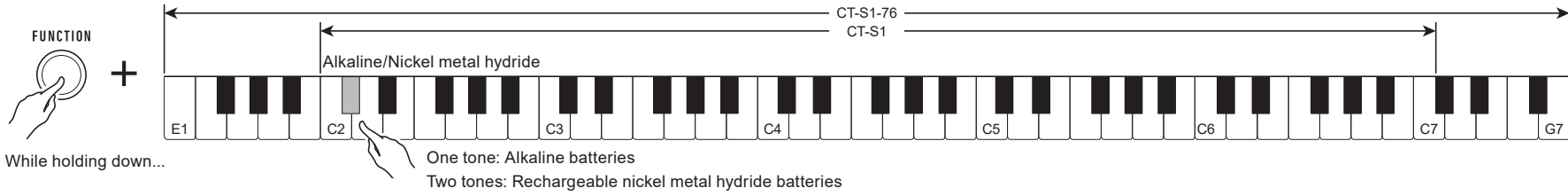

Returning Settings to Their Initial Factory Defaults (Initialization)

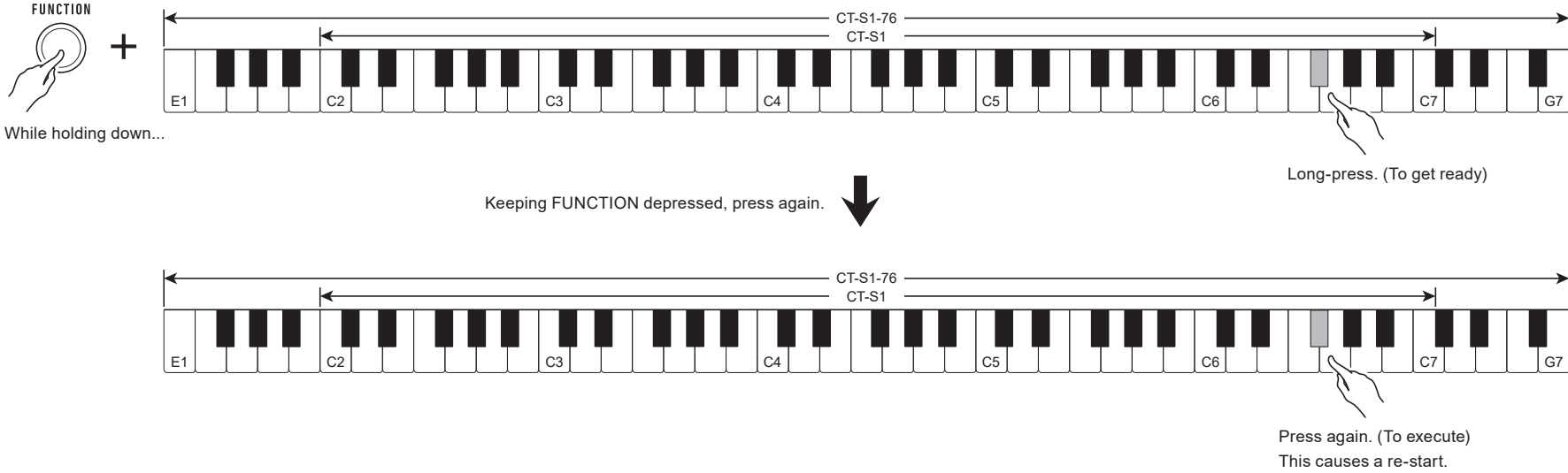

Using the Dedicated App (CASIO MUSIC SPACE)

Enjoy a range of fun functions using the Digital Keyboard together with the CASIO MUSIC SPACE app. Please visit the "Downloads" section of our website. Only the CT-S1-76 is compatible with the Remote Controller, which allows remote control of functions and settings on the Digital Keyboard via an app.

- The WU-BT10 (sold separately) or a commercially available USB cable is required to connect the Digital Keyboard to a smart device.

Reference

Product Specifications

**Model:** CT-S1-76BK/CT-S1-76WE  
**Keyboard:** 76 keys  
**Acoustics:** Amp output: 6.5W + 6.5W  
Speakers: 13cm × 6cm (oval) × 2  
**Power Supply:** 2-way power supply  
Batteries: 8 AA-size alkaline batteries or AA-size rechargeable nickel metal hydride batteries  
AC Adaptor: AD-A12150LW  
**Power consumption:** 12V --- 10W  
**Dimensions:** 114.0(W) × 25.8(D) × 8.3(H) cm (44 7/8 × 10 3/16 × 3 1/4 inch)  
**Weight:** Approximately 5.3 kg (11.7 lbs) (Excluding batteries)

**Model:** CT-S1BK/CT-S1WE/CT-S1RD  
**Keyboard:** 61 keys  
**Acoustics:** Amp output: 2.5W + 2.5W  
Speakers: 13cm × 6cm (oval) × 2  
**Power Supply:** 2-way power supply  
Batteries: 6 AA-size alkaline batteries or AA-size rechargeable nickel metal hydride batteries  
AC Adaptor: AD-E95100L  
**Power consumption:** 9.5V --- 7.5W  
**Dimensions:** 93.0(W) × 25.8(D) × 8.3(H) cm (36 5/8 × 10 3/16 × 3 1/4 inch)  
**Weight:** Approximately 4.5 kg (9.9 lbs) (Excluding batteries)

Specifications and designs are subject to change without notice.

- Any reproduction of the contents of this manual, either in part or its entirety, is prohibited. Except for your own, personal use, any other use of the contents of this manual without the consent of CASIO is prohibited under copyright laws.
- IN NO EVENT SHALL CASIO BE LIABLE FOR ANY DAMAGES WHATSOEVER (INCLUDING, WITHOUT LIMITATION, DAMAGES FOR LOSS OF PROFITS, BUSINESS INTERRUPTION, LOSS OF INFORMATION) ARISING OUT OF THE USE OF OR INABILITY TO USE THIS MANUAL OR PRODUCT, EVEN IF CASIO HAS BEEN ADVISED OF THE POSSIBILITY OF SUCH DAMAGES.
- The contents of this manual are subject to change without notice.
- Company and product names used in this manual may be registered trademarks of others.

Declaration of Conformity

Model Number: CT-S1-76/CT-S1  
Trade Name: CASIO COMPUTER CO., LTD.  
Responsible party: CASIO AMERICA, INC.  
Address: 570 MT. PLEASANT AVENUE, DOVER, NEW JERSEY 07801  
Telephone number: 973-361-5400  
CFR 47 §2.938 (b)(2) Attestation  
As of the date of first importation or marketing of this device, the device is not produced by any entity identified on the Covered List, established pursuant to 47 CFR § 1.50002, as producing covered communications equipment.  
This device complies with Part 15 of the FCC Rules, Operation is subject to the following two conditions:  
(1) This device may not cause harmful interference, and (2) this device must accept any interference received, including interference that may cause undesired operation.

A labels rating is affixed to the bottom of the product.

WARNING

If Auto Power Off is set to [Off], the Digital Keyboard does not automatically turn off and continues to use power.