

USER MANUAL

BC26-RTN-V1.21.17



All About Passion

Button function

Up Left ^

Short Press: Switch Data Type / Numerical Value

Left Down v / *

Short Press: Switch Data Type / Numerical Value
Long Press: Enter / Exit Setting Mode

Right Button > / P

Short Press: Power on / Start Riding / Switch Settings
Long Press: Power off / End the ride

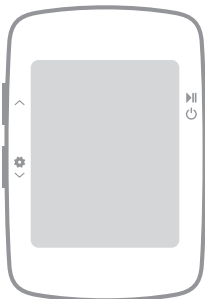

- 2 -

Status Icons

88:88	Time
No signal	No satellite signal
Satellite signal level	Satellite signal level
Alert sound on / off	Alert sound on / off
Riding	Riding
Manual pause / Auto pause	Manual pause / Auto pause
Bluetooth connected	Bluetooth connected
Battery level	Battery level
Average speed	Average speed
Maximum speed	Maximum speed
Miles per hour	Miles per hour
Kilometers per hour	Kilometers per hour
Riding time	Riding time
Distance	Distance
Altitude	Altitude
Odometer (Total distance)	Odometer (Total distance)

TOT	Total riding time
UTC	Time zone
h	Hour
ft / km / m / mi	Unit



- 3 -

Standard accessories



Main Device x 1

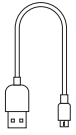

Charging Cable x 1

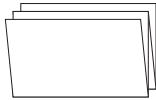

User Manual x 1



Standard bike mount x 1



Rubber pad for standard bike mount x 1

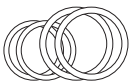

Big size rubber ring x 2
Small size rubber ring x 2

- 4 -

How to Install

Standard Mount Installation

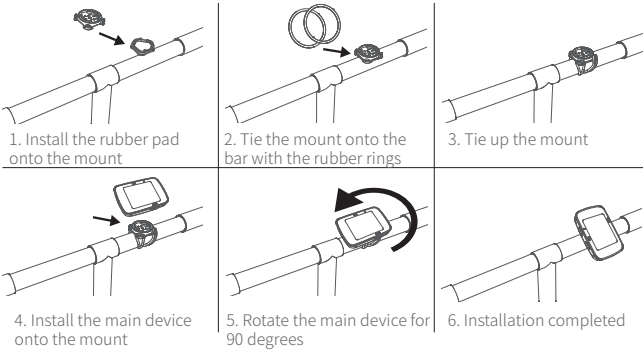

- 5 -

Charging

- Please charge the device before first time use.
- Please use DC 5V power adaptor for charging.
- During the charging, the battery icon will flash until fully charged.

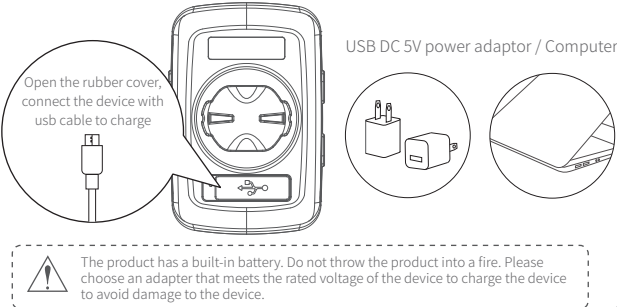

- 6 -

Acquiring Satellite Signals, Time Setting and Auto Backlight

Acquiring Satellite Signals

BC26 uses GPS for speed tracking, and please make sure the device is outdoor and under a clear view of sky when using it. Usually it may take 15-90 seconds for the bike computer to locate satellite signals, remain stationary when acquiring satellite signals.

Time Setting

The time and date will be calibrated automatically after locate the satellite signals(Check how to set the time zone correctly, please refer to the time zone setting chapter).

Auto Backlight

This device will automatically calculate the sunrise and sunset time, from the time half an hour before sun set to half an hour after sun rise, the backlight will be automatically lighted; the backlight will be turned off if no operation detected in 15 seconds.

- 7 -

Time Zone Setting

- Long press * to enter the setting mode (P1~P3), P1 time zone setting, the currently set numerical value flicker display;
- Short press v/^ to switch numerical value;
- Short press > to confirm the current setting, and enter the next digit or the next setting (P2 metric / imperial setting);
- The device will automatically save and exit after 15s no operation or long press * to exit the setting.

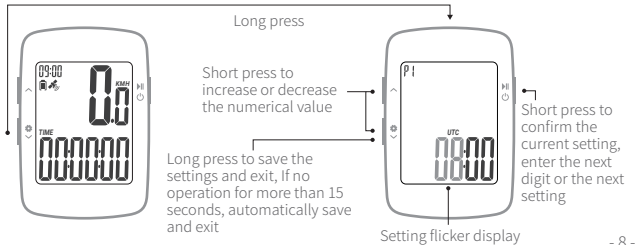

- 8 -

Setting Metric and Imperial Units

- Long press * to enter setting mode (P1~P3), short press > to enter P2 metric / imperial setting;
- Short press v/^ to switch between metric (KMH) / imperial (MPH);
- Short press > to confirm the current setting and enter the next setting (P3 speed alert setting).

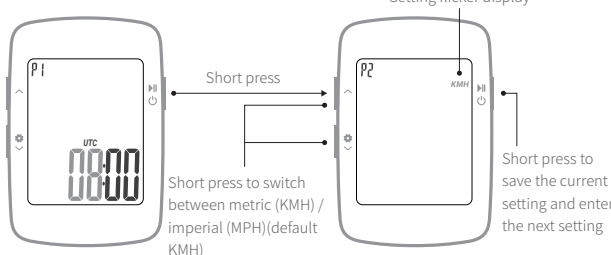

- 9 -

Maximum Speed Alert Setting

- Long press * to enter the setting mode (P1~P3), short press > to enter the P3 maximum speed alert setting, the currently set numerical value flicker display;
- Short press v/^ to switch numerical value;
- Short press > to confirm the current setting and enter the next digit setting or the next setting;
- Short press v/^ set the prompt tone on / off, after the setting is completed, Long press * to exit or no operation for 15s to automatically save and exit.

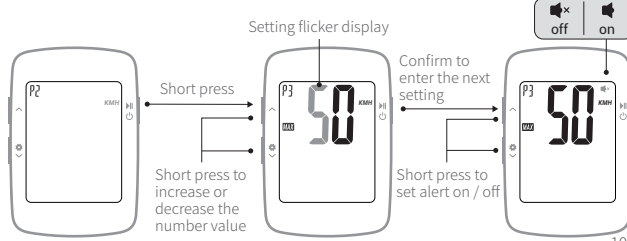

- 10 -

GPS Positioning

- Auto GPS positioning after the bike computer is power on. Please start cycling after the GPS positioning is successful.
- Please make sure you are outdoor when positioning. Bad weather and dense forest may affect GPS signal. You can stand still 3-5 minutes to get more connections with satellites for better GPS signal.
- If you lost GPS Positioning during riding, the speed data (real-time, average, maximum) will be displayed as "-.-", and the rest of the data remains the same.

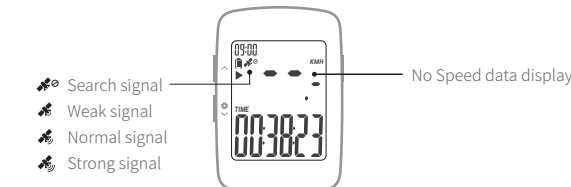

- 11 -

Cycling

Turn on the device, short press > to start riding, short press > to pause / start; Long press > to end riding (when the speed is 0 or there is no data during riding, or when the speed is too low, the bike computer will automatic pause |||| / automatic start >); When there is no speed data during riding, the cycling computer will automatically enter dormant after 15 minutes, and it will return to the previous riding state after pressing > to turn it on).

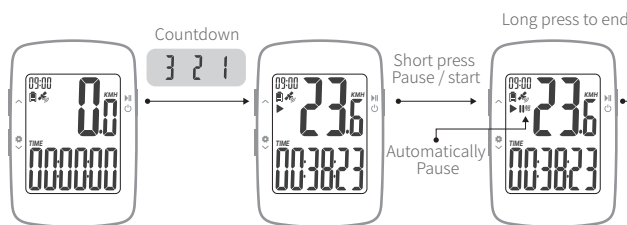

- 12 -

Riding Data Display

- Short press ^ cycle to switch real-time speed, maximum speed, and average speed.
- Short press v cycle to switch time, distance, altitude and time & distance display mode automatically switch data.

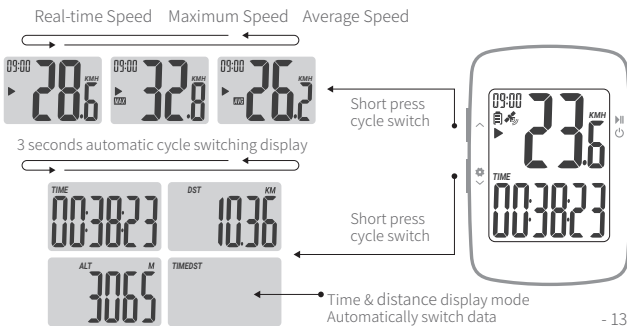

- 13 -

* Bluetooth Connection

- Download CoospoRide in Google Play or App Store



* Compatible with

- iOS 9.0 version and above, iPhone 4s and above
- Any Bluetooth 4.0 enabled Android device with Android 4.3 and above

- 14 -

- Power on the bike computer;

- Open the CoospoRide App, enter the binding cycling computer step, select the BC26 bike computer in the device list to bind the device, (the phone needs to turn on Bluetooth and allow Bluetooth permissions);



- 15 -

- In the activity page of the App, click on the connected device to enter the record synchronization operation page (through the authorization to Strava in the App more settings, the computer data can be synchronized to the Strava platform at the same time);
- Select the record to be synchronized and click Sync, and the record on the bike computer will be deleted automatically after synchronization.

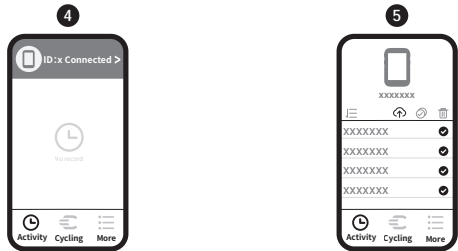

- 16 -

Basic Parameters

Wireless	Bluetooth
Display	FTN Screen, 2.3 inch
Auto Backlight	Yes
Locate mode	GPS & BDS
Storage Format	.fit
Water Resistance	IPX7
Weight	54g
Language	English
Battery Capacity	600mAh
Battery Life	20 hours for a single use after fully charged
Material	PC+ABS
Dimension	72.26x50x21.55 mm
File Transfer	Bluetooth (Specified App Compatible)

- 17 -

Attentions

The water resistant level of the bicycle computer is IPX7. It can be used in the rain if you close the protective cover on the back tightly. It is recommended to take down the bicycle computer and put it into waterproof bag if it rains heavily.

Responsibility Disclaimer

- The information contained in this manual just for reference. The product described above may be subject to alteration owing to the manufacturer's continuing research and development plans, without making an announcement in advance.
- We shall not bare any legal responsibility for any direct or indirect, accidental or special damages, losses and expenses arising from or in connection with this manual or the contained product.

- 18 -