

Main menu changes

Streaming services and Input Switching menus were moved to a different place in the system. Please read this guide to learn how to access them in the new Firmware.

Accessing Input Switching menu

Easiest way to access the Input Switching menu is by dedicated icon in the Swipe down menu. Swipe down from top of the screen to view this menu. Available in all parts of the system.

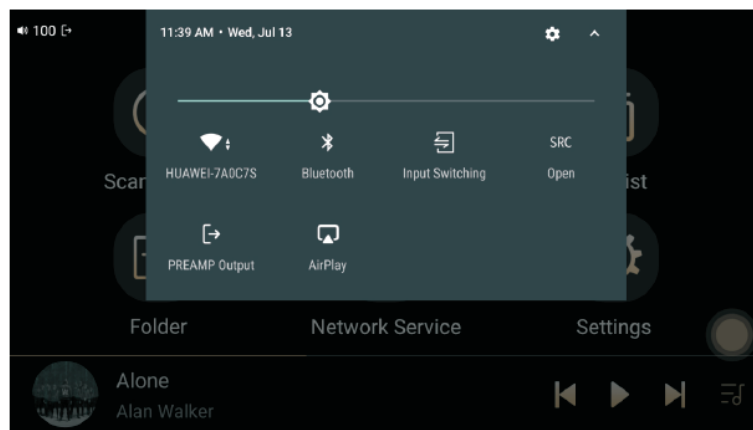

New “Source” Floating button

This second floating button was added to the system, allowing for quick access to Input Switching Menu from anywhere in the system. To open Input Switching Menu, hold on the “Source” button for 2 seconds.

You can hold and drag this button, to move it around the screen.

“Source” button can be disabled in System settings – Display – Open Audio-Source Floating Ball.

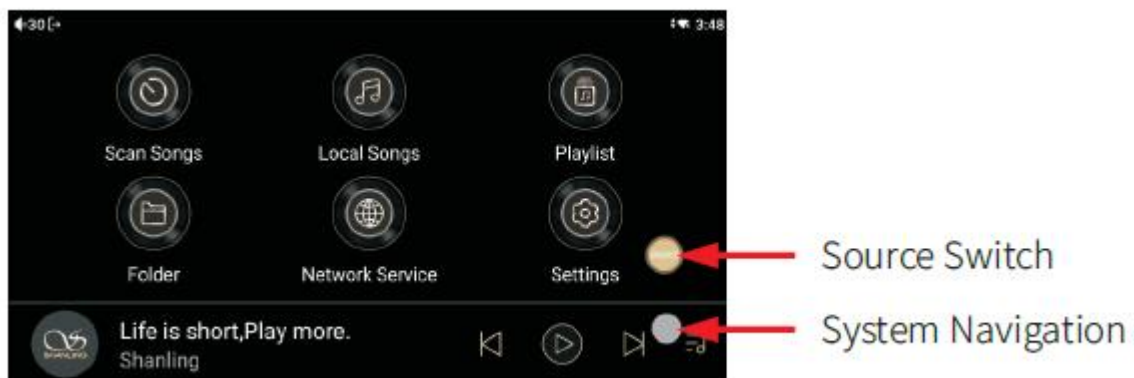

New Location of Streaming services

Streaming services were moved to the Input Switching menu. To access this menu, use the “Source” floating button or “Input-Switching” icon in Swipe down menu.

When opening the Streaming services menu, there is slight 5 second delay.

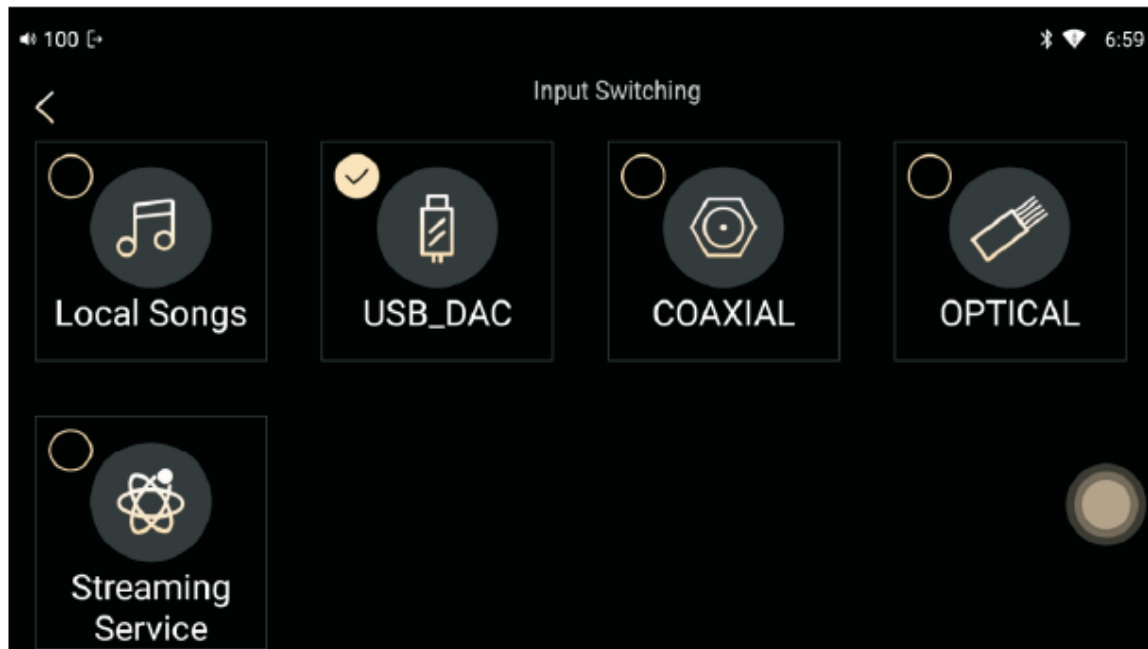

New Floating buttons in Wireless Projection on Eddict player

There are two new floating buttons in Wireless projection - Exit Button and Volume Control button.

If all floating buttons are enabled, you will see 4 floating buttons in Wireless Projection.

All of these buttons can be moved around the screen, making sure they do not cover any UI elements underneath them.

