

SPECIFICATIONS

Model Number	: WGP12S
Number of Buttons	: 22
Connectivity	: StrikeSpeed Wireless, Wired
Thumbstick Type	: Hall-Effect
Trigger Type	: Hall-Effect
Face Button Type	: Membrane
Turbo	: Yes
Vibration	: 4-level Adjustable
Macro Buttons	: 12
polling Rate	: 1000 Hz (Wired), 1000 Hz (Wireless)
Battery Capacity	: 600 mAh Li-ion
Battery Life	: Up to 20 Hours
Size	: 160*108*69 mm
Weight	: 205 ± 3 g
Power Rating	: 3.7V \Rightarrow 180 mA
Compatibility	: Windows 7 or later, Switch, Android, PS3

PRODUCT TOUR

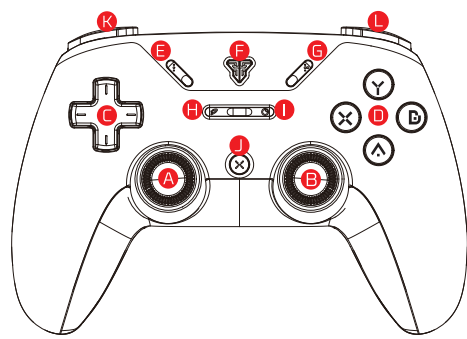

EN

- A** Left Thumbstick
- B** Right Thumbstick
- C** Directional Pad
- D** Action Buttons
- E** Select Button
- F** Home Button
- G** Start Button
- H** Turbo Button
- I** Snap Button
- J** Fx Button
- K** Left Bumper
- L** Right Bumper
- M** Right Trigger
- N** Left Trigger
- O** USB-C Port
- P** Right Rear Paddle
- Q** Left Rear Paddle

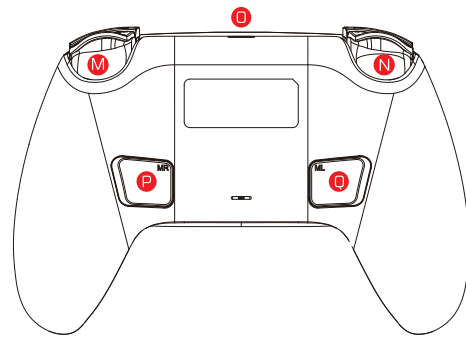

ID

- A** Thumbstick Kiri
- B** Thumbstick Kanan
- C** Bantalan Arah
- D** Tombol Aksi
- E** Tombol Select
- F** Tombol Beranda
- G** Tombol Start
- H** Tombol Turbo
- I** Tombol Snap
- J** Tombol Fx
- K** Bumper Kiri
- L** Bumper Kanan
- M** Pemicu Kanan
- N** Pemicu Kiri
- O** USB-C Port
- P** Right Rear Paddle
- Q** Left Rear Paddle

THUMBSTICK CIRCULARITY



You can change the thumbstick circularity by press & hold the turbo button & R3/L3 button for 3 seconds.

**There are 2 types thumbstick behaviour: Radial & Pinwheel*

CALIBRATION



To start the calibration process for your gamepad's thumbstick and trigger, please follow these steps:

1. Ensure your gamepad is turned off, then press & hold the Turbo, Fx, and Home buttons simultaneously.
2. Indicator 1 will begin to blink. Press the A button, & Indicator 2 will start blinking, signaling that the gamepad is ready for calibration.
3. Gently move the thumbstick in a circular motion, then slowly press the trigger button. After completing the calibration, press the A button once more to finalize the process.

XYAB<>YXBA SWAP



You can swap the action button to suit your needs by press & hold the turbo button & R3 for 3 seconds.

**There are 2 types of action button, Switch & Xbox.*

THUMBSTICK<>D-PAD SWAP



To switch the left thumbstick to function as a D-pad, press & hold the turbo button & L3 for 3 seconds.

SMART GYROS



To enable Smart Gyro (Aim/View), hold fx + L2 button until controller vibrates. To activate it, simply hold L2 button.

To enable Smart Gyro (Movements), hold the fx + L1 button until controller vibrates. To activate it, simply hold L1 button.

FACTORY RESET



To reset your gamepad, please press & hold Fx button for 8 seconds.

DOWNLOAD

To further customize your setting, please visit our website and download the software (if applicable).



www.fantechworld.com

HOW TO CONNECT

WIRED CONNECTION



2.4GHZ CONNECTION

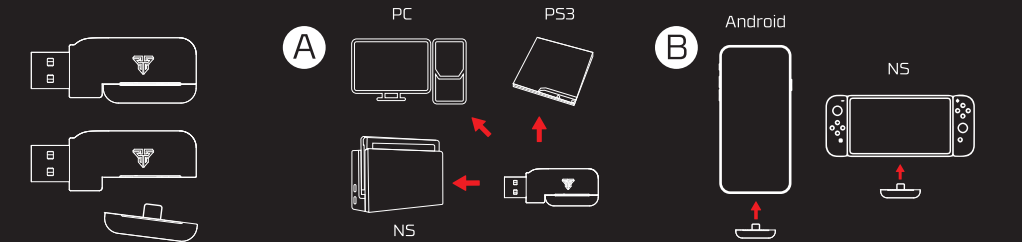

LED INDICATOR



X-Input

(PC, Android)



D-Input

(PC, Android, Emu)



S-Input

(Emu, PS3, NS)

**On PC, to toggle from X-Input to D-Input, press Fx & home button for 3 seconds.*

**On Android, LED will only show D-Input notification as small picture above. Switch from D-Input to X-Input by pressing the home & snap buttons simultaneously for 3 seconds.*

COMBO SWAP FUNCTION



Press & hold turbo & Fx button for 3 seconds to activate combo swap function (keyboard & mouse function).

TURBO FUNCTION



1. To activate the turbo effect, hold down the Turbo button and press the action button you wish to assign.
2. To enable the auto-fire effect, hold the Turbo button and press the button that has already been assigned.
3. To remove the turbo effect, hold the Turbo button and press the assigned button again.

**The turbo function can be applied to these buttons: Action buttons, LT, RT, RB, LB.*

RUMBLE FUNCTION



You can adjust the rumble intensity by holding the Fx button and push the L3 up & down.

**There are 4 level of rumble (100%-70%-30%-0%).*

MACRO FUNCTION



1. Press & hold the Fx button along with the Rear Paddle (left or right) you want to assign for 3 seconds.
2. LED 2 + 3 will light up, indicating the device is ready to receive input.
3. Press the button you wish to assign, then press the Rear Paddle again to complete the recording process.
4. To erase the macro, repeat the steps, but during the input section, simply press the Rear Paddle again without assigning a button.

**You can record up to 63 buttons. If you don't press anything for 5 minutes when recording, it will automatically stop inputting the macro.*

Join the Fantech
Discord
Community



ANY QUESTIONS?

Thanks for choosing Fantech.
If you have any question or need any help with your products,
please do not hesitate to contact us.

support@fantechworld.com

WGP12S

REVOLVER III
MULTI-PLATFORM GAMEPAD



QUICK START GUIDE

PANDUAN CEPAT **[ID]**
快速入门指南 **[ZH]**

