

## ERV WALL CONTROLLER

### ODD-ERV-TIMER

#### WARNING

**WARNING — THE INSTALLATION MUST BE CARRIED OUT BY A QUALIFIED ELECTRICIAN.**

Electrical wiring must be done by qualified personnel in accordance with all applicable codes and standards. Before connecting wires, unplug the unit or switch power off at service panel and lock service disconnecting means to prevent power from being switched on accidentally. Always wear safety glasses and gloves while performing these instructions.

#### CAUTION

Failure to comply with the following can cause erratic operation of the control and/or unit:

- Never install more than one main wall control per ventilation unit
- Keep control low voltage wiring at least 1 foot (305 mm) away from motors, lighting balast, light dimming circuit and power distribution panel. Do not route control wiring alongside house power wiring
- Ensure the wires are securely connected
- Use normal cooper wire or low voltage wire to connect the unit with the controller, 30M length maximum or use a shielded wire, 10M ideal

#### INSTALLATION

1. Unplug the ventilation unit.
2. Cut a  $2\frac{7}{8}$ " x  $1\frac{3}{4}$ " hole in a wall, at a convenient location for the control. Route a cable (type 22/4) for the control from the unit to this hole. See figure at right.
3. Temporarily place the control over the hole and mark both mounting screw hole positions.
4. Remove the control, drill both screwholes ( $3/16$ " ) in wall and insert the wall anchors (included).
5. Strip the end of the cable to access the 4 wires (about 3"). Strip the end of each wire (about  $1/4$ "). Connect the wires to the terminals regardless of the wire color. Note which wire color has been chosen for each terminal.  
NOTE: To avoid miswiring, refer to the notes taken at step 5 to match the wire color with the right terminal.
6. Mount the control to the wall.
7. Perform the electrical connection to the terminal connector of the unit. For more details, refer to the installation manual of the ventilation unit.
8. Plug the ventilation unit and test the wall control.

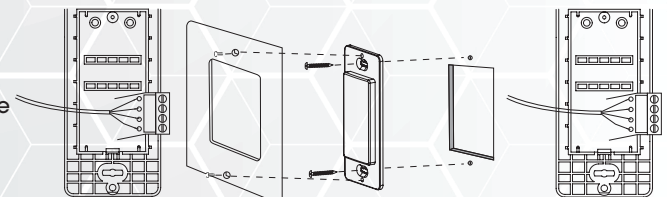
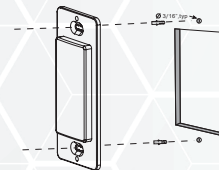
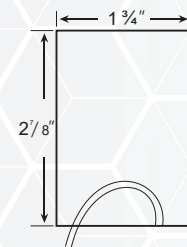

#### HOW TO USE

Push once for 20-minute, twice for 40-minute, or three times for 60-minute activation. Indicator lights up and the controlled unit goes to high speed.  
Push once more to stop activation. Unit returns to its previous setting.

Type of indication:

- LED 1 = 20 min timer is active
- LED 2 = 40 min timer is active
- LED 3 = 60 min timer is active

