



BG-S8

BATTERY GRIP

Designed for the
Sony a6600
Mirrorless Camera

 VELLO®

USER'S MANUAL

Thank you for choosing Vello.

The Vello BG-S8 battery grip offers extended shooting time and a comfortable hand position when shooting in a vertical (portrait) orientation. It's compatible with the Sony a6600 mirrorless camera, and it accepts up to two Sony NP-FZ100 rechargeable batteries. Its alternate shutter-release button works with the included Multi-Terminal cable.

Please read through this entire manual before using the BG-S8 battery grip.



Precautions

1. The BG-S8 should be used only with compatible devices specified in this manual.
2. Use only with the batteries and battery holders recommended in this manual.
3. If you notice smoke, noise, or an unusual smell from the battery pack, discontinue use immediately. Remove the batteries and take the device to a Vello authorized reseller.
4. The battery level may not display properly if batteries are installed before mounting the grip.
5. Remove batteries from the grip when not in use.
6. Do not attempt to disassemble.
7. Avoid exposing this product to water or extreme humidity, and keep it in a dry, cool place.
8. Keep out of reach of children.
9. All images are for illustrative purposes only.

Overview

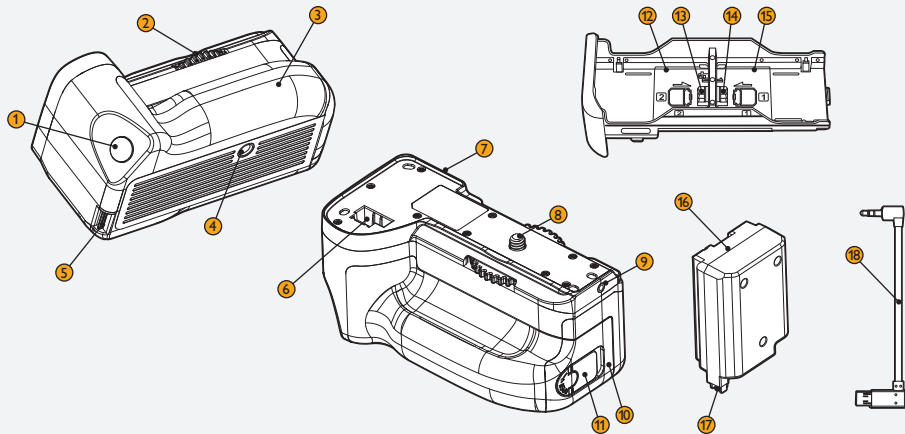

① Shutter release button

② Thumbwheel lock

③ Nonslip grip

④ Tripod socket

⑤ Hand-strap mount

⑥ Connection plate cover recess

⑦ Power ON/OFF switch

⑧ Mounting screw

⑨ Shutter-release socket

⑩ Battery tray

⑪ Battery tray lock

⑫ Battery slot 2

⑬ Slot 2 contacts

⑭ Slot 1 contacts

⑮ Battery slot 1

⑯ Battery pack adapter

⑰ Battery pack adapter contacts

⑱ Shutter release cable

Attaching the Battery Grip

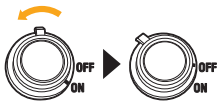

1. Ensure that the camera power is turned off.

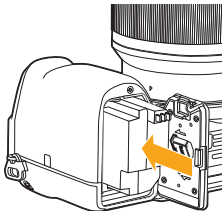

2. Open the camera's battery chamber door, and insert the battery pack adapter.



3. Open the camera's connection plate cover, and close the battery chamber door. This will leave the battery pack adapter's contacts exposed.

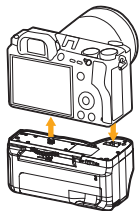

- 4.** Align the camera's tripod socket with the BG-S8's mounting screw, and insert the camera's connection plate cover into the recess.



- 5.** Rotate the thumbwheel counterclockwise until it's firmly tightened.

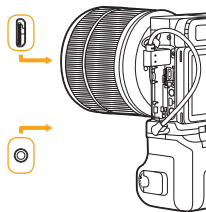

- 6.** Connect the shutter release cable from the 2.5 mm socket on the battery grip to the Multi-Terminal port on the camera body.

Inserting the Batteries

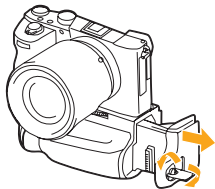

1. Lift and rotate the battery tray's lock counterclockwise and remove the tray from the grip.

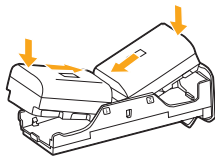

2. Align the contacts of the first battery with slot 1, and slide the battery in and down until it clicks. Repeat this step for the second battery.

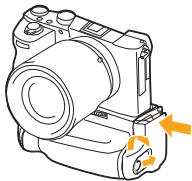

3. Insert and lock the battery tray inside the battery grip.

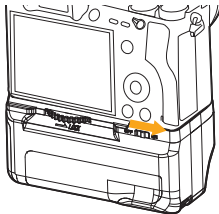

4. Turn on your camera and switch the battery grip's power switch to the ON position.

Note: When removing the grip, turn off the grip and camera power, and remove the batteries.

Specifications

Power source	Up to two NP-FZ100 rechargeable Li-ion batteries
Shutter-release socket	2.5 mm
Operating temperature	32°F to 104°F (0°C to 40°C)
Dimensions (H × W × D)	2.4 × 4.8 × 2.6 in. (61 × 121.8 × 65.7 mm)
Weight	6.8 oz. (194 g) without batteries

ONE-YEAR LIMITED WARRANTY

This VELLO product is warranted to the original purchaser to be free from defects in materials and workmanship under normal consumer use for a period of one (1) year from the original purchase date or thirty (30) days after replacement, whichever occurs later. The warranty provider's responsibility with respect to this limited warranty shall be limited solely to repair or replacement, at the provider's discretion, of any product that fails during normal use of this product in its intended manner and in its intended environment. Inoperability of the product or part(s) shall be determined by the warranty provider. If the product has been discontinued, the warranty provider reserves the right to replace it with a model of equivalent quality and function.

This warranty does not cover damage or defect caused by misuse, neglect, accident, alteration, abuse, improper installation or maintenance. EXCEPT AS PROVIDED HEREIN, THE WARRANTY PROVIDER MAKES NEITHER ANY EXPRESS WARRANTIES NOR ANY IMPLIED WARRANTIES, INCLUDING BUT NOT LIMITED TO ANY IMPLIED WARRANTY OF MERCHANTABILITY OR FITNESS FOR A PARTICULAR PURPOSE. This warranty provides you with specific legal rights, and you may also have additional rights that vary from state to state.

To obtain warranty coverage, contact the Vello Customer Service Department to obtain a return merchandise authorization ("RMA") number, and return the defective product to Vello along with the RMA number and proof of purchase. Shipment of the defective product is at the purchaser's own risk and expense.

For more information or to arrange service, visit www.vellogear.com or call Customer Service at 212-594-2353.

Product warranty provided by the Gradus Group.

www.gradusgroup.com

VELLO is a registered trademark of the Gradus Group. © 2021 Gradus Group LLC. All Rights Reserved.



All other trademarks are the property of their respective owners.

GG1