

Suitable for those are over 14 years old



## SOFTWARE INSTRUCTION MANUAL



---

Software support required operating system: iOS 8.0 or higher / Android 4.4.4 or higher.  
Before using the product, please read this instruction manual carefully and try to choose to fly in an environment with good air and light, so as to ensure normal operation.

## 1. Download and installation instructions of APP software:

### 1.1 Download and install the software:



### 1.2 Description of links:

- ① Long press 3 seconds to turn on the power, enter (Mobile or IPAD) "Settings" option, open the wireless network, find the name of the device "VS-XXXXXX" in the wireless network search list and connect it. After the connection is successful, exit the setting option.
- ② Open "VS GPS PRO" software icon in mobile phone and enter the control interface. (Try to stay away from other signal sources when flying)

⚠ Note: One drone, at the same time, only one mobile app is allowed to connect!

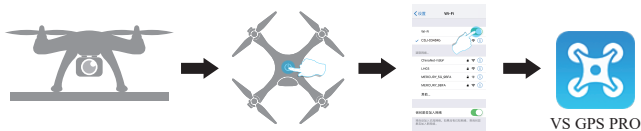

## 2. Function introductions of APP control interface:



### 3.Environmental requirements before flying:

Please choose an open indoor area or a rainless outdoor place with a wind force below grade 4.

Please keep away from people, trees, wires, tall buildings, airports and signal towers when flying.

⚠Special note: flying height and distance limit: full-electricity fence shall be with a height of 120m and a distance of 300m; low-electricity fence shall be with a height of 15m and a distance of 20m.



### 4.Instructions for operation of APP functions:

#### 4.1 Map update:

When APP is started for the first time, the mobile data network of your device (mobile phone or IPAD) shall be connected(Figure 1); return to APP control interface, double-click the GPS signal icon (Figure 2) in the lower left corner to make the map can update your location in real time through the mobile data network. After completion of the update, click the back icon in the lower left corner (Figure 3) to return to the interface icons.



Figure 1



Figure 2



Figure 3

#### 4.2 Newbie mode

Click the "Settings" icon in the APP control interface (Figure 4), go to the settings interface, choose to turn off the newbie mode (Figure 5), and click to save the settings (Figure 6). Click on "Save Settings" (icon 6), then you can let the drone fly without altitude and distance restrictions.

⚠Special note: When flying outdoors for the first time, you need to turn off the novice mode and set the flight parameters for a better operating experience.



Figure 4



Figure 5



Figure 6

#### 4.3 Horizontal calibration and compass calibration operation

Click the "Parameter setting" icon in the APP control interface (Figure 7) to enter the calibration settings interface (Figure 8), we need to calibrate the two items according to the operation method shown in the text, and click the "Start Calibration" icon to confirm completion (Figure 9).



Figure 7



Figure 8



Figure 9

## 4.4 Unlock

After clicking the "more features" icon in the APP control interface (Figure 10), select the "unlock" icon in the picture frame (Figure 11). At this time, the four propellers will turn at the same time, indicating that the unlocking is successful, and the drone will be able to operate normally.



Figure 10



Figure 11

## 4.5 One-key takeoff and landing

Click the "one key takeoff" icon in the APP control interface (Figure 12), in the pop-up box, slide to the right to confirm (Figure 13). The drone will automatically rise to a height of about 1 meter and keep flying smoothly at this height; during the flight, click this icon again and the drone will automatically land slowly. During the flight, click this icon again, the drone will land slowly.



Figure 12



Figure 13

## 4.6 Rocker controller

During the flight, we can control the flight direction of the drone by clicking on the "more features" icon (Figure 14) and then clicking on the "rocker" icon (Figure 15) in the picture frame. icon in the picture frame (Figure 15), and use the joystick to control the flight direction of the drone (Figure 16).



Figure 14



Figure 15



Figure 16

## 4.7 One-key return

During the flight, click the "one key return" icon in the APP control interface (Figure 17), and swipe right in the pop-up box to Confirm (Figure 18) to start the return flight. After starting the return flight, the drone will return directly to the takeoff point; during the return flight, click this icon again to cancel the return flight. Click this icon to cancel the return flight.



Figure 17



Figure 18

## 4.8 High/low speed

During the flight, click the "more features" icon in the APP control interface (Figure 19), select the "High/low speed" icon (Figure 20), you can switch the flight speed of the drone, the default is low speed mode.





Figure 19



Figure 20

## 4.9 Waypoint flying

① Click the "more features" icon in the APP control interface, and then click the "waypoint flying" icon in the picture frame (Figure 21), then the map interface will be converted to the map interface; in the blue range of the map, click to set waypoints (Figure 22), you can Set the track range of single or continuous waypoints (Figure 23). In the process of setting, if you think the waypoints are too dense, you can click the delete icon to delete a single point (Figure 24) or choose to delete all the waypoints.

② After setting the waypoints, click the send icon (Figure 25), in the pop-up box, swipe right to confirm (Figure 26), the drone will fly from the initial point to all the waypoints by itself to complete the preset flight path. During the flight, you can control the orientation of the vehicle with the joystick.



Figure 21



Figure 22



Figure 23



Figure 24



Figure 25



Figure 26

## 4.10 Surrounding flying

Click the "parameter setting" icon in the APP control interface, enter the surround setting interface (Figure 27), adjust the required radius distance (Figure 28), and click to save the settings; then in "more features", click the "Surrounding flying" icon in the picture frame (Figure 29), the drone will fly around the set radius distance with the current flight position as the center.

⚠ **Special note:** When electricity of drone is too low, the surround flying will not be possible.

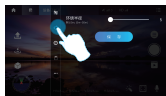

Figure 27



Figure 28



Figure 29

## 4.11 Smart follow

After clicking the "more features" icon in the APP control interface (Figure 30), choose to click the "smart follow" icon in the picture frame (Figure 31), the flying machine will take the distance from the current position to the controller's (cell phone or iPad) device as the base and move by itself. In the process of following, you can choose to click the "smart follow" icon to cancel following.

⚠ **Special note:** After changing the position of the drone, if the electricity of drone is too low or there is a phone call, drone will exit the follow mode.



Figure 30



Figure 31

## 4.12 Find drone

During the flight, if we don't know the exact location of the drone, we can click the "more features" icon in the APP control interface, and then choose to click the "Find drone" icon in the picture frame (Figure 32) to switch to the map interface to find the exact location of the drone (Figure 33).



Figure 32



Figure 33

## 4.13 Photo/Video

Click the "shutter" icon in the APP control interface (Figure 34) to take photos quickly; or click the "photo/video" icon (Figure 35) to choose more shooting methods in the pop-up box. In the process of recording, click the video icon again to end the recording. After the shooting is finished, the photo or video will be saved to the album.



Figure 34



Figure 35

## 4.14 Add music

After clicking the "more features" icon in the APP control interface, choose to click the "Add Music" icon in the picture frame (Figure 36), click to select music in the upper left corner of the converted interface (Figure 37), then choose your favorite background music and click to confirm (Figure 38), so that our recorded video will have a favorite background music; after the recording is finished, the composite short video will be saved to the album.



Figure 36



Figure 37



Figure 38

## 4.15 Lens Filters

Click the "Lens Filters" icon in the APP control interface (Figure 39), click to select our favorite filter effect (Figure 40), you can add beautifying effects to the pictures or videos you take, the default filter is the original effect.



Figure 39



Figure 40

#### 4.16 PTZ adjustment

After clicking the "more features" icon in the APP control interface, choose to click the "PTZ adjustment" icon in the picture frame (Figure 41), you can adjust the angle of the PTZ in the process of taking pictures or recording.



Figure 41

Cloud platform lens  
back to the midpoint  
Restart the head  
Fine adjustment of the up  
and down angle of the head



Up and down angle  
adjustment of the head  
Head lens facing down  
Fine adjustment of the left  
and right angle of the head

#### 4.17 Memory card formatting

When the SD card is used for the first time, you need to click the "parameter setting" icon in the APP control interface to enter the SD card format setting interface (Figure 42) and click to start the formatting process in order to store photos and videos normally.



Figure 42

### 5.Control interface function description:

When the left joystick (throttle) is pushed up or down, the drone can be controlled to rise or fall.



When the left joystick (throttle) is pushed to the left or to the right, the left or right turn of the drone can be controlled.



When the right joystick (throttle) is pushed up or down, the drone can be controlled to move forward or backward.



When the right joystick (throttle) is pushed to the left or to the right, the left or right side of the drone can be controlled to fly.



## 6.Solving guidelines for the common problems:

Problems	Reason	Solution
Drone indicator flashing while it does not respond to the operations	<ol style="list-style-type: none"> <li>1. GPS star searching of drone is failure.</li> <li>2. Electricity of drone battery is low.</li> </ol>	<ol style="list-style-type: none"> <li>1. Move drone to an open place and make star searching again</li> <li>2. Charge the battery</li> </ol>
Drone blades rotate but it cannot take off	<ol style="list-style-type: none"> <li>1. The battery electricity is low.</li> <li>2. Blade deformation</li> </ol>	<ol style="list-style-type: none"> <li>1. Charge the battery</li> <li>2. Replace the blade</li> </ol>
Drone shakes badly	Blade deformation	Replace the blade
Fine tuning to the end but drone still can't fly smoothly	<ol style="list-style-type: none"> <li>1. Blade deformation</li> <li>2. Motor failure</li> </ol>	<ol style="list-style-type: none"> <li>1. Replace the blade</li> <li>2. Replace the motor</li> </ol>
Start drone again after an impact, the flying can be controlled	Triaxial acceleration sensor loses balance due to impact	Place drone for 5-10s, or correct the gyroscope.