



Signal S2TM

Quick Start Guide

Thank you for your Polk purchase. If you have a question or comment, please feel free to call or email us.

Technical Assistance

In North America, call Polk Customer Service at **800-377-POLK(7655)** (M-F, 9 a.m.-5:30 p.m. EST)

Outside the US, call **+1-410-358-3600**

Email: polkcs@polkaudio.com

Polk Audio
1 Viper Way
Vista, CA 92081

The complete owner's manual can be found online at www.polkaudio.com

In all other countries, please refer to polk-eu@mailmw.custhelp.com

What's in the Box

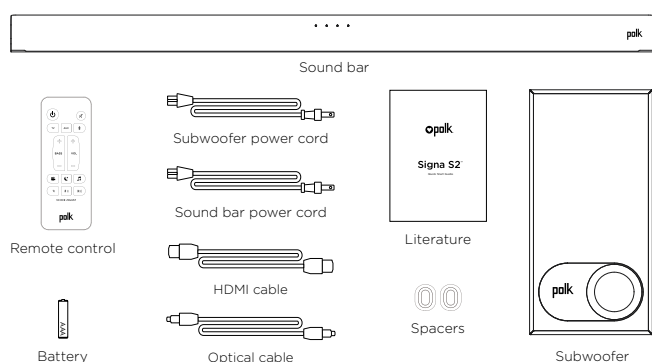

Connecting Your Signa S2 to Your TV

1. Is an HDMI port on your TV labeled "ARC"?

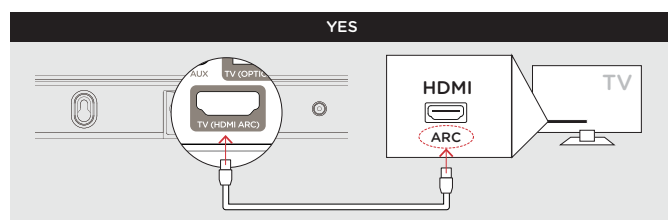

Connect the included **HDMI cable** to the HDMI ports labeled with "ARC" on both the TV and the sound bar.

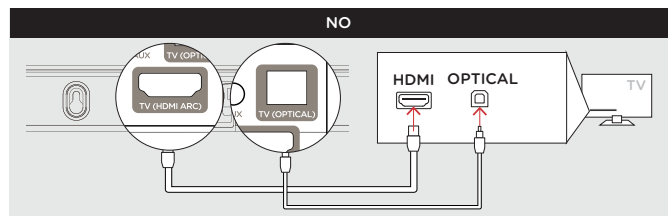

Connect the an **Optical cable** between the TV and sound bar.
Connect the included **HDMI cable** to any available HDMI port on the TV and to the "TV ARC" port on the sound bar.

NOTE: HDMI (ARC) and optical supports Dolby 5.1 decoding.

2. Remote battery installation:
Insert the provided AAA battery.

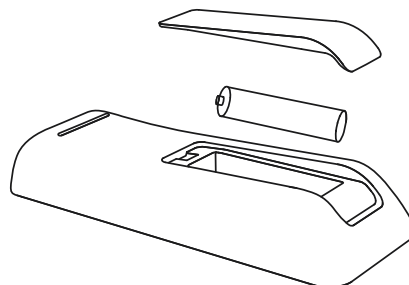

3. Connect the sound bar power cord to an AC outlet

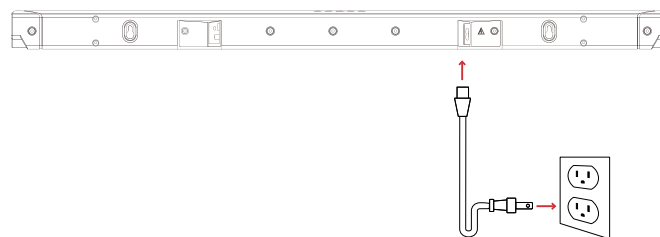

4. Position subwoofer and connect to an AC outlet (for best performance place on the same wall as the TV)

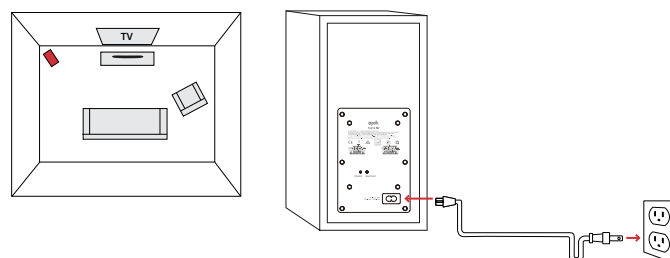

NOTE: The Signa S2 sound bar and wireless subwoofer are preset at the factory to work together. Should your wireless subwoofer stop receiving an audio signal, follow these instructions to re-establish the connection:

1. Turn on your sound bar.
2. Press and hold the BAR SYNC button on the back of the subwoofer for 3 seconds.
3. Simultaneously press and hold *Bluetooth* and VOL + buttons on the sound bar for 5 seconds.

The sound bar will search for a connection while the first and second LEDs on the sound bar will flash intermittently. The lights will stop flashing when the sound bar and subwoofer connect. If the sound bar and subwoofer fail to connect, the first and second LEDs will flash together 5 times. Repeat steps above to establish a connection.

5. Turn on your sound bar
Press the Power button  on the sound bar or remote.

NOTE: Make sure TV internal speakers are off

Remote Control

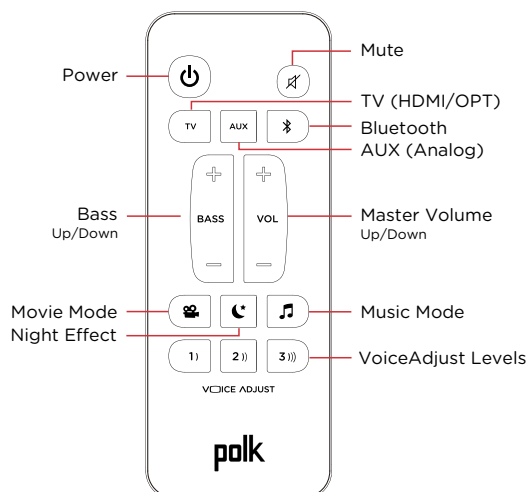

Sound Bar Top Panel

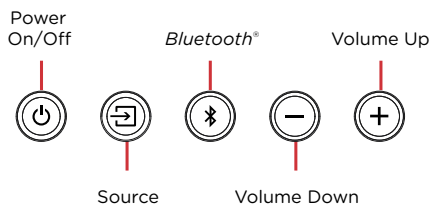

Sound Bar Back Panel

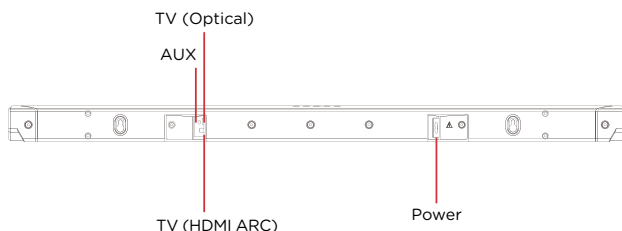

Sound Bar LEDs

The Signa S2 has a **horizontal** row of LED lights that provide status indications, like source, volume and listening modes.

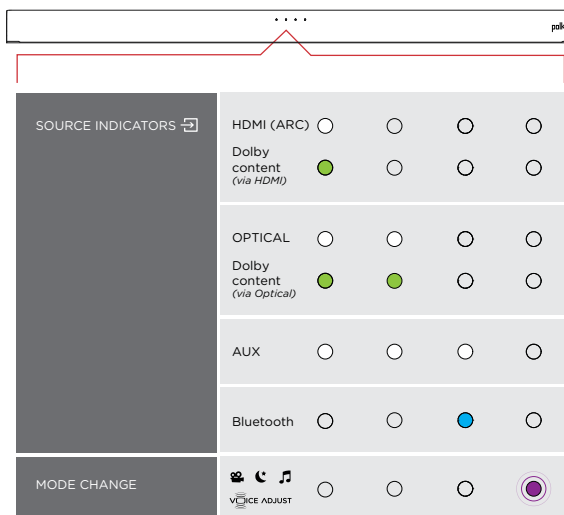

Optimizing Your Listening Experience

Bass Control

Control Bass Volume Levels

Easily adjust bass volume for more or less impact.



Movie Mode

Enhances audio reproduction in TV and movies.



Music Mode

Enhances audio whenever you're listening to music, or watching TV or movies that have music playing in them.



Night Effect

Reduces bass and volume dynamics while improving voice intelligibility for low-volume listening.

VOICE ADJUST™

Control Dialogue Volume Levels

Isolate and adjust the voice channel level to reproduce clear, crisp dialogue.

Music Listening

How to Set Up Bluetooth

1. To enable *Bluetooth*, press the *Bluetooth* button on the sound bar or remote control. A blue LED will pulse on the sound bar.



2. Go to the *Bluetooth* devices section on your phone, tablet or computer and select Polk Signa S2. The LED is solid blue when *Bluetooth* is connected.

NOTE: To take control when another device is connected, press *Bluetooth* button.

How to hear your TV again: When you are finished using *Bluetooth*, press the source button on the sound bar or remote (TV, AUX).

Auto Standby

When there is no input signal and operation for 15 minutes, this unit automatically enters the standby mode.

Bluetooth standby

When Bluetooth connection is made from a registered Bluetooth device, this unit turns on automatically.

1. Press and hold the [TV] button for approximately 5 seconds. (The default setting is "Off").

Specifications

Sound bar

Power supply: AC 100 - 230 V, 50/60Hz
Operating temperature: 5°C - 35°C
Power consumption: 40 W
Power consumption in standby mode: 0.3 W
Power consumption in Bluetooth standby: 1.6 W

Subwoofer

Power supply: AC 100 - 230 V, 50/60Hz
Operating temperature: 5°C - 35°C
Power consumption: 40 W
Power consumption in standby mode: 0.26 W
Power consumption in Bluetooth standby: 1.1 W



Manufactured under license from Dolby Laboratories. Dolby, Dolby Audio and the double-D symbol are trademarks of Dolby Laboratories.



The terms HDMI, HDMI High-Definition Multimedia Interface, and the HDMI Logo are trademarks or registered trademarks of HDMI Licensing Administrator, Inc.



The Bluetooth® word mark and logos are registered trademarks owned by the Bluetooth SIG, Inc. and any use of such marks by Polk Audio is under license. Other trademarks and trade names are those of their respective owners.



1 Viper Way
Vista, CA 92081
800 377 7655
www.polkaudio.com

SU100001