

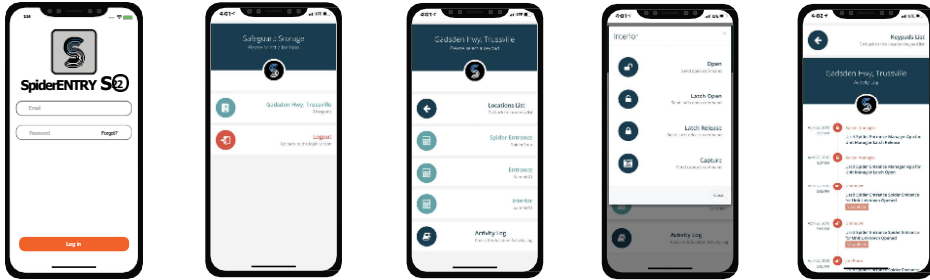

Owners / Managers
Search app stores and download the
"SpiderEntry Management App."

You will be able to control your gate access
remotely with ease, using our free managers
app.



Owner/Manager Steps

Download Managers App! You will need login credentials, which will be provided to you by a Spiderdoor team member. Search App stores on your mobile device for the Spiderentry Managers App. Download the app and this will allow managers to access their gates from anywhere. Lastly, You can also login on your desktop at

https://app.spiderdoor.com/new_admin

This will allow you to view activity log, photos of tenants, (on certain keypad models) and open or latch open your gate, all from the Spiderdoor dashboard.

ATTENTION - No Exceptions

You must contact our office 24 hours in advance of install in order to successfully tie your access control into your management software. If you do not contact us 24 hours in advance, your system will not be fully operational for 24 hours from the time you notify us of the install. Email us at Support@Spiderdoor.com

**Tech support for installations is only available:
Monday through Friday from 9am - 4pm EST.
No weekend tech support available**



SpiderENTRY (619) 489-6959

INSTALL GUIDE

S23

1

Unpack the box and make sure you have all items
shown below.



SpiderENTRY Keypad

TTTT
OOOO
Nuts & Bolts



2 sets of Key



PowerAdapter
12-24 volts DC

2

Unlock and open the front door to install and wire properly. Door
will swing forward.

Closed
position



Open
position

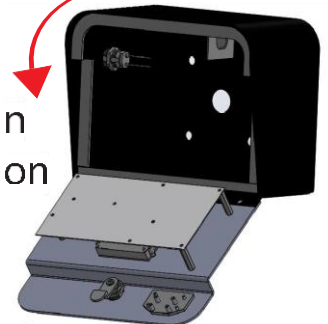

Mount the box to the pedestal using the four holes
in the back of the box. 4 bolts and 4 nuts are provided.
Be sure to pull the CAT5 wire through the open hole in the
middle of the box.

WARNING

AUTOMATIC GATE CAN CAUSE SERIOUS INJURY OR DEATH!

ALWAYS CHECK THAT THE GATE PATH IS CLEAR PRIOR TO OPENING!
SAFETY REVERSING DEVICES SHOULD ALWAYS BE USED!

- 3 The relay wire coming from your gate motor should tie into the green relay input labeled "GATE" (seen in illustration below). This wire tells your gate to open when a good code is punched in.

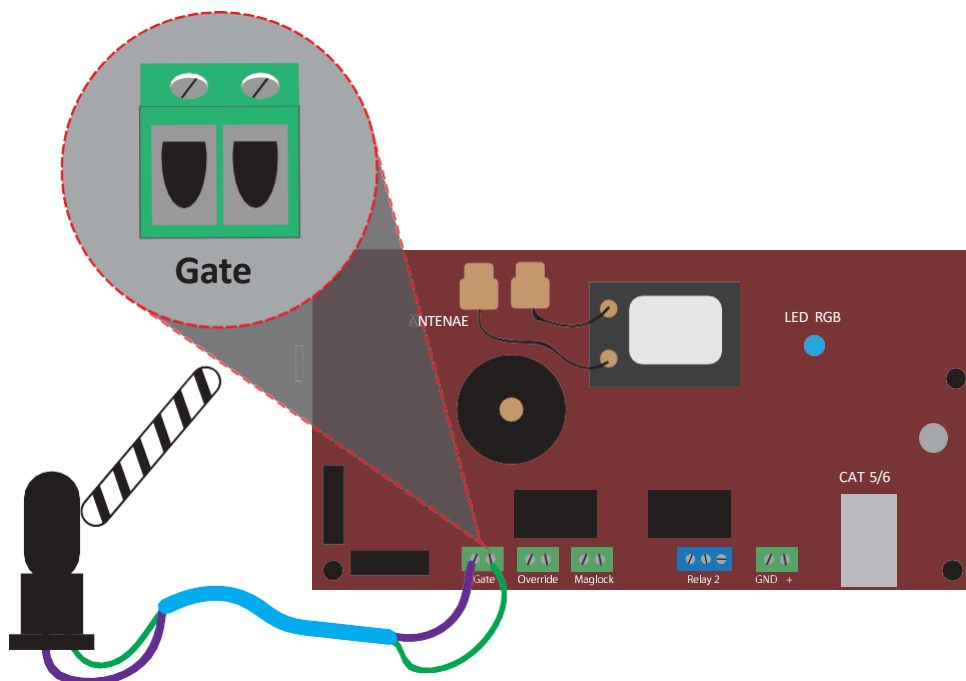

- 4 The power should connect into the green input labeled GND / V+. This should be ran to the supplied adapter for the proper amount of power. Note that the keypad can only handle between 12v - 24v and nothing below or above. Warranty does not cover a damaged pad due to improper power installation.

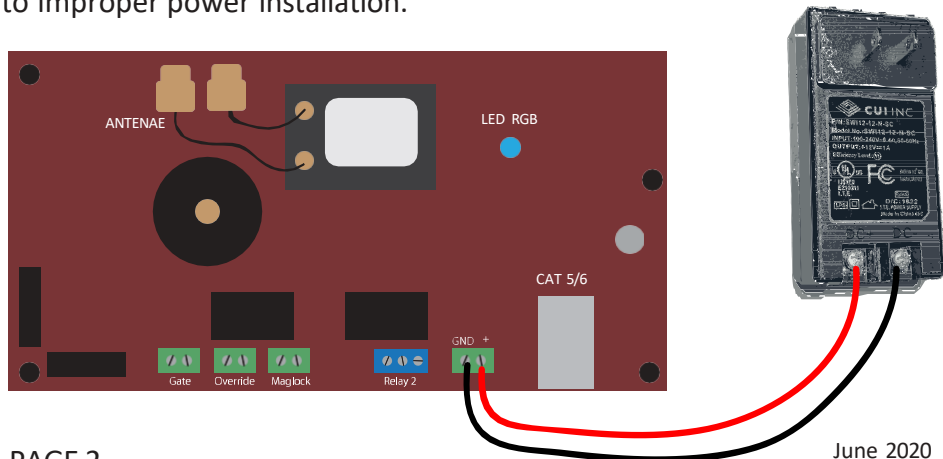

- 5 This key on the side is an over ride for the managers. The manager/owner can then walk up to keypad and give it a half turn clockwise and the relay will prompt the gate to physically open. This over rides the keypad itself and simply makes continuity to tell the gate motor to open the gate and stay open. It will stay open until you turn the key a half turn counterclockwise. **NOTE: If you have this key turned a half turn clockwise during an install, this will cause your gate to stay in the open position.**



Managers Override Key

This switch will allow a manager to open the gate with a key.

- 6 If using a Magnetic lock for a walk through door, you will want to use the green input labeled Mag Lock (N/C and common.) This will go to the mag lock on your door. You will plug it in to the normally closed and common port on the mag lock.

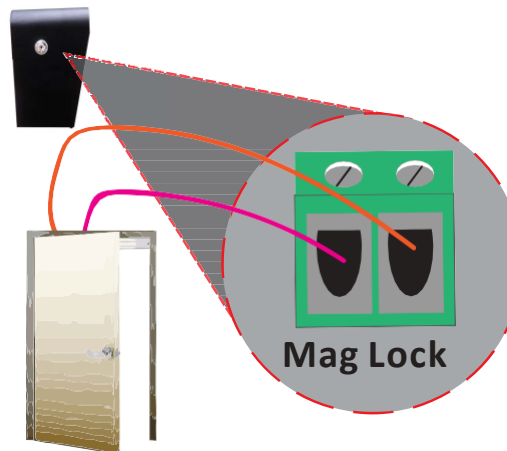

Keypad Sounds

ACTIVE CODE

A solid 4 second buzz means the gate code entered is a good code..

INACTIVE CODE

Three short beeps signifies that a code is INACTIVE or no good.

REQUIRED: Go to www.Spiderdoor.com to "Request Install" 24 hours in advance or email Support@Spiderdoor.com

Supplier's Declaration of Conformity 47 CFR § 2.1077 Compliance Information

Product Name: Access Control Keypad

Product Model: S23, S33

Manufacturer:

Spiderdoor

2284 Brock Circle

Birmingham, Alabama 35242

xxx@spiderdoor.com

www.spiderdoor.com

Modular Components Used:

NAME: nRF91

MODEL: nrRF9160

FCC ID: 2ANPO00NRF9160

This device complies with part 15 of the FCC Rules.

Operation is subject to the following two conditions:

(1) This device may not cause harmful interference, and (2) this device must accept any interference received, including interference that may cause undesired operation.

FCC Compliance Statement

This device complies with part 15 of the FCC Rules. Operation is subject to the following two conditions:

(1) this device may not cause harmful interference, and (2) this device must accept any interference received, including interference that may cause undesired operation.

CAUTION: The grantee is not responsible for any changes or modifications not expressly approved by the party responsible for compliance. Such modifications could void the user's authority to operate the equipment.

NOTE: This equipment has been tested and found to comply with the limits for a Class B digital device, pursuant to part 15 of the FCC Rules. These limits are designed to provide reasonable protection against harmful interference in a residential installation. This equipment generates, uses, and can radiate radio frequency energy, and if not installed and used in accordance with the instructions, may cause harmful interference to radio communications. However, there is no guarantee that interference will not occur in a particular installation. If this equipment does cause harmful interference to radio or television reception, which can be determined by turning the equipment off and on, the user is encouraged to try to correct the interference by one or more of the following measures:

- Reorient or relocate the receiving antenna.
- Increase the separation between the equipment and receiver.
- Connect the equipment into an outlet on a circuit different from that to which the receiver is connected.
- Consult the dealer or an experienced radio/TV technician for help.

RF exposure statement

This equipment complies with the FCC RF radiation exposure limits set forth for an uncontrolled environment. This equipment should be installed and operated with a minimum distance of 30cm between the radiator and any part of your body.

Canadian Compliance Statement

This device contains license-exempt transmitter(s)/receiver(s) that comply with Innovation, Science and Economic Development Canada license-exempt RSS(s). Operation is subject to the following two conditions:

- (1) This device may not cause interference.
(2) This device must accept any interference, including interference that may cause undesired operation of the device.

L'émetteur/récepteur exempt de licence contenu dans le présent appareil est conforme aux CNR d'Innovation, Sciences et Développement économique Canada applicables aux appareils radio exempts de licence. L'exploitation est autorisée aux deux conditions suivantes :
L'appareil ne doit pas produire de brouillage;
L'appareil doit accepter tout brouillage radioélectrique subi, même si le brouillage est susceptible d'en compromettre le fonctionnement.

RF exposure statement

This equipment meets the exemption from the routine evaluation limits in section 6 of RSS-102. It should be installed and operated with a minimum distance of 30cm between the radiator and any part of your body.
Cet équipement est conforme à l'exemption des limites d'évaluation habituelle de la section 6 de la norme RSS-102. Il doit être installé et utilisé à une distance minimale de 30 cm entre le radiateur et toute partie de votre corps.