

TECHNICAL SPECIFICATIONS

General Parameters

Weight	21.8 lbs
Dimensions	10.4*10.0*6.7in
Operating Temperature	During charging: 32~104 °F During discharge: 14~104 °F
Optimal Operating Temperature	32~95 °F
Detection and Certification	UN38.3+MSDS, FCC, RoHS, UL Compliant

Input

ATXC 13 Port (for AC charging)	Port 450W, 100~130V
XT 60 Port (for solar, wall, and car charging)	Port 120W, up to 30V

Output

AC Outlets (x2)	AC 120V / 60Hz pure sine wave	Actual power 1000W, Peak power 1050W
Fast-Charge USB Ports (x2)	Each port 24W, up to 12V	Fast-Charge USB-C Ports (x2)
DC5521 Ports (x2)	Each port 60W, up to 12V	
Battery Type	Lithium-ion NCA	
Battery Capacity	48 Ah	
Battery Power	1037 Wh	
Cycle Life	After 1000+ cycles, the battery capacity will decrease to 80%	
Shelf Life	Can be stored for 6 months when fully charged	

HOW TO CHARGE

500W ATX Cable (Included)



Required Time <2.5 hours
Charging 90% with one port

100W Car Charging Cable (Included)



Required Time <11 hours
Charging 90% with one port

100W Solar Panel (Optional)



Required Time <11 hours
Charging 90% with one port
(Varies with weather conditions)

How to Charge?

There are two intelligent input ports at the back of the device. The device can be charged via a charging cable, a car charging cable, or a solar charger. In addition, you can also connect two solar chargers and connect one of them to the XT60 port of the device.

Can the device be powered while charging?

Yes.

FAQs

How to Maintain?

To prolong its cycle life, it's recommended to keep the battery level above 30% and store it in a dry and cool place. Keep away from fire sources, avoid prolonged sun exposure, and do not allow it to get wet.

How to Use Safely?

The safe operating temperature range is 32~104 degrees Fahrenheit. Please use it within the safe temperature range. If the working temperature range is exceeded during use, it may cause the device to exceed its safe and effective working limits. Do not immerse the device in water. Handle the device gently, do not throw it around.

PACKAGING LIST



Portable Power Station x 1

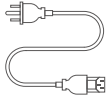

ATX C13 Cable x 1

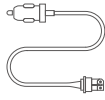

Car Charger x 1



Instruction Manual x 1

ALLLIKE



SN-1000 Product User Manual



1. Please keep dry and away from fire;
2. Please do not disassemble, puncture or strongly impact the product;
3. Please recycle and dispose the product in accordance with local laws;
4. The intended use of this device is Floor-standing.

IMPORTANT SAFETY INFORMATION

⚠ WARNING: Always observe the following basic precautions when using the product:

- Please read the manual before using the product;
- To reduce the risk of injury, be cautious of surrounding children when using the product;
- Do not place fingers, hands, or any part of your body inside the product;
- Using accessories not recommended or products from third-party power suppliers may pose risks of fire, electric shock, or personal injury;
- Do not use damaged or modified batteries or devices;
- Do not use the portable power station with damaged wires, plugs, or output lines;
- Do not attempt to disassemble the portable power station yourself when maintenance or repair is needed. Please hand over the portable power station to a qualified service provider. Incorrect disassembly methods may lead to risks of fire or electric shock;
- To reduce the risk of electric shock, unplug the portable power station from the socket before conducting any guided repair operations;
- Charge the internal battery in a well-ventilated area. Do not obstruct air circulation;
- Under adverse conditions, liquid may be sprayed from the battery. Avoid contact with the battery and the liquid. If accidentally contacted, rinse with clean water. If the liquid comes into contact with your eyes, seek medical help immediately;
- Do not expose the product to fire or overly hot environments;
- Repairs should only be done by a qualified service person.

Please keep the safety instructions in a safe place.

SAFETY GUIDELINES

To turn the device on or off, you need to hold the power button for a long time. To activate the AC power socket, you need to press the AC power button briefly while the device is on. To turn on the light, you need to briefly press the light button when the device is on. This is a deliberate design decision on our part, intended to conserve battery power and preserve energy for future needs.

FEATURE INTRODUCTION

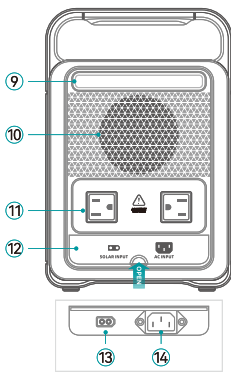
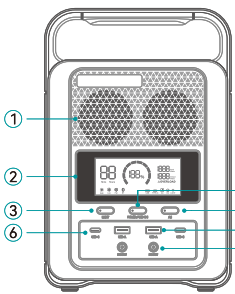

- 1 Air Inlet
- 2 LCD Display
- 3 Light Button (Press briefly to turn on or off) Light Indicator
- 4 Main Power and DC Power Button (Press for a long time or briefly to turn on or off) DC Output Indicator
- 5 AC Power Button (Press briefly to turn on or off) AC Output Indicator
- 6 USB-C PD Output Port
- 7 Fast-Charge USB Output Port
- 8 DC 5521 Output Port
- 9 LED Lighting
- 10 Air Outlet
- 11 AC Output Port
- 12 Input Interface Cover
- 13 Solar Input Port
- 14 AC Input Port

1. LCD DISPLAY

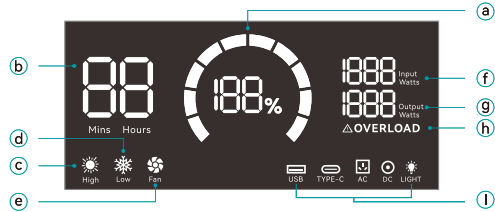

- **Battery Indicator** — Displays the remaining battery percentage;
- **Remaining Charging Time** — Estimates the remaining charging time based on the current power usage, accurate to the minute;
- **High-Temperature Indicator** — Warns when the battery temperature is too high. All input and output functions stop, and the fan starts. It will automatically resume operation once the battery cools down;
- **Low-Temperature Indicator** — Warns when the battery temperature is too low. All input and output functions will stop. Move the device to a warmer location, and it will automatically resume operation;
- **Fan Indicator** — The cooling fan automatically turns on when the device temperature is too high;
- **Current Input** — Displays the current power input level in watts;
- **Current Output** — Displays the current power output level in watts;
- **Overload Warning** — When the power output from the AC socket exceeds the maximum AC power output value, the overload indicator will light up, and the AC indicator will flash simultaneously, then AC output will automatically turn off immediately, finally the warning sign will extinguish once the user presses the AC power button. Other ports are not affected by the overload warning and continue to work;
- **Port Usage Indicator** — Indicates whether each port is in use or not.

2. Fast-Charge USB Output Port

Use these ports to quickly charge your devices. The USB output indicator light will automatically light up when the USB ports are available. If your device does not support fast charging, it will charge at a normal speed.

3. USB-C PD Output Port

Use USB-C to charge devices with TYPE-C ports. When the USB-C port is in use, the USB-C output indicator light will automatically light up.

4. DC5521 Power Output Port

Use DC5521 to charge your devices. When the DC5521 port is available, the DC5521 output indicator light will automatically light up.

5. Main Power and DC Power Button (Long press or short press to turn on or off)

Long press to turn the device on or off. After turning on, the LCD screen will light up. Short press to control the DC output on the front panel. If no output port is in use, the screen will enter sleep mode after 30 seconds of inactivity, but the battery will still operate. After a period of inactivity, it will automatically turn off to protect battery health.

6. AC Power Button (Press briefly to turn on or off)

The AC Power Button controls the AC output. To enable the AC power, briefly press the AC power button. Be sure to unplug the power cord from the AC port and briefly press the AC power button to turn off the AC power when you're not using the AC power to charge your device. The AC indicator light will illuminate when the AC power is enabled.

7. Light Button (Press briefly to turn on or off)

The light button controls the light's illumination and mode switching. The modes switch in the following sequence: low brightness -> half brightness -> high brightness -> SOS -> flashing -> light off.

8. AC Outlets

Charge devices that require an AC voltage of 120 volts.

9. Ventilation Holes

The cooling holes help prevent overheating. If the temperature exceeds the optimal range, the fan will automatically start.