

PRIME BREW

NS01PB

Portable
coffee
machine

Please read all instructions carefully
and retain for future use.

USER MANUAL



nomious™



Scan the QR code for a video instruction of how to brew coffee with Nomious PRIME BREW

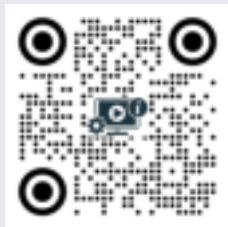

Scan the QR to download or read the user manual

Introducing the Nomious Prime Brew - Portable Coffee Machine. Your perfect companion for a fresh brew, anytime, anywhere. This innovative device is designed to deliver a hot cup of coffee with just a touch of a button.

With Nomious, you can enjoy a hot cup of coffee by simply adding water and your favorite grounds or capsules, giving you the flexibility to choose your preferred type of coffee.

nomious™

INDEX

1	General Safety Information	3
2	Battery Warning	7
3	Product Components	8
4	Product Parameters	10
5	Charging	11
6	Button Guide	12
7	How to Brew with Prime Brew	13
8	Troubleshooting	18
9	Cleaning & Descaling	23
10	Storage	24
11	Declarations/Notices	24

GENERAL SAFETY INFORMATION

- Always keep the product out of reach from children! The packaging materials and accessories can contain small parts that may cause choking if ingested.
- Appliances can be used by persons with reduced physical, sensory or mental capabilities or lack of experience and knowledge if they have been given supervision or instruction concerning use of the appliance in a safe way and they understand the hazards involved.
- This appliance can be used by children aged from 8 years and above if they have been given supervision or instruction concerning use of the appliance in safe way and if they understand the hazards involved. Cleaning and user maintenance shall not be made by children unless they are older than 8 and supervised. Keep the appliance out of reach of children aged less than 8 years.
- Children shall not play with the appliance.
- Cleaning and user maintenance shall not be made by children without supervision.
- Do not hand over the product to another user who did not read the manual before usage.
- Be aware that surfaces can become hot during operation. Avoid touching hot surfaces.
- Use the coffee maker according to this instruction, any misuse may cause electric shock or other hazards.

- Be aware that hot coffee will flow out of the outlet. Avoid placing your hand or other body parts under the outlet during operation.
- Use the right cup size that fits properly under the coffee outlet to prevent spills and burns.
- Allow the coffee to cool down before drinking to avoid burns. Take small sips to test the temperature of the coffee before drinking normally.
- Never turn on the product without water in the tank.
- Place the product on a stable, level surface to prevent it from tipping over.
- Do not place the product under direct sunlight or near heat sources.
- Never leave the product unattended while it's operating.
- Ensure no foreign objects are inside the water tank and coffee container before operation.
- Do not hold, move or shake during operation. Do not open the water tank lid while operation and make sure it is cooled down when you open the water tank lid or the locking chamber.
- Use clean, filtered water for brewing to prevent mineral build-up.
- Do not fill the water tank above the maximum level indicated to prevent overflow.
- Use the right size of coffee ground as recommended in the manual to prevent clogging.
- Ensure the product is well ventilated during operation and not covered.

- Keep the product away from flammable materials during operation.
- Always use original parts and accessories intended for use with the product.
- Never try to dismantle the product or accessories yourself, and do not replace components (unless applicable) or push objects into the product. Only authorized dealers or service centers may open the products.
- Never try to put unnecessary tension or strain on the USB cable, including rolling the cable around human bodies, pets or around the body of the product, as this could lead to damages of the product.
- Please be cautious to keep all products, cables and other accessories in a safe operating environment and avoid exposing your product to rain, moisture or other liquids (if not designed for this use).
- If the product overheats, has been dropped and damaged, has damaged cables, or has been dropped in a liquid, then discontinue its use and contact Nomious.
- Observe all signs and instructions that require an electrical device to be switched off in designated areas such as hospitals or aircrafts.
- Use caution when you are engaging in activities that requires your full attention e.g. traffic.

- Use only a suitable USB cable which is in good condition, and charge/power the product according to the instructions.
- Only use the provided USB cable for charging. Using a different cable may result in damage or fire.
- Do not leave the product plugged in and charging for an extended period of time beyond the required charging time.
- Avoid charging it in high temperature environments.
For maintenance, unplug the charger/power, make sure it is turned off and cool down product before cleaning. Do not use abrasive cleaners which could damage the finish. Clean the product by wiping with dry or slightly damp cloth. Do not add the product or other accessories into a dishwashing machine.
- The USB cable and port may only be dry-dusted.
- Dispose of the product according to local standards and regulations.
- This appliance is intended to be used in household and similar applications such as:
 - kitchens
 - offices and other working environments;
 - hotels and motels
- The appliance must not be immersed.

- Be careful, the heating element surface is subject to residual heat after use.
- Make sure all parts are clean before starting the brewing process (read more about cleaning). Cleaning and user maintenance shall not be made by children without supervision.
- Avoid using the product at high altitudes due to the lower boiling point of water, which increases the risk of accidents or damage.

Please observe the following.

Remember, safety first! Enjoy your coffee.

BATTERY WARNING!

- “Caution” – The battery used in this product may present risk of fire or chemical burn if mistreated. Batteries may explode if damaged.
- Dispose the product with batteries according to local regulations. Please recycle when possible. Do not dispose as household waste or in a fire as the batteries may explode.
- Never try to dismantle the product to replace the batteries.

PRODUCT COMPONENTS

- 1 Lid
- 2 Main Body
- 3 Water Tank
- 4 Button & Light Indicator
- 5 Capsule Basket
- 6 Coffee Powder Basket
- 7 Locking Chamber
- 8 Cup
- 9 Type-C USB Cable
- 10 Spoon
- 11 Brush

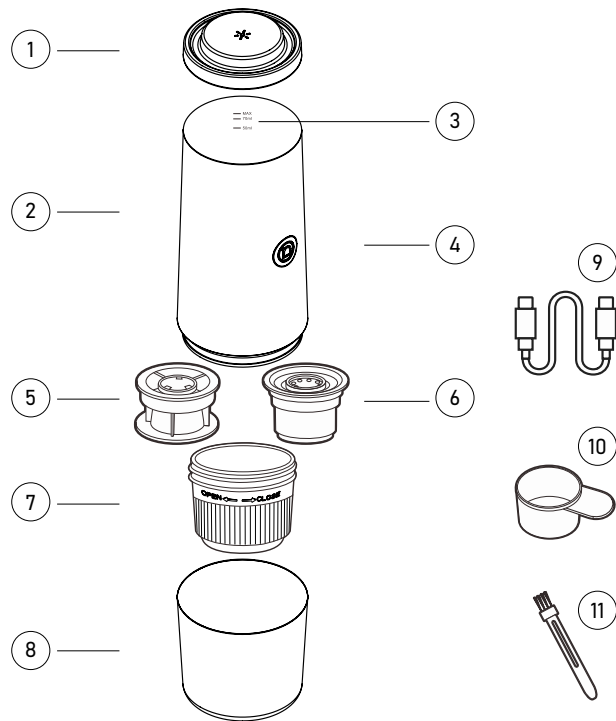

PRODUCT PARAMETERS

PORTABLE COFFEE MACHINE					
Model Name:		Prime Brew			
Version:		NS01PB			
Coffee Input:		Powder or Capsules (compatible with Nespresso®** or similar types of capsules)			
Brewing method:		Hot or Cold brewing			
Water Tank Material:		Food Grade Stainless Steel			
Water Tank Capacity:		80ml	Extraction Pressure:		20bar
Power:	90W	Input:	5V === 3A	Battery:	7500mAh
Water Heating:		Built-in water heating technology			
Extract temperature:		92°C / 197.6°F (Approx 3 min to heat up 50ml water)			
Product Weight:		650g (without coffee baskets)			

CHARGING

- Use a 5V/3A wall charger for the fastest charging result. A 5V/2A wall charger is also compatible.
- Use the type-C cable provided with the machine for charging.
- When the machine is fully charged all LED lights turns on and turns off after 1 minute.
- Do not operate the machine while charging.
- Using a low-quality charging adapter or USB cable may extend charging time and potentially damage the machine.



0% Battery



20% Battery



40% Battery



60% Battery



80% Battery



100% Battery

BUTTON GUIDE

Single Press

1. Press the button once while in standby mode to display the battery level.
2. When operating, press the button once to stop brewing process.

Double Press

Press the button twice to initiate the heating process. The LED light will rotate clockwise. Once the water temperature reaches 92°C (197.6°F), all the lights will illuminate, and the rotation will cease.

Long Press

Press and hold the button for 3 seconds to begin the extraction process. The LED light will be flashing during this process.

HOW TO BREW COFFEE WITH PRIME BREW

1 Check Battery

- Press the button once.
- If the battery is low, charge the machine with the USB cable before starting.

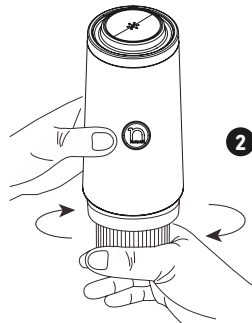
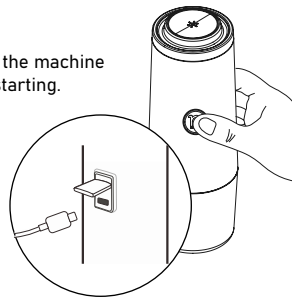

2 Prepare the Machine

- Remove the cup.
- Unscrew the chamber.
- If you used the machine recently, wait 5 minutes before brewing your next cup, to avoid burns from hot parts or water.

HOW TO BREW COFFEE WITH COFFEE POWDER

1

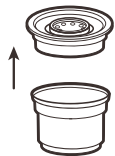

Open the powder basket lid.

2

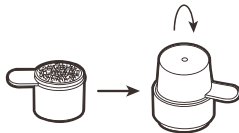

Scoop one full spoon (about 6g) of coffee powder and pour it into the basket.

3

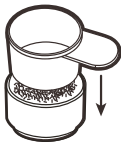

Press the powder gently with the spoon.

4



Put back on the lid and position the basket, lid facing up, into the chamber.

5

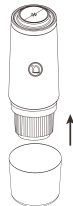

- Screw the chamber back onto the main body tightly.
- Attach the cup back onto the machine

6

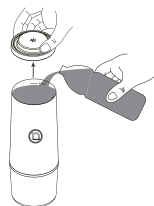

- Unscrew the water tank lid. Fill up with water, do not exceed the 80ml maximum line.

7

Brew Coffee

- Cold Brew: Press and hold the button for 3 seconds to start extracting.
- Hot brew by adding hot water: Press and hold the button for 3 seconds to start extracting.
- Hot brew by adding cold / room temperature water: Press the button twice to initiate the heating process. The LED light will rotate clockwise. Once the water temperature reaches 92°C/197.6°F, all the lights will illuminate, and the rotation will cease. Then press and hold the button for 3 seconds to start extracting.

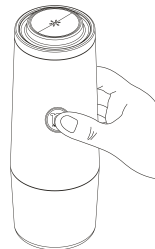

8

Stop Brewing

Press the button once to stop.

HOW TO BREW COFFEE WITH COFFEE CAPSULES

1

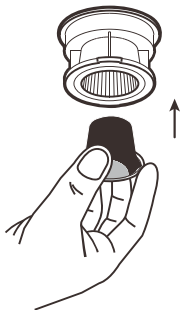

Place the capsule in the basket and press it down to the bottom. Rotate the image for point one.

2



Place the basket into the chamber with the capsule aluminum surface facing down.

3



- Screw the chamber back onto the main body tightly.
- Attach the cup back onto the machine

4

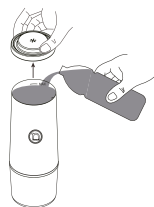

- Unscrew the water tank lid. Fill up with water, do not exceed the 80ml maximum line.

5

Brew Coffee

- Cold Brew: Press and hold the button for 3 seconds to start extracting.
- Hot brew by adding hot water: Press and hold the button for 3 seconds to start extracting.
- Hot brew by adding cold / room temperature water: Press the button twice to initiate the heating process. The LED light will rotate clockwise. Once the water temperature reaches 92°C/197.6°F, all the lights will illuminate, and the rotation will cease. Then press and hold the button for 3 seconds to start extracting.

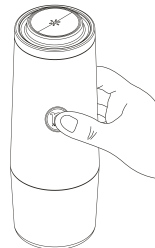

6

Stop Brewing

Press the button once to stop.

Extraction Failure (coffee not coming out)

Possible Cause	Recommended Solution
Too fine coffee powder	Do not use extra fine coffee grind (flower consistency) smaller than 0.2mm, as it may block water flow. Use espresso grind typically ranges from 0.35mm to 0.2mm (powdered sugar consistency).
Too much coffee in the basket	Reduce the amount of coffee. It's recommended to use no more than one scoop (6g) measured with the provided spoon.
Too compressed coffee powder in the basket	Press the coffee powder gently with the spoon bottom so the basket is about 80% full.
Internal air pressure	<p>Method 1:</p> <ol style="list-style-type: none"> 1. Empty the water tank. 2. Turn the machine upside down. 3. Add cold water into the water outlet. 4. Press and hold the button 3 seconds to release the air pressure and water. <p>Method 2:</p> <ol style="list-style-type: none"> 1. Add cold water to the water tank. 2. Press the water outlet several times to release the air pressure. 3. Press and hold the button 3 seconds to extract the water.

Poor Coffee Crema Result

Brewing Method	Possible Cause	Recommended Solution
Coffee Powder	Too low dose of coffee powder in the basket	It's recommended to use one scoop (6g) measured with the provided spoon to get a rich Coffee Crema.
	Too coarse coffee powder	Use a finer grind. Recommended to use espresso grind typically ranges from 0.35mm to 0.2mm (powdered sugar consistency) for the richest Coffee Crema result.
	Multiuse of coffee powder	Use a new dose of coffee powder for every brew.
	Expired coffee powder	Use fresh coffee powder or freshly ground roasted beans that are not expired or moistened.

Poor Coffee Crema Result

Brewing Method	Possible Cause	Recommended Solution
Coffee Capsules	Wrong type of capsules	Use capsules which contain the right type of coffee. For richest coffee crema results use espresso capsules.
	Wrong installation	Press the capsule in the basket and press it down to the bottom. Make sure you screw the chamber tightly.
	Multiuse of capsules	Use a new capsule for every brew.
	Expired coffee capsules	Use fresh coffee capsules which is not expired, damaged or punctured.

Water leaking during operation

Brewing Method	Possible Cause	Recommended Solution
Coffee Powder	Wrong installation	Make sure the lid is attached tight to the basket and placed into the chamber with the lid upwards. Make sure the chamber is screwed tightly to the main body.
	Physical damaged parts	Replace the damaged parts.
Coffee Capsules	Wrong installation	Press the capsule in the basket and press it down to the bottom. Ensure that the capsule aluminum surface is facing down. Make sure you screw the chamber to the main body tightly.
	Physical damaged parts	Replace the damaged parts.

Not heating

Light Indication	Possible Cause	Recommended Solution
All lights flashing	Long press on the button starts the extraction process and not heating process.	Press the button twice to initiate the heating process. The LED light will rotate clockwise and the heating process is started.
Light turn on for a short time	Single press on the button shows the battery level and do not start the heating process.	Press the button twice to initiate the heating process. The LED light will rotate clockwise and the heating process is started.

Not charging

Please refer to the "Charging" section for details.

CLEANING & DESCALING**General advice**

1. Do not use detergent to clean the parts and machine externally and internally.
2. Do not clean or dry the parts or machine by using a dishwashing machine.
3. Use a damp cloth or sponge to gently clean the parts and machine.
4. Use a dry cloth to gently dry the parts and machine.
5. Clean the machine and parts after usage and before storing.

Parts Cleaning

1. Do not clean the parts while they are on the main body.
After each coffee brew, clean the basket, lids, chamber and cup by using clean water.

External Cleaning

1. Do not soak the main body under water.
2. Do not hold the main body under flowing water.
3. Make sure the charging port is protected by the rubber cap.

Internal Cleaning

1. Fill the water tank with clean water.
2. Remove the chamber and basket.
3. Press and hold the button 3 seconds to extract the water.
4. Recommended to do internal cleaning before and after brewing coffee.

STORAGE

1. Do not expose the machine to fire, direct sunlight, direct water or high temperatures.
2. Store the machine in a cool and dry place.

DECLARATIONS/NOTICES

This mark on a product and/or accompanying documents indicates that when it is to be disposed of it must be treated as Waste Electrical & Electronic Equipment (WEEE). Any WEEE marked waste products must not be mixed with general household waste, but kept separate for the treatment, recovery and recycling of the materials used. For proper treatment, recovery and recycling; please take all WEEE marked waste to your Local Authority Civic waste site, where it will be accepted free of charge. If all consumers dispose of Waste Electrical & Electronic Equipment correctly, they will be saving valuable resources and preventing potential negative effects upon human health and the environment from hazardous materials that the waste may contain.





INNOVATION IN MOTION

www.nomious.com