

Accessory type and quantity may vary depending on the model.

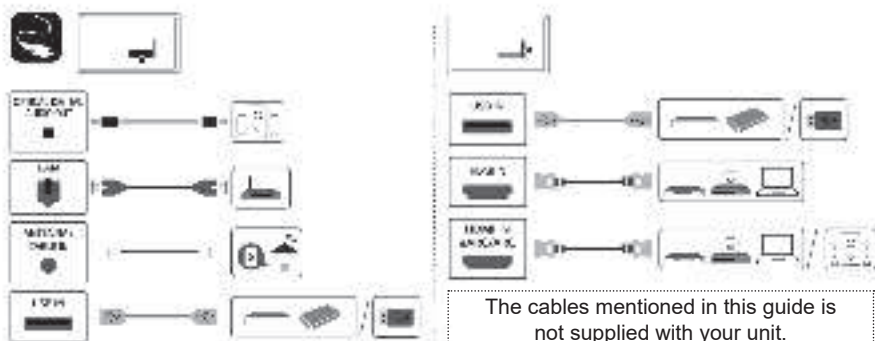

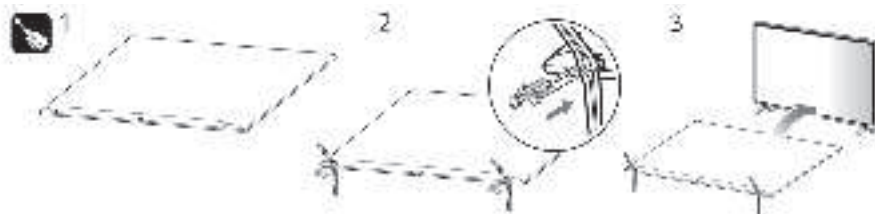

(Batteries not supplied)



The remote control vary depend of model: The buttons on the remote control may have a different name or location than the remote control shows in this manual.



kg (kilogram)  
lb (pound)

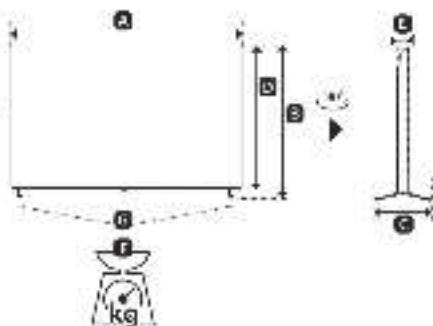

MODELS	A	B	C	D	E	F	F+G	Power
804006809B 804006809A 804006809C 804006809D	1.57" (40.0)	1.57" (40.0)	1.57" (40.0)	1.57" (40.0)	1.57" (40.0)	1.57" (40.0)	1.57" (40.0)	100W
	40.0	40.0	40.0	40.0	40.0	40.0	40.0	

Power requirement:

AC 110V ~ 60/50Hz

The image shown here is for illustrative purposes only and may be subject to change.  
The actual number of ports and their locations may vary depending on the model.

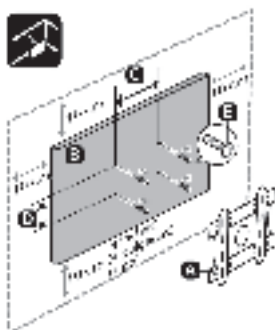

C/D (mm)

A	B	C+D (mm)	E
1500x1170	800x1170 800x1170 800x1170 800x1170	500 (20.0) x 400 (15.7) 500 (20.0) x 400 (15.7)	140



Read Safety and Reference

Easy Setup Guide

Please read this manual carefully before operating your set and retain it for future reference.



: Depending upon model

804006809B



PRINTED IN MEXICO / SC:01-08-2022 1P / Elbrd:J.E.  
OBPN: \*MFL718785232201 REV00\* / SHNMDL:86UQ7070ZUD\_B