

## 2 | Download and Install the AI Monitor iOS App

AI Infrared Monitor System  
All-In-One ULTI-A100

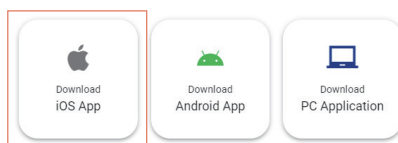
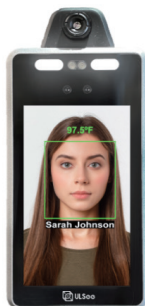

Tap on **Download iOS App**

### 3 | Connect to ULTI-A100 using the ULTI-A100's IP Address

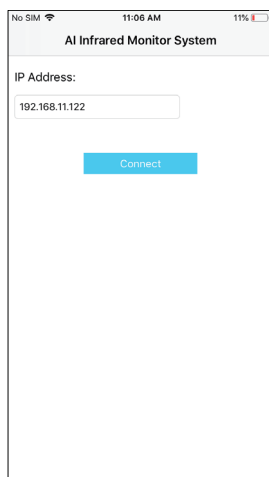

- Enter the ULTI-A100's IP address in the IP Address field. If there is a port number, add it at the end of the URL with a ":" prefix.
- Tap on the **Connect** button

## 4 | Log in with Admin Credentials

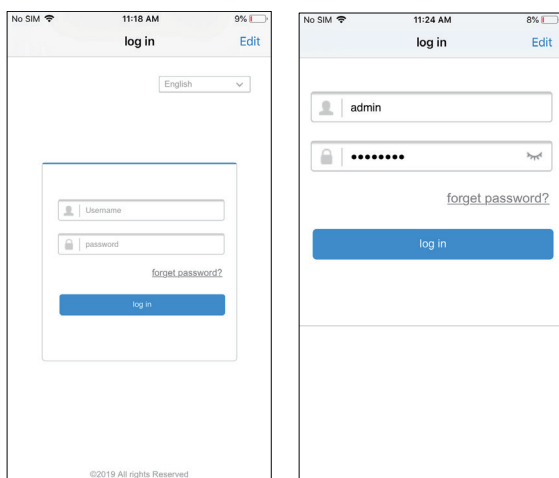

Type in username admin, password admin123 and click on **log in**.

## 5 | Viewing the Live Video Stream of an AI Infrared Monitor ULTI-A100 Unit

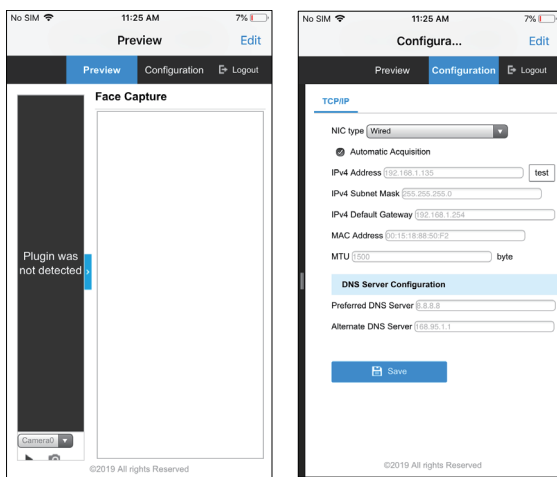

- Tap on **Preview** to view the live video stream from an AI Infrared Monitor ULTI-A100 unit's camera, choose the camera from the drop-down menu from the bottom-left set of controls and tap on the ► button.
- Tap on **Configuration** to switch from the Preview screen to the Configuration screen

## 6 | Revealing the Function Menu

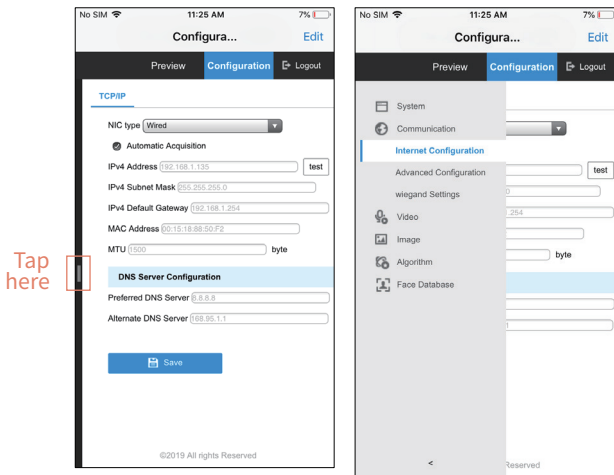

Tap on  to reveal the function menu, because the function menu is hidden by default

## 7 | Hiding the Function Menu

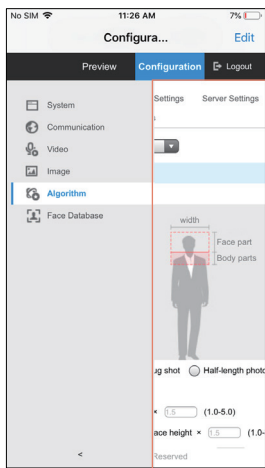

Tap on  
this  
region

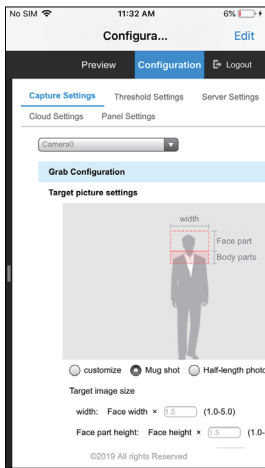

Tap on the right pane to hide the function menu

## 8 | Logging out of the Admin Account

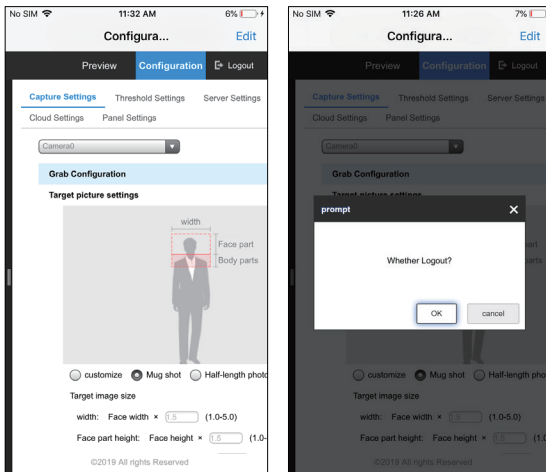

Tap on **Logout** on the upper-right corner to log out of the admin account

## Optional | Changing the IP Address Needed to Connect to ULTI-A100

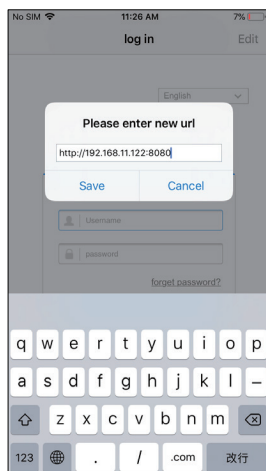
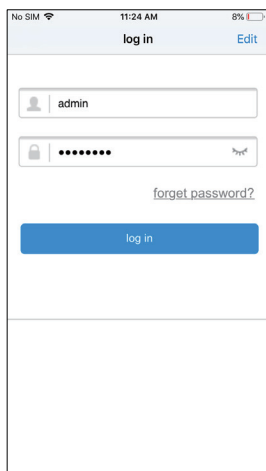

Tap on **Edit** on the upper-right corner to change the IP address needed to connect to the ULTI-A100, if required. If there is a port number, add it at the end of the URL with a ":" prefix.



## **Software Configuration (Android)**

### 1 | Open the All-in-One ULTI-A100 Product Page



Enter URL **<https://tinyurl.com/y6nu4x9w>** into a Web browser's Address field or scan the QR code above, to quickly access the AI Monitor Product Page

## 2 | Download and Install the AI Monitor Android App

AI Infrared Monitor System  
All-In-One ULTI-A100

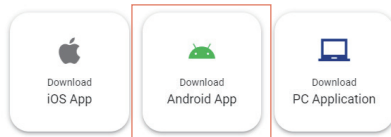
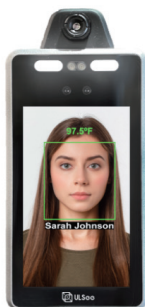

Tap on **Download Android App**

### 3 | Connect to ULTI-A100 using the ULTI-A100's IP Address

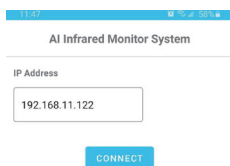

11:57 55%

AI Infrared Monitor System

IP Address

192.168.11.122

CONNECT

- Enter the ULTI-A100's IP address in the IP Address field. If there is a port number, add it at the end of the URL with a ":" prefix.
- Tap on the **Connect** button

## 4 | Log in with Admin Credentials

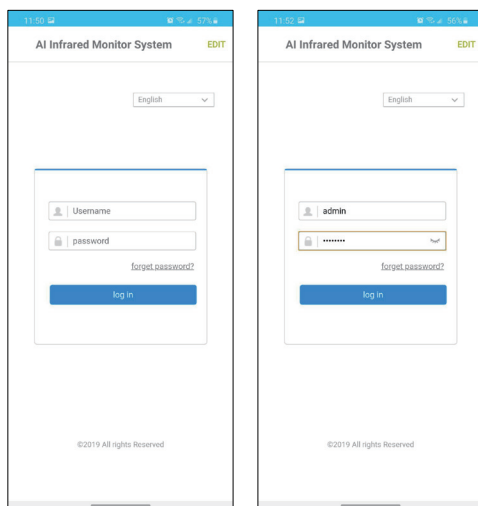

Type in username admin, password admin123 and click on **log in**.

## 5 | Viewing the Live Video Stream of an AI Infrared Monitor ULTI-A100 Unit

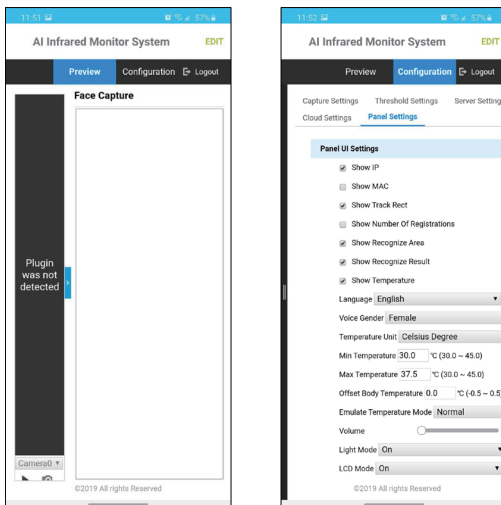

- Tap on **Preview** to view the live video stream from an AI Infrared Monitor ULTI-A100 unit's camera, choose the camera from the drop-down menu from the bottom-left set of controls and tap on the ► button.
- Tap on **Configuration** to switch from the Preview screen to the Configuration screen

## 6 | Revealing the Function Menu

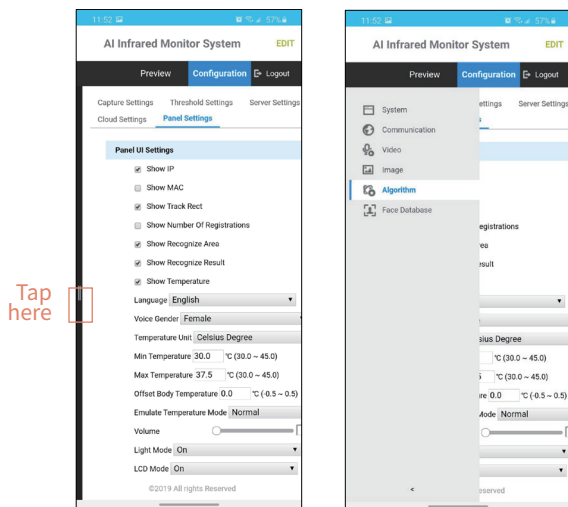

Tap on  to reveal the function menu, because the function menu is hidden by default

## 7 | Hiding the Function Menu

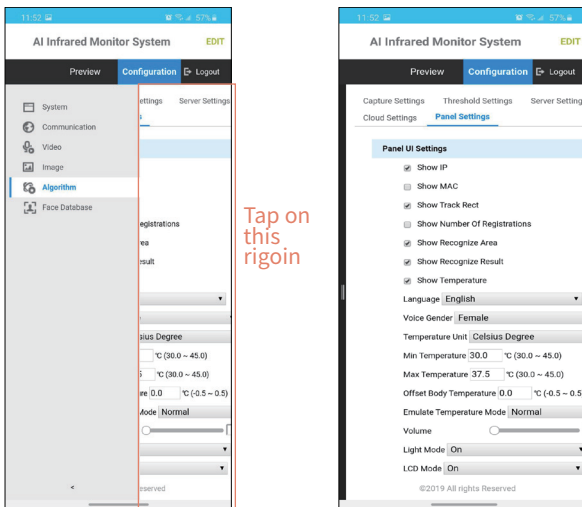

Tap on the right pane to hide the function menu



## 8 | Logging out of the Admin Account

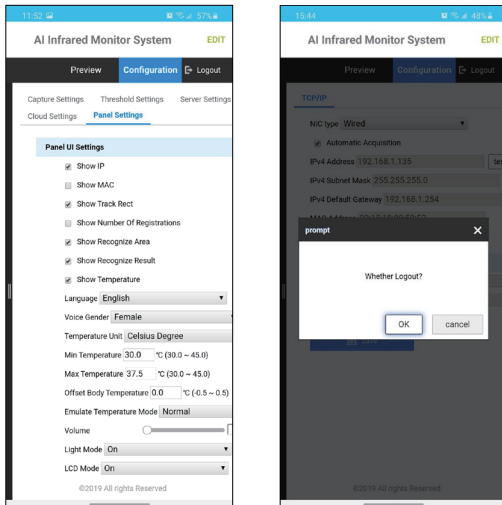

Tap on **Logout** on the upper-right corner to log out of the admin account

## Optional | Changing the IP Address Needed to Connect to ULTI-A100

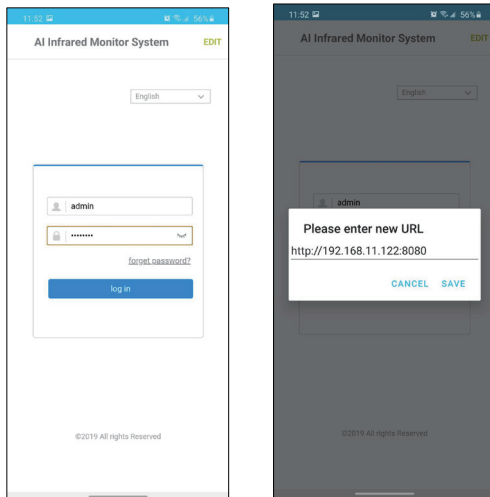

Tap on **Edit** on the upper-right corner to change the IP address needed to connect to the ULTI-A100, if required. If there is a port number, add it at the end of the URL with a ":" prefix.

**The AI Infrared Monitor ULTI-A100 unit  
is now set up and ready for use**

## Notification

This device complies with Part 15 of the FCC Rules. Operation is subject to the following two conditions :

1. this device may not cause harmful interference, and
2. this device must accept any interference received, including interference that may cause undesired operation.

The distance between user and device should be no less than 20cm.

This equipment has been tested and found to comply with the limits for a Class B digital device, pursuant to Part 15 of the FCC Rules. These limits are designed to provide reasonable protection against harmful interference in a residential installation. This equipment generates uses and can radiate radio frequency energy and, if not installed and used in accordance with the instructions, may cause harmful interference to radio communications. However, there is no guarantee that interference will not occur in a particular installation. If this equipment does cause harmful interference to radio or television reception, which can be determined by turning the equipment off and on, the user is encouraged to try to correct the interference by one or more of the following measures:

- Reorient or relocate the receiving antenna.
- Increase the separation between the equipment and receiver.
- Connect the equipment into an outlet on a circuit different from that to which the receiver is connected.
- Consult the dealer or an experienced radio/TV technician for help.

Changes or modifications not expressly approved by the party responsible for compliance could void the user's authority to operate the equipment.







## ULSee Inc.

**Address** | 9F, No.97, JingYe 1st Road, ZhongShan District,  
104451 Taipei City Taiwan

**Telephone** | +886-2-8502-2798

**Website** | <https://ulsee.com/#/>

**E-mail** | [service@ulsee.com](mailto:service@ulsee.com)