

User Manual

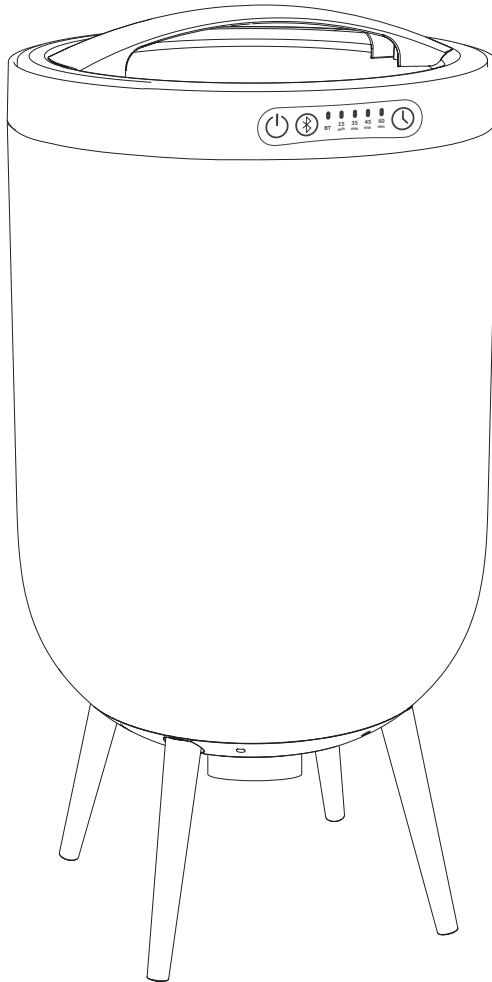

HSTW-17

Luxury Towel Warmer

Contents

Important Safety Instructions	01
FCC Information	02
Location of Part & Controls	03
Product Specifications	04
Using The Towel & BlanketWarmer	04
Function overview	05
Tips for Best Results	06
Care and Maintenance	06

CAUTION

TO REDUCE THE RISK OF SERIOUS INJURY, PLEASE NOTE THAT THIS IS NOT A TOY. DO NOT ALLOW CHILDREN TO OPERATE OR PLAY NEAR THE TOWEL & BLANKET WARMER.

TO REDUCE THE RISK OF FIRE OR ELECTRIC SHOCK, DO NOT EXPOSE THIS UNIT TO RAIN OR MOISTURE

The lightning flash with arrow-head symbol within an equilateral triangle is intended to alert the user to the presence of uninsulated "dangerous voltage" within the unit's enclosure that may be of sufficient magnitude to constitute a risk of electric shock.

The exclamation point within an equilateral triangle is intended to alert the user to the presence of important operating and maintenance (servicing) instructions in the literature accompanying the unit.

Important Safety Instructions

ALL OF THE SAFETY AND OPERATING INSTRUCTIONS SHOULD BE READ, ADHERED TO AND FOLLOWED BEFORE THE UNIT IS OPERATED.

- FOR HOUSEHOLD USE ONLY
- FOR ADULT USE ONLY
- FOR DRY FABRIC ITEMS ONLY

SAVE THESE INSTRUCTIONS.

WARNING

To reduce risk of fire, electric shock, or serious injury to persons when using the appliance, follow basic precautions including the Read all instructions before using the appliance.

- Always unplug the unit from the electrical outlet immediately after using.
- Do not use appliance for anything other than its intended use.
- Do not place or store the unit where it can fall or be pulled into a tub or sink.
- Do not place in or drop into water or other liquid.
- Do not reach for a unit that has fallen into water. Unplug it immediately.
- Care should be taken so that objects do not fall into and/or liquids are not spilled onto the unit.
- This unit should never be left unattended when plugged in.
- Close supervision is necessary when this unit is used near children or disabled persons.

- Use this unit for its intended use as described in this manual.
- Never operate this unit if it has a damaged cord or plug, if it is not working properly, or if it has been dropped, damaged, or dropped in water.
- Keep cords away from heated surfaces. Do not wrap the cord around the exterior of the appliance or let the cord hang over a table or counter edge.
- Do not use outdoors.
- Do not alter the safety plug or use an extension cord with this device.
- Do not operate with a voltage converter.
- Do not touch hot surfaces.
- Do not use accessory attachments not recommended by the manufacturer as this may cause injuries.

FCC Information

CAUTION

Changes or modifications not expressly approved by the party responsible for compliance could void the user's authority to operate the equipment.

This device complies with Part 15 of the FCC Rules. Operation is subject to the following two conditions:

1. This device may not cause harmful interference.
2. This device must accept any interference received including interference that may cause undesired operation.

WARNING: Changes or modifications to this unit not expressly approved by the party responsible for compliance could void the user's authority to operate the equipment. Note: This equipment has been tested and found to comply with the limits for a Class B digital device, pursuant to Part 15 of the FCC Rules. These limits are designed to provide reasonable protection against harmful interference in a residential installation. This unit generates, uses and can radiate radio frequency energy and if not installed and used in accordance with the instructions, may cause harmful interference to radio communications. However, there is no guarantee that interference will not occur in a particular installation. If this equipment does cause harmful interference to radio or television reception, which can be determined by turning the equipment off and on, the user is encouraged to try and correct the interference by one or more of the following measures:

- Reorient or relocate the receiving antenna.
- Increase the separation between the equipment and receiver.
- Connect the equipment to an outlet on a circuit different from that to which the receiver is connected.
- Consult the dealer or an experienced radio/TV technician for help.

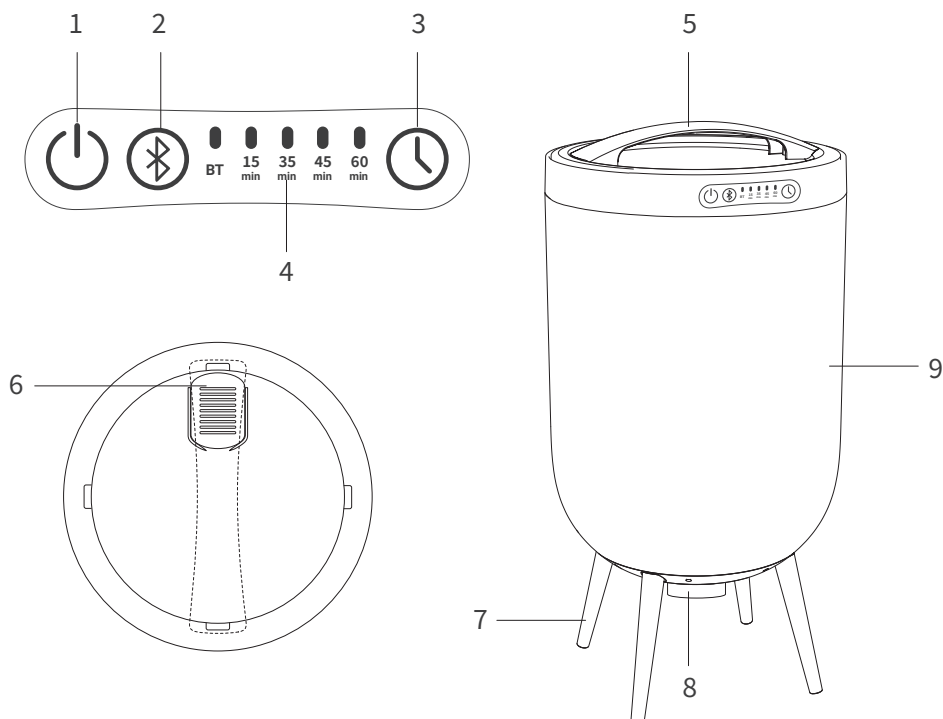

LOCATION OF PARTS AND CONTROLS

1.	Power control: touch to turn on/ turn off —heating
2.	Bluetooth/light control: • Short press to turn on/ turn off Bluetooth speaker • Long press to turn on/ change/ turn off the ambient lighting
3.	Timer control: Touch to set heating time.
4.	Heating status indication light
5.	Lid
6.	Fragrance disc holder
7.	Detachable stands
8.	Bluetooth speaker
9.	Bucket Body

USING THE TOWEL WARMER

The Towel Warmer will warm two bath towels measuring approximately 40" x 70" .

1. Place the Towel Warmer on a dry, level, hard surface.
2. Insert the power cord into an electrical outlet.
3. Place your dry towel(s) inside. Replace the lid.
4. Method 1: After powering on, touch the power key, the heating status indication light flashes for 5 seconds and then starts heating. The default time is 30 minutes.
5. Method 2: After powering on, touch the power key, then touch the timer key to select the heating time. Finishing the selecting, the heating status indication light flashes for 5 seconds and then starts heating.
6. When the heating time is over or power off, the heating status indication light will turn off when the temperature is lower than 140°F.

PRODUCT SPECIFICATIONS

Rated Voltage 120V AC

Frequency 60Hz

Wattage Max 420W

Gross Weight 12.79 LBS

Dimensions with Bases 65.5CM (H) x 33CM (W) x 33CM (L)

This device complies with Part 15 of the FCC Rules.

Radiation Exposure Statement

This equipment complies with FCC radiation exposure limits set forth for an uncontrolled environment. This equipment should be installed and operated with minimum distance 20cm between the radiator and your body.

FUNCTION OVERVIEW

Power control: touch to turn on/ turn off —heating

Bluetooth/light control:

- Short press to turn on/ turn off Bluetooth speaker
- Long press to turn on/ change/ turn off the ambient lighting

Timer control: Touch to set heating time.

Indication Light

- After powering on, touch the power key, the heating status indication light flashes for 5 seconds and then starts heating. The default time is 30 minutes.
- After powering on, touch the power key, then touch the timer key to select the heating time. Finishing the selecting, the heating status indication light flashes for 5 seconds and then starts heating.
- When the temperature is lower than 140°F, the heating status indication light is green.
- When the temperature is higher than 140 °F, the heating status indication light is red.
- When the set time is over, and the temperature is below than 140 °F, the Indication light will turn off.
- When Bluetooth turns on and BT light will blink, it means matching

Time Settings

- Heating Time Options: Choose from four preset durations - 15, 30, 45, 60 minutes by tapping the time button.
- Power Key Function: Start or stop heating by tapping the power key.
- Default Settings: If no time is selected after powering on and pressing the power key, heating starts with a default time of 30 minutes.
- Heating Interruption: Stop heating by touching the power key and start again by tapping it once more(heating starts with a default time of 30 minutes).

Lid

Find lid alignment arrow on the left side of your lid. Twist clockwise to lock, counterclockwise to unlock.

Fragrance Disc Holder

Find aromatherapy box on the underside of your lid. Remove aroma disc or solid fragrance from plastic. Slide cover and insert disc. Slide cover back in place. Note: DO NOT use liquid or oil scents. Aroma not included.

TIPS FOR BEST RESULTS

1. Use cotton or cotton blend towels or fabrics.
 2. For fast and even heating, loosely pile one towel into the Towel & Blanket Warmer. Two towels will take longer to heat.
 3. Use only with DRY fabrics.
- *NOTE: DO NOT use with damp or wet articles.
4. Avoid using delicate fabrics that cannot withstand high heat. Any fabric indicating that a cool iron must be used may not be able to withstand the heat of the Towel & Blanket Warmer, resulting in damage to the fabric and the product.
 5. Once the heating cycle has begun, keep the lid closed. This will prevent heat from escaping. Opening the lid when working may result in slower heating times.
- *NOTE: Condensation on the lid and interior of the product is normal.
6. When used with the Towel & Blanket Warmer, the Fragrance Disc may warp over time.

CARE AND MAINTENANCE

Remove the power cord from the electrical outlet before cleaning. Wipe with a dry cloth only when unit is cool to the touch.