

**SANUS®**  
A brand of **Legrand**

## WSSE3A1 / WSSE3A2

### Height-Adjustable Speaker Stand

For SONOS® Era 300™

#### INSTRUCTION MANUAL

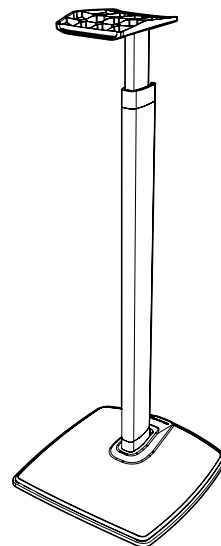

### We'll Make It Stress-Free

If you have any questions along the way, just give us a call.

**US:** +1 (800) 359-5520 • **EMEA:** +31 (0) 495 580 852 • **UK:** +44 (0) 800 056 2853

We're ready to help!

Texto en español, página 12

Deutscher Text Seiten 16

Svensk text sida 20

中文文字说明请参见第 24 页

Texte français page 14

Nederlandse tekst op pagina 18

Русский текст: стр. 22

日本語は 26 ページ

# IMPORTANT SAFETY INSTRUCTIONS

— PLEASE READ ENTIRE MANUAL PRIOR TO USE — SAVE THESE INSTRUCTIONS

**Before getting started, let's make sure this product is perfect for you!**

**This stand is designed to support only Sonos® Era 300™ speakers.**

**⚠ CAUTION:** Avoid potential personal injuries and property damage!

- Check your speaker owner's manual to see if there are any special requirements for mounting your speaker.
- Please read through these instructions completely to be sure you're comfortable with this easy install process.
- Do not use this product for any purpose not explicitly specified by manufacturer.
- Manufacturer is not responsible for damage or injury caused by incorrect assembly or use.
- If you do not understand these instructions or have doubts about the safety of the installation, assembly or use of this product, contact Customer Service at US: +1 (800) 359-5520 • EMEA: +31 (0) 495 580 852 • UK: +44 (0) 800 056 2853.

**Speaker  
Weight Limit**  
**DO NOT  
EXCEED**



## Tool Needed

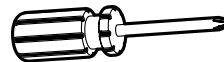

Screwdriver

# Dimensions

## TOP VIEW

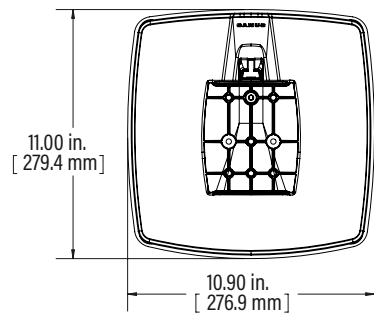

## 3-D

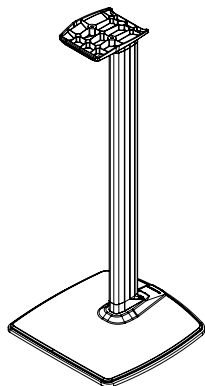

## FRONT VIEW

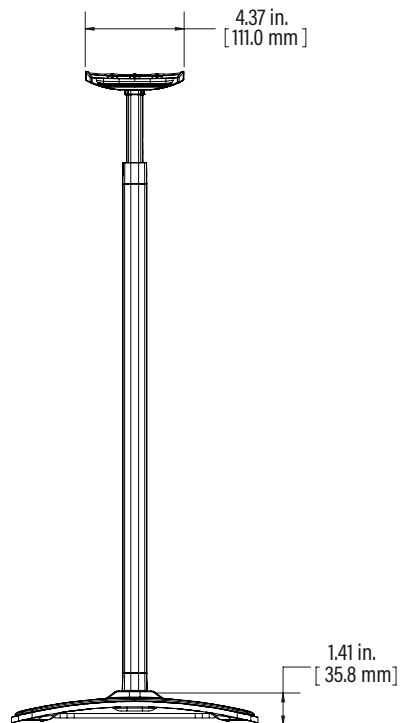

## SIDE VIEW

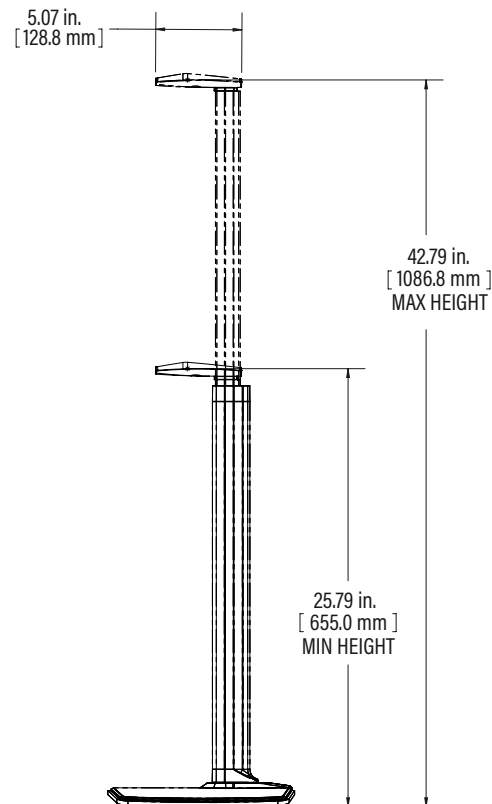

# Parts and Hardware

**⚠ WARNING:** This product contains small items that could be a choking hazard if swallowed.

Before starting assembly, verify all parts are included and undamaged. If any parts are missing or damaged, do not return the damaged item to your dealer; contact Customer Service. Never use damaged parts!

**📄 NOTE:** Not all hardware included will be used.

Quantities shown are for one speaker stand.

## STEP 2

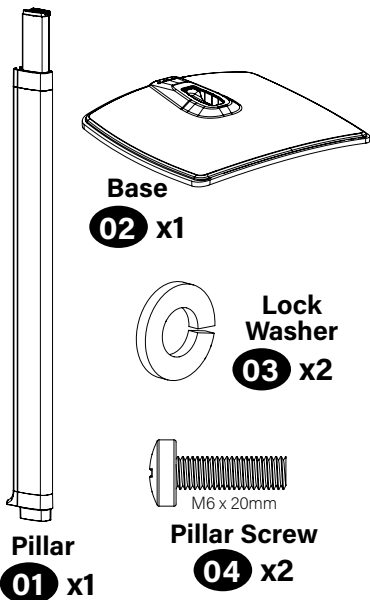

## STEP 3



### OPTIONAL

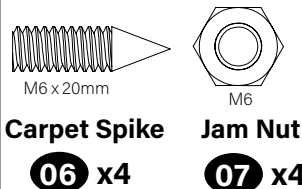

## STEPS 4 and 5

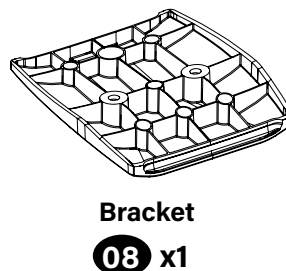

## STEP 6



## STEP 7

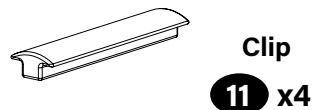

## STEP 1

## Route Cable(s)

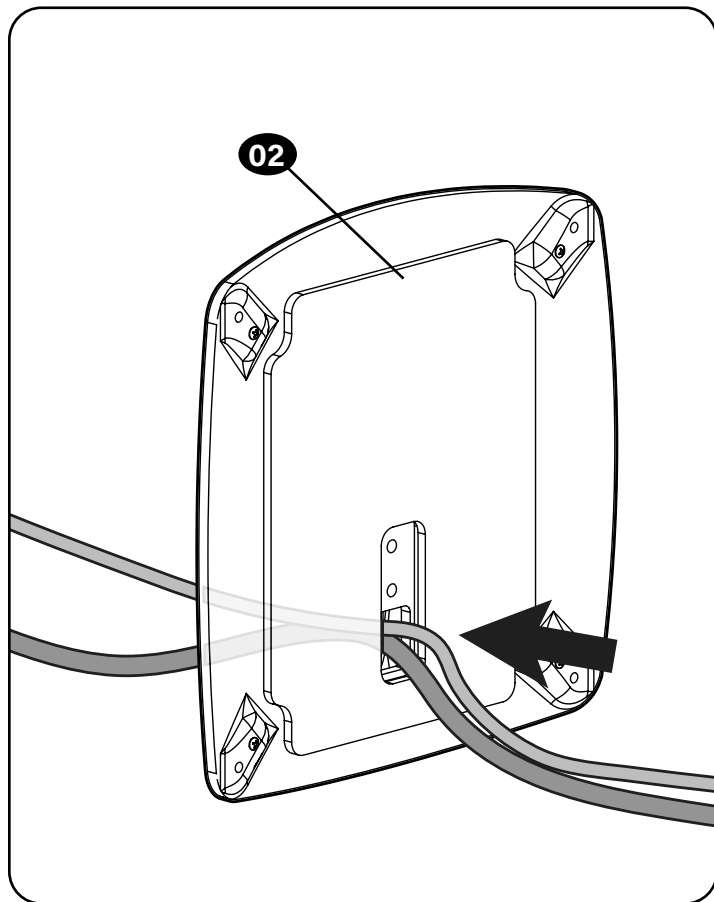

## STEP 2

## Attach Base to Pillar

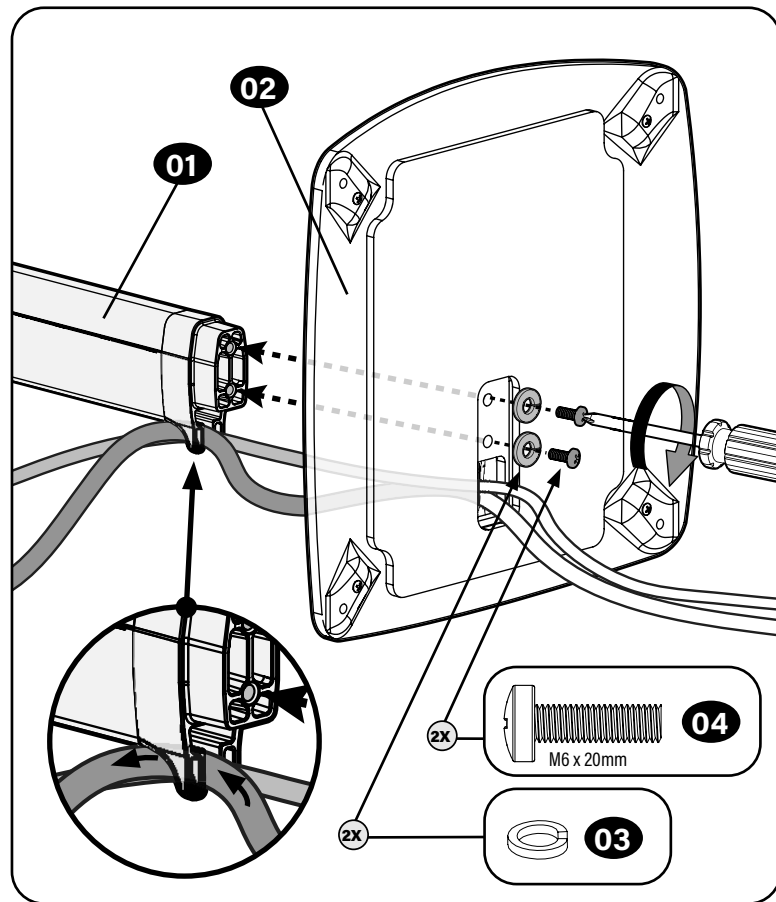

## STEP 3

## Install Rubber Pads -or- Carpet Spikes

### Rubber Pads

Twist rubber pads **05** into the base **02**.

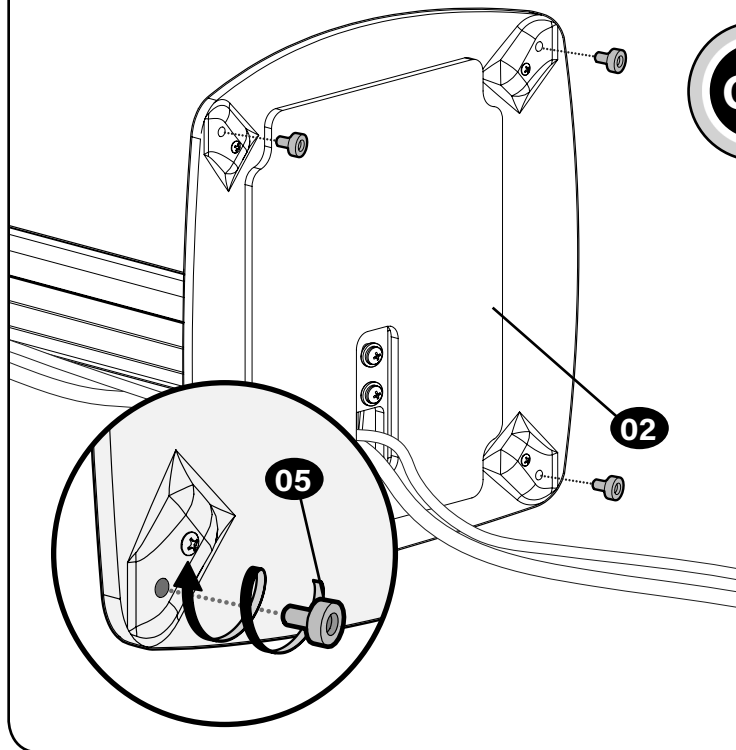

OR

### Optional Carpet Spikes

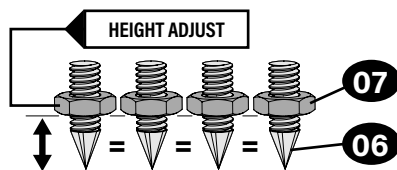

**⚠ WARNING:** The ends of carpet spikes **06** are sharp and may scratch flooring, damage wiring, or be hazardous to children.

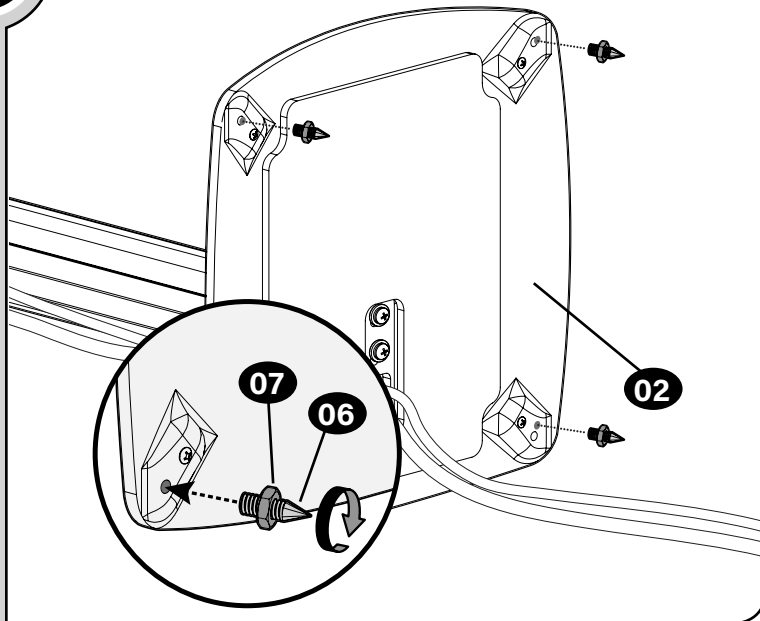

## STEP 4

## Attach Bracket to Pillar

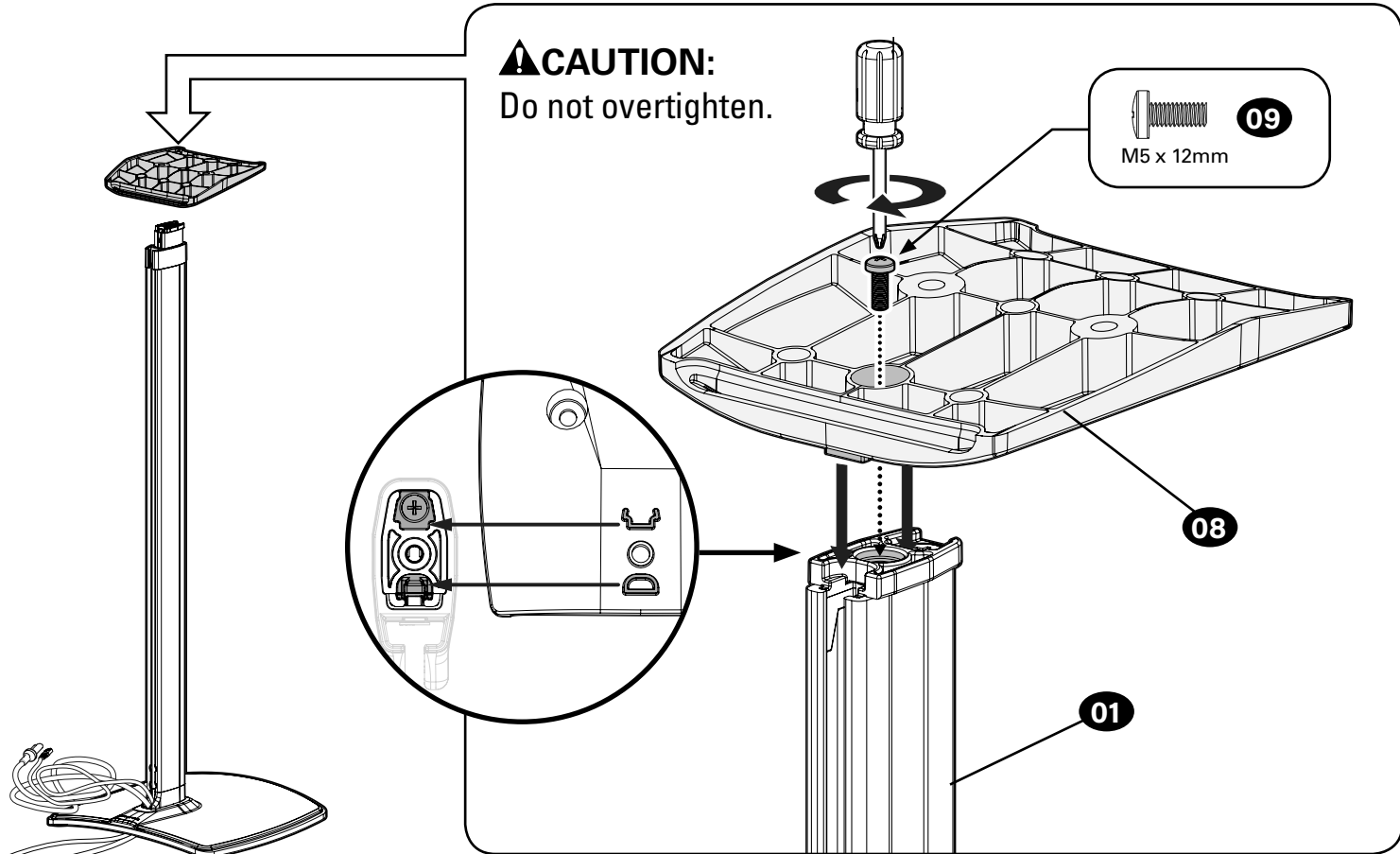

## STEP 5

## Install Speaker

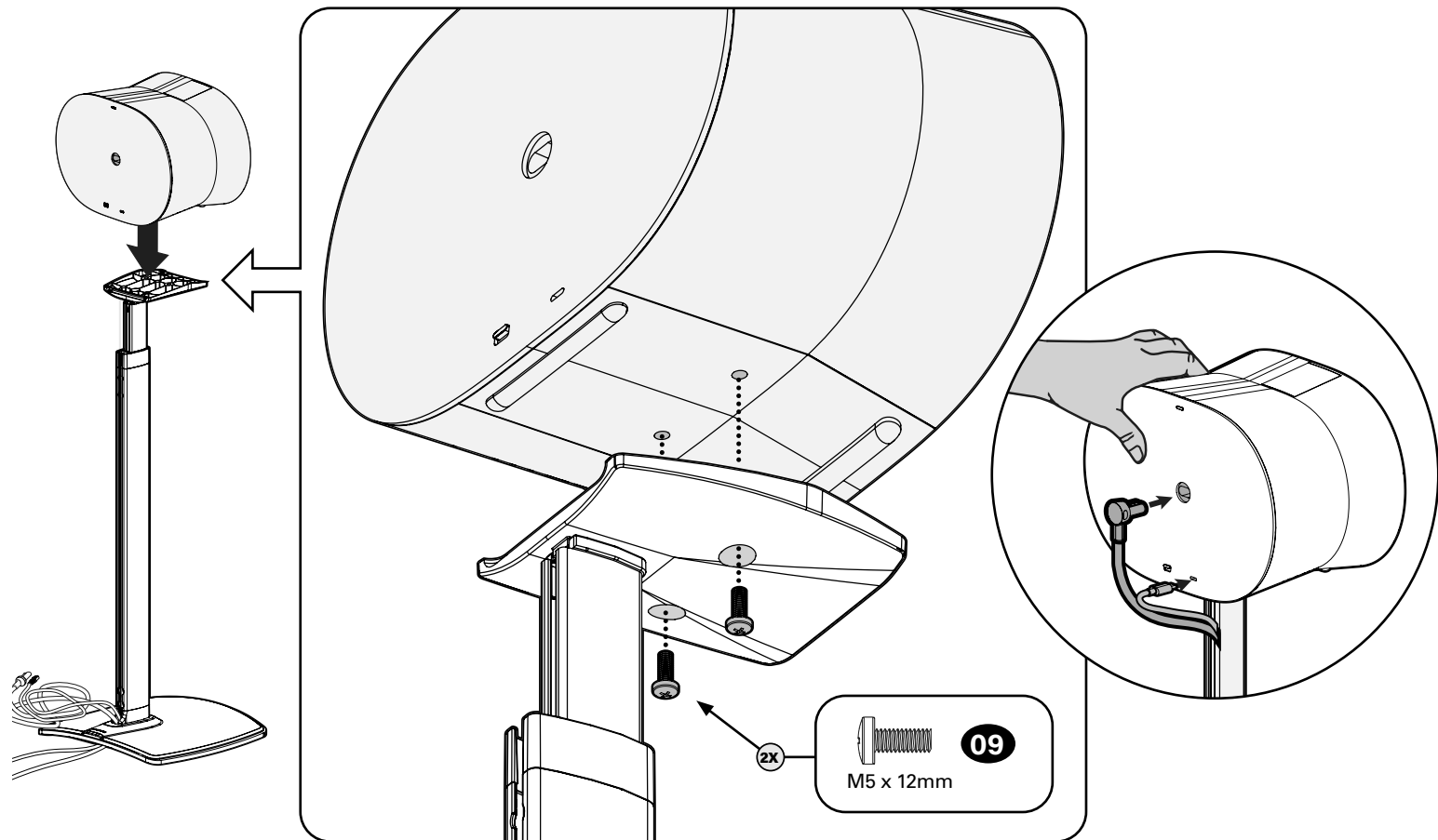



## STEP 6

## Height Adjustment

 **RAISE**

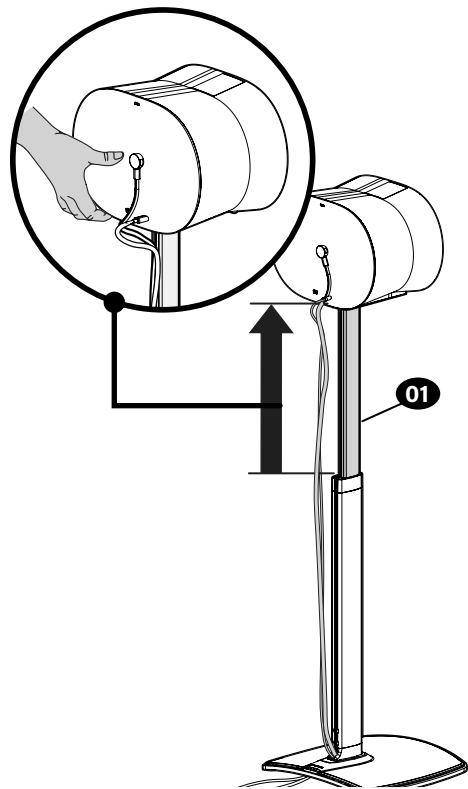

 **LOWER**

**⚠ CAUTION:** Avoid potential personal injuries and property damage!

Hold upper post **01** BEFORE pressing trigger button **10**.

Trigger button **10** is removable to prevent accidental lowering, or to route cables into post **01** (STEP 7).

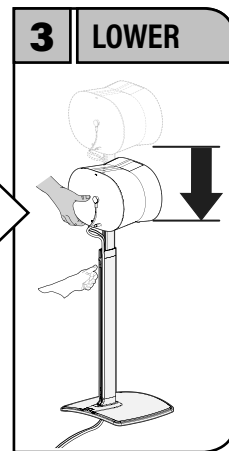
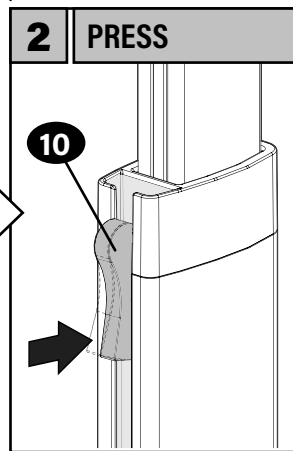
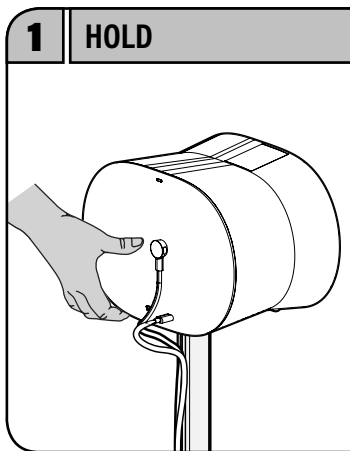
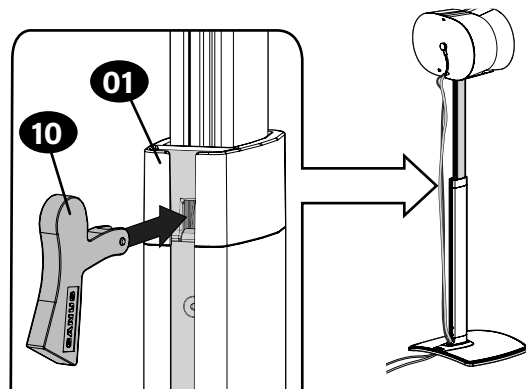

## STEP 7

## Secure Cable(s)

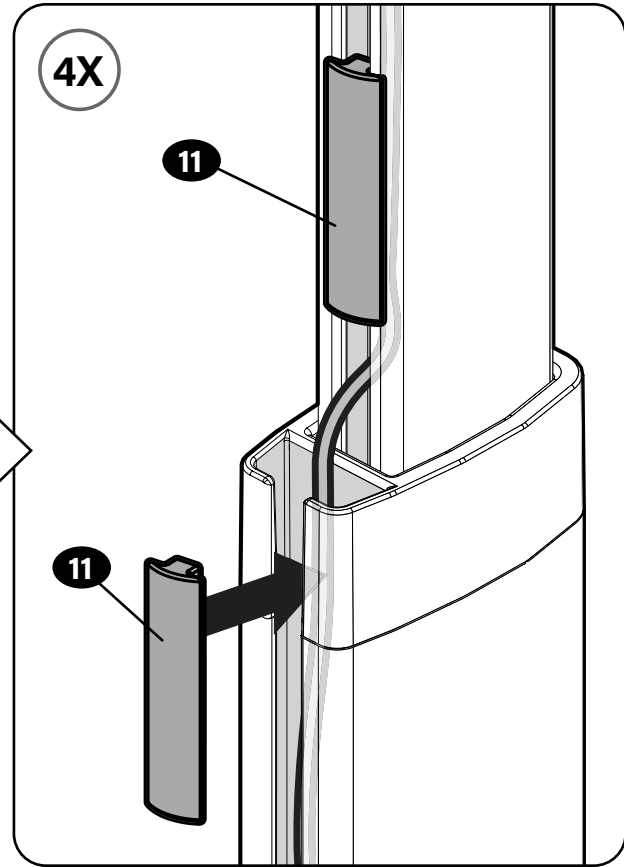
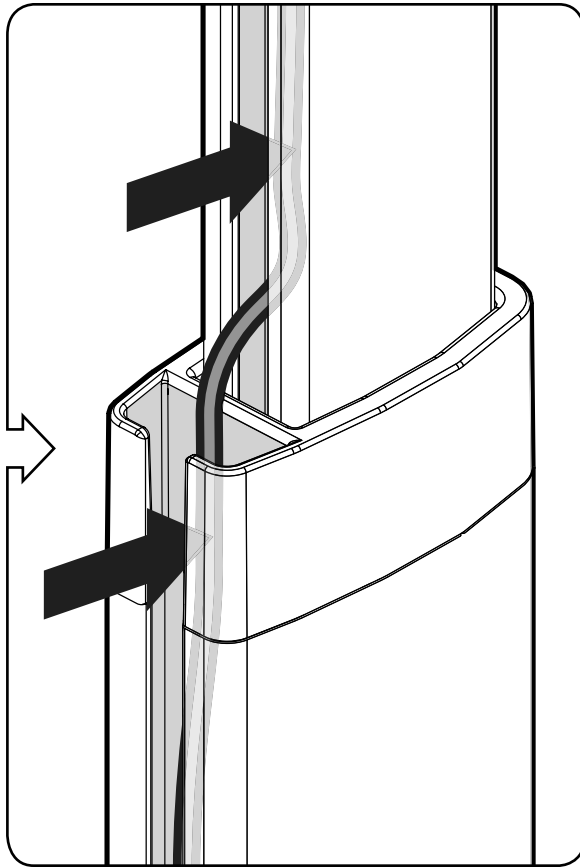
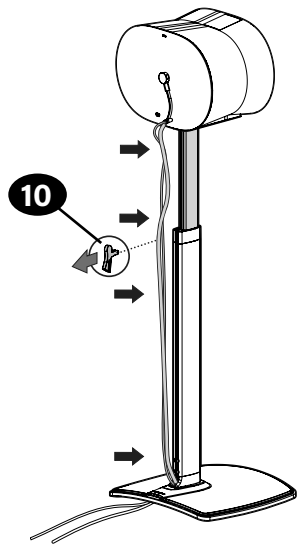

**enjoy**

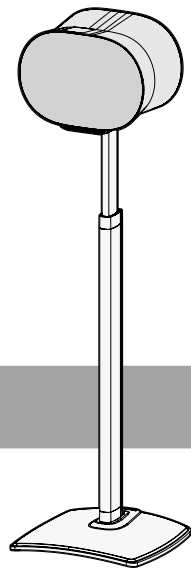

# SANUS®

A brand of  **Legrand**

**Thank you for choosing SANUS!** Please take a moment to let us know how we did:

**Legrand AV Inc.**

6436 City West Parkway  
Eden Prairie, MN 55344 USA

**US:** +1 (800) 359-5520

**Legrand AV Netherlands B.V.**

Franklinstraat 14  
6003 DK Weert Netherlands

**UK:** +44 (0) 800 056 2853

**EMEA:** +31 (0) 495 580 852

**Authorized Representative for the UK**

Starline Holding Technology Ltd.  
Unit C Island Road  
Reading RG2 0RP UK

Legrand AV Inc. and its affiliated corporations and subsidiaries (collectively, "Legrand"), intend to make this manual accurate and complete. However, Legrand AV makes no claim that the information contained herein covers all details, conditions, or variations. Nor does it provide for every possible contingency in connection with the installation or use of this product. The information contained in this document is subject to change without notice or obligation of any kind. Legrand AV makes no representation of warranty, expressed or implied, regarding the information contained herein. Legrand AV assumes no responsibility for accuracy, completeness or sufficiency of the information contained in this document.

©2022 Legrand AV Inc. All rights reserved. SANUS is a brand of Legrand. SANUS and the SANUS logo are registered trademarks of Legrand.

Sonos and Sonos product names are trademarks or registered trademarks of Sonos, Inc. All other brand names or marks are used for identification purposes and are trademarks of their respective owners.

**Legrand AV Inc.** • 6436 City West Parkway • Eden Prairie, MN 55344 USA

6901-603037 00