

# BELiFE

## CORDLESS VACUUM CLEANER

BVC11

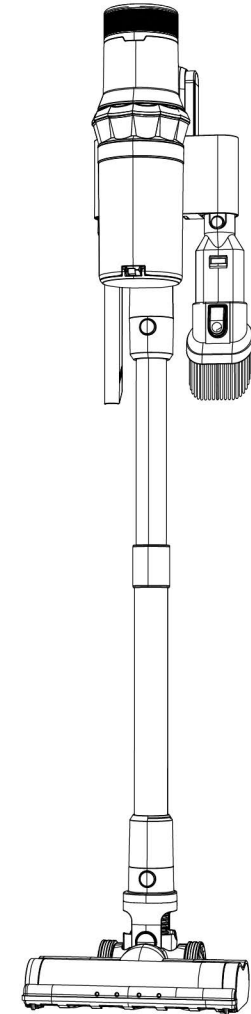

## Customer Service

✉ Email: [BelifeHome@outlook.com](mailto:BelifeHome@outlook.com)

☎ Customer service hotline: 401-300-0032

Hours: 9AM-5PM (CDT) WEEKDAY



## USER MANUAL

Please read this manual carefully before using this product.  
We hope you enjoy using this product as much as we enjoyed  
developing it and using it daily.

## TABLE OF CONTENTS

TABLE OF CONTENTS	2
IMPORTANT SAFETY INSTRUCTIONS	3
PRODUCT PARTS	4-5
PREPARING TO USE	6-8
USING	9-10
CLEANING AND MAINTENANCE	11-13
TECHNICAL SPECIFICATIONS	14
TROUBLESHOOTING	15
WARRANTY POLICY	16-17

## IMPORTANT SAFETY INSTRUCTIONS

Before using the cordless vacuum cleaner, please read this user manual carefully.

1. It is a must to check all the following instructions carefully before using this vacuum.
2. When you are using the vacuum, please follow the instructions on operation below.
3. Only use the vacuum in a suitable environment.
4. This vacuum is not designed for use by persons (including children) with reduced physical, sensory or mental capacities or lack of experience and knowledge, unless supervised by a person responsible for their safety.
5. If the vacuum or power adaptor is damaged, please return it to the authorized service center for service or replacement to avoid personal injury.
6. Children below age 8 are not allowed to use this vacuum.
7. Children of age 8 and above are only allowed to use this vacuum in the company of their custodian.
8. This vacuum is NOT a toy. Please pay special attention when you are using it around a child, pet or plant.
9. To avoid injury or electric shock, please do not attempt to repair the vacuum.
10. When charging the vacuum, connect the power adaptor to the power socket first and then to the unit.
11. Keep hair, clothes and any part of your body away from the brush and/or suction inlet.
12. Do not pick up hot ash / cigarette butts / matches and flammable liquid, such as gasoline with the vacuum.
13. Watch the steps when using the vacuum on stairs.
14. Do not use the vacuum if the filter is not fitted into the appliance.
15. This vacuum is designed for domestic use following this instruction manual.
16. Do not keep the vacuum in charging status if you are planning to be away for a long time.
17. To avoid electric shock, please do not dip any part of the vacuum into liquid.
18. Use only genuine spare parts and accessories from . Using other types of batteries may explode, causing damage and injury to persons.
19. Charge the battery of the vacuum with correct voltage rating stated in the product specification on page 16.
20. Store the vacuum in a cool and dry place.
21. Regularly maintain the vacuum and empty the dirt bin to ensure its proper operation.
22. Please return the faulty or malfunctioning vacuum to the authorized service center.
23. Do not charge the battery or the appliance outside of the temperature range specified in the instructions. Charging with the wrong power adapter rating or at a temperature outside of the specified range may damage the battery and increase the risk of fire. To optimise the battery life : When not in use, keep the appliance at room temperature between 18°C (64°F) to 28°C (82°F). The ambient temperature range for operation and charging should be between 10°C (50°F) to 30°C(86°F)

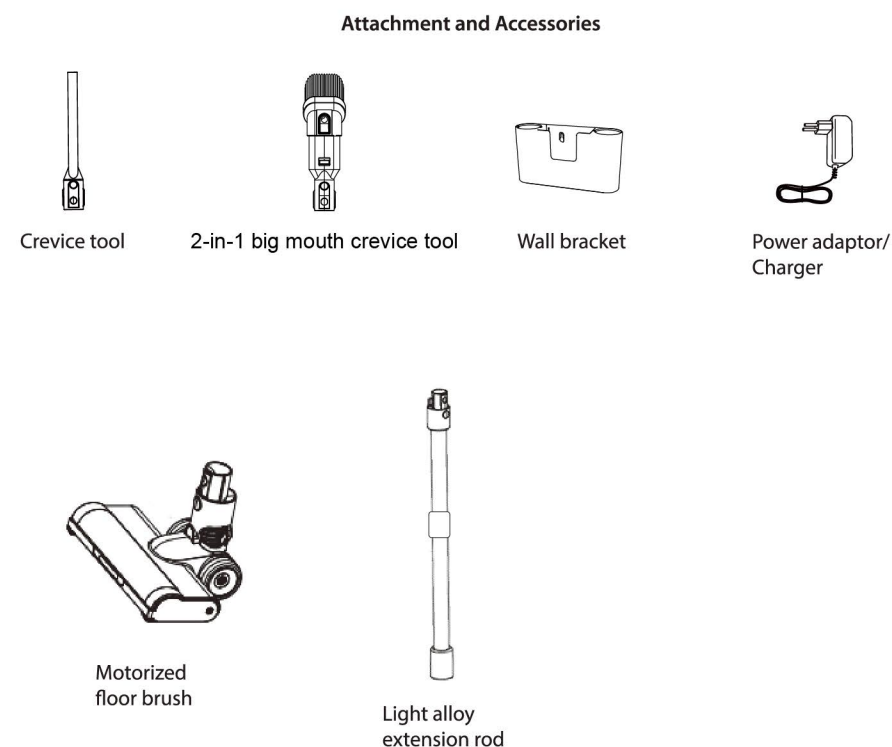
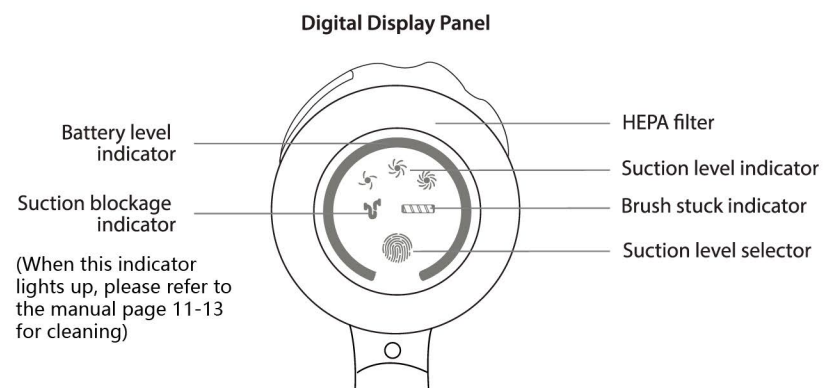
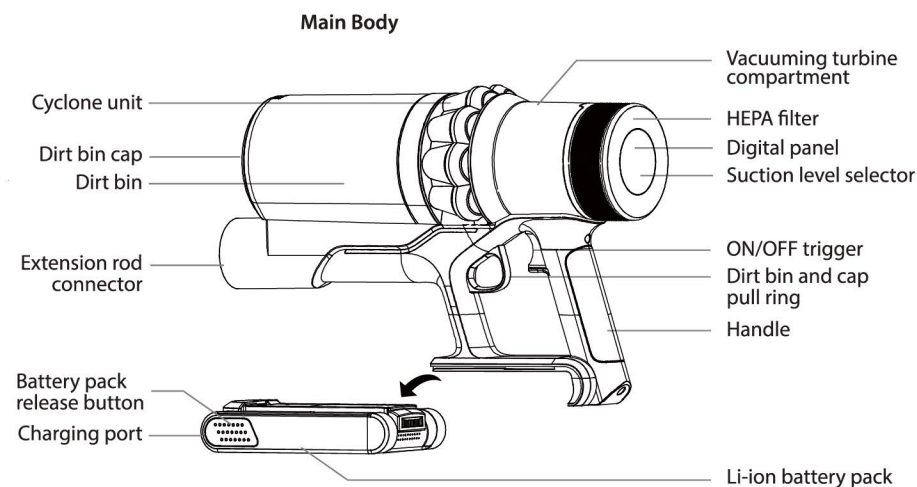

What's in the package

Main body	x 1	Wall bracket	x 1
Motorized floor brush	x 1	Power adaptor/Charger	x 1
Crevice tool	x 1		
2-in-1 big mouth crevice tool	x 1		
Light alloy extension rod	x 1		

NOTE: Attachments and accessories contained in the package may vary due to continuous improvement or according to different model number.

### Main body and accessories/cleaning tools assembly

Align the main body, extension rod and the cleaning tool as shown and insert until they "click". To remove any attachments/accessories, press and hold the button, and pull to remove.

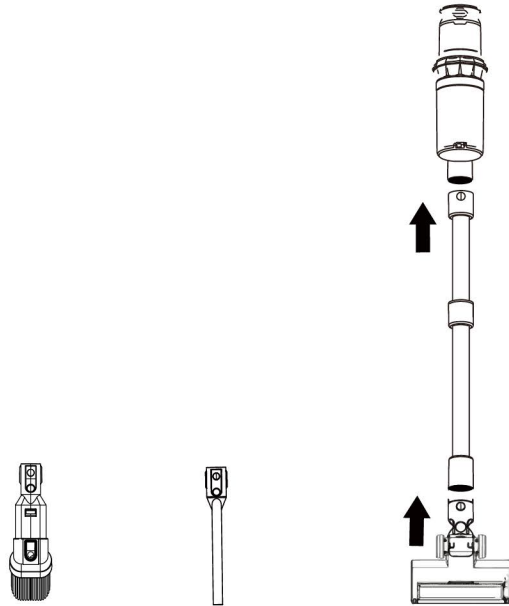

NOTE: All attachment included are compatible with the main body and the extension rod.

### Wall bracket

1. Place output plug of the adapter into the hole in the wall bracket and arrange the cable according to the track provided(Fig 1).
2. Screw the wall bracket onto the wall in a cool and dry location(Fig 2).

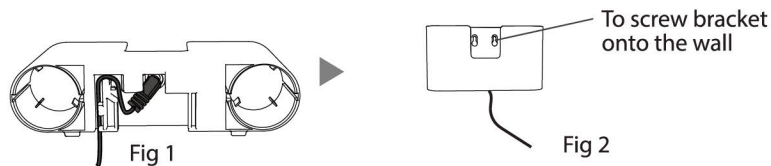

### Charging the battery

1. There are 3 options to charge your vacuum cleaner (Fig 1, 2 and 3).
2. Power/battery indicating lights "blink" to indicate charging is in progress.
3. Charging time is approximately 3.5 to 5 hours from low power to fully charged.

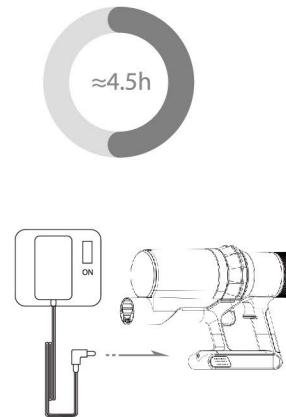

Fig 1. Direct

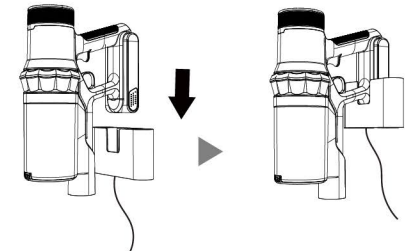

Fig 2. Wall bracket

**WARNING!** DO NOT lean the vacuum against any surface (wall, edge of table, cabinet, etc) in upright position for support at any time in case it accidentally slips and falls, causing damage to the main body, .

## Li-ion battery pack

1. cordless vacuum comes with a high capacity li-ion rechargeable battery pack. If you have purchased an additional battery pack, it is advisable to alternate using both of them for a more even performance.
2. The battery capacity (vacuum run time) will reduce gradually over time. In the event the vacuum runs for less than 10 minutes every time it is fully charged, it is time to replace with a new replacement battery.

**NOTE:** If the vacuum is not going to be used for more than 2 months, fully charge before disconnecting the power adapter and store it in a cool and dry place.

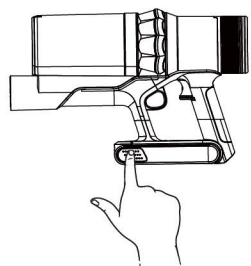

- 1 Press the battery release button

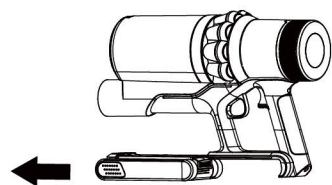

- 2 Slide out the battery pack

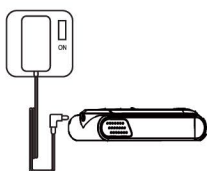

- 3 Plug in to charge

## Turn on the vacuum cleaner

1. Pull the trigger to turn on. Standard suction mode is the default.
2. Pull the trigger again to switch it off.

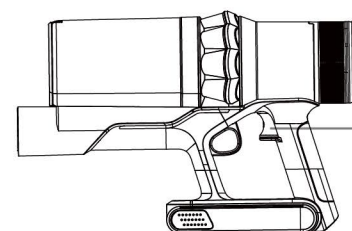

1-press ON/OFF trigger

Suction level selector

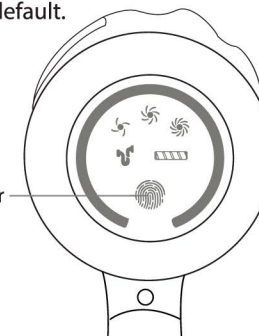

## Using the motorized floor brush

1. The motorized floor brush can be used on any hard floor and short pile carpet.
2. The underside of the motorised brush comes with a strip of dust blocking felt (Fig 1) for effective dust pick up. DO NOT move the motorised brush backward towards the dirt you want to pick up.
3. Move in forward direction to pick up dirt, pull back along the cleaned track, turn slightly and push forward to continue picking up the next track of dirt in ladder pattern (Fig 2).
4. The brush motor is designed with self-protection function. Power to the brush motor will be cut off to prevent the motor from getting damaged if the brush is not able to turn freely (e.g. stuck with foreign object).

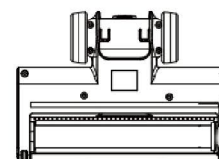

Fig 1

Dust blocking felt

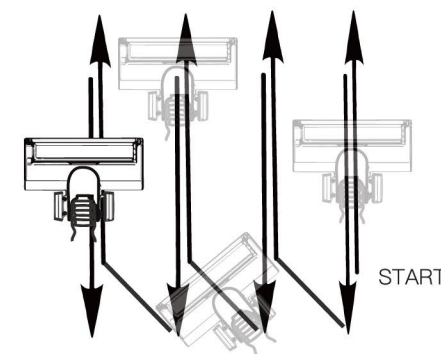

Fig 2



## Using other accessories



For narrow and deep spaces.



For uneven surfaces like keypads

### IMPORTANT TIPS:

1. Stand upright, keep your arm bent naturally and relax your shoulders and arms.
2. Use pendulum motion to swing your arm forward and backward while turning the handle slightly to change direction (as shown in Fig 1).
3. To change direction significantly (e.g. vacuum between chairs) move your legs and body to change direction so that your body is always perpendicular to the vacuum.
4. **DO NOT** twist your wrist or raise your shoulder/arm excessively to vacuum at an awkward angle. This may cause injury to your muscles/joints.

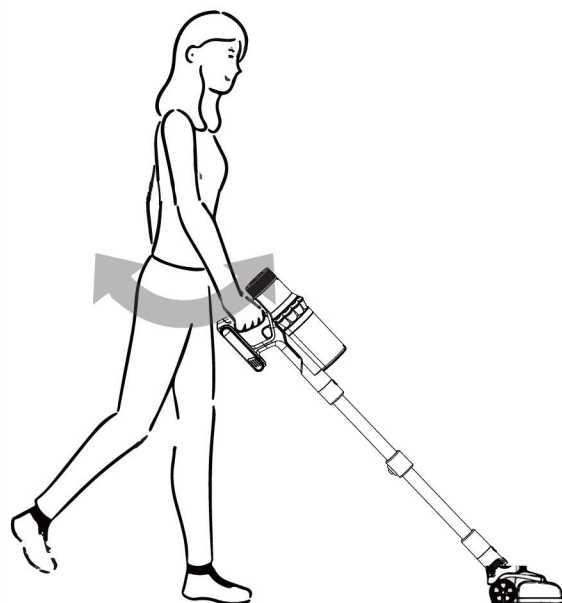

Fig 1

For optimal performance, it is recommended to clear the dirt bin after every use. Always keep the filters clean.

Replace the pre-motor filter and HEPA filter yearly or whenever the air flow is weak even after proper cleaning and drying.

## Clearing the dirt bin

Cleaning frequency: After every use.

Maintain 90° vertical operation, otherwise the dust cup cannot be opened

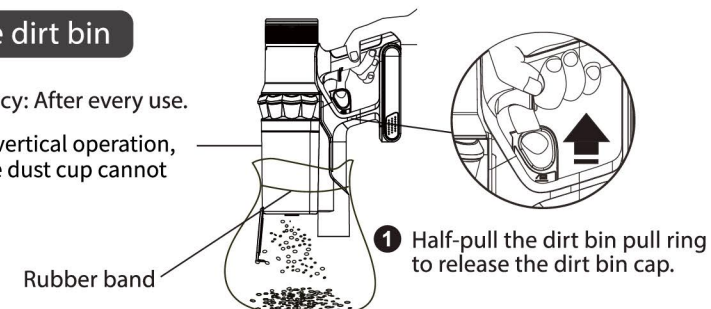

## Cleaning the cyclone unit

Cleaning frequency: Whenever needed.

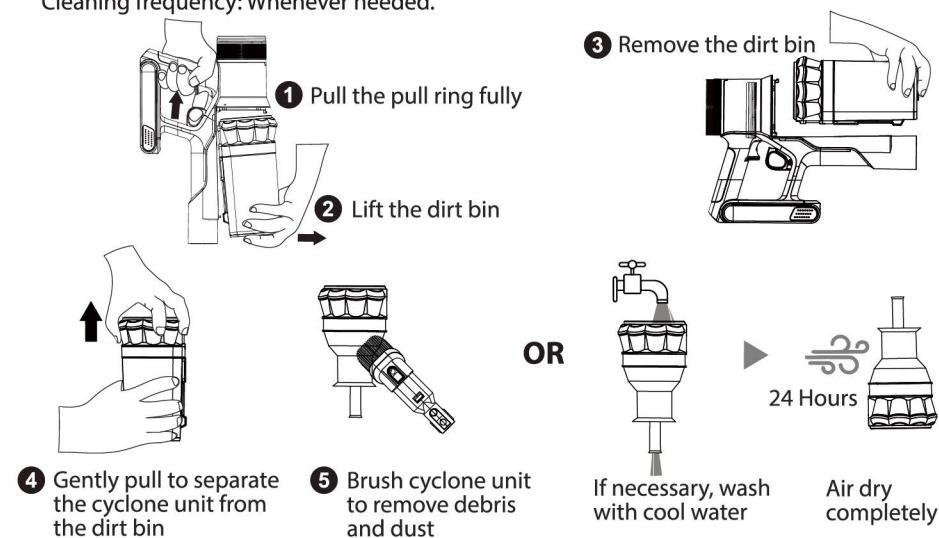

**WARNING!** Never attempt to disassemble the sealed cyclone unit.

## Cleaning the HEPA filter

Cleaning frequency: 3-6 month or whenever airflow is weak.

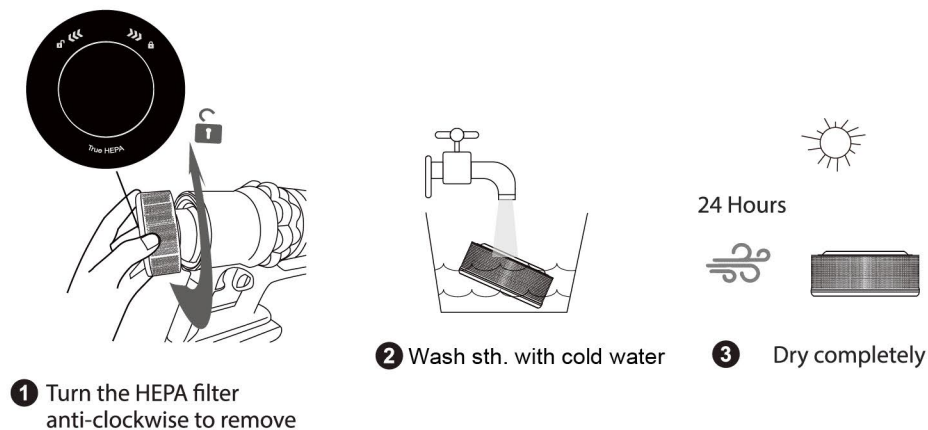

## Cleaning the pre-motor filter

Cleaning frequency: 1-2 months or whenever airflow is weak.

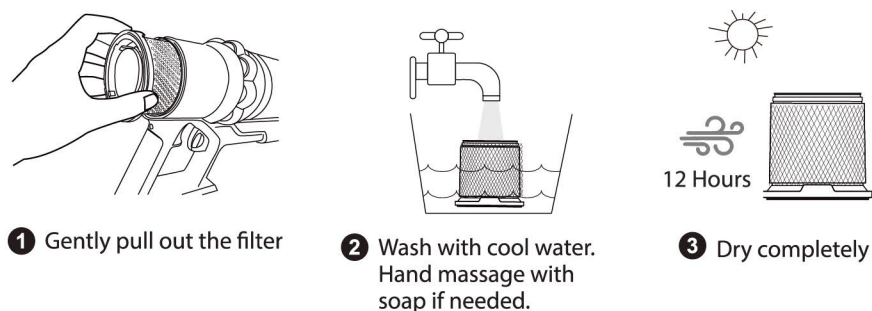

### WARNING!

1. DO NOT brush any part of the porous filtration material.
2. DO NOT soak any filter in water for more than 10 minutes.
3. DO NOT wash any other part of the vacuum except the Specified filter assembly.

## Cleaning the brush and bearing

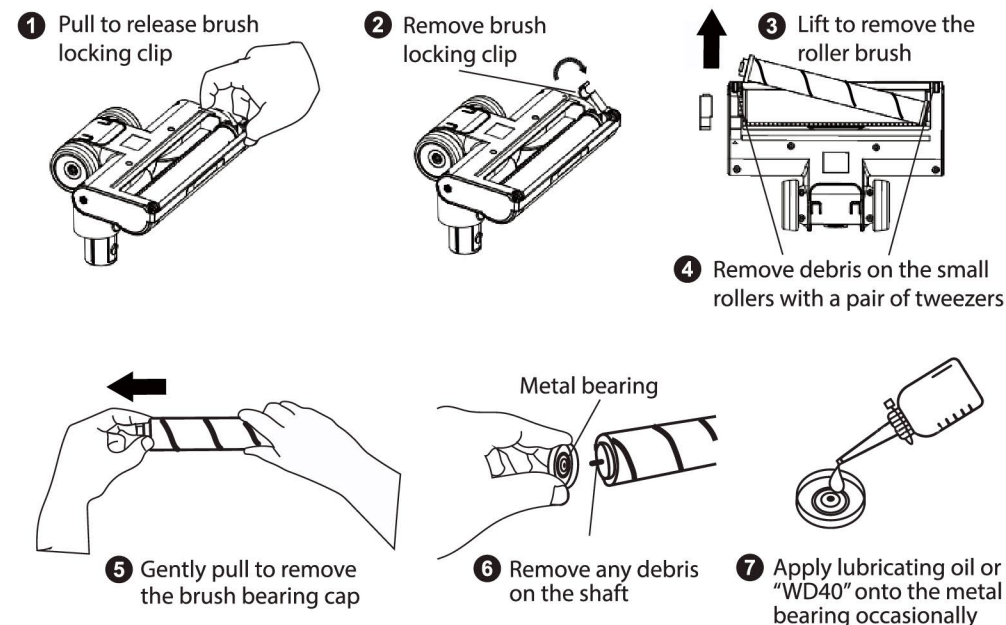

## Washing the fluffy brush

If necessary, e.g. accidentally run through sugary liquid, wash the brush with running water. Remove the bearing cap before washing. DO NOT soak the fluffy brush.

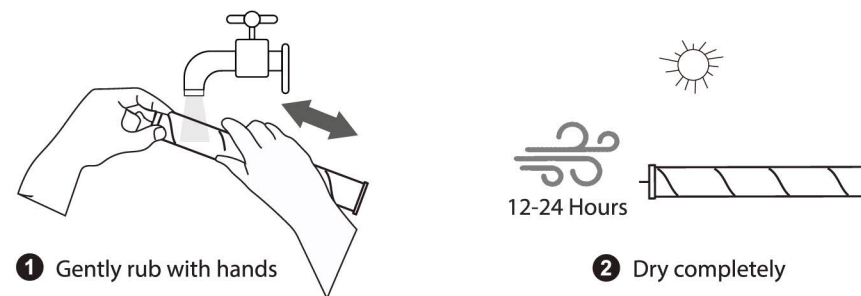

## TECHNICAL SPECIFICATIONS

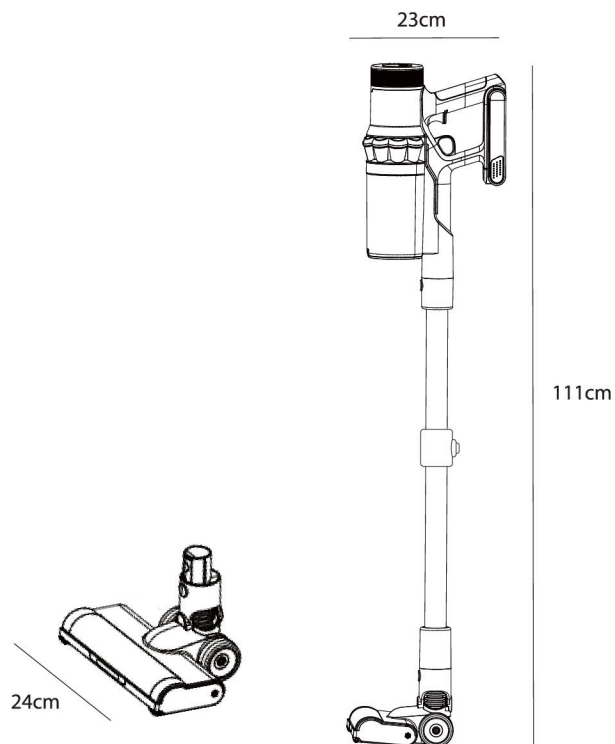

Power adaptor input	:	100 - 240VAC 50-60Hz 0.5A
Adaptor output	:	31VDC 0.5A
Battery	:	Li-ion 25.9V
Charging time	:	4-5H
Run time	:	13-40min
Product dimension	:	440 (H) *330 (W) *190 (D) mm
Net Weight	:	1.5 kg(main body) 2.38kg(with extension rod and motorised brush)

### NOTE:

Charging time and run time vary depending on ambient temperature and operating conditions. The protection system will be deployed automatically to protect the motor and battery if the temperature is too high or too low.

## TROUBLESHOOTING

	Symptoms	Possible Causes	Suggested Solutions
1	<ul style="list-style-type: none"> <li>Cannot turn on</li> </ul>	<ul style="list-style-type: none"> <li>Low battery power.</li> <li>No power supply to the adaptor.</li> </ul>	<ul style="list-style-type: none"> <li>Charge the unit to use. The power/ battery indicating lights should move ("blink").</li> <li>Ensure that the power socket is working. Verify it with other appliance.</li> </ul>
2	<ul style="list-style-type: none"> <li>Battery is not charging.</li> </ul>	<ul style="list-style-type: none"> <li>Temperature protection triggered. Battery level indicator flashing</li> </ul>	<ul style="list-style-type: none"> <li>Let the machine cool down in a cool location for 30 minutes. This is normal when running at high suction mode continuously for a long period.</li> </ul>
3	<ul style="list-style-type: none"> <li>Fully charged but run for a few seconds only</li> </ul>	<ul style="list-style-type: none"> <li>Wrong power adaptor is used.</li> </ul>	<ul style="list-style-type: none"> <li>Check that you are using the correct adaptor with output 31VDC 0.5A.</li> <li>Please follow instructions on page 11-13 to clean up and keep the inlet and outlet air ducts free from blockage</li> </ul>
4	<ul style="list-style-type: none"> <li>Weak suction</li> <li>Machine stop working with suction blockage indicator lit up</li> </ul>	<ul style="list-style-type: none"> <li>Filter is clogged by fine dust.</li> <li>Motorised brush is not spinning.</li> <li>Air passage is clogged by foreign object.</li> </ul>	<ul style="list-style-type: none"> <li>Clean filter regularly. Refer to Maintenance section.</li> <li>Remove hair and foreign object from the brush. Remove compressed hair strains from the bearing. Refer to Maintenance section.</li> <li>Check and remove any foreign object at the floor brush, extension rod, main body air inlet and dirt bin.</li> <li>Please follow instructions on page 11-13 to clean up and keep the inlet and outlet air ducts free from blockage</li> </ul>
5	<ul style="list-style-type: none"> <li>Motor sounds abnormal when running</li> </ul>	<ul style="list-style-type: none"> <li>Vacuum inlet or filter is clogged.</li> </ul>	<ul style="list-style-type: none"> <li>Clear blockage along brush inlet, extension rod and dirt bin, and clean filter.</li> </ul>
6	<ul style="list-style-type: none"> <li>Main brush not spinning</li> </ul>	<ul style="list-style-type: none"> <li>Brush is stuck.</li> </ul>	<ul style="list-style-type: none"> <li>Remove any foreign object that caused the brush to cut off power automatically.</li> <li>If there is no foreign object (it may have dropped off), restart the vacuum.</li> </ul>

### NOTE:

Hello, we provide 1 year warranty service, if you have any use problems, please contact us by email: BelifeHome@outlook.com



Asia Sdn Bhd (Corvan) warrants to the original purchaser ("you" or "your") that your Cordless Vacuum Cleaner product hardware and the brushless(digital) motor of the vacuuming turbine (jointly named "Product") shall be free from defects in material and workmanship for 1 year and 5 years respectively from the date of original purchase.

### Remedies

To the maximum extent permitted by applicable law, Corvan's entire liability and your exclusive remedy for any breach of warranty during the applicable warranty period shall be, at Corvan's option, to repair or replace the Product, provided that the Product is returned to the point of purchase or such other place as Corvan may direct with a copy of the sales receipt or dated itemized receipt. Shipping, handling charges and bank credit card commission may apply. Corvan may, at its option, use new or refurbished or used parts in good working condition to repair or replace any Products. Any replacement Product will be warranted for the remainder of the original warranty period.

### How to Obtain Warranty Support

When you need to make warranty requirements, please contact us by email: [BelifeHome@outlook.com](mailto:BelifeHome@outlook.com)

### Exclusions

This warranty does not cover power adapter (charger) and consumables including filters and brushes. Problems or damages resulting from (1) accident, abuse, misapplication, or any unauthorized repair, modification or disassembly of the Product; (2) improper operation or maintenance, usage not in accordance with Products instructions or connection to improper voltage supply; (3) negligent use or care, neglect or careless operation of the Product; (4) use of consumables, parts and accessories including batteries other than those produced or recommended by Corvan are not covered under this warranty. In addition, to the maximum extent permitted by applicable law, this warranty does not cover Product (1) used and claimed outside the country of purchase; (2) not purchased from an authorized dealer of Corvan; (3) repaired or altered by parties other than Corvan, or its authorized agents; (4) whose serial numbers have been altered or removed; or (5) damaged from external sources such as transit, weather, electrical outages or POWER SURGE.

TO THE MAXIMUM EXTENT PERMITTED BY APPLICABLE LAW, THE WARRANTIES SET OUT ABOVE ARE EXCLUSIVE AND IN LIEU OF ALL OTHER WARRANTIES OR TERMS AND CONDITIONS, AND WARRANTIES WHETHER EXPRESS, IMPLIED OR STATUTORY INCLUDING, WITHOUT LIMITATION, ANY WARRANTIES OR TERMS AND CONDITIONS OF MERCHANTABILITY, SATISFACTORY QUALITY, FITNESS FOR A PARTICULAR PURPOSE OR NON-INFRINGEMENT ARE EXPRESSLY DISCLAIMED BY CORVAN AND ITS SUPPLIERS. NO OTHER WARRANTIES OR GUARANTEES, WHETHER EXPRESS OR IMPLIED, GIVEN BY ANY PERSON, FIRM OR CORPORATION WITH RESPECT TO THIS PRODUCT SHALL BE BINDING ON CORVAN.

### Limitation of Liability

TO THE MAXIMUM EXTENT PERMITTED BY APPLICABLE LAW, CORVAN SHALL NOT BE LIABLE FOR LOSS, WHETHER DIRECT OR INDIRECT, OF REVENUE OR PROFITS, FAILURE TO REALIZE SAVINGS OR OTHER BENEFITS OR OTHER FINANCIAL LOSS, OR ANY OTHER SPECIAL, INCIDENTAL OR CONSEQUENTIAL DAMAGES CAUSED BY THE USE, MISUSE OR INABILITY TO USE THIS PRODUCT, REGARDLESS OF THE LEGAL THEORY ON WHICH THE CLAIM IS BASED, AND EVEN IF CORVAN HAS BEEN ADVISED OF THE POSSIBILITY OF SUCH DAMAGES.

TO THE MAXIMUM EXTENT PERMITTED BY APPLICABLE LAW, CORVAN'S ENTIRE LIABILITY SHALL BE LIMITED, AT CORVAN'S OPTION, TO REPLACEMENT OR REPAIR OF THE PRODUCT OR REFUND OF THE PURCHASE PRICE PAID. THIS LIMITED WARRANTY SHALL NOT EXTEND TO ANYONE OTHER THAN THE ORIGINAL PURCHASER OF THIS PRODUCT AND IS NONTRANSFERABLE.

### No Other Warranties

No dealer, agent, or employee is authorized to make any modification, extension, or addition to this warranty.