



Warranty Register

Register your warranty at  
[www.gevi.com/pages/  
warranty-registration](http://www.gevi.com/pages/warranty-registration)  
to receive 3 months warranty  
extension for FREE.

Customer Service

**855-9922-888**

Email: [service@gevi.com](mailto:service@gevi.com)

Website: [www.gevi.com](http://www.gevi.com)



# GROUND & PODS SINGLE SERVE COFFEE MAKER

Master in Life

Instructions  
Manual



SSCMA0

# SAY HELLO TO YOUR NEW SINGLE SERVE BREWER

Wherever you are, you can always enjoy a  
cafe-quality cup with our coffee maker!

Gevi is creating a better home where aesthetics and  
functionality meets. Our journey began with coffee  
machine, turning morning rituals into barista  
-worthy experiences.

Explore with us!



# TABLE OF CONTENTS

---

<b>IMPORTANT SAFEGUARDS.....</b>	<b>1</b>
<b>GET YOUR COFFEE MAKER READY.....</b>	<b>5</b>
<b>BEFORE FIRST USE.....</b>	<b>7</b>
<b>BREWING COFFEE .....</b>	<b>8</b>
<b>CARE &amp; CLEANING INSTRUCTIONS.....</b>	<b>9</b>
<b>TROUBLESHOOTING GUIDE.....</b>	<b>10</b>
<b>TECHNICAL PARAMETERS.....</b>	<b>11</b>
<b>CUSTOMER SUPPORT.....</b>	<b>11</b>
<b>WARRANTY .....</b>	<b>12</b>

## IMPORTANT SAFEGUARDS

---



When using electrical appliances, basic safety precautions should always be followed to reduce the risk of fire, electric shock, and/or injury to persons, including the following:

### Warning

**For Your Safety:** This appliance is not intended for use by individuals with reduced physical, sensory, or mental capabilities, or those lacking experience and knowledge, unless closely supervised and instructed by a responsible person.

**Adult Supervision Required:** Always supervise children near the appliance to ensure they don't play with it.

**Hot Surfaces:** Be careful around hot surfaces. Use handles and knobs to avoid burns from touching hot parts or spilled liquids.

**Prevent Electrical Shock:** Never immerse the cord, plug, or coffee maker in water or other liquids.

**Unplug When Not in Use:** Disconnect the appliance from the outlet when not in use and before cleaning. Allow it to cool before attaching/removing parts.

**Stable Operation:** Place the coffee maker on a flat, stable surface away from the edge of the counter to prevent tipping.

**Damaged Appliance:** Do not operate the appliance if the cord, plug, or the appliance itself is damaged. Contact customer service for repairs or replacements. Never attempt to repair a damaged appliance yourself.

## IMPORTANT SAFEGUARDS

---

**Approved Accessories:** Only use attachments recommended by the manufacturer to avoid potential injuries.

**Outdoor Use:** This appliance is for indoor use only.

**Cord Safety:** Avoid letting the cord hang over counters or touch hot surfaces.

**Heat Source Safety:** Do not place the appliance near or on a hot gas/electric burner or in a heated oven.

**Moving Parts:** Keep hands clear of moving parts during operation.

**Secure Front Lid:** Ensure the Front Lid is securely latched during brewing.

**Power Off Before Unplugging:** Turn off the coffee maker and wait for the indicator light to go off before removing the plug from the outlet.

**Proper Unplugging:** Grasp the plug itself when unplugging, not the cord.

**Storage:** Never store the coffee maker in a cabinet while it's hot.

**Prevent Sprays:** To avoid hot water sprays, do not open the Front Lid while brewing.

**Intended Use Only:** Use the appliance only for its intended purpose.

## IMPORTANT SAFEGUARDS

### SAVE THIS INSTRUCTION BOOKLET

For electronic instruction booklet, please contact Gevi support team.

#### North American models with grounded plugs:



#### Polarized Plug

This machine has a polarized plug, (one blade is wider than the other). As a safety feature to reduce the risk of electrical shock, this plug is intended to fit in a polarized outlet only one way.

If the plug does not fit fully in the outlet, reverse the plug. If it still does not fit, contact a qualified electrician. Do not attempt to defeat this safety feature or modify the plug in any way. If the plug fits loosely into the AC outlet or if the AC outlet feels warm do not use that outlet.

#### Power Cord Instructions:

A short power-supply cord (or detachable power-supply cord) may be provided to reduce risks resulting from becoming entangled in or tripping over a longer cord. Longer detachable power-supply cords or extension cords are available and may be used if care is exercised in their use. If a long detachable power-supply cord or extension cord is used:

- a. The marked electrical rating of the detachable power-supply cord or extension cord should be at least as great as the electrical rating of the machine.

## IMPORTANT SAFEGUARDS

- b. If the machine is of the grounded type, the extension cord should be a grounding type cord.
- c. The longer cord should be arranged so that it will not drape over the counter top or table top where it can be pulled on by children or tripped over unintentionally.

Do not pull, twist or otherwise abuse the power cord.

#### Product Notices:

1. Place the machine on a hard, flat, level surface to avoid interruption of airflow underneath the machine.
2. Do not operate the machine with an empty water tank.

## GET YOUR COFFEE MAKER READY

### Unpacking

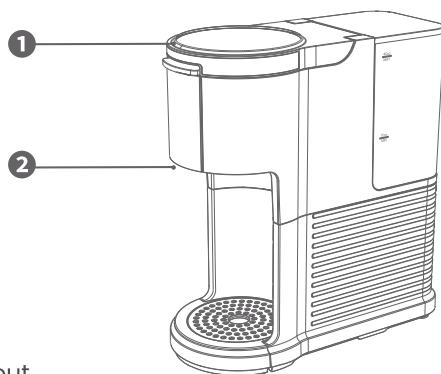

**Gevi Single Serve Brewer**

- 1 Front Lid
- 2 Brew Sprout



#### Resuable K-Cup Filter

Comes fully installed in the Capsule Adapter. Must be used with the Capsule Adapter.



#### Capsule Adaptor

Comes fully installed in the brewer. Must be in the brewer when brewing capsules.



#### Ground Coffee Brew Basket

Comes fully assembled. Must be inserted when brewing grounds.



#### Water Reservoir

Removable water reservoir with a MIN mark of 15oz and a MAXmark of 40oz.

## GET YOUR COFFEE MAKER READY

### Know Your Coffee Maker

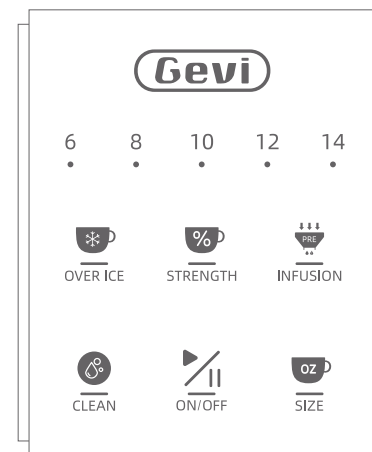

**Touch Control Panel**



#### SERVING SIZE INDICATOR LIGHT

Indicating the selected serving size.



#### OVER ICE STYLE

Brew hot coffee over ice.



#### STRENGTH STYLE

Brew stronger coffee.



#### INFUSION STYLE

Pre-infuse coffee to extract more flavors.



#### CLEAN FUNCTION

Clean and descale.



#### POWER & OPERATION

On and off, start and end any process.



#### SERVING SIZE

Choose from 6oz to 14oz to serve your needs.

## BEFORE FIRST USE

1. Remove all packaging materials from within and around the brewer.
2. Rinse all the accessories with soap water and dry with damp cloth.
3. Fill the water reservoir to the Max line with fresh water.
4. Plug the machine into an outlet and turn it on with “ON/OFF”.
5. Place a large mug which can hold at least 10 oz of liquid beneath the brew spout.

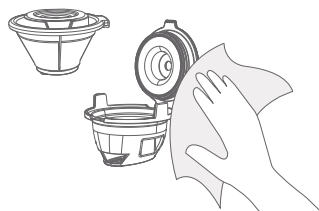

Figure 1



Figure 2

6. Ensure the front lid is closed and securely latched.
7. Once the coffee maker is activated (Figure 2), hit the “ON/OFF” to start the cleansing brew.
8. Once the brew is complete, discard the water and do it again.
9. Discard the water from the second brew, you're ready to go.



Water in the tank must be between MIN and MAX mark.

## BREWING COFFEE

1. Fill the water reservoir to the **Max line** with cold water and plug in the coffee maker.
2. Insert your K-cup into the adapter or add ground coffee to the brew basket. Lock the front lid otherwise it won't start brewing.

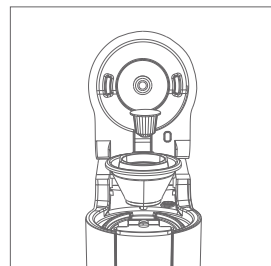

Insert K-cup into capsule adapter then to brew compartment.

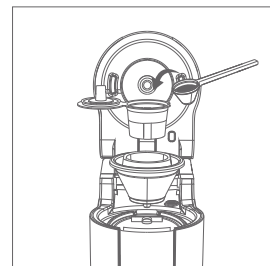

Add coffee (2 tsp) into reusable K-Cup filter, then to capsule adapter.

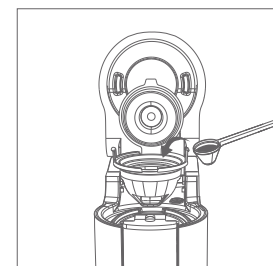

Add coffee (3 tsp) to ground coffee basket then to the brew compartment.

3. Press “ON/OFF” to activate the machine. Wait for 1-2 seconds until only “ON/OFF” and “SIZE” stay on.
4. Press “SIZE” to choose your desired size for coffee.
5. Press “OVER ICE” or “STRENGTH” or “INFUSION” for brewing styles.
6. Press “ON/OFF” to start brewing. “ON/OFF” shines breathing during brewing. Brewing is complete when “ON/OFF” and “SIZE” are constantly on.



Ensure front lid is securely latched during brewing.

## CARE & CLEANING INSTRUCTIONS

Descaling is needed when the descaling indicator lights up.

### Descale

**To cancel the reminder, press the "Clean" and the descale reminder will continue next time.**

1. Empty the Coffee Maker. Make sure there are no coffee pods or leftover water in the brewer.
2. Prepare the Descaling Solution (Gevi Coffee Maker Descaler) and dissolve it in cold water in a separate container.
3. Pour the descaling solution into the water tank up to the "MAX" fill line.
4. Hold "Clean" to start the descaling process.
5. During the descaling cycle, the "Clean" light flashes.
6. Once the cycle is complete, discard the used descaling solution.
7. Fill the water tank with fresh, clean water up to the "MAX" fill line.
8. Repeat the descaling cycle (steps 4-5) two to three times with just clean water to remove any leftover descaling solution residue.
9. Wipe down any external surfaces that might have come into contact with the descaling solution.

#### Note

1. Never use undiluted vinegar, as it can damage the machine.
2. The descaling cycle may take 30 minutes.

## TROUBLESHOOTING GUIDE

### Brewer Does Not Have Power

- Check if the coffee maker is plugged into a working outlet. Ensure the power cord is not damaged or frayed.
- Reset the coffee maker by unplugging it and plugging it back in.

### Brewer Will Not Brew

- Check if the water reservoir is empty.
- Clean the needle inside the adaptor and adaptor compartment.

### Brewer Leaking

- Tighten the adaptor compartment properly.
- Check if the water reservoir is overfilled.
- Clean the gasket around the water reservoir.

### Brewer Making Loud Noises

- Descale the coffee maker by running descaling solution through it.
- Check if there is any foreign object stuck inside the machine.
- Contact GEVI CUSTOMER SUPPORT for further assistance.

### Additional Tips

- Regularly descale the coffee maker to prevent mineral buildup.
- Clean the adaptor compartment and the outside of the machine regularly.
- Avoid overfilling the water reservoir or using a adaptor that is too large.

If you encounter any other problems or the troubleshooting steps do not resolve your issue, please contact GEVI CUSTOMER SUPPORT for further assistance.

## TECHNICAL PARAMETERS

Model:	SSCMA0
Voltage:	120V
Frequency:	60Hz
Watt:	1000W
Net Weight:	1.8kg
Gross Weight:	2.7kg
Color	Black
Product Size:	11.1*5.5*12.1 inch

## CUSTOMER SUPPORT

### Gevi Official Website

Website anytime, anywhere. You can also get more information about Gevi via. Have a question or need assistance with your appliances? Visit Gevi's Official [www.gevi.com](http://www.gevi.com).

### Gevi Official Hotline

Wish to speak with someone? Call [855-9922-888](tel:855-9922-888) during 9:00 AM to 5:00 PM Pacific Standard Time (PST).

### Gevi Official Email

To describe your issue in detail, write to us at [service@gevi.com](mailto:service@gevi.com).

## WARRANTY

### [www.gevi.com](http://www.gevi.com)

Warranty service is provided by Gevi Customer Service Center. To contact customer service team, visit our website at [www.gevi.com](http://www.gevi.com), email at [service@gevi.com](mailto:service@gevi.com) or call Gevi at [855-9922-888](tel:855-9922-888).

#### Note

A valid proof of purchase is required for warranty service.

#### Period

#### Gevi Will Replace

30 Days  
From the date of  
original purchase

Whole unit if the coffee machine  
fails due to a defect in materials  
or workmanship

1 Year  
From the date of  
original purchase

Any part of the coffee machine  
which fails due to a defect in  
materials or workmanship

### Warranty Extension

Register your warranty at  
[www.gevi.com/pages/warranty-registration](http://www.gevi.com/pages/warranty-registration)  
to receive 3 months warranty extension for FREE.



Warranty Register

# WARRANTY



**WARNING:** This product can expose you to chemicals including Lead and Bisphenol A (BPA) , which are known to the State of California to cause birth defects or other reproductive harm. For more information go to [www.P65Warmings.ca.gov](http://www.P65Warmings.ca.gov).



**ADVERTENCIA:** Este producto puede exponerlo a sustancias químicas, incluidos el plomo y el bisfenol A (BPA), que según el estado de California causan defectos congénitos u otros daños reproductivos. Para obtener más información, visite [www.P65Warmings.ca.gov](http://www.P65Warmings.ca.gov).



## Environmental Protection Treatment

You can help protect the environment!

Strictly follow the rules: please dispose of your waste electrical equipment at the appropriate waste stations!



## Tratamiento para la Protección del Medio Ambiente

¡Cuida el medio ambiente! Deposita tus residuos de aparatos eléctricos en los puntos de reciclaje designados.

