

NEED HELP? TALK TO US! CUSTOMER SUPPORT

Email: support@jafanda.com

Web: www.jafanda.com

1309 Coffeen Avenue STE 4304 Sheridan, Wyoming 82801

Designed by JAFANDA in America,Made in China



JAFĀNDA

JF100-Air Purifier User Manual

Please read the manual carefully and keep it for future reference.
Thank you for choosing us!

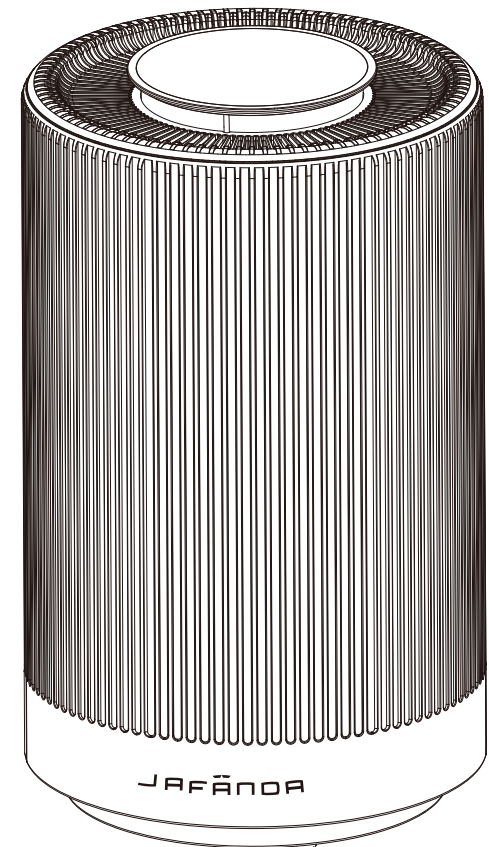

THANK YOU FOR YOUR PURCHASE!

Contact our support team by Email:
support@jafanda.com

Join the jafanda Community on Social Media



@JAFANDA US

Contents

Specifications	3
Package contents	3
General safety	3
Safe use & care	4
Assembly	4
Multi-function in one	4
Controls panel	5
Care and maintenance	6
Change your filter	6
About the filter	7
Troubleshooting	8
Warranty	8
Customer support	9

SPECIFICATIONS

Thank you for purchasing the jafanda Air Purifier , Please read this manual carefully and keep it for future reference. If you need any assistance, please contact our support team with your product model number and Amazon order number.

Product name	Air Purifier	Dimensions	7.95 x 7.95 x 15.15 in /20 x 20 x38 cm
Power Adapter (Input)	100-240V~ 50/60Hz	Weight	3.3lb/1.5kg
Power Adapter (Output)	12V---1A	Standby Power	< 0.5W
Rated Power	10W	Filter life time	6 months(standard environment)
Noise Level	23-43dB	Operating Conditions	Temperature: 14 °F-104 °F/-10 °C-40 °C Humidity: 20%-95% RH

PACKAGE CONTENTS

1× Air Purifier	1 x AC Power Adapter
1× Filter in Air Purifier	1× User Manual

GENERAL SAFETY

DO NOT block the air inlet/outlet

DO NOT operate this appliance if it has a damaged power cord or plug.

DO NOT operate this appliance if it malfunctions or is damaged in anyway. Contact customer service if any part of this appliance is damaged.

DO NOT immerse any part of the appliance, power cord, or plug in water or other liquids.

Always unplug from outlet when not in use, before putting on or taking off parts, and before cleaning.

DO NOT use of attachments not recommended by jafanda may cause fire, electric shock or risk of injuries.

DO NOT use this Air Purifier as a toy. Close supervision is required when being used near or by children.

DO NOT use it in areas with oily smoke or high humidity in the bathroom

SAFE USE & CARE

Please be careful when cleaning the air purifier. Strong corrosive cleaning agents will damage the surface of the machine

Only use this appliance for its intended use as described in this manual.

DO NOT use the Air Purifier on flames, hot plates or stoves.

DO NOT expose to heat source.

Remove the filter PE bag

ASSEMBLY

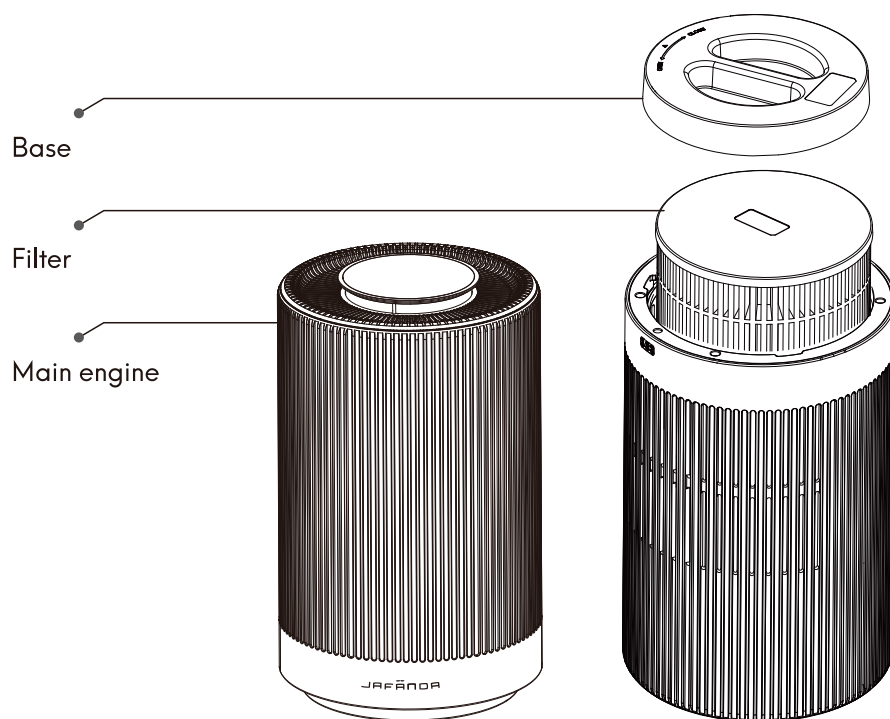

MULTI-FUNCTION IN ONE

1. Efficiently purify PM2.5, smog, pollen and other particulate pollutants
2. Filter 3 airflow speed
3. Main engine

CONTROL PANEL

	Power button	Touch "⏻" to turn on, the button icon lights become all white, and the airflow defaults to the first gear operation. In the working state , touch "⏻" again and the machine enters the standby state, the power button and timer button icon lights will be half-lit, the rest icon lights will be off.
	Fan speed	Touch "🌀" to increase and decrease the airflow speed from Lv1, Lv2 and Lv3.
	Sleep mode	In Night mode, your appliance will continue to purify the air, but only runs on its quietest setting and with its LCD screen dimmed. In the working state , touch "🌙" to enter sleep mode, and touch it again to wake up the machine. When the icon lights are all off, you need to touch any key to lift the sleep button and then touch "🌙" to wake up the machine.
	Safety lock	To prevent accidental touch by children and pets. Long-press "🔒" for 3+ seconds to lock, during which all button icons are off and the control panel cannot be operated by touch, only the safety lock stays lit. Long-press "🔒" for 3+ seconds to unlock, other button icons resume to light up.
	Timer switch	Your appliance will automatically turn OFF/ON after the selected time. In the standby state , touch "🕒" to active automatic turn on, In the working state , touch "🕒" to active automatic turn off. To set time: touch "🕒" 4 times to select (2h/4h/8h/cancel timing) respectively.
	Ambient light	The ambient light at the bottom of the machine will turn on slowly and then go out every time you reconnect the adapter and then power on. In the working state , touch the "💡" to adjust brightness. When it goes into standby state , the previous light settings will be memorized, and the next time you turn it on, it will directly enter the previous light mode. 5 light modes in turn: ①25%-②50%-③100%-④icon lights and ambient light OFF-⑤icon lights ON and ambient light OFF
	Filter reset button	The filter lifespan is 2000 hours, when the remaining time of the filter life is less than 150 hours, the filter icon light flashes orange , prompting the user to replace the filter. After replacement, you need to long-press "🔄" for 5+ seconds, the light turns white and the filter time will be cleared and retimed. If not, the filter icon light will flash orange every time the device is turned on. It is not allowed to reset when the filter life is > 150 hours. Mandatory filter life reset method: In the standby state long press "⏻" + "🔄" for 5+ seconds, all the button icon lights flash 6 times and then go out to indicate that the filter life reset is complete

CARE AND MAINTENANCE

To always get the best performance from your appliance, it is important to regularly clean it and check for blockages.

Changing your filters: The display on your appliance and Filter reset button will indicate when to change your filters. Order new filters on the www.jafanda.com. Your new filters will come with instructions, go online for further support and videos.

Do not use your appliance without the filters in place. Unplug your appliance from the mains electricity supply before cleaning or changing filters.

Error codes: If your appliance shows an error code, try turning it off and then on again. If this does not clear the error code contact Jafanda Customer Care. For further information and support about the care and maintenance of your appliance and replacing the filters go to www.jafanda.com.

CHANGE YOUR FILTER

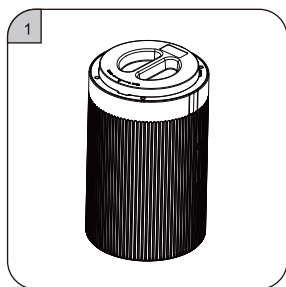

Rotate to open according to the product identification instructions

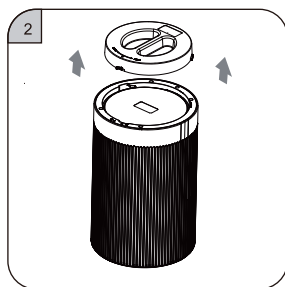

Remove the base

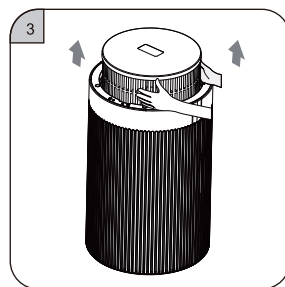

Take out the new filter with plastic film inside the body

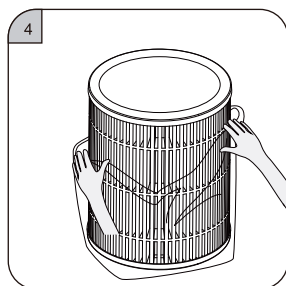

Remove all plastic film on the filter

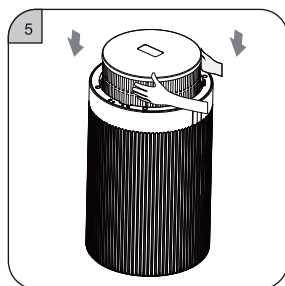

Load new filter

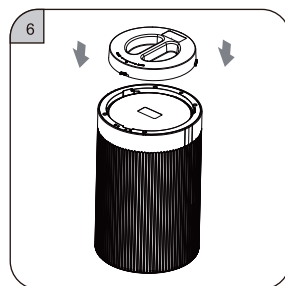

Cover the base, and then ready to turn on to use, go back to control panel and press "⏻".

ABOUT THE FILTER

The air purifier uses a 3-stage filtration system to purify air

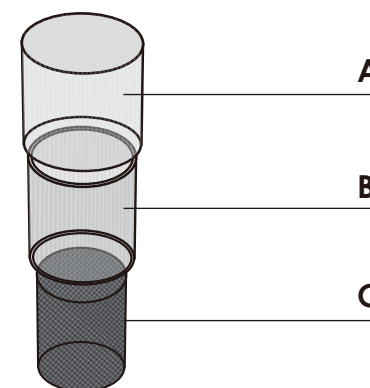

A. Pre-Filter

- Captures large particles such as lint, fibers, hair, and pet fur.
- Maximizes the filter's life by protecting it.

B. True H13 HEPA Original Filter

- Removes at least 99.97% of airborne particles 0.3 micrometers (μm) in diameter.
- Filters small particles such as mold spores, tiny dust particles, parts of smoke, and allergens such as pollen, dander, and mites.

C. High-Efficiency Sponge Carbon Filter

- Physically adsorbs smoke, odors, and fumes.

TROUBLESHOOTING

Problem	Solution
Product not working	1. Check whether the plug is inserted into the socket, whether turn on the power button. 2. Reinstall the filter.
Fresh air cannot be sent out smoothly from the air outlet	1. Please unpack the plastic packaging first. 2. Clean foreign matter.
Poor odor removal	Please replace the jafanda filter .
The machine makes an unusual sound when it's running	1. Please remove obstructing objects. 2. Clean foreign matter.

WARRANTY

jafanda provides 1-year product warranty from the date of the purchase for all our products. We will take care of all quality-related issues with a REPLACEMENT or FULL REFUND including any return shipping costs. If your product is defective and under warranty, please contact us at Email: support@jafanda.com.

Please carefully follow our warranty process to minimize any delays:

1. Note the product model name. It can be found on a sticker located underneath or on the back of the product.

2. Provide the order number for a purchase made through Amazon.

The typical turn around time to address Warranty claims is 14 business days, depending on your geographical location and type of damage or Warranty claim.

This warranty does not apply to the following:

Damage due to abuse, accident, alteration, misuse, tampering, or vandalism.

Improper or inadequate maintenance.

Damage in return transit.

Unsupervised use by children under 18 years of age.

Extend Your Warranty by 1 Year

Register your product at www.jafanda.com/pages/warranty to extend your 1-year warranty by an additional year. Please fill out all required fields and include your order ID, place of purchase, and purchase date, if applicable.

CUSTOMER SUPPORT

jafanda assumes no liability for damage caused by the use of the product other than for its intended use or as instructed in the user manual. Some states DO NOT allow this exclusion or limitation of incidental or consequential losses so the foregoing disclaimer may not apply to you. This warranty gives you specific legal rights and you may also have other rights that may vary from state to state.

Any issues or questions regarding your new product, please feel free to contact our Customer Support Team.

Customer Support

Email: support@jafanda.com

*Please have your order number ready before contacting Customer Support