

1

1.1.0

Installation

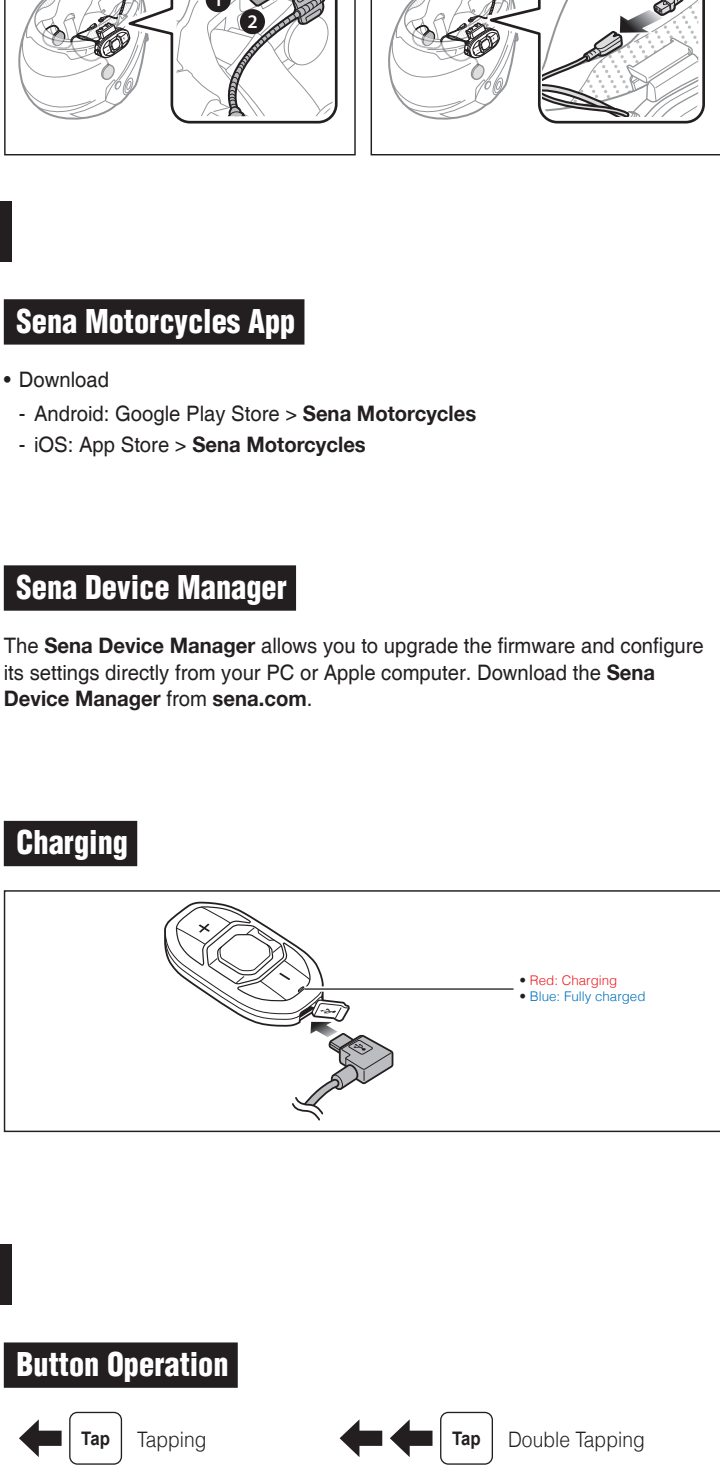

2

Sena Motorcycles App

- Download
- Android: Google Play Store > **Sena Motorcycles**
- iOS: App Store > **Sena Motorcycles**

Sena Device Manager

The **Sena Device Manager** allows you to upgrade the firmware and configure its settings directly from your PC or Apple computer. Download the **Sena Device Manager** from sena.com.

Charging

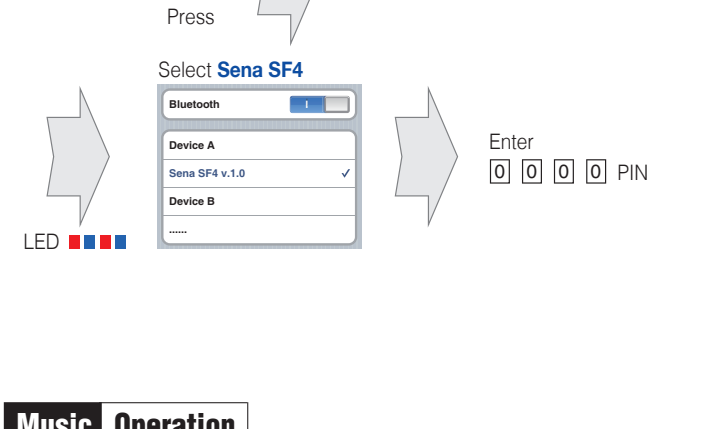

3

Button Operation



Power On/Off

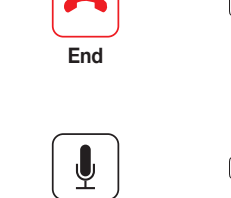

Volume Adjustment

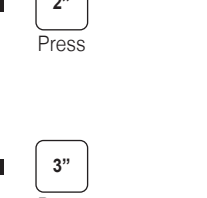

Battery Check



4

Phone, Music Pairing

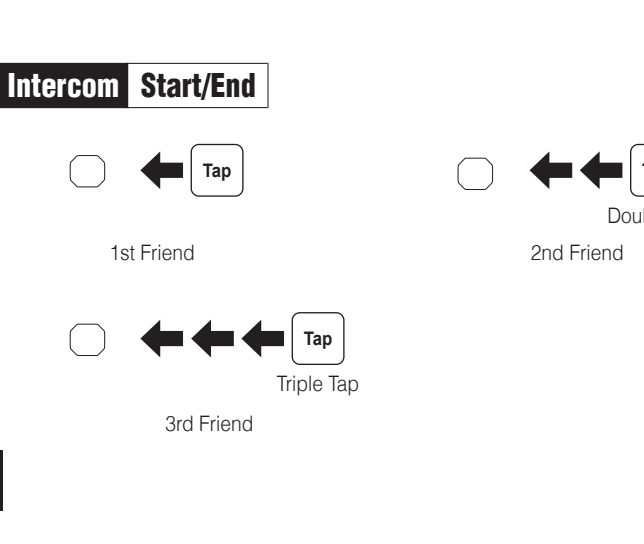

Music Operation



5

Mobile Phone Call Making and Answering

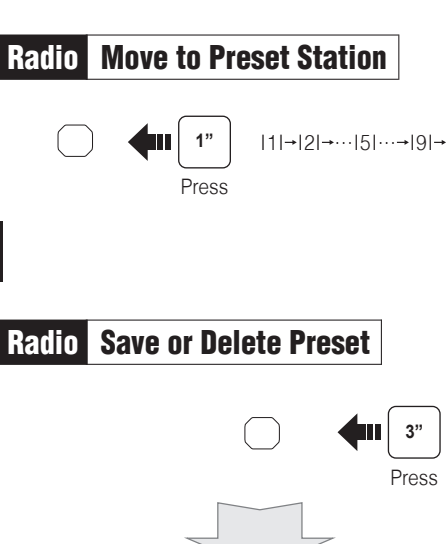

6

Intercom Pairing

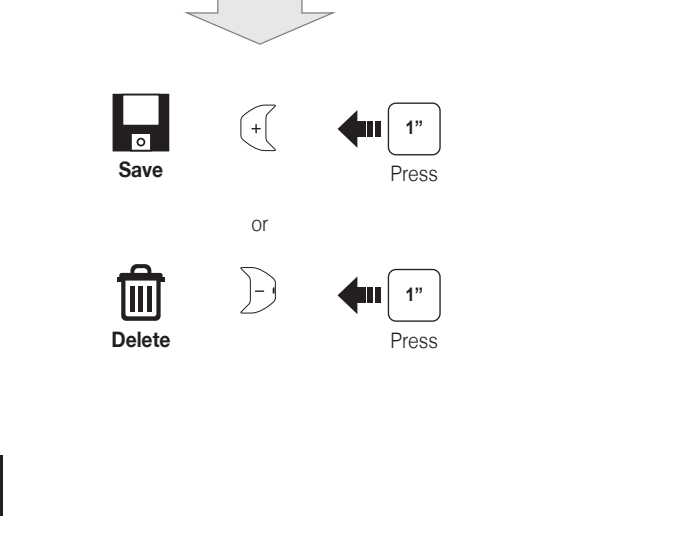

Intercom Start/End

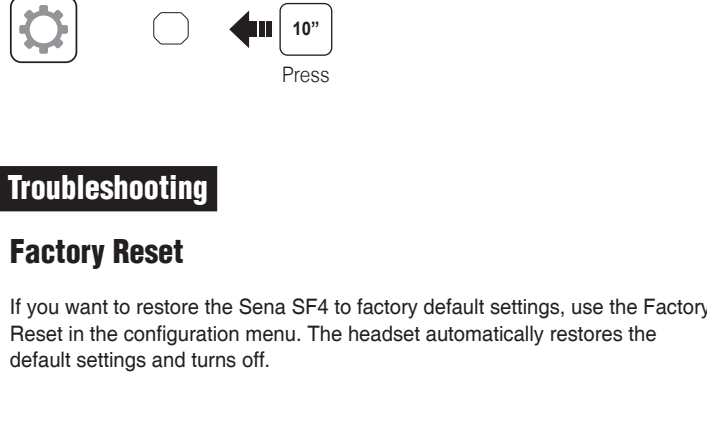

7

Radio On/Off



Radio Seek Stations

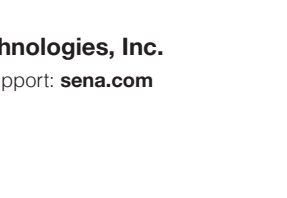

Radio Scan Up FM Band

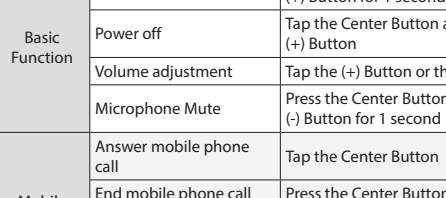

Radio Move to Preset Station

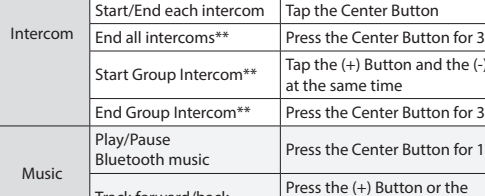

8

Radio Save or Delete Preset



9

Setting

Configuration Menu

Troubleshooting

Factory Reset

If you want to restore the Sena SF4 to factory default settings, use the Factory Reset in the configuration menu. The headset automatically restores the default settings and turns off.

Fault Reset

If the Sena SF4 is not working properly for any reason, reset by gently pushing the pin-hole reset button on the back of the main unit.

SENA Technologies, Inc.
Customer Support: sena.com

SF Series Quick Reference

Type	Operation	Button Command	LED
Basic Function	Power on	Press the Center Button and the (+) Button for 1 second	Solid blue
	Power off	Tap the Center Button and the (+) Button	Solid red
	Volume adjustment	Tap the (+) Button or the (-) Button	-
	Microphone Mute	Press the Center Button and the (-) Button for 1 second	-
Mobile Phone	Answer mobile phone call	Tap the Center Button	-
	End mobile phone call	Press the Center Button for 2 seconds	-
	Speed dial	Press the Center Button for 3 seconds	-
	Voice dial	Press the (+) Button for 3 seconds	-
	Reject incoming call	Press the Center Button for 2 seconds	-
Intercom	Intercom pairing	Press the Center Button for 5 seconds	Red flashing
	Start/End each intercom	Tap the Center Button	-
	End all intercoms**	Press the Center Button for 3 seconds	-
	Start Group Intercom**	Tap the (+) Button and the (-) Button at the same time	Green flashing
	End Group Intercom**	Press the Center Button for 3 seconds	-
Music	Play/Pause Bluetooth music	Press the Center Button for 1 second	-
	Track forward/back	Press the (+) Button or the (-) Button for 1 second	-
FM Radio*	FM radio on/off	Press the (-) Button for 1 second	-
	Select preset	Press the Center Button for 1 second	-
	Seek stations	Double tap the (+) Button or the (-) Button	-
	Scan up FM band	Press the (+) Button for 1 second	-
	Stop scanning	Press the (+) Button for 1 second	-
	Save preset while scanning	Tap the center Button	-

* Available in SF2 and SF4

** Available only in SF4