

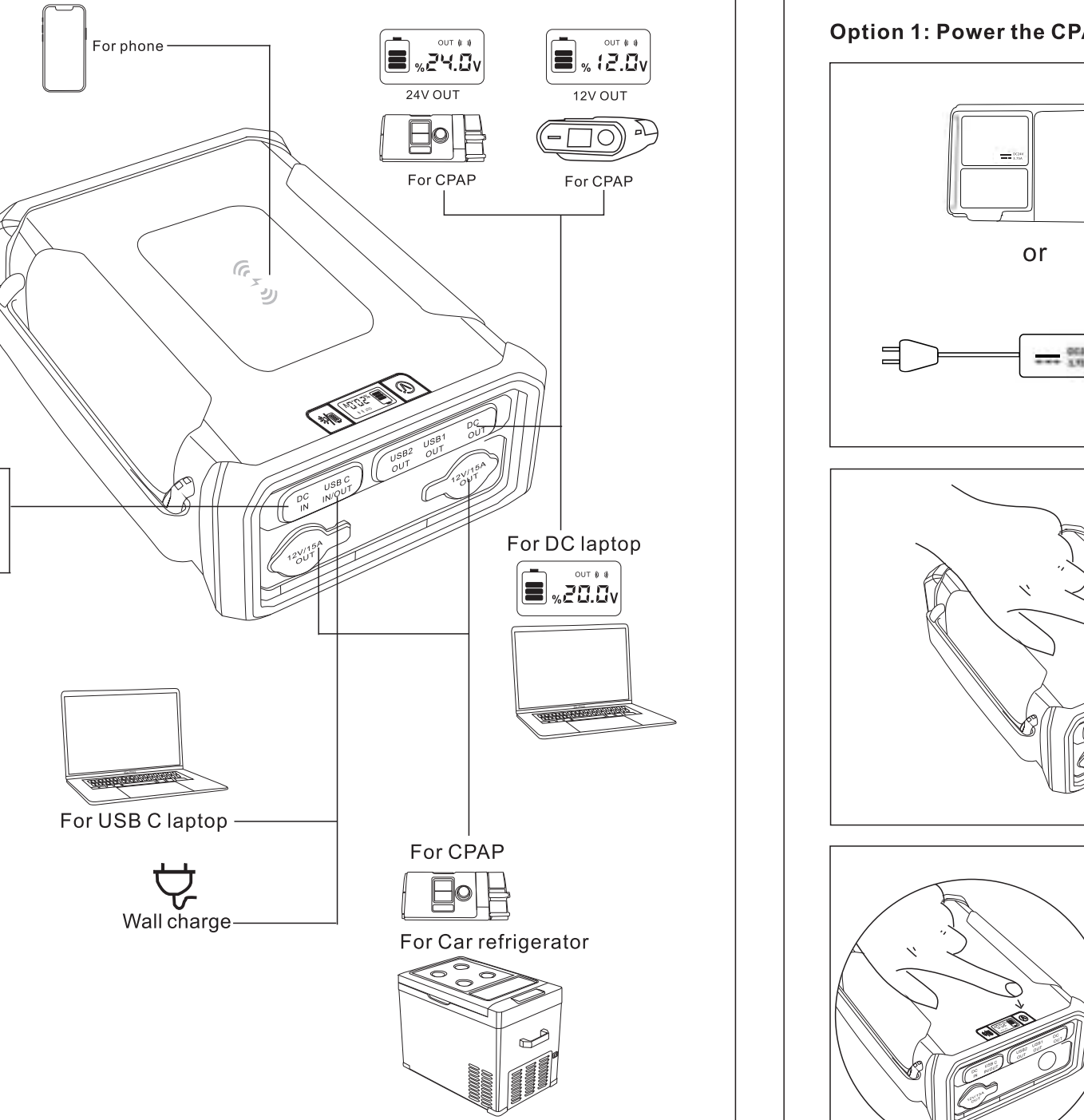

CPAP BATTERY BACKUP USER'S MANUAL

- Easy Charge, Longer Power -
For more information visit our support page at www.easyleonger.com
Lifetime Customer Support: support@easyleonger.com



How to power the CPAP machine

Option 1: Power the CPAP machine via the DC output port.

1. Verify the operating voltage of the CPAP machine by checking the specifications label on the CPAP machine, the included adapter, or the user manual.

There are only 4 options for the DC output voltage of this battery: 12V, 16.5V, 20V, 24V.

Please ensure that your CPAP's operating voltage matches one of these options, otherwise, you won't be able to use the battery's DC port to power your CPAP, need to follow option 2 or option 3.

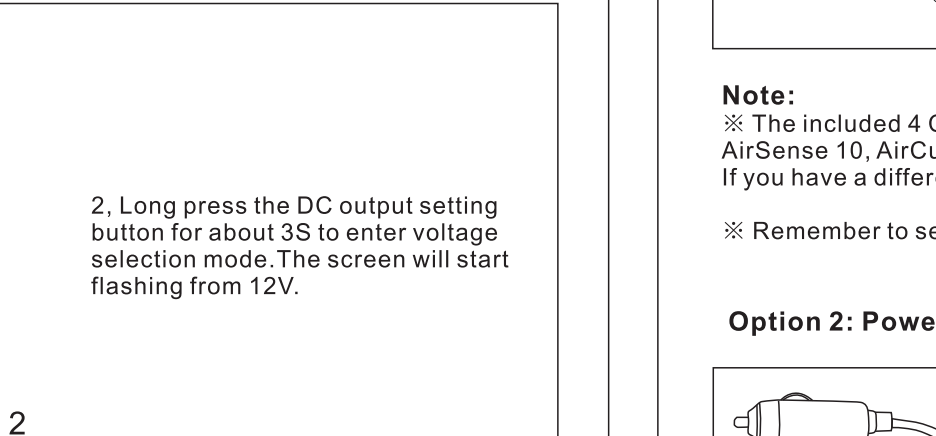

2. Long press the DC output setting button for about 3S to enter voltage selection mode. The screen will start flashing from 12V.

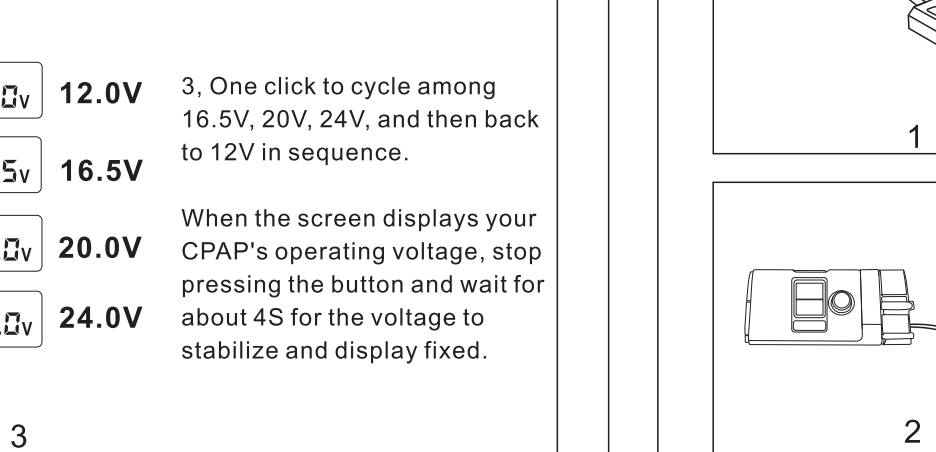

3. One click to cycle among 16.5V, 20V, 24V, and then back to 12V in sequence.

When the screen displays your CPAP's operating voltage, stop pressing the button and wait for about 4S for the voltage to stabilize and display fixed.

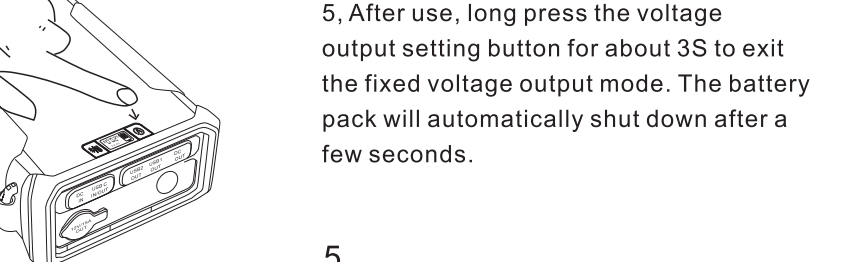
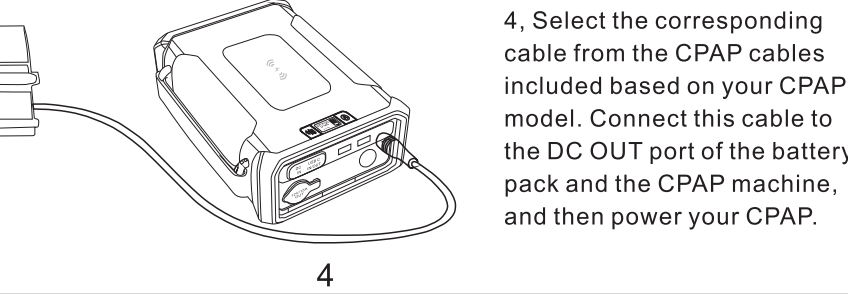

4. Select the corresponding cable from the CPAP cables included based on your CPAP model. Connect this cable to the DC OUT port of the battery pack and the CPAP machine, and then power your CPAP.

5. After use, long press the voltage output setting button for about 3S to exit the fixed voltage output mode. The battery pack will automatically shut down after a few seconds.

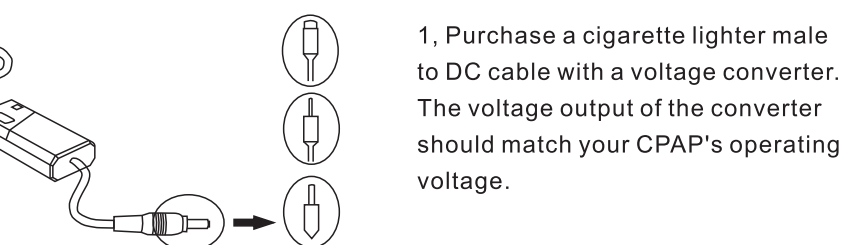

2. No need to set the voltage of the battery pack. Simply connect the battery pack to your CPAP, and it will power your CPAP.

After use, unplug the cable, and the battery pack will automatically shut down soon.

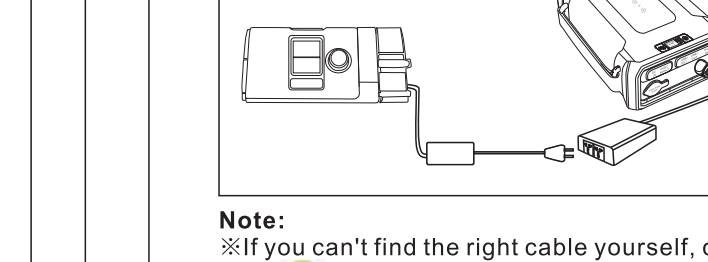
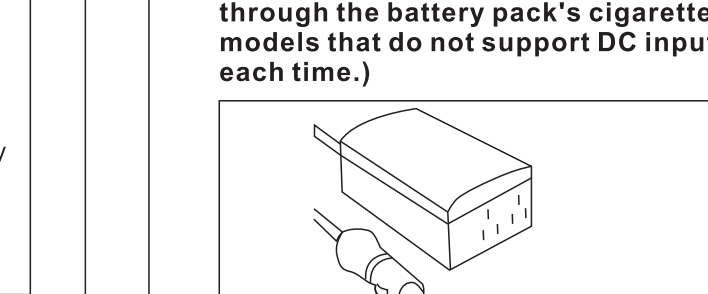

5. After use, long press the voltage output setting button for about 3S to exit the fixed voltage output mode. The battery pack will automatically shut down after a few seconds.

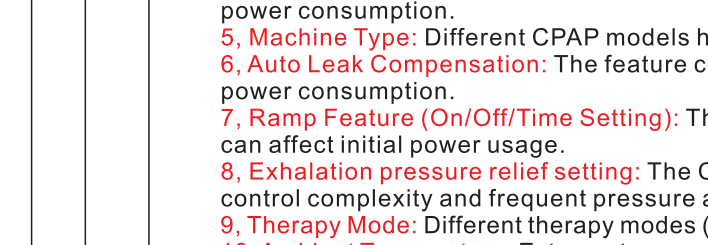
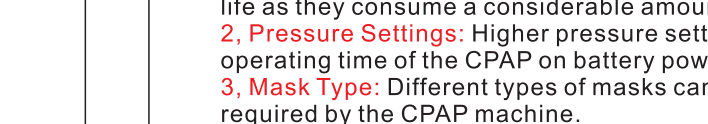

2. No need to set the voltage of the battery pack. Simply connect the battery pack to your CPAP, and it will power your CPAP.

After use, unplug the cable, and the battery pack will automatically shut down soon.

Option 3: Power the CPAP by using the CPAP machine's included AC adapter through the battery pack's cigarette lighter port. (Applicable for CPAP machine models that do not support DC input or users who don't want to set the voltage each time.)

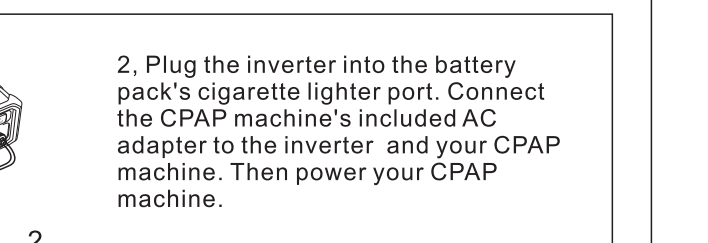
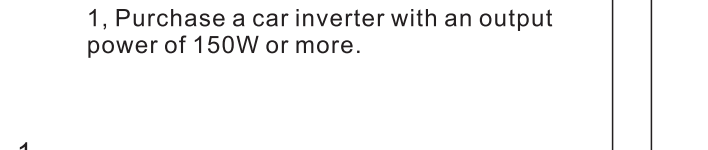

1. Purchase a car inverter with an output power of 150W or more.

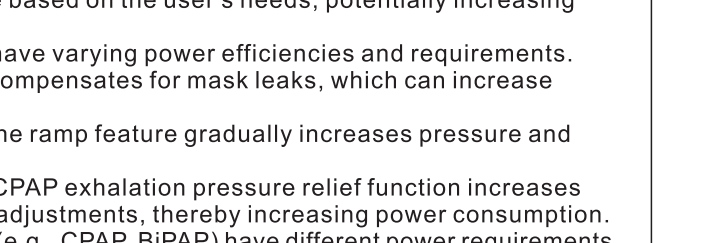
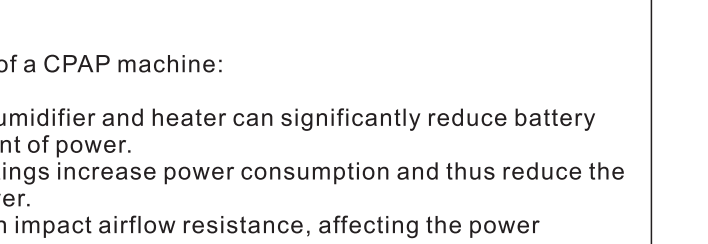

2. Plug the inverter into the battery pack's cigarette lighter port. Connect the CPAP machine's included AC adapter to the inverter and your CPAP machine. Then power your CPAP machine.

Note:

※ If you can't find the right cable yourself, contact us and we will recommend the right cable for you. support@easyleonger.com

※ Factors affecting CPAP runtime:

Several factors can influence the runtime of a CPAP machine:

- Humidifier and Heater Use:** Using the humidifier and heater can significantly reduce battery life as they consume a considerable amount of power.
- Pressure Settings:** Higher pressure settings increase power consumption and thus reduce the operating time of the CPAP on battery power.
- Mask Type:** Different types of masks can impact airflow resistance, affecting the power required by the CPAP machine.
- Auto Mode:** Auto mode adjusts pressure based on the user's needs, potentially increasing power consumption.
- Machine Type:** Different CPAP models have varying power efficiencies and requirements.
- Auto Leak Compensation:** The feature compensates for mask leaks, which can increase power consumption.
- Ramp Feature (On/Off/Time Setting):** The ramp feature gradually increases pressure and can affect initial power usage.
- Exhalation pressure relief setting:** The CPAP exhalation pressure relief function increases control complexity and frequent pressure adjustments, thereby increasing power consumption.
- Therapy Mode:** Different therapy modes (e.g., CPAP, BiPAP) have different power requirements.
- Ambient Temperature:** Extreme temperatures can impact battery efficiency and CPAP operation.
- User's Breathing Habits:** Variations in breathing patterns can affect the CPAP's power usage.
- Altitude:** Higher altitudes can affect air density and pressure requirements, influencing power consumption.
- Bluetooth/App/Wireless:** These features involve sending and receiving data, running continuously in the background to monitor and control the status of the respiratory device, and constantly searching for available signals and connections, all of which increase power consumption.
- Battery Capacity:** A higher-capacity battery can provide longer operating times.
- Smart start/stop feature:** The CPAP device's function requires the CPAP device to continuously monitor, execute algorithmic computations, utilize sensors, and provide real-time responses, resulting in additional energy consumption.
- Other influencing factors.

LED display

Click the power button ① to activate the wireless charging function.

Battery level:



※ When recharging the battery pack: The LED screen will display "IN", and the corresponding bar graph for the battery level will blink. When the battery is fully recharged, all 4 bars will keep lighting.

※ When charging the device: The LED screen displays "OUT", and as the battery level decreases, the bars will disappear one by one.

How to recharge the battery pack

There are 4 options for recharging the battery pack:



1. Using the included AC adapter.

Charging time: 5-6 hours.

2. Using a 60W+ charger and E-Marker USB C cable.

Charging time: 6-7 hours.

3. Using a 100W+ output solar panel.

Charging time: 4-5 hours.

4. Recharging the battery pack with a vehicle.

※ Most vehicles use a 12V system, but the ES960 DC port input voltage range is 18-24V, so it cannot be charged directly from the DC port. The ES960 DC input plug size is 5.5mm*2.1mm.

If not using the included AC adapter to charge the battery pack, please confirm that your other chargers or solar panels meet the requirements before charging.

Under the same settings and usage conditions, power consumption will be as follows: Travel/Mini CPAP < CPAP machine < Automatic Positive Airway Pressure (APAP) < BiLevels & BiPAP.

By considering these factors, you need to estimate the expected runtime of their CPAP machine and plan accordingly, such as ensuring they have sufficient battery capacity for overnight use or adjusting settings to optimize power efficiency.

Note: The screen displays a range of battery levels, and since the State of Charge (SOC) estimation of current LiFePO4 batteries can be imprecise, it may not reflect the actual remaining battery power. If you are using the battery pack independently rather than as a UPS, please use the included AC adapter or an additional PD charger to charge the battery pack and check the actual remaining power. We strongly recommend fully charging it before use to avoid inaccurate estimates of remaining battery life, which could result in shorter-than-expected CPAP runtime, affecting your night's sleep or travel plans.

Our advise

Direct Connection to CPAP with included DC cables

1. AirSense 11, DreamStation 2, AirSense 10, AirCurve 10, AirMini, DreamStation, ResMed S9, ResMed CPAP.

Using a Cigarette Lighter Cable with a Voltage Converter

1. Luna G3 Auto, Luna 8 G3 Auto, ResMed AirSense, DreamStation G3, DreamStation 2, DreamStation 2, ResMed S9, ResMed CPAP.

Using an Inverter Connected to a Battery Pack

1. FFP SleepStyle Auto CPAP, Apnea Medical XT Auto, Devibrio Sleepcube, Lowenstein Prima 20A Auto, Prima SMART, Breathe 22 Travel, Prima SOFT, Luna Travel PAP.

Powering other devices

1. Both QC 3.0 USB1 and USB2 ports are compatible with various devices, including smartphones, tablets, cameras, and other digital devices.

2. The USB-C port can be used with most USB-C compatible laptops and devices (up to PD 60W).

3. Supports 12V devices under 150W, such as car refrigerators, air pumps, drone batteries, outdoor tent lights, lamps, fishing lights, hunting lights, fans, etc.

Simply connect your device to the battery pack using a USB or cigarette lighter cable, and it will automatically start charging the device. If you encounter any issues with device charging, ensure that the data cable and port are connected correctly, and try pressing the power button. After use, turn off the device and unplug the cable.

Wireless charging

1. One click the power button to activate wireless charging.

2. The wireless charging indicator lights up.

3. Place your device that supports wireless charging in the wireless charging area.

Using pass-through charging functionality

※ 2 ways to use the pass-through function.

1. Connect the device via the DC port or cigarette lighter port.

2. Connect the device via the DC port or cigarette lighter port.

The battery can charge and discharge simultaneously. Use the included AC adapter to plug into the DC IN port or use a USB-C cable to connect a charger to the USB-C IN port of the battery pack. Then, use another cable to connect your device from the other output ports.

Note: When connecting a CPAP through the battery's cigarette lighter port, you must use a cigarette lighter male to DC cable with a voltage converter, and the output voltage of this converter must match your CPAP's operating voltage.

Connect two CPAP devices simultaneously

1. The battery can charge and discharge simultaneously. Use the included AC adapter to plug into the DC IN port or use a USB-C cable to connect a charger to the USB-C IN port of the battery pack. Then, use another cable to connect your device from the other output ports.

Note: When connecting a CPAP through the battery's cigarette lighter port, you must use a cigarette lighter male to DC cable with a voltage converter, and the output voltage of this converter must match your CPAP's operating voltage.

The battery pack's runtime will be significantly reduced when powering two CPAP devices simultaneously.

Emergency LED light

Warm Light: Press and hold the right power button for about 3 seconds to activate/deactivate the warm light.

White Light: Double press the right power button to activate/deactivate the white light.

Storage and operating temperature

Please use it under normal temperature in order to protect the battery life.

-- Storage temperature: -10~+35°C.

-- Operating temperature: Charging: 0~+60°C. Discharging: -10~+60°C.

FQA

Q1. How to turn off the battery pack?

A1: If the DC fixed voltage output mode is activated, long press for approximately 3 seconds to exit the DC fixed voltage output mode. The battery pack will automatically shut down after a few seconds. Otherwise, it will take approximately 2 hours to shut down.

Q2. Can this battery be taken on a plane?

A2: No, it cannot. Due to its capacity exceeding TSA limits and not being approved by TSA, it cannot be taken on a plane.

Q3. Can the battery charge and discharge simultaneously?

A3: Yes, the battery can charge and discharge simultaneously. This battery has a "pass-through charging" feature. It allows the battery to charge itself while simultaneously providing power to other devices through its output ports.

Warning

Before using this product, please read all instructions and warnings. Incorrect usage may damage the product or cause personal injury.

1. Not approved by airlines. Not allowed to be taken on airplanes.

2. Due to conversion efficiency, the battery capacity of the power bank does not represent the rechargeable capacity. For best results, please use the original charging cable of the charged device.

3. When storing the product, please keep it out of reach of children or pets.

4. The DC port and USB-C port share the same circuit, so these two ports cannot work simultaneously. The priority is given to the one that works first, and the other one will stop working.

5. When not in use, charge the battery pack once every 3 months to maintain at least 50% of the battery capacity to prevent battery damage from depletion.

6. Do not place the power bank in a high-temperature environment or throw it into a fire, as this may cause the power bank to swell or explode.

7. Do not immerse the power bank in liquid to avoid short-circuiting.

8. Do not use sharp objects or apply impact to the power bank, as this may cause overheating, fire, or explosion.

9. Do not attempt to dismantle or damage the battery pack structure—improper operations may cause the battery pack to overheat, catch fire, or explode.

10. Use specified or approved chargers for charging.

11. Please use the battery pack within the allowed temperature range.

12. If you notice any abnormal conditions such as heating, bulging, strange odors, leakage, deformation, etc., please stop using the power bank immediately and contact us.

Customer support

If you experience any problems with your ES960, we are here to help you resolve them quickly.

To expedite the process, please follow the template below when reaching out to us: Order number + description of the issue + attach pictures/videos if necessary. However, if you find that your EASYLENGER device is exhibiting abnormal behavior, we recommend that you immediately cease using the product and contact us for support at support@easyleonger.com.

Warranty

12-month warranty, plus an extra 12 months upon product registration on www.easyleonger.com

Note: This warranty is void if the defect is caused by

-- Damage caused by force majeure.

-- Accidental damage, misuse, abuse, neglect.

-- Improper repair or alteration by unauthorized persons.

-- Expired warranty period.

Instagram: https://www.instagram.com/easyleonger_Global/

Facebook: <https://www.facebook.com/easyleonger>

TikTok: <https://www.tiktok.com/@easyleonger>

Pinterest: <https://www.pinterest.com/easyleonger>

Twitter: <https://twitter.com/easyleonger/>

YouTube: <https://www.youtube.com/@easyleonger>

FC CE RoHS

UK CA PS

MADE IN CHINA