

## ORIGINAL OPERATING INSTRUCTIONS STEAM CLEANER

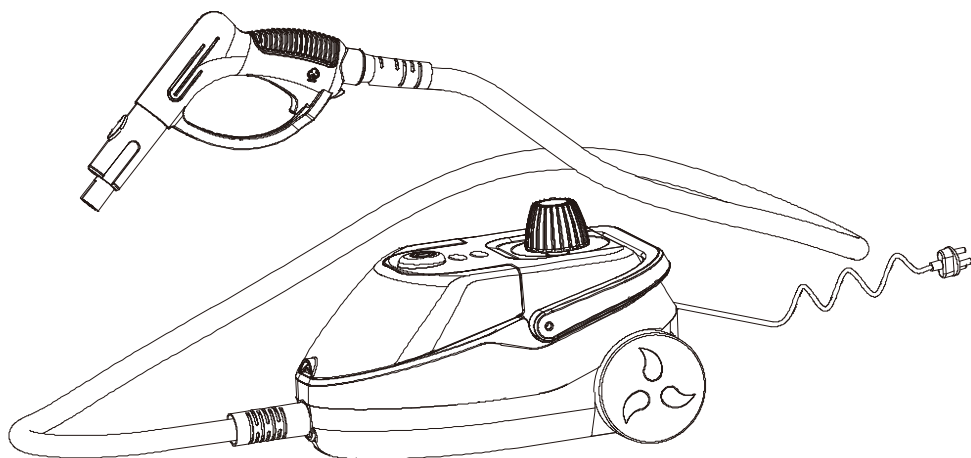

Thank you for buying a HAUSHOF STEAM CLEANER. It has been engineered and manufactured to HAUSHOF's high standard for dependability, ease of operation, and operator safety. When properly cared for, it will give you years of rugged, trouble-free performance.



**WARNING:** To reduce the risk of injury, the user must read and understand the operator's manual before using this products. HOUSEHOLD USE ONLY!

**SAVE THIS MANUAL FOR FUTURE REFERENCE**

Model#: JX-078



Distributed by:  
Hangzhou GreatStar Industrial Co., Ltd.  
No.35 Jiuquan Road, Shangcheng District,  
Hangzhou 310019, China  
[www.greatstartools.com](http://www.greatstartools.com)  
MADE IN CHINA

## Attentions

### IMPORTANT SAFEGUARDS

When using an electrical appliance, basic precautions should always be followed, including the following:

READ ALL INSTRUCTIONS BEFORE USING THIS UNIT

#### Warning:

Risk of electric shock!

A faulty electrical installation, excessive line voltage, or incorrect operation may result in an electric shock.

- Only connect the steam cleaner if the line voltage of the socket corresponds to the data on the rating plate.
- Only connect the steam cleaner to an easily accessible socket so that you can quickly disconnect the steam cleaner from the mains supply in the event of a fault.
- Do not operate the steam cleaner if it is visibly damaged or if the mains cord or mains plug is defective.
- If the mains cord of the steam cleaner is damaged, the manufacturer, its after sales support or a person with similar qualifications must replace it to avoid risks.
- Do not open the housing; instead, have a qualified professional carry out the repairs. Contact a qualified workshop for this. Liability and warranty claims are waived in the event of repairs performed by the user, improper connection or incorrect operation.
- Only parts that comply with the original device information may be used for repairs. Electrical and mechanical parts, which are essential for providing protection against sources of danger, are located in this steam cleaner.
- Do not operate the steam cleaner with an external timer or separate remote control system.
- Do not immerse the steam cleaner, the mains cord or mains plug in water or other liquids.
- Never touch the mains plug with damp hands.
- Never pull the mains plug out of the socket by the mains cord; instead, always do so by taking hold of the mains plug.
- Never use the mains cord as a carrying handle.
- Keep the steam cleaner, mains plug and mains cord away from open flames and hot surfaces.

- Lay the mains cord so that it does not pose a tripping hazard.
- Do not kink the mains cord and do not lay it over sharp edges.
- Only use the steam cleaner indoors. Never operate it in wet rooms or in the rain.
- Never store the steam cleaner so that it is at risk of falling into a bath tub or a basin.
- Never reach to retrieve an electrical device if it has fallen in water. In this case, immediately pull the mains plug out of the socket.
- Make sure that children do not insert any objects in the steam cleaner.
- Never leave the steam cleaner unsupervised! Always pull the mains plug out of the socket after use or if you interrupt work. The device will heat up and build up steam pressure as long as the mains plug is connected to the socket!
- Before filling the steam cleaner with water, cleaning it or changing accessories, pull the mains plug out of the socket.
- Never point the steam directly at electric devices or furnishings containing electric parts such as the inside of ovens.
- Only use the steam cleaners with dry hands and not without shoes (not barefoot). This will reduce dangerous body currents in the event of a fault.
- Never point the steam cleaner at objects that are sensitive to moisture.
- Keep children away from the steam cleaner and connection line.
- Never take the safety cap off as long as steam is still being emitted from the steam nozzle!
- Do not touch the hot parts of the steam cleaner with bare fingers during operation. Clearly advise other users of the risks!
- Keep in mind that hot steam is also able to escape from the steam cleaner after you have turned it off.

#### Attention:

- Let the accessories used cool off first before you remove them.
- Do not use the steam cleaner if it has fallen down, if there are any apparent damages or if it is leaky.
- Keep the steam cleaner away from children if it is switched on or is cooling down.

## Attentions

- Wear gloves, protective goggles and respiratory protection when attempting to remove substances that are harmful to health.
- Do not point the steam jet at other persons or animals. Hot steam can cause serious injury!
- First check an inconspicuous area as to whether the material you intend to clean is suitable for cleaning with a steam cleaner e.g.:  
Steam could cause lacquered wood or leather to fade.  
Unprotected wood could swell up.  
The steam could remove protective layers of wax.  
Plastics could tint if exposed to steam.  
Soft plastics could deform if exposed to steam.  
Cold glass or mirror surfaces could burst if exposed to hot steam.
- If you would like to clean windows, you must first warm them up, e.g. by applying steam to a larger area at a greater distance and then from a closer distance.
- Please be careful that acrylic, velvet and satin are sensitive to hot steam.
- Ensure that the mains cord does not come into contact with hot parts.
- Never expose the steam cleaner to high temperatures (heaters etc.) or to effects of the weather (rain etc.).
- Never fill the steam cleaner with liquids other than water.
- Never immerse the steam cleaner in water to clean it and do not use a steam cleaner to clean it. Otherwise, the steam cleaner could be damaged.
- Do not in any case place the steam cleaner or the individual parts in the dishwasher. It would be destroyed.
- Please check the steam cleaner and package contents carefully.
- Stop using the steam cleaner if its plastic parts exhibit cracks or breaks or are deformed. Only replace damaged parts with corresponding original spare parts.
- Do not operate the steam cleaner with an empty tank. Once the water reservoir has been used up, pull the mains plug to avoid overheating it.

## Safety Guards

The below notice is to prevent harm and damage to the user and others, it is separated as [Forbidden] & [Attention].

Forbidden	
⊘ Do not spray to any aim in the same place for more than 5 seconds.	⊘ Do not put heavy weight or stamp on the power cord.
⊘ Do not unplug the power source if the power switch is on.	<b>S</b> Do not touch steam within 20cm from the gun.
<b>S</b> Do not open the safety valve during the usage.	⊘ Do not use broken power cord or switch.
<b>S</b> Do not pour any other liquid except clean water.	⊘ Please do not let children play.
<b>S</b> Do not put machine in rough & heat surface.	<b>S</b> Do not use water to rinse or put in a damp place.
⊘ Do not use when there is no water.	⊘ Do not dump the machine when the power is on.

Attention	
⊘ Turn off the power when there is a failure.	⊘ Machine must be in a ventilated room.
⊘ This product is only suitable for family.	⊘ Please be sure to lock the child lock when the machine is stopped.
<b>S</b> Please check whether the machine is damaged before using.	<b>S</b> Please pay attention when you are filling water.
<b>S</b> There may be some water in the steam for the first usage.	<b>S</b> Do not change, replace or remove any parts until the machine cools down.
<b>S</b> If the temperature is below 0°C, please do not use it to clean the window.	<b>S</b> Do not spray the steam to clean glass in the same position more than 2 seconds.
<b>S</b> Please revolve the safety valve before power on or hot water will pour out.	<b>S</b> When the machine is not in use, please turn off the power switch.
⊘ If there is any failure, the machine must be sent to the professional service center.	<b>S</b> Please open the safety valve after completely cooling down.

## Symbols



To reduce the risk of injury, user must read instruction manual



Waste electrical products must not be disposed of with household waste. Please recycle where facilities exist. Check with your local authorities or retailer for recycling advice.



Caution! Hot surface!



THIS SYMBOLS MEAN WARNING: Any use of steam has the potential danger of scalding.



Protective earth.

### Proper use:

The steam cleaner is only designed for removing dirt with water vapor. With unique patented technology by using high temperature and steam pressure to clean floors, windows, lampblack machines and air conditioners. No chemical reagent, and almost zero injury of cleaning items. For example, it is suitable for cleaning the following areas: smooth surfaces (e.g. work areas, tiles, glazed tiles, windows or mirrors), hard-to-reach areas (e.g. corners, grouting, blinds, toilets, fittings) and textiles (e.g. curtains, cushions, articles of clothing and car seats).

### Please be informed that:

The steam cleaner is only intended for private use and is not suitable for commercial purposes. The steam cleaner is not intended for outdoor use. Never use the product with liquids other than water. Only use the steam cleaner as described in this user manual. Any other use is deemed improper and may result in damage to property or even personal injury. And the manufacturer or vendor accepts no liability for damage caused by improper or incorrect use. The steam cleaner is not a children's toy.

## Parts Name

### Steam cleaner structure picture

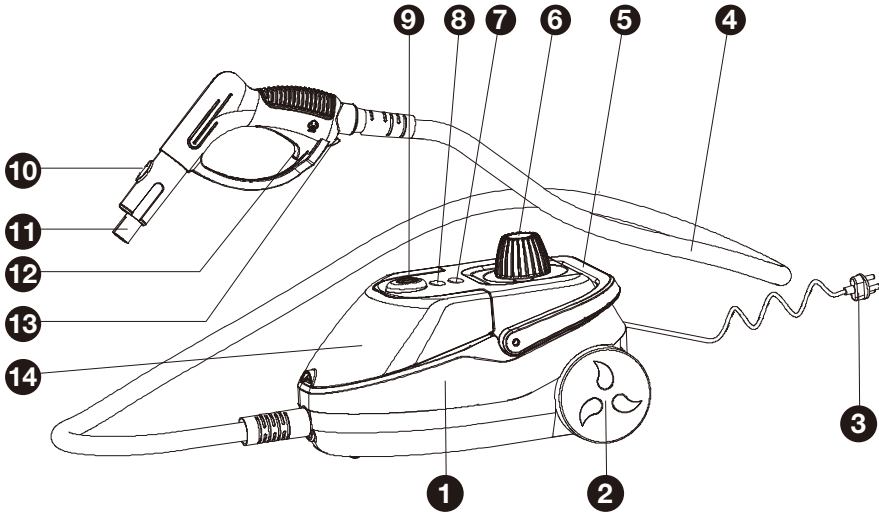

No.	Name	Function
1	Main Body	Product steam for cleaning.
2	Wheel	Ease of mobility and control the direction.
3	Plug	Connect with the socket for power.
4	Soft pipe	Deliver the steam.
5	Handle	Move the machine easily by hand.
6	Safety cap	Open it to fill the water & Relief the over pressure.
7	Indicator light (yellow)	Display steam states.
8	Indicator light (red)	show that the product is powered on.
9	Switch	Products needs to be turned on or off.
10	Accessory lock	Connected with accessories. Remove the accessories when pressed down.
11	Steam outlet	For steam output.
12	Steam trigger	Control the steam outputs.
13	Children(Safety) lock	Lock the steam trigger.
14	Storage box	Storage for small accessories

## Parts Name



15. Funnel × 1



16. Measuring cup × 1

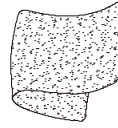

17. Towel of floor brush × 2



18. High pressure nozzle × 1



19. Small nylon brush × 1



20. Big nylon brush × 1

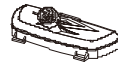

21. Ironing brush × 1

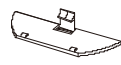

22. Glass brush × 1



23. Extension tube × 1



24. Nozzle × 1



25. Floor brush connector × 1

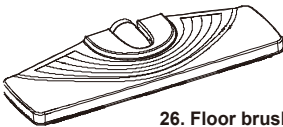

26. Floor brush × 1

## Technical Data

Rated Voltage:	120V~
Frequency:	60Hz
Rated Power:	1500W
Max Pressure:	58PSI (4.0 bar)
The steam temperature at outlet:	221°F (105°C)
Continuous Steam:	1.41 oz/min (40g/min)
Tank Capacity:	Max 50.7oz (1.5L)
Lightweight Body:	7.2lbs (3.28kg)

## Preparation

### Preparation:

**NOTES:** Before use the steam cleaner , please take off the cap(6) on the nozzle first.

#### 1.Removing the safety cap(Fig.1):

- Make sure the power cord of the cleaner is NOT connected to a socket.
- Unscrew the safety cap(6) remove it.

**Fig. 1**

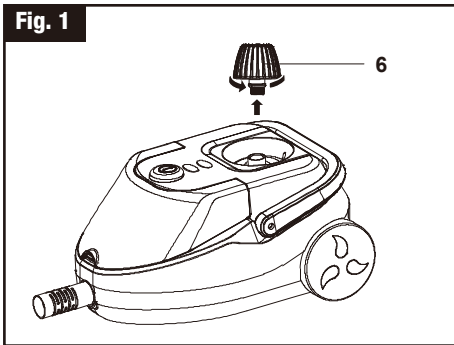

#### 2.Filling in water(Fig.2):

- Fill the cleaner with water by using the measuring cup(16) and funnel(15).

**NOTE:** Recommended load capacity of up to 1.4L to allow room for normal use.

**Fig. 2**

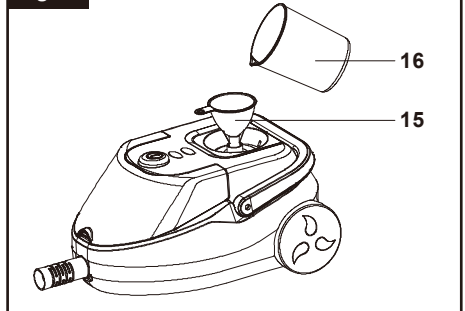

#### 3.Replacing the safety cap(Fig.3):

- Screw the safety cap(6) on again.

**Fig. 3**

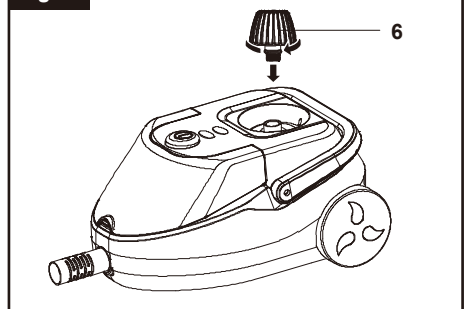

## Preparation

### 4. Attaching accessories(Fig.4):

- Attach accessories to the Steam outlet(11).
- See chapter "Instructions of accessories" for more information.

**Fig. 4**

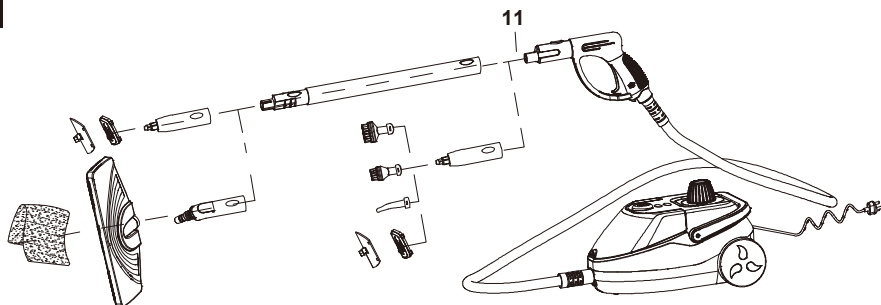

### 5. Connecting to power(Fig.5):

- Please ensure that the boiler with water and the relief valve in a tight status before you power the machine on.
- Connect the power cord to a socket.
- The yellow indicator light (7) and the red power indicator light (8) will illuminate simultaneously.

**Fig. 5**

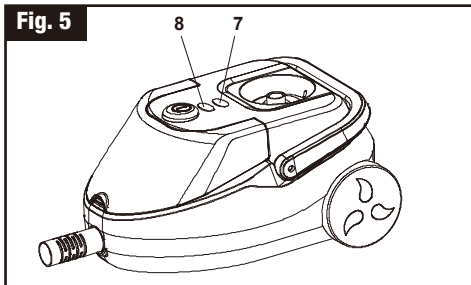

### 6. Unlocking the steam button(Fig.6):

- Switch the safety lock(13) to the "ON" position,unlock the steam button. You can release the safety lock button once steam begins to discharge, then simply press and hold the trigger.

**Fig. 6**

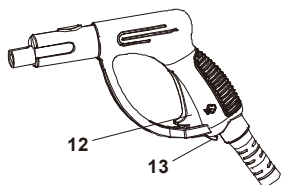

### 7. Releasing steam(Fig.6):

- (a) Unlock the steam button and simultaneously press the steam trigger (12) to release steam for cleaning.
- (b) Once steam begins to discharge, you can press the safety lock button (13) to the "OFF/LOCK" position to enable continuous steam output.

### 8.Disconnecting from power(Fig.7):

- When cleaning is done, release the steam trigger button(12), disconnect the power cord and allow the cleaner to cool down completely before storing it.

**Fig. 7**

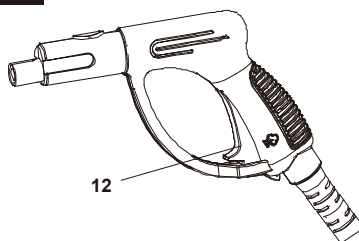

- 1.Unpack the package, check whether all the accessories are there and make sure that the product and accessories are not damaged.



## Operation

**2. Before use, please read the user manual carefully. The steam cleaner is only for private use (not suitable for commercial purposes), and for indoor use only (not for outdoor use).**

**Fig. 8**

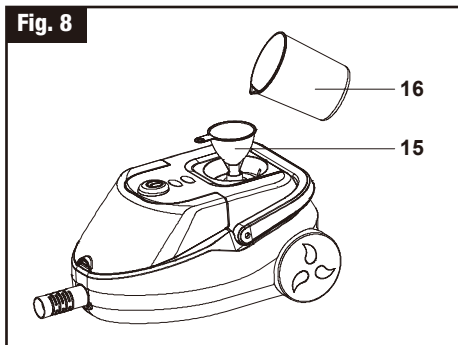

**3. Put the steam cleaner on a level platform and open the safety cap by twisting it counterclockwise. Then use the funnel and measuring cup to fill the water, and then reinstall the safety cap and tighten it in position (Fig.8).**

### **Special attentions:**

- Maximum tank capacity is 1.5L, but we suggest you only fill water 1.4L to get the dry steam. If more than 1.4L water, there may be some water in the steam at the first 1 minutes.
- In order to get ideal steam, please be sure to fill 0.5L ~ 1.2L water.
- Please do not add water less than 500ml.
- Please use clean water. (small solid particles may block pipe and the machine may be not work)
- Please do not pour any chemicals such as alcohol, cleaning agents into the steam cleaner. (some chemical solvents can easily cause machine failure, and even endanger the user's personal safety in serious cases)
- If the tap water in your area is very hard, it is recommended that you mix the tap water with distilled water. Otherwise, the steam cleaner could calcify prematurely and clog the steam nozzle.

**4. When the power is plugged in, the yellow and red indicator lights turn on simultaneously, indicating that the steam cleaner is heating up**

**and the pressure is increasing. Please wait for about 7 - 9 minutes until the yellow indicator light turns off, which means heating is finished and the machine is ready for use.**

### **Attention:**

- Please only use the machine if the yellow indicator light turns off.
- The steam released from the first use may contain some water droplets, so please avoid using it to clean carpets, curtains and other items that easily absorb water.

**5. After heating is finished, please select the accessory you need and install it on the unit.**

**6. Switch the safety lock button to the "ON" position. then press and hold the trigger to release steam. Once steam begins to discharge, you can switch the safety lock button to the "OFF/LOCK" position to enable continuous steam output. To stop the steam output, simply switch the safety lock button back to the "ON" position.**

- Without pressing the children lock, the steam trigger can not be pressed.

### **Attention:**

If there is no more water in the water tank, no more steam will be emitted when you push the steam trigger. The water must be refilled as follows:

- Pull the main plug out of the socket.
- Push the steam trigger until no more steam is escaping.
- Wait for cooling about 20 minutes.
- Slowly unscrew the safety cap and wait a few seconds.
- Slowly refill the water.
- Close the safety cap again.

**7. After usage, please turn the power off, release all the residual steam and wait for the machine cooling down.**

- The steam cleaner has an overheat protection. It will automatically switch off if it overheats (e.g. when the water tank is empty).

## Instructions of Accessories

### 1: Extension tube

Mount the extension tube to use the steam cleaner to clean the floors, high windows or inaccessible areas. Place the open end of the tube on the steam gun until the steam gun release button clicks in the place. Use one or two extension tube, as necessary. To remove the extension, press the release button and pull the tubes apart with a downward motion. (Fig.9)

**Fig. 9**

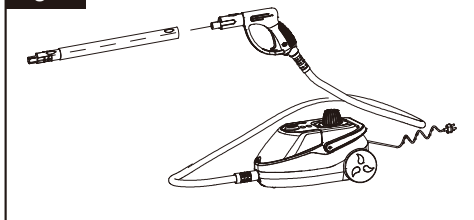

### 2: Nozzle

The nozzle can be used for deep cleaning corners, junctions, or bathrooms by connecting it to a steam outlet, such as an extension tube. (Fig.10)

**Fig. 10**

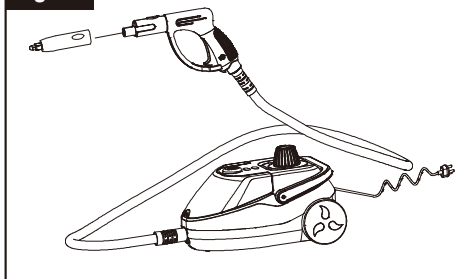

### 3: Nylon brush

Insert the nozzle into the notch of the round brush, and turn it clockwise until it clicks. After use, take out the round brush by turn it anti-clockwise (Fig.11).

**Fig. 11**

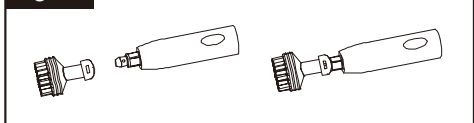

### 4: Window brush

To clean window, mirrors, or tiles or objects with smooth surface, use the window brush, which has a rubber for cleaning. When installed, set in the two prominent parts of the hook scraper; then place the glass brush cover for it; an audible click will sound, and the installation is complete (Fig.12).

- ⊗ If temperature is lower than 0°C, please do not use this product to clean glass.
- ⊗ Do not placed in the same position more than 2 seconds.

**Fig. 12**

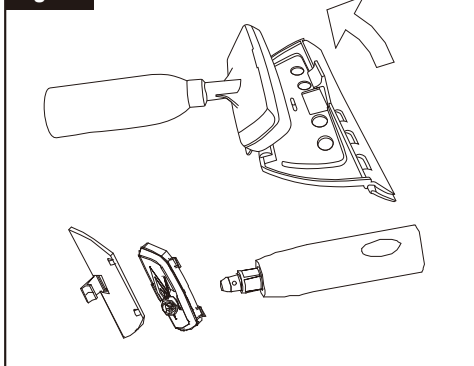

## Instructions of Accessories

### 5: Floor brush

- a) The floor brush is ideal for cleaning washable walls and floors. It is recommended to sweep or vacuum floors before mopping.

First of all, attach the floor brush and the connector(Fig.13).

**Fig. 13**

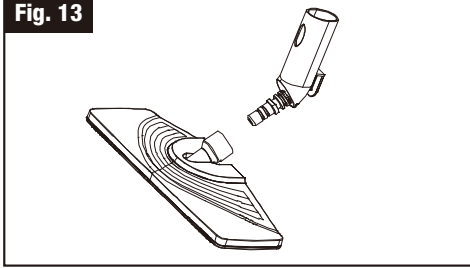

- b) Connect the nozzle on the floor brush to the end of the extension tube. Make sure that the nozzle fits properly in place.

There are magic tapes on the floor brush. So first, just stick the white part of the towel which can be directly fixed to the floor brush, then you can use it to clean the walls, floors, tiles and so on.(Fig.14)

**Fig. 14**

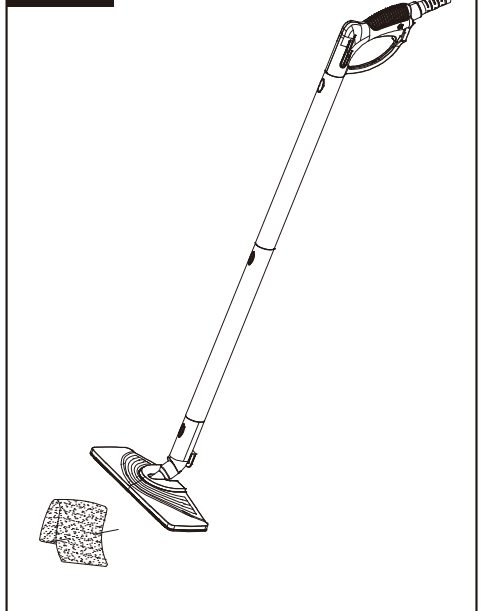

## Cleaning and Maintenance

### Cleaning:

1. Before cleaning, pull the mains plug out of the socket.
2. Let the steam cleaner cool off completely.
3. Wipe the steam cleaner and the accessories off with a damp cloth. Then let all parts dry completely.

### Storage:

All parts must be completely dry before being stored.

- Always store the steam cleaner in a dry, clean and dust-free place.
- Store the steam cleaner under out of the reach of children.

## Common Troubleshooting

Situation	Case	Solution
No spray steam	Plug is not inserted to the power socket tightly.	Insert again or change the socket.
	Switch indicator light off.	Turn on the switch.
	No water.	Fill some water.
	Not press the steam button.	Press on the child lock.
Water is flowing from the nozzle	There may be some water in the steam for the first usage or the machine has been stopped for a while.	It is a normal phenomenon and will disappear quickly.
Others	Influence the normal use.	Ask for professional service.
	Steam come out besides the nozzle.	Ask for professional service.
	Plastic deformation and softening phenomenon.	
	Other electric equipment can not be used.	
	Steam comes out from the safety valve.	

## Environment Friendly Disposal

### Disposal of the Appliance



This product has been marked with a symbol relating to removing electric and electronic waste. This means that this product shall not be discarded with household waste but that it shall be returned to a collection system.

It will then be recycled or dismantled in order to reduce the impact on the environment. Electric and electronic equipment can be hazardous for the environment and for human health since they contain hazardous substances.

### Disposal of the Packaging



The packaging consists of cardboard and correspondingly marked plastics that can be recycled. Make these materials available for recycling.

**HAUSHOF**