

ASSEMBLY INSTRUCTIONS

6 IN. HAWTHORNE OPEN SHELF CABINET

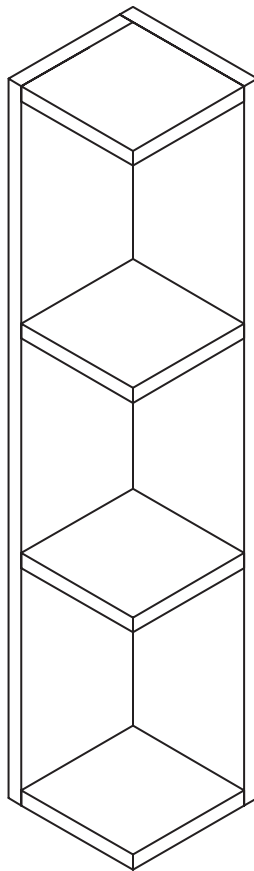

Questions, problems, missing parts?
Before returning to the store, call Home Decorators Collection Customer Service.
8 a.m. – 7 p.m., EST, Monday – Friday, 9 a.m. – 6 p.m., EST, Saturday

1-800-998-7021

HOMEDEPOT.COM/HOMEDECORATORS

THANK YOU

We appreciate the trust and confidence you have placed in Home Decorators Collection through the purchase of this open shelf. We strive to continually create quality products designed to enhance your home. Visit us online to see our full line of products available for your home improvement needs. Thank you for choosing Home Decorators Collection!

Table of Contents

Table of Contents	2
Safety Information	2
Warranty	2
LIMITED LIFETIME WARRANTY	2
What is Covered	2
What is Not Covered	2
California and Minnesota Residents	3
California residents.	3
Minnesota residents.	3

Pre-assembly	3
Planning Assembly	3
Tools Required	3
Hardware Required.	3
Pre-assembly (continued)	4
Package Contents.	4
Installation	5
Maintenance	7
Care and Cleaning	7
Troubleshooting	7

Safety Information



WARNING

- Two people are required for safe installation. Take extra precautionary measures to ensure a secure grip on the open shelf cabinet when lifting.
- Read these instructions carefully and keep in a safe place.
- Do not over tighten connectors (screws, bolts, etc.) Overtightening can lead to product damage.
- Assembly needs to be carried out by a qualified person. Wrong assembly can lead to the furniture / object topples or falls resulting in personal injury or damage.
- Screws or fittings are not included. Choose screws and fittings that suits your wall and have sufficient holding power. If you are uncertain, contact your local specialized retailer.



CAUTION

- The bathroom wall must be finished prior to installation of the open shelf cabinet.
- Be sure to check all packing materials carefully for small parts that may have come loose inside the carton during shipment. If parts are missing, contact THE HOME DEPOT to obtain any missing parts.

Warranty

LIMITED LIFETIME WARRANTY

WHAT IS COVERED

Home Decorators Collection products are manufactured with superior quality standards and workmanship and are backed by our limited lifetime warranty. Home Decorators Collection products are warranted to the original consumer purchaser to be free of defects in materials or workmanship. We will replace FREE OF CHARGE any product or parts that proves defective. Simply, return the product / part to any of The Home Depot retail locations or call 1-800-986-3460 to receive the replacement item. Proof of purchase (original sales receipt) from the original consumer purchaser must be made available for all Home Decorators Collection warranty claims.

WHAT IS NOT COVERED

This warranty excludes incidental/inconsequential damages and failures due to misuse, abuse or normal wear and tear. This warranty excludes all industrial, commercial & business usage, whose purchasers are hereby, extended a limited lifetime warranty from the date of purchase, with all other terms of this warranty applying except the duration of warranty. Some states and provinces do not allow the exclusion or limitation of incidental or consequential damages, so the above limitations may not apply to you. This warranty gives you specific legal rights and you may also have other rights that vary from state to state and province to province. Please see a store or contact 1-800-986-3460 for more details.

Contact the Customer Service Team at 1-800-986-3460 or visit www.HOMEDEPOT.COM/HOMEDECORATORS.

California and Minnesota Residents

CALIFORNIA RESIDENTS



WARNING THIS PRODUCT CAN EXPOSE YOU TO STYRENE / WOOD DUST WHICH IS KNOWN TO THE STATE OF CALIFORNIA TO CAUSE CANCER. GO TO WWW.P65WARNINGS.CA.GOV/PRODUCTS

MINNESOTA RESIDENTS

"IMPORTANT HEALTH NOTICE.

SOME OF THE BUILDING MATERIALS USED IN THIS HOME (OR THESE BUILDING MATERIALS) EMIT FORMALDEHYDE. EYE, NOSE, AND THROAT IRRITATION, HEADACHE, NAUSEA AND A VARIETY OF ASTHMA-LIKE SYMPTOMS, INCLUDING SHORTNESS OF BREATH, HAVE BEEN REPORTED AS A RESULT OF FORMALDEHYDE EXPOSURE. ELDERLY PERSONS AND YOUNG CHILDREN, AS WELL AS ANYONE WITH A HISTORY OF ASTHMA, ALLERGIES, OR LUNG PROBLEMS, MAY BE AT GREATER RISK. RESEARCH IS CONTINUING ON THE POSSIBLE LONG-TERM EFFECTS OF EXPOSURE TO FORMALDEHYDE.

REDUCED VENTILATION MAY ALLOW FORMALDEHYDE AND OTHER CONTAMINANTS TO ACCUMULATE IN THE INDOOR AIR. HIGH INDOOR TEMPERATURES AND HUMIDITY RAISE FORMALDEHYDE LEVELS. WHEN A HOME IS TO BE LOCATED IN AREAS SUBJECT TO EXTREME SUMMER TEMPERATURES, AN AIR-CONDITIONING SYSTEM CAN BE USED TO CONTROL INDOOR TEMPERATURE LEVELS. OTHER MEANS OF CONTROLLED MECHANICAL VENTILATION CAN BE USED TO REDUCE LEVELS OF FORMALDEHYDE AND OTHER INDOOR AIR CONTAMINANTS. IF YOU HAVE ANY QUESTIONS REGARDING THE HEALTH EFFECTS OF FORMALDEHYDE, CONSULT YOUR DOCTOR OR LOCAL HEALTH DEPARTMENT."

Pre-assembly

PLANNING ASSEMBLY

To ensure your assembly goes smoothly, please read these instructions carefully and review the recommended tools and hardware before you begin.

TOOLS REQUIRED

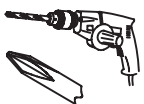

Electric drill
with #2 drill bit



Safety
goggles



Phillips
screwdriver



Level

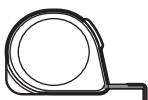

Measuring
tape

HARDWARE REQUIRED



Two wall anchors - if the
open shelf cabinet will not
be screwed to wall studs



For wood wall



For brick wall

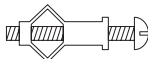

For dry wall

Pre-assembly (continued)

PACKAGE CONTENTS

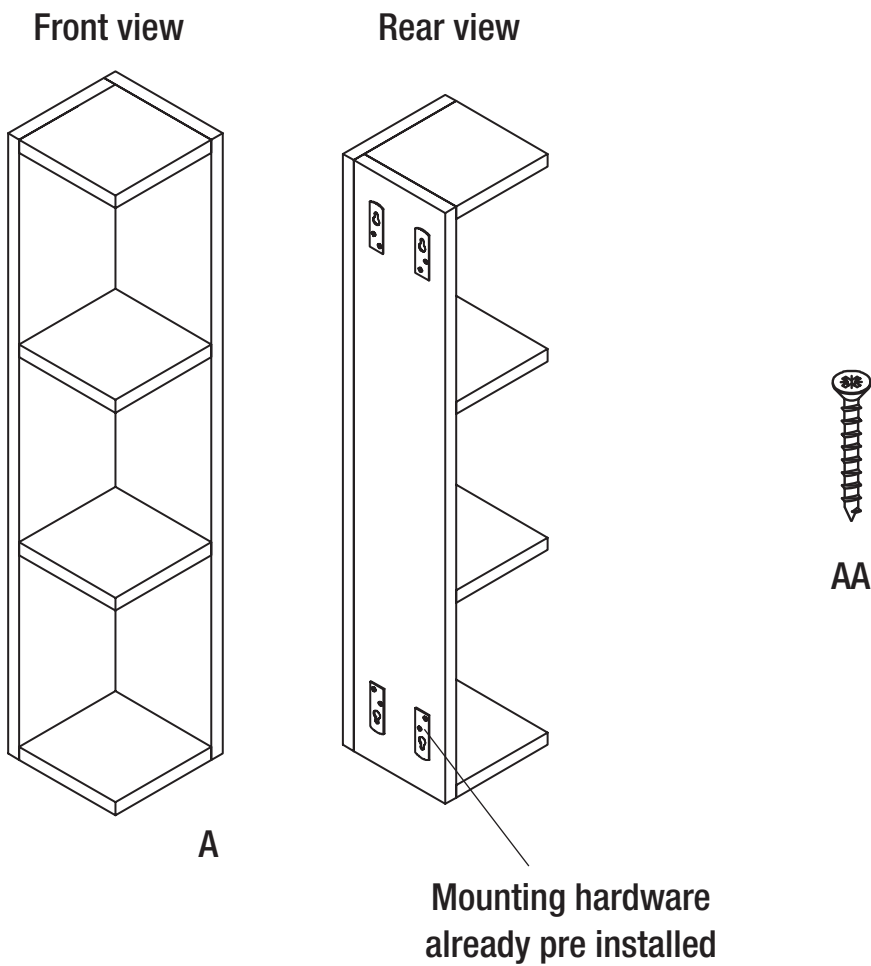

Part	Description	Quantity
A	Open shelf	1
AA	2 in. screw	2

Installation

1 Determine the desired location

- Determine the desired location for fixing the open shelf (A).
- Mark the location of the mounting screws (AA) on the wall, ensuring that they are level.



CAUTION: Different wall materials require different types of fixing hardware (not included). Use suitable fixing hardware for the walls in your home. For advice on suitable fixing systems, consult a local specialized retailer.

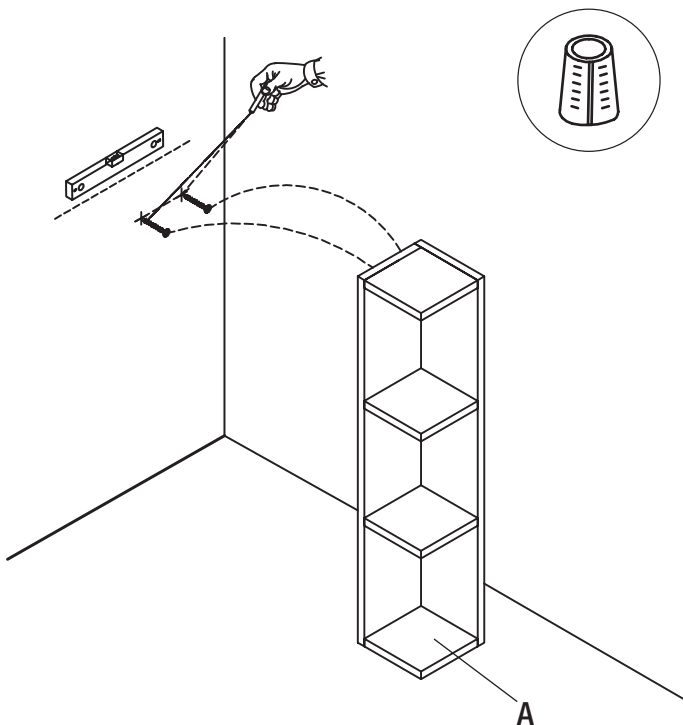

2 Inserting screws

- Using a drill, create a hole in the wall for each wall anchor over the marked locations.
- Insert two wall anchors (not included). Insert one #8 x 2 in. screw (AA) into each wall anchor.
- If installing directly into wall studs: using a drill, insert one #8 x 2 in. screw (AA) into each marked location.

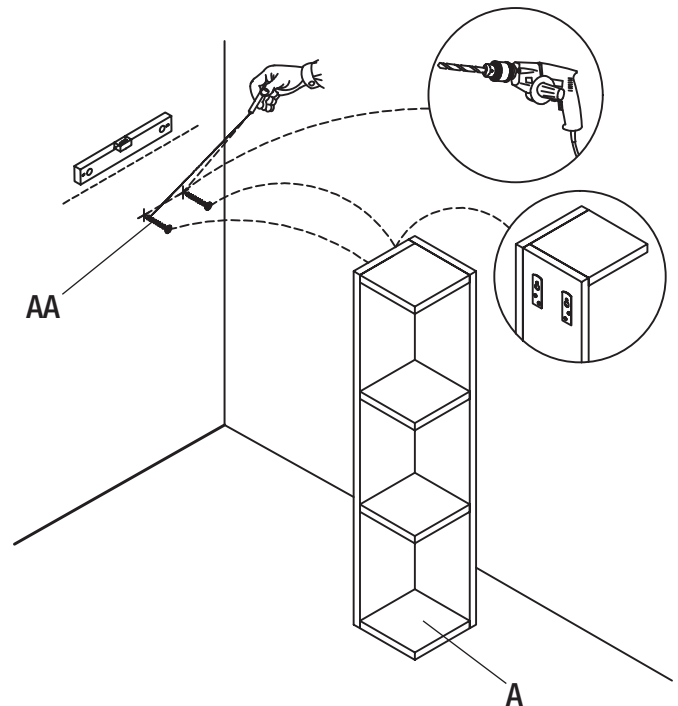

CAUTION: For wall stud installation, insert the screws with washers into the stud locations (not included).

For drywall installation, drill holes at the appropriate locations and insert toggle bolts with washers (not included).

For concrete wall installation, drill 1/4 in. holes at the appropriate locations and insert wall anchors, followed by the screws (not included).

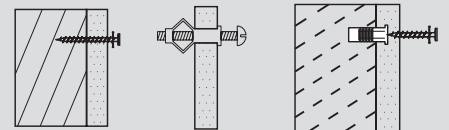

Installation (continued)

3 Hanging the open shelf (option 1)

- Align the open shelf (A) to the side of the medicine cabinet.
- Rotate the open shelf (A) upside down for left/right configurations.
- Hang the open shelf (A) on the screws (AA) using the mounting hardware preassembled to the open shelf.



NOTE: Illustrations show left and right positioning. Each open shelf is sold individually.

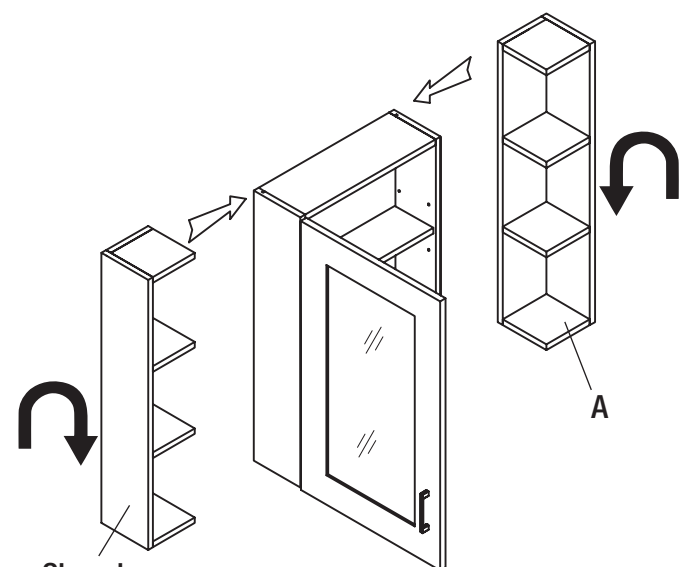

Closed
side outside

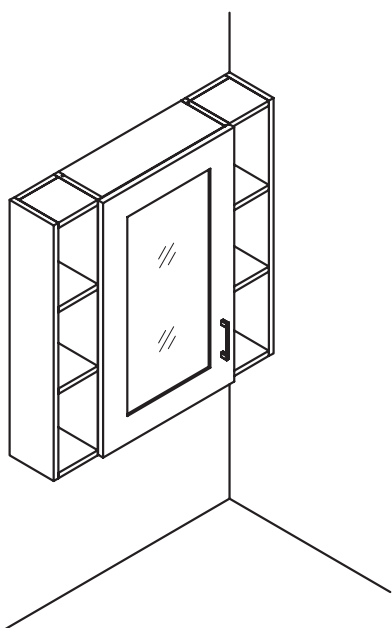

4 Hanging the open shelf (option 2)

- Rotate the open shelf (A) upside down for left/right configurations.

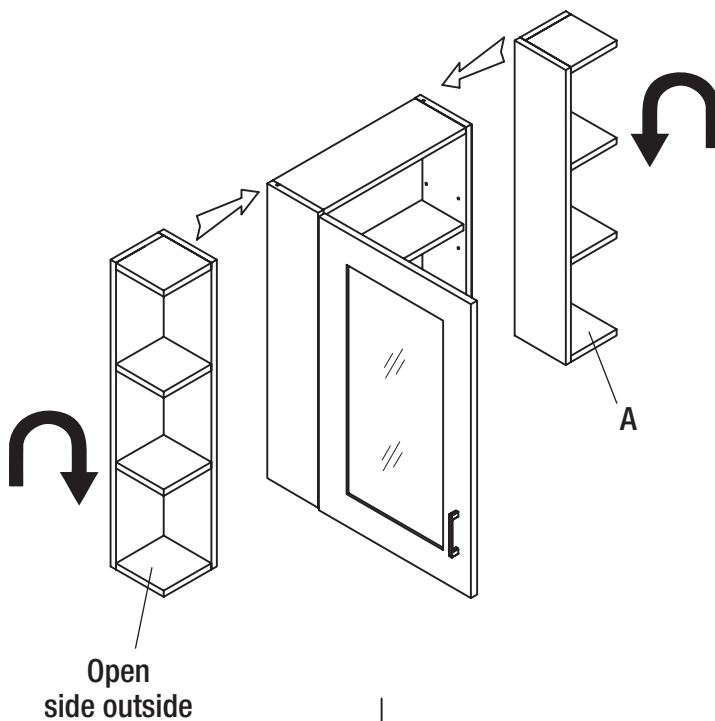

Open
side outside

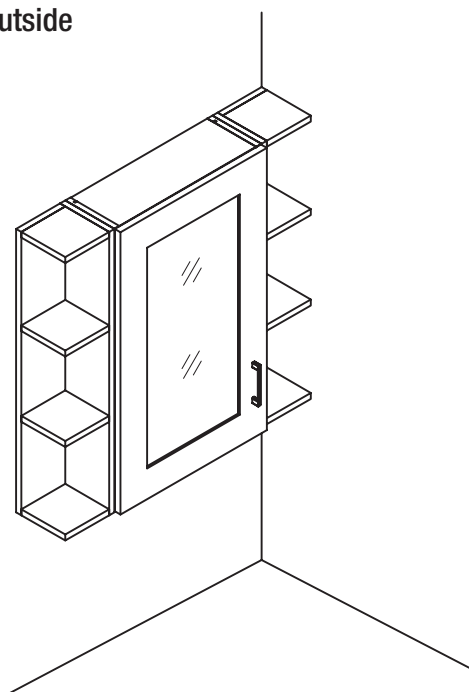

Maintenance

- ☐ To maintain the beauty of the furniture finish, avoid placing the open shelf cabinet in direct sunlight.
- ☐ Avoid exposing the open shelf cabinet to extreme temperatures by installing away from heat and air vents.

Care and Cleaning

- ☐ Dust frequently with a clean, soft and dry cloth.
- ☐ Wipe away any water or liquid spills on the open shelf cabinet immediately with a clean, soft and dry cloth.

Troubleshooting

Problem	Possible Cause	Corrective Action
Open shelf cabinet is higher on one side than the other.	<ul style="list-style-type: none"><input type="checkbox"/> Mounting screws are not level.<input type="checkbox"/> Hanging hardware on the open shelf cabinet is not level.	<ul style="list-style-type: none"><input type="checkbox"/> Remove the open shelf cabinet from the wall and re-check the screws; adjust as needed.<input type="checkbox"/> Measure the position of the hanging hardware on the back of the open shelf cabinet and ensure that it is level, adjust as needed.

The logo for Home Decorators Collection is centered on a dark gray rectangular background. It features the word "HOME" in a large, white, serif font. Below it, the word "DECORATORS" is written in a smaller, white, serif font. At the bottom, the word "COLLECTION" is written in an even smaller, white, sans-serif font, followed by a registered trademark symbol (®).

HOME DECORATORS COLLECTION®

Questions, problems, missing parts?
Before returning to the store, call Home Decorators Collection Customer Service.
8 a.m. - 7 p.m., EST, Monday - Friday, 9 a.m. - 6 p.m., EST, Saturday

1-800-998-7021

[HOMEDEPOT.COM/HOMEDECORATORS](https://www.homedepot.com/homedecorators)

Retain this manual for future use.