

User Manual

Digital HDTV Antenna
AN-2027

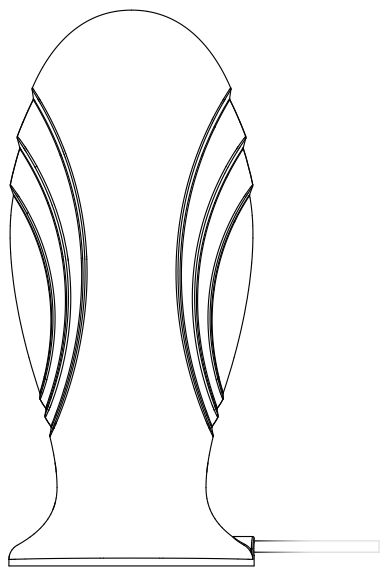

Package contents

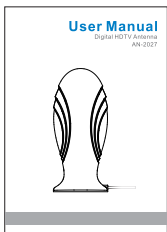

User manual x 1

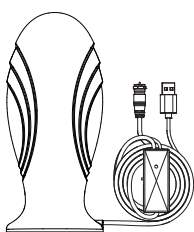

HDTV Antenna x1

Parameters

- 1.Frequency range: VHF 174-230Mhz; UHF 470-862Mhz
- 2.VSWR: ≤ 2.0
- 3.Impedance: 75Ω
- 4.Gain: 10dBi(Short distance)/ 25dBi(Long distance)
- 5.Connector: F Male or Customized
- 6.Power supply : USB port (5V/500mA)
- 7.Polarization : Horizontal / Vertical

Instructions

I.Antenna Connection

Connect to Set-Top box(STB)

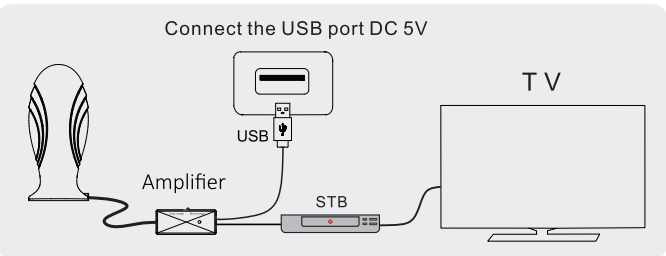

Connect directly to HDTV

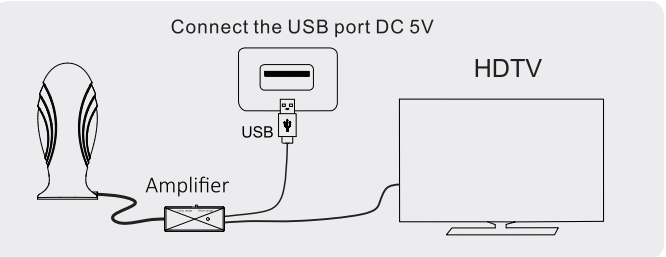

- 1.Connect amplifier with the coaxial cable to the ANT/IN or CABLE IN port on the back of TV/Set Top Box.
- 2.Plug the amplifier's USB connector into an open USB port on the back of TV/STB or into a wall outlet using power adapter to ensure amplifier works properly.

Connect to HDTV

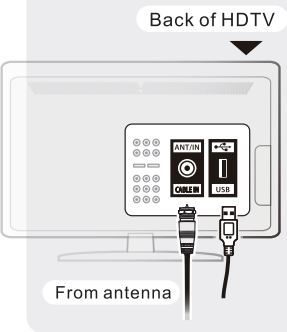

Connect to STB

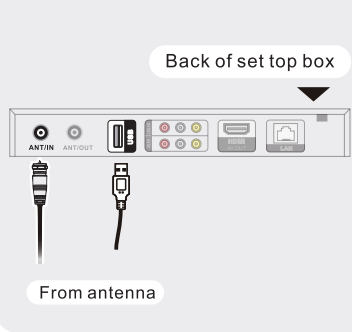

Power supply selection

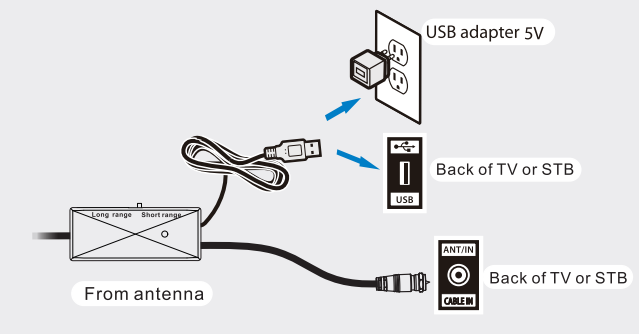

II.Antenna Mounting

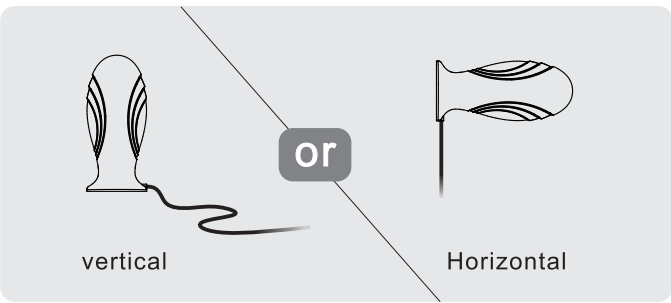

Tips

- (1)The antenna has magnets that attach to iron objects.
- (2)Antennas are placed in different directions and positions in different areas.
- (3)Try to place the antenna vertically and horizontally, then scan the channels and choose the way place more TV shows.

III.Scan for Channels

1. In the TV's setup menu, set the mode to Antenna or Air. Refer to the TV manual for detailed instructions.
2. While in the TV's setup menu, set TV to scan for channels. This can sometimes be listed as auto-program, channel search or channel scan. Consult your TV manual for detailed instructions.

IV.How to use this switch ?

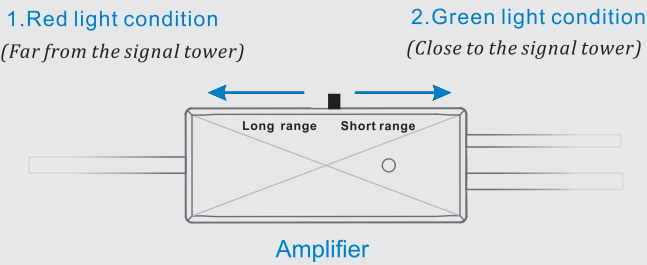

1.Red light condition

- (1) When you flip the switch to the red light you're in a high gain state.
- (2) If the signal is not good due to the distance from the transmitter tower, please dial the switch to this state.
- (3) Please do not toggle the switch to this state when the signal is good.

2.Green light condition

- (1) Toggle the switch to the green light is in a low gain state.
- (2) Please dial the switch to this state when you are close to the signal transmitting tower.
- (3) If the signal is not good in the green light state ,please dial the switch to the red light high gain state.

Remark:

If signals can't be received when using the amplifier, adjust the amplifier to the low gain gear and try again. Amplifier may cause self-oscillation in some occasions(i.e.your house is close to broadcast tower),which may interfere with signal reception.

FAQ

Q: Will all the channels I receive be High Definition (HD)?

A: Not all digital signals are High Definition(HD). Make sure you are using a High Definition Television(HDTV) with built in ATSC tuner. When connecting the antenna to a third-party receiver, make sure it is capable of receiving HD. Otherwise no HD channels can be picked up.

Q: Can you put the antenna behind the TV?

A: Yes, but it may not be the ideal location for the antenna.The TV will block some of the signal, which will weaken the signal.

Q: Are channel lineups available?

A: No. The channels you can receive depend on many complex factors such as distance to the transmitting antennas, your height above ground, the compass reading, trees blocking a clear view, etc. The good news is that once you use scan function of your TV you will see what channels were found.

Q: Is this just like a freeview box?

A: No, it's just an aerial that plugs into back of your freeview-enabled TV, so you can have a TV anywhere in house without having to run cables all over the place. Works a treat and we can get all the usual freeview channels including digital radio in the spare bedroom.

Q: How many channels can I receive?

A: The number of channels you can receive will be determined by what is being broadcast in your area. Channel reception will vary from location to location based on terrain (including trees, buildings, hills and mountains). The fewer obstructions, the better your chance of receiving strong digital signals. Go to <http://dtv.gov/maps>. Enter your address for a listing of likely channels available in your area.

Troubleshooting

1. Check to make sure you have correctly connected the antenna to your HDTV or third-party HD receiver.
2. Reposition the antenna in a different location. Maybe higher on a wall or close to a window ? Facing the direction of the broadcast tower is usually best. Signal strength will vary based on certain conditions. Distance from the tower, hills, buildings and even tall trees can impact reception. Always re-scan for channels after moving the antenna.
3. If a channel is missing, try turning the antenna 10 or 20 degrees in either direction to avoid reflection or move the antenna, and then re-scan the channel.
4. The picture or sound freezes while I am watching a channel, or there are boxes in the picture.This is often caused by a weak or intermittent signal. Try moving the antenna to a different location or aiming it in the direction of the broadcast tower for that channel.
5. Not all digital signals are High Definition (HD). Make sure you are using a High Definition Television (HDTV) with built in ATSC tuner. When connecting the antenna to a third-party receiver, make sure it is capable of receiving HD. Otherwise no HD channels can be picked up.



Made in china