

# WiFi Programmable Thermostat User Guide

AC7300

## Description

AC 7300 Wi-Fi Programmable Thermostat is designed to bring comfort to people's life whether you are at home or on-the-go.

Integrated with Wi-Fi 2.4Ghz, it allows you to have the remotely access, change, or program your room temperature at anytime, anywhere. You are also able to use smart controls from Google Home/, Amazon Alexa. And Geo-fencing function is available on Application.

The smart thermostat has the full compatibility to the systems inclusive of oil fuel/gas fuel/electric fuel/single, two stage, multi stage heating & cooling.



## Technical Data

|                   |   |                  |                            |
|-------------------|---|------------------|----------------------------|
| Power Supply      | AC24V/ 2xAA battery   | Backlight        | White                      |
| Max Load          | 0.5A  | Sensor           | NTC 10K                    |
| Set Point Range   | Heat/Cool 41~ 95°F (5~35°C)<br>Auto- Heat 41~91°F (5~33°C)<br>Auto- Cool 45~95°F (7~35°C) | Accuracy         | ±1 °C /1°F ( increment 1°) |
| Ambient           | 0~50°C  | Protection Class | IP30                       |
| Relative Humidity | 85%   | Housing          | - ABS+PC(fire resistant)   |

## Home Page

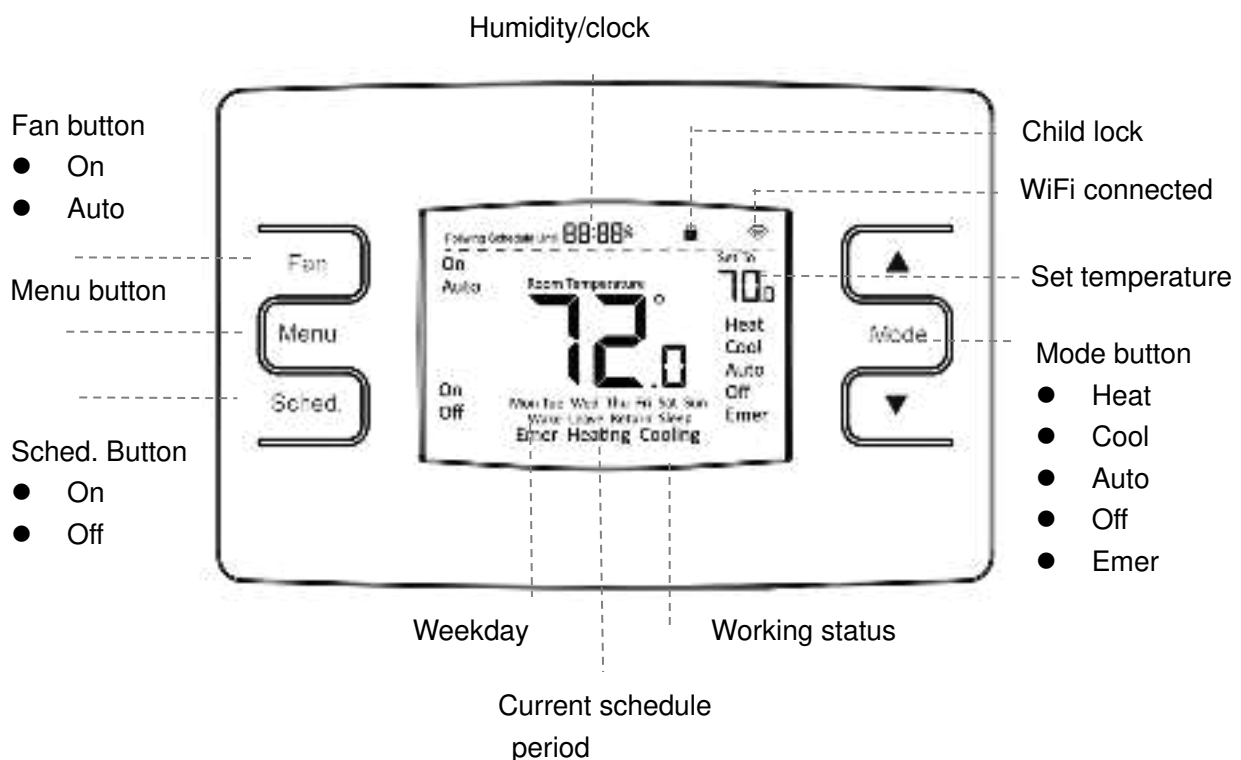

# WiFi Programmable Thermostat

## User Guide

AC7300



### WiFi Connection

- Before wifi configuration, please make sure your phone is now connect to 2.4GHz WIFI.
- WiFi only enable when powered by AC24V, will disable when powered only by battery.

1. Please download “**Smart Life**” APP from Google play or App store.
2. Register your account with your phone number or email address, then log in please.
3. Add device by press **+** button at top right corner.
4. Press “All Devices”, find “Thermostat” on the list and select.
5. Under thermostat on, press and hold **Menu** button until the wifi icon display on the top right corner. Then press  button, wifi icon flash, mean it is now waiting for configuration with Application.
6. Press “Confirm indicator rapidly blink” on phone, then enter your password of your network for first time.
7. Wait a moment till connection done.



In case connection failed , you can try AP mode connection. Try below from step 5.

AP-5. Under thermostat on, press and hold **Menu** button until the wifi icon display on the top right corner. Then press  button, wifi icon flash, Then press  button again, AP display on screen.

AP-6. please switch the mode on below mobile page from easy mode to AP mode, then follow the indications to connect the hot spot.



### Child Lock

Under child lock ON (refer to menu3 of parameter setting ), the buttons will lock once backlight off.

Press  and  button at the same time for 5s to unlock it for temporary adjust.

### Mode setting

Press **Mode** button to select Off/Cool/Heat/Auto/Emergency Heat mode.

When in Auto mode, press  or  button, cool will flash, set the temperature for it when it is flash if you need.

Press **Mode** button now will switch to heat, heat will flash, then set the temperature for Auto-cool if you need.

### Fan

Press **Fan** button to select On /Auto.

Fan On means fan always on.

Fan Auto mean fan only runs when heating or cooling on.

# WiFi Programmable Thermostat

## User Guide

AC7300

### Schedule

Press **Sched.** button to select On /Off

Schedule On means it will work follow the preset schedule setting, **following schedule** will display. if you adjust the temp. now, it will show **Temporarily set to.**

Schedule Off means it will work according to the current set temperature, and it will always show **Permanent hold.**

### Clock & Weekday setting

Press and hold **Mode** button for 5s, set the clock (Min-Hour-Weekday) by pressing ▲ and ▼ button, each press of **Mode** button will go to next item setting.

### 7 days Schedule setting

The schedule setting is suggested to set on the Application. However, if you need to set it on the thermostat, please follow below description.

#### Set the schedule for heat mode:

When in heat mode, press and hold **Sched.** button to enter schedules setting. Set the schedule (Weekday-Period-Start time-Temp.) by pressing ▲ and ▼ button. Each press of **Fan.** Button will go to next item setting.

#### Set the schedule for cool mode:

When in cool mode, press and hold **Sched.** button to enter schedules setting. Set the schedule (Weekday-Period-Start time-Temp.) by pressing ▲ and ▼ button. Each press of **Fan.** Button will go to next item setting.

#### Set the schedule for Auto mode:

When in Auto mode, press▲, cool flash, (press **Mode** button to switch to Auto-heat, heat flash) then press and hold **Sched.** button to enter schedules setting. Set the schedule (Weekday-Period-Start time-Temp.) by pressing ▲ and ▼ button. Each press of **Fan.** Button will go to next item setting.

#### Copy function:

- 1) When you enter schedule setting , long press the **Menu** button, copy and Mon. will flash.
- 2) Press **Fan** button to select the copy day, then press **Menu** button to confirm. Copy connect will show.
- 3) Press **Fan** button to select next day to copy to, press **Menu** button to confirm, repeat to select all the weekdays you would like to copy to.
- 4) Press **Sched.** button will exit the copy setting.

#### Example:

| Period | Mon   |      | Tues  |      | Wed   |      | Thur  |      | Fri   |      | Sat   |      | Sun   |      |
|--------|-------|------|-------|------|-------|------|-------|------|-------|------|-------|------|-------|------|
|        | Time  | Temp | Time  | Temp | Time  | Temp | Time  | Temp | Time  | Temp | Time  | Temp | Time  | Temp |
| wake   | 7:00  | 19℃  | 7:00  | 19℃  | 7:00  | 19℃  | 7:00  | 19℃  | 7:00  | 19℃  | 7:00  | 19℃  | 7:00  | 19℃  |
| leave  | 8:30  | 22℃  | 8:30  | 22℃  | 8:30  | 22℃  | 8:30  | 22℃  | 8:30  | 22℃  | 8:30  | 22℃  | 8:30  | 22℃  |
| return | 17:00 | 22℃  | 17:00 | 22℃  | 17:00 | 22℃  | 17:00 | 22℃  | 17:00 | 22℃  | 17:00 | 22℃  | 17:00 | 22℃  |
| sleep  | 22:00 | 22℃  | 22:00 | 22℃  | 22:00 | 22℃  | 22:00 | 22℃  | 22:00 | 22℃  | 22:00 | 22℃  | 22:00 | 22℃  |

# WiFi Programmable Thermostat

## User Guide

AC7300

### Parameter setting

Press **Menu** button to enter parameter setting, press ▲ and ▼ button to set the value. Each press of Menu button will go to next item setting.

| <u>Menu</u> | <u>Description</u>                  | <u>Range</u>   | <u>Default Value</u> |
|-------------|-------------------------------------|--|----------------------|
| 01          | Temp. calibration                   | -8 °C ~8 °C  | 0 °C                 |
| 02          | Temp. unit                          | °F/°C  | °F                   |
| 05          | Child Lock                          | 0: Unlock<br>1: Lock   | 0                    |
| 06          | 1st stage temp. differential        | 0-3 °C   | 0 °C                 |
| 07          | 2nd stage temp. differential        | 1~10 °C  | 3 °C                 |
| 08          | Compressor on delay                 | 0-9min   | 4                    |
| 09          | Fan off delay                       | 0-3min   | 1 min                |
| 18/19       | Software version                    |  |                      |
| 30          | Outdoor                             | AC--Conventional cooling<br>HP--Heat pump<br>AC0--No cooling   | AC                   |
| 31          | Indoor                              | H--Heating<br>H0--No heating   | H                    |
| 32          | Fan                                 | F--Furnace<br>F0--Boiler, no fan   | F                    |
| 33          | O/B reversing valve(heat pump only) | 0--OB signal=0; cool mode<br>OB signal=1; heat mode<br>1--OB signal=1; cool mode<br>OB signal=0; heat mode | 0                    |

### Installation

#### Caution:

- To protect the device, please cut off the power of master switch before you install a new thermostat.
- This thermostat works on 24 volt systems, it will not work on 120/240 volt systems.

Step 1 Separate the baseplate and front panel.

Step 2 Connecting the wires according to the wiring diagram.

Use the screwdriver and screws to fix the baseplate on the wall. .

Step 3 Install the 2xAA battery if you need.

Step 4 Put the front panel onto the baseplate according to the snaps on the baseplate.

# WiFi Programmable Thermostat User Guide

AC7300

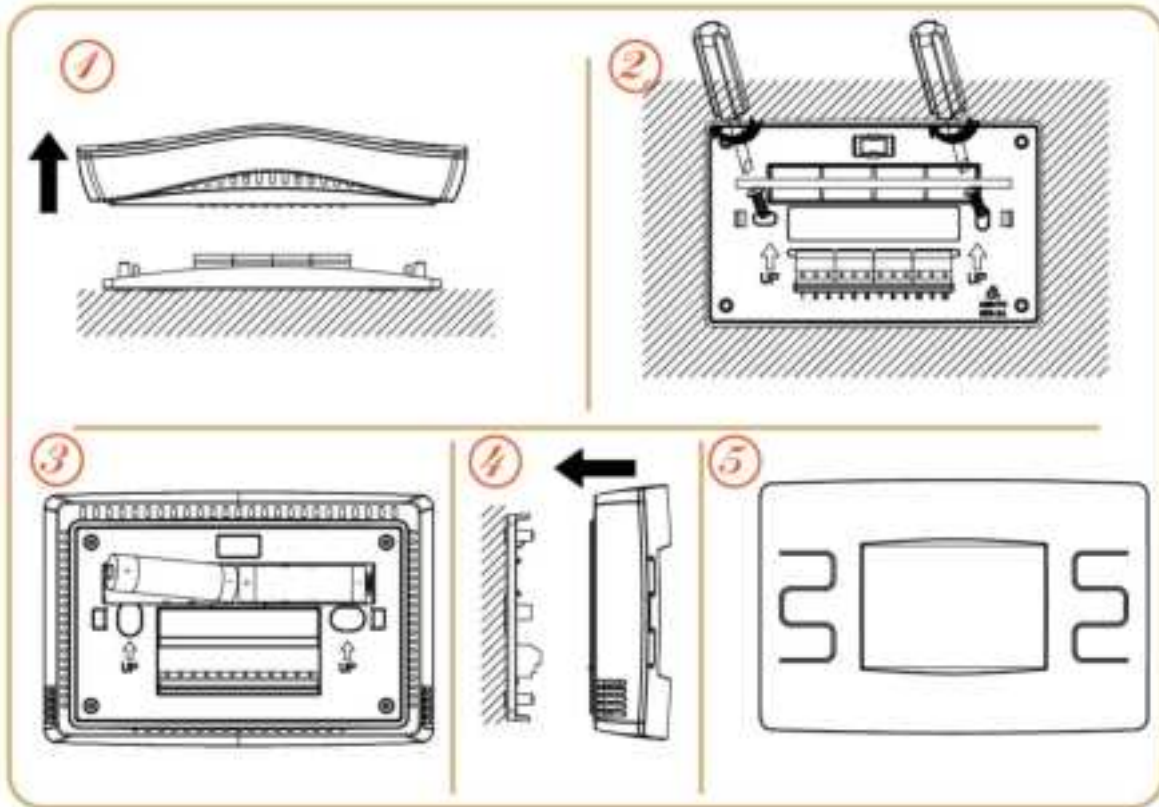

## Wiring diagram

### Description of Terminals

C Common wire, 24V

RH Power(heating end), 24V

RC Power(cooling end), 24V

E/W1 Emergency heat/1st stage heat

O/B Change-over valve

AUX/W2 Emergency heat/2nd stage heat

Y2 2nd stage cool

Y1 1st stage cool

G Fan

Single/Multistage  
Conventional system

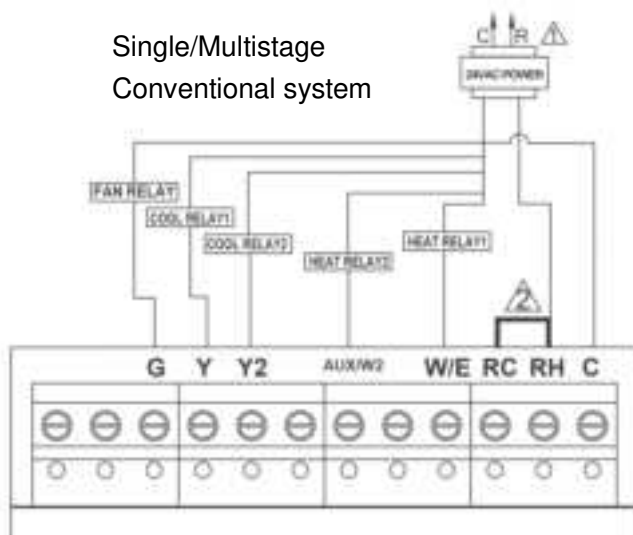

1. 24VAC power

2. Jumper

Heat pump system

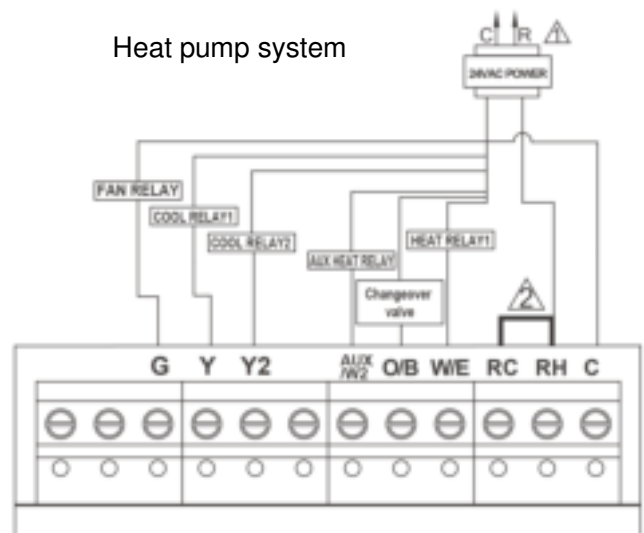

1. 24VAC power

2. Jumper

# WiFi Programmable Thermostat User Guide

AC7300

## Dimension

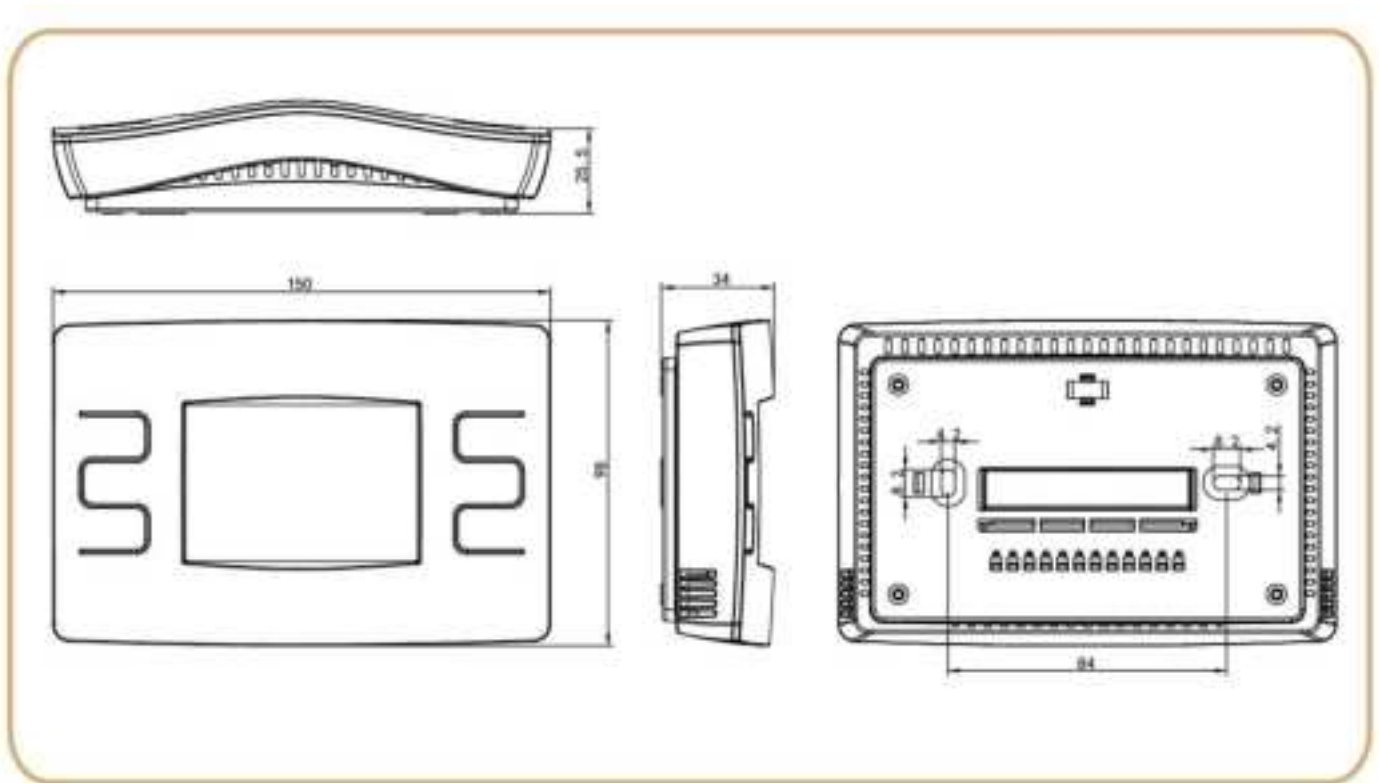

## FCC Warning

This device complies with Part 15 of the FCC Rules. Operation is subject to the following two conditions:

(1) This device may not cause harmful interference, and (2) this device must accept any interference received, including interference that may cause undesired operation.

NOTE 1: This equipment has been tested and found to comply with the limits for a Class B digital device, pursuant to part 15 of the FCC Rules. These limits are designed to provide reasonable protection against harmful interference in a residential installation. This equipment generates, uses and can radiate radio frequency energy and, if not installed and used in accordance with the instructions, may cause harmful interference to radio communications. However, there is no guarantee that interference will not occur in a particular installation. If this equipment does cause harmful interference to radio or television reception, which can be determined by turning the equipment off and on, the user is encouraged to try to correct the interference by one or more of the following measures:

- Reorient or relocate the receiving antenna.
- Increase the separation between the equipment and receiver.
- Connect the equipment into an outlet on a circuit different from that to which the receiver is connected.
- Consult the dealer or an experienced radio/TV technician for help.

NOTE 2: Any changes or modifications to this unit not expressly approved by the party responsible for compliance could void the user's authority to operate the equipment.

## RF Exposure Statement

To maintain compliance with FCC'S RF Exposure guidelines, This equipment should be installed and operated with minimum distance of 20cm between the radiator your body. This device and its antenna(s) must not be co-located or operation in conjunction with any other antenna or transmitter.