

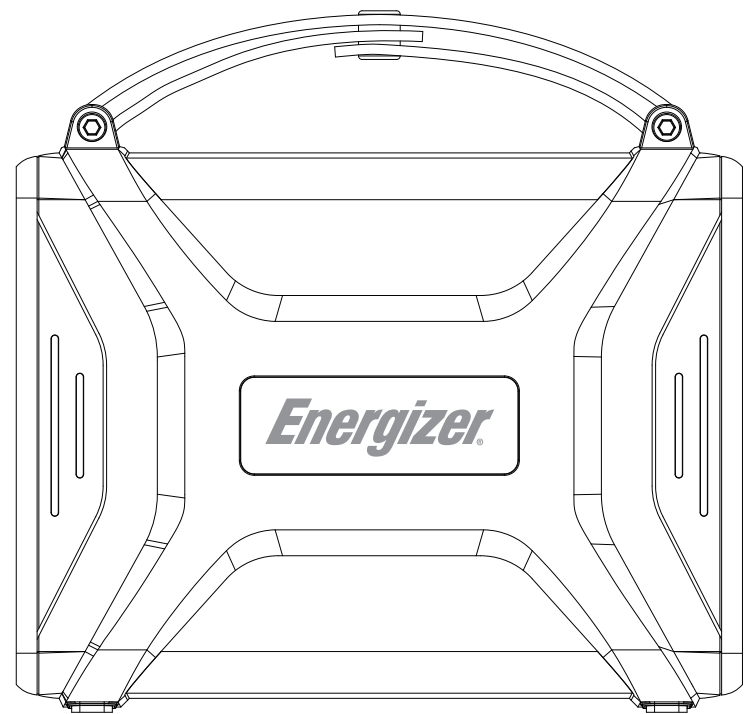

USER MANUAL

PPS240W01 Portable Power Station



Thank you for choosing Energizer !

Energizer products are designed to keep you powered while you're doing what you love. Whether you're climbing in the Himalaya, living in your van while you travel the world, or camping in your backyard we will keep you powered. The purpose of this manual is to help you use the product correctly. Please read the manual carefully and follow the guidance.

⚠ ATTENTION

- The specifications and the pictures in this manual are for reference only.
- The product is only used for emergency situation, it cannot replace the standard AC power for household appliances or digital products.
- Actual AC outlet and AC adapter will be different depending on the locations of customer.
- Fully charge the product before using it for the first time (minimum 10 hours), the battery bar no longer flashes is indicated fully charged.

Get To Know Your Product

1. Front

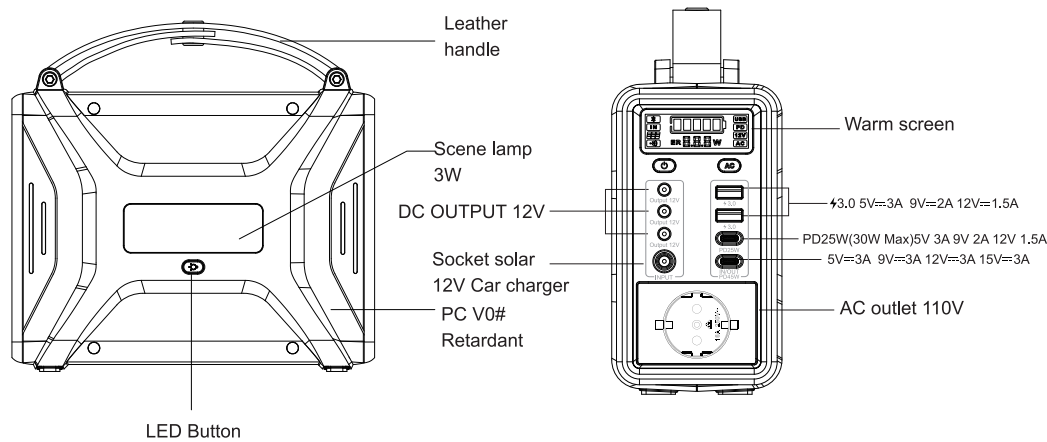

Charging Your Product

⚠ ATTENTION

If it is not used for a long time, it is best to fully charge it every three months before storing; If it has not been used for half a year, please fully charge the product before using. It is best to fully charge each charging.

1.LCD Battery Display

There are 5 segments to the battery,approximating 20% -40% - 60% - 80% -100% capacity. As you use your product, segments will disappear from the display, indicating the remaining charge. When charging your product you will notice a battery segment blinking at a 1 second interval status. Once your products is fully charged, all battery segments will be lit and remain solid.

2.Charge Through Solar Panel

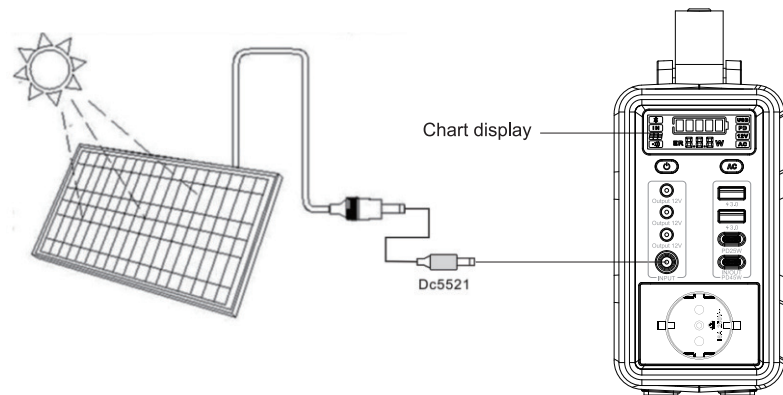

- Place your solar panel where it will get as much strong direct sunlight as possible.
- Connect the output port of the solar panel with the input port of the product to start charging. You will know the product is being charged when the LCD display indicators blink. The product is fully charged when all battery indicators stop blinking and remain solid.

⚠ Notes:

The actual charging efficiency can vary widely depending on weather, ambient temperature, sunlight's strength, the angle that the solar panels faces to the straight sunlight and other factors. The maximum output voltage of the solar panel should not exceed 23.5V. In order to ensure solar chaining efficiency, it is recommended to use solar panels with an open circuit output voltage of 10.8-23.5V. the maximum electric current can reach 3A.

MPPT Technology

With the built-in MPPT (Maximum Power Point Tracking)Technology, this product could be charged by solar panel efficiently. MPPT technology is designed to use with wind turbines and photovoltaic (PV) solar systems to maximize power extraction under all conditions. With MPPT technology, the product cancompare the output voltage of the solar. Panels with the battery voltage in real-time. It then finds out the best power output for charging the battery and maximize the charging efficiency.

3.Charge Through AC Adapter

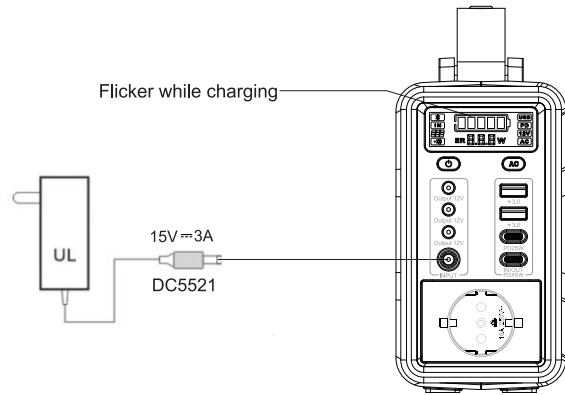

⚠ Notes:

- The product is fully charged when all battery indicators stop blinking and remain solid. After the product is fully charged, please unplug the AC wall charger in time.
- Usually, it takes about 7 hours to fully charge the machine using the original power adapter.
- When you charge your power station by the INPUT port, the PD 100W port can't be used output.

Charge Through Your Car

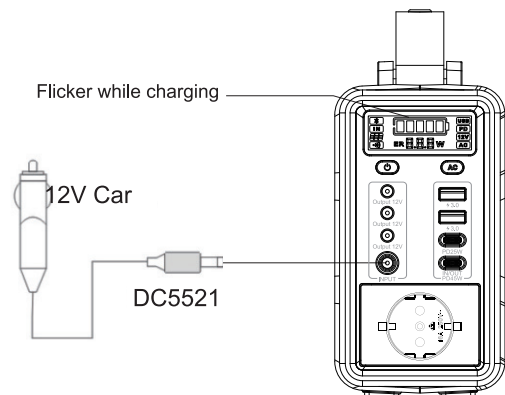

- Plug the original car charger into the cigarette lighter socket of your 12V car, and then plug into the ACinput port of the machine.
- The original car charger features 10A protector tube to protect your car.
- You will know the machine is being charged when the battery indicators blink.
- Depending on your car you may not get a full charge with this method of charging.
- If the charging voltage of your car is too low, the battery can't be charged using this method.

⚠ Notes:

To avoid car battery power loss, you should charge this product through your car cigarette lighter only when your car engine is started.This function is for 12V car ONLY.

Protection mode(DC input)

- Due to the different models of your car, it may not be fully charge.
- Under-voltage protection: The power generator can't be charged if the voltage of your car is too low.

Charge Through PD Charger(PD charger no include)

Plug your PD charger to the PD 45W IN/OUT port.

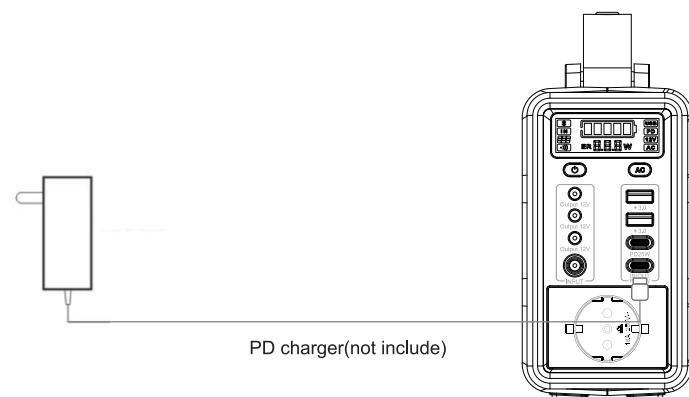

Using Your Product

1. Button

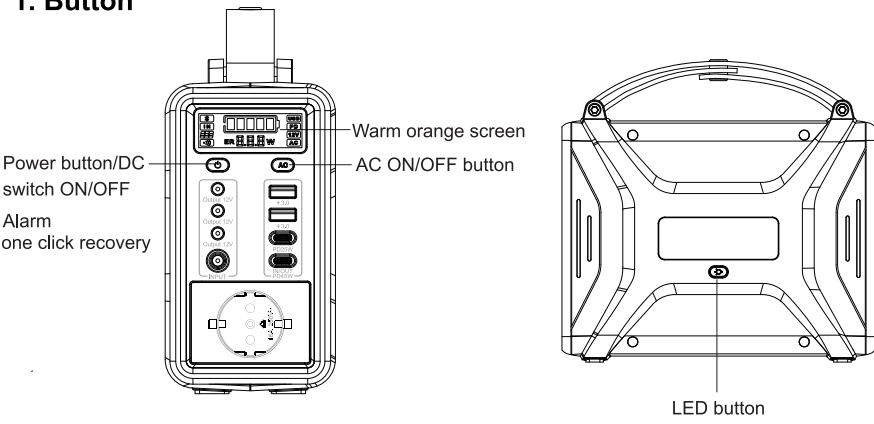

- Long press the power button for 3 secs to turn the machine on. Press this button again to turn on DC function.
- Press the AC button to turn on the AC function.
- Long press the AC button to turn off the sound.
- Press the POWER/DC button and AC button simultaneously to switch the frequency of the machine;

2. LED Button

- Press the LED button to turn on the LED. The first push will put turn on the bright level mode.
- Press the LED button again to change the LED mode into low-LED mode.
- Press the LED button again to activate the sos mode.
- Press the LED button again to change the LED mode to flashing mode.
- Press the LED button again to turn the LED off.

Warning! DO NOT stare the light straightly!

3. USB Output Function

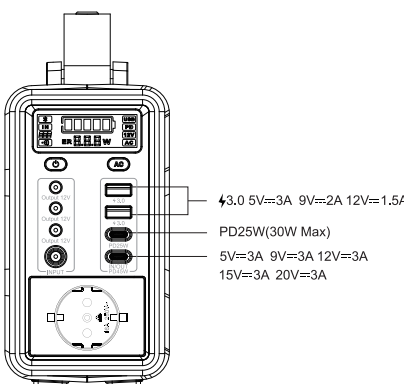

When two USB-A and the USB-C port charging simultaneously, the three ports can only output 5V/5.6A in total.

4. DC Outputs

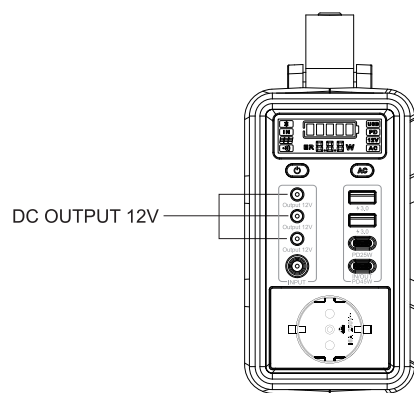

- These three DC5521 (5.5mm in diameter) 12V ports offer max 10A output current and automatically distributing max current according to the external connected devices to ensure shortest charging time.
- Each of DC5521 ports can be connected with an cigarette lighter (power requires no more than 120W).

Protection mode(DC outputs)

Short circuit protection: when short-circuit occurs to the external devices, buzzer sounds ER002 to turn off DC.

⚠ Notes:

When the product's AC, DC, and USB output at the same time, and the total battery current is greater than 38A, after 3 minutes of operation, the product's buzzer will alarm, and the LCD screen will display the fault code E11. If the alarm continues for more than 30 seconds, it has not been cleared, The product will forcibly turn off the DC output to reduce the total output current of the battery and ensure the safety of the product,When the DC output is turned off due to overload, please do not force it to turn on again by pressing the button. When the battery voltage is less than 11.2V, the DC output function will be forcibly closed, and it needs to be charged to release it.

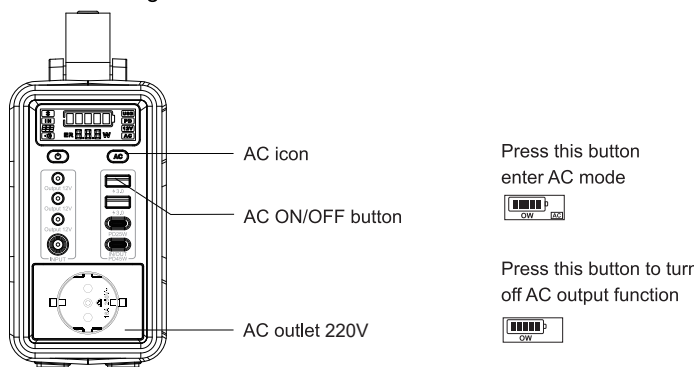

Press this button enter AC mode

Press this button to turn off AC output function

- Press the power button to enter AC mode. Plug the power cable of AC appliance into the AC outlet of the machine.
- Make sure the power of the connected AC appliance is less than 200W.

⚠ Notes:

The LCD screen backlight would automatically turn off down 2 minutes after light up. When the machine is notworking, it automatically shut down.

Protection mode:(AC output)

- This product has undervoltage protection; overload protection; short circuit protection; The overtemperature protection. adopts double isolation circuit, which is safe, reliable and efficient.
- When overload, overtemperature or short circuit occurs, this machine will start beeping and the ER003 icon appears on the screen and then the machine automatically shut down to ensure safety.

Product Specifications

Battery

Cell Type	LiFePO4
Capacity	240Wh (12.8V/18.75A)
Battery Maintenance	Charge Every 3-6 Months

Port

USB Port (Output)	2*3.0 5V=3A 9V =2A 12V=1.5A
USB-C Port (Output)	PD25W(30W Max)
USB-C Port (Output/Input)	5V=3A 9V=3A 12V=3A 15V=3A
5.5mm Port (Output,5.5mm)	3*12V, up to 10 A (120W Max)
AC Port (Output)	220Vac 50Hz
Charging Port (Input, 5.5mm)	Adapter:DC 15V/3A Charging Port (Input,5.5mm) Solar Panel :10.8~23.5V

General

Weight	2.83kg
Dimensions	209×155×85mm
Operating Usage Temp	0~40℃
Illumination	1Ultra-bright LEDs

Error Code

Error code	Causes	Solutions
ER001	DC output overload	Release the overload status,press the DC output button again,the DC output will be able to be used normally
ER002	DC output short circuit	Remove the short-circuit state,press the DC output button again,the DC output will be able to be used normally
ER003	AC output overload, over temperature, over voltage, and short circuit	Release the overload,over temperature,over under voltage,short circuit status,press the AC output key again,the AC output can be used normally
ER004	PD (bi-directional charging)short circuit, overload	Release the overload and short-circuit status, re-insert the USB, theUSB output will be able to be used normally
ER005	PCBA over temperature	Put the product in a cool place and wait for the product temperature drops before using
ER006	PCBA low temperature	Put the product in a high temperature place and wait for the product temperature rises before using
ER007	Battery undervoltage protection	Stop using and fully charge
ER008	PD (unidirectional charging)/USBA short circuit,overload	Release the overload and short circuit status, press the USB output button again,the USB output will be able to be used normally
ER009	DC charging overvoltage	Use a charge with the correct charging voltage to charge the device
ER010	Battery charge and discharge over temperature	Put the product in a cool place and wait for the product temperature drops before using
ER011	Battery discharge overload	When overload,the DC output will be automatically turned off after 210 seconds
ER012	Low power	The AC and DC output will be automatically turned off when prompt to charge
ER013	Deep discharge (prompt to do a charge)	Press any key to release,and charge the battery to full

Caution

- Do not short-circuit the product. To avoid short-circuiting, keep the product away from all metal objects.
- Do not heat the product, or dispose it in fire, water or other liquids. Keep it away from high ambient temperature. Do not expose the product to direct sunlight.
- Keep the product away from humid, dusty places.
- Do not disassemble or reassemble this product.
- Do not drop, place heavy objects on, or allow strong impact to this product.
- This product is not intended to be used by person with reduced physical, sensory or mental capabilities.
- Please keep this product away from children.
- Do not cover the product with towels, clothing and other item.
- Do not overcharge this product.
- When fully charged, disconnect the product from the power source immediately.
- When charging this product, please keep it away from TV, radio and other equipment to avoid radio wave interference.
- If you are not going to use this product for a long time, please disconnect the cable before storing it away.
- To charge some portable electronic devices, you may need to set those devices in charge mode first. Refer the corresponding user manual of those devices for confirmation.

Sine Wave Output

Energizer power station is pure sine wave, which is compatible with AC electric appliance that works with Sinusoidal waveform (power<200W). However, the product is only used for emergency situations. It cannot replace the standard DC or AC power supply for household appliances or digital products.

Package Contents

- 1 x 240Wh Portable power Station
- 1 x Power Adapter
- 1 x Cigarette Lighter Female Adapter
- 1 x Car Charger
- 1 x User Manual

Warranty

Our company provides customers with warranty of 12 months from the date of purchase.

Contact us

For any inquiries or comments concerning our products, please send an email to energizer@iittechnology.com and we will respond to you as soon as possible.



Made in China