

封面

120x85mm

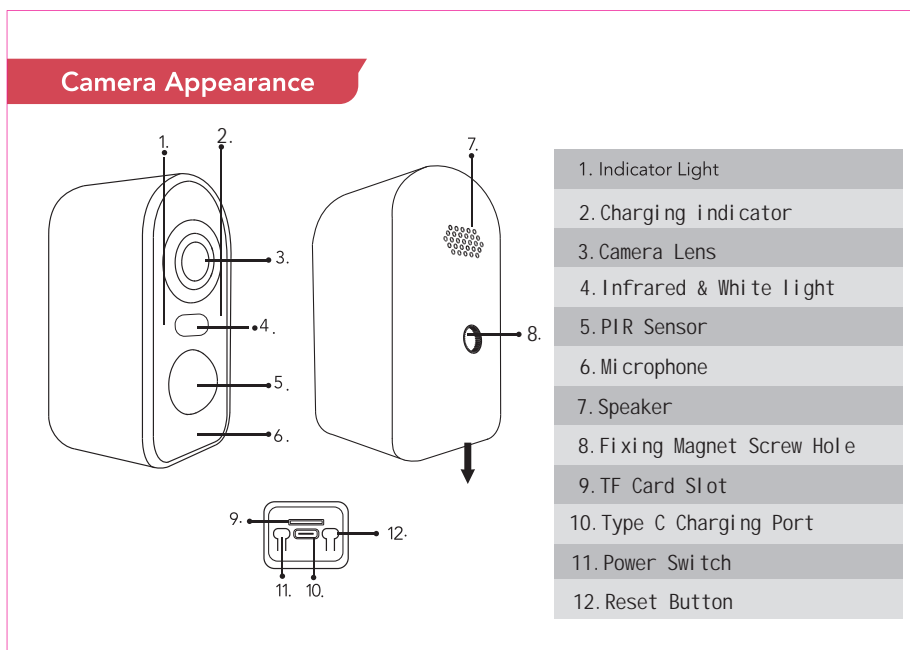
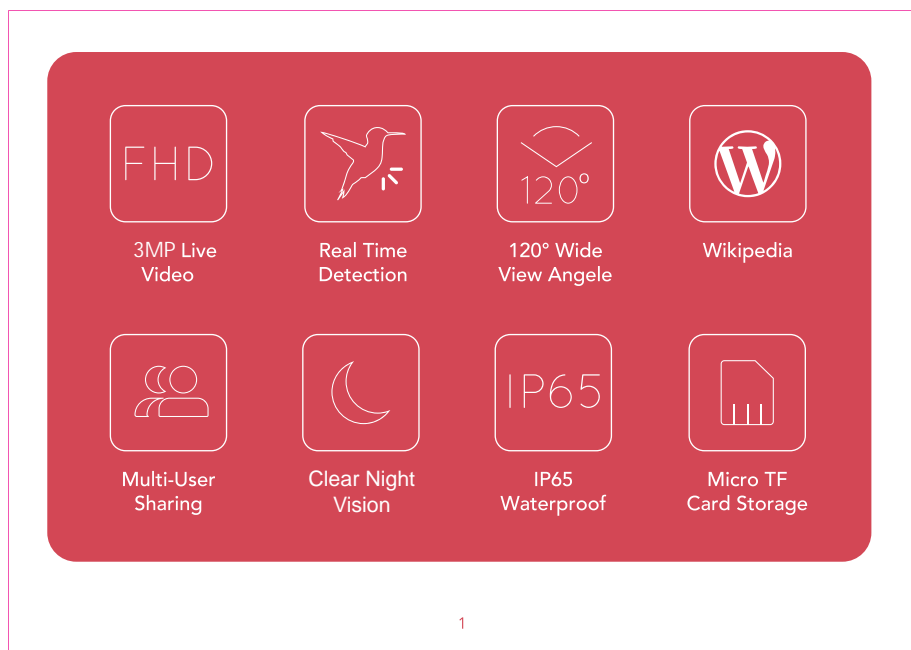

Camera Specification	
Project	Specifications
Lens of the camera	3.2mm
Image resolution ratio	2304*1296P
Camera dimension	97.5*51.5*56mm
Medium	Micro SD card (128GB)
Working temperature	-10°~45°C
Adapter requirement	5V/2A

Switch the Machine and Networking

Power on and off:
Press the power key for 3s to switch between startup and shutdown status.
After the camera is powered on, the blue indicator lights on above the device, and broadcast the "Please configure your WiFi settings."
The front lens indicator light can be observed to confirm whether the device is powered off or turned on. (no prompt sound when power off)

Reset:
If you fail to hear the broadcast, please press the Reset button to restore the factory setting. Insert the reset hole with a pin, long press the Reset key, hear the "Reset successfully. Please wait for the camera to reboot. Please configure your WiFi settings." Then you can enter the distribution network mode.
When first connects to a camera, use HiBirds app to configure the camera network as prompted.

If press the reset button for no reaction, please confirm that the device is turned on (the blue indicator light in front of the lens flashes), you can charge for 2 hours first, and then turn on and reset again.

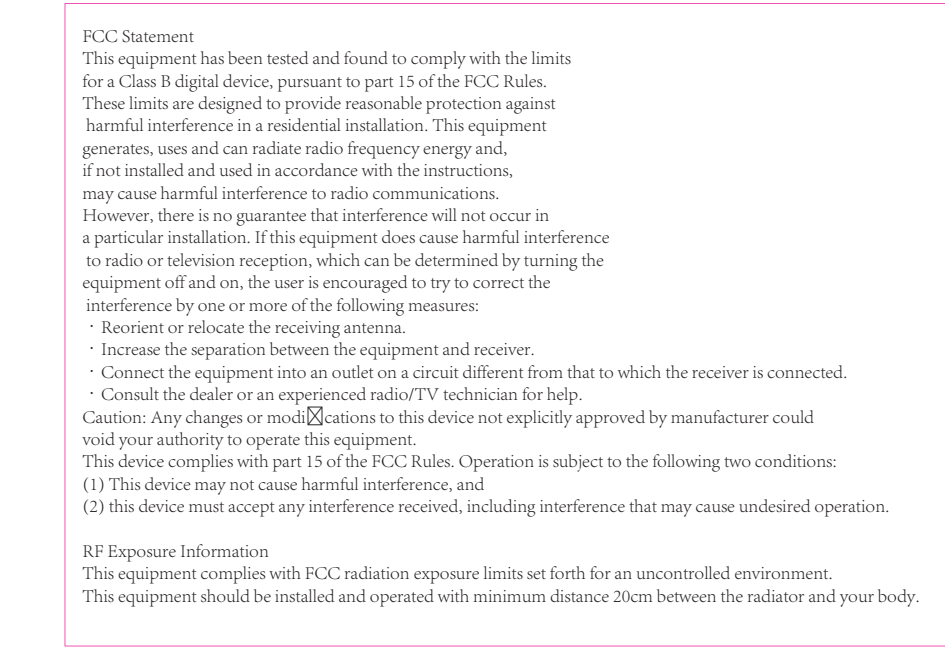
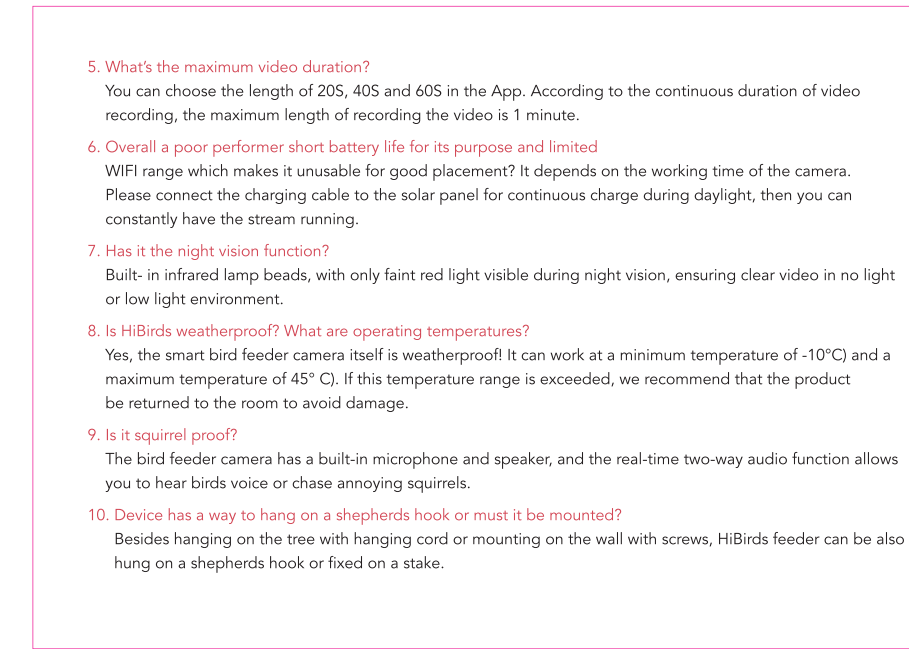
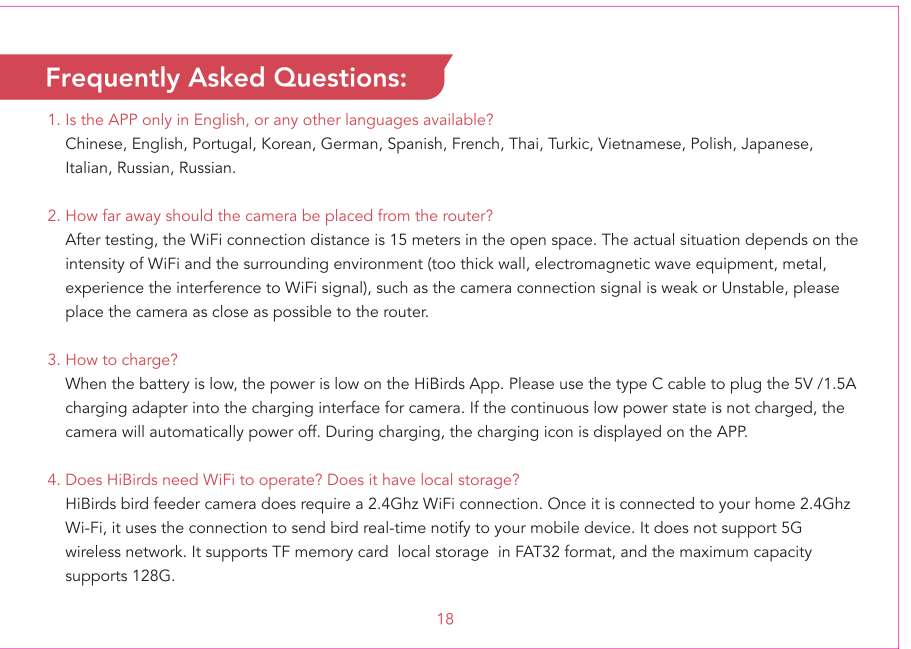
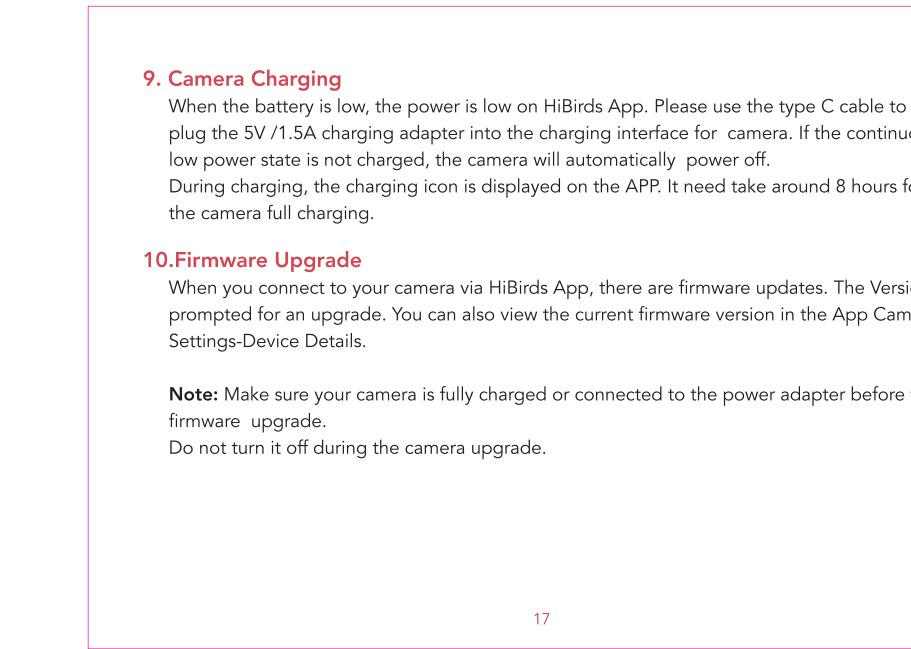
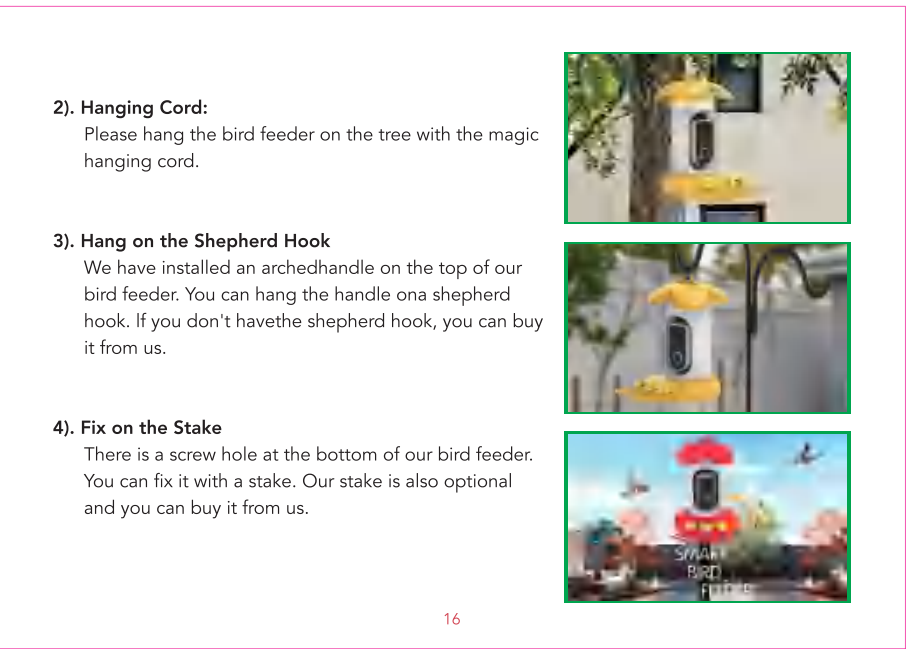
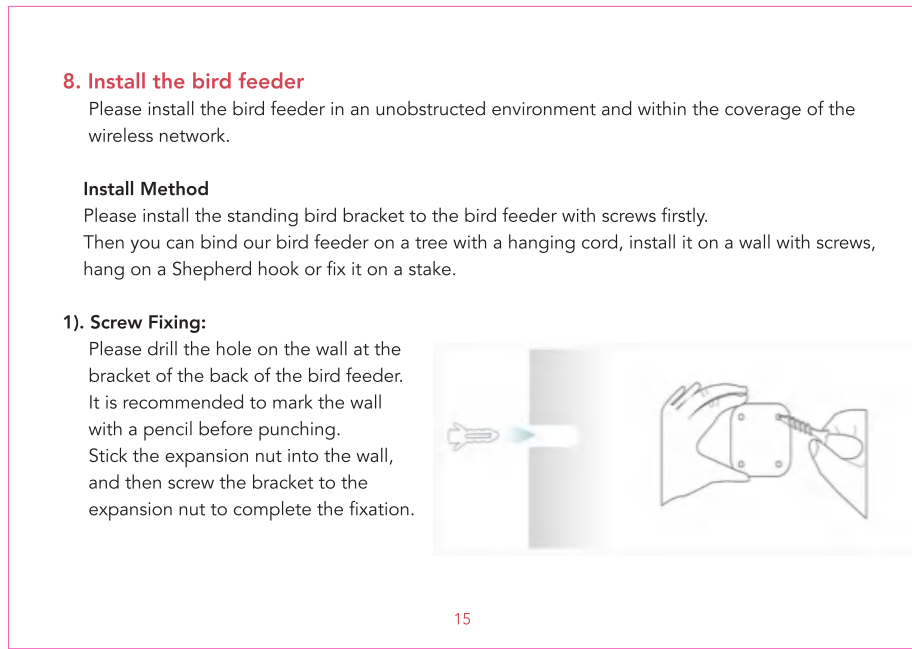
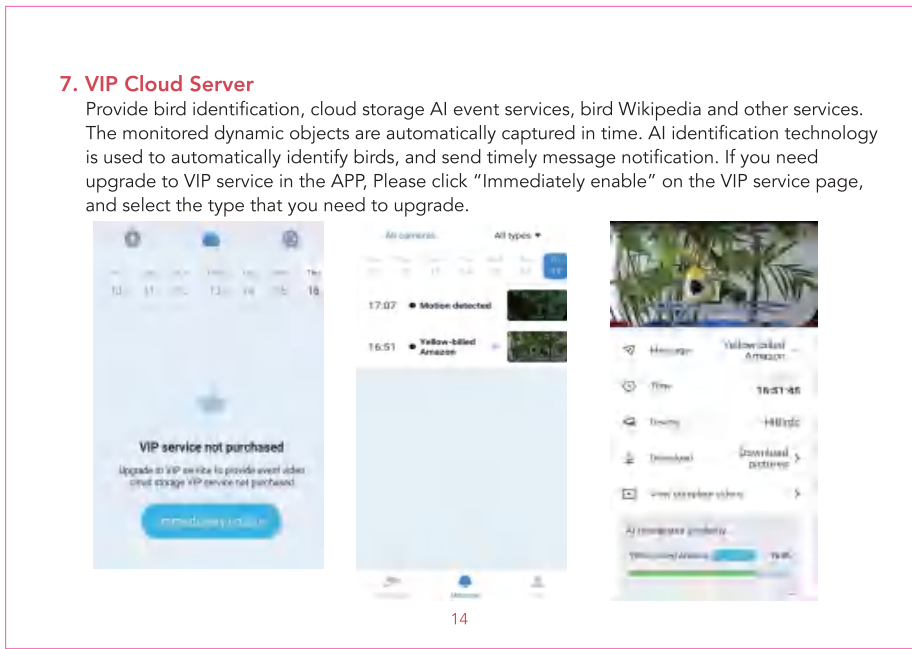
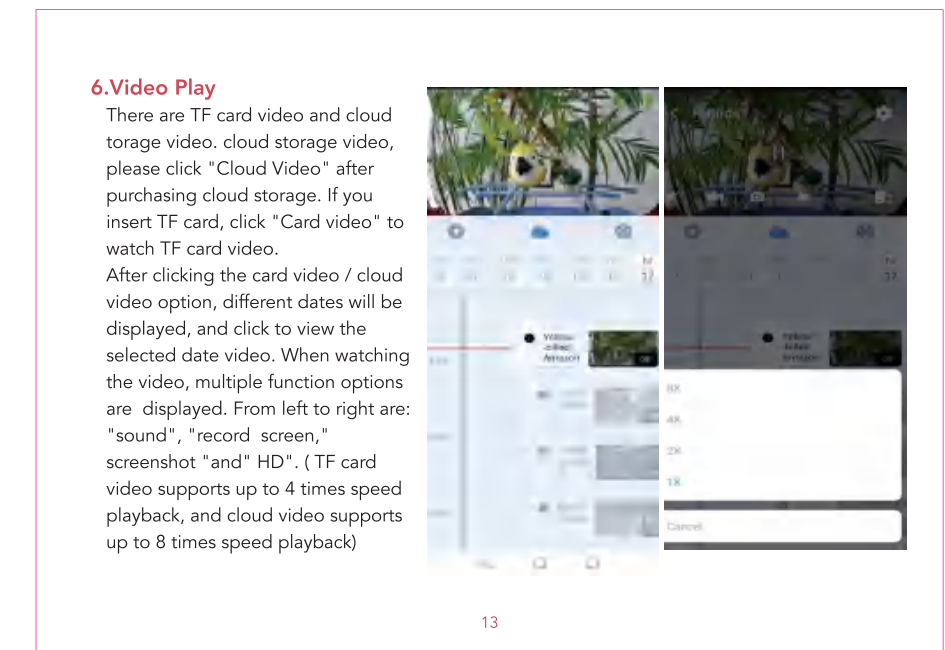
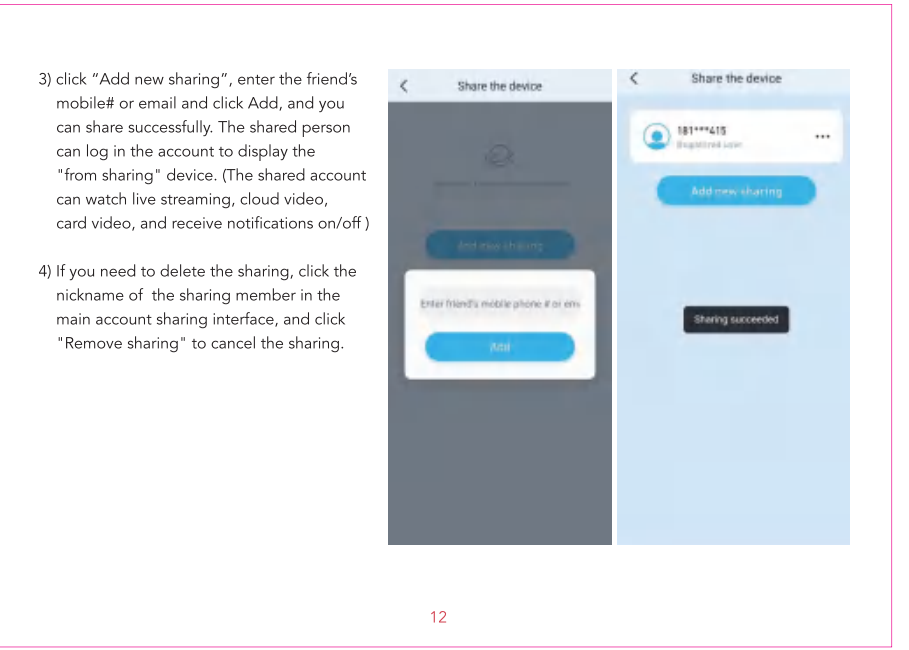
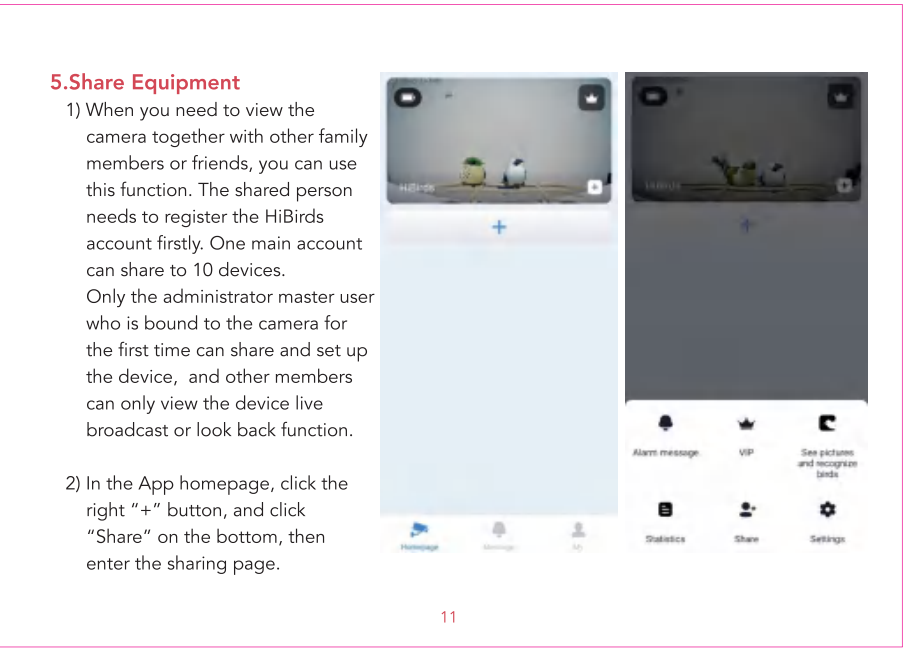
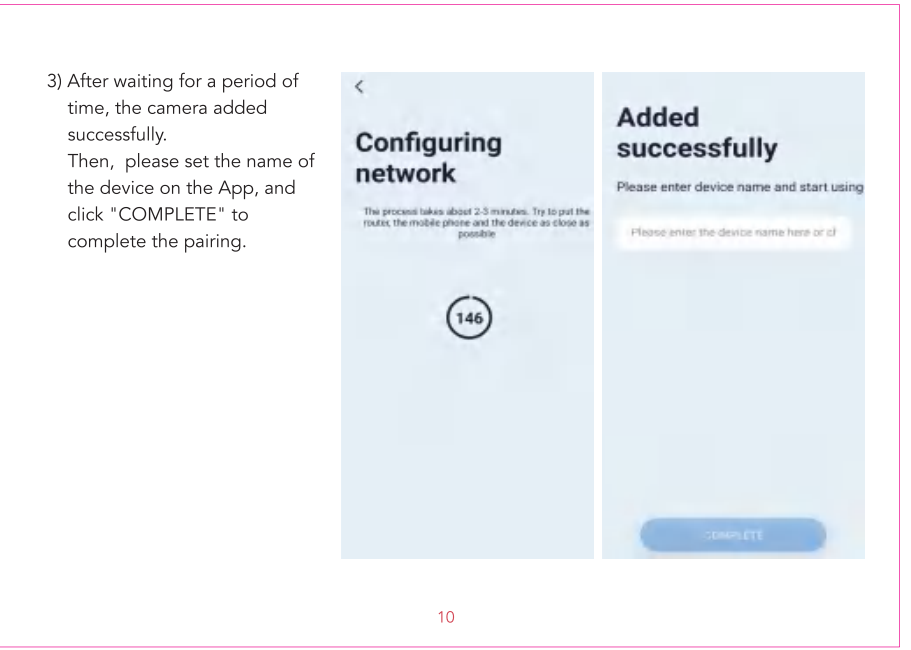
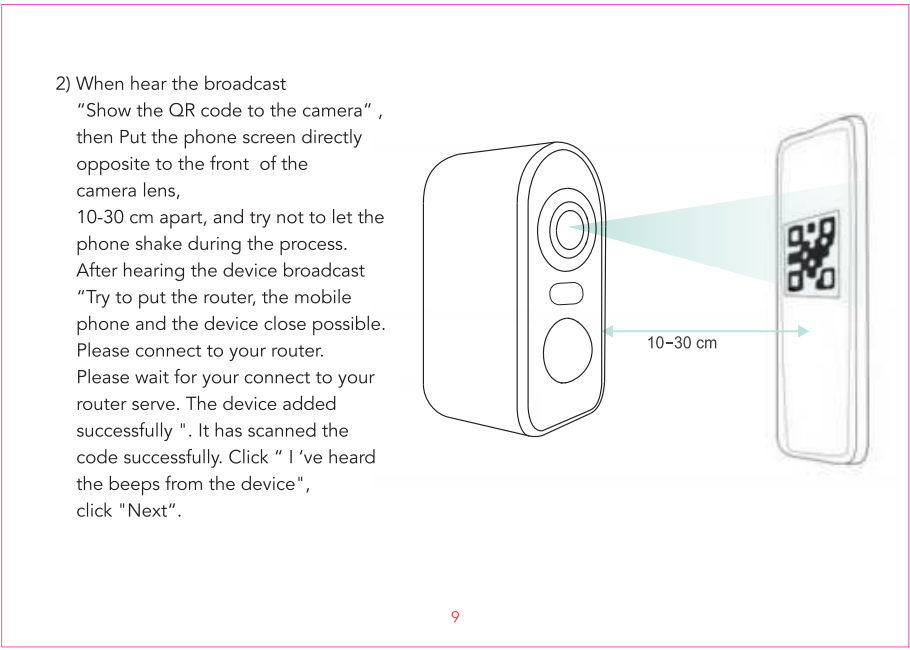
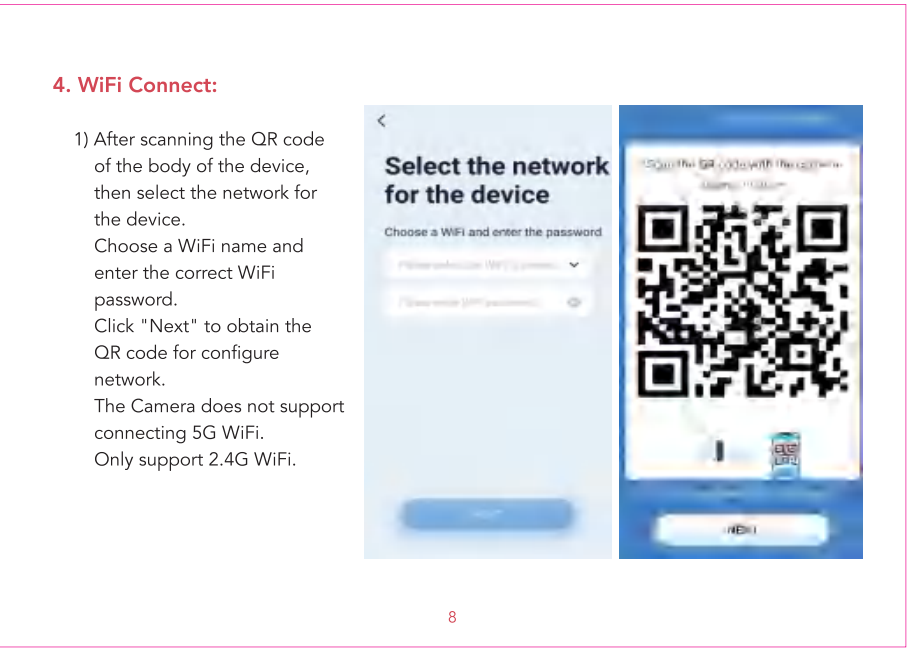
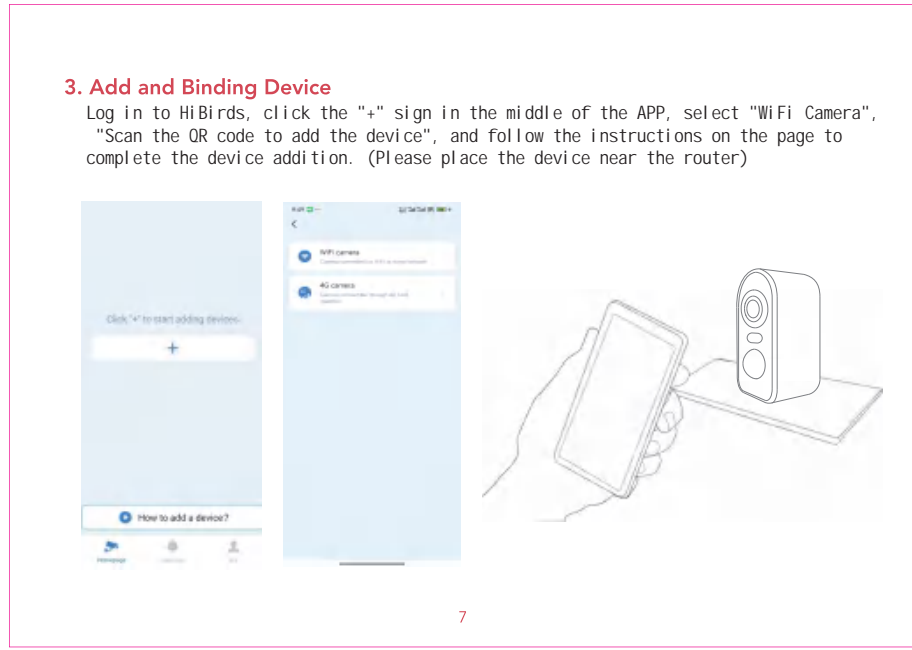
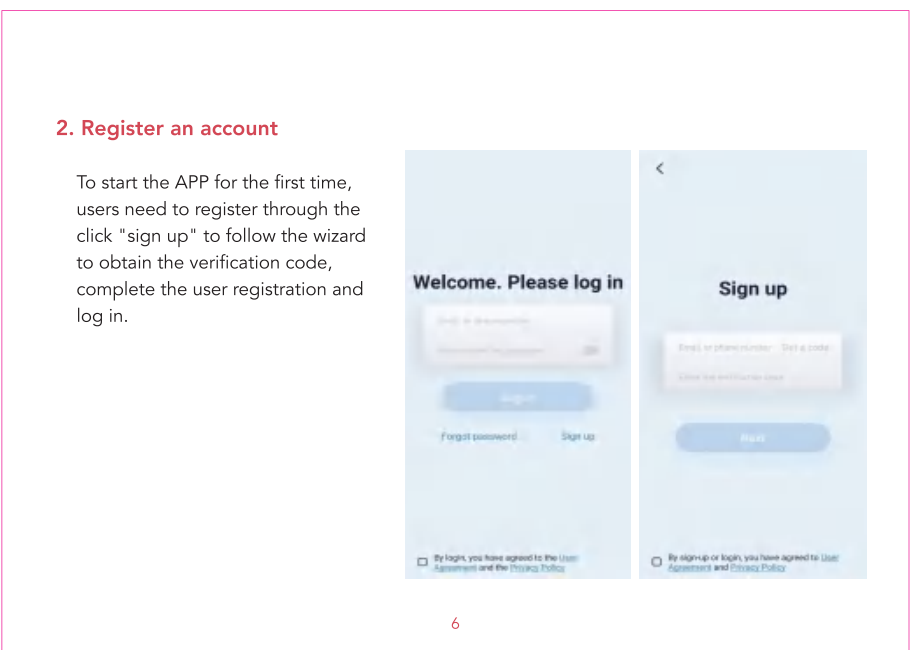

Frequently Asked Questions:

1. Is the APP only in English, or any other languages available?
Chinese, English, Portugal, Korean, German, Spanish, French, Thai, Turkic, Vietnamese, Polish, Japanese, Italian, Russian, Russian.
2. How far away should the camera be placed from the router?
After testing, the WiFi connection distance is 15 meters in the open space. The actual situation depends on the intensity of WiFi and the surrounding environment (too thick wall, electromagnetic wave equipment, metal experience the interference to WiFi signal), such as the camera connection signal is weak or Unstable, please place the camera as close as possible to the router.
3. How to charge?
When the battery is low, the power is low on the HiBirds App. Please use the type C cable to plug the 5V/1.5A charging adapter into the charging interface for camera. If the continuous low power state is not changed, the camera will automatically power off. During charging, the charging icon is displayed on the APP.
4. Does HiBirds need WiFi to operate? Does it have local storage?
HiBirds bird feeder camera does require a 2.4GHz WiFi connection. Once it is connected to your home 2.4GHz Wi-Fi, it uses the connection to send bird real-time notify to your mobile device. It does not support 5G wireless network. It supports TF memory card local storage in FAT32 format, and the maximum capacity supports 128G.

5. What's the maximum video duration?
You can choose the length of 20S, 40S and 60S in the App. According to the continuous duration of video recording, the maximum length of recording the video is 1 minute.
6. Overall a poor performer short battery life for its purpose and limited WiFi range which makes it unusable for good placement? It depends on the working time of the camera. Please connect the charging cable to the solar panel for continuous charge during daylight, then you can constantly have the stream running.
7. Has it the night vision function?
Built-in infrared lamp beads, with only faint red light visible during night vision, ensuring clear video in no light or low light environment.
8. Is HiBirds waterproof? What are operating temperatures?
Yes, the smart bird feeder camera itself is waterproof! It can work at a minimum temperature of -10°C and a maximum temperature of 40°C. If this temperature range is exceeded, we recommend that the product be returned to the room to avoid damage.
9. Is it squirrel proof?
The bird feeder camera has a built-in microphone and speaker, and the real-time two-way audio function allows you to hear birds voice or chase awaying squirrels.
10. Device has a way to hang on a shepherd's hook or must it be mounted?
Besides hanging on the tree with hanging cord or mounting on the wall with screws, HiBirds feeder can be also hung on a shepherds hook or fixed on a stake.

POC Statement
This equipment has been tested and found to comply with the limits for a Class B digital device, pursuant to part 15 of the FCC Rules. These limits are designed to provide reasonable protection against harmful interference in a residential installation. This equipment generates, uses and can radiate radio frequency energy and, if not installed and used in accordance with the instructions, may cause harmful interference to radio communications. However, there is no guarantee that interference will not occur in a particular installation. If this equipment does cause harmful interference to radio or television reception, which can be determined by turning the equipment off and on, the user is encouraged to try to correct the interference by one or more of the following measures:
· Reorient or relocate the receiving antenna.
· Increase the separation between the equipment and receiver.
· Connect the equipment into an outlet on a circuit different from that to which the receiver is connected.
· Consult the dealer or an experienced radio/TV technician for help.
Caution: Any changes or modifications to this device not explicitly approved by manufacturer could void your authority to operate this equipment.
This device complies with part 15 of the FCC Rules. Operation is subject to the following two conditions:
(1) This device may not cause harmful interference, and
(2) This device must accept any interference received, including interference that may cause undesired operation.

RF Exposure Information
This equipment complies with FCC radiation exposure limits set forth for an uncontrolled environment. This equipment should be installed and operated with minimum distance 20cm between the radiator and your body.

封底