



Anker Innovations Limited. All rights reserved. **Eufy** and the **Eufy logo** are trademarks of Anker Innovations Limited, registered in the United States and other countries. All other trademarks are the property of their respective owners.

51005001377 V02

User Manual

eufy Security SpaceView

Note: make sure you get the latest firmware upgrade for your baby monitor.

What's in the Box

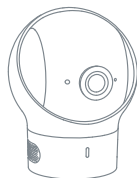

Baby Camera
T8300-C



Wall Mount



Camera Micro-USB
Power Cable (3 m)



Camera Adapter
(5V 2A)



Mounting
Screws



Wide-Angle Lens



User manual



Power adapter varies by region.

Camera Features:

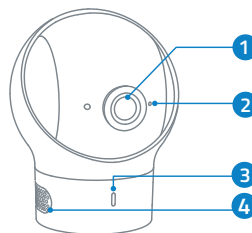

- 1 Standard camera lens
- 2 Microphone
- 3 Power LED Status indicator

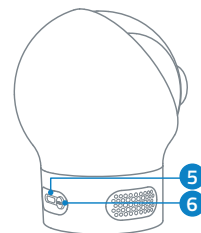

- 4 Speaker
- 5 Micro USB port
- 6 Pairing button

Setting Up the Camera

Camera Installation

Connect the baby camera's Micro USB power cable to the camera adapter (5V 2A), and then connect the adapter to a power outlet. Finally, connect the other end of the baby camera's micro USB power cable to the micro USB port in the camera.

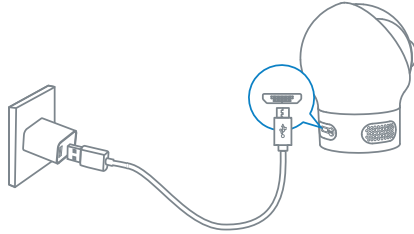

Adding a new Baby Camera to the Baby Monitor

1. Check the firmware version of the monitor (see image below), to make sure your SpaceView Baby Monitor is running firmware version v2.3.0 or above. Contact our customer service team for the latest firmware updates at: support@eufylife.com

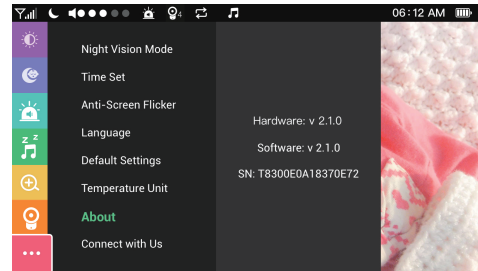

2. Enter menu settings, go to **Camera** -> **Add Camera**, then follow onscreen instructions to start the pairing.
3. Press and hold the pairing button on the rear of the camera for 1 second until a notification prompt is heard.

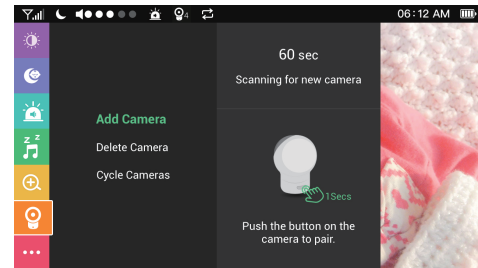

4. You can enable the Cycle Camera function when the monitor has two or more baby cameras linked to it; a maximum of 4 cameras can be paired to a monitor. The monitor will cycle through the video of each camera paired to it. Press the OK button on the monitor to switch between the different cameras.

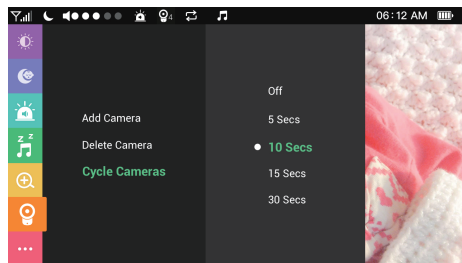

Camera Placement (on the Wall Mount)

1. Use the monitor to test the viewing angle from your desired mounting spot.
2. Mark the screw holes with a pencil.
3. Drill 1/5" holes into the wall and then insert the anchors into the holes.

4. Insert the screws through the mounting holes of the wall mount and screw into the anchors.

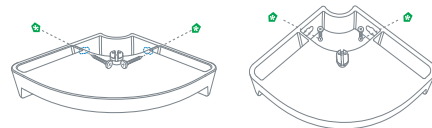



90° vertical installation

180° horizontal wall installation

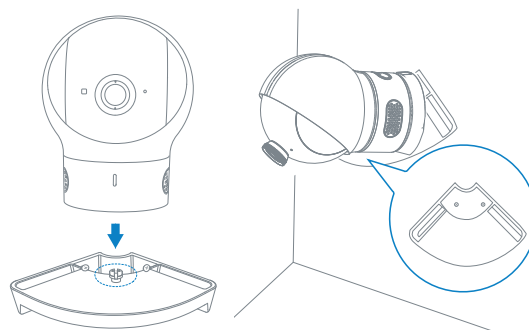
5. Place the camera on the wall mount.

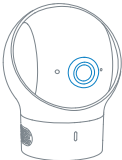

Replacing the Camera lens

Lens type	Usage	Lens
Standard camera lens (default lens)	This lens is recommended for general viewing; infants are clearly seen within a 2~3m range. The lens angle of view for standard camera lens is 62°.	
Wide-angle lens	This lens provides a wide-angle view of the room. The lens angle of view for wide-angle lens is 110°.	

The standard camera lens is not removable. When you want to use the wide-angle lens, simply place it over the standard camera lens and fasten.

Wide-angle lens Installation



Place the baby camera on a flat surface to install the wide-angle lens. Clean the lens with soft cloth.

1. Place the wide-angle lens over the standard camera lens.
2. Turn the wide-angle lens clockwise to fasten onto the standard camera lens; stop turning once you feel resistance.

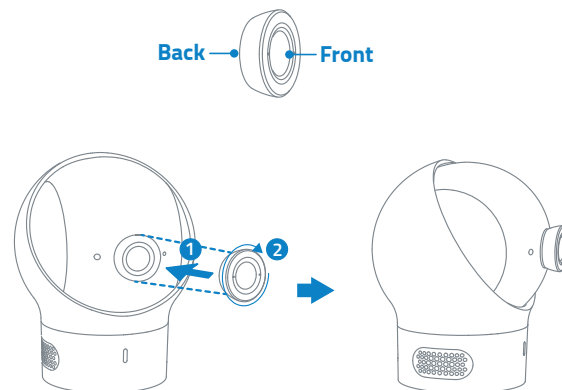

Safety

Warning

Strangulation Hazard: Children have STRANGLED in cords. Keep this cord out of the reach of children (more than 1m (3ft) away). Never use extension cords with AC Adapters. Only use the AC Adapters provided.

 This product complies with the radio interference requirements of the European Community.

Declaration of Conformity

Hereby, Anker Innovations Limited declares that this device is in compliance with the essential requirements and other relevant provisions of Directive 2014/53/EU. For the declaration of conformity, visit the Web site <https://www.eufylife.com/>.

This product can be used across EU member states.

Due to the used enclosure material, the product shall only be connected to a USB Interface of version 2.0 or higher. The connection to so called power USB is prohibited.

A statement regarding the AC/DC adapter as disconnect device is missing in the user manual.

The statement shall require a socket outlet that is installed near equipment and that shall be easily accessible.

The adapter shall be installed near the equipment and shall be easily accessible.

Do not use the Device in the environment at too high or too low temperature, never expose the Device under strong sunshine or too wet environment. The suitable temperature for T8300-C and accessories is -20°C~40°C.

When charging, please place the device in an environment that has a normal room temperature and good ventilation.

It is recommended to charge the device in an environment with a temperature that ranges from -10°C~40°C.

Please ensure to use only the charger offered by the manufacturer. Using unauthorized charger may cause danger and violate the authorization of the projector and the guarantee article.

The charger output voltage/current is 5Vdc/2A. The plug considered as disconnect device of adapter.

If you use a third-party charger, the recommended output voltage/current of the adaptor is 5Vdc/2A, and the adapter shall be CE approval type.

CAUTION RISK OF EXPLOSION IF BATTERY IS REPLACED BY AN INCORRECT TYPE. DISPOSE OF USED BATTERIES ACCORDING TO THE INSTRUCTIONS
RF exposure information: The Maximum Permissible Exposure (MPE) level has been calculated based on a distance of d=20 cm between the device and the human body. To maintain compliance with RF exposure requirement, use product that maintain a 20cm distance between the device and human body.
Operating Frequency Range: 2410-2477MHz
The T8300-C Max Output Power: 18.04dBm

The T3800-C device has been evaluated to meet general RF exposure requirements and can be used in fixed exposure condition. RF exposure information: The Maximum Permissible Exposure (MPE) level has been calculated based on a distance of d=20 cm between the device and the human body. To maintain compliance with RF exposure requirement, use product that maintain a 20cm distance between the device and human body. The following importer is the responsible party (contact for EU matters only)
Importer: Anker Technology (UK) Ltd
Importer Address: Suite B, Fairgate House, 205 Kings Road, Tyseley, Birmingham, United Kingdom B11 2AA



This product is designed and manufactured with high quality materials and components, which can be recycled and reused.



This symbol means the product must not be discarded as household waste, and should be delivered to an appropriate collection facility for recycling. Proper disposal and recycling helps protect natural resources, human health and the environment. For more information on disposal and recycling of this product, contact your local municipality, disposal service, or the shop where you bought this product.

FCC Statement

This device complies with Part 15 of the FCC Rules. Operation is subject to the following two conditions: (1) this device may not cause harmful interference, and (2) this device must accept any interference received, including interference that may cause undesired operation.

Warning: Changes or modifications not expressly approved by the party responsible for compliance could void the user's authority to operate the equipment.

Note: This equipment has been tested and found to comply with the limits for a Class B digital device, pursuant to Part 15 of the FCC Rules. These limits are designed to provide reasonable protection against harmful interference in a residential installation.

This equipment generates uses and can radiate radio frequency energy and, if not installed and used in accordance with the instructions, may cause harmful interference to radio communications. However, there is no guarantee that interference will not occur in a particular installation. If this equipment does cause harmful interference to radio or television reception, which can be determined by turning the equipment off and on, the user is encouraged to try to correct the interference by one or more of the following measures: (1) Reorient or relocate the receiving antenna. (2) Increase the separation between the equipment and receiver. (3) Connect the equipment into an outlet on a circuit different from that to which the receiver is connected. (4) Consult the dealer or an experienced radio/TV technician for help.

FCC Radio Frequency Exposure Statement

The T8300-C device has been evaluated to meet general RF exposure requirements. The T8300-C can be used in fixed exposure condition. The min separation distance is 20cm.

The following importer is the responsible party Company Name:

POWER MOBILE LIFE, LLC

Address: 400 108th Ave NE Ste 400, Bellevue, WA 98004-5541

Telephone: 1-206-383-8247

Customer Service

■ Warranty

12-month limited warranty

■ Call Us

United States +1 (800) 988 7973 Mon-Fri 9AM-5PM (PT)

United Kingdom +44 (0) 1604 936 200 Mon-Fri 6AM-11AM (GMT)

Germany +49 (0) 69 9579 7960 Mon-Fri 6:00-11:00

■ Email Us

Customer Support: support@eufylife.com



@EufyOfficial



@EufyOfficial



eufyofficial

