

Moodlight ColorStrip LED lights

10'



USER GUIDE

INTRODUCTION & FEATURES

Give your living room a unique atmospheric twist with the AuraLED Moodlight ColorStrip. Designed with a self-adhesive backing, this colorful backlight can be fixed directly onto the back of your TV or computer screen, enhancing your home theater and easing light-induced fatigue. It fits screens up to 65" and includes a wireless remote control, which provides you with the freedom to customize your selection of 16 colors and find the perfect brightness, rhythm, and color scheme.

PACKAGE CONTENTS

- 10 ft. ColorStrip
- Wireless Remote Control
- User Guide

1

PRODUCT OVERVIEW

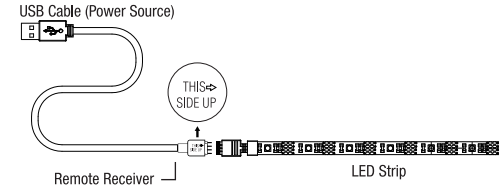

- To adjust the size of the ColorStrip, please cut along the designated line as shown below:

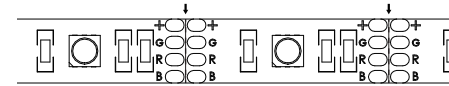

NOTE: Cutting anywhere else will result in partial or total damage to the LED ColorStrip.

2

INSTALLATION

NOTE: Please make sure that the back surface of your TV is free of dust, oils, or fingerprints before attempting to apply your ColorStrip. Use an alcohol-based cleaning cloth to wipe the back of your TV.

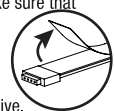
- Locate the USB port on the back of your TV. If your TV does not have a USB port, you may use any other USB power source.
- Make sure that you are satisfied with the coverage area of the ColorStrip prior to peeling off the adhesive tape. Make sure that the USB cable is placed near the USB port and has enough slack to reach safely. The Remote Receiver must also be visible in order to work properly. 
- Peel off the backing of the strip to expose the adhesive.
- Apply the strip to the cleaned surface on the back of your TV. Press down for 3-4 seconds to secure it.
- Connect the ColorStrip to the USB Cable and insert the cable into the USB port.
- Once connected, remove the protective plastic strip from the remote control to activate the battery.
- Press the ON button to turn on the ColorStrip.
- Refer to the color combinations settings on the remote to customize your ColorStrip.

over 3

ASSEMBLY

See below for suggested ColorStrip placement depending on your TV size:

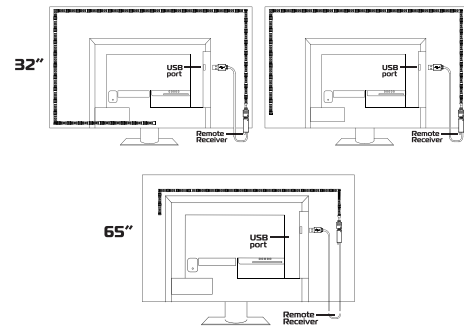

These illustrations are for visual reference only. ColorStrip placement will vary depending on each individual unit.

4

WIRELESS REMOTE CONTROL

Buttons 1 and 2 can be used to control the brightness for the LED color buttons, and change the speed for buttons 6,7,8,9.



When remote control operation becomes slow, it is time to change the battery.

*Compatible with CR2025-CR2032 battery types.

5

COLORSTRIP SPECS

Input: 5V/1A-4A
 Power Consumption: 4W-16W
 LED Chip: 5050, RGB
 Color: 16 colors with 4 Mood light settings
 LED Strip: 120 LED lights / 10 ft. (120")
 Back Adhesive: Self-adhesive
 Working Temperature: -4° - 113°F
 Working Humidity: 0% ~ 80% RH

CARE & IMPORTANT SAFEGUARDS

- Keep the ColorStrip away from flammable objects.
- Always make sure that all parts have been connected properly.
- Check to make sure the voltage of the power source (USB) is 5V.
- Do not connect the ColorStrip to the power source until all of the installation steps have been completed properly.
- Always make sure that the Remote Receiver is not covered or blocked. This will ensure proper operation using the remote control.
- If this product malfunctions, please do not try to repair it yourself. Take it to a qualified electrician.

6

If you have any other questions or issues with product use and/or care, please contact tzumi Customer Support at: support@tzumi.com or 1-855-GO-TZUMI.



Moodlight ColorStrip LED lights. Distributed by AuraLED. NY, NY 10016. © Copyright 2022. All Rights Reserved. Made in China. Other trademarks and trade names are those of their respective owners. All pictures shown are for illustration purposes only. Actual product may vary due to product enhancement. Subject to change without prior notice.



7