

Smart Video Doorbell



Quick Start Guideline

Please read it carefully before usage and save the manual for future use

Appearance

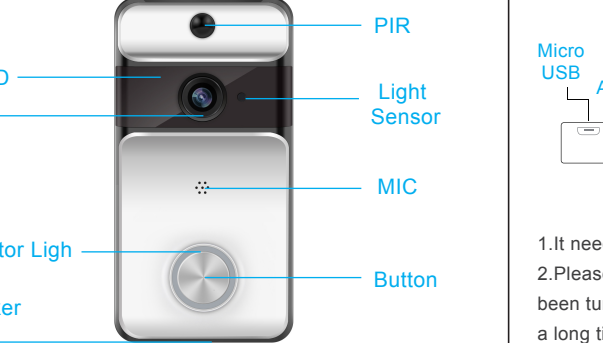

IR LED In the event of inadequate ambient light, turn on the IR LED to increase the brightness

Light Sensor Used to collect ambient light. When luminance is lower than 2 Lux, turn on the IR LED

MIC Used to collect ambient sound and achieve vocal dialogue

Button Used to wake up the Equipment to notify the user of any visitor and link to the buzz responder

PIR When someone moves in front of the equipment, triggers a signal that is generated and sent to the cell phone

Lens Lens Used to collect the image and video

Indicator Light When the Blue Indicator Light is blinking, the Equipment is in the configuration status; When the Red Indicator Light is always "ON", the Wi-Fi connection has failed; When the Blue Indicator Light is always "ON", the Equipment is successfully connected; When the Red and Blue Indicator Lights are "ON" at the same time, the Equipment is connected to Wi-Fi;

Speaker Used to send out a system prompting sound and achieve vocal dialogue

1

Battery introduction

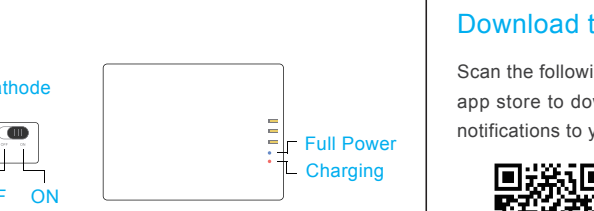

- 1.It need to charge 12 hours on the 1st charging
- 2.Please make sure the button on the bottom of battery have been turn "on" otherwise, it will not charging or power on for a long time
- 3.When you charge the battery, the led indicators will be flash blue, After fully charged the led indicators will be stable blue

Packing List

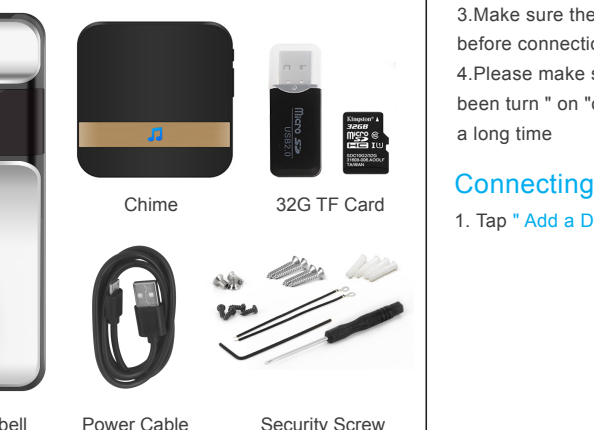

2

Connecting doorbell to your phone

Download the APP - XSH Cam

Scan the following the QR code or search "XSH Cam" on the app store to download the app. Note: Allow the app to send notifications to your phone firstly.



Prepare before connection

Before you begin...

- 1.Make sure the Xsh Cam app is installed to your device.
- 2.Make sure that your device is connected to a 2.4GHz Wi-Fi network, NOT a 5GHz network.
- 3.Make sure the rechargeable battery have been fully charged before connection
- 4.Please make sure the button on the bottom of battery have been turn "on" otherwise, it will not charging or power on for a long time

Connecting Doorbell with App

1. Tap "Add a Device"

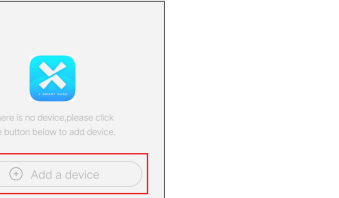

3

2. Tap "Setup Device"

Note:If you have multiple devices,only setup one at a time

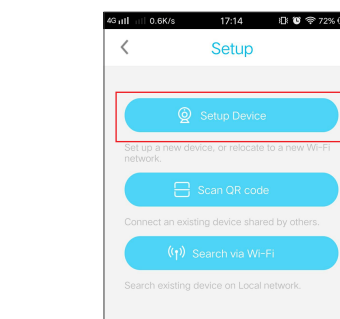

4

4. The name of the Wi-Fi network will automatically be filled in, enter the Wi-Fi password.

The APP will fill the corresponding password automatically if connected with the same Wi-Fi, and you don't need to fill the password again.Then please tap "Next".

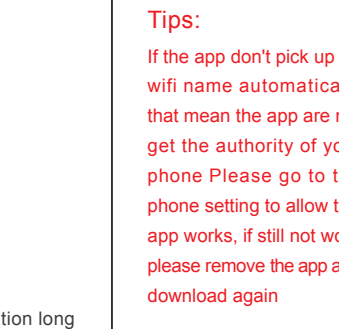

5

6. If your doorbell fails to connect, reset the doorbell andrepeat all the steps (please see the previous section, and reset the doorbell)

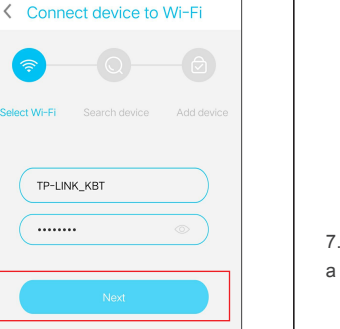
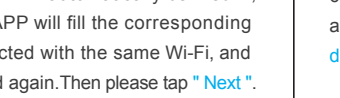

6

7. After a successful connection, you will be prompted to create a name and password for your camera.

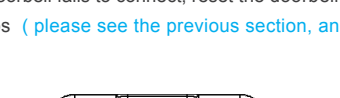

7

8. Setup completed! The APP will be entered the device list interface automatically.Congratulations! The device is ready for use.

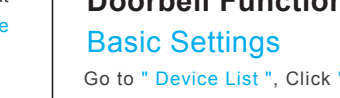

8

9. SD Card / Cloud Storage Settings

Cloud Storage Settings
Cloud Video/Storage:Enable it to get cloud storage service

Note: Cloud Storage is free.7day loop recording
Each record only 8S.
couldn't change it

SD card Storage Settings
Cloud Video/Storage:
Disable it to get Micro SD card inserted for storage

Checking and SD card capacity and Format SD card here

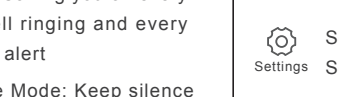

9

10. Checking Recorded Video

Checking Recorded Video on Cloud storage
Please find the "cloud video" on the live video interface to check all could video

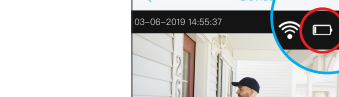

Checking Recorded Video on SD card
Please drag the timeline to the yellow area to play the recorded video.Yellow area is the recorded Video

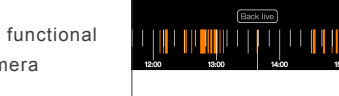

10

11. Active Time / Dormancy Time

Recording time setup. Only available for SD card storage
15S.30S.60S:choose different record time after the PIR motion detection have been triggered for recording

Always: Always in recording mode no matter if there is any movement. But it only worked for SD card storage And battery are easy to run out



PIR detection:Motion Detection Setup
Disble:Close the PIR detection

Low:doorbell wake up after it detects human for 7s. then take video and alert at same time

Medium:doorbell wake up after it detects human for 5s. then take video and alert at same time

High:doorbell wake up after it detects human for at least 1s. then take video and alert at same time

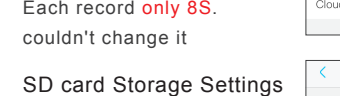

11

12. LED mode Setup:

Turn on / off the LED on the doorbell button

Disable: Turn off the LED on the doorbell button

Enable: Turn on the LED on the doorbell button



Orentiation
Orentiation :Change the Orentiation of the video

Envoriment:Turn on / turn off the Night IR or back light, hight light compensation to make the video in a better view



Power Frequency
Power frequency: Change the power frequency for the doorbell

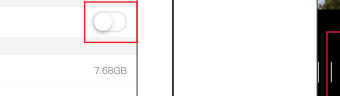

12

13. Note for using

1.The device is powered by rechargeable lithium batteries. New battery is not fully charged. Please charge it firstly on the 1st installation. After power off, then you could charge it by connecting USB cable with usb adpater, power bank,PC or laptop. The mobile device APP will be prompted while the battery voltage is low. Please charge the device after received the reminder.

2.Keep the camera in range of your router. Make sure to pick a place within range of your network. Thick or insulated doors can greatly reduce the strength of your Wi-Fi signal even if your router is close by, so you should try streaming video before you mount your camera.

3.The device is a low power consumption intelligent products, can support remote wake up from the APP, PIR human detection, press doorbell wake up. The device will be works for 30 seconds after wake up then be in the resting state automatically and until to next waking up.

Setup Video instruction
1.Please Scan below QR code to watch the instruction guide
2.Or Please go the youtube, and search " Zhiliao M5 Video doorbell " to watch it.

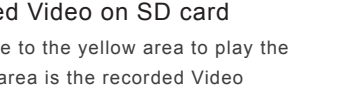

Zhiliao After-Sales Support
Contact Us
Email:info@zhiliaocam.com
www.zhiliaocam.com

Follow Us
Youtube: Zhiliao Support
Instagram: Zhiliaoofficial

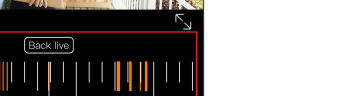

13