



Quick installation Guide

Wireless USB Adapter

V1.0

1 Hardware Installation

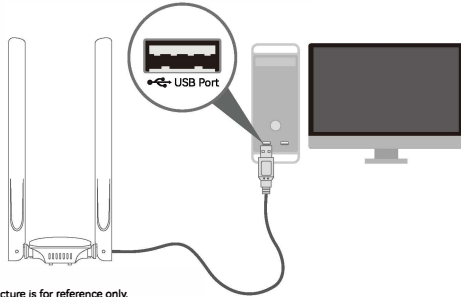

The picture is for reference only.
Please be subject to the actual products.

2 Driver Installation

*The driver only supports windows 10 systems

a. After the hardware installation is completed, the computer automatically recognizes and opens the Realtek disk. Select and open the windows folder. If it does not pop up automatically, open the desktop "this computer" and double-click to open the Realtek disk.

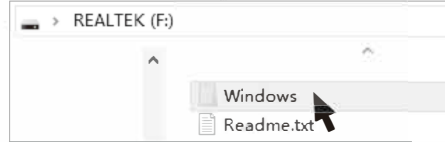

b. Double click to open WifiAutoInstallSetup.exe, click Install to install the driver in the installation interface, and click After about one minute, the interface will close automatically to complete the installation.

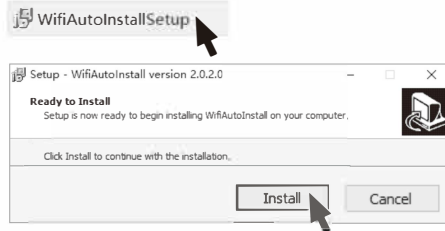

! Note: Please close any firewall or security protection software before installation.

3 Wireless Receiver

Click the wireless network icon  in the lower right corner of the computer and select the name of the wireless network to be connected. Select your Wi-Fi network and enter the Wi-Fi password when prompted.

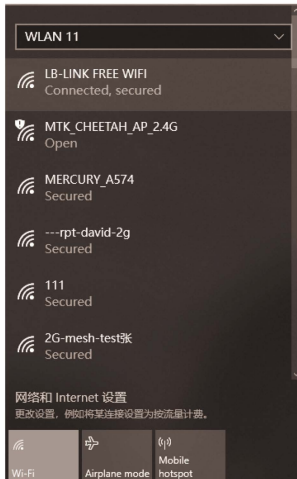

Troubleshooting

After inserting the Driver CD, the setup wizard does not pop up. What should I do?

1. Please open "Computer", and find the "B-link CD". Double click on "autorun.exe" to run it.
2. Make sure the computer is configured to auto-play media, and all devices can use auto-play.

After I install the driver, I can't use the wireless USB N adapter. What should I do?

1. Try another USB port on the computer.
2. Make sure your computer does not have a similar driver. If so, uninstall the other driver and plug in the wireless adapter again.

FCC Warning

This device complies with part 15 of the FCC rules. Operation is subject to the following two conditions: (1) this device may not cause harmful interference, and (2) this device must accept any interference received, including interference that may cause undesired operation.

Changes or modifications not expressly approved by the party responsible for compliance could void the user's authority to operate the equipment.

NOTE: This equipment has been tested and found to comply with the limits for a Class B digital device, pursuant to part 15 of the FCC Rules. These limits are designed to provide reasonable protection against harmful interference in a residential installation. This equipment generates uses and can radiate radio frequency energy and, if not installed and used in accordance with the instructions, may cause harmful interference to radio communications. However, there is no guarantee that interference will not occur in a particular installation. If this equipment does cause harmful interference to radio or television reception, which can be determined by turning the equipment off and on, the user is encouraged to try to correct the interference by one or more of the following measures:

-Reorient or relocate the receiving antenna.

- Increase the separation between the equipment and receiver.
- Connect the equipment into an outlet on a circuit different from that to which the receiver is connected.
- Consult the dealer or an experienced radio/TV technician for help.

Radiation Exposure Statement

This equipment complies with FCC radiation exposure limits set forth for an uncontrolled environment. This equipment should be installed and operated with minimum distance 20cm between the radiator and your body.