

Harness with Simple Soft Canbus Box

- 1. Check if your vehicle's factory radio matches the provided picture below.
- 2. Connect the cable plug that matches your car's head unit.

**Note:** Not all plugs need to be connected. Please note that some factory features may be lost if the factory radio is removed, such as a CD player.

**Model A:** Support factory SWC, Bose AMP, Backup Camera or 360 Camera, USB, A/C info

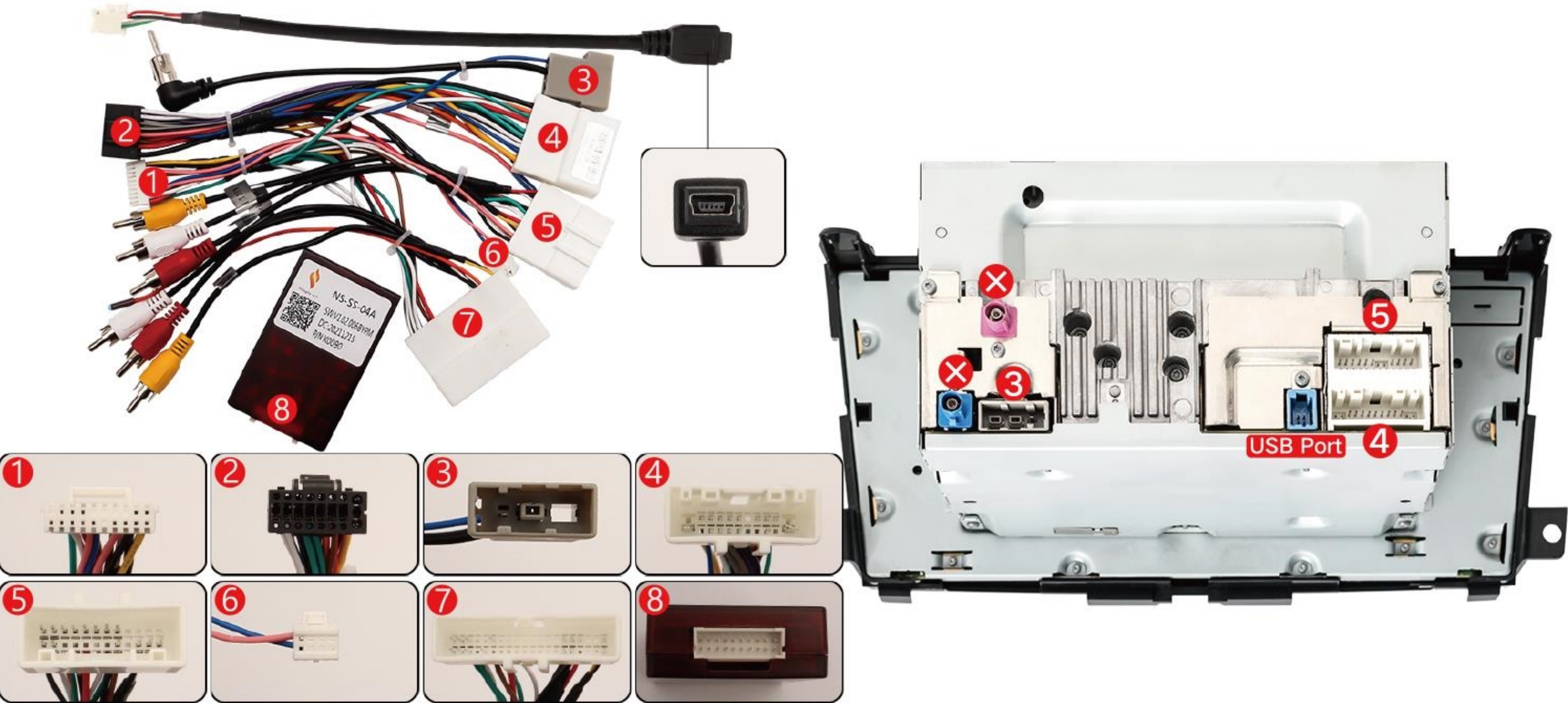

**Model B:** Support factory SWC, Bose AMP, Backup Camera or 360 Camera, USB, A/C info

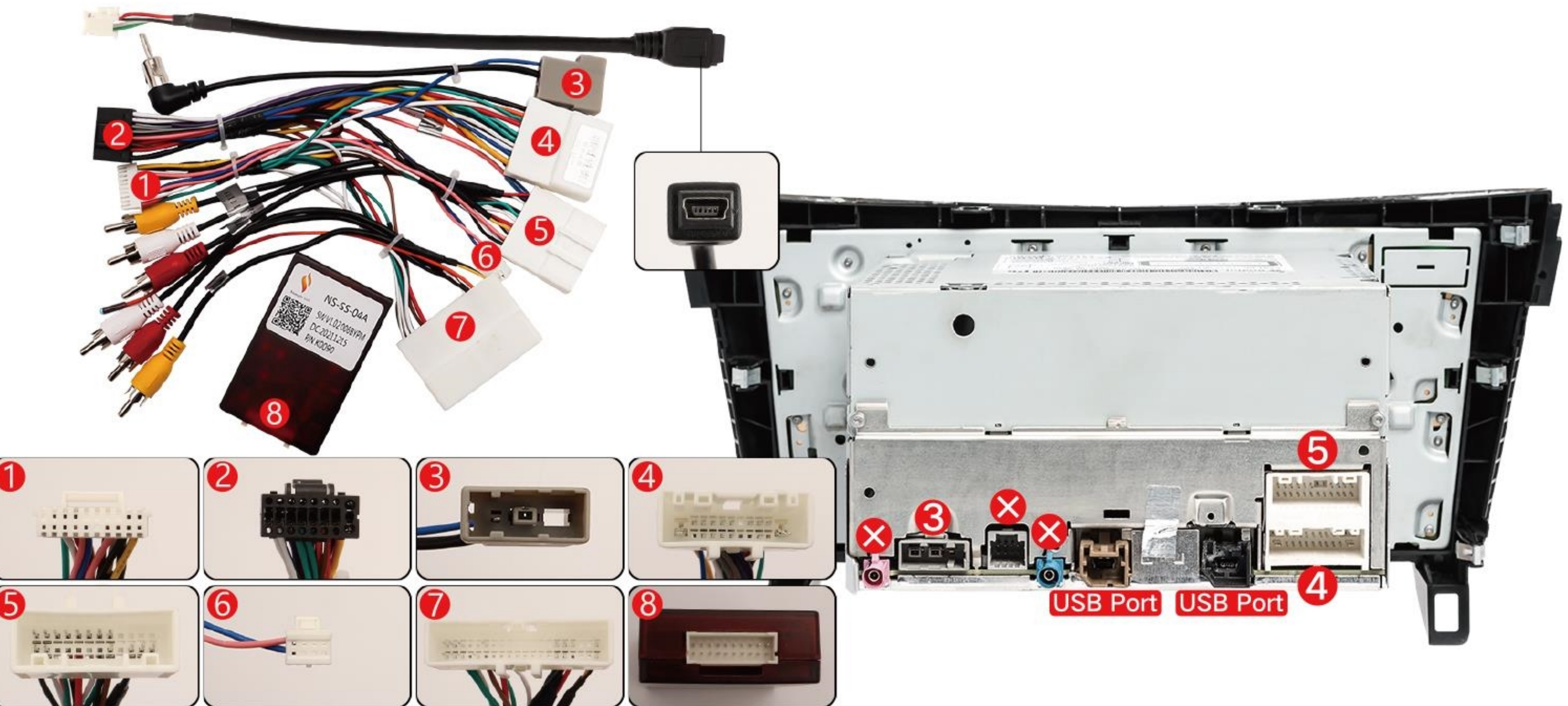



## Model C:

Support factory SWC, Bose AMP, Backup Camera or 360 Camera, USB, A/C info

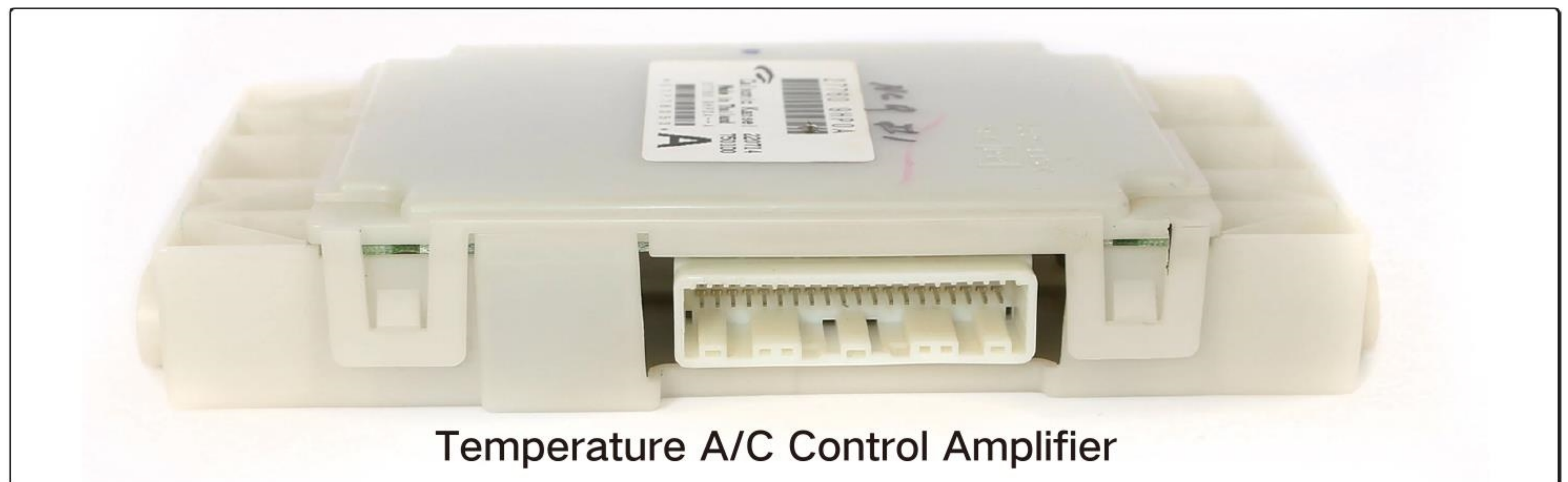
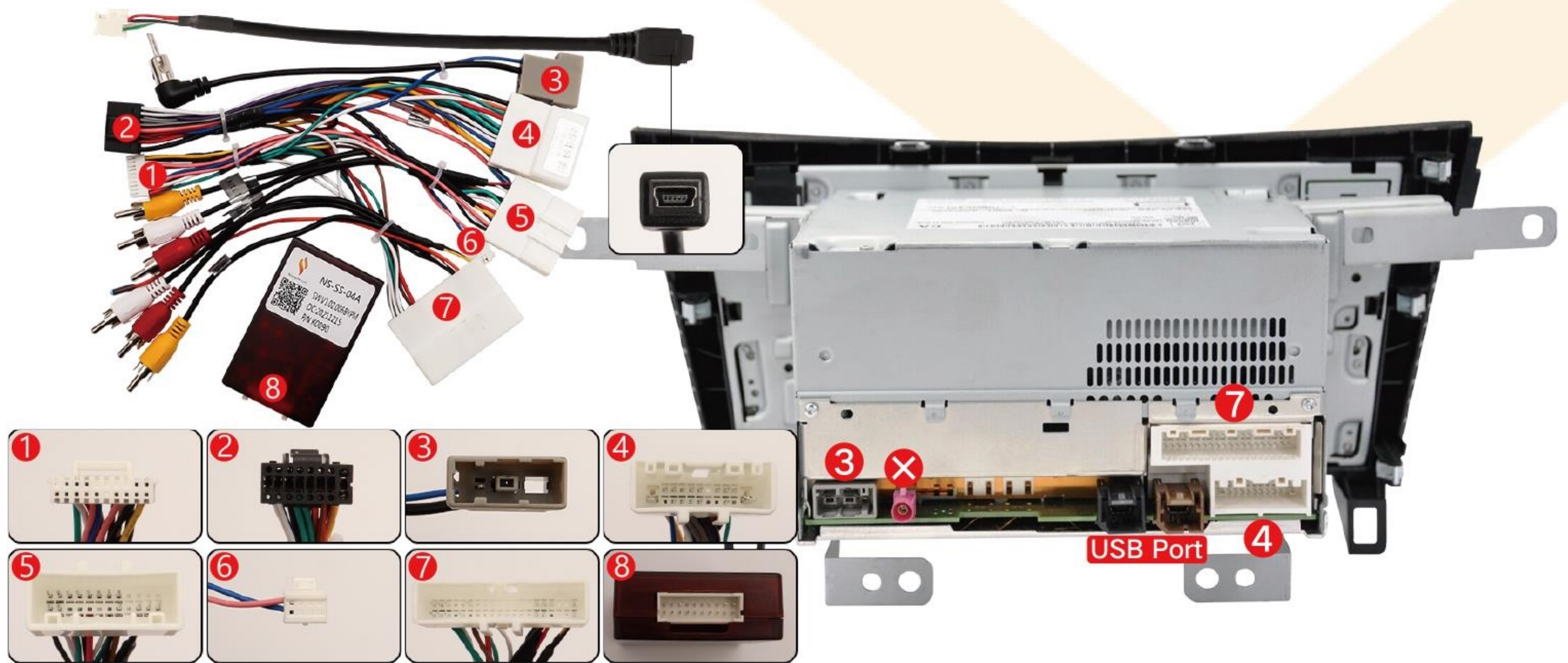

Keep the factory temperature A/C Control Amplifier and install it back. Then connect it to the original harness. Afterward, the factory A/C will display on our head unit.

**3. CAN008-X Harness** comes with a Simple Soft Canbus box.

**Note:** Please set up the canbus option after you finish the canbus harness. You can contact your radio 's seller to get correct canbus option.

● **Correct Canbus Option:** 03: Simple Soft - 71: Nissan - 01: 2013 Altima - Public

● **Video:** How to Set Up Canbus Option

<https://www.youtube.com/watch?v=oRcBn3C6uns>





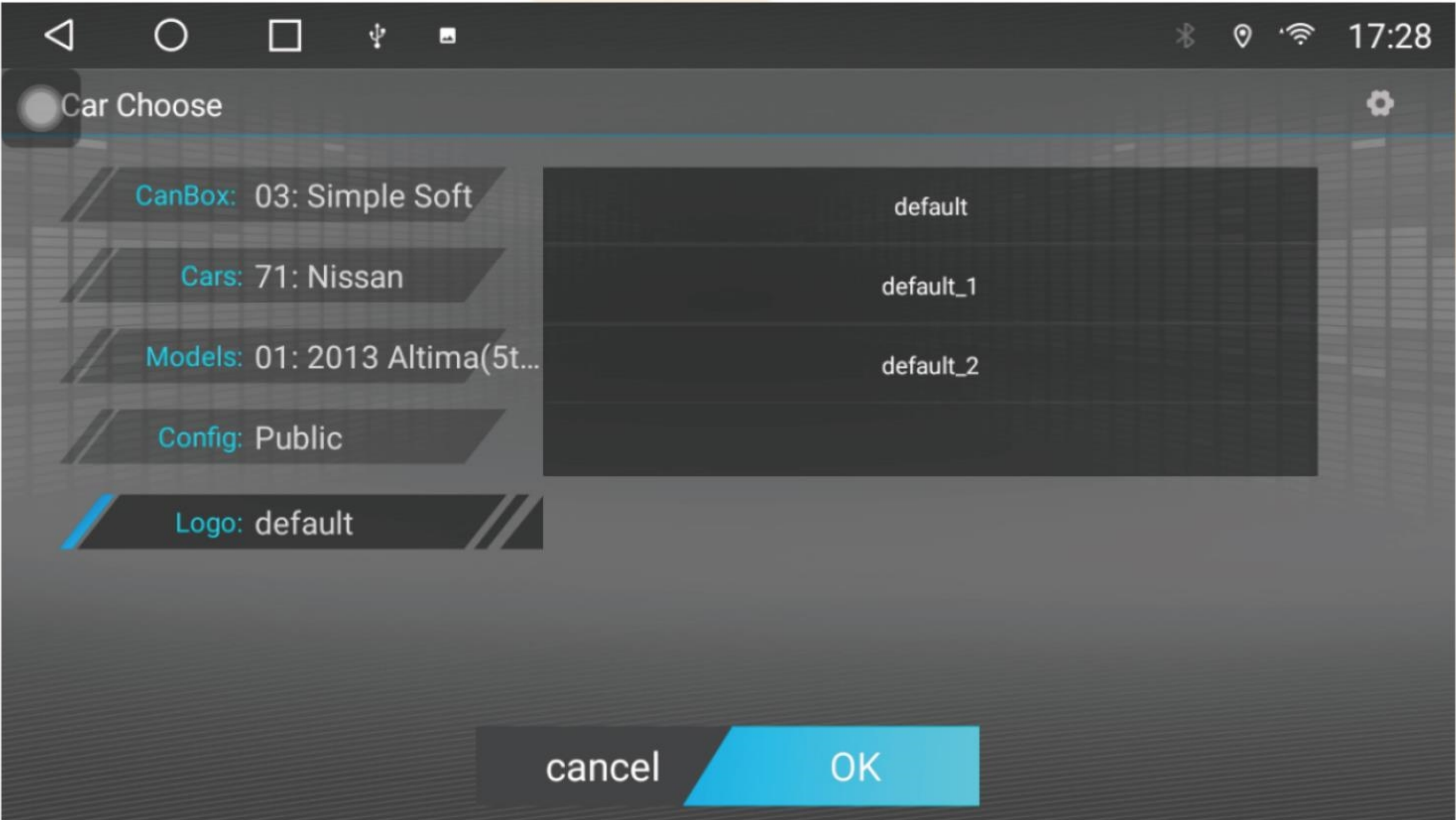

TS10 radio's Can Bus ption as a reference

4. Wiring harness connection diagram

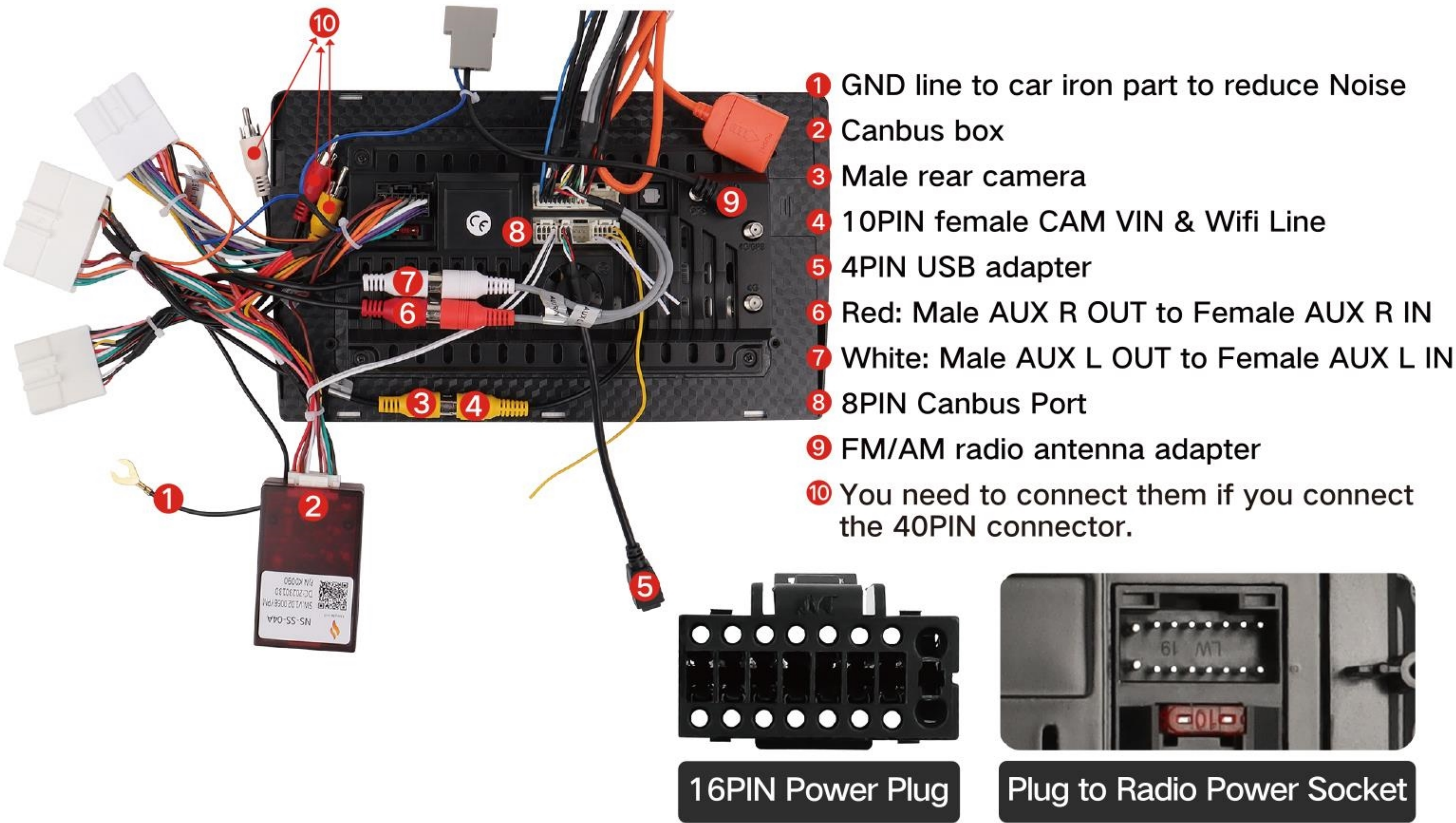

5. If you need assistance or have inquiries, please contact ViaBecs Tech for help. Click **our Store Name** and then find"**Ask a Question**". then you can contact us.