

# User Manual

## IMI KI FRAME 2 Lite



Scan the QR code to get the manual in more languages

### How To Download & Connect To APP

Scan the following QR code, download and install the IMIKI Life App.

" Scan QR Code and Download "



### Pairing

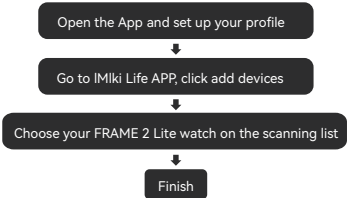

The MAC address on the "setting" - "About" page could help you identify your device on the scanning list.

### Use the Touch Screen

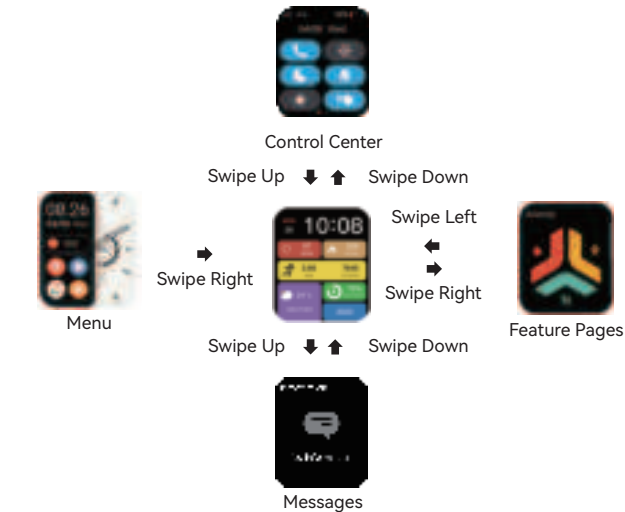

### Smart Watch Features

	<b>100+ Sports Modes:</b> You can choose from 100 sports modes, and then you can view detailed sports data in the App.		<b>Status:</b> Record steps, distance, calories for the day. More detailed information analysis and data records can be viewed in the APP.
	<b>Phone Call:</b> You can enter a phone number and call. <b>Call Logs:</b> Record your call history. <b>Contacts:</b> Contacts can be added synchronously on the APP.		<b>Sleep Monitor:</b> Record and display the total sleep duration, deep sleep and light sleep duration of the previous night. More detailed information analysis and data records can be viewed in the APP.
	<b>Heart Rate Monitor:</b> Measure the current heart rate value; the watch can record and display the 24h heart rate value throughout the day, monitor the heart rate in real time throughout the day, and the APP saves the average heart rate value every ten minutes. More detailed information analysis and data records can be viewed in the APP. (The value is for reference only and cannot be used as a medical basis)		<b>Blood Pressure Monitor:</b> Test the blood pressure, more detailed information analysis and data records can be viewed in the APP. (The value is for reference only and cannot be used as a medical basis)
	<b>Blood Oxygen Monitor:</b> Test the blood oxygen value; monitor and save data every ten minutes, more detailed information analysis and data records can be viewed in the APP. (The value is for reference only and cannot be used as a medical basis).		<b>Weather:</b> Displays the weather conditions and the weather for the next 4 days. The weather information needs to be connected to the APP before the data can be obtained. If the connection is disconnected for a long time, the weather information will not be updated.
	<b>Music Control:</b> After connecting to the mobile phone, the watch can control the music play/pause/previous/next song on the mobile phone, and the volume can be adjusted.		<b>Message:</b> Instant message reminder, 8 latest messages will be showed.

### Smart Watch Features

	<b>Alarm Clock:</b> 8 alarm clocks can be set, watch will vibrate, ring and display on.		<b>AI Voice Assistant:</b> Click AI voice function button, speak out wake up "word" wake-up AI voice assistant (for example, the wake up word of Xiaomi phone is "Xiao Ai"), please make sure the BT function is successfully connected.
	<b>More functions:</b> Stopwatch / Timer / Flashlight / Find Phone / Remote Camera / World Clock / Calculator		<b>Setting:</b> Watch face & theme / Brightness / Vibration / Password / Wrist awake / Down button / Do not disturb / QR Code / System / About

### Other Functions

Sedentary reminder, lower battery reminder, incoming call reminder, shake to take photo, find watch, watch face / customized watch face, 12/24h time system, unit setting, turning the wrist to brighten the screen, physiological cycle reminder, goal achievement reminder.

### Charging

Attach the charging cable to the watch charging port, ensuring the metal pins fully connected.

Please use the correct charging adapters which are 5V, 0.5A above.

**Note:** If smart watch can not be powered on after being left unused for long time, please clean up the charging metal pins to make sure connecting well.

### Warranty

- One year warranty for default hardware defectives, half of year for battery and charging cable.
- Below reasons cause to defectives are not included in free warranty service:
  - Personal assemble or disassemble.
  - Falling damage during use.
  - All man-made damage or due to the third party's fault, improper use (such as: water in the smart watch, external force shattering, scratch during use etc.)
- Please provide a warranty card with the details filled when request for after selling service.
- Please contact with direct dealers for warranty service.
- Please note all functions of the product are based on physical objects.

### Specifications

Model: IMIKI FRAME 2 Lite  
Battery Capacity: 300mAh  
Standby Time: 14 Days  
Charging Voltage: 3.8V  
Water & Dust Proof: IP68  
BT Version: BLE5.2/BT3.0  
Frequency Band: 2.402MHz - 2480MHz  
Max. Signal Transmission: < /= 5dBm

### Disposal of electrical and electronic equipment



The crossed-out garbage can means that you are legally obliged to collect these devices separately from unsorted municipal waste. Disposal in the residual waste bin or yellow bin is prohibited. If the products contain batteries or accumulators that are not permanently installed, they must be removed before disposal and disposed of separately as batteries.

### Possibilities of returning old appliances

Owners of old devices can hand them in within the framework of the options set up and available by public waste disposal authorities for returning or collecting old devices to ensure that the old devices are properly disposed of.

### Data protection

We would like to point out to all end users of waste electrical and electronic equipment that they are responsible for deleting personal data on the old equipment to be disposed of.



We, IMIKI Co, Ltd, hereby declare that this device complies with the basic requirements and the other applicable provisions of the EU Declaration of Conformity according to the Radio Equipment Directive 2014/53/EU and the RoHS Directive 2011/65/EU. The full EU declaration of conformity can be found on the website:  
<https://www.imikilife.com/declarations>

Manufacturer: IMIKI Co., Ltd  
Address: 1401F, South Area, Jingji Yujing Times Building, Longgang District, Shenzhen, China