



# Bulldog

eWeLink Wi-Fi  
CONNECTIVITY  
GUIDE





Bulldog EVC300 Wi-Fi  
Connectivity - eWeLink

# EVC300 CONTROLLER

## Basic Controller Functions



Press and release to open or close your Bulldog Valve.  
Hold this button for 7 seconds then release to cycle  
through the Wi-Fi pairing modes.





## Bulldog EVC300 Wi-Fi Connectivity - eWeLink

The Wi-Fi pairing mode is indicated by the blue LED blink pattern.

- **(Solid):** Your controller is in normal operation and connected to Wi-Fi.
- **(Flash then long pause):** Your controller is in normal operation and not connected to Wi-Fi.
- **(Three flashes then a pause):** Your controller is ready for Quick Pairing.
- **(Constant fast flashes):** Your controller is ready for Compatible mode.
- **(To start over):** Unplug and re-plug your controller's power.



Press to stop alarm sounding.



Press to pair sensors and remote stop buttons.



Bulldog EVC300 Wi-Fi  
Connectivity - eWeLink

# APP CONTROL

Download and Install The  
eWeLink App



**NOTE:** Your device must be connected to a Wi-Fi network that utilizes a 2.4GHz band and WPA2 security.

**eWeLink On  
Google Play**



**eWeLink On  
Apple Store**





## Bulldog EVC300 Wi-Fi Connectivity - eWeLink

### Pairing Method 1: Quick Pairing

**NOTE:** Turn your mobile data off as it may interfere with quick pairing.

1. Hold the  button for 7 seconds and release to cycle Bulldog Controller into Quick Pairing Mode. **This is indicated by the blue LED flashing 3 times followed by a pause.** (Refer to Basic Controller Functions)





## Bulldog EVC300 Wi-Fi Connectivity - eWeLink

2. On your eWeLink app tap the “Add” or “+” button.

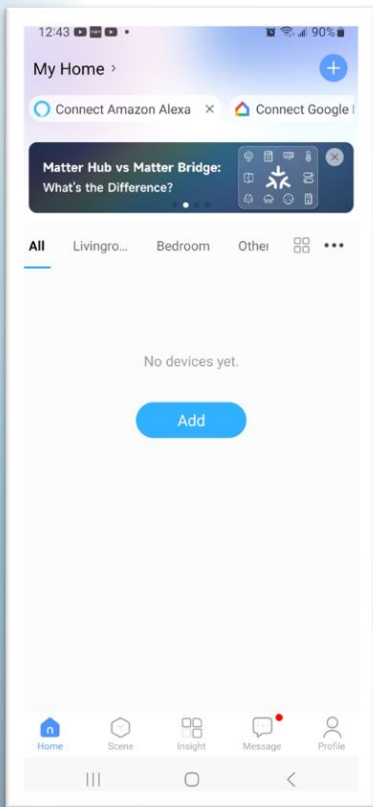



# Bulldog EVC300 Wi-Fi Connectivity - eWeLink

3. Enter your Wi-Fi password and tap on the Next button.

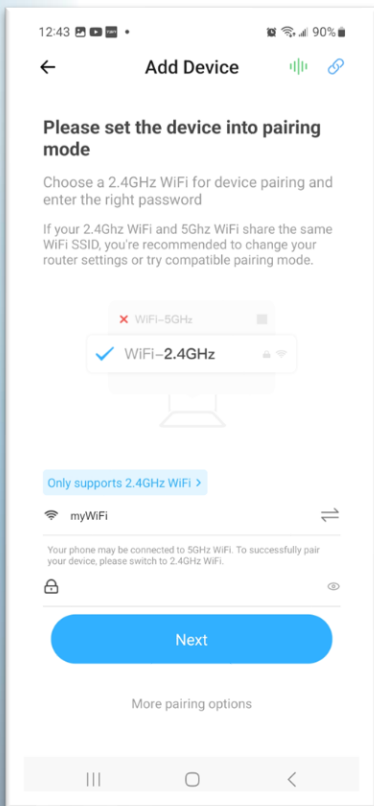



## Bulldog EVC300 Wi-Fi Connectivity - eWeLink

4. Wait up to 30 seconds for device to connect.

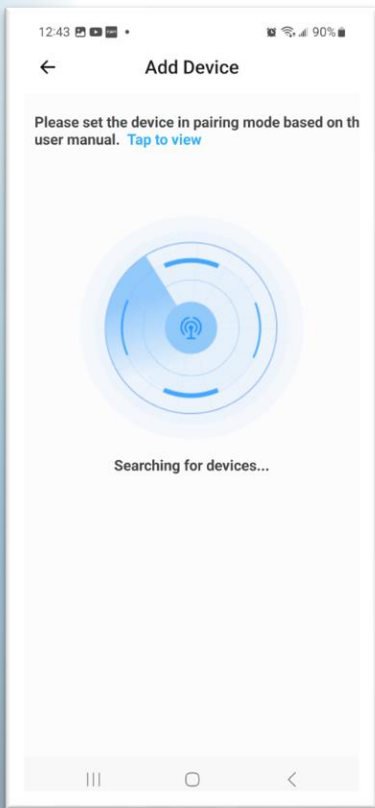





## Bulldog EVC300 Wi-Fi Connectivity - eWeLink

5. Once your Bulldog device is found, tap the Next button.

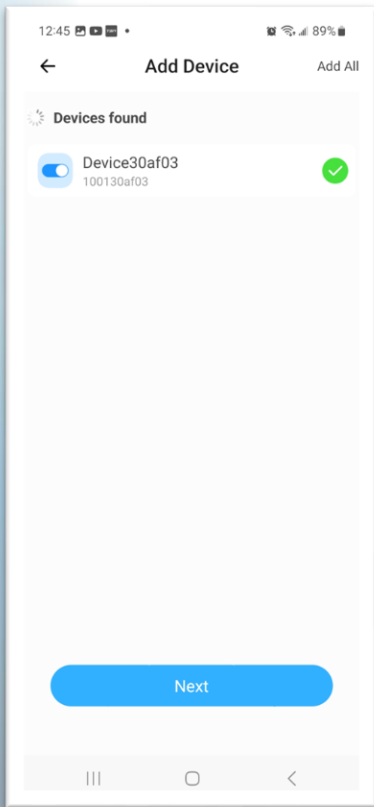



## Bulldog EVC300 Wi-Fi Connectivity - eWeLink

6. When completed you can change the name of the Bulldog device and then tap on the Done button.

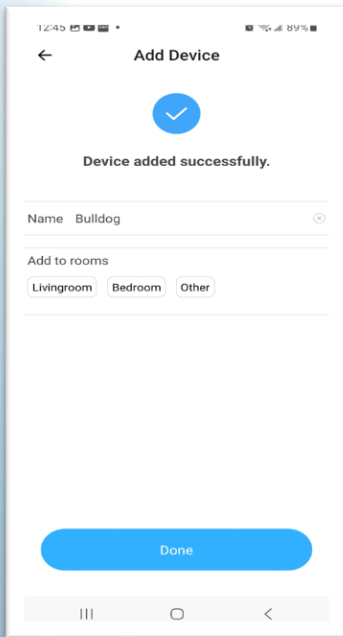

7. Connected! Go to **Once Connected to App**.  
Not connecting? Go to **Pairing Method 2** on the next page.



## Bulldog EVC300 Wi-Fi Connectivity - eWeLink

# Pairing Method 2: Compatible Mode Pairing

**NOTE:** Turn your mobile data off as it may interfere with Compatible Mode pairing.

1. On your eWeLink app click the “add” or “+” button.

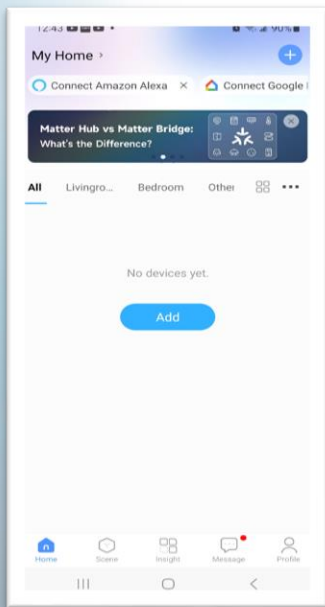



## Bulldog EVC300 Wi-Fi Connectivity - eWeLink

2. Confirm your Wi-Fi network and password, then tap on 'More pairing options.'

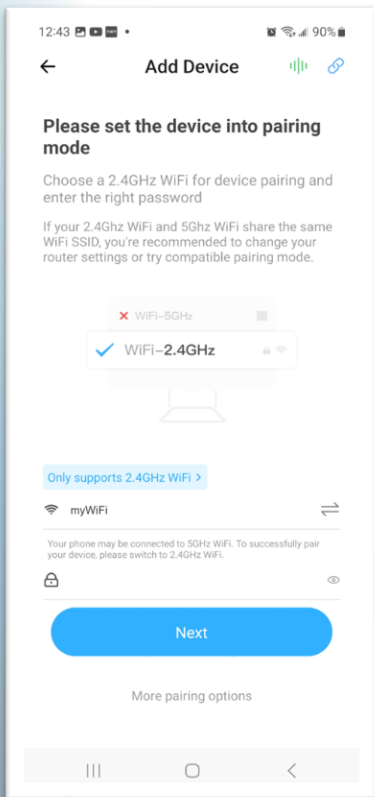



## Bulldog EVC300 Wi-Fi Connectivity - eWeLink

3. Press and hold the  button to cycle the Bulldog Controller into Compatible Mode. **This is indicated by the blue LED constant fast flashing.** (Refer to Basic Controller Functions)





# Bulldog EVC300 Wi-Fi Connectivity - eWeLink

4. Press the “Next” button.

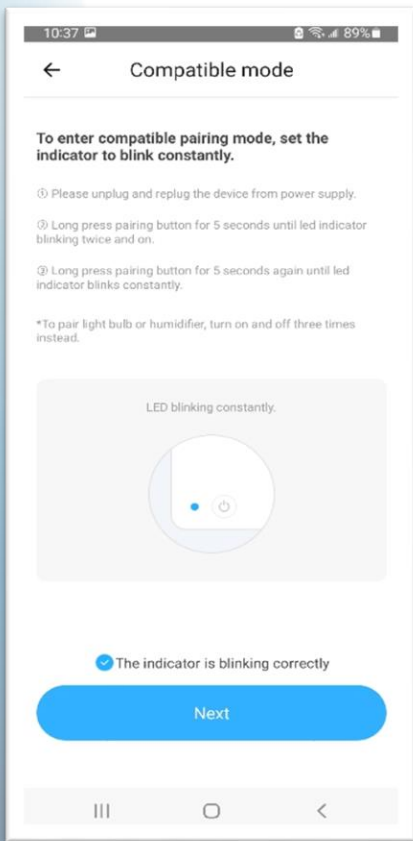



## Bulldog EVC300 Wi-Fi Connectivity - eWeLink

5. Re-confirm your Wi-Fi information and Tap Next.
6. Wait up to 30 seconds for you controller to appear.
  - **(ITEAD Device appears)**: select it and move to next step.
  - **(Device does not appear)**: confirm that your controller is in Compatible Mode as indicated by the Blue LED flashing quickly and constantly.



## Bulldog EVC300 Wi-Fi Connectivity - eWeLink

7. Enter your device settings by pressing the “Go to connect” button, or open your settings app.

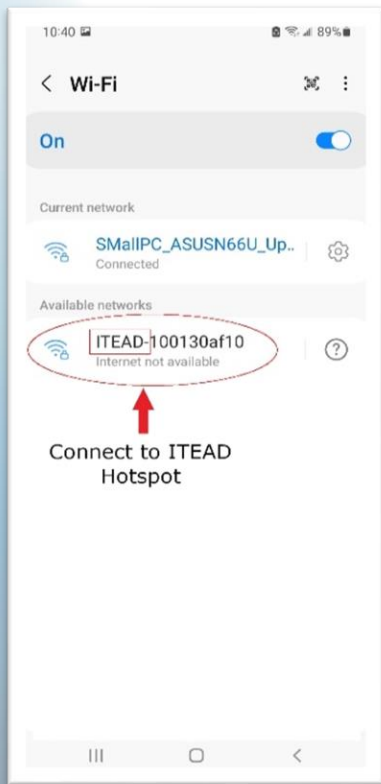





## Bulldog EVC300 Wi-Fi Connectivity - eWeLink

8. In settings, connect your device Wi-Fi to the Bulldog Controller hotspot. The default password is "12345678"

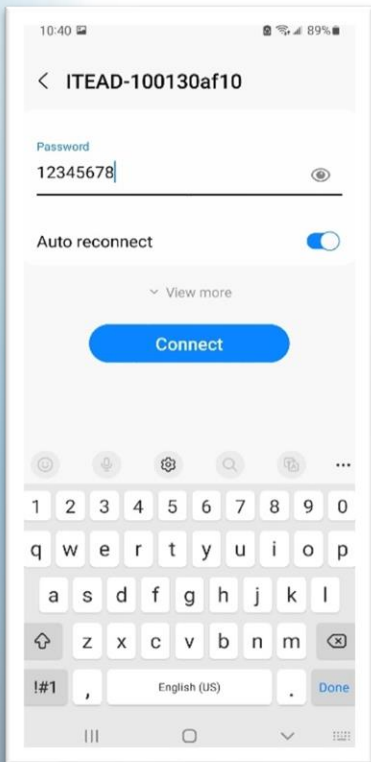

# Bulldog EVC300 Wi-Fi Connectivity - eWeLink

- When prompted that "Internet may not be available", press the "Connect only this time" button.
- Return to the eWeLink app which will present a loading screen.
- After connecting, move to section **Once Connected to App**

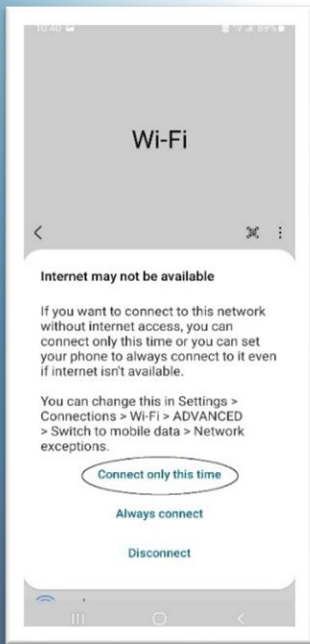



# Bulldog EVC300 Wi-Fi Connectivity - eWeLink

## Once Connected to App

1. Rename your Bulldog controller appropriately.  
(i.e., "Water Main" or "Bulldog Valve Robot")

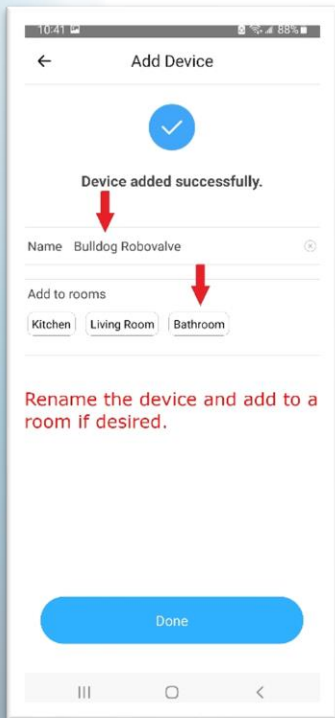



## Bulldog EVC300 Wi-Fi Connectivity - eWeLink

2. Click your new device in the “Home” screen.
3. Click three horizontal dots in the top right corner.

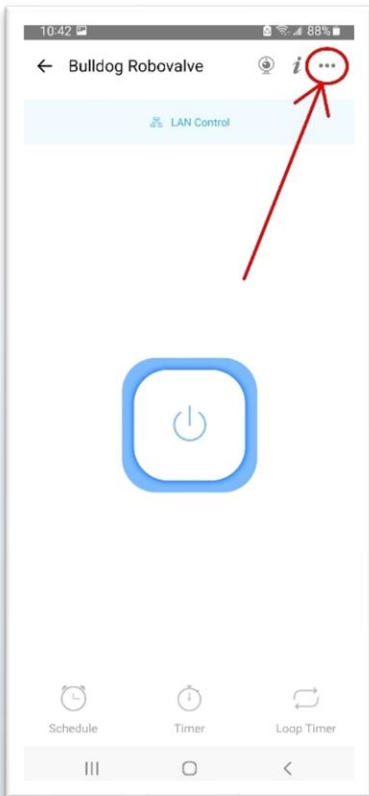
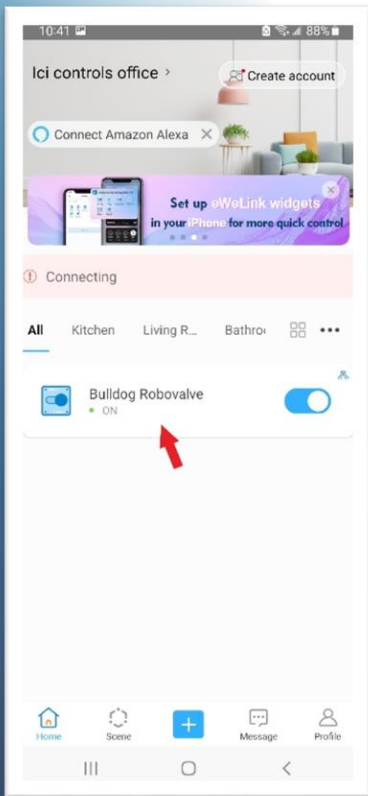

# Bulldog EVC300 Wi-Fi Connectivity - eWeLink

4. Scroll down to and press the “Device Settings” button.

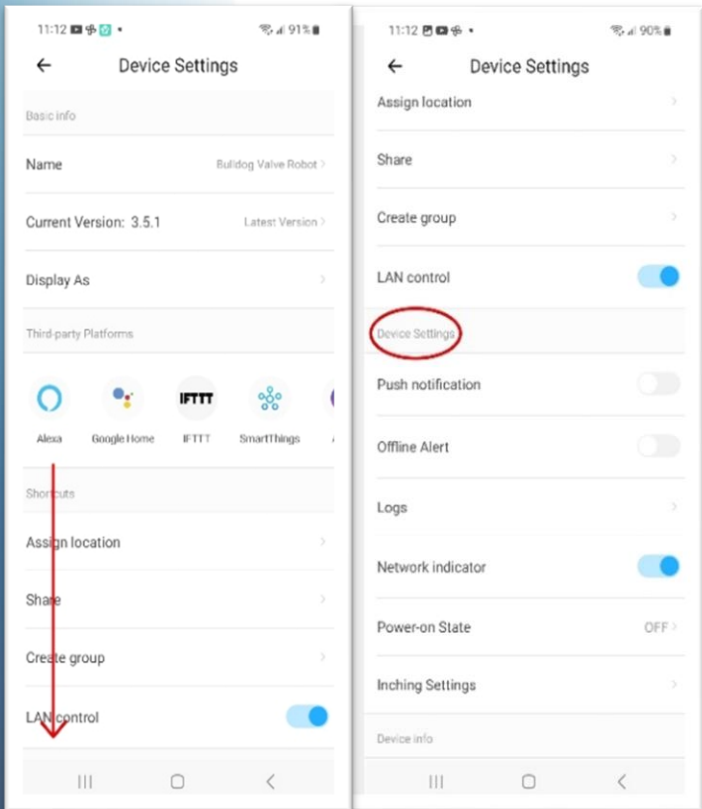

## Bulldog EVC300 Wi-Fi Connectivity - eWeLink

5. Under “Power-on State”, Select “Last state” and save.
6. Turn on Push Notifications and return to your “Home” screen.

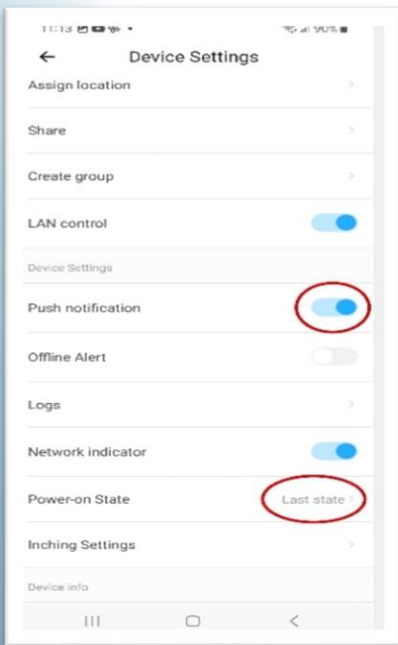

7. Your Bulldog Controller is now paired, and can be toggled on and off in the app.



Bulldog EVC300 Wi-Fi  
Connectivity - eWeLink

# SUPPORT

**Additional  
Support Page**



**eWeLink  
Pairing Video**



**Sonoff Bridge  
Support**





# Bulldog EVC300 Wi-Fi Connectivity - eWeLink

## Econet Support Email:

[support@econetcontrols.com](mailto:support@econetcontrols.com)

## EcoNet Support Phone:

[\(888\) 320-9188](tel:(888)320-9188)

## Additional Support Page Link:

<https://www.econetshop.com/index.php/support/>

## eWeLink Pairing Video Link:

<https://www.youtube.com/watch?v=WfbXw3lg11w>

## Sonoff Bridge Support Link:

[https://www.econetshop.com/PDF/  
SonoffBridgeKit.pdf](https://www.econetshop.com/PDF/SonoffBridgeKit.pdf)