



18000mah Jump Starter IC-JB21R

User Manual

Thank you for your purchase on iClever IC-JB21R Jump Starter. Please read the instructions carefully before first use. Please keep this manual near to jump starter for future use.

Product Accessories

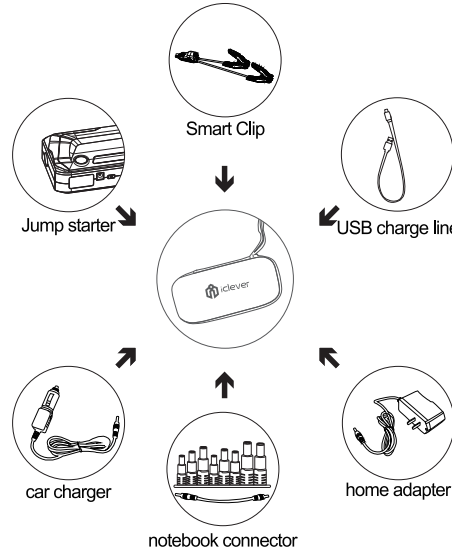

— 1 —

Detailed Function Parameters

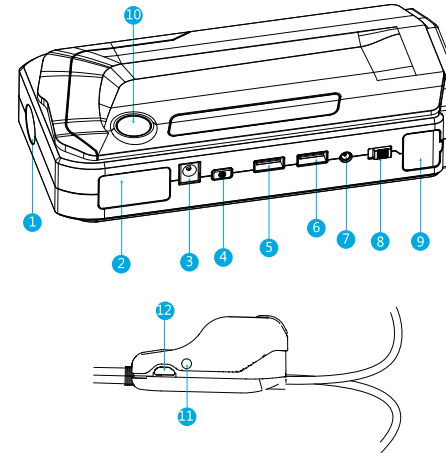

- 1.Flashlight
- 2.LCD indicator
- 3.Laptop charging port
- 4.Power Button
- 5.USB Output: 5V/2.4A
- 6.USB Output: 5V/2.1A
- 7.Input(DC 15V/1A)
- 8.On/Off Switch
- 9.12V Car Jumper Connector
10. Air Compass
11. Smart Jumper Cable LED light
12. Boost Button

— 2 —

Jump Start a Vehicle

Thank you for your purchase on iClever IC-JB21R Jump Starter. Please read the instructions carefully before first use. Please keep this manual near to jump starter for future use.

Step1.

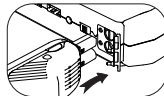

Insert the blue plug of the Smart Jumper Cables into the ENGINE START Input Socket.

- 1) When the LED indicator flashes in red and green color alternately, the power or your jump starter is enough and please continue to the next step.
- 2) If the indicator only flashes red color in a cycle (Each period it flashes 3 times and then pause),the jump starter is in low battery. Please charge the starter in time.

Step2.

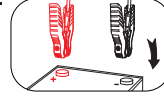

Connect the RED clamp of the Smart Jumper Cables onto the positive "+" terminal of the vehicle battery and connect the Black one to the negative "-" terminal.

- 1) If the LED indicator glows in green color, it works normally and please continue.
- 2) If the LED indicator glows in other color, please refer to the "Attention" and take action.

— 3 —

Step3.



Ensure the smart jump cable clamps are connected to car battery correctly. Attempt to start the vehicle while the indicator lights turn to solid green. Let the jump starter cool down 2 mintues after each attempt.

Step4.

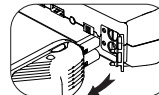

As soon as the vehicle has started, remove the Smart Jumper Cables from the Jump Starter. Then remove the Smart Jumper Cables from the battery terminals.

Attention

In the step 2, the LED indicator may turn to different colors according different situation.

Indicator status	Meaning	Action
Always in green	Works normally	Continue to the next step
Flashes in red	The (+) (-) are connected reversely	Remove the clamp from the car battery and then connect correctly
Always in red OR flashes in red & green color alternately	Vehicle battery voltage is too low (10.5 V ± 0.3 V or less)	In emergency, you can force to jump start by pressing the Boost button at 3s until the indicator changes into green color.

— 4 —

NOTE: Before forcibly starting, please read the warning information below.

WARNING:

Pressing the BOOST button at 3 seconds may be dangerous because the protection function of smart clamp will be lost temporarily.

In emergency, if you need to jump start the vehicle forcibly, please ensure the RED clamp is connected to "+" terminal of car battery while the Black Clamp is to the "-" terminal.

Other indicator status and processing method

Indicator status	Meaning	Action
Flash in green	The voltage of the in-vehicle battery is higher than the voltage of the jump starter. Reverse charge protection function is activated.	The cause of failure to start the engine is not battery rise. Please consider other causes.
Flash in red for 4 times and pause	The overheat protected function is activated as the jump starter has been used continuously.	Wait about 5-10 minutes, please use after the temperature of the product drop down

— 5 —

Work to charge mobile phone

Turn ON / OFF switch ON. Connect with the terminal such as a mobile phone • tablet with the supplied USB charging cable and charge it.

USE the LED light

Turn the switch to ON.

Press and hold power button for 3 seconds;Steady flashlight beam

Next quick press: SOS Strobe.

Next quick press: Fast Strobe.

Next quick press: Turn off flashlight.

The red warning light flashes when the power button is pressed twice at high speed. Press it again to turn it off.

For safe use

1. Please put the product away from children. Please use it properly according to the operation method described in the user manual.
2. When the red clip and the black clip are caught while connecting the cable to the main body, the short circuit protection function is activated, the indicator alternately blinks in red / green, and the output becomes zero.

— 6 —

3. For 12V vehicles only. Hazards may occur if use the jump starter for other types of vehicles. It is forbidden to use the device for an aircraft, ship and so on.

4. Be sure to use genuine cable when connecting to this terminal charging terminal.

5. DO NOT immerse the product in water, operate the appliance close to the heat sources or in explosive atmospheres, such as in presence of flammable liquids, gases or dust.

6. If it is not used for a long time, please charge regularly (once in about three months).

7. Do not drop the main body or accessories or give it a shock.

8. Do not place it near fire or heat sources.Do not disassemble or modify the product.

9. If the product swells, there is a sound or an odor, stop using it immediately.

Specification

Capacity : 18000mAh / 66.6WH	Input : 15V=1A
Output for Vehicle : 12V/16V/19V	Start Current: 300A
Dimension :7.48*3.54*1.73 Inch	Peak Current : 800A
USB Output :5V=2.1A	Battery Life : 1,000circles
USB Output :5V=2.4A	Operating Temperature:-4 °F - 140°F

— 7 —