



INFINITY 38" CURVED ULTRAWIDE FREESYNC GAMING MONITOR

WQHD, IPS, 144HZ, 1MS & USB-C (3840 X 1600)

KAMN38UQCWA

SAFETY & WARNINGS

- Read all instructions before using the monitor and retain this user guide for future reference.
- Unplug the monitor before cleaning it with a slightly damp, clean cloth.
- It is recommended to wipe the screen with a dry microfibre cloth once the monitor has been turned on.
- Do not use cleaning alcohol, ammonia-based liquids or other harsh cleaners.
- Do not cover or block the ventilation holes in the monitor casing.
- Do not place the monitor near heaters, stoves, fireplaces or other sources of heat, as well as in rooms lacking adequate ventilation.
- Do not insert any objects or spray any liquid into the vents.
- Do not position the monitor in unsafe locations. If the monitor falls, it may be damaged and may injure nearby people.
- Unplug the monitor if it is not going to be used for an extended period.
- Do not place heavy objects on the monitor, its power cord or any connected cables.
- Do not open the back panel of the monitor, as it contains a high-voltage current even when not plugged in.

COMPONENTS



Monitor



Stand stem



Stand base



16x4mm screw



M4x16mm screw
(x5) (x1 for spare use)

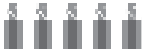

M4x7mm screw (x5)
(x1 for spare use)



Power cord



Power adapter



DP 1.4 cable



Decorative VESA cover



User guide

OVERVIEW

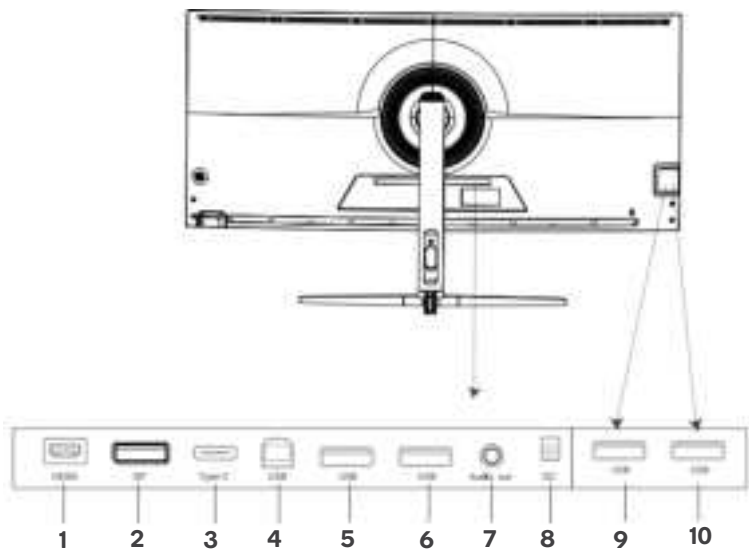

1	HDMI	6	USB-A
2	DP	7	Audio Out
3	USB-C	8	DC (Power Input)
4	USB-B	9	USB-A
5	USB-A	10	USB-A

- For best results, an HDMI 2.1 cable is recommended when connecting to the monitor.
- When connecting devices to the monitor, it is recommended to connect the USB-B first. Then, the USB-A ports can be used.
- USB-B is commonly used for printers, monitors and other devices.
- USB-A is commonly used for mice, keyboards, U disks and other devices.
- USB-C is commonly used for laptops or phones.

WARNING: Before connecting the monitor to your computer, shut off the power for the computer and the monitor.

Users Controls

Press the joystick in to turn the monitor on/off.

Note:

To access the monitor settings, ensure you first have a source connected to one of the monitor ports.

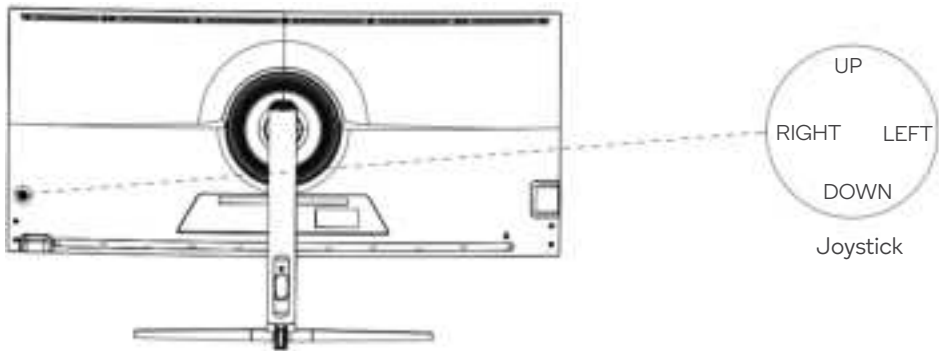

Control	Description
Indicator	Blue - Power on.
	Red - Standby.
Press LEFT	Return to the previous menu level or exit the OSD menu.
Press RIGHT	Enter the OSD menu and confirm key.
Press UP & DOWN	Adjust OSD menu settings.
Press in	Power on/off.

ASSEMBLY

Stand Assembly

1. Place a cloth on a flat table. Ensure there are no hard objects, such as screws, on the table.
2. Gently lay the monitor on the cloth with the screen facing down.

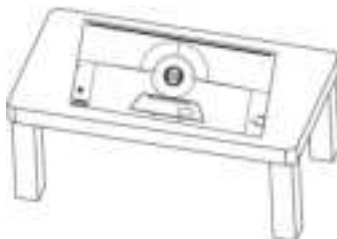

3. Secure the stand stem to the stand base using the provided rotary screw.
4. Slot the assembled stand into the monitor. Lift the monitor by holding the stand and place it on the table.

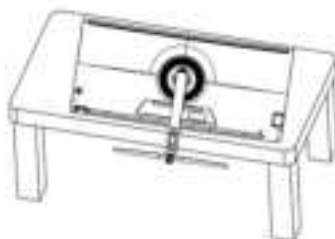
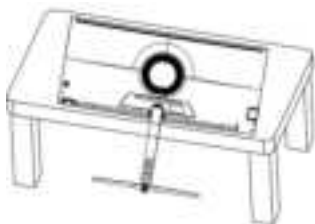

5. Clamp the VESA cover on the 4 buckle holes on the rear of the monitor and turn clockwise to lock. To remove the VESA cover, turn it anticlockwise.



Decorative VESA Cover (x2)

Adjust The Angle

The angle of the screen can be adjusted forward 5° or backward 20° to create the ideal viewing experience.

Notes:

- Do not touch or press the screen when adjusting the angle of the monitor.
- The images below are for illustrative purposes only. Actual monitor may differ slightly.

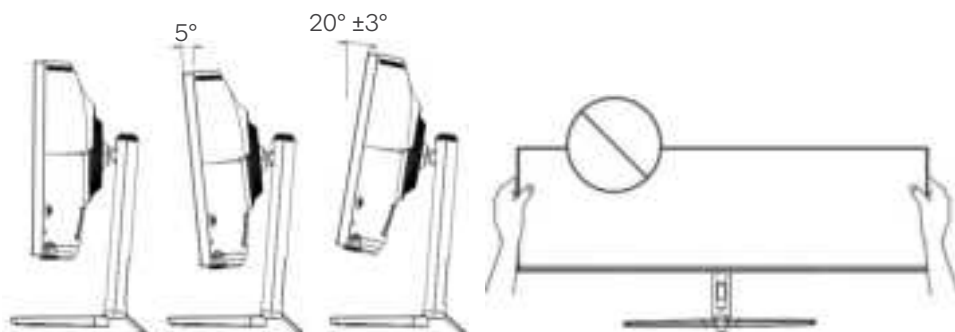

Wall Mounting

- To ensure sufficient ventilation, install the monitor at least 10cm away from the wall and leave about 10cm of space on each side of the monitor.
- If you are not confident in wall mounting this product, consult a licensed trade professional.

WARNING: Before installing the monitor on the wall, detach the stand from the monitor.

1. Place a clean, dry and lint-free cloth on a flat, stable surface.
2. Gently lay the monitor on the cloth with the screen facing down.
3. Identify the 4 wall mounting screw holes on the back of the monitor.
4. Install the wall mounting bracket (not provided) on the back of the monitor and attach the monitor to the wall according to the mounting bracket's instructions.
5. Ensure that all screws (not provided) are tightened and secured.

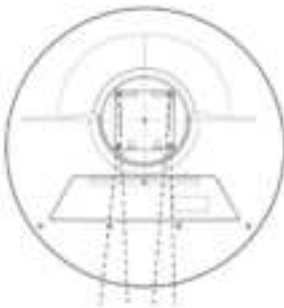
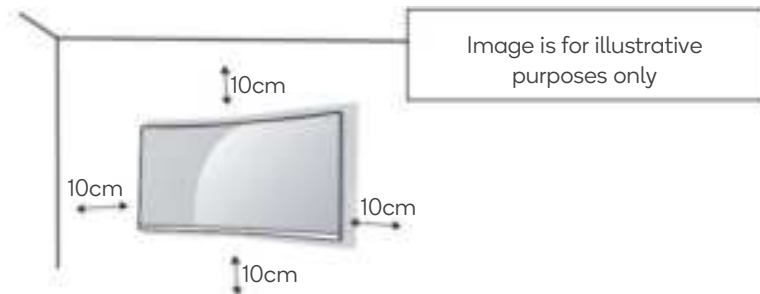

VESA: 100 x 100mm

Recommended screw size:

Plate thickness 2-3mm - M4x7mm

Notes:

- Depending on your chosen VESA mount, you may need to use the provided M4x16mm or M4x7mm screws. Refer to the user guide of your VESA mount.
- Use a wall mounting bracket and screws that conform to VESA standards. Ensure that the plate fits appropriately.
- For more information, refer to the user guide for the wall mounting bracket.
- This monitor does support wall mounting, however, due to its size, it is recommended to use a stand.

OPERATION

1. Insert one end of the provided DP 1.4 cable into your computer's graphics card. Insert the other end of the cable into the DP port on your monitor.
2. Connect the power adapter to the monitor and then connect the other end of the power adapter to the power cord. Then, connect the power cord to your power source. It is recommended that you use a surge protector with adequate voltage if an electrical outlet cannot be directly reached.
3. Locate the 'Power' button on the monitor and press it to turn the monitor on.

FreeSync/G-Sync

- Ensure your computer has FreeSync/G-Sync capability, a DP 1.4 port and the latest graphic drivers.
- FreeSync/G-Sync is on by default when setting 60Hz refresh rate.
- To use FreeSync/G-Sync, connect your computer and monitor with a DP 1.4 cable.
- After connecting, you will receive a prompt to enable FreeSync/G-Sync on your computer. If you do not receive the prompt, you may need to enable the function in your graphics card menu.

PBP/PIP

- Wide screen monitors offer Picture-by-Picture (PBP) and Picture-in-Picture (PIP) display modes that allow users to view multiple videos or devices simultaneously on a single monitor.
- PBP divides the screen into sections, enabling side-by-side display of different video signals from separate sources, while PIP overlays windows on top of each other, useful for tasks like video conferencing. These functions let you connect and display various devices on one monitor, such as a computer and a gaming console, maximising screen real estate and enhancing multitasking or entertainment experiences.

Using the OSD Menu

1. To view the OSD menu, press the joystick to the right.
2. Configure the options by moving the joystick up, down, left and right.
3. To return to the previous menu, move the joystick to the left.
4. To exit the OSD menu, move the joystick to the left until you exit.



SPECIFICATIONS

Panel	Panel type	IPS
	Curvature	R2300 (TYPE)
	Aspect ratio	21:09
	Size (inch)	37.5"
	Resolution	3840 x 1600
	Refresh rate	144Hz
	Brightness (typ.)	300cd/M ² (max)
	Contrast ratio static	TYP 1000:1
	Colour support	1.07B (8-BIT + HI-FRC)
	Viewing angle (H/V)	178/178 (H/V)
	Response time (GTG)	5 (Typ.) (G to G) ms, with OD 1ms
Input/output	Interface	HDMI+DP+TYPE-C+3-1 x USB (TYPE B) +2 x USB (TYPE A) +AUDIO OUT+DC
	USB extension	USB-A (x2)
	Speaker	2
Power	Power supply	100-240AC, 50/60HZ
	Type	DC 24V-5A
	Consumption	Input power: 125W (max) Standby power: standby≤0.5W
Physical Specifications	Monitor colour	Black
	Dimensions	Packaging dimensions: 980 x 235 x 495mm (±5mm)
	Weight	Net Weight: 6.7 kgs (±0.5 kgs) Gross Weight: 9.9 kgs (±0.5 kgs)
	Wall mount size	100 x 100mm
	Stand	Tilt: Lean forward 5°, lean back 20°±3°
		Up & down: yes
		Swivel: yes
Pivot: yes		
FreeSync Range		HDMI: 3840 x 1600@60Hz-85Hz DP: 3840 x 1600@60Hz-144Hz

NOTES

[illegible]



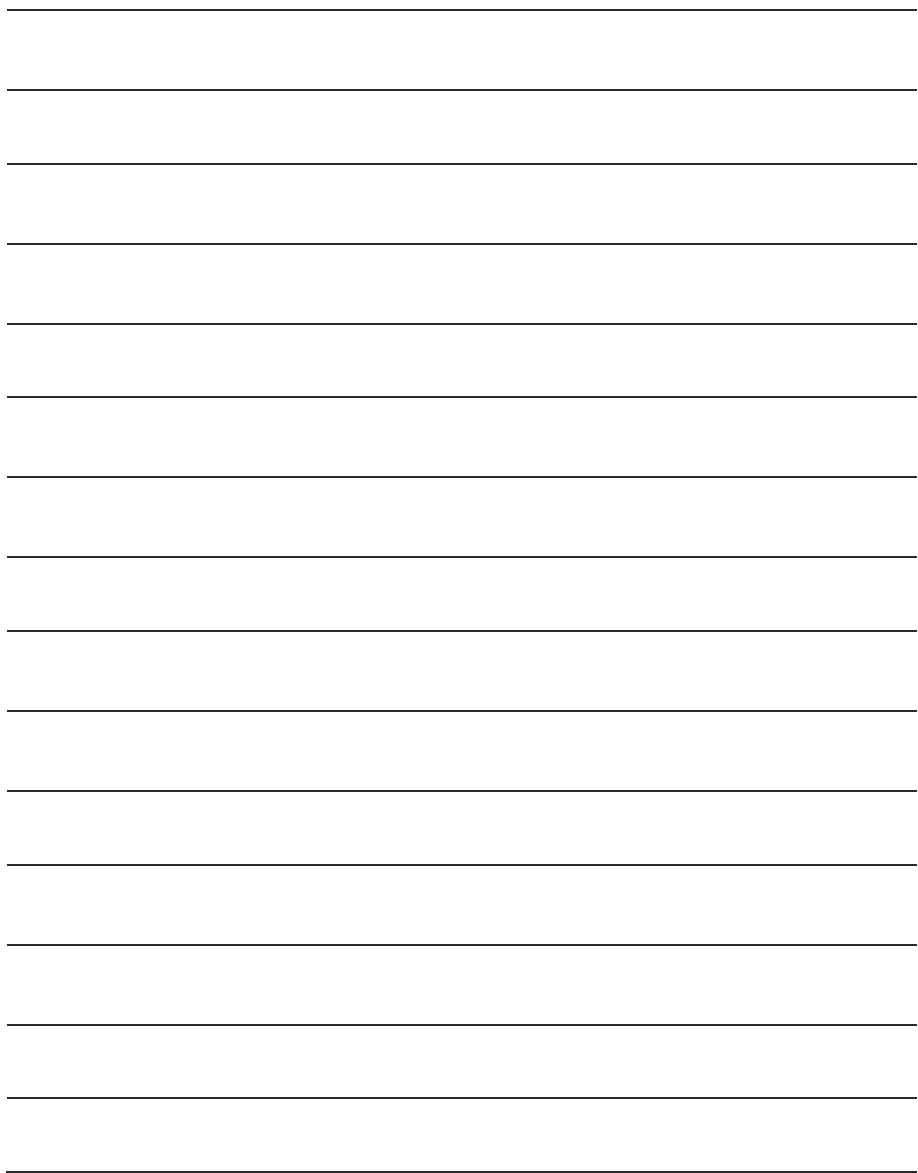

Need more information?

We hope that this user guide has given you the assistance needed for a simple set-up.

For the most up-to-date guide for your product, as well as any additional assistance you may require, head online to **help.kogan.com**

kogan.com