

1 Appearance

- ① Microphone ② Camera ③ Indicator ④ Button ⑤ Card Reading Area
⑥ Loudspeaker ⑦ Terminals ⑧ Debugging Port ⑨ TAMPER
⑩ Set Screw ⑪ TF Card Slot ⑫ Network Interface

Note: The debugging port is used for debugging only.

Indicator Description

Unlock: Green Call: Orange Communicate: White

2 Terminal and Wiring

NC: Door Lock Relay Output (NC) 485-: RS-485 Interface (Reserved)
NO: Door Lock Relay Output (NO) 485+: RS-485 Interface (Reserved)
COM: Common Interface 12 VDC IN: Power Supply Input
AIN1: For the access of Door Contact GND: Grounding
AIN3: For the access of Exit Button
AIN2&AIN4: Reserved

3 Installation Accessory

- ① Mounting Template ② Mounting Plate

Note: The dimension of the mounting plate is 102.58 mm × 39.24 mm × 6.2 mm.

4 Installation

Note: Video intercom villa door station supports surface mounting.

Before You Start

- Make sure all related equipments are power-off during the installation.
- Tools that you need to prepare for installation: Drill (φ2.846) and gradienter.
- Purchase the protective shield before installation.

★ Surface Mounting without Protective Shield

- Stick the mounting template on the wall. Drill screw holes according to the mounting template. Remove the template from the wall.
- Secure the mounting plate on the wall with 4 supplied screws according to the screw holes.

- Install the villa door station to the mounting plate. Fix the device on the mounting plate with the set screw.

Note: Apply silicone sealant among the cable wiring area to keep the raindrop from entering. Please refer to figure A.

★ Surface Mounting with Protective Shield

- Stick the mounting template on the wall. Drill the screw holes according to the mounting template. Remove the template from the wall.
- Align the protective shield with the mounting template.
- Secure the mounting plate and protective shield on the wall with 4 supplied screws according to the screw holes.
- Install the villa door station to the mounting plate. Fix the device on the mounting plate with the set screw.

Note: If installing outdoors, you are advised to install the device with protective shield. For the finished view, please refer to figure B.

5 Configuration via Web

① Activate Device via Web

You are required to activate the device first by settings a strong password before you can use the device.

Default parameters of door station are as follows:

- Default IP Address: 192.0.0.65.
- Default Port No.:8000.
- Default User Name: admin

- Power on the device, and connect the device to the network.
- Enter the IP address into the address bar of the web browser, and click Enter to enter the activation page.

Note: The computer and the device should belongs to the same subnet.

- Create and enter a password into the password field.
- Confirm the password.

- Click OK to activate the device.

Note: When the device is not activated, the basic operation and remote configuration of device cannot be performed.

② Access to the Device by Web Browsers

- In the browser address bar, enter the IP address of the device, and press the Enter key to enter the login page.
- Enter the user name and password and click Login.

③ Communicate with Indoor Station

- Click Settings -> Intercom -> Press Button to Call to enter the settings page.
- Set the parameters.
 - Edit call No. for every button.
 - Check Call Management Center to set the button calling center.

Note: If you check Call Management Center and set the call No. as well, call management center has higher privilege than call No.

- Press button to call indoor station.

④ Issue Card

- Click Settings -> Access Control and Elevator Control to enter the settings page.
- Click Issue Card. Present the card on the card reading area.
- When issuing finished, the windows pop up on the settings page.

Note:

- Only M1 card supported, and Mifare card with non-standard shape is recommended.
- Up to 10000 cards can be issued and managed by V series door station. A voice prompt (No more cards can be issued.) can be heard when the issued card amount exceeds the upper limit.

⑤ Unlock Door

After issuing cards, you can unlock the door by presenting the issued cards.

Refer to Video Intercom Villa Door Station User Manual (scan the QR code) for details.

1

DS-KV6103-PE1(C) DS-KV6113-WPE1(C)

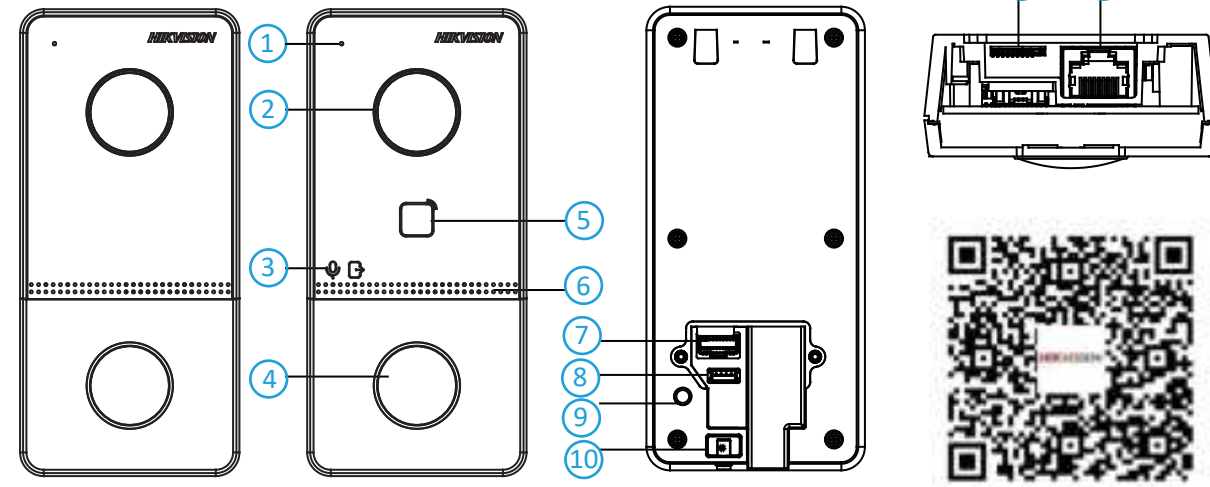

2

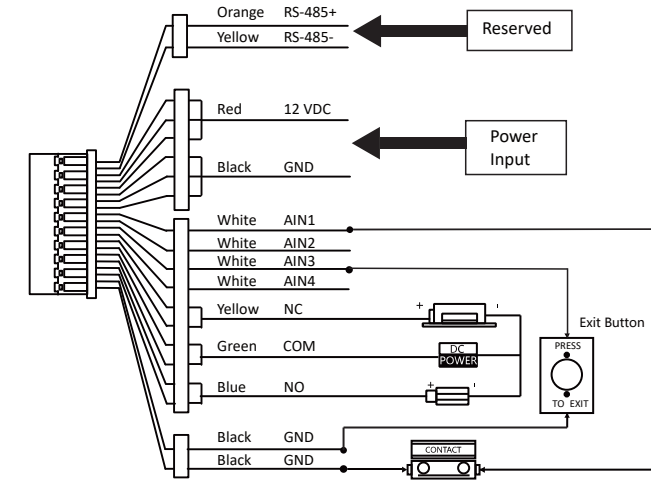

3

★ Surface Mounting without Protective Shield

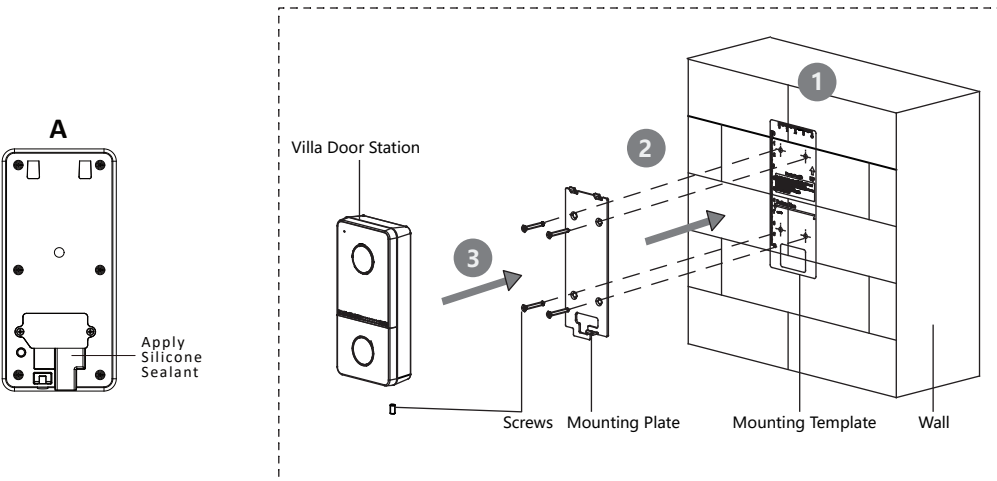

4

★ Surface Mounting with Protective Shield

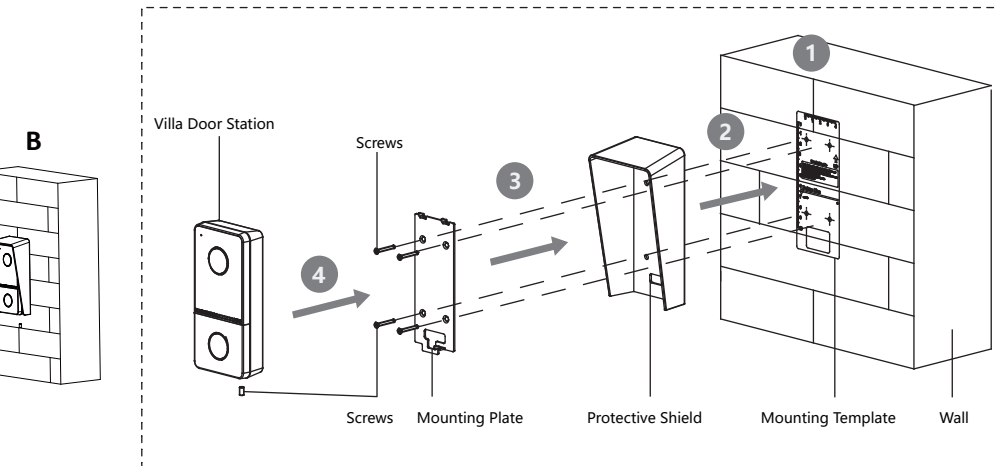

4

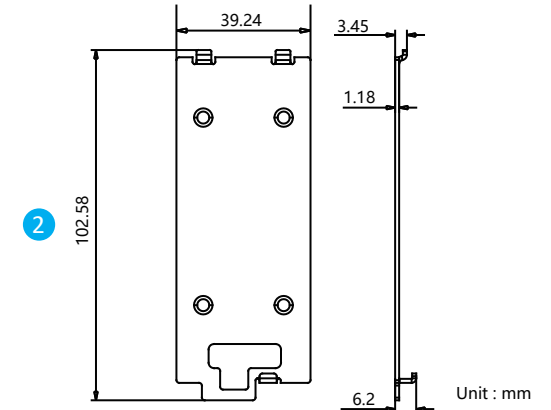
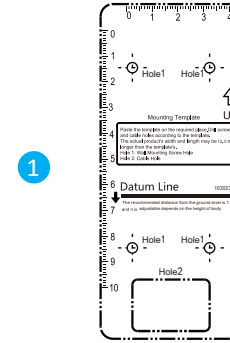

5

Recommended Installation Height (The distance between the camera and the ground): 1.4 m to 1.6 m.

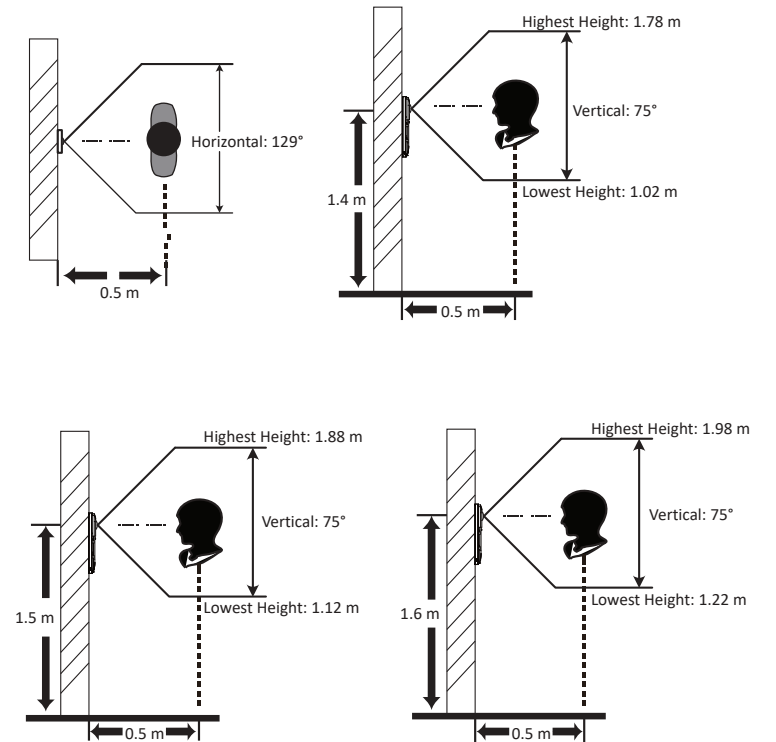

Chapter 2 Terminal and Wiring Description

2.1 Terminal Description

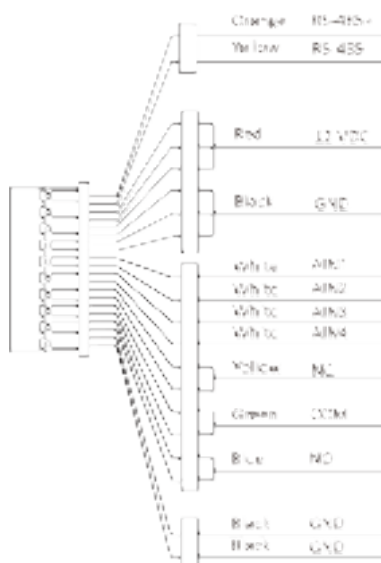

Figure 2-1 Terminal Description



Note

RS-485 terminal is not supported.

2.2 Wiring Description

2.2.1 Door Lock Wiring

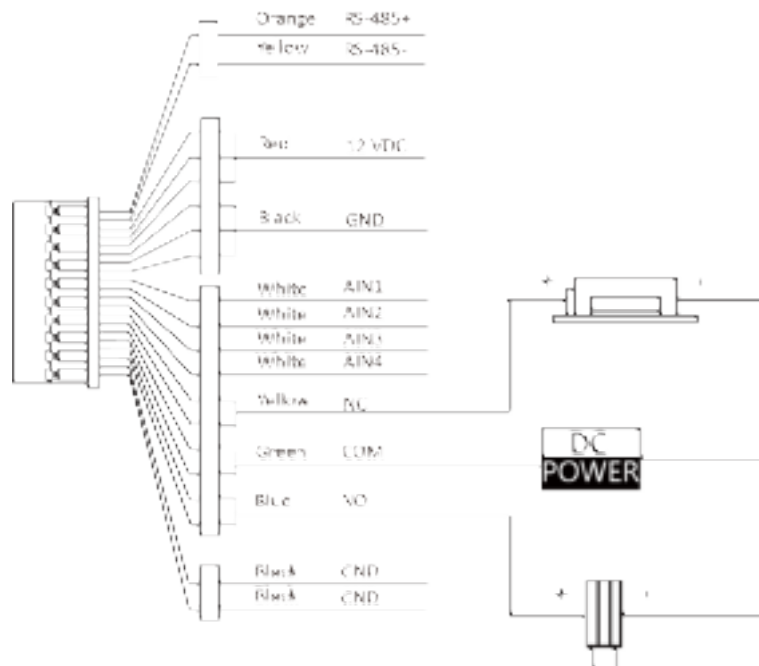

Figure 2-2 Door Lock Wiring



Note

Terminal NC/COM is set as default for accessing magnetic lock/electric bolt; terminal NO/COM is set as default for accessing electric strike.

2.2.2 Door Contact Wiring

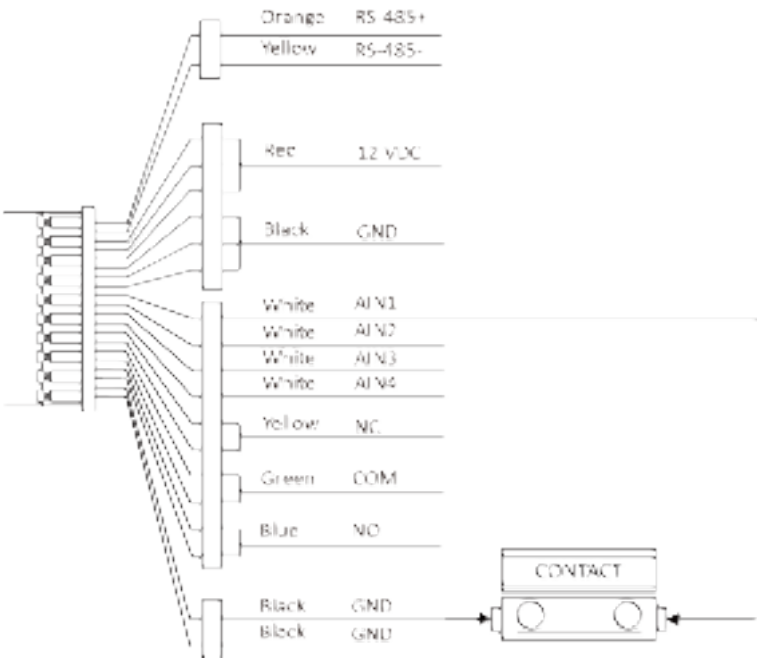

Figure 2-3 Door Contact Wiring

2.2.3 Exit Button Wiring

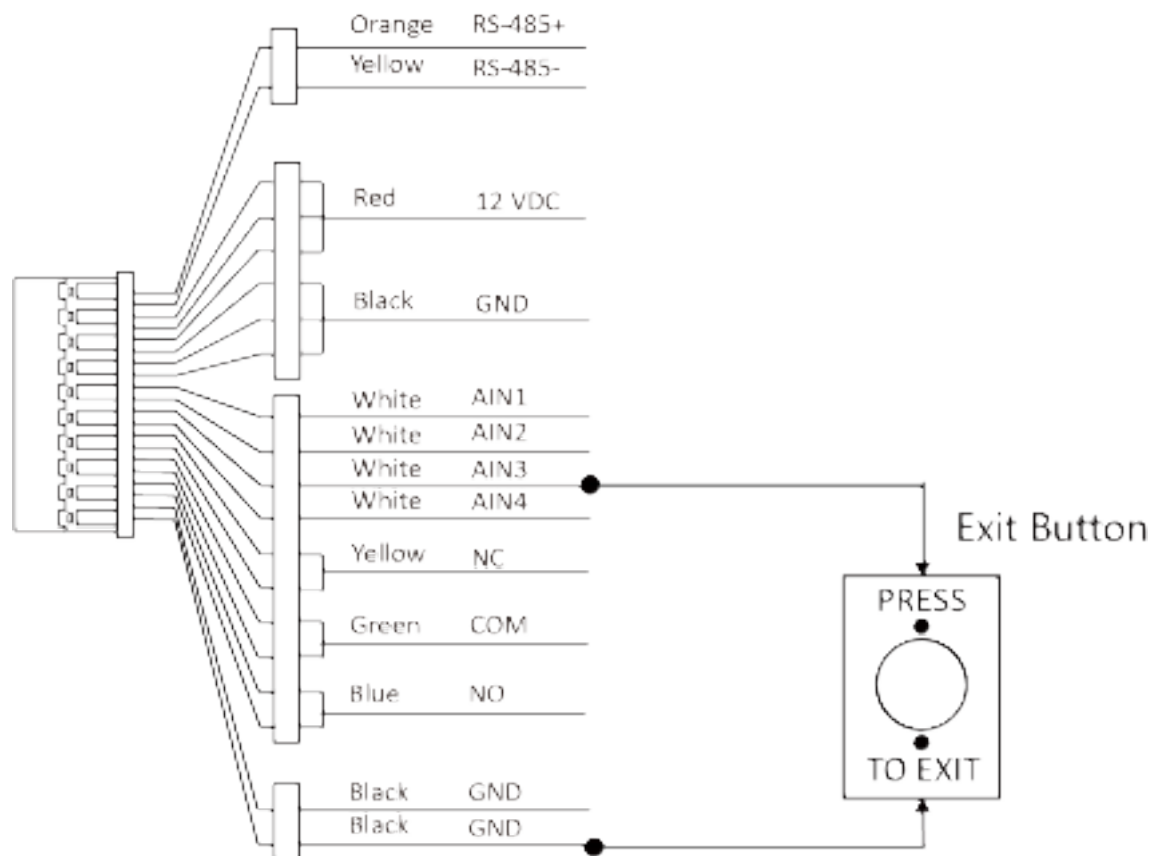

Figure 2-4 Exit Button Wiring

ENGLISH

Diagram References

1 Appearance

- ① Screen ② Microphone ③ Debugging Port ④ Network Interface
⑤ Loudspeaker ⑥ TF Card Slot ⑦ Alarm Terminal ⑧ Reserved
⑨ Power Terminal

Note:
• The appearance of the device varies according to different models. Refers to the actual device for detailed information.
• The debugging port is used for debugging only.

2 Terminal and Wiring

There are 20 pins in the terminal on the rear panel of the indoor station: 2 RS-485 pins, 5 reserved pins, 4 relay output pins, 8 alarm input pins, and 1 GND pin.

Note: There are 20 pins in the terminal on the rear panel of the DS-KH6320-TE1: 11 reserved pins, 8 alarm input pins, and 1 GND pin. Please refer to the specific model.

3 Installation

It supports wall mounting. There are two installation modes.

Installation Accessory Description

The wall mounting plate and junction box are required to install the indoor station onto the wall.

The dimension of junction box should be 75 mm (width) × 75 mm (length) × 50 mm (depth). The dimension of wall mounting plate is shown.

Before You Start

- Make sure the device in the package is in good condition and all the assembly parts are included.
- The power supply the indoor station supports is 12 VDC. Please make sure your power supply matches your indoor station.
- Make sure all related equipments are power-off during the installation.
- Check the product specification for the installation environment.

★ Wall Mounting with junction Box

1. Chisel a hole in the wall. The size of the hole should be 76 mm (width) × 76 mm (length) × 50 mm (depth).
2. Insert the junction box to the hole chiseled on the wall.
3. Fix the wall mounting plate to the junction box with 2 screws.
4. Hook the indoor station to the wall mounting plate tightly by inserting the plate hooks into the slots on the rear panel of the indoor station, during which the lock catch will be locked automatically.

★ Wall Mounting without junction Box

1. Insert 2 expansion tubes into the wall.
2. Fix the wall mounting plate to the junction box with 2 screws.
3. Hook the indoor station to the wall mounting plate tightly by inserting the plate hooks into the slots on the rear panel of the indoor station, during which the lock catch will be locked automatically.

4 Getting Started

① Activate Indoor Station

You are required to activate the device first by set t i ngs a strong password before you can use the device.

1. Power on the device. It will enter the activation page automatically.
2. Create a password and confirm it.
3. Tap OK to activate the indoor station.

② Quick Configuration

1. Choose Language and tap Next.
2. Set network parameters and tap Next.
 - Edit Local IP, Subnet Mask and Gateway parameters.
 - Enable DHCP, the device will get network parameters automatically.
3. Configure the indoor station parameters.
 - Select Indoor Station and tap Next to link main door station.

- i. Edit Floor and Room No.
- ii. Create and confirm SIP register password.

Note: If you want to add the indoor station to the door station, the SIP password of the indoor station should be the same as the registration password of the door station.

- c. Tap Advanced Settings to edit Community No, Building No. and Unit No.
- d. Optional: Enable Indoor Station Settings and select the indoor station to link.
 - Select Indoor Extension and tap Next to link indoor station.
- i. Edit No., Room Name.
- ii. Create and confirm SIP register password.

4. Linked related devices and tap Next. If the device and the indoor station are in the same LAN, the device will be displayed in the list. Tap the device or enter the serial No. to link.

- i. Tap the settings icon to pop up the Network Settings page.
 - ii. Edit the network parameters of the door station manually or enable DHCP to get the network parameters automatically.
 - e. Tap OK to save the settings.
5. Tap Finish to save the settings.

Refers to Video Intercom Network Indoor Station Configuration Guide (Scan the QR code) for details.
Refers to Video Intercom Network Indoor Station Operation Guide (Scan the QR code) for details.

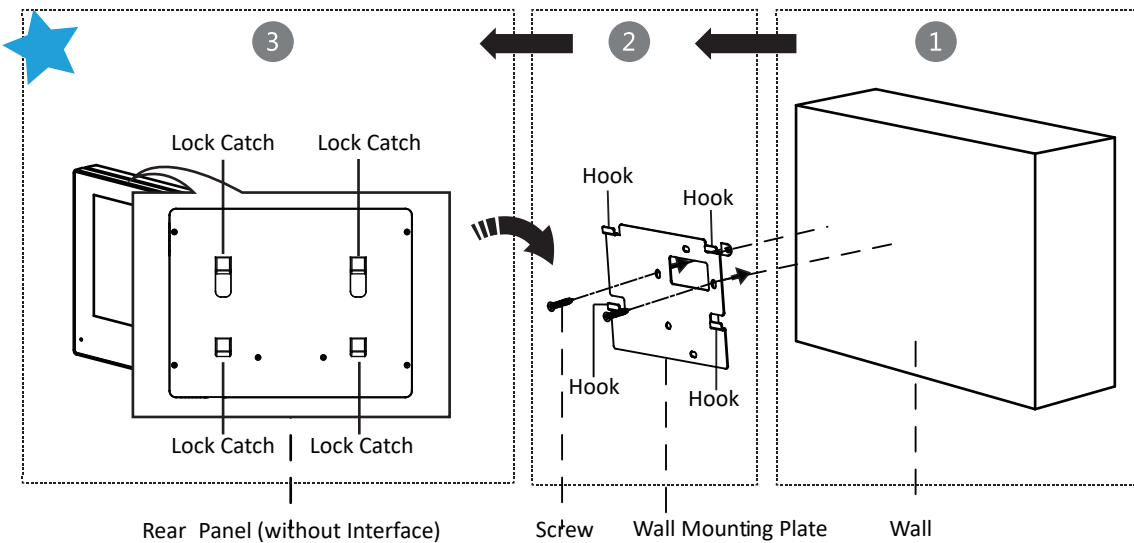
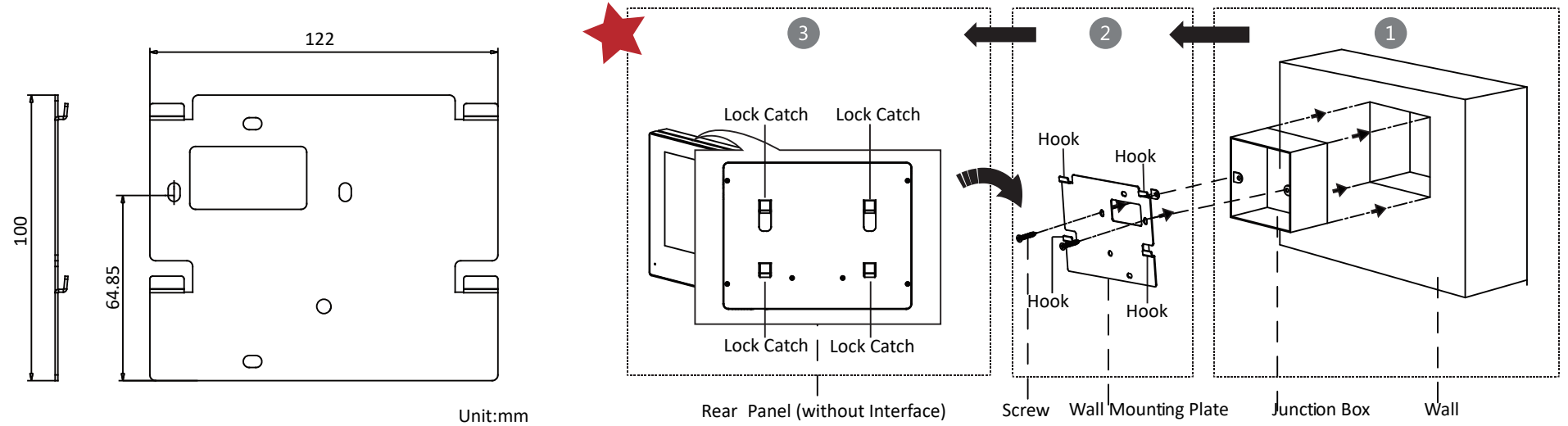
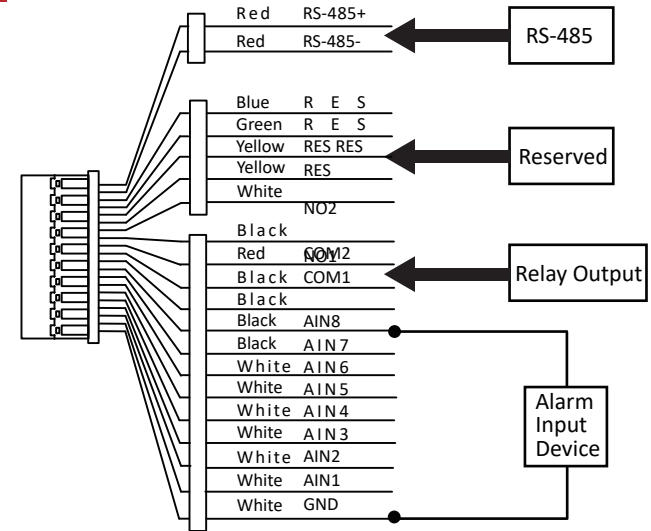
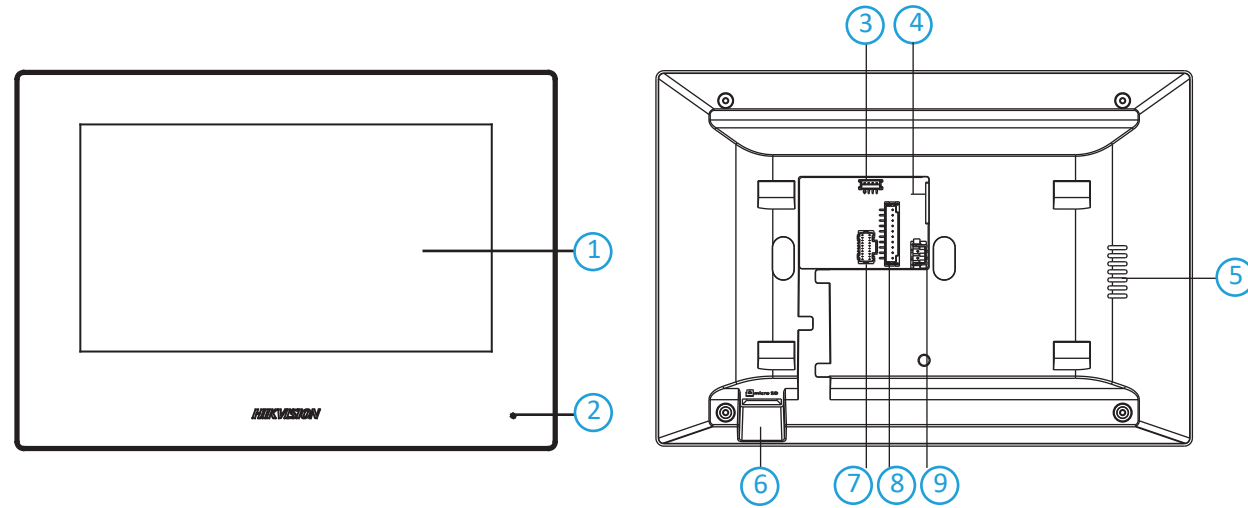

Scan the QR code to get the User Manual for detailed information.



DS-KH6320-WTE1 Network Indoor Station



The KH6 series IP indoor station, with 7-inch touch screen, brings you a fluent video and audio communication. By considering the difficulty of deployment of the traditional video intercom, the device has improved the design and can deploy the whole video intercom system by itself independently, without extra devices or configurations, which reduces the deployment time and cost. You can view, chat with, and send permission for the visitor via mobile phone in anywhere. The device can also link other control systems, such as CCTV system, elevator control system, etc.

- 7-inch TFT touch screen with 1024 × 600 resolution
- Convenient Hik-Connect APP Mobile Control
- Receive calls, open the door and live view remotely
- Easy to use without PC
- Easy wizard for quick set up
- Configure the whole system on one touch screen
- Live view of the door station and cameras in public areas
- Support voice messages when no response from the indoor station
- Receive alarms by linkage with a alarm system and notify the center to handle in time
- Elevator access control

▪ Specification

System parameters	
Operation system	Linux
ROM	32 MB
RAM	128 MB
Processor	Embedded high performance processor
Display parameters	
Screen size	7-inch
Operation method	Capacitive touch screen
Type	Colorful TFT
Resolution	1024 × 600
Video parameters	
Lens	/
Resolution	/
FOV	/
Wide dynamic range (WDR)	/
Video compression standard	/
Focal length	/
Audio parameters	
Audio input	1 built-in omnidirectional microphone
Audio compression standard	G.711U/G.711A
Audio output	1 built-in loudspeaker
Audio compression bitrate	64 Kbps
Audio quality	Noise suppression and echo cancellation
Volume adjustment	Adjustable
Capacity	
Message capacity	TF card inserted: 200 captured pictures, 200 alarm records Without TF card: 2 MB RAM for picture storage; The storage number is decided by the picture size, 200 alarm records
Notice capacity	200
Linked indoor extensions capacity	16
Linked doorphone capacity	17
Linked network camera capacity	16
Network parameters	
Network protocol	TCP/IP, SIP, RTSP
Wi-Fi	2.4 GHz, IEEE802.11b, IEEE802.11g, IEEE802.11n
Bluetooth	/
3G/4G	/
Zigbee	/
Device interfaces	
Alarm input	8
Network interface	1 RJ-45 10/100 Mbps self-adaptive
TAMPER	/

RS-485	1 RS-485 (Half duplex)
USB	/
TF card	Support TF card, up to 128 G
Alarm output	2
Lock control	2 relays, Max. 30 VDC 0.3 A
General	
Button	/
Installation	Surface mounting
Indicator	/
Weight	Net weight: 355 g (0.8 lb) Gross weight: 683 g (1.5 lb)
Protective level	/
Working temperature	-10 °C to 55 °C (14 °F to 131 °F)
Working humidity	10% to 90% (no-condensing)
Dimension (W × H × D)	200 mm × 140 mm × 15.1 mm (7.9" × 5.5" × 0.6")
Battery	/
Application environment	Indoor
Power consumption	≤ 5 W
Language	English, Russian, Bulgarian, Hungarian, Greek, German, Italian, Czech, Slovak, French, Polish, Dutch, Portuguese (Brazil), Spanish, Hebrew, Romanian, Turkish, Estonian, Danish, Swedish, Norwegian, Finnish, Vietnamese, Croatian, Slovenian, Serbian, Arabic, Portuguese (Portugal), Lithuanian, Uzbek, Kazakh, Mongolian, Ukrainian

▪ Available Model

DS-KH6320-WTE1

▪ Dimension

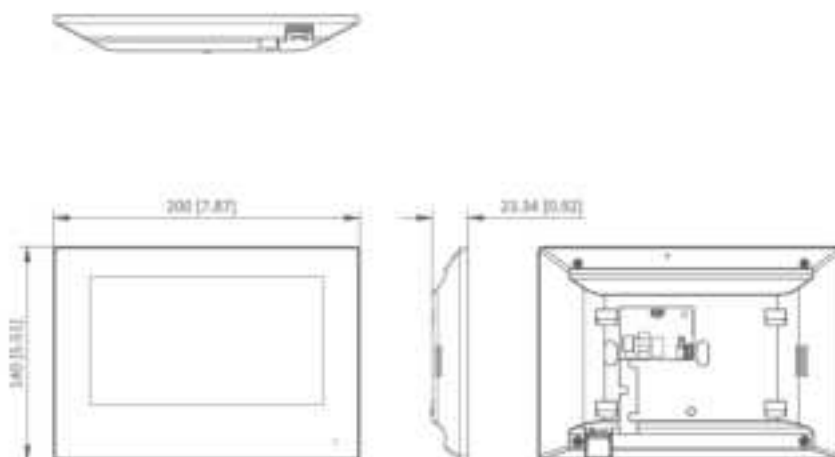

Unit:mm [inch]
SCALE 1:1

▪ **Accessory**

▪ **Optional**

DS-KAW50-1 50W 12V Power Adapter	DS-KABH6320-T Indoor Station Table Bracket	DS-KAW50-1N 50W 12V Power Adapter
		