



Quick Start Guide & Manual

SeeMe PRO 360



Thank you for buying a SeeMe light set

We are a very small start-up company with a unique approach to cycle safety, working hard to reduce the number of cyclists killed or badly injured on the World's roads. Our Hero product is the PRO 360, giving 360° visibility, great lighting and HD Video recording like a dashcam.

Our goal is to build the very best lights that make cyclists more visible and therefore less susceptible to danger.

Whilst we strive to get everything 100% right and totally reliable, it is inevitable that occasionally issues will occur. If that happens to you, please get in contact with us immediately and we will do everything in our power to correct the situation. Your feedback is important to help us perfect our products.

We are always open to new innovations and if you see a way we can improve our product in any way and make you the cyclist safer, please contact to us on support@seeme-cycle.com.

It is most important to us that every customer is happy with their purchases and helps us spread the word.



WHAT IS IN YOUR CARRY CASE?

ITEM NO.	PART NUMBER	QTY.
1	P1480_A001_01 Front Light	1
2	P1480_A002_01 Rear Light	1
3	P1480_A003_01 Front Bike Mount	1
4	P1480_A004_01 Seat Clamp	1
5	P1480_B008_01 MicroSD Card	2
6	P1480_B009_01 USB C cable	2



SEE ME[®]
PRO 360

1. INTRODUCTION & SAFE OPERATION

Before using these lights, please read this manual and any attached documentation thoroughly, and keep copies for future reference.



WARNINGS FOR SAFE OPERATION

- If your light unit or parts become dirty with mud, etc., please clean it with a soft cloth moistened with mild soap and water.
- Do not immerse in water or use a power wash to clean it.
- Do not use any solvent or abrasive cleaner which could damage your light and invalidate your warranty.
- Your light is a sealed unit. Do not attempt to open it as this will void the warranty.
- When not in use or being charged, keep your lights in the protective bag provided to protect them from accidental damage.
- When mounting the light units, they should clip and unclip without being forced. Please treat them with care and they will operate well.
- For your safety, you should choose your light mode and setting before starting to cycle and we advise that you stop to change any settings.
- Your light units are sealed units and must not be opened by anyone but our service engineers. Tampering with or opening a unit will invalidate your warranty.

2. QUICK START GUIDE

CHARGING

Fully charge the batteries before using the lights for the first time and if they haven't been used for a long time.

Your SeeMe Cycle Light Set comes with a waterproof cover on its base, furthest from the main beam light. See illustration **A** below.

Carefully peel back the protective end cap. Insert the USB-C charger lead provided and plug this into your own Charger Plug for your locality (not supplied).

Generally your phone or i-Pad charger plug is suitable, or alternatively it can be charged from your Computer or Laptop USB slots, although this may mean slower charging.

Ensure the protective cover is replaced securely to ensure



3. HOW TO FIT MOUNTING BRACKETS

MOUNTING

Your SeeMe Cycle Light Set comes with two mounts designed to fit the majority of cycles on sale today.

The front mount will only fit round standard handlebars of between 25.4mm - 31.8mm diameter using different rubber sleeves included as part of the package.

The rear mount will fit seat bars that do not have other accessories fitted such as bags or carriers..

Our mounts will not currently fit Aero or other bar variations, but we do propose to develop these in the near future.

Once fitted, these mounts remain securely fitted on your cycle and allow you to remove lights quickly and easily for added security.

Exploded diagrams of the two mounts are shown overleaf as diagrams **B & C**.

It is a good idea to watch our "How to videos" on our download page to see how it is done before installation.

www.seeme-cycle.com/downloads/

3. EXPLODED DIAGRAMS OF MOUNT ASSEMBLIES

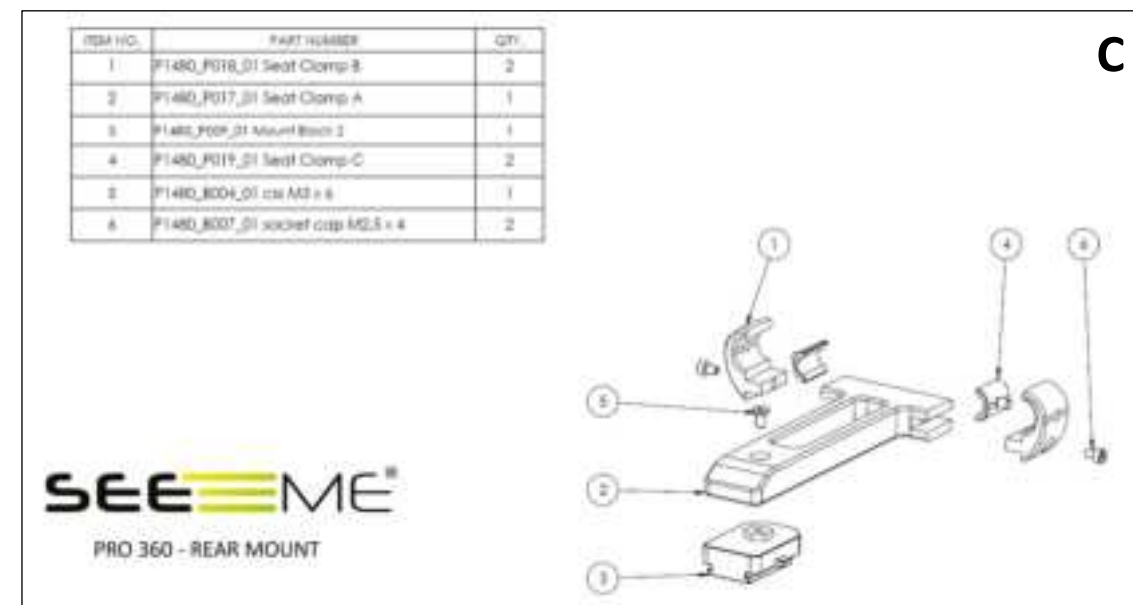
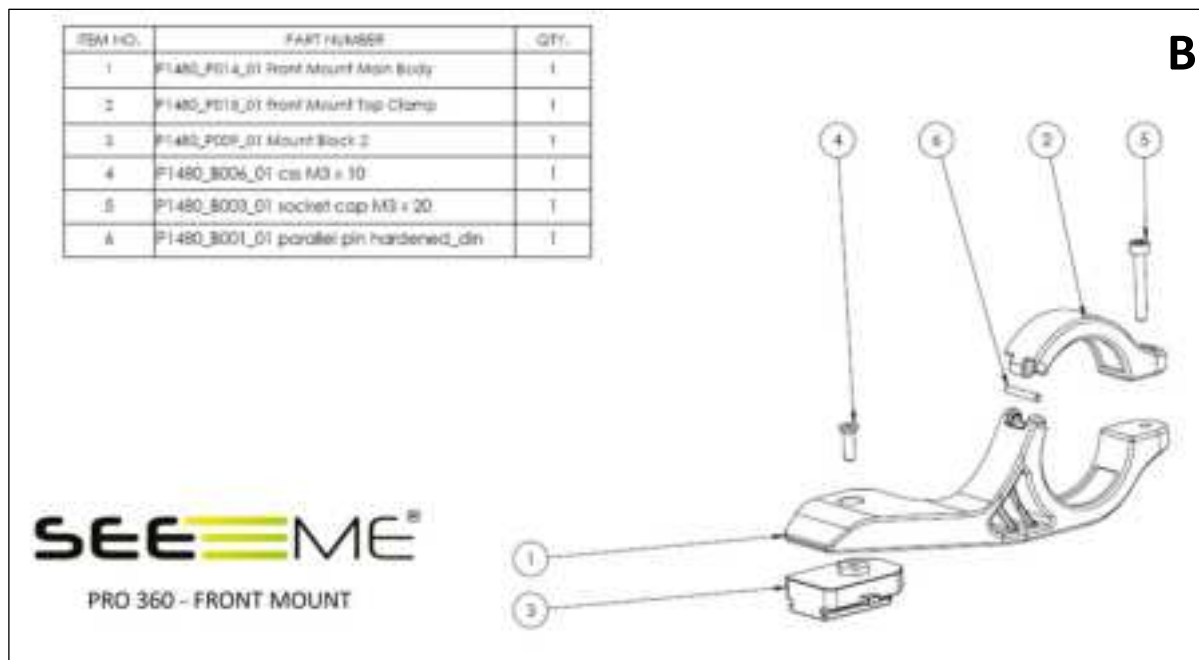

4. HOW TO MOUNT/REMOVE LIGHT UNITS

Once your mounts are securely fixed to your cycle, it is a simple job to slide the unit onto the mount until it clicks into place. See illustration D below.



Do not use undue force to fit it on the mount, as they could break. They should attach easily, so just try a slightly different angle.

You can watch our “How to videos” on our download page to see how it is done if you have any issues. www.seeme-cycle.com/downloads/



5. BATTERY CHARGE INDICATOR

On each SeeMe cycle light unit, the power button has an illuminated sealing ring, which doubles as a battery charge indicator as follows. See illustration E below.

-  battery is charged to 80 – 100% of full charge
-  battery is charged to 30 – 80% of full charge
-  battery is charged to 1 – 30% of full charge (level is low)

Flashing – Battery is charging when connected to a USB-C charger cable.



6. HOW TO OPERATE THE UNITS

LIGHTING (Switching on and through modes).
SeeMe PRO 360 lights operate via a single push button. To switch on each light unit, press the switch with a long press until the light illuminates. This turns the light units on full power. To switch to different modes follow the chart below.

HD VIDEO CAMERAS
Once the light unit is turned on, the video camera starts to operate and remains on all the time the lights are on until you power the unit down

OPERATING THE MAIN POWER SWITCH TO CHOOSE BETWEEN THE SIX MODES OF LIGHTING.

SWITCH ACTION	MAIN BEAMS	SIDE WINGS	HD VIDEO CAMERAS
Long Press	On constant 100% power	On constant 100% power	Starts to record
1 st Short Press	Constant 70% power	Constant 70% power	Always on
2 nd Short Press	Constant 50% power	Constant 50% power	Always on
3 rd Short Press	Constant 100% power	Flashing 2 per second	Always on
4 th Short Press	Constant 70% power	Flashing 2 per second	Always on
5 th Short Press	Constant 50% power	Flashing 2 per second	Always on
6 th Short Press	Return to the beginning of the sequence		Always on
Long press at any time	Off	Off	Off

7. HOW TO DOWNLOAD VIDEOS

Your TF/Micro SD card is located behind the protective cover alongside your charging port (see illustration F).

Recordings can be transferred to a PC, Mac or Laptop by inserting the card into a card reader or appropriate slot provided on some computers.

We recommend that you transfer one file at a time (copy and paste, don't just drag) to make sure you don't slow down your computer or transfer rate, then view the files on your PC/Mac/Laptop as this will be faster than viewing from the card.

Remember that once full, the card will start to overwrite the earliest files, so download regularly if you wish to keep videos of your rides to show others or as evidence after an incident. As files are large, you may not wish to keep every video.

Should you wish to increase storage capacity, you can buy larger cards and each unit will accept cards up to 128Gb. We recommend that you make sure you buy cards with the same Speed, UHS Speed and Video Speed classes as the one provided.

Deciphering the numbers on a microSD card

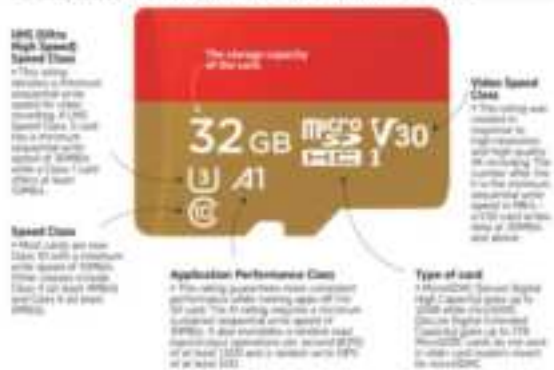

F

8. SPECIFICATIONS

Our policy is to use high grade components in all of our products, to ensure longevity and reliability.

Lighting performance

- High Intensity LED Directional Main Front Beam – 1,500 lumens with adjustable brightness levels
- High Intensity LED Rear Main Beam – 450 lumens with adjustable brightness levels
- Quadrant LED lighting strips – 160 lumens each strip
- Downward facing diffusers on both main beams.
- All lights have adjustable brightness levels, flashing and constant modes

Camera performance

- Omnivision OV2640 HD Camera using a CMOS UXGA (1632 x 1232) image sensor.
- Effective Video Resolution – 2MP
- Effective Still Resolution – 2MP (1632 x 1232 pixels)
- Output resolution – Full HD 1080p at 30fps
- Viewing Angle – 140 degrees
- Weatherproof and Waterproof IP Ratings - IP66 Rated
- Low light technology - Night colour vision with Infra Red LEDs

Weatherproof & Waterproof IP rating

Each unit is IP66 rated, which means:

- The first 6 signified the Solid IP Rating and means “these devices are dust tight, so dust cannot enter”.
- The second 6 signifies the Liquid IP Rating means they are “protected from jets of water from any direction with no harmful effects.”

Battery information

Front and Rear light units are each fitted with:

- Li-ion 18650 battery maximum capacity 3400mAh
- Engineers have calculated this will power a unit on its maximum consumption with all lights and video camera on for over 2 hours. This of course is subject to being fully charged which is done via a USB-C charging lead provided. No plug is supplied
- Battery life expectancy (charging cycles) 750-1,000 cycles

Memory Cards

- Each SeeMe light comes with a 32Gb TF/Micro SD Card fitted. This can be upgraded to 128Gb by purchasing a card separately
- Card manufacturers state that a 32Gb card will record approximately 168 minutes of 1080p at 30fps and 672 minutes on a 128Gb card

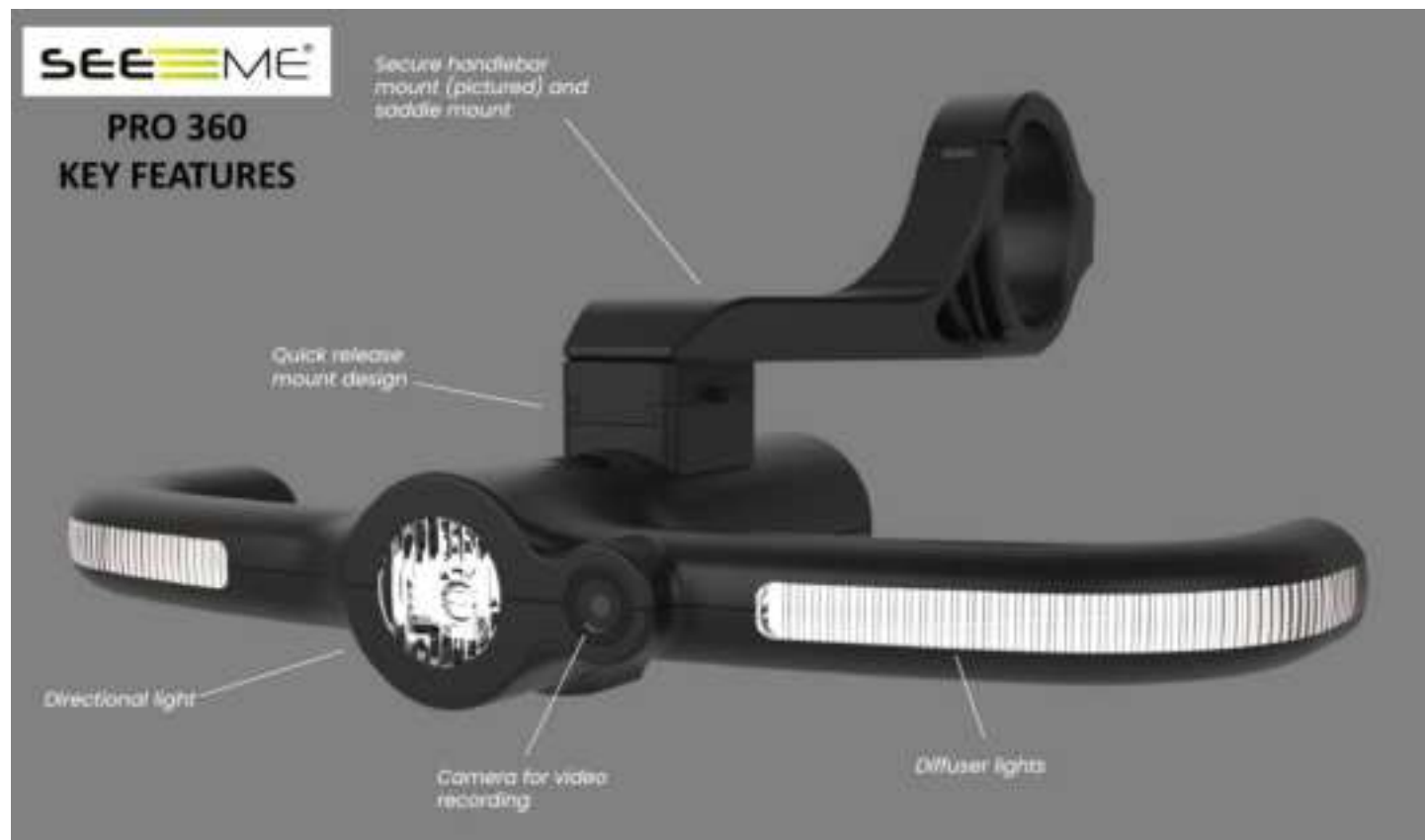

9. QUALITY CONTROL PROCESS

Every SeeMe cycle light is subject to rigorous quality control testing at every stage of manufacturer.

Components are quality checked on receipt and each process of manufacture is separately QC checked.

Once manufacturing is complete, batteries will be fully charged and tested, followed by a comprehensive check that all modes and features work correctly .

This ensures that everything operates successfully before units are dispatched to customers.



10. ENVIRONMENTAL

SeeMe believes that we have a duty to reduce waste, reduce our use of paper to save trees and recycle everything possible. Our products are made to comply with WEEE regulations and our boxes are 100% recycled..

Virgin materials are only used in the manufacture of our products where the use of recycled materials would compromise the quality or the safety of our customers.

11. CERTIFICATION

SeeMe PRO 360 cycle light sets will be accredited to the following certifications, which will be available to download from our Downloads Page.

Market	Testing Program
UK & EU	CE EMC EN55015,EN61547,EN55032,EN55035,EN61000-3-2/-3
	ROHS 2.0
	REACH SVHC 241
CANADA	ISED
USA	FCCSDOC FCC Part15b
	CA65 +CPSIC
	TSCA (Mixed test, only plastic)
AU	C-tick (Application based on CE EMC)
	UN38.3+Sea and air identification report +SDS report + experimental summary report

12. LIMITED WARRANTY & SUPPORT

Warranty

Your SeeMe lights are covered by a limited return to base warranty against material and manufacturing defects.

We will provide you a replacement unit, if we can't repair your light.

This warranty covers your SeeMe light units and mounts only, and lasts for 12 months from the date of original purchase of this product.

What is Not Covered

Excluded from this warranty is:

- Accidental damage.
- Any damage caused by the owner attempting to open the sealed unit, modifying, attempting to fix, or otherwise altering the product.
- All accessories such as cables, memory cards, carry bags or attachments.
- The limited warranty is not transferable to subsequent owners or purchasers of this product.
- The cost of returning the unit to us for repair/replacement.

Limitation on Liability:

SeeMe shall not be responsible for any incidental or consequential loss or damages.

This warranty is offered exclusively under English Common Law, which will apply regardless of the shipping destination.

Returns (under warranty)

In the unlikely event that your SeeMe light stops functioning, please contact us on support@seeme-cycle.com for a returns number **BEFORE** returning any product to us.

A returns number is required for all warranty claims and we accept no responsibility for anything posted to us without this number and a completed form enclosed in the parcel..

Support

If you have any issues other than warranty claims with your SeeMe lights or any questions not covered in the [FAQs](#) on our website, please contact our help desk on support@seeme-cycle.com.

Please describe the issue clearly and provide full contact details (Name, address, phone number, email address, Product Model number that the question pertains to..

We will do our best to answer any questions and assist you.

Our support desk is open 9am to 5pm Monday to Friday except on UK Bank Holidays.

ADDITIONAL INFORMATION

Recycling

What YOU should do to comply with the WEEE regulations:

When you purchase a product from SeeMe Cycle that contains electrical or electronic components, you will be able to dispose of the old one free of charge via a Designated Collection Facilities (DCF). The waste will then be treated so that hazardous elements cannot contaminate the environment, and where possible the item will be recycled.

When your WEEE product reaches the end of its life, please do not put in your domestic waste bin, as it will not be recycled.

To ensure your WEEE is recycled in accordance with the regulations, you should ensure that the goods are separately disposed of by taking it to your local DCF. This would normally be your local civic amenity site (recycling centre).

Worldwide DFCs can be found at - [WEEE Directory \(weee-directory.com\)](http://weee-directory.com)



