

# USER MANUAL

RM-AR2749F

---



## 1.1 Preface

Thank you for choosing this Intelligent Car Information System. It is a comprehensive system of navigation and entertainment, also known as the Car - Machine Interconnection System. The car owner can connect the car to the mobile phone for navigation and voice recognition; when parking, the car owner can connect the USB to listen to music or watch videos; when driving, the car owner can use the phone function directly for navigation and music; no more need to hold the mobile phone to make calls, safe and convenient. The illustrations in this manual are for reference only. For details, please refer to the actual system.

## 1.2 Safety Precaution

Please note that it is not permitted to operate the machine while driving, in order to comply with driving safety rules and traffic laws. This machine is an electronic product, please observe the safety precautions of ordinary electronic machines. This machine is powered by a 12V-24V 5A vehicle power supply, do not install the machine on a substandard power supply to avoid damage to the machine. Do not disassemble and assemble without permission, it should be carried out by professional maintenance personnel. Do not modify or upgrade the system software without authorisation. Do not touch the surface of the main unit with sharp or hard materials. Do not use in extreme environments, normal operating temperature is -40°C to 70°C, Do not spill liquids or chemicals (such as water) on the machine. The company does not take any responsibility for the loss or damage of personal data caused by the user's wrong operation, product maintenance, replacement or other unexpected circumstances, and is not responsible for other indirect losses caused thereby. The company has the ownership and final interpretation right of the function manual, three guarantee certificate, warranty card and other related materials.

## ■ 1.FUNCTION INTRODUCTION

---



### **Apple CarPlay**

The iPhone's in-car infotainment system works with the centre console button to provide voice control for phone calls, messages, navigation, music and Siri voice interaction for more information. It supports both wireless and wired connections to CarPlay;

### **Android Auto**

The original ecological Android car-machine interaction system developed by Google, voice control phone, information, navigation, music built-in voice control system;

### **Front/Rear/360 Input**

The intelligent module supports video decoding and can be equipped with front view, rear view (with intelligent dynamic trajectory display and radar support), and 360° panoramic view;

## ■ 2.APPLICABLE SYSTEM AND CAR MODELS

---

Alfa Romeo		
Model	Year	Screen Size
Giulia / Giulia Quadrifoglio	2017-2020	6.5 inch/ 8.8 inch
Stelvio		

### ■ 3.INSTALL MANUAL

---

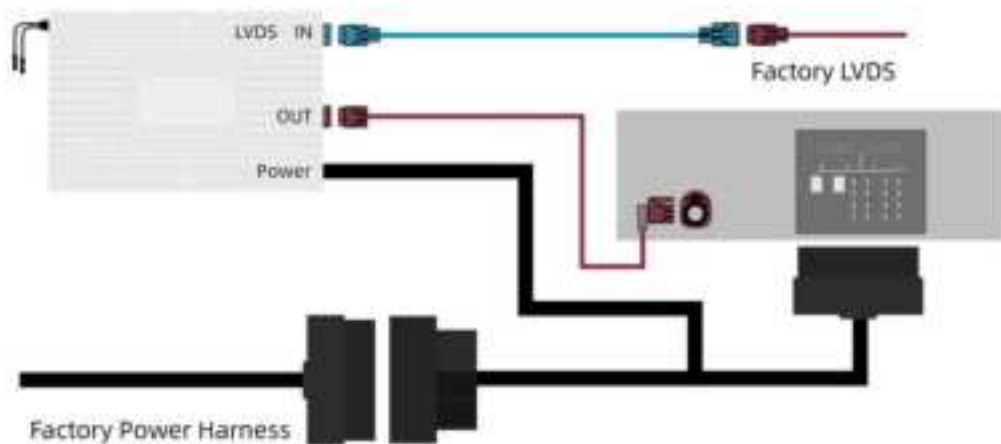

## ■ 4.DIP SETTINGS & SWITCH

---

Here are the DIP settings of the Alfa Romeo car model, please adjust according to your car model and screen size.

Car Model	Year	Screen Size	DIP
Giulia / Stelvio	2017-2020	6.5 inch	135 (ON)
		8.8 inch	235 (ON)

**Note:**Please note that the dial is set to "ON"



## ■ 4.DIP SETTINGS & SWITCH

### 4.2 Button Control

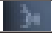

BUTTON	OPERATION	FUNCTION
	Short press	Answer the phone
	Long press	Wake up Siri
	Short press	Wake up Siri after setting
	Short press	Next song
	Short press	Previous song
	Swipe up	Increase the volume
	Swipe down	Decrease the volume



BUTTON	OPERATION	FUNCTION
MENU	Long press	Switch OEM screen to interface screen OR Interface screen to the OEM screen
	Rotation	Volume control system
 (Knob)	Short press	Control system APP
 Hazard Light	Double Click	Switch OEM screen to interface screen OR Interface screen to the OEM screen

## ■ 5. WIRELESS CONNECTION

The latest technology currently in use is a wireless CarPlay and Android Auto solution that supports audio and video separation.

Before using the wireless connection, please pair your device via Bluetooth and ensure that the car audio system is set to Bluetooth Music mode for optimum connection and audio performance.





## ■ 5.WIRELESS CONNECTION

### 5.1 Wireless CarPlay

Go to Smart Box Bluetooth



#### Connect Step :

1. Turn on the Bluetooth and WIFI on your phone, and leave them turned on.
2. Select the Bluetooth device name as 'CAR Audio\_XXXX' pair - use CarPlay while a request window pops up.



## ■ 5.WIRELESS CONNECTION

---

### Audio Source

Please verify on iPhone that the sound source is the original car radio.



## ■ 5.WIRELESS CONNECTION

### 5.2 Wireless Android Auto

Go to Smart Box Bluetooth.



### Connect Step :

1. Turn on Bluetooth and WiFi on your phone and leave them on.
2. Select the Bluetooth device name as the "CAR Audio XXXX" pair. Follow the on-screen Android Auto connection process after Bluetooth pairing is successful.

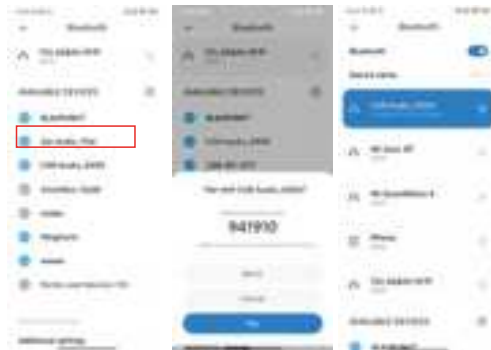

## 6.EXTERNAL SETTINGS

## 6.1 Rear view camera input

This CarPlay interface supports AHD (Analogue High Definition) camera input for clear rear-view images.

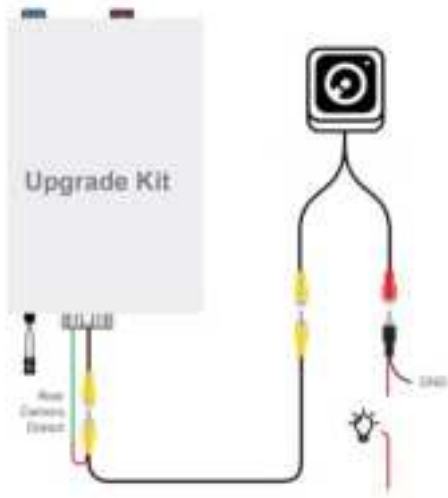

## ■ 6.EXTERNAL SETTINGS

### Then enter the system settings :

1. Click on "Factory mode → Advanced mode → Enter the password "888888" → MCU setup → Uncheck "A0"option.
2. Return to the previous level and click "Restart System" to successfully enable the reversing rear view function.



### 6.2 Radar and Trajectory

If the aftermarket camera you are installing also supports the reversing trajectory line, please uncheck the A1 box to display the reversing trajectory line. And the A2 box is the aftermarket radar option, uncheck the box to use it.



## ■ 7.SPECIFICATION

---

Operating voltage	9-16V, 14.4V (rated)	Storage temperature	-30~+85'C
Operating temperature	-30~+75°C	Ambient humidity	≤98% (at45'c).65±5% (rated)
Power consumption current	1A(rated).3A(Max)	Shutdown current	Current: 300mA (Clock is on)
Quiescent current:	less than 3mA		
Charging current:	≤2A, If the USB charging current is >1A, the host machine should activate the circuit protection function to control the current within 1.5A and prevent products from burning.		

## ■ 8.COMMON PROBLEM

---

### **8.1 Why will the Box's Bluetooth disconnect?**

Here is how wireless CarPlay works. After the device information is sent to confirmed via Bluetooth pairing, a Wi-Fi connection is established for data transfer. To avoid interference, the Bluetooth connection is disconnected. This is a normal phenomenon.

### **8.2 I cannot connect the CarPlay, but the Bluetooth already paired**

Please forget about Bluetooth and reset Wi-Fi in iPhone (Settings>General>Transfer or Reset[Device]>Reset>Reset Network Settings)

### **8.3 Why the wireless CarPlay not Stable?**

- 1.Ensure that the mounting position of the CarPlay box is not obstructed by metal parts, as this can affect the transmission of the Wi-Fi signal.
2. Change the WiFi channel, then enter the CarPlay box. Click: Factory Mode > Connectivity Settings > Hotspot Band > Select 1, 6 or 11, depending on the current region.

