

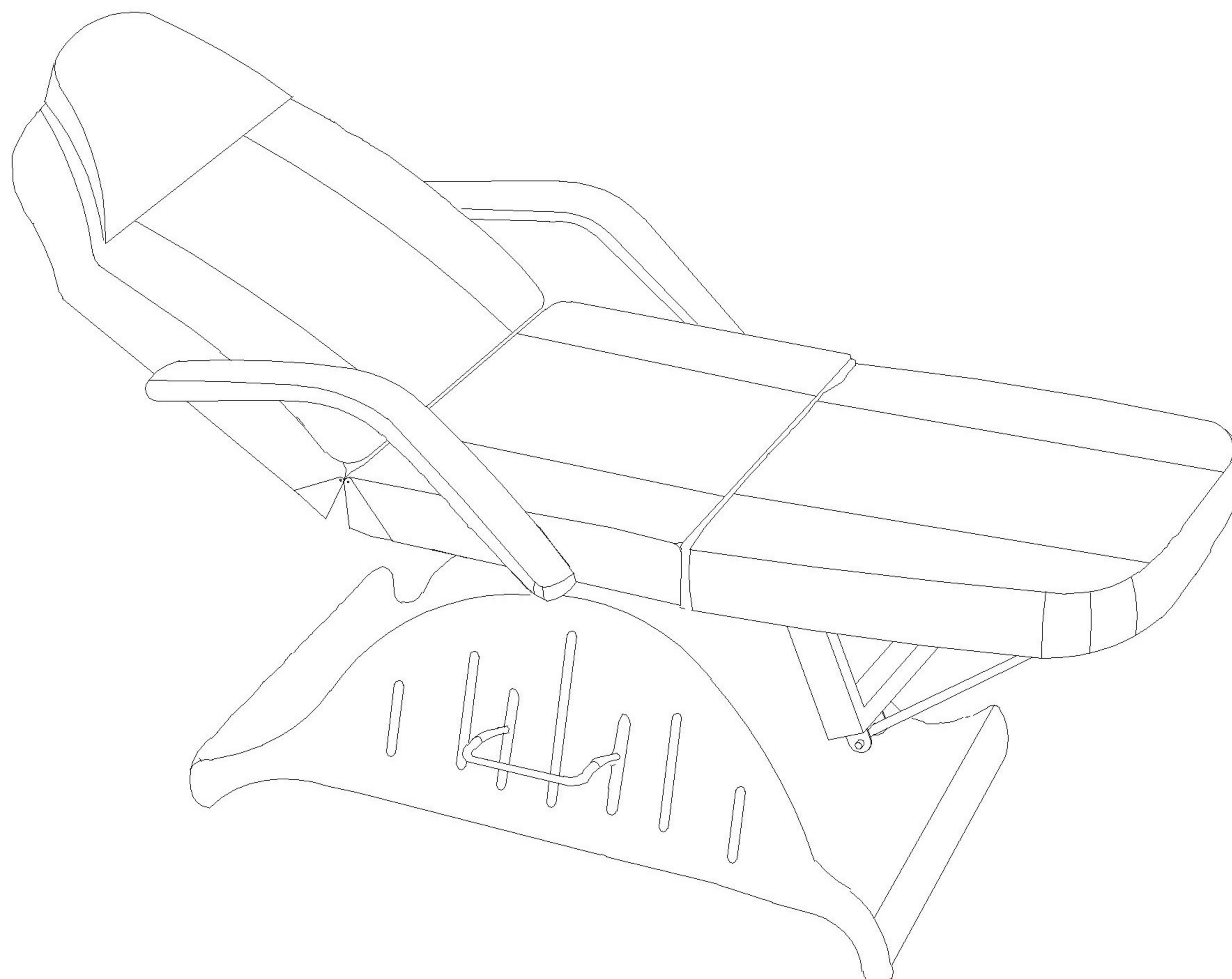

1-800-477-6655
buyritebeauty.com

SHEILA HYDRAULIC BED
SY-8003A
INSTRUCTION MANUAL



List of Parts & Tools

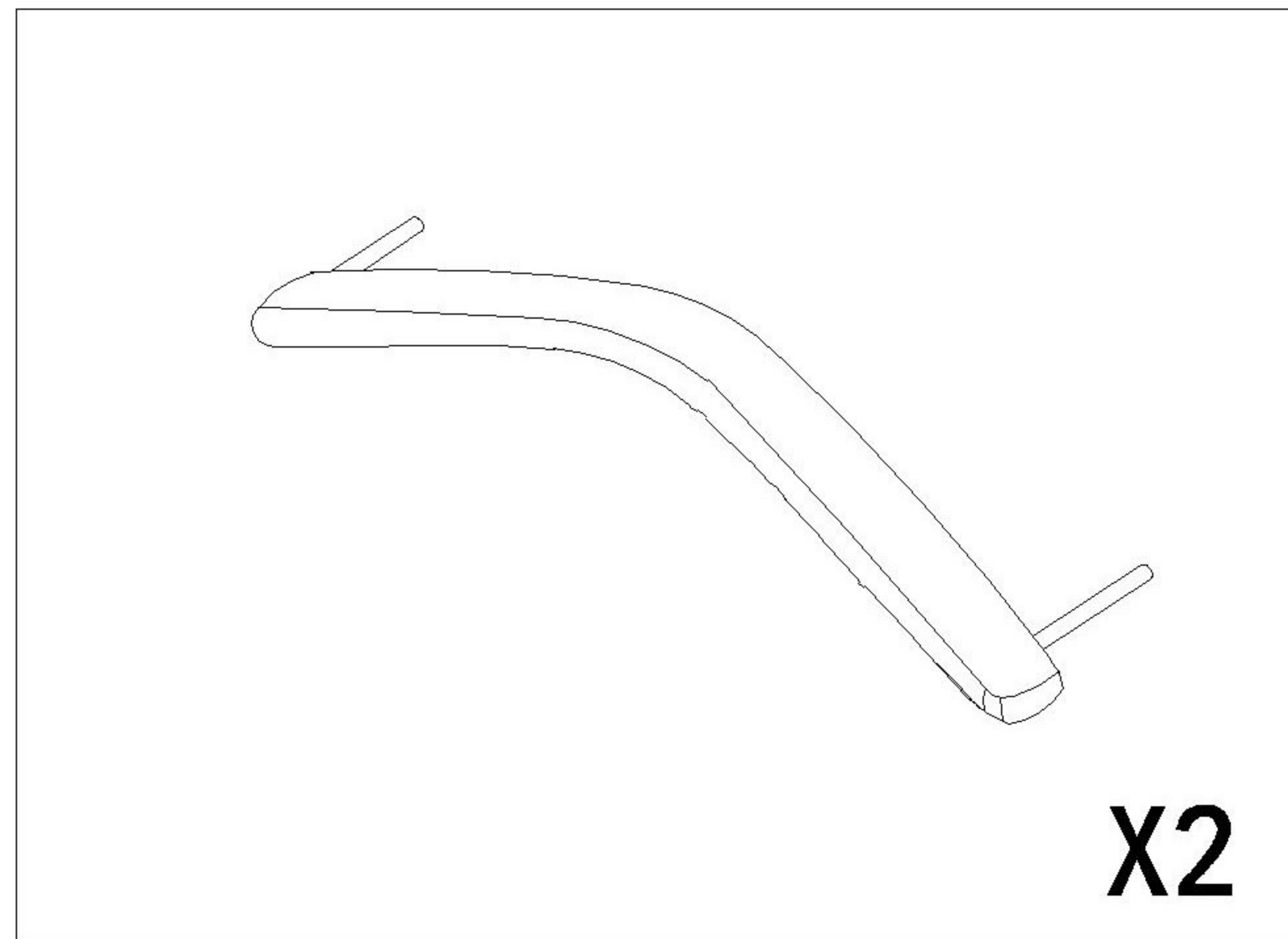

Armrest

X2



X1

Hydraulic Bed

Step 1

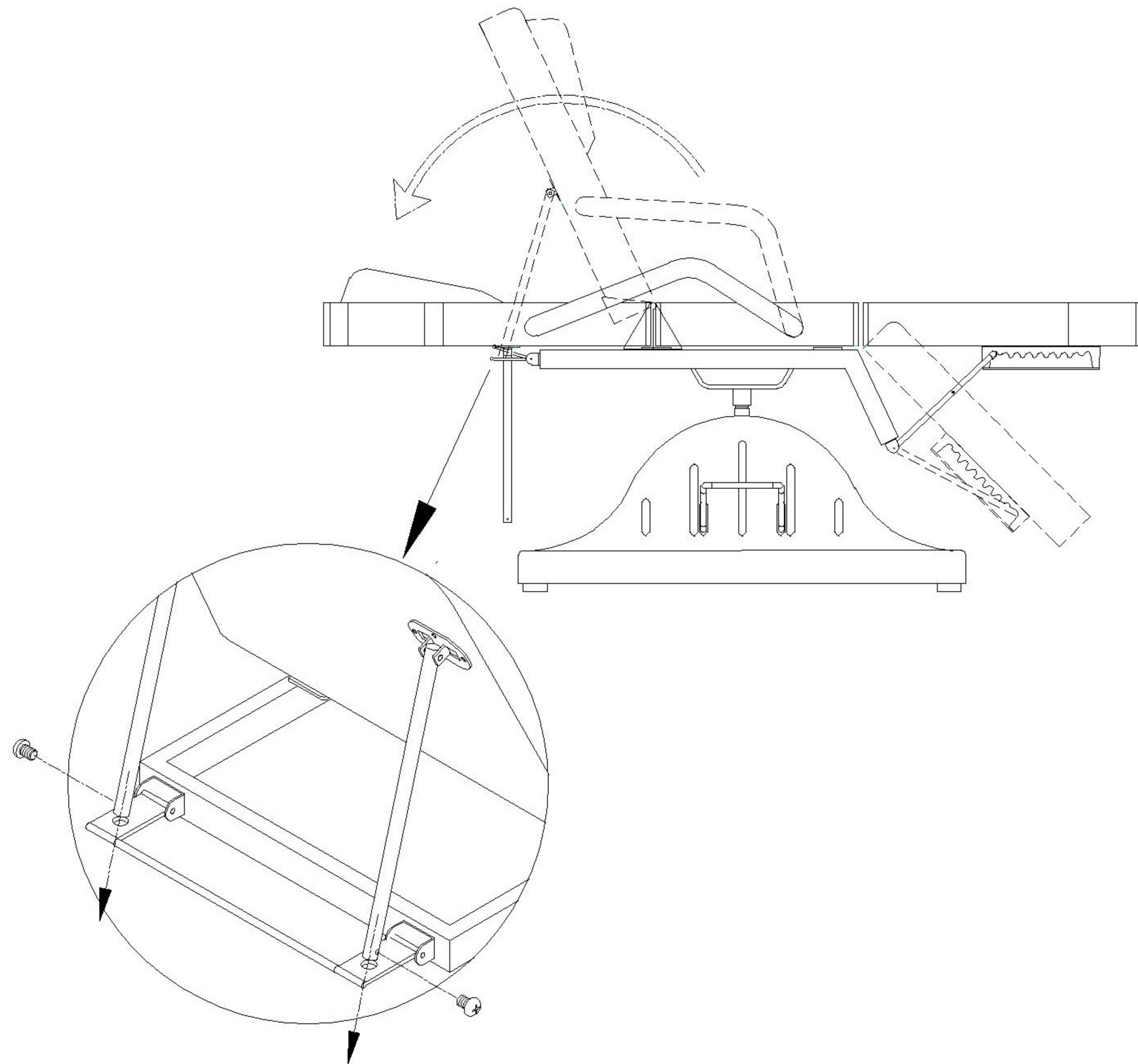

1. Carefully remove the bed frame from the carton and place it on a flat, stable surface.
2. Locate the backrest cushion adjusting rods that are attached to the back section on the underside of the backrest and remove the screws at the end of each rod.
3. As shown above, carefully insert the adjusting rod into the guiding mechanism that is attached to the bed frame. Important: Before inserting the adjusting rod, note the position of the guiding mechanism in the diagram above. The guiding mechanism must be facing upward to ensure proper installation and functionality.
4. Once the adjusting rod has been properly inserted into the guiding mechanism, reinstall both screws into the adjusting rods and tighten securely.

Step 2

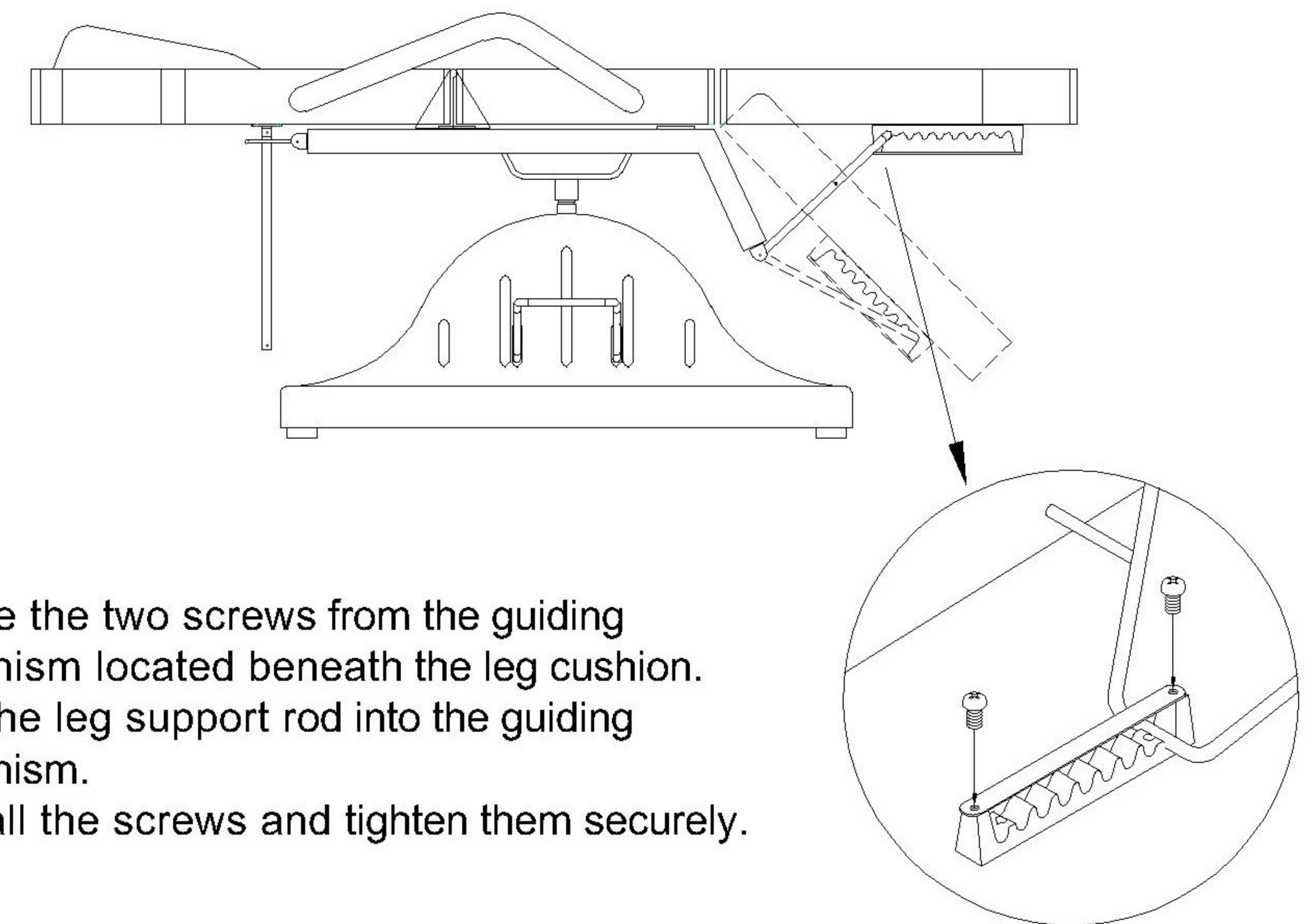

1. Remove the two screws from the guiding mechanism located beneath the leg cushion.
2. Insert the leg support rod into the guiding mechanism.
3. Reinstall the screws and tighten them securely.

Step 3

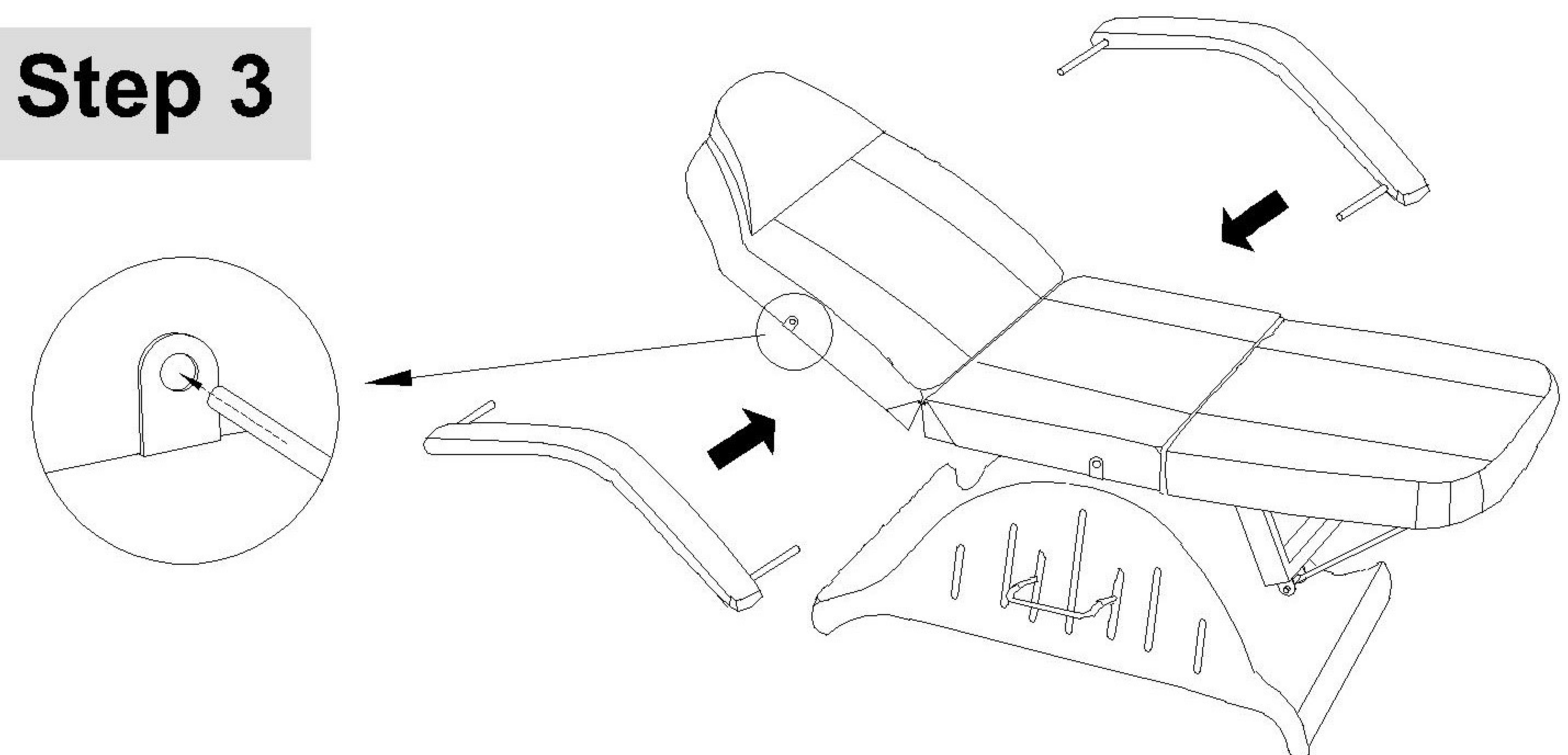

1. Align the armrest with the holes located on each side of the bed frame.
2. Slide the armrests evenly into the holes, making sure they are fully secure and level before use.

Product care



Brush away excess hair

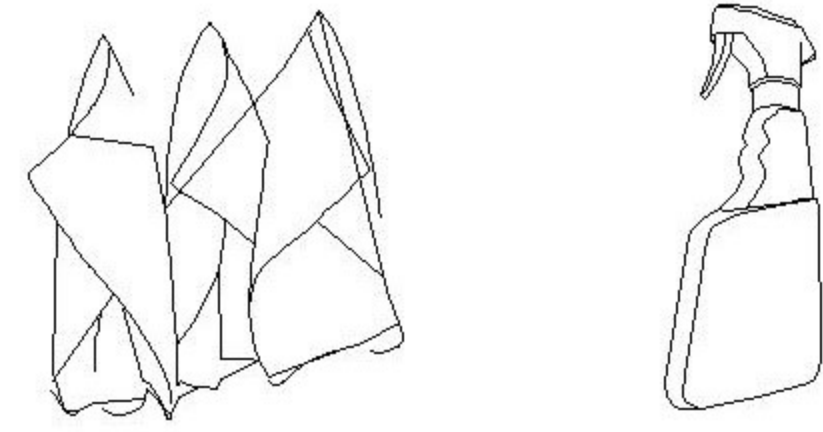

Clean surface with damp cloth or use simple soap & water solution.

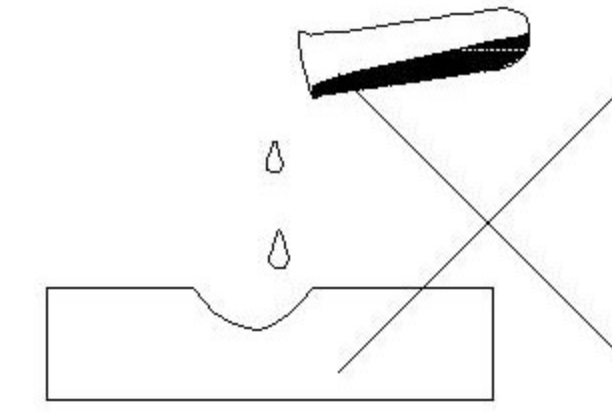

Avoid using corrosive cleaning agents such as bleaches.

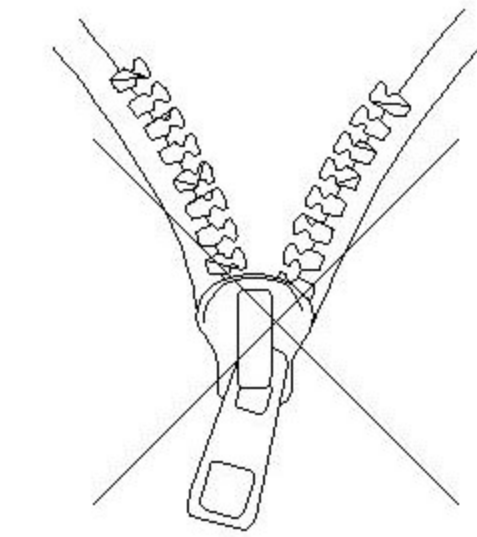

Do not remove upholstery for cleaning

Product Information

1. Enjoy your new bed!
2. After assembly and before use, we suggest pumping the hydraulic to full height and back down several times to prime the hydraulic fluid. This will keep the pump smooth and responsive.
3. Note that short quick pumping is more effective for adjustments than pressing the lever all the way down each time.
4. If you have any questions or concerns, please contact our customer experience team at 912-335-4445.