

# **morphy richards®**

**Smart Ideas for Your Life**

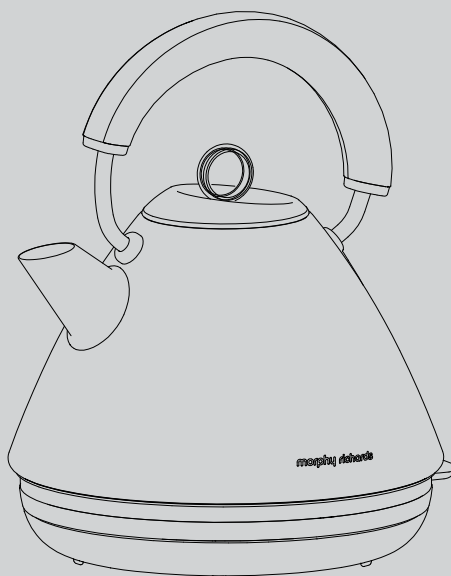

## **Ascend 1.5L Pyramid Kettle**



**Models: MRSGK15B / MRAK5WT**

**Read these instructions carefully before  
using this appliance for the first time**

For product hints and tips plus more join us at

[\*\*www.morphyrichards.com.au\*\*](http://www.morphyrichards.com.au)



facebook.com/MorphyRichardsAUS



instagram.com/morphyrichardsau

## IMPORTANT SAFETY INSTRUCTIONS

To reduce the risk of fire, electric shock, injury to persons or damage to property, follow basic precautions including the following:

**WARNING:** Avoid spillage on the connector.

**WARNING:** Misuse can lead to injury.

**WARNING:** Heating element surface is subject to residual heat after use.

**WARNING:** Do not operate kettle on an inclined plane.

**WARNING:** Do not move kettle while in use.

- This appliance is not intended for use by persons (including children) with reduced physical, sensory or mental capabilities, or lack of experience and knowledge, unless they have been given supervision or instruction concerning use of the appliance by a person responsible for their safety.
- Children should be supervised to ensure that they do not play with the appliance.
- Cleaning and user maintenance shall not done by children.
- Keep the appliance and its cord out of reach of children.
- This appliance is intended to be used in household and similar applications such as: farm houses; by clients in hotels, motels and other residential type environments; bed and breakfast type environments. It is not suitable for use in staff kitchen areas in shops, offices and other working environments.

### Location

**WARNING:** Do not place the appliance on a metal tray or metal surface while in use.

- Always locate your appliance away from the edge of a worktop.
- Do not use the appliance outdoors or near water.
- Ensure that the appliance is used on a firm, flat surface.

## IMPORTANT SAFETY INSTRUCTIONS

### Power cable

- Do not let the power cable hang over the edge of a worktop where a child could reach it.
- Do not let the power cable run across an open space e.g. between a low socket and a table.
- Do not let the power cable run across a cooker or other hot area which might damage the cable.
- The power cable should reach from the socket to the base unit without straining the connections.
- If the power cable is damaged, it must be replaced by the manufacturer, its service agent or similarly qualified person in order to avoid a hazard.
- It is recommended to not use this appliance with extension leads and/or power boards.

### Personal safety

- **WARNING:** To protect against fire, electric shock and personal injury do not immerse cord, plug and appliance in water or any other liquid.
- **WARNING:** Do not open the lid whilst the water is boiling.
- Always keep the top of the cordless base dry, especially around the connection area, disconnect the power supply before drying. Allow to dry thoroughly before reconnection to the power supply.
- Do not fill above the MAX mark, otherwise boiling water may be ejected.
- Always pour hot water slowly and carefully without tipping the appliance too fast to prevent splashing and spillage.
- Do not hold the switch in the on position or tamper with the switch to fix it in the on position as this may cause damage to the switch-off mechanism.
- Unplug from the outlet before cleaning.
- Allow to cool before putting on or taking off parts and cleaning.
- Do not move the kettle while switched on.

## IMPORTANT SAFETY INSTRUCTIONS

### Other safety considerations

- **WARNING:** The appliance must not be immersed for cleaning.
- **WARNING:** To prevent damage to the appliance, do not use alkaline cleaning agents when cleaning. Use a soft cloth and detergent.
- The use of attachments or tools not recommended or sold by Morphy Richards, may cause fire, electric shock or injury.
- The kettle is only to be used with the stand provided.
- Do not use the appliance for any use other than to boil water.
- Do not place the appliance on or near a hot gas or electric burner or in a heated oven.
- The appliance must not be on the base unit when being filled with water.
- Unplug from the outlet when not in use.

### Electrical requirements

- Check that the voltage on the rating label of your appliance corresponds with your house electricity supply which must be A.C. (Alternating Current).

### Treating scalds

- Run cold water over the affected area immediately. Do not stop to remove clothing, seek medical advice quickly.

## READ CAREFULLY AND KEEP FOR FUTURE REFERENCE

SPECIFICATIONS

Model:	MRSGK15B	MRAK5WT
Colour:	Satin Black	White
Rated Voltage & Frequency:	220-240V~ 50-60Hz	
Rated Power:	1850-2200W	
Max Capacity:	1.5L	
External Dimensions (L x W x H):	221 x 235 x 277mm	
Net Weight:	1.42 Kg	

PRODUCT OVERVIEW

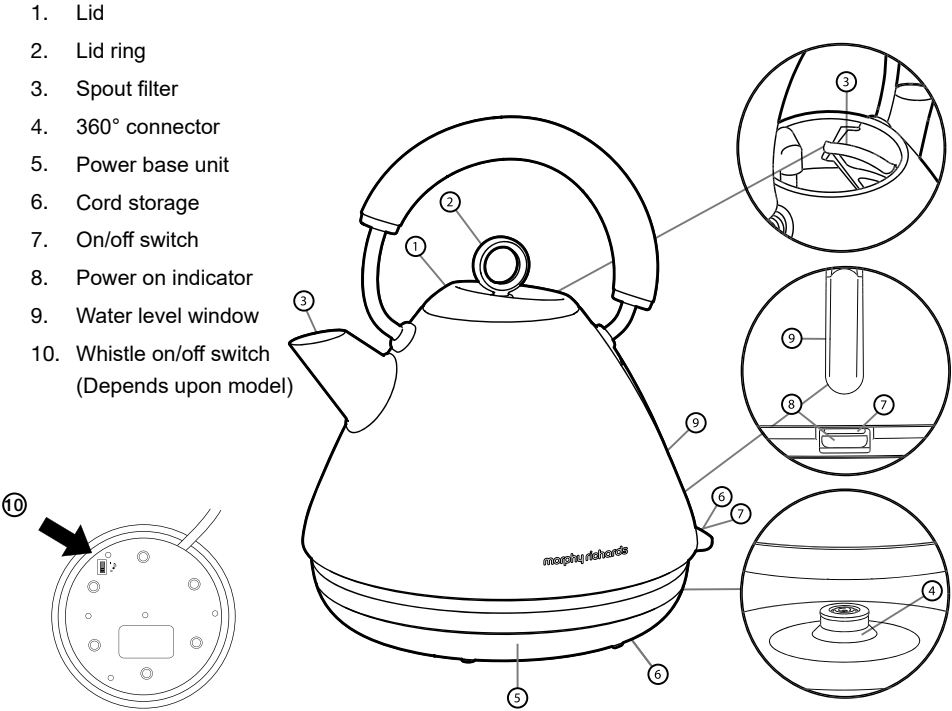

## BEFORE FIRST USE

1. Remove all packaging materials.
2. Check that all accessories are complete and the appliance is not damaged.
3. Clean all parts to remove any dust or manufacturing residue.
4. If you are using the kettle for the first time, it is recommended that you should clean your kettle before use by boiling the Max capacity of water and then discarding the water twice. Wipe the surface with a damp cloth.

**NOTE:** The maximum capacity of this kettle is 1.5L.

## REMOVING THE FILTER

1. Open the kettle lid by pulling the ring up.
2. Locate and lift the filter upwards from its holder. See drawing on page 5.
3. To refit the filter, slide it into the side wall guides of the filter holder until it clicks into place.

**WARNING:** Unless the filter is fitted correctly, the kettle lid may not close and lock securely.

## USING THE KETTLE

1. Wherever possible, fill through the spout, as this helps to free the filter from limescale build-up. The integrated water level indicator allows you to easily see the amount of water in the kettle. Always ensure that the level of water in the kettle is filled to at least the minimum level shown on the water gauge.

## USING THE KETTLE

2. Place the kettle on the base unit, ensuring the kettle locates on to the 360° connector. The 360° connector allows the kettle to be located at any position. Ideal for left and right handed users and for convenient positioning on the worktop.
3. Plug in and switch on at the wall socket.
4. Switch the kettle on. The 'power on' light will illuminate.
5. Fast boil kettles perform differently, if your kettle is a fast boil model, it may sound louder during boiling, and switch off suddenly with no after noise - this is normal.
6. When the water boils the kettle will switch off automatically. If you are using the kettle for the first time, pour away the boiled water and refill.
7. Lift the kettle from the base unit by the handle ensuring you hold the kettle level. To re-boil, switch ON again. If the kettle has just switched off wait a minute or two before switching it back on again. If you do not put in enough water, or switch on the kettle when it is empty, the safety cut-out will switch off the power automatically. If this happens, refill and wait a few minutes for the element to cool, then use as normal.

## WHISTLE FUNCTION

**NOTE:** The kettle power base is fitted with a switch that can turn the whistle function on or off as desired. When activated, when the kettle boils, the base will sound a whistle. Refer to page 5.

## DECALCIFICATION

**NOTE:** Minerals like calcium and limestone can be found in water and may leave deposits in the appliance and can affect its performance. De-calcifying the appliance is an important part of ensuring your drinks always tastes great! We recommend de-calcifying the appliance periodically to keep it at peak performance following the steps below or using a commercially available descaler and follow the instructions on the package.

1. Fill the kettle with 3 cups of white vinegar, then add water to cover the bottom of the kettle completely.
2. Leave the solution in the kettle overnight.
3. Discard the mixture in the kettle, and fill the kettle with clean water to the maximum position, boil and discard the water.
4. Repeat several times until the odour of vinegar has been removed. Any stains remaining inside the spout can be removed by rubbing with a damp cloth.

**IMPORTANT:** Ensure that the electrical connections are completely dry before using the kettle.

## CLEANING

**WARNING:** Always disconnect the plug from the mains and allow the kettle to cool before cleaning.

**CAUTION:** To prevent damage to the appliance do not use alkaline cleaning agents when cleaning, use a soft cloth and a mild detergent.

- Wipe the outside with a damp cloth.

**IMPORTANT:** Do not use abrasive cleaners on the outside of the kettle which may scratch the surface.



## MAINTENANCE

If the unit fails to operate efficiently, is broken or other problems arise, unplug and do not operate.

Ask for advice by calling your local after sales service agent or the Customer Care Centre on 1300 556 816 (AU) / 0800 666 2824 (NZ).

## REGISTER YOUR PRODUCT

By having your product registered on the Morphy Richards customer portal, your details can be accessed quickly in the event that there is an issue with your product. Make it quick and easy to get the help you need, if you ever need it.



## WARRANTY

Please refer to the warranty card in the box for warranty information. For any troubleshooting advice, please contact the relative Customer Care Centre below.

Glen Dimplex Australia Pty Ltd  
8 Lakeview Drive,  
Scoresby 3179, Victoria  
Australia  
Ph: 1300 556 816

Glen Dimplex New Zealand Ltd  
38 Harris Road, East Tamaki,  
Auckland 2013  
New Zealand  
Ph: 0800 666 2824

## NOTES

[illegible]

## NOTES

[illegible]



Recycling: Do not dispose of electrical appliances as unsorted municipal waste. Use separate collection facilities. Contact your local government for information regarding the collection systems available. If electrical appliances are disposed of in landfills or dumps, hazardous substances can leak into the ground water, polluting the food chain and damaging health and wellbeing.

Expanded Polystyrene Disposal: The websites listed below can assist in the responsible disposal of EPS (Expanded Polystyrene) packaging products.

Australia: <https://recyclingnearyou.com.au/polystyrene> and/or <http://epsa.org.au>

New Zealand: <https://greenbusinesshq.com/epsrecycling> and/or

<https://www.plastics.org.nz/environment/recycling-disposal/eps-recycling>

**morphy richards**

Glen Dimplex Australia Pty Ltd

8 Lakeview Drive

Scoresby VIC 3179

Phone: 1300 556 816

Email: [seasonal.support@glendimplex.com.au](mailto:seasonal.support@glendimplex.com.au)

Web: [www.morphyrichards.com.au](http://www.morphyrichards.com.au)

© Glen Dimplex Australia. All rights reserved. Material contained in this publication may not be reproduced in whole or in part, without prior permission in writing of Glen Dimplex Australia.

MRAK5xx\_IM\_v3