

Use & care manual

---

# FOOT LEG MASSAGER

SL-K68



 **SNAILAX<sup>®</sup>**



## Safety Instructions



**Please read the following instructions carefully before putting your massage device into use to ensure trouble-free operation and optimum efficiency. Please retain these instructions for further reference!**

- The device conforms to recognized technical principles and the latest safety regulations.
- This item is NOT A TOY. Close supervision is necessary when this appliance is used by, on, or near children or disabled persons. Do not allow children to play with product.
- Do not allow more than one person to use this product at a time.
- The device should never be left unattended when plugged in.
- Never use any power sources other than UL standard home adapter provided as original equipment with this massage device.
- Any possible repairs may only be carried out by authorized expert staff. Improper use and unauthorized repairs are not permitted for safety reasons and lead to loss of warranty.
- Please avoid contact of the device with water, high temperatures and direct sunlight.
- Do not damage, process, excessively bend, pull hard, twist or knot power cord.
- Do not use any damaged cables, plugs or loose sockets.
- Do not use the product when the power cord is damaged.
- In case of malfunction, disconnect immediately from the mains.
- Misuse or incorrect use excludes any liability for damage.
- Do not use while you sleep.
- In order to avoid excessively stimulating the muscles and nerves, the recommended massage time should not be exceeded 15 minutes at a time.
- Do not use this product for medical treatment.
- People who are insensitive to heat must be accompanied by normal person when using this massage device.
- During use, if you feel abnormal, please stop using this product immediately, and then consult your doctor.



**We recommend that those with any of the following conditions consult a doctor before using this massage device.**

1. Those who are using electronic medical instrument imbedded in the body, such as cardiac, pacemaker etc.
2. Those who are being treated by doctors, especially those who feel uncomfortable.
3. Those who are malignant tumor patients, heart disease patients, acute patients.
4. Women who are pregnant or menstruating.
5. Those with osteoporosis or fracture spine.
6. Those with skin disease or those whose skins are injured.
7. Those whose body temperature is over 38 degrees (Febrile Phase).

Failure to observe the above instructions may constitute misuse of the product and can cause serious injury or burns.

## Instruction

Thank you for purchasing Snailax foot leg Massager.  
With normal care and proper treatment, it will provide years of reliable service.

**Please read all instructions carefully before using this product.**

**Please retain this manual for future reference.**

### FEATURES

- 2 In 1 foot leg massager or heated ottoman seat
- shiatsu,compression and heating massage for legs and feet
- 3 massage modes
- 3 levels of pressure intensity
- 3 speeds of kneading/vibration functions
- 2 heat settings
- Detachable and washable foot sleeves

### CONTENTS



### TECHNICAL DATA

<b>Measurements:</b>	16.7x14.7x28.5 inches (Closed)
<b>Weight:</b>	17.96 lbs
<b>Voltage:</b>	Input: AC 100-240V ~50/60Hz Output: 24VDC 2500MA
<b>Nominal Power:</b>	max. 53Watt
<b>Automatic runtime:</b>	15 minutes

## Setup and Operation

1. Please put the product on the flat floor.
2. Connect the adapter cable to the corresponding port on the foot massager.



3. Plug the home adapter into electrical outlet ( the adapter is safe to use with both 110-120V & 220-240V )

## How to use your massager



Opt.1 Warm ottoman seat



Opt.2 Foot and leg massager

### Opt.1 Used as an Ottoman seat

- 1) After power on, press the 'Heat' key to turn on the heating function to get a comfortable heated ottoman seat or footrest. Continuously press the 'Heat' key to choose Low/High heat level or turn off the heat.
- or 2) Unplug the adapter, use it as a non-electric ottoman, an extra seating or a footrest.

### Opt.2 Used as a foot and let massager

- 1) Open the product and use it as a foot leg massager



## How to use your massager

2) Adjust the support bar at the bottom of the product to your desired massage angle.

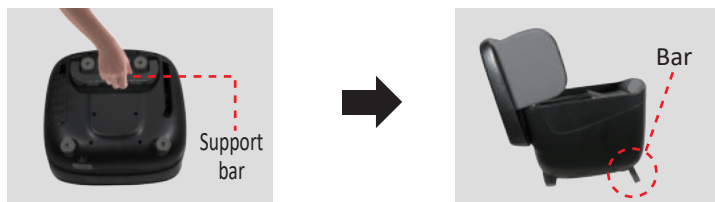

3) Please choose a chair with desired height and be seated, then put your feet in the massager.

4) Turn on the massage device through operating control panel (See below instruction)

• **NOTE:** Do not setup or use the device in a bathroom or similiary wet / damp areas.

## Operation

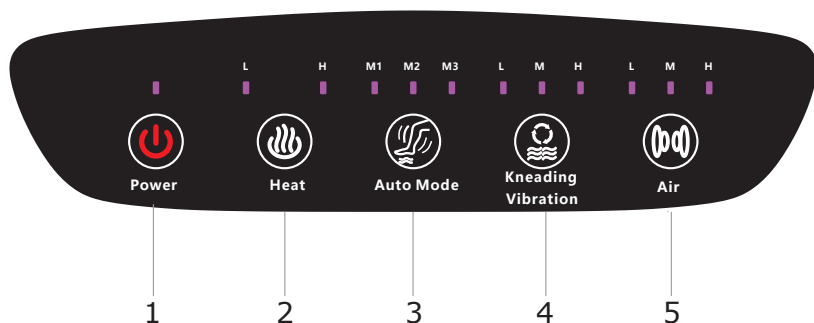

### 1.Power Key

After power on,the indicator flashes and the machine is in standby state,press this key to turn on the massager.

When the machine is working, press this key to turn off all functions.

### 2.Heat key

After power on, press this key to turn on the heat function, Continuously press to cycle through Low/High heat level or Off setting. The corresponding indicator L / H will light up.

### 3.Auto Mode Key

After power on, press the key to activate the full-intelligent massage modes. Continuously press to cycle through M1 to M3 or Off setting.

Mode 1- M1 light is on (Combination of compression, Shiatsu kneading and Vibration )

Mode 2- M2 light is on (Compression massage works primarily, Shiatsu kneading and Vibration functions work intermittently)

Mode 3- M3 light is on (Kneading & Vibration massage work primarily, Compression function works intermittently )

### 4.Kneading & Vibration Key

After power on, press the key to activate Kneading & Vibration massage function, continuously press to cycle through Low, Medium, High speed or Off setting. The corresponding indicator will light up.

### 5.Air key

After power on, press the key to activate the Compression massage function, continuously press to cycle through Low/Medium/High Level of intensity or Off setting. The corresponding indicator will light up.

- This device will switch off automatically after 15 minutes timer run out.

## Attention !!!

- a) After power on, the Compression, Heat, Kneading & Vibration can be freely customized.
- b) 'Auto Mode', 'Kneading/Vibration' and 'Air' Compression are only available when the machine is opened to be used as a foot and leg massager.
- c) Used as an ottoman seat, only heating is available.

## Cleaning & Maintenance Instructions

- Before cleaning, make sure the power supply is turned off and the plug has been pulled out from the socket.
- It is forbidden to dip the whole product in water or other liquid when cleaning.
- Use a soft cloth to wipe the surface of the product and control panel.
- Use a piece of cloth that has been dipped with cleaning agents to wipe the main unit of the foot Massager, and then use a piece of dry and soft cloth to wipe it.
- Do not pull the power plug by damp hands.
- Do not use water washing product, do not spray the water or other liquids to the interior of the product.
- Do not use corrosive cleaning agents like benzene or thinner to clean the Foot Massager, otherwise, the color of upholstery will fade or the Foot Massager will crack or be eroded.
- Do not iron the upholstery.
- When product is wet, let the product dry naturally and thoroughly.

### Removable & Washable Cover

- Detach the cover and wash in machine or by hand. Allow to air dry

### Maintenance

- Make sure the power supply is turned off and the plug has been pulled out from the socket.
- Sweep off the dust. Keep the foot massager clean and away from damp places.
- Store the massager in a cool, dry place out of reach of children.
- Avoid contact with sharp edges or pointed objects which might cut or puncture the cover of massager.

## TROUBLESHOOTING GUIDE

Fault	Solutions
There is a clattering noise in the movement	This is perfectly normal caused by the working of product. It is normal status.
The massage device switches off suddenly	Device may have been in use for 15 minutes. Auto-shut off function activated. Continue using by pressing the 'power' button after resting the unit for 15 minutes.
The massage device fails to start	Check if device has been used for more than 15 mins. If so, let device rest for 15 mins before continuing. Device may require longer time to cool in warmer environments.
	Check if adapter is plugged into socket.
	Check if adapter output is connected to device power inlet.



## Warranty

If you have any issue about the product, please feel free to contact us by sending email to support@snailax.com We will strive to provide the best service possible within 24 hours.

### **30 days unconditionally Return**

Snailax product can be returned to receive a full refund for any reason within 30 days. Please contact our customers service (support@snailax.com), our staff will contact you within 24 hours.

### **90 days refund/replace**

Snailax product can be returned / replaced within 90 days if the product break down in the period of proper use.

### **12 months Warranty**

If the product break down within 12 months in the period of proper use, customers can enjoy the relevant warranty to get them replaced.

### **Attention!**

No warranty will be given to any force majeure and man-made causes to a defective product, such as improper care, personal tear down and willful damage,etc.

## **Extend Warranty for Free**

- 1) Enter the following URL or scan the QR code below to find Snailax facebook page and like it, enter“Warranty” to messenger to extend your warranty from 1 year to 3 years.



<https://www.facebook.com/snailax>

- OR 2) Send message“Warranty” and email us support@snailax.com to extend your warranty from 1 year to 3 years.

## ***Have question ?***

**Tel:** 734-709-6982

Monday-Friday 9:00AM-4:30PM

**Email:** support@snailax.com

# FCC STATEMENT

NOTE: This equipment has been tested and found to comply with the limits for a Class B digital device, pursuant to Part 15 of the FCC Rules. These limits are designed to provide reasonable protection against harmful interference in a residential installation. This equipment generates, uses and can radiate radio frequency energy and, if not installed and used in accordance with the instructions, may cause harmful interference to radio communications. However, there is no guarantee that interference will not occur in a particular installation. If this equipment does cause harmful interference to radio or television reception, which can be determined by turning the equipment off and on, the user is encouraged to try to correct the interference by one or more of the following measures:

- Reorient or relocate the receiving antenna.
  - Increase the separation between the equipment and receiver.
  - Connect the equipment into an outlet on a circuit different from that to which the receiver is connected.
  - Consult the dealer or an experienced radio / TV technician for help.
- This device complies with Part 15 of the FCC Rules. Operation is subject to the following two conditions: (1) this device may not cause harmful interference, and (2) this device must accept any interference received, including interference that may cause undesired operation.

WARNING: Changes or modifications to this unit is not expressly approved by the party responsible for compliance could void the user's authority to operate the equipment.





2750 Carpenter Road,  
Suite 1 B, Ann Arbor, 48108  
Tel: 734-709-6982  
[support@snailax.com](mailto:support@snailax.com)  
[www.snailax.com](http://www.snailax.com)