

HOUSE OF
DURATECH
innovative pool products

Manual

DLD20 LinkDongle™



14-12-21

HEAT Accessories

Table of contents

Technical specifications.....Page 3

Box contents.....Page 3

About the DLD20 LinkDongle™Page 3

Installation instructions.....Page 4

Control functions.....Page 9

Safety information.....Page 9

Environment / disposal of old equipment.....Page 10

Service & warranty.....Page 10

Regulatory compliance.....Page 10

Technical specifications

General Specifications	DLD20 LinkDongle™
Input voltage	230 VAC
Interface	LoRa 865,75MHz
Ambient air temperature	-10°C to +40°C
Humidity	10% to 90% RH - non condensing
Ingress protection rate	IP54
Size	Height: 107mm Width: 65mm Depth: 20mm
Weight	90g

Box contents

Manual

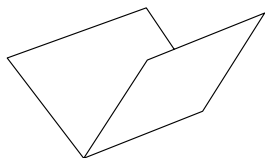

DLD20 LinkDongle™

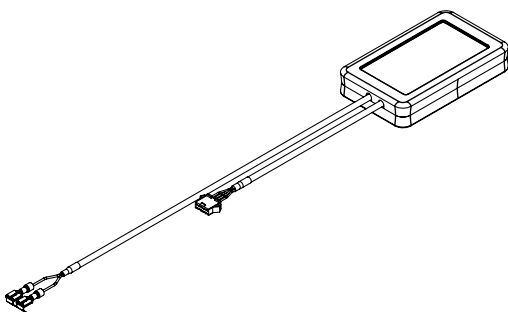

About the DLD20 LinkDongle™

The DLD20 LinkDongle™ is an RF module for connecting and controlling the existing Dura Pro or DURA+i heat pumps wirelessly with the LinkTouch™. The DLD20LinkDongle™ must be connected to the existing electronic circuit of the Dura Pro or DURA+i heat pump.

Installation instructions



Power off the heat pump and disconnect from mains (230 VAC), prior to the installation of the LinkDongle™

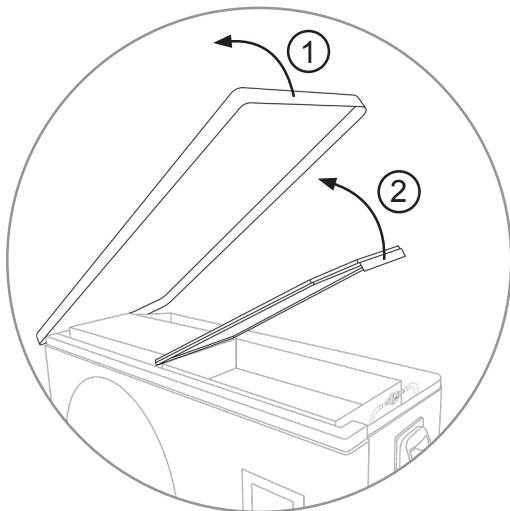

1. Open the top lid*

2. Open the electronics lid*



3. Find the RS485 cable.

It has a black connector and white, yellow, red & black wires.

It is marked with yellow tape

* Picture shown is for illustration purposes only. Actual product may vary (DURA PRO & DURA+i)

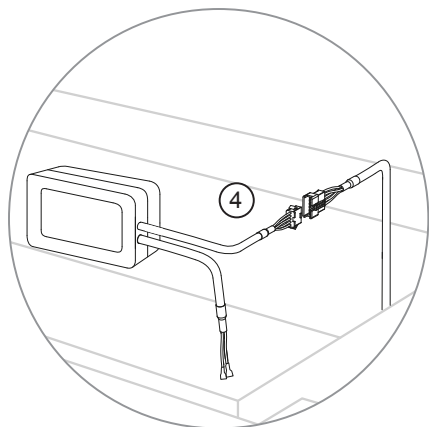

4. Connect RS-485 cable from the heatpump to the DLD20

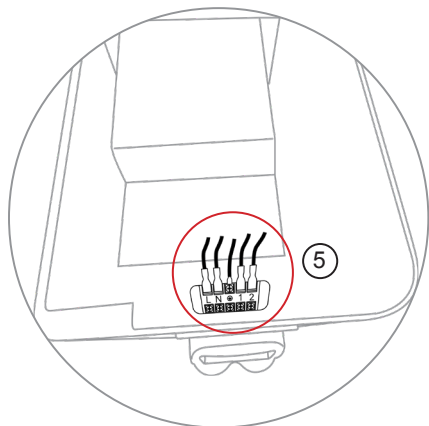

5. Find the terminal block (the power supply to the heatpump)

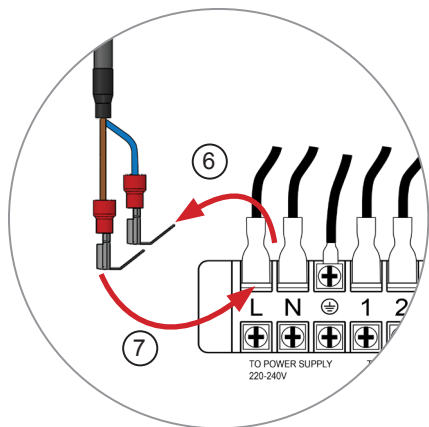

6. Remove the original spade connectors from the L and N terminals, and put them on the piggyback connectors of the DLD20.
Brown = L
Blue = N
7. Put the assembled piggyback connectors back on the terminal block

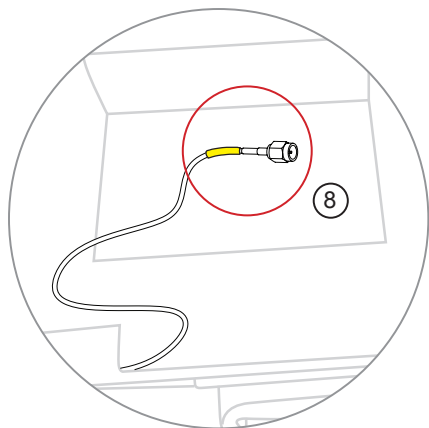

8. Find the SMA antenna connector (inside the electronics compartment of the heatpump. It will be marked with yellow tape)

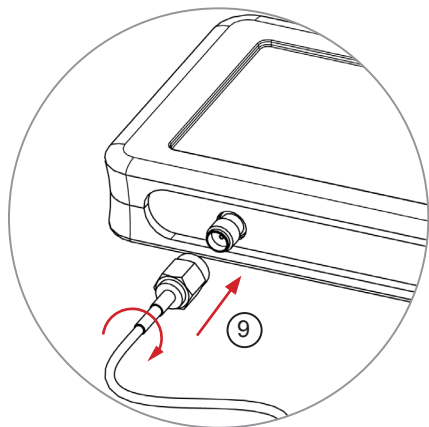

9. Connect the SMA antenna connector with the DLD20

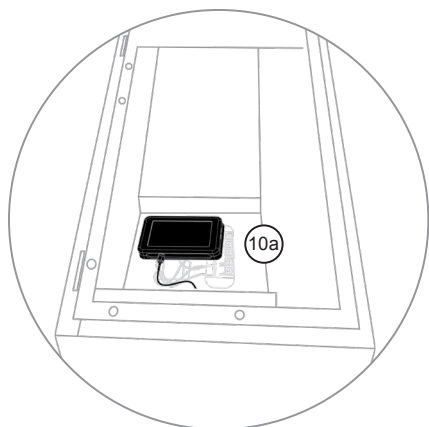

10. Install the DLD20 in the electronics compartment of the heatpump. Make sure none of the connected cables are bent or damaged

Location depending on type of heatpump:

- 10a. **DURA+i:**
In the middle of the electronics compartment. You can use cable ties to secure it in place

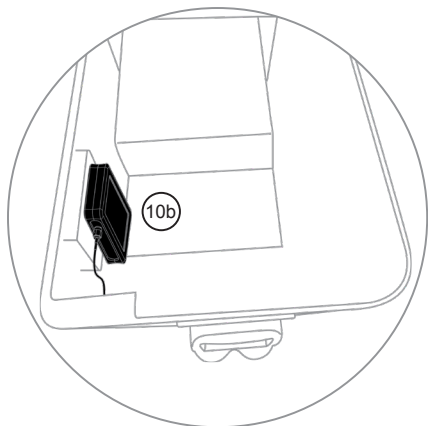

10b. DURAPRO-12, -17, -21:

Tape the DLD20 to the back of the display housing.

(Remove the adhesive liner from the back of the DLD20)

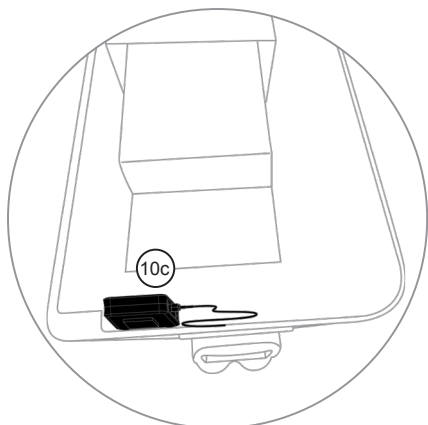

10c. DURAPRO-25S, -28TS

Tape the DLD20 to the metal housing of the heatpump.

(Remove the adhesive liner from the back of the DLD20)

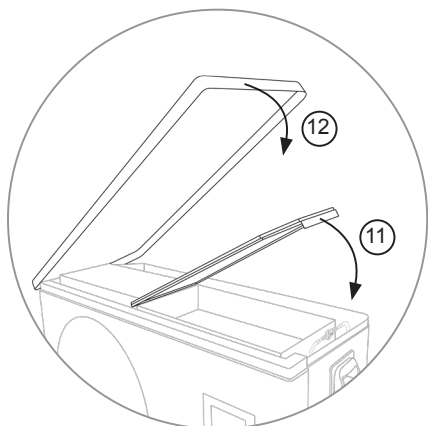

11. Reassemble the electronics lid*

12. Reassemble the top lid*

* Picture shown is for illustration purposes only. Actual product may vary (DURA PRO & DURA+i)

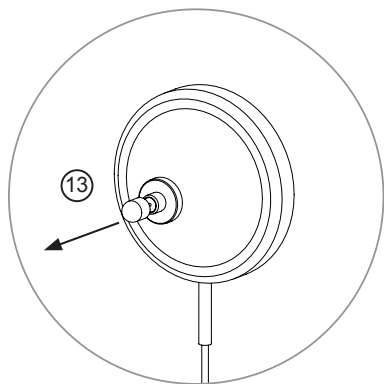

13. Remove the plastic protection cap from the antenna base

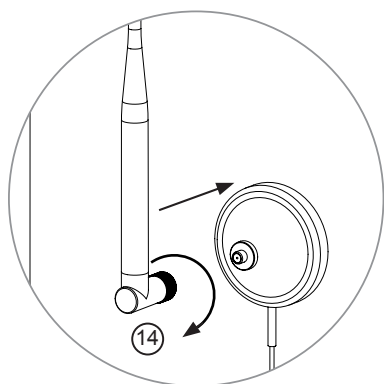

14. Screw the antenna onto the antenna base.

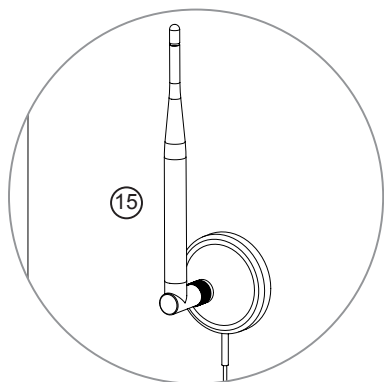

15. Make sure the antenna is pointing up



Reconnect the heat pump to mains (230VAC) and power on
after installing the DLD20 LinkDongle™



Control functions

See LinkTouch™ for further information on how to pair with the heat pump after installing the DLD20 LinkDongle™.

Safety information

Intended use

This device has been developed as an RF connecting device for Dura Pro and DURA+i heat pumps and is operated with the LinkTouch™ or controlled by the LinkMaster™.

Precautions for setup

- The DLD20 LinkDongle™ should only be installed and connected as described in this manual.
- Protect the cables from being strained, pinched or bucked.
- Use only the original cables from the heat pump and DLD20 LinkDongle™ to do the installation.
- Do not use the cables if damaged or frayed. In case of damage, contact an authorised technician for repair.
- The DLD20 LinkDongle™ contains no serviceable parts. Do not attempt to service the DLD20 LinkDongle™ yourself. Repair service should be performed by an authorised technician.

Environment / Disposal of old equipment

This symbol of a crossed out waste bin on a product, its packaging and/or accompanying documents means that the product is subject to the European Directive 2002/96/EC as well as national law for implementation of the directive. Directive and law prescribe that electrical and electronic products must not be disposed of with household waste. The customer must dispose of the product by delivering it to a designated station for collection, treatment and recycling of waste electrical and electronic equipment. The correct disposal of your old appliance is free of charge and will help prevent potential negative consequences of the environment and human health.

For more information about disposing your old appliance, contact your city office, waste disposal service, or the shop where you purchased the product.



Service & warranty

If you need service or information or if you have a problem, please contact your local dealer. If needed they will contact the manufacturer to solve your problem.

They are gladly willing to assist you!

You can find more information at www.duratech.be

We warrant all parts to be free from manufacturing defects in materials and workmanship for a period of two years from the date of retail purchase.

This warranty is limited to the first retail purchaser and is not transferable. The liability of the manufacturer shall not exceed the repair or replacement of defective parts and does not include any costs for labour to remove and reinstall the defective part, transportation to or from the factory, and any other materials required to make the repair. This warranty does not cover failures or malfunctions resulting from the following:

1. Failure to properly install, operate or maintain the LinkDongle™ in accordance with the installation guidelines provided in this manual.
2. The workmanship of any installer of the product.
3. Abuse, alteration, accident, fire, flood, lighting, rodents, insects, negligence or acts of god.
4. Use of non-factory authorized parts or accessories in conjunction with the product.

LIMITATION OF LIABILITY

This is the only warranty given by the manufacturer, No one is authorized to make any other warranties on our behalf. This warranty is in lieu of all other warranties, expressed or implied, including but not limited to any implied warranty of fitness for a particular purpose and merchantability. We expressly disclaim and exclude any liability for consequential, incidental, indirect or punitive damages for breach of any expressed or implied warranty.

This warranty gives you specific legal rights, which may vary, by country.

WARRANTY CLAIMS

For prompt warranty consideration, contact your dealer and provide the following information: proof of purchase, model number, serial number and date of installation. The dealer will contact the manufacturer for instructions regarding the claim and determine the location of the nearest service point.

Regulatory compliance

This product uses radio equipment which fully complies with the European harmonized standards of RED (Radio Equipment Directives) 2014/53/EC.

Declarations of conformity covering this product are available for download from the House of Duratech website: www.duratech.be

HOUSE OF
DURATECH
— innovative pool products —

DURAVISION
Pool Light Products

- VISION Moonlight
- VISION Spectra
- VISION Adagio Pro
- VISION Pro
- VISION Wall Conduits
- VISION Faces Plates
- VISION Specials

DURALINK
Control Products

- LINK Driver
- LINK Touch
- LINK Controller
- LINK Master
- LINK Accessoires
- LINK Cover

DURAHEAT
Heat Pump Products

- HEAT Hot Splash
- HEAT Sun Spring
- HEAT Dura V
- HEAT Dura Vi
- HEAT Dura +i
- HEAT Dura Pro
- HEAT Accessories

DURACOVER
Pool Cover Products

- COVER Wall Duct
- COVER Cable Duct
- COVER Hanging System
- COVER Tube
- COVER Motor

DURAFLOW
Pool Flow Products

- FLOW Inverter

Contact details

Propulsion Systems bv
Dooren 72
1785 Merchtem, Belgium

Tel +32 2 461 02 53

www.duratech.be
info@propulsionsystems.be



DURAH^{HEAT}

402-0313-1



We reserve the rights to change all or part of the contents of this document without prior notice