



## V1 STEREO TURNTABLE

VPA-583

# OVERVIEW

## Top View

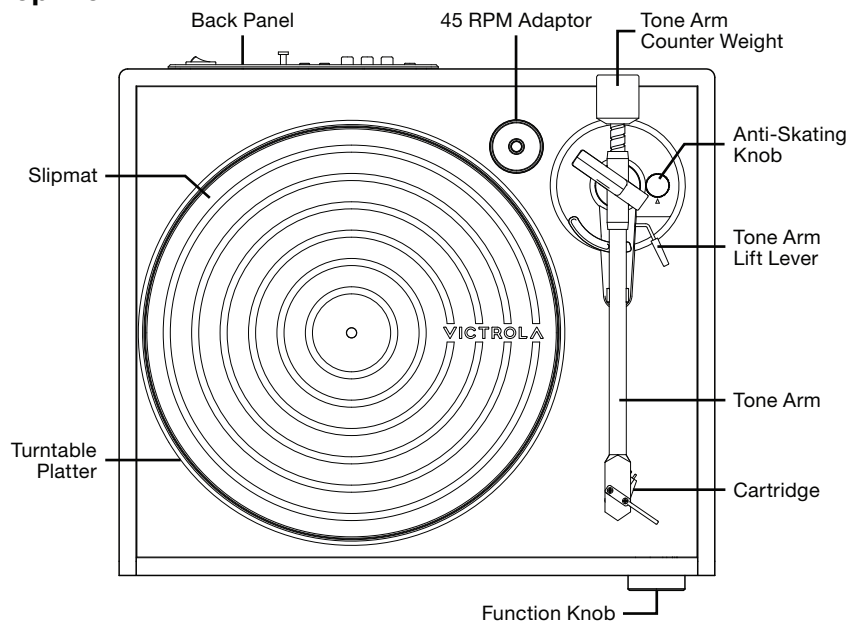

## Back View

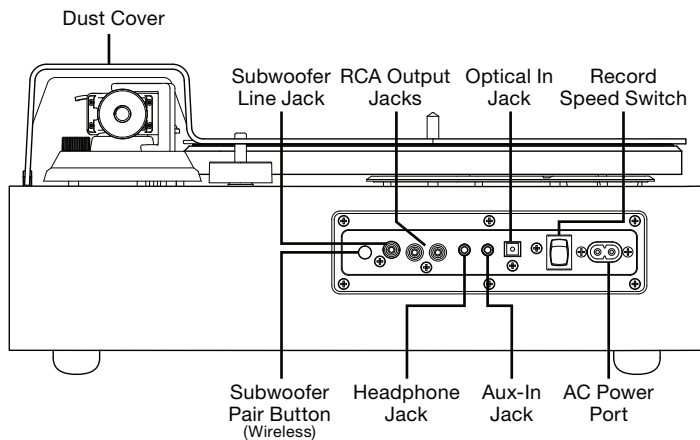

## Remote Control

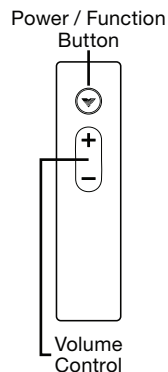

# QUICK START GUIDE

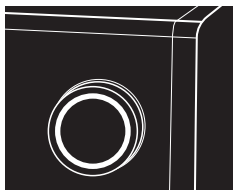



## FUNCTION KNOB - BASIC OPERATION

**POWER:** Press and hold for 1-2 seconds to turn the unit ON or OFF.  
**VOLUME:** Rotate to raise or lower volume.

## FUNCTION KNOB - TO CYCLE THROUGH FEATURES

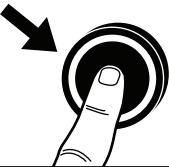
**VINYL:** Press to enter record player function mode.  
**VINYL STREAM:** Press to connect the unit to an external Bluetooth speaker.  
**BLUETOOTH:** Press to pair the unit with a Bluetooth device (smartphone).  
**OPTICAL IN (TV):** Press to play audio from a connected TV.  
**AUX-IN:** Press to play audio from a connected auxiliary device.

OPERATION	RING COLOR	FUNCTION & VOICE PROMPT
	WHITE	<b>POWER ON:</b> Press and hold for 1-2 seconds.
		<b>POWER OFF:</b> Press and hold for 1-2 seconds. <i>When powering back ON, the unit will return on the last used function mode.</i>
	WHITE	<b>Press for: VINYL PLAYING:</b> "Vinyl"
	WHITE	<b>Press for: VINYL STREAM:</b> "Vinyl Stream" "Vinyl Stream" Dial will FLASH when searching. When connected, prompt will say "Connected" & dial will turn SOLID. <i>In Vinyl Stream mode, internal speakers will be disengaged.</i>
	BLUE	<b>Press for: BLUETOOTH:</b> "Bluetooth" Dial will FLASH when searching. When connected, prompt will say "Connected" & dial will turn SOLID.
	WHITE	<b>Press for: (TV) OPTICAL IN:</b> "TV Optical"
		<b>Press for: AUXILIARY IN:</b> "Auxiliary"
	WHITE	<b>RAISE VOLUME:</b> Rotate dial CLOCKWISE. <i>Dial will brighten when in use. Unit will chime when MAX volume is reached.</i>
		<b>LOWER VOLUME:</b> Rotate dial COUNTER-CLOCKWISE. <i>Dial will brighten when in use.</i>

## REMOTE CONTROL FUNCTIONS

### POWER / FUNCTION BUTTON

**POWER ON / OFF:** Press and hold for 1-2 seconds.  
**FUNCTION CONTROL:** Quickly press to cycle through each feature.

### VOLUME CONTROL

**+** Press to raise volume.  
**-** Press to lower volume.

## REMOTE CONTROL BATTERY REPLACEMENT

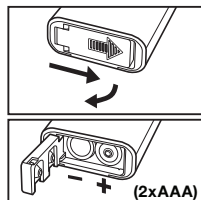

See "Safety Info" section for Battery Warning and Cautions.

# SIMPLE SETUP



## GETTING STARTED

Remove the needle cover, by gently pulling towards the front of the unit. Carefully plug in the unit, install platter and tone arm weight.

**Note:** It is recommended that this product should be operated only from the type of power source indicated on the rating label. This unit uses AC power and is powered by a standard wall outlet.

## BASIC OPERATION

Using the Function Knob, press and hold for 1-2 seconds to turn the unit ON or OFF. Cycle through the Function Knob to select from the following playing modes:

**VINYL:** Playing a Vinyl record.

**VINYL STREAM:** Connecting to an external Bluetooth speaker or headphone.

**BLUETOOTH:** Connecting and playing music from a Bluetooth device (smartphone).

**OPTICAL IN (TV):** Connecting and playing audio from a connected TV.

**AUX-IN:** Connecting and playing music from a auxiliary device.

**VOLUME:** Rotate to raise or lower the volume.



**RCA LINE OUT:** Use the red & white plugs on the back of the unit to connect to an amplifier/stereo device. Be sure to first reduce the volume to a minimum level on the record player (RCA cord not included).



**HEADPHONE:** Use the headphone jack on the back of the unit to connect your headphones/earbuds. Be sure to first reduce the volume to a minimum level on the record player.

## PLATTER / BELT DRIVE INSTALLATION

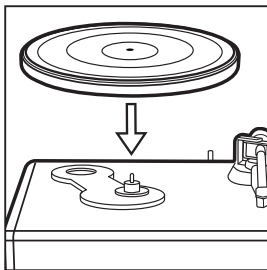

PLACE THE PLATTER ON THE TURNTABLE - THE BELT IS PRE-INSTALLED UNDER THE PLATTER

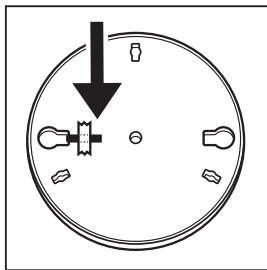

FIND THE GUIDE STRING TAPED TO THE PLATTER AND CAREFULLY REMOVE THE TAPE WHILE HOLDING THE STRING

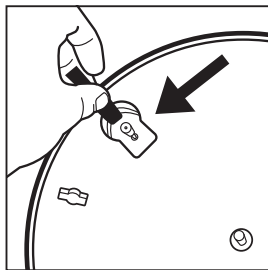

USE THE STRING TO PULL THE BELT OVER THE MOTOR PIN - ONCE BELT IS ON MOTOR PIN, DISCARD THE GUIDE STRING

# T O N E A R M S E T U P

**\*\*\*IMPORTANT, THE TONE ARM MUST BE SET UP AS INSTRUCTED BELOW OR DAMAGE MAY OCCUR TO THE UNIT OR RECORDS.**

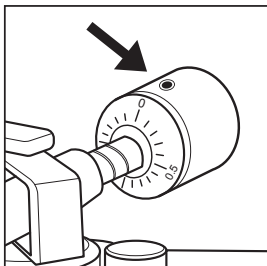

IDENTIFY THE WEIGHT ON THE BACK OF THE TONE ARM. USE THE INCLUDED 2.5MM HEX KEY TO LOOSEN THE SET SCREW

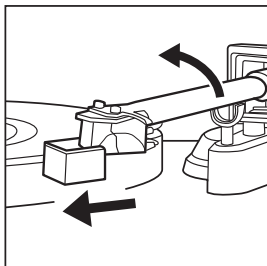

REMOVE THE NEEDLE COVER - LIFT TONE ARM OUT OF THE HOLDER TO THE LEFT SO IT FLOATS FREELY - NOT TOUCHING ANYTHING

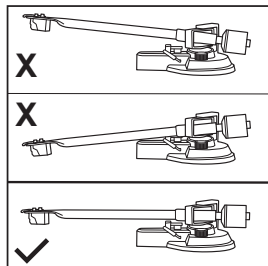

TURN THE COUNTER WEIGHT ON THE BACK OF TONE ARM UNTIL THE TONE ARM IS FLAT AND BALANCED (SEE BOTTOM PICTURE)

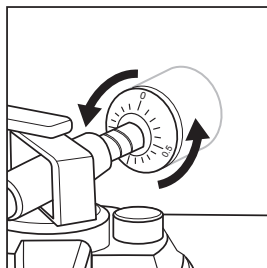

SET ONLY THE "NUMBER" RING, SO "0" IS IN THE TOP MOST POSITION: DO NOT LET THE REAR WEIGHT TURN (NUMBER RING AND COUNTER WEIGHT MOVE SEPARATELY FROM EACH OTHER)

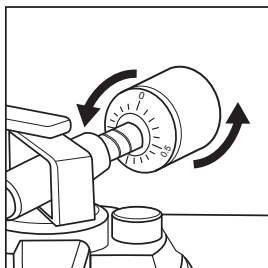

HOLDING BOTH THE NUMBER RING & COUNTER WEIGHT, ROTATE COUNTERCLOCKWISE 1 1/2 ROTATIONS UNTIL YOU END ON "1", THAN TIGHTEN SET SCREW

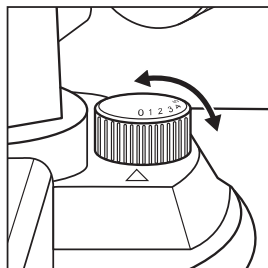

ONCE THE COUNTER WEIGHT IS SET, ADJUST THE ANTI-SKATE CONTROL TO THE RECOMMENDED SETTING OF "1.5"

The purpose of the counter weight is to set the tone arm to 3 grams of downward force, the recommended tracking weight for this cartridge. (One full counterclockwise turn with the counter weight is equal to 2g, that is why you continue to turn counterclockwise until "1")

**ANTI-SKATING ADJUSTMENT** *The anti-skating function helps compensate inward tracking force that occurs with certain records when the stylus (needle) nears the center or end of the record.*

Once the counterweight is set, adjust the anti-skate control. For the included cartridge, the recommended anti-skate setting should be "1.5".

If you notice excessive skipping or tonearm pulling inward or outward, you can adjust the anti-skate as needed.

# VINYL PLAYING



## **VINYL:** Playing a Vinyl record

**Note:** -Before using, make sure the tone arm is properly setup.  
See **TONE ARM SETUP** page.

Using the Function Knob, press and hold for 1-2 seconds to turn the unit ON.  
Simply press the Function Knob to make sure it is in Vinyl mode  
(the dial will illuminate white).

Remove the needle cover, by gently pulling towards the front of the unit.

Select the proper record speed (see back of unit).

*If using a 45 RPM record, use the included 45 adaptor.*

Release the Tone Arm from the holder and gently place on the record using the lift lever.  
Rotate the Function Knob to adjust the volume if needed.

**Note:** -Make sure to only touch the center or edges of the record to avoid damage to the vinyl grooves.

*-Do not adjust the counter weight while playing a record as this could break the needle and scratch the record.*

*-If no sound is playing, the unit may be in Vinyl Stream mode, cycle through the function knob to make sure it is in Vinyl mode.*

The record will stop spinning automatically when playback is complete.

To stop manually, lift the tone arm from the record and return it to the rest.

# VINYL STREAM™



## **VINYL STREAM:** Playing a Vinyl record on a external Bluetooth speaker or headphones.

Using the Function Knob, press and hold for 1-2 seconds to turn the unit ON.  
Simply press the Function Knob to make sure it is in Vinyl Stream mode  
(the dial will flash white).

Turn ON your external Bluetooth speaker or headphone, and set to pairing mode.  
Wait a few seconds for the unit to find your device.

The unit will chime and say "Connected", while the Function Knob will remain white.  
Use your external device to control the volume.

**Note:** -In Vinyl Stream mode, internal speakers will be disengaged.

*-We recommend placing the Bluetooth device within 1m (3.3') of the product when initially pairing.*

*-Make sure the unit is within 10m (33ft) from your external device for the strongest connection.*

*-Vinyl Stream is only compatible with vinyl record playback.*

*-The product stays in the pairing mode for 30 seconds. If pairing is not properly completed, follow the above steps again from the beginning after turning all devices OFF.*

## BLUETOOTH PAIRING



**BLUETOOTH:** Connecting and playing music from a Bluetooth device (Smartphone).

Using the Function Knob, press and hold for 1-2 seconds to turn the unit ON. Simply press the Function Knob to make sure it is in Bluetooth mode (the dial will flash blue).

On your device, turn Bluetooth ON. Then search for / select **"V1 SYSTEM"** in the settings menu.

The unit will chime and say *"Connected"*, while the Function Knob will remain blue. Use your external device to control playback.

Rotate the Function Knob to adjust the volume if needed.

**Note:** -Make sure the unit is within 10m (33ft) from your external device for the strongest connection.

-If no sound is playing, the unit may be in Vinyl Stream mode, cycle through the function knob to make sure it is in Bluetooth mode.

## OPTICAL IN / AUX-IN LISTENING



**OPTICAL IN (TV):** Connecting and playing audio from a connected TV.

Using the Function Knob, press and hold for 1-2 seconds to turn the unit ON. Simply press the Function Knob to make sure it is in Optical In (TV) mode (the dial will illuminate white).

Plug one end of the Optical In cable (included) into the Optical In socket on the back of the unit. Plug the other end of the cable into the Optical In socket of your TV. Make sure your TV is outputting sound to the Optical In Socket, in your TV Settings. Adjust the volume on your TV.



**AUXILIARY IN:** Connecting and playing audio from an auxiliary device.

Using the Function Knob, press and hold for 1-2 seconds to turn the unit ON. Simply press the Function Knob to make sure it is in Auxiliary In mode (the dial will illuminate white).

Plug one end of the Aux-In cable (not included) into the Aux-In socket on the back of the unit. Plug the other end of the cable into the Aux-In Jack of your device. Adjust the volume on your device.

## SUBWOOFER PAIRING



**WIRELESS PAIRING THE S1 SUBWOOFER (Sold Separately):**

Turn on the S1 Subwoofer. Press the MODE button on the back of the unit until the LED turns BLUE. The LED will slowly flash BLUE indicating it is in Wireless Mode.

Press and hold the MODE button for 1-2 seconds to enter Pairing Mode. The LED will begin to quickly flash BLUE.

On the V1, Press and hold the PAIR button on the back of the unit for 1-2 seconds. you will hear the pairing notification from the V1. Once both the V1 and S1 are paired, you will hear a connection chime. The BLUE LED on the back of the S1 remain solid.

# CARTRIDGE REPLACEMENT

## REPLACEMENT CARTRIDGE: VICTROLA VPC-190

The VPC-190 Cartridge is rated in excess of 1000 hours of normal use. As soon as you notice a change in sound quality or damage to the stylus, it is recommended that it be changed.

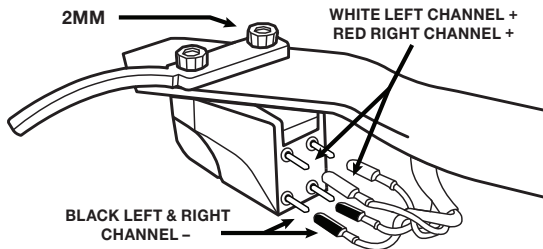

1. Unplug the unit and put the needle cover on the old cartridge.
2. Carefully remove all the wire leads from the back of the old cartridge.
3. Loosen the 2 allen head screws with the included 2mm hex keys on the top of the tone arm / cartridge. Remove old cartridge.
4. Mount the new cartridge, and adjust the position to ensure it will track parallel to the record grooves and tighten the screws.
5. Connect the wire leads to the new cartridge by pushing them firmly on to the connector pins.  
WHITE Left channel positive (L+)  
RED Right channel positive (R+)  
BLACK Left and Right channel negative (L- & R-)

For best results, use a cartridge alignment protractor or download our Cartridge Alignment Protractor at [victrola.com/cartridgealignment](http://victrola.com/cartridgealignment)

# SPECIFICATIONS

## GENERAL

Power Requirements .....	AC 100-240V~50/60HZ
Power Consumption .....	20 W
Speaker power.....	2 x 10W(RMS), (PMPO 40W)
Dimensions (W x D x H).....	350mm x 420mm x 120mm (approx)
Weight .....	6.15 kgs

## RECORD PLAYER

Motor.....	DC servo motor
Drive System.....	Belt Drive
Speeds.....	Off/33-1/3 rpm, 45 rpm
Cartridge Type .....	Moving Magnetic Cartridge
Moving Magnetic Cartridge .....	Victrola VPC-190

## BLUETOOTH

Bluetooth Version .....	Bluetooth V5.0
Bluetooth Profiles .....	A2DP, AVRCP
Bluetooth Frequency range.....	2.402GHz-2.480GHz
Operating Distance .....	10 meters (33 ft.)

## INCLUDED:

V1 Music System & Dust Cover, 45 RPM Adapter, Remote Control (Batteries Included), Silicone Slipmat, Digital Optical Cable, Power Cable, Instruction Manual, Quick Setup Guide, 2mm/2.5mm hex key



# WARNING

## Important Safety Instruction

1. Read these instructions – All the safety and operating instructions should be read before this product is operated.
2. Keep these instructions – The safety and operating instructions should be retained for future reference.
3. Heed all warnings – All warnings on the appliance and in the operating instructions should be adhered to.
4. Follow all instructions – All operating and use instructions should be followed.
5. Do not use this apparatus near water – The appliance should not be used near water or moisture – for example, in a wet basement or near a swimming pool, and the like.
6. Clean only with dry cloth.
7. Do not block any ventilation openings. Install in accordance with the manufacture's instructions.
8. Do not install near any heat sources such as radiators, heat registers, stoves, or other apparatus (including amplifiers) that produce heat.
9. Protect the power cord from being walked on or pinched particularly at the plugs, convenience receptacles, and at the point where they exit from the apparatus.
10. Only use attachments/accessories specified by the manufacturer.
11. Use only with the cart, stand, tripod, bracket, or table specified by the manufacturer, or sold with the apparatus. When a cart is used, use caution when moving the cart/apparatus combination to avoid injury from tip-over.
12. Unplug the apparatus during lightning storms or when unused for long periods of time.
13. Refer all servicing to qualified personnel. Servicing is required when the apparatus has been damaged in any way, such as power supply cord or plug is damaged, liquid has been spilled or objects have fallen into the apparatus has been exposed to rain or moisture, does not operate normally, or has been dropped.



**CAUTION/ATTENTION:**  
RISK OF ELECTRIC SHOCK. DO NOT  
OPEN. / ATTENTION RISQUE DE  
CHOC ÉLECTRIQUE. NE PAS OUVRIR



14. This lightning flash with arrowhead symbol within an equilateral triangle is intended to alert the user to the presence of non-insulated “dangerous voltage” within the product’s enclosure that may be of sufficient magnitude to constitute a risk of electric shock.
  - a. Warning: To reduce the risk of electric shock, do not remove cover (or back) as there are no user-serviceable parts inside. Refer servicing to qualified personnel.
  - b. The exclamation point within an equilateral triangle is intended to alert the user to the presence of important operating and maintenance instructions in the literature accompanying the appliance.
15.  This equipment is a Class II or double insulated electrical appliance. It has been designed in such a way that it does not require a safety connection to electrical earth.
16. The mains plug is used as disconnect device, the disconnect device shall remain readily operable.
17. **WARNING:** To reduce the risk of fire or electric shock, do not expose this apparatus to rain or moisture. The apparatus shall not be exposed to dripping or splashing and that no objects filled with liquids, such as vases, shall not be placed on apparatus.
18. The use of the equipment in moderate climate.
19. **WARNING:** Please refer the information on exterior bottom/back enclosure for electrical and safety information before installing or operating the apparatus.
20. The ventilation should not be impeded by covering the ventilation openings with items such as newspaper, table-cloths, curtains etc.
21. No naked flame sources, such as lighted candles, should be placed on the apparatus.
22. Do not install this equipment in a confined space such as a book case or similar unit.

# SAFETY INFO

## Safety Information

1. In order to shut off power to this product completely, unplug the power cord from the wall outlet. Be sure to unplug the unit if you do not intend to use it for an extended period of time, such as during a vacation.
2. Use of controls, adjustments and performance of procedures other than those specified herein may result in hazardous radiation exposure.
3. To prevent electric shock, match wide blade of plug to wide slot, fully insert.
4. If this product is experience problems during operation, contact qualified service centers, and do not use the product in defective states.

## Before Use

1. Choose unit installation location carefully. Avoid placing it in direct sunlight or close to a source of heat. Also avoid locations subject to vibrations and excessive dust, cold or moisture. Keep away from sources that hum, such as transformers or motors.
2. Do not open the cabinet as this may result in damage to the circuitry or electrical shock. If a foreign object should get into the set, contact Customer Service.
3. Be sure not to handle record with dirty fingers. Never play a record that has a crack on the surface.
4. When removing the power plug from the wall outlet, always pull directly on the plug, never pull the cord.
5. To protect the stylus, don't forget to put on the white protective needle cover after use.
6. Do not attempt to clean the unit with chemical solvents as this might damage the finish. Use a clean, dry cloth.
7. In order to shut off the power to this product completely, unplug the power cord from the wall outlet. Be sure to unplug the unit if you do not intend to use it for an extended period of time, such as a vacation.
8. Keep this manual in a safe place for future reference.

## Battery Safety Information:

This unit uses 2x "AAA" batteries. Make sure that they are oriented so their polarity markings, "+" and "-" match the remote's markings. When the distance required between the remote control and main unit decreases, it is necessary to replace the battery with new ones.

## Battery Precautions

Be sure to insert the batteries with correct positive "+" and negative "-" orientation.

ALWAYS use batteries of the same type. Never mix different types of batteries together.

Caution: There is a risk of explosion if the battery is replaced by an incorrect battery type.

When using rechargeable batteries, refer to the precautions on their labels.

When the remote control unit is not to be used for a long time (more than a month), remove the batteries to prevent them from leaking.

Do not heat or disassemble batteries, and NEVER dispose of old batteries by throwing them in a fire.

Do not dispose device into standard garbage disposal sites. Dispose of device at available Battery Recycling Sites after fully discharging battery. Not doing so may violate disposal laws and regulations.

Please refer to local regulations for proper battery disposal.

# FCC STATEMENT

This device complies with Part 15 of the FCC Rules. Operation is subject to the following two conditions: (1) This device may not cause harmful interference, and (2) this device must accept any interference received, including interference that may cause undesired operation.

NOTE: This equipment has been tested and found to comply with the limits for a Class B digital device, pursuant to Part 15 of the FCC Rules. These limits are designed to provide reasonable protection against harmful interference in a residential installation. This equipment generates uses and can radiate radio frequency energy and, if not installed and used in accordance with the instructions, may cause harmful interference to radio communications. However, there is no guarantee that interference will not occur in a particular installation. If this equipment does cause harmful interference to radio or television reception, which can be determined by turning the equipment off and on, the user is encouraged to try to correct the interference by one of the following measures:

- Reorient or relocate the receiving antenna.
- Increase the separation between the equipment and receiver.
- Connect the equipment into an outlet on a circuit different from that to which the receiver is connected.
- Consult the dealer or an experienced radio/TV technician for help.

**WARNING:** Any changes or modifications not expressly approved by the party responsible for compliance could void the user's authority to operate this equipment.

The device must not be co-located or operating in conjunction with any other antenna or transmitter. To maintain compliance with the FCC's RF exposure guidelines, place the product at least 20cm from nearby persons.

#### Déclaration d'IC sur l'exposition aux radiations:

Cet équipement est conforme aux limites d'exposition aux radiations définies par le Canada pour des environnements non contrôlés. Cet équipement doit être installé et utilisé à une distance minimum de 20 cm entre l'antenne et votre corps. Cet émetteur ne doit pas être installé au même endroit ni utilisé avec une autre antenne ou un autre émetteur.

This device complies with RSS247 of Industry Canada. Cet appareil se conforme à RSS247 de Canada d'Industrie. This device complies with Industry Canada license-exempt RSS standard(s). Operation is subject to the following two conditions: (1) this device may not cause interference, and (2) this device must accept any interference, including interference that may cause undesired operation of the device appareils radio exempts de licence. Son fonctionnement est sujet aux deux conditions

Suivantes: (1) le dispositif ne doit pas produire de brouillage préjudiciable, et (2) Ce dispositif doit Accepter tout brouillage reçu, y compris un brouillage susceptible de provoquer un fonctionnement indésirable.

## WARRANTY

**Victrola is a registered trademark of Innovative Technology Electronics, LLC.**

#### United States

Victrola (Innovative Technology Electronics, LLC) warrants to the original retail purchaser that this product will be free from defective materials and workmanship for one (1) year from the date of purchase, subject to the limitations below. This warranty period is not extended if we replace the product.

To obtain a replacement under the terms of this warranty, you must contact the dealer from which it was purchased with your original receipt. If assistance from the dealer from which it was purchased is impossible, you may contact our customer service for warranty assistance at [victrola.com/contact](http://victrola.com/contact).

Except as limited below, if the product proves defective in either material or workmanship within one (1) year from the date of purchase, Victrola will replace the product at no charge. If the product model is no longer available and cannot be replaced with an identical model, Victrola will issue a merchandise credit for the purchase price to be redeemed at [victrola.com](http://victrola.com).

#### Limitations:

- This limited warranty does not cover failure of the product arising, in whole or in part, from improper installation, storage, transportation, misuse, abuse, accident, neglect, mishandling, unauthorized repair, modification, or wear from ordinary use or environmental deterioration.
- This limited warranty does not cover cosmetic damage, including paint damage, or consequential damage to other components or premises which may result for any reason from the failure of the product.
- This limited warranty is null and void for products not used in accordance with Victrola's instructions.
- This limited warranty terminates if the original retail purchaser sells or otherwise transfers this product.
- This limited warranty is null and void for defects or damage caused by installation or repair performed by any person or entity other than a Victrola authorized installer or dealer.

This warranty gives you specific legal rights, and you may also have other rights which vary from state to state, jurisdiction to jurisdiction or country to country. All express and implied warranties for the product, including but not limited to any implied warranties of merchantability and fitness for a particular purpose, are limited in time to the term of this warranty. Some states, jurisdictions or countries do not allow the exclusion of certain implied warranties or conditions, or limitations on how long an implied warranty or condition lasts, so this limitation may not apply to you. Victrola's responsibility for malfunctions and defects in hardware is limited to replacement or repair as set forth in this warranty statement. Victrola does not accept liability for special, punitive, consequential or incidental damages or losses, whether direct or indirect, including without limitation, any liability for third party claims against you for damages or losses or for products not being available for use. The maximum liability for which Victrola may be responsible will be no more than the amount you paid for the product that is the subject of the claim. Some states, jurisdictions or countries do not allow the exclusion or limitation of special, indirect, incidental or consequential damages, so the above limitation or exclusion may not apply to you.

### **Canada and US Territories**

The Warranty on this product shall comply with applicable law when sold to a consumer in Canada or a US Territory. To obtain any applicable warranty service, please contact the dealer from which you purchased the product, or the distributor that supplied the product, with your original receipt. If assistance from the dealer from which it was purchased is impossible, you may contact our customer service for warranty assistance at [victrola.com/contact](http://victrola.com/contact).

If this product proves defective in either material or workmanship, Victrola will replace the product at no charge. If the product model is no longer available and cannot be repaired effectively or replaced with an identical model, Victrola at its sole option may replace the unit with a current model of equal or greater value.

### **Outside the U.S, Canada, and US Territories**

The Warranty on this product shall comply with applicable law when sold to a consumer outside of the United States, Canada, and US Territories. To obtain any applicable warranty service, please contact the dealer from which you purchased the product, or the distributor that supplied the product, with your original receipt.



## S1 SUBWOOFER

VPS-650

# OVERVIEW

## Back View

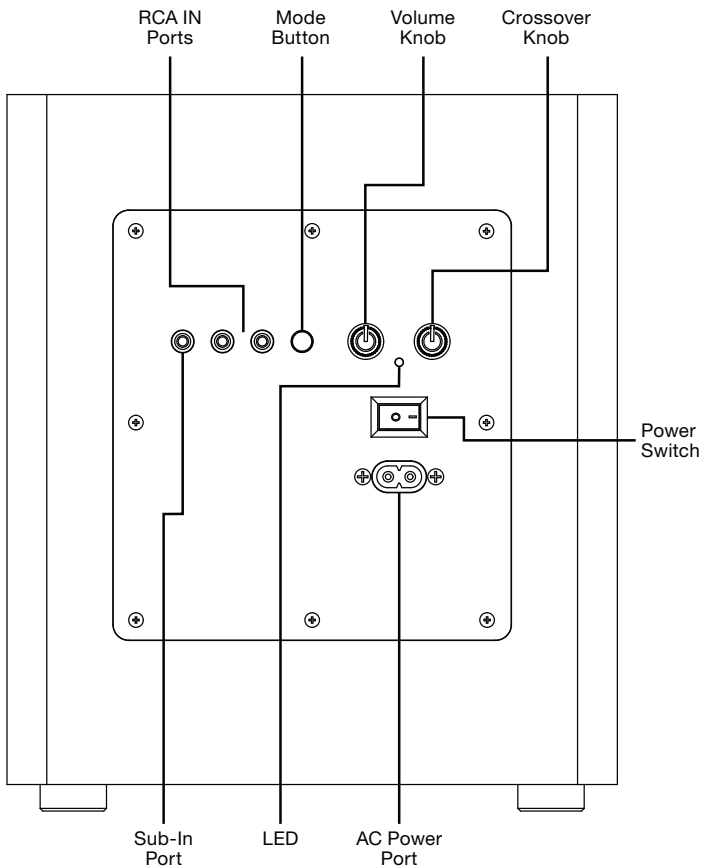



# QUICK START GUIDE

## MODE BUTTON - TO CYCLE THROUGH FEATURES

**BLUETOOTH:** Press to pair the unit.

**SUB-IN:** Press to play audio from a subwoofer connection.

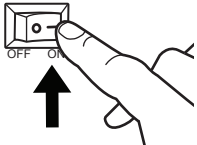
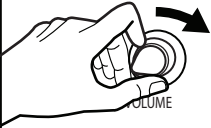
**RCA-IN:** Press to play audio from a connected auxiliary device.

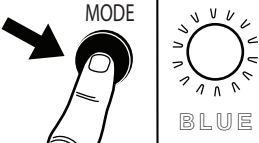
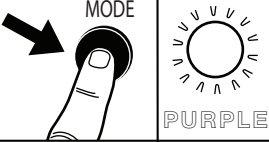
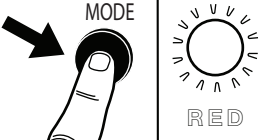
OPERATION	FUNCTION
	<b>POWER ON/OFF:</b> Flip Switch to Power ON or OFF the Unit.
	<b>VOLUME KNOB:</b> Turn the Knob to Raise or Lower the Volume.
	<b>CROSSOVER KNOB:</b> Turn The Knob To Boost or Reduce the Frequency Sound Range.
	<b>Press MODE Button for: BLUETOOTH:</b> LED will FLASH when searching. Once connected, the LED will turn SOLID.
	<b>Press MODE Button for: SUB-IN:</b>
	<b>Press MODE Button for: RCA-IN:</b>

# SIMPLE SETUP



## BASIC OPERATION

Using the Power Switch, flip the unit's power ON.

Connect your S1 using one of the wired or wireless pairing modes shown below.

Make sure the S1 is in the proper mode based on the MODE LED color guide on the Quick Start Guide.

## SETTING THE VOLUME

Set the volume knob on the S1 to the middle setting and begin playing music through the connected speakers at an appropriate level.

With the music playing, adjust the volume knob on the S1 up or down to match the main speaker volume according to your preference.

After adjusting, the master volume on the connected audio device will control the S1 simultaneously with the speaker's volume.

# WIRED CONNECTION



## HARDWIRING THE S1 SUBWOOFER

### OPTION A (SUB-IN):

(Connection 1) Use the single SUB-IN port if you are connecting a receiver/audio device with a SUB-OUT port and you are using a single RCA subwoofer cable (sold separately)

(Connection 2) Use the single SUB-IN port if you are connecting a receiver/audio device with Left and Right pre-outs instead of a single SUB-OUT port by using the included subwoofer Y cable. Connect the R and L RCA ends to the external device, and the single RCA end to the SUB-IN port on the back of the S1.

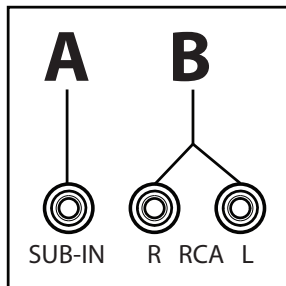

### OPTION B (RCA IN)

(Connection 1, most common for wired connections with the Victrola V1 or M1 using the included Y cable) Use the Left and Right RCA inputs if you are connecting a receiver/audio device with a Single SUB-OUT port and you are using the included subwoofer Y cable. The Single RCA end of the Y cable will connect to the external device, and the R & L RCA ends will connect to the back of the S1.

(Connection 2) Use the Left and Right RCA inputs if you are connecting a receiver/audio device with Left and Right pre-outs using a standard 2-male to 2-male RCA cable (sold separately).



# WIRELESS PAIRING



## WIRELESS PAIRING THE V1 TURNTABLE (Sold Separately):

Turn on the S1 Subwoofer and V1 Turntable. Press the MODE button on the back of the Subwoofer until the LED turns BLUE. The LED will slowly flash BLUE indicating it is in Wireless Mode.

Press and hold the MODE button for 1-2 seconds to enter Pairing Mode. The LED will begin to quickly flash BLUE.

On the V1 Turntable, Press and hold the PAIR button on the back of the unit for 1-2 seconds. you will hear the pairing notification from the V1. Once both the V1 and S1 are paired, you will hear a connection chime. The BLUE LED on the back of the S1 will remain solid.

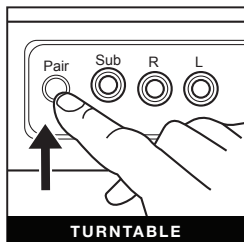
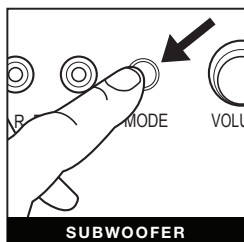
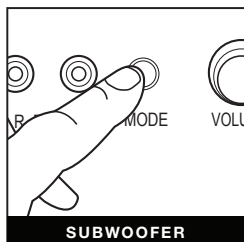

# SPECIFICATIONS

## GENERAL

Power Requirements	AC 100-240V~50/60Hz
Power Consumption	70 W
Horn	6.5" woofer x1
Dimensions (W x D x H)	230mm x 230mm x 279mm (approx)
Weight	4.75 kgs

## BLUETOOTH

Bluetooth Version	Bluetooth V5.0
Bluetooth Profiles	A2DP, AVRCP
Bluetooth Frequency range	2.402GHz-2.480GHz
Operating Distance	10 meters (33 ft.)

## INCLUDED:

S1 Subwoofer, RCA Y Cable, Power Cable, Instruction Manual, Quick Setup Guide

# WARNING

## Important Safety Instruction

1. Read these instructions – All the safety and operating instructions should be read before this product is operated.
2. Keep these instructions – The safety and operating instructions should be retained for future reference.
3. Heed all warnings – All warnings on the appliance and in the operating instructions should be adhered to.
4. Follow all instructions – All operating and use instructions should be followed.
5. Do not use this apparatus near water – The appliance should not be used near water or moisture – for example, in a wet basement or near a swimming pool, and the like.
6. Clean only with dry cloth.
7. Do not block any ventilation openings. Install in accordance with the manufacture's instructions.
8. Do not install near any heat sources such as radiators, heat registers, stoves, or other apparatus (including amplifiers) that produce heat.
9. Protect the power cord from being walked on or pinched particularly at the plugs, convenience receptacles, and at the point where they exit from the apparatus.
10. Only use attachments/accessories specified by the manufacturer.
11. Use only with the cart, stand, tripod, bracket, or table specified by the manufacturer, or sold with the apparatus. When a cart is used, use caution when moving the cart/apparatus combination to avoid injury from tip-over.
12. Unplug the apparatus during lightning storms or when unused for long periods of time.
13. Refer all servicing to qualified personnel. Servicing is required when the apparatus has been damaged in any way, such as power supply cord or plug is damaged, liquid has been spilled or objects have fallen into the apparatus has been exposed to rain or moisture, does not operate normally, or has been dropped.



**CAUTION/ATTENTION:**  
RISK OF ELECTRIC SHOCK. DO NOT  
OPEN. / ATTENTION RISQUE DE  
CHOC ÉLECTRIQUE. NE PAS OUVRIR



14. This lightning flash with arrowhead symbol within an equilateral triangle is intended to alert the user to the presence of non-insulated “dangerous voltage” within the product’s enclosure that may be of sufficient magnitude to constitute a risk of electric shock.
  - a. Warning: To reduce the risk of electric shock, do not remove cover (or back) as there are no user-serviceable parts inside. Refer servicing to qualified personnel.
  - b. The exclamation point within an equilateral triangle is intended to alert the user to the presence of important operating and maintenance instructions in the literature accompanying the appliance.
15.  This equipment is a Class II or double insulated electrical appliance. It has been designed in such a way that it does not require a safety connection to electrical earth.
16. The mains plug is used as disconnect device, the disconnect device shall remain readily operable.
17. **WARNING:** To reduce the risk of fire or electric shock, do not expose this apparatus to rain or moisture. The apparatus shall not be exposed to dripping or splashing and that no objects filled with liquids, such as vases, shall not be placed on apparatus.
18. The use of the equipment in moderate climate.
19. **WARNING:** Please refer the information on exterior bottom/back enclosure for electrical and safety information before installing or operating the apparatus.
20. The ventilation should not be impeded by covering the ventilation openings with items such as newspaper, table-cloths, curtains etc.
21. No naked flame sources, such as lighted candles, should be placed on the apparatus.
22. Do not install this equipment in a confined space such as a book case or similar unit.

# SAFETY INFO

## Safety Information

1. In order to shut off power to this product completely, unplug the power cord from the wall outlet. Be sure to unplug the unit if you do not intend to use it for an extended period of time, such as during a vacation.
2. Use of controls, adjustments and performance of procedures other than those specified herein may result in hazardous radiation exposure.
3. To prevent electric shock, match wide blade of plug to wide slot, fully insert.
4. If this product is experience problems during operation, contact qualified service centers, and do not use the product in defective states.

## Before Use

1. Choose unit installation location carefully. Avoid placing it in direct sunlight or close to a source of heat. Also avoid locations subject to vibrations and excessive dust, cold or moisture. Keep away from sources that hum, such as transformers or motors.
2. Do not open the cabinet as this may result in damage to the circuitry or electrical shock. If a foreign object should get into the set, contact Customer Service.
3. Be sure not to handle record with dirty fingers. Never play a record that has a crack on the surface.
4. When removing the power plug from the wall outlet, always pull directly on the plug, never pull the cord.
5. To protect the stylus, don't forget to put on the white protective needle cover after use.
6. Do not attempt to clean the unit with chemical solvents as this might damage the finish. Use a clean, dry cloth.
7. In order to shut off the power to this product completely, unplug the power cord from the wall outlet. Be sure to unplug the unit if you do not intend to use it for an extended period of time, such as a vacation.
8. Keep this manual in a safe place for future reference.

# FCC STATEMENT

This device complies with Part 15 of the FCC Rules. Operation is subject to the following two conditions: (1) This device may not cause harmful interference, and (2) this device must accept any interference received, including interference that may cause undesired operation.

NOTE: This equipment has been tested and found to comply with the limits for a Class B digital device, pursuant to Part 15 of the FCC Rules. These limits are designed to provide reasonable protection against harmful interference in a residential installation. This equipment generates uses and can radiate radio frequency energy and, if not installed and used in accordance with the instructions, may cause harmful interference to radio communications. However, there is no guarantee that interference will not occur in a particular installation. If this equipment does cause harmful interference to radio or television reception, which can be determined by turning the equipment off and on, the user is encouraged to try to correct the interference by one of the following measures:

- Reorient or relocate the receiving antenna.
- Increase the separation between the equipment and receiver.
- Connect the equipment into an outlet on a circuit different from that to which the receiver is connected.
- Consult the dealer or an experienced radio/TV technician for help.

**WARNING:** Any changes or modifications not expressly approved by the party responsible for compliance could void the user's authority to operate this equipment.

The device must not be co-located or operating in conjunction with any other antenna or transmitter. To maintain compliance with the FCC's RF exposure guidelines, place the product at least 20cm from nearby persons.

Déclaration d'IC sur l'exposition aux radiations:

Cet équipement est conforme aux limites d'exposition aux radiations définies par le Canada pour des

environnements non contrôlés. Cet équipement doit être installé et utilisé à une distance minimum de 20 cm entre l'antenne et votre corps. Cet émetteur ne doit pas être installé au même endroit ni utilisé avec une autre antenne ou un autre émetteur.

This device complies with RSS247 of Industry Canada. Cet appareil se conforme à RSS247 de Canada d'Industrie. This device complies with Industry Canada license-exempt RSS standard(s). Operation is subject to the following two conditions: (1) this device may not cause interference, and (2) this device must accept any interference, including interference that may cause undesired operation of the device appareils radio exempts de licence. Son fonctionnement est sujet aux deux conditions

Suivantes: (1) le dispositif ne doit pas produire de brouillage préjudiciable, et (2) Ce dispositif doit Accepter tout brouillage reçu, y compris un brouillage susceptible de provoquer un fonctionnement indésirable.

## WARRANTY

**Victrola is a registered trademark of Innovative Technology Electronics, LLC.**

### **United States**

Victrola (Innovative Technology Electronics, LLC) warrants to the original retail purchaser that this product will be free from defective materials and workmanship for one (1) year from the date of purchase, subject to the limitations below. This warranty period is not extended if we replace the product.

To obtain a replacement under the terms of this warranty, you must contact the dealer from which it was purchased with your original receipt. If assistance from the dealer from which it was purchased is impossible, you may contact our customer service for warranty assistance at [victrola.com/contact](http://victrola.com/contact).

Except as limited below, if the product proves defective in either material or workmanship within one (1) year from the date of purchase, Victrola will replace the product at no charge. If the product model is no longer available and cannot be replaced with an identical model, Victrola will issue a merchandise credit for the purchase price to be redeemed at [victrola.com](http://victrola.com).

### **Limitations:**

- This limited warranty does not cover failure of the product arising, in whole or in part, from improper installation, storage, transportation, misuse, abuse, accident, neglect, mishandling, unauthorized repair, modification, or wear from ordinary use or environmental deterioration.
- This limited warranty does not cover cosmetic damage, including paint damage, or consequential damage to other components or premises which may result for any reason from the failure of the product.
- This limited warranty is null and void for products not used in accordance with Victrola's instructions.
- This limited warranty terminates if the original retail purchaser sells or otherwise transfers this product.
- This limited warranty is null and void for defects or damage caused by installation or repair performed by any person or entity other than a Victrola authorized installer or dealer.

This warranty gives you specific legal rights, and you may also have other rights which vary from state to state, jurisdiction to jurisdiction or country to country. All express and implied warranties for the product, including but not limited to any implied warranties of merchantability and fitness for a particular purpose, are limited in time to the term of this warranty. Some states, jurisdictions or countries do not allow the exclusion of certain implied warranties or conditions, or limitations on how long an implied warranty or condition lasts, so this limitation may not apply to you. Victrola's responsibility for malfunctions and defects in hardware is limited to replacement or repair as set forth in this warranty statement. Victrola does not accept liability for special, punitive, consequential or incidental damages or losses, whether direct or indirect, including without limitation, any liability for third party claims against you for damages or losses or for products not being available for use. The maximum liability for which Victrola may be responsible will be no more than the amount you paid for the product that is the subject of the claim. Some states, jurisdictions or countries do not allow the exclusion or limitation of special, indirect,

incidental or consequential damages, so the above limitation or exclusion may not apply to you.

### **Canada and US Territories**

The Warranty on this product shall comply with applicable law when sold to a consumer in Canada or a US Territory. To obtain any applicable warranty service, please contact the dealer from which you purchased the product, or the distributor that supplied the product, with your original receipt. If assistance from the dealer from which it was purchased is impossible, you may contact our customer service for warranty assistance at [victrola.com/contact](http://victrola.com/contact).

If this product proves defective in either material or workmanship, Victrola will replace the product at no charge. If the product model is no longer available and cannot be repaired effectively or replaced with an identical model, Victrola at its sole option may replace the unit with a current model of equal or greater value.

### **Outside the U.S, Canada, and US Territories**

The Warranty on this product shall comply with applicable law when sold to a consumer outside of the United States, Canada, and US Territories. To obtain any applicable warranty service, please contact the dealer from which you purchased the product, or the distributor that supplied the product, with your original receipt.