

Contents

The Quick Guide is not intended as a substitute for your *Owner's Manual*. We strongly encourage you to review the *Owner's Manual* and supplementary manuals so you will have a better understanding of your vehicle's capabilities and limitations.

Overview ●

Topic 1

Entering and Exiting

- Keys ▶ P.7
- Wireless Remote Control ▶ P.8
- Theft Deterrent System ▶ P.9



Topic 2

Before Driving

- Front Seats ▶ P.11
- Rear Seats ▶ P.12
- Driving Position Memory ▶ P.13
- Head Restraints ▶ P.14
- Seatbelts ▶ P.15
- Outside Rear View Mirrors ▶ P.16
- Anti-glare Inside Rear View Mirror ▶ P.16
- Steering Wheel ▶ P.17

Topic 3

When Driving

- Starting ▶ P.19
- Transmission ▶ P.20
- Turn Signal Lever ▶ P.21
- Emergency Flasher Switch ▶ P.21
- Cruise Control ▶ P.22



- Dynamic Laser Cruise Control ▶ P.23
- Trip Information Display ▶ P.25
- Multi-information Display ▶ P.26
- Parking Brake ▶ P.27



- Headlight Cleaner ▶ P.34
- Instrument Panel Light Control ▶ P.34
- Multi-display Light Control ▶ P.35

Topic 4

Rain and Night Driving

- Headlights ▶ P.29
- Fog Lights ▶ P.30
- Windshield Wipers and Washer ▶ P.30
- Rear Window Wiper and Washer ▶ P.33
- Rear Window and Outside Rear View Mirror Defogger, and Windshield Wiper De-icer ▶ P.34

Topic 5

Driving Comfort

- Audio System ▶ P.37
- Rear Seat Entertainment System ▶ P.40
- Air Conditioning System ▶ P.42
- Garage Door Opener ▶ P.43
- Console Boxes ▶ P.45
- Cup Holders ▶ P.46



- Glove Box ▶ P.47
- Seat Heaters ▶ P.47
- Compass ▶ P.47



Topic 6

Opening and Closing

- Door Locks ▶ P.49
- Moon Roof ▶ P.50
- Back Door ▶ P.51
- Fuel Tank Cap ▶ P.52
- Hood ▶ P.53
- Power Windows ▶ P.54

What to do if ...



Responding to warning/indicator lights and other problems that may arise.

Customizing Your Lexus



A list of features that can be customized.

Depending on specifications, the vehicle shown in the illustration may differ from your vehicle in terms of color and equipment.

Overview

Instrument Panel

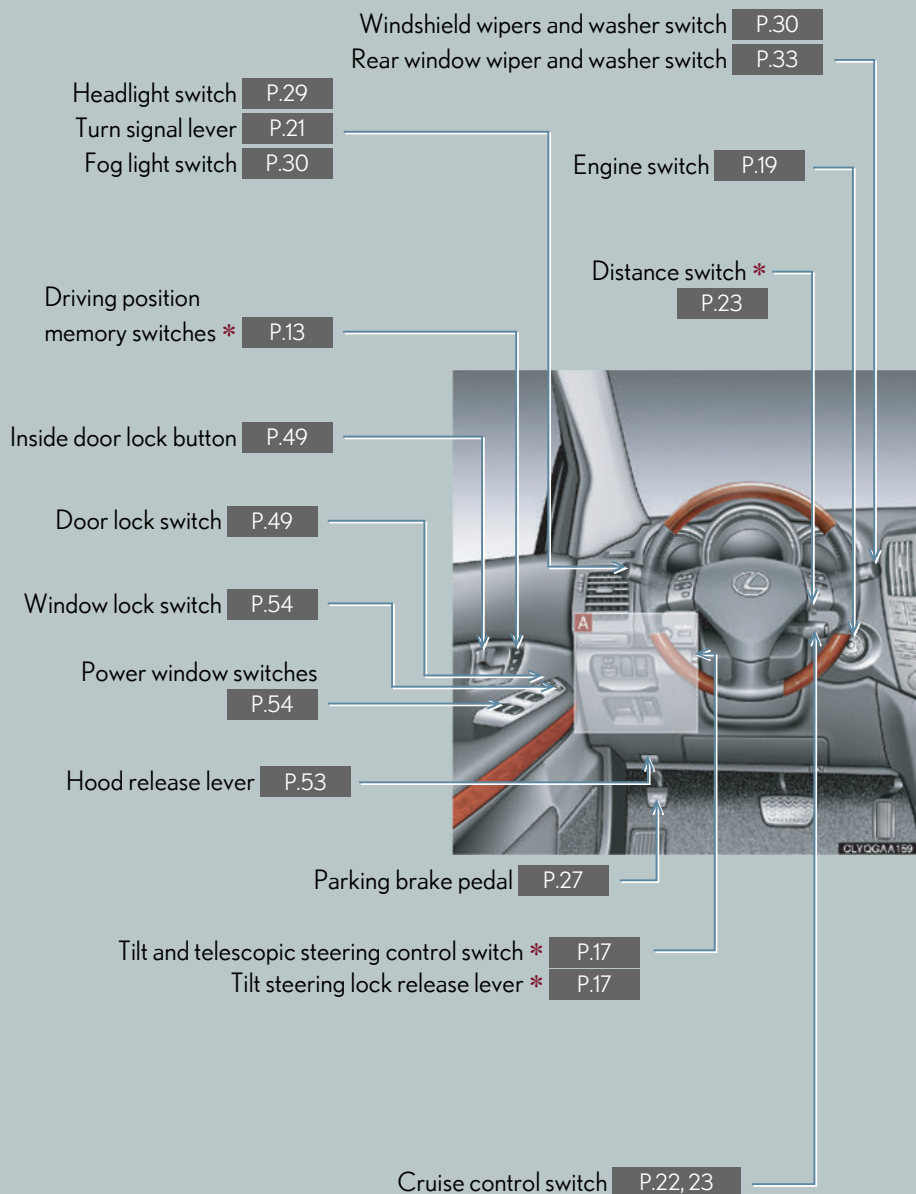

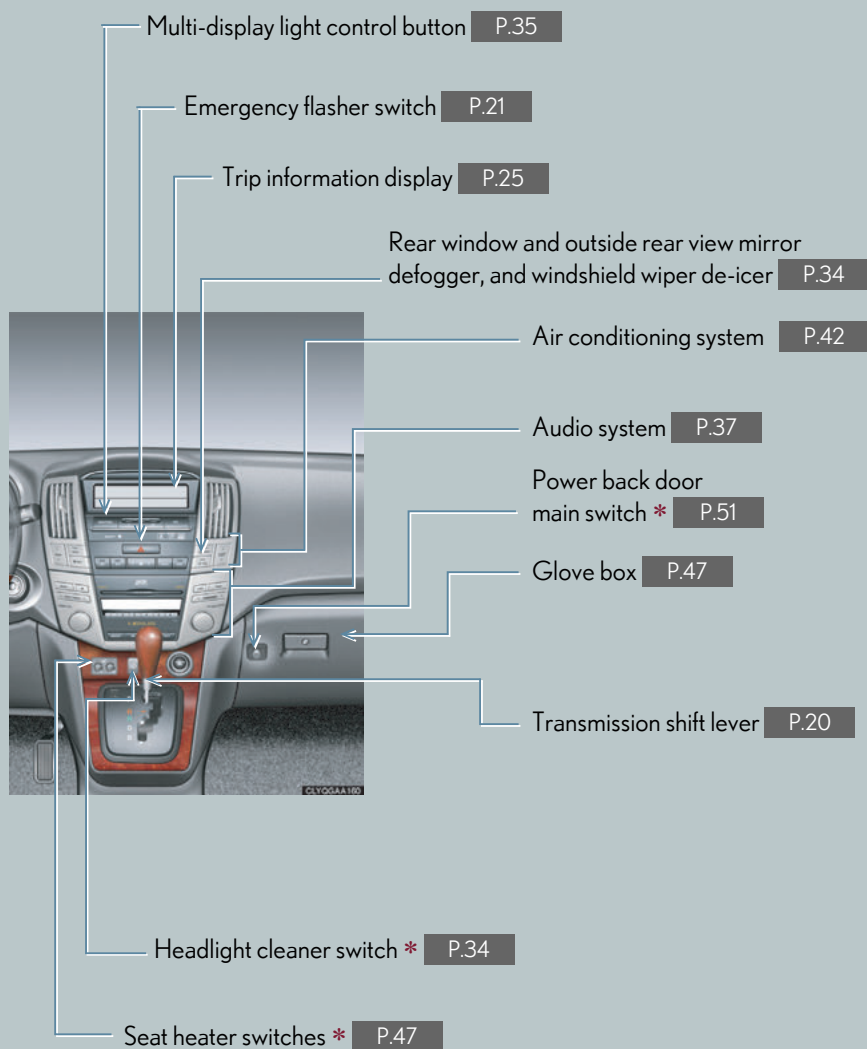

* : If equipped

Overview

Instrument Panel

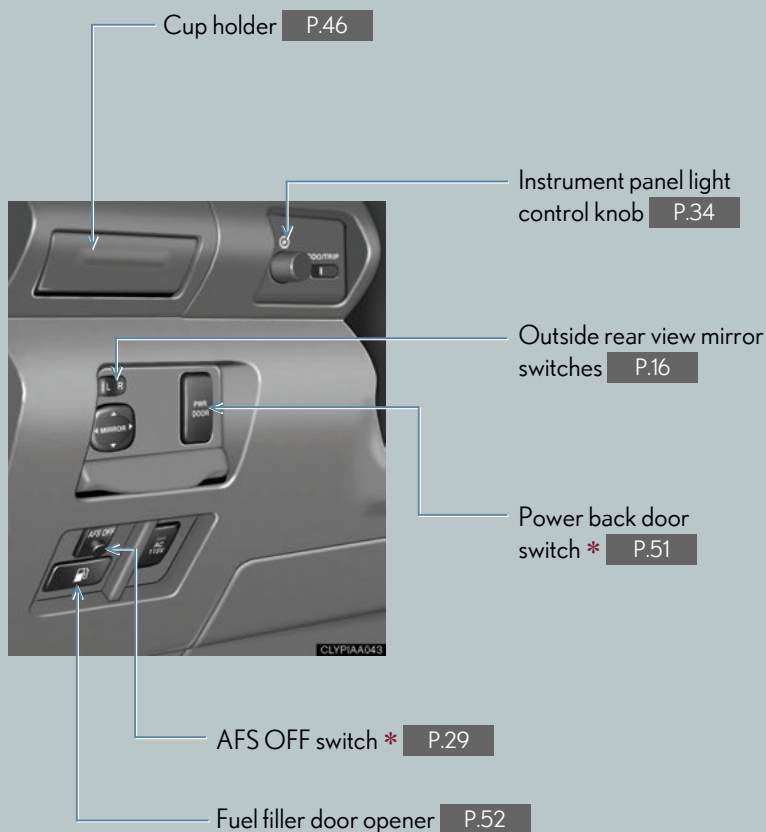

* : If equipped



Topic 1

Entering and Exiting

| | |
|------------------------------|---|
| Keys | 7 |
| Wireless Remote Control..... | 8 |
| Theft Deterrent System..... | 9 |



Keys

► Without power back door



CLYQGAA130

► With power back door



CLYQGAA130

- 1** Master keys
These keys work in every lock.
- 2** Valet key
This key cannot lock/unlock the glove box.
- 3** Key number plate
Keep the plate in a safe place, such as your wallet. Do not keep the plate in the vehicle.
- 4** Flat key
This key works in every lock.
Lexus recommends that you always carry the flat key with you for emergency use.

Wireless Remote Control

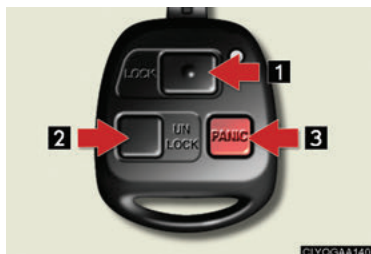

► Without power back door

- 1 Press:** locks all doors
- 2 Press once:** unlocks the driver's door
Press twice: unlocks all doors
Press and hold: opens the windows*

- 3 Press and hold:** sounds the alarm
(Use the alarm to attract attention to the vehicle in order to help deter break-ins. To stop the alarm, press any button on the wireless remote control.)

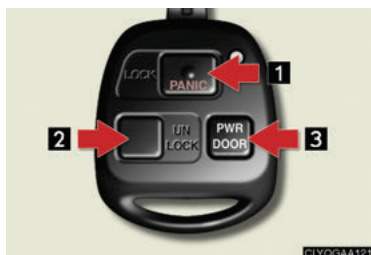

► With power back door

- 1 Press:** locks all doors
Press and hold: sounds the alarm
(Use the alarm to attract attention to the vehicle in order to help deter break-ins. To stop the alarm, press any button on the wireless remote control.)
- 2 Press once:** unlocks the driver's door
Press twice: unlocks all doors
Press and hold: opens the windows*
- 3 Press and hold:** opens or closes the back door

*: On vehicles with a moon roof, the moon roof will also open.



Theft Deterrent System

The theft deterrent system includes the following features to help protect your vehicle from theft.

Engine immobilizer system



The engine immobilizer system prevents the engine from being started in the event that an attempt is made to start the vehicle using an unregistered key.

The security indicator light flashes to indicate that the system is set.

Alarm

The system sounds the alarm and flashes lights when the doors or hood that have been locked is forcibly opened.

To set the alarm: lock all the doors from outside the vehicle. When all the doors are locked, the security indicator light comes on to indicate that the alarm is in its preparation state. The indicator light begins to flash after approximately 30 seconds to indicate that the system is armed.

To deactivate or stop the alarm: unlock the doors using the key or the wireless remote control, or turn the engine switch to the ON position. (The alarm will stop after several seconds.)

Steering lock

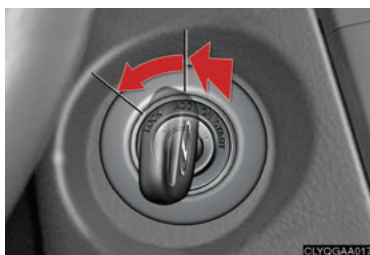

The steering wheel locks when the engine switch is turned to the LOCK position.



Topic 2

Before Driving

| | |
|---|----|
| Front Seats..... | 11 |
| Rear Seats..... | 12 |
| Driving Position Memory..... | 13 |
| Head Restraints | 14 |
| Seatbelts..... | 15 |
| Outside Rear View Mirrors | 16 |
| Anti-glare Inside Rear View Mirror..... | 16 |
| Steering Wheel | 17 |

Front Seats

■ Adjusting seat position

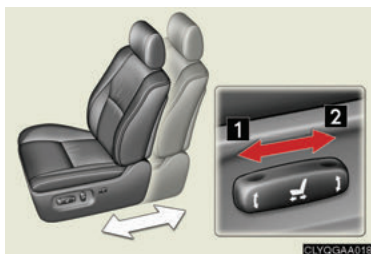

- 1 Moves the seat forward
- 2 Moves the seat backward

■ Adjusting seatback angle

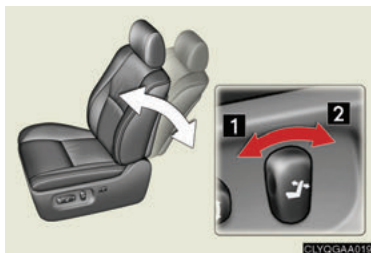

- 1 Tilts the seatback forward
- 2 Reclines the seatback

■ Adjusting the seat cushion



- 1 Raises and lowers the front of the cushion
- 2 Raises and lowers the entire seat

■ Adjusting the lumbar support

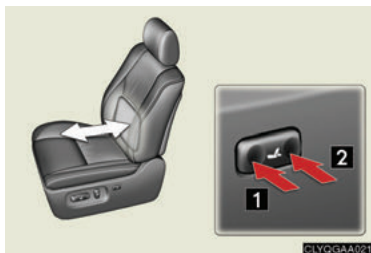

- 1 Firmer
- 2 Softer

Rear Seats

■ Adjusting seat position



With the lever raised, slide the seat forward or backward.

■ Adjusting seatback angle



Pull the lever and tilt the seatback forward or backward.

■ Folding down the seatback



Pull the lever and fold the seatback down until it locks.

To return the seatback, pull the lever and lift the seatback up.

■ Folding down the center seatback only



Pull the lever behind the center seatback and fold the seatback down.

Driving Position Memory (If Equipped)

The driver's seat, steering wheel and outside rear view mirrors can be returned to a previously set position by simply pressing a button.

Positions can be conveniently recorded for the vehicle's primary drivers.

Setting memory positions



While holding down the SET button, press and hold memory button 1 or 2 until you hear a beep.

The current position of the seat, steering wheel and outside rear view mirrors are recorded.

Recalling memory positions



Press memory button 1 or 2.

Head Restraints

Vertical adjustment

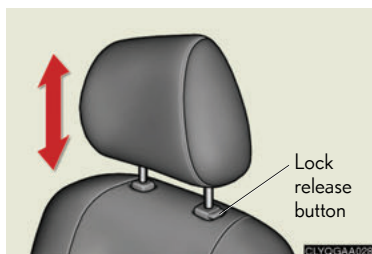

To raise: push the head restraint upward.

To lower: push the head restraint down while pressing the lock release button.

Angle adjustment (front seats only)

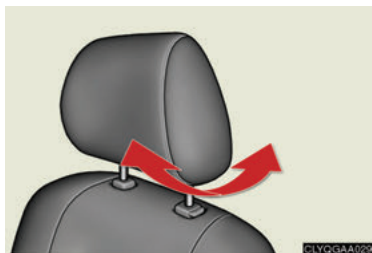

Move forward and backward.

Seatbelts

■ Adjusting shoulder belt height (front seats only)

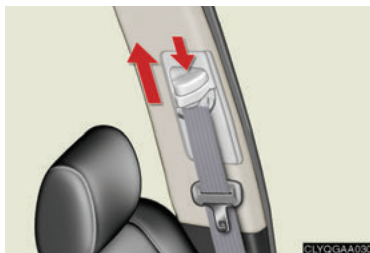

To raise: push the anchor upward.

To lower: depress the button and push the anchor down.

■ Seatbelt comfort guides (outside rear seats only)



If the shoulder belt sits close to the neck, pass the seatbelt through the comfort guide.

Outside Rear View Mirrors

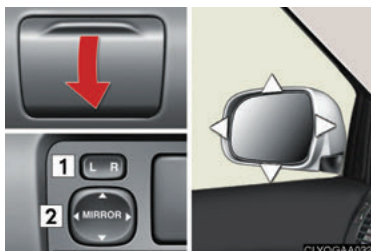

- 1 To select the mirror you wish to adjust (L or R), use the master switch.
- 2 To adjust mirror angle, use the control switch.

On vehicles with driving position memory, the mirrors will automatically angle downwards when the vehicle is reversing.

To disable this function, set the master switch in the neutral position (between L and R).

Anti-glare Inside Rear View Mirror

The anti-glare mirror uses a sensor to detect light from vehicles behind and automatically reduces glare.



To turn the anti-glare function ON/OFF, press and hold the button for 3 seconds.

The indicator comes on when the anti-glare function is turned ON.

Steering Wheel

Manually adjustable type



To adjust the steering wheel, pull the lever up while holding the steering wheel, tilt the steering wheel to the desired angle, and release the lever.

Power-adjustable type

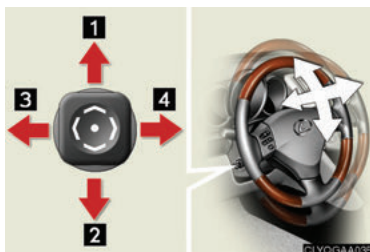

- 1 Up
- 2 Down
- 3 Away from the driver
- 4 Toward the driver

The power-adjustable type steering wheel retracts automatically when the key is removed from the engine switch to allow for easy exit and entry. The steering wheel returns automatically to its previously set position when the key is inserted into the engine switch.



Topic 3

When Driving

| | |
|------------------------------------|----|
| Starting | 19 |
| Transmission..... | 20 |
| Turn Signal Lever..... | 21 |
| Emergency Flasher Switch..... | 21 |
| Cruise Control | 22 |
| Dynamic Laser Cruise Control | 23 |
| Trip Information Display..... | 25 |
| Multi-information Display..... | 26 |
| Parking Brake | 27 |



Starting

Starting the hybrid system

Make sure the parking brake is engaged and the shift lever is in P.



- 1 Depress the brake pedal.

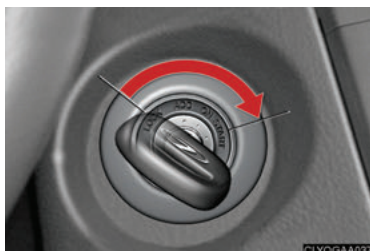

- 2 Turn the engine switch to the START position.

Stopping the hybrid system

- 1 Engage the parking brake and shift the shift lever to P.
- 2 Turn the engine switch to the LOCK position.

Engine switch

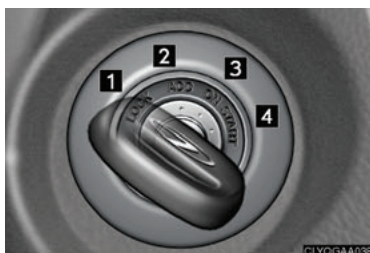

- 1 LOCK

- 2 ACC

Some electrical components such as the audio system can be used.

- 3 ON

- 4 START

Transmission

Shift positions



- P Park
- R Reverse
- N Neutral (drive not engaged)
- D Drive (normal driving position)
- B Engine brake

← The vehicle can only be shifted out of P when the engine switch is in the ON position and the brake pedal is depressed.

Downshifting increases power for uphill driving, or engine braking for downhill driving or stopping.

Entering and Exiting

Before Driving

When Driving

Rain and Night Driving

Driving Comfort

Opening and Closing

What to do if ...

Customizing Your Lexus



Turn Signal Lever

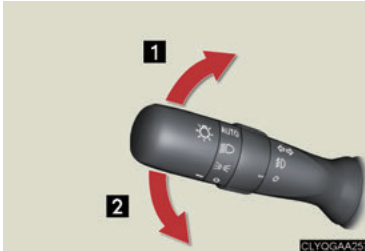

- 1 Right turn signal
- 2 Left turn signal

To signal a lane change, move the lever partway and hold.

Emergency Flasher Switch

► With navigation system



Engaging the emergency flasher switch causes all the turn signal lights to flash.
The emergency flashers can be operated even when the engine is off.

► Without navigation system



Cruise Control (If Equipped)

Cruise control allows the driver to maintain a constant speed without having to operate the accelerator pedal.

Use for highway driving or when traveling at a constant speed for long periods of time.

Setting the speed



- 1 Press the ON-OFF button.
The system will turn on.
- 2 Accelerate or decelerate to the desired speed, and then push the lever down.
This sets the speed in the cruise control memory.

Canceling



- 1 To temporarily cancel the cruise control, pull the lever toward you. To resume the cruise control, push the lever up.
- 2 To turn the system off, press the ON-OFF button.

Adjusting the speed setting



- To increase speed:** push the lever up.
To decrease speed: push the lever down.

Release the lever when the desired speed is reached.



Dynamic Laser Cruise Control (If Equipped)

Dynamic laser cruise control supplements conventional cruise control with a vehicle-to-vehicle distance control mode.

Cruise control display



Cruise control settings are shown on the instrument cluster.

- 1 Vehicle ahead indicator
- 2 Vehicle-to-vehicle distance
- 3 Preset speed

Vehicle-to-vehicle distance control mode

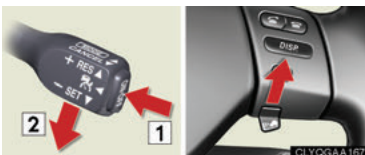

- 1 Press the ON-OFF button.
 - 2 Accelerate or decelerate to the desired speed, and then push the lever down.
- Vehicle-to-vehicle distance can be adjusted using the distance switch.

Constant speed control mode

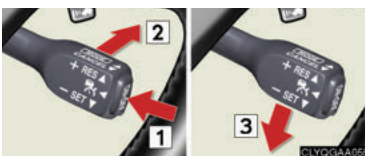

- 1 Press the ON-OFF button.
- 2 Push the lever forward and hold for at least one second.
- 3 Accelerate or decelerate to the desired speed, and then push the lever down.

■ Canceling



- 1 To temporarily cancel the dynamic laser cruise control, pull the lever toward you. To resume the cruise control, push the lever up.
- 2 To turn the system off, press the ON-OFF button.

■ Adjusting the speed setting



To **increase speed**: push the lever up.

To **decrease speed**: push the lever down.

Release the lever when the desired speed is reached.

The vehicle-to-vehicle distance control mode maintains the preset cruising speed as long as no vehicle is detected ahead.



Trip Information Display

The following information concerning your vehicle is displayed.

Display information

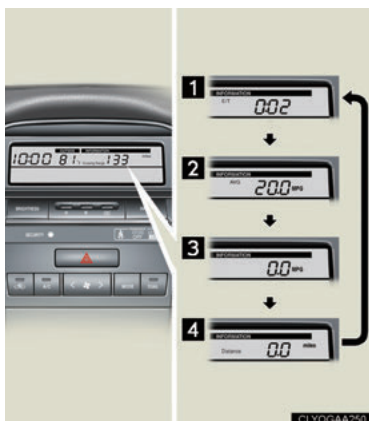

- 1 Driving time
- 2 Average fuel consumption
- 3 Current fuel consumption
- 4 Driving distance

Changing the display of trip information



Trip information items can be switched by pressing the INFO switch.

To reset either the average vehicle speed or the driving distance, press and hold the INFO switch when either item is displayed.

Multi-information Display

The multi-information display shows information about your vehicle, including the items shown below.

Display information



- Trip information
 - Outside temperature
 - Driving range
 - Average fuel consumption after refueling
 - Current fuel consumption
- Energy monitor
- Dynamic laser cruise control settings (if equipped)
- Warning messages

Changing the display of trip information



Trip information items can be switched by pressing the DISP. switch.

In the event that a problem is detected in any of the vehicle's systems, a warning message is shown on the multi-information display.



Parking Brake



To set the parking brake: firmly depress the parking brake pedal.

To release the parking brake: depress the parking brake pedal again.



Topic 4

Rain and Night Driving

- Headlights..... 29
- Fog Lights 30
- Windshield Wipers and Washer 30
- Rear Window Wiper and Washer 33
- Rear Window and Outside
Rear View Mirror Defogger,
and Windshield Wiper De-icer 34
- Headlight Cleaner 34
- Instrument Panel Light Control 34
- Multi-display Light Control 35

Headlights

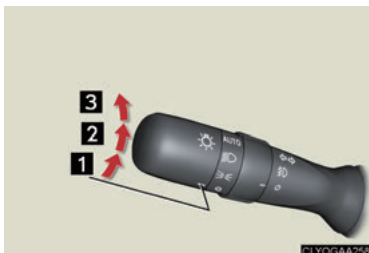

- 1** The instrument panel, side marker, parking, tail and license plate lights turn on.
- 2** The headlights and all lights listed above turn on.
- 3** The headlights and parking lights turn on/off automatically in accordance with ambient light levels.

To engage the high beams, push the lever forward.
To flash the high beams, pull the lever and hold.

■ AFS (if equipped with Adaptive Front-lighting System)

AFS improves visibility on curves by automatically adjusting the horizontal orientation of the headlights in accordance with vehicle speed and the degree of the tire angle that are controlled by steering input.



To cancel the system, press the AFS OFF switch.

- 1** OFF
- 2** ON

The indicator comes on when the system is off.

Fog Lights

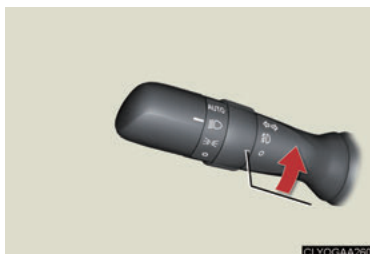

The fog lights can be used only when the headlights (low beam) are on.

Windshield Wipers and Washer

Intermittent wiper with interval adjuster (if equipped)



- | | | |
|---|--|------------------------|
| 1 | | Off |
| 2 | | Intermittent operation |
| 3 | | Low speed |
| 4 | | High speed |
| 5 | | Single wipe |



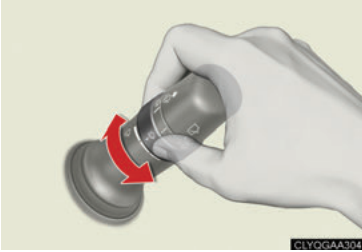

Intermittent operation: Wiper interval can be adjusted by turning the band.

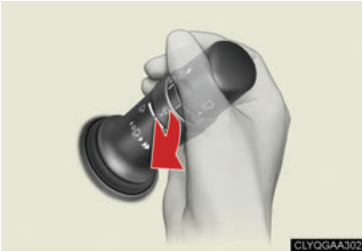

To spray washer fluid, pull the lever. The wipers will operate automatically.

■ Rain-sensing windshield wipers (if equipped)

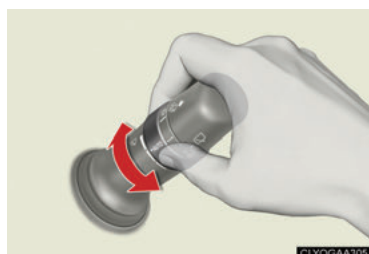





- 1 Off
- 2 Automatic operation
- 3 Low speed
- 4 High speed
- 5 Single wipe

Automatic operation: Sensitivity can be adjusted by turning the band.

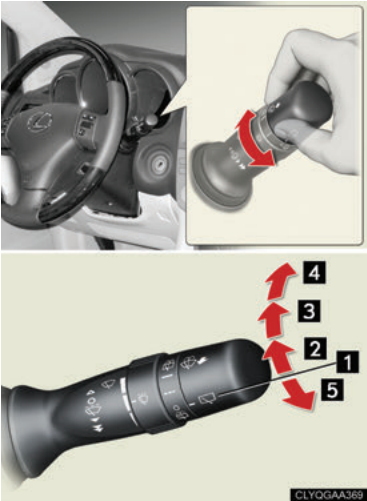
To spray washer fluid, pull the lever. The wipers will operate automatically.

Rear Window Wiper and Washer

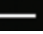

- 1  Off
- 2  Intermittent window wiper operation
- 3  Normal window wiper operation
- 4  Washer/wiper dual operation
- 5  Washer/wiper dual operation

Rear Window and Outside Rear View Mirror Defogger, and Windshield Wiper De-icer



To defog the rear window and the outside rear view mirrors, press the button.

Press again to cancel.

On vehicles for Canada, the windshield wiper de-icer will operate simultaneously with defoggers.

The system turns off automatically after 15 minutes.

Headlight Cleaner (If Equipped)



The headlight cleaner can be used only when the engine switch is in the ON position and the headlights are on.

Instrument Panel Light Control

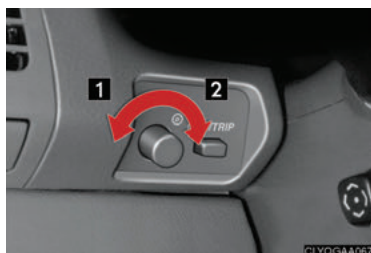

- 1** To dim: turn the knob counterclockwise.
- 2** To brighten: turn the knob clockwise.

Multi-display Light Control



To adjust the brightness of the multi-display light, press the button repeatedly until the desired brightness is obtained.



Topic 5

Driving Comfort

| | |
|--------------------------------------|----|
| Audio System | 37 |
| Rear Seat Entertainment System | 40 |
| Air Conditioning System | 42 |
| Garage Door Opener | 43 |
| Console Boxes | 45 |
| Cup Holders | 46 |
| Glove Box | 47 |
| Seat Heaters | 47 |
| Compass | 47 |

Audio System

► With navigation system

Owners of models equipped with a navigation system should refer to the "Navigation System Owner's Manual".

► Without navigation system

■ Basic operation

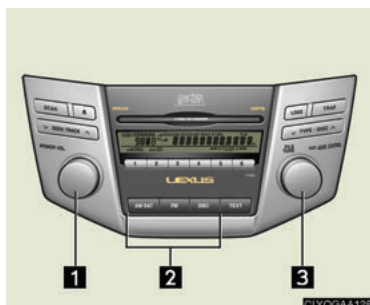

- 1 Power/Volume
- 2 Audio sources
- 3 Sound quality modes
 - Listening position
 - Automatic Sound Levelizer (ASL)
 - Rear seat entertainment system lock (if equipped)

■ Audio sources

AM·SAT: AM radio/Satellite radio*

FM: FM radio

DISC: CD player

*: The optional Lexus genuine satellite tuner and antenna allows you to receive and play XM® Satellite Radio broadcasts. (Subscription is required. For detailed information, see the Owner's Manual.)

■ Radio

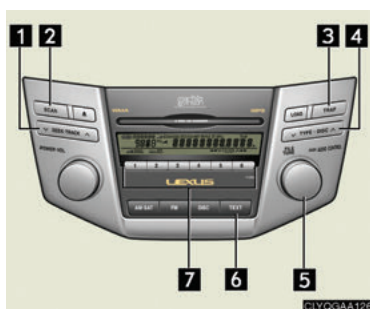

- 1 Seek
- 2 Scan
 - All radio stations: press
 - Preset radio stations: press and hold
- 3 Traffic information
- 4 RDS genre select
- 5 Radio tuner
- 6 Text messages
- 7 Station presets

■ Entering station presets

- 1 Select the desired station by using the tune, the seek or the scan function.
- 2 Press and hold one of the preset buttons (1-6) until you hear a beep, indicating that the station is set.

CD player

Playing an audio CD

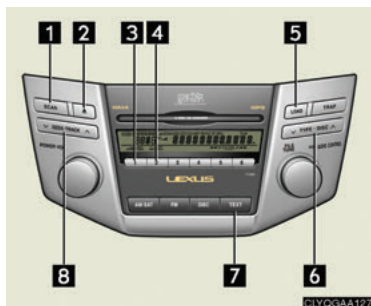

- 1** Scan
All tracks in current disc: press
First track of each CD: press and hold
- 2** Eject
- 3** Random playback
Current disc: press
All discs: press and hold
- 4** Repeat
Current track: press
Current disc: press and hold
- 5** Disc load
- 6** Disc select
- 7** Text information
- 8** Track select/rewind/fast-forward

Playing a CD with MP3/WMA files

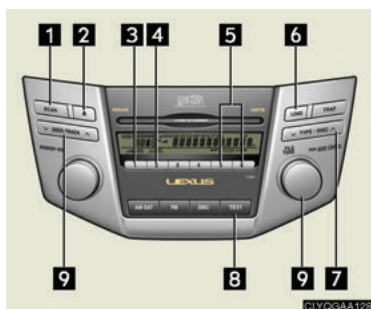

- 1** Scan
All files in current folder: press
First file of each folder: press and hold
- 2** Eject
- 3** Random playback
Current folder: press
All folders: press and hold
- 4** Repeat
Current file: press
All files in current folder: press and hold
- 5** Folder select
- 6** Disc load
- 7** Disc select
- 8** Text information
- 9** File select



■ Loading a CD

- 1 Press the LOAD button.
WAIT is shown on the display.
- 2 Insert a CD when the indicators on the slot turn from amber to green.
The display changes from WAIT to LOAD.

■ Loading multiple CDs

- 1 Press and hold the LOAD button until you hear a beep.
WAIT is shown on the display.
- 2 Insert a CD when the indicators on the slot turn from amber to green.
The display changes from WAIT to LOAD.
The indicators on the slot turn to amber when the CD is inserted.
- 3 Insert the next CD when the indicators on the slot turn from amber to green again.
Repeat the procedure for the remaining CDs.
To stop the operation, press the DISC button.

■ Remote control (steering wheel switches)

The audio system can be operated using the remote control located on the steering wheel.



- 1 Power on/change mode: press
Power off: press and hold
- 2 Volume
- 3 Radio: radio tuner
CD: disc/track/file (MP3/WMA) select

Rear Seat Entertainment System (If Equipped)

The rear seat entertainment system is designed to allow the rear passengers to enjoy audio and DVD video that is separate from the front audio system.

Location of the components

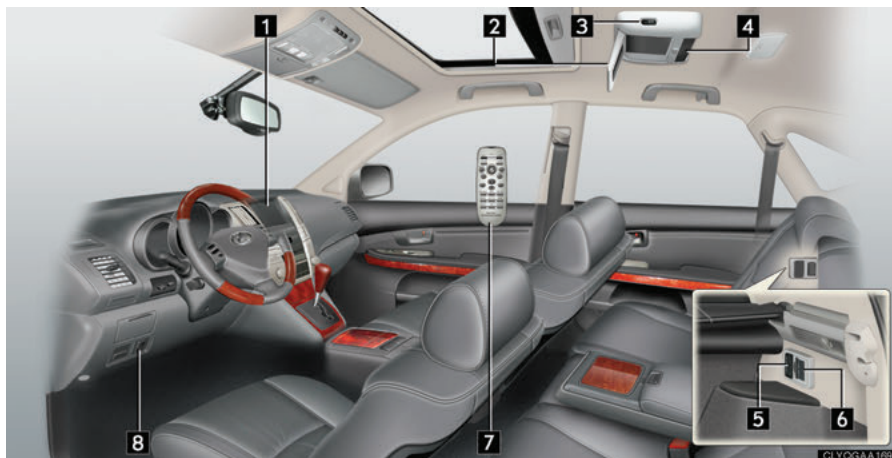

- 1 Front audio system
- 2 Display
- 3 Headphone volume control dials and headphone jacks
- 4 DVD player
- 5 A/V input adapter
- 6 Power outlet
- 7 Remote control
- 8 Power outlet main switch

Opening the display

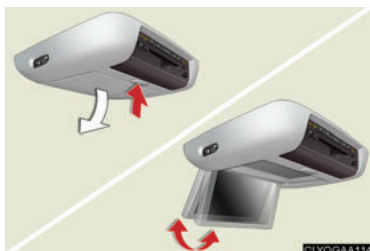

Press the lock release button.

The angle can be adjusted between 90° and 125°.

Entering and Exiting

Before Driving

When Driving

Rain and
Night Driving

Driving Comfort

Opening and Closing

What to do if ...

Customizing
Your Lexus

Unit

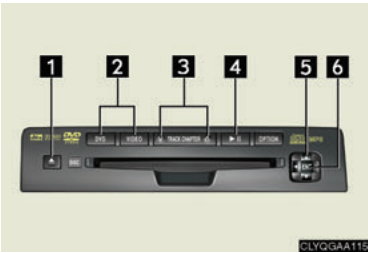

- 1 Eject
- 2 Mode select (power on)
- 3 Track/chapter select
- 4 Play/pause
- 5 Cursor position
- 6 Enter

Remote control



- 1 Mode select (power on)
- 2 Cursor position
- 3 Enter
- 4 Track/chapter select
- 5 Play/pause
- 6 Rewind
- 7 Title/disc menu number search
- 8 Power off
- 9 Folder select
- 10 Fast-forward
- 11 Stop

Air Conditioning System

► With navigation system

Owners of models equipped with a navigation system should refer to the "Navigation System Owner's Manual".

► Without navigation system



- 1 Driver side temperature control
- 2 Switch to automatic mode
- 3 Driver side temperature display
- 4 Passenger side temperature display
- 5 Windshield defog/defrost
- 6 Passenger side temperature control

- 7 Dual mode switch
- 8 Air flow controls
- 9 Fan speed controls
- 10 A/C switch
- 11 Outside air/recirculated air mode switch
- 12 OFF button

■ Using the automatic mode



- 1 Press the AUTO button.
- 2 Adjust the temperature using the TEMP button.

■ Adjusting the temperature in DUAL mode



In DUAL mode, driver and passenger side temperature settings can be adjusted separately.

- 1 Press the DUAL button.
- 2 Adjust the driver side temperature using the TEMP button, and the passenger side temperature using the PASSENGER TEMP button.

Garage Door Opener

The garage door opener can be programmed to operate garage doors, gates, entry doors, door locks, home lighting systems, security systems, and other devices.

The garage door opener (HomeLink® Universal Transceiver) is manufactured under license from HomeLink®.



The HomeLink® compatible transceiver in your vehicle has 3 buttons which can be programmed to operate 3 different devices.

■ Programming HomeLink®

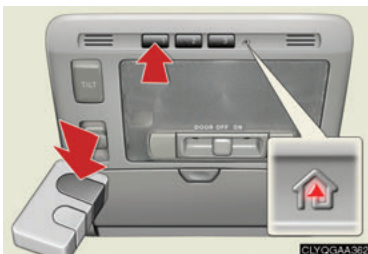

- 1 Hold your hand-held transmitter within 3 inches of the HomeLink® buttons.
- 2 Press and hold down the desired HomeLink® button.
- 3 For U.S.A. owners:

While pressing the HomeLink® button, press and hold down the button on the hand-held transmitter until the indicator light changes from a slow to a rapid flash.

For Canadian owners:

While pressing the HomeLink® button, repeatedly press and release (cycle) the button on the hand-held transmitter every 2 seconds until the indicator light changes from a slow to a rapid flash.

If your garage door is of the rolling code type:

- 4 Press the training button on the motor-head unit in your garage.
 - 5 Press and hold the vehicle's programmed HomeLink® button for 2 seconds and release it. Repeat this step once again.
- If the door does not open, press and release the same button once again.

■ Programming other devices

For U.S.A. owners:

To program an entry gate, see the Owner's Manual.

To program other devices, contact your Lexus dealer.

For Canadian owners:

To program all other devices, follow the same procedure as for garage door programming.

■ Operating HomeLink®



Press the appropriate HomeLink® button.
The indicator light should come on.

Entering and Exiting

Before Driving

When Driving

Rain and
Night Driving

Driving Comfort

Opening and Closing

What to do if ...

Customizing
Your Lexus

Console Boxes

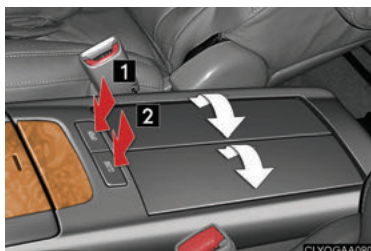

► Front

- 1 Opens
- 2 Closes

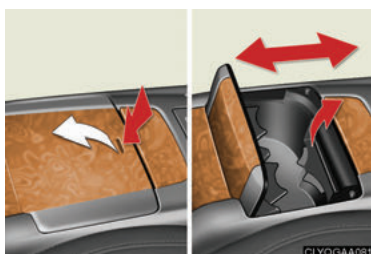

To adjust the position of the front console box, open the cup holder lid and slide the console box while lifting the lever.



► Rear (if equipped)

To open, pull up the knob and lift the armrest.

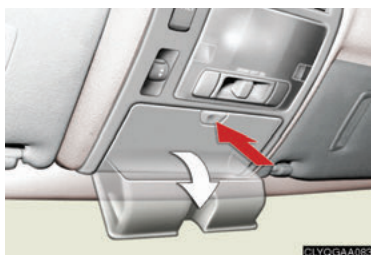

► Overhead console

To open, press the lid.

Cup Holders



► Front (type A)

To open, press in and release.

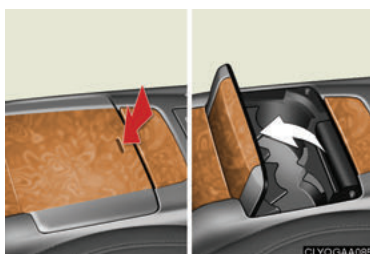

► Front (type B)

To open, press down on the rear of the lid.



► Rear

To open, press the lock release button.

Entering and Exiting

Before Driving

When Driving

Rain and
Night Driving

Driving Comfort

Opening and Closing

What to do if ...

Customizing
Your Lexus

Glove Box

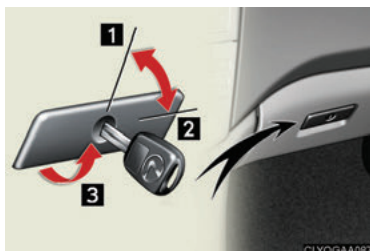

- 1 Unlock
- 2 Lock
- 3 Open: pull the lever

The glove box can be locked and unlocked using the master key.

Seat Heaters (If Equipped)

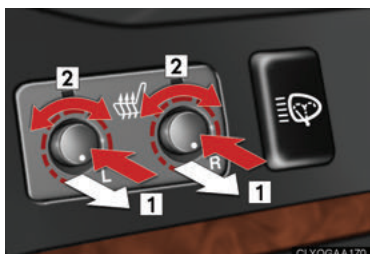

- 1 Press the knob to pop out.
- 2 Turn the knob to adjust the seat temperature.

Compass

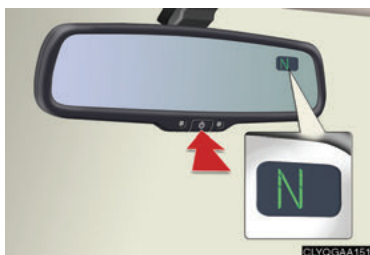

To display the compass, press the button.

To cancel the display, press the button again.



Topic 6

Opening and Closing

| | |
|---------------------|----|
| Door Locks | 49 |
| Moon Roof | 50 |
| Back Door | 51 |
| Fuel Tank Cap | 52 |
| Hood | 53 |
| Power Windows | 54 |

Door Locks

■ Locking the vehicle from inside

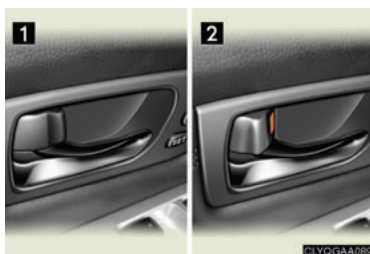

► Inside lock button

- 1 Locks
- 2 Unlocks



► Door lock switch

Operates all door locks.

- 1 Locks
- 2 Unlocks

■ Locking the vehicle from outside

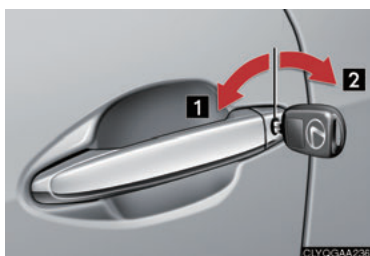

► Using the key

- 1 **Turn:** locks all doors
Turn and hold: closes the windows*
- 2 **Turn once:** unlocks the driver's door
Turn twice: unlocks all doors
Turn and hold: opens the windows*

*: On vehicles with a moon roof, the moon roof will also open/close.

► Using the wireless remote control (→P.7, 8)

■ Rear door child-protector lock



Setting the switch to the LOCK position prevents the rear doors from being opened from the inside.

Always set the child protector locks when children are seated in the rear seat.

Moon Roof

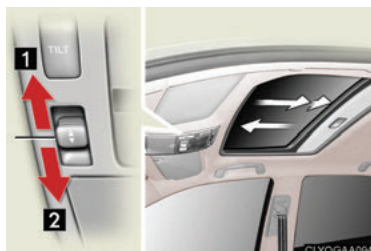

► Opening and closing

1 Opens

The moon roof stops slightly before the fully opened position.

To fully open, press the switch again.

2 Closes

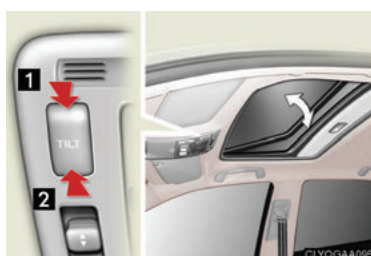

► Tilting up and down

1 Tilts up

2 Tilts down

Entering and Exiting

Before Driving

When Driving

Rain and
Night Driving

Driving Comfort

Opening and Closing

What to do if ...

Customizing
Your Lexus

Back Door

Back door opener



To open the back door, push up the opener and raise the door.

Power back door switches (with power back door)

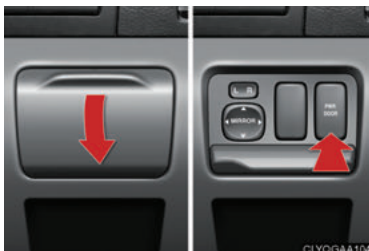

► Instrument panel

To open or close the back door, press the switch for one second.



► Back door

To close the back door, press the switch.

Wireless remote control (with power back door)

→P.8

Turning the power back door system on and off (with power back door)

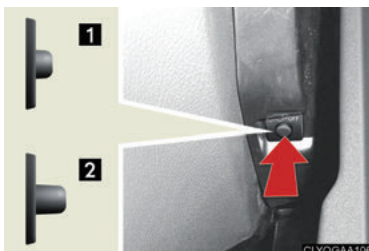

To disable the system, turn off the main switch in the glove box.

1 ON

2 OFF

When the power back door system is disabled, the back door cannot be opened using the wireless remote control or power back door switch.

Fuel Tank Cap



1 Press the fuel filler door opener.



2 When the message REFUEL READY appears, the fuel filler door will open.

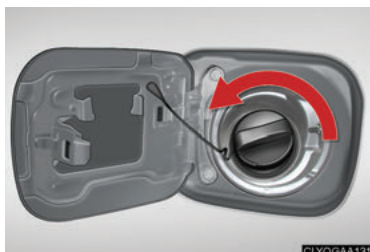

3 Slowly remove the cap by turning it counter-clockwise.
After the cap is removed, it can be hung on the inside of the fuel filler door.

Entering and Exiting

Before Driving

When Driving

Rain and
Night Driving

Driving Comfort

Opening and Closing

What to do if ...

Customizing
Your Lexus

Hood



1 Pull the hood release lever.



2 Insert your fingers under the hood, pull the hood catch and lift the hood.

Power Windows



1 Power window switches

To open: press the switch.

To close: pull the switch up.

Fully pulling up and releasing the switches causes the windows to close fully. Fully pressing down and releasing the switches causes the windows to open fully.

2 Window lock switch

The window lock switch disables the operation of all windows other than the driver's door window.

Entering and Exiting

Before Driving

When Driving

Rain and
Night Driving

Driving Comfort

Opening and Closing

What to do if ...

Customizing
Your Lexus

List of Warning/Indicator Lights



The units used on the speedometer, the tachometer gauge display, indicators and warning lights may differ depending on the model / type.

Stop the vehicle immediately. Continuing to drive the vehicle may be dangerous.



(U.S.A.) (Canada)

Brake system warning light

Stop the vehicle immediately.



Charging system warning light

Have the vehicle inspected immediately.



(U.S.A.) (Canada)
Malfunction indicator lamp



(U.S.A.) (Canada)



SRS warning light



(U.S.A.) (Canada)
ABS warning light



(U.S.A.) (Canada)



Hybrid battery warning light



Brake system warning light (yellow)



Electric power steering warning light



(Flashing and then continuously on)
Tire pressure warning light

For further information, refer to the Owner's Manual.

Follow the correction procedures.



Open door warning light



Low fuel level warning light



Driver's seat belt reminder light



Front passenger's seat belt reminder light^{*2}



Tire pressure warning light



Master warning light

See the Owner's Manual



Turn signal indicator



Headlight high beam indicator



Headlight indicator (U.S.A.)



Tail light indicator (Canada)



Cruise control indicator



Driving ready indication



Shift position indicators



Slip indicator



AFS OFF indicator^{*1}



AIR BAG ON indicator^{*2}



AIR BAG OFF indicator^{*2}

^{*1}: Vehicles with discharge headlights

^{*2}: On the center panel

For further information, refer to the Owner's Manual.

Spare Tire and Tool Compartment

Jack, tools, and spare tire



- 1 Tool bag
- 2 Jack handle
- 3 Jack
- 4 Adapter socket (for removing the spare tire)
- 5 Towing eyelet
- 6 Wrench
- 7 Spare tire

Taking out the spare tire



- 1 Remove the inside spare tire cover.



- 2 Open the right side auxiliary box and remove the cover of the spare tire clamp bolt.



- 3 Put the adapter socket on the spare tire clamp bolt. Connect the jack handle and adapter socket, and then turn the jack handle counter-clockwise.



- 4 Pull out the spare tire and remove the holding bracket.

If the engine switch does not turn easily...

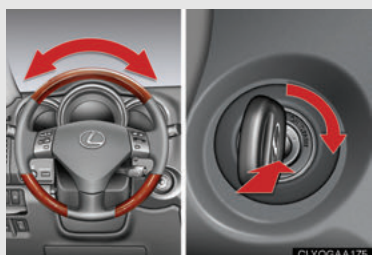

Turn the engine switch while lightly moving the steering wheel from left to right.

Customizing Your Lexus

Your vehicle includes a variety of electronic features that can be personalized to your preferences. Programming these preferences requires specialized equipment and may be performed by an authorized Lexus dealership.

Some function settings are changed simultaneously with other functions being customized. Contact your Lexus dealer for further details.

| Item | Function | Default setting | Customized setting |
|-------------------------|--|---|--------------------------------|
| Wireless remote control | Wireless remote control | ON | OFF |
| | Unlocking operation | Driver's door unlocked in one step, all doors unlocked in two steps | All doors unlocked in one step |
| | Automatic door lock function to be activated if door is not opened after being unlocked | ON | OFF |
| | Time elapsed before automatic door lock function is activated if door is not opened after being unlocked | 60 seconds | 30 seconds |
| | | | 120 seconds |
| | Operation signal (Emergency flashers) | ON | OFF |
| | Operation signal (Buzzer) | ON | OFF |
| | Buzzer sounds when pushing LOCK with any door not closed | ON | OFF |
| | Power back door operation | Push and hold | Push twice* |
| | | | One short push* |
| Power back door | Panic function | ON | OFF |
| | Switch operation | Push and hold | One short push |
| | Wireless remote control linked operation | ON | OFF |
| | Operation signal volume | OFF | High |
| | | | Low |
| | Operation when door locks | Possible | Impossible |

*: It is possible to select them only when the power back door operation with the open/close switch is made impossible when the door is locked.

| Item | Function | Default setting | Customized setting |
|--------------------------------|--|---|---------------------------------|
| Power back door | Assistance of opening with door opener | OFF | ON |
| | Sensitivity of jam protection function | Level 1 | Level 2 to 4 |
| Door lock | Unlocking using a key | Driver's door unlocked in one step, all doors unlocked in two steps | All doors unlocked in one step. |
| | Speed-detecting automatic door lock function | OFF | ON |
| | Opening driver's door unlocks all doors | OFF | ON |
| | Shifting gears to P unlocks all doors. | ON | OFF |
| | Shifting gears to position other than P locks all doors. | ON | OFF |
| Power windows | Linked door lock/unlock operation | ON | OFF |
| | Wireless remote control linked operation | ON (open only) | OFF |
| Moon roof | Linked door lock/unlock operation | ON | OFF |
| | Wireless remote control linked operation | ON (open only) | OFF |
| Automatic light control system | Light sensor sensitivity | Level 3 | Level 1 to 5 |
| | Time elapsed before headlights automatically turn off after doors are closed | 30 seconds | 0 second |
| | | | 60 seconds |
| Windshield wipers and washer | Switching operation when the vehicle is stationary | ON | OFF |

Entering and Exiting

Before Driving

When Driving

Rain and Night Driving

Driving Comfort

Opening and Closing

What to do if ...

Customizing Your Lexus

Customizing Your Lexus

| Item | Function | Default setting | Customized setting |
|----------------|--|-----------------|--------------------|
| Illumination | Time elapsed before lights turn off | 15 seconds | 7.5 seconds |
| | | | 30 seconds |
| | Front footwell lighting | ON | OFF |
| | Inside door handle well lighting | ON | OFF |
| | Operation when the doors are unlocked | ON | OFF |
| | Operation after the hybrid system is off | ON | OFF |
| Steering wheel | Automatic tilt-away steering column | ON | OFF |



Your Lexus dealer

Your Lexus dealer will provide quality maintenance and any other assistance you may require.

If there is not a Lexus dealer near you, please call the following number:

■ U.S. OWNERS

- In the U.S. mainland or Canada:

Lexus Roadside Assistance

1-800-25-LEXUS or 1-800-255-3987 (Toll-Free)

- In Hawaii:

Servco Automotive Roadside Assistance/Customer Services

1-800-25-LEXUS or 1-800-255-3987 (Toll-Free)

■ CANADIAN OWNERS

- In Canada or the U.S. mainland:

Lexus Roadside Assistance/Customer Service

1-800-26-LEXUS or 1-800-265-3987 (Toll-Free)

Please access our **websites** for further information.

- The U.S. mainland: www.lexus.com

- Hawaii: www.servcolexus.com

- Canada : www.lexus.ca

©2008 TOYOTA MOTOR CORPORATION

All rights reserved. This material may not be reproduced or copied, in whole or in part, without the written permission of Toyota Motor Corporation.