

# 2500645

---



Please read all instructions carefully before use and retain for future reference.



**ATTENTION** This appliance has a thermal cut out switch. The thermal cut out will activate and shut down the appliance should the appliance overheat.

Unplug from the mains and or battery and allow to cool for 30 minutes before re-use.

**CAUTION** Do not immerse in water.



**CAUTION** hot surfaces



Do not cover.



Do not use outdoors.

THIS PRODUCT IS ONLY SUITABLE FOR WELL INSULATED SPACES OR OCCASIONAL USE.



Please read all instructions carefully before use and retain for future reference.

**INTENDED USE** Only operate the appliance for its intended purpose and within the parameters specified in this manual. This appliance is for domestic use only. Do not use outdoors or on wet surfaces. This appliance is not intended for use by persons with reduced physical, sensory or mental capabilities, or lack of experience and knowledge, unless supervised or given appropriate instruction concerning the product's use by a person responsible for their safety.

The appliance is not intended to be operated by means of an external timer or separate remote-control system.

**GENERAL SAFETY** Do not allow to be used as a toy. Children should be supervised to ensure they do not play with the appliance.

If the appliance is not functioning properly, has been dropped, damaged, left outdoors, or immersed in liquid, do not use, contact DOMU Brands Customer Services.

Do not use the appliance if any parts appear to be faulty, missing or damaged. Ensure all parts are securely attached as instructed by this instruction manual before use.

**CABLES AND PLUGS** Check to ensure your electricity supply matches that shown on the rating plate. This product should only be used as rated. Preferably, the socket outlet should be protected by a Residual Current Device RCD (UK/EU)

Ground Fault Indicator (US).

Do not use with a damaged cable or plug. If the supply cable is damaged, it must be replaced by a qualified engineer or authorised service agent in order to avoid a hazard. The use of an extension cable is not recommended.

Do not handle the plug or appliance with wet hands.

Keep the cable away from heated surfaces.

Do not let the cable hang over the edge of the table or countertop where it could be pulled on inadvertently by children or pets.

Do not pull the cable around sharp edges or corners.

Do not leave unattended when plugged in. Unplug from outlet when not in use.

Turn off all controls before unplugging.

Do not unplug by pulling on the cable. To unplug, grasp the plug, not the cable.

Always unplug before performing user maintenance, connecting or disconnecting attachments, or changing accessories.

Ensure the cable is stored safely to prevent hazards.

**RISK OF PERSONAL INJURY** Always locate your appliance away from the edge of the worktop, on a firm, flat, heat-resistant surface with sufficient space around all sides. Do not insert any objects into openings or cover the appliance.

Do not place any cardboard, plastics or paper inside or on the appliance unless stated in the instructions.

Do not use the appliance near any combustible

surfaces. Do not use outdoors or near heat sources.

Take care not to touch any surfaces that may get hot when in use. Take care not to touch any surfaces that may remain hot for a period of time after use.

Never operate the appliance when empty.

Do not overload/overfill the appliance.

When using for the first time your appliance may give off a 'new' smell or vapour. This will dissipate after a few uses. Do not lift or move the appliance whilst in use.

Do not operate continuously for periods longer than those marked on the product or indicated in the instructions.

Ensure the appliance is switched off and unplugged before changing accessories or cleaning.

Use only as described in this manual and with DOMU Brands recommended attachments only.

## TECHNICAL SPECIFICATION

Rated Voltage 220V-240V~

Rated Power 2500W

Rated Frequency 50Hz

INFORMATION REQUIRMENTS FOR ELECTRICAL LOCAL SPACE HEATER

Model		2500645	
Item	Symbol	Value	Unit
Heat Output			
Nominal Heat Output	P <sub>nom</sub>	2.5	kW
Minimum Heat Output (indicative)	P <sub>min</sub>	1.2	kW
Maximum Continious Heat Output	P <sub>max</sub>	2.5	kW
Auxiliary electricity consumption			
At nominal heat output	EL <sub>max</sub>	N/A	kW
At minimum heat output	EL <sub>min</sub>	N/A	kW
In standby mode	EL <sub>SB</sub>	0.00025	kW
Type of heat input for Electrical Storage Heaters only (select one)			
Manual heat charge control with integrated thermostat.		no	
Manual heat charge control with room and/or outdoor temperature feedback.		no	
Electronic heat charge control with room and/or outdoor temperature feedback		no	
Fan assisted heat output		no	
Type of heat output/room temperature control (select one)			
Single stage heat output and no room temperature control		no	
Two or more manual stages, no room temperature control		no	
With mechanical thermostat room temperature control		yes	
With electronic room temperature control		no	
Electronic room temperature control plus day timer		no	
Electronic room temperature control plus week timer		no	
Other control options (multiple selections possible)			
room temperature control with prescence detection		no	
room temperature control with open window detection		no	
with distance control option		no	
with adaptive start control		no	
with working time limitation		yes	
with black bulb sensor		no	
Contact Details		DOMU Brands Ltd, 5th & 6th Floor, The Tower, Deva City Office Park, Salford, M3 7BF	

## SPECIFICATION

---

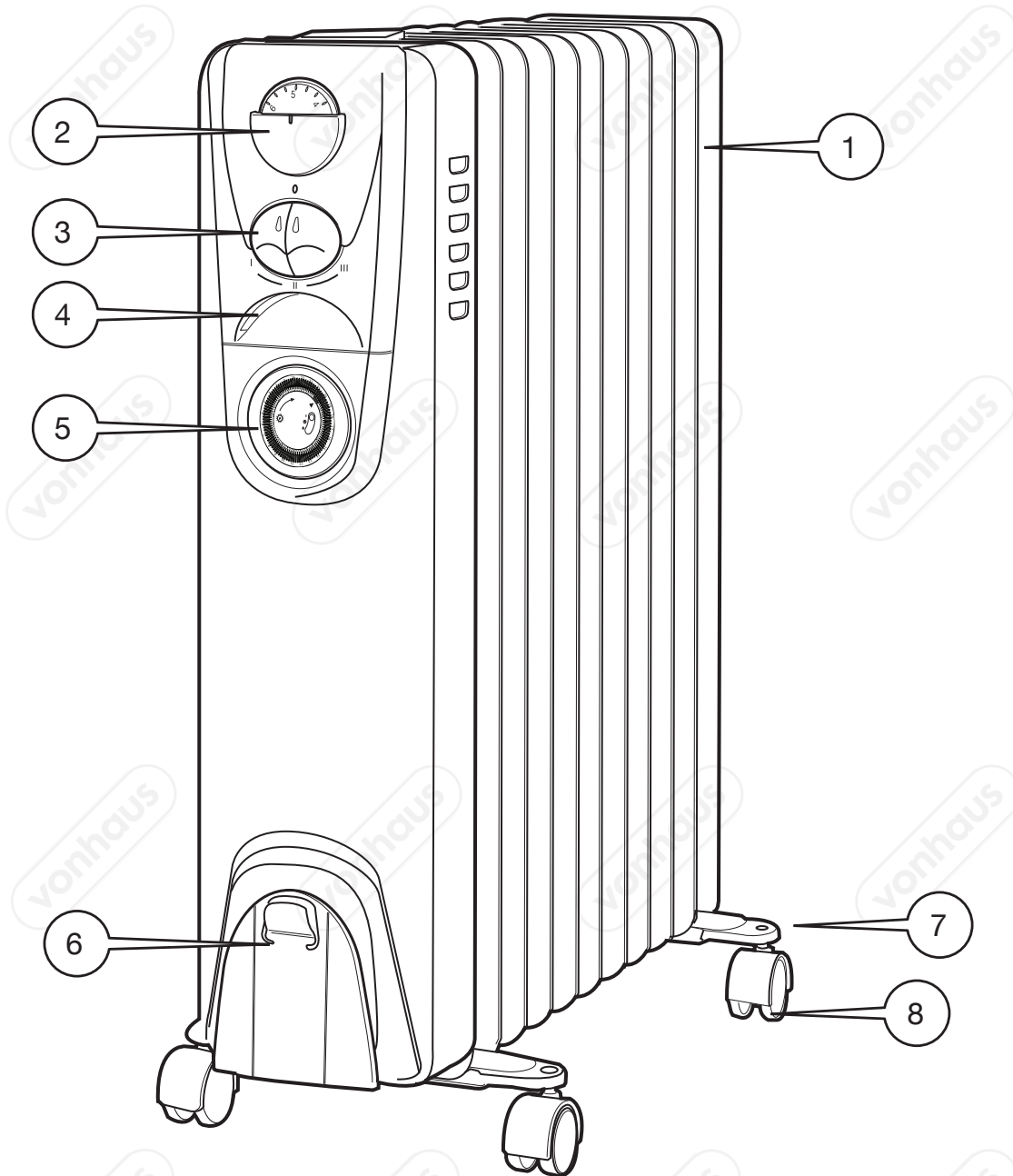

- 1- Radiator Fins
- 2- Adjustable Thermostat.
- 3- Power Switch
- 4- Front handle
- 5- Timer.
- 6- Cable Holder
- 7- Wheel Base
- 8 - Wheels

## ASSEMBLY

---

**1.** Turn the radiator upside-down on a scratch-free and stable surface to prevent damage to the paint finish or your floor surfacing (**see Fig 1**).

**2.** Fit the wheels assemblies onto the radiator by placing the U-shaped bolts between the outermost fins on each side of the radiator (**see Fig.2 - 4**).

**3.** Securely fasten the wheels assemblies onto the radiator by screwing the wing nuts onto the bolts (**see Fig. 5**).

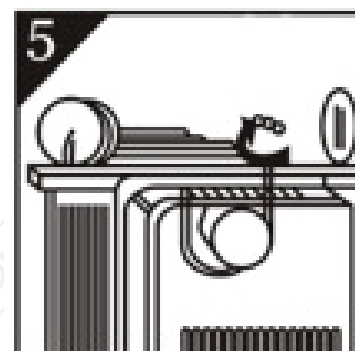
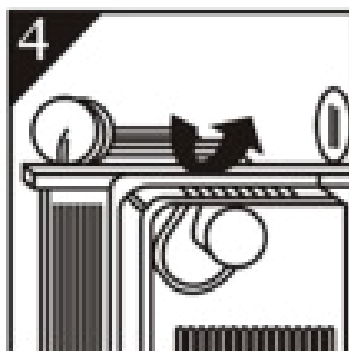
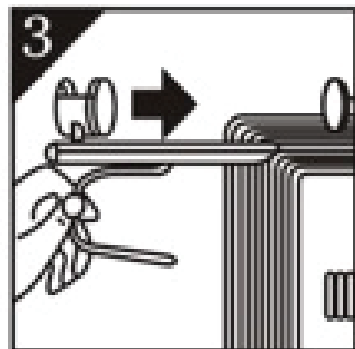
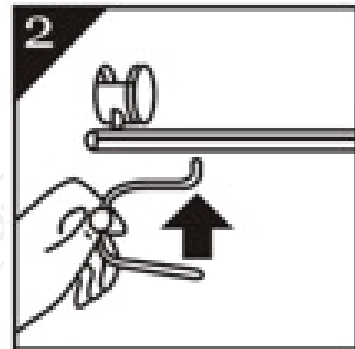
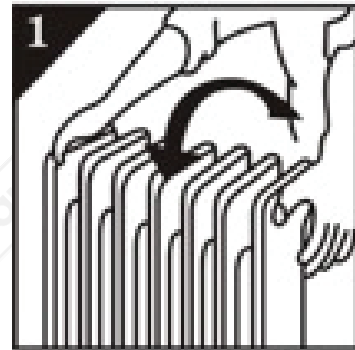

## OPERATION

---

**1.** Place the Unit in an upright position on a flat, steady, stable, heat-resistant surface. Make sure there is nothing flammable or heat sensitive within 1 meter (40 inches).

**CAUTION:** Operating the product in any other position could cause a hazard.

**2.** Ensure the thermostat Dial is at to the minimum position and setting the power switch to “0” for off before connecting to a suitable mains outlet.

**3.** Press the power switch from “0” to either “I” (Left switch down), “II” (Right switch down) or “III” (Both switches down with both indicators illuminated)

**4.** Turn the Thermostat Dial clockwise to the “III” position. When the room temperature rises to a comfortable level, slowly turn thermostat counter-clockwise until the indicator light just goes out. To adjust the room temperature turn the thermostat clockwise to raise the temperature, or counter-clockwise to lower it. Thus the heater will attempt to keep the room temperature at the desired level.

**5.** To turn off the heater, set the power switch to “0” position. The power indicator light turns off. Unplug the Unit from the electrical outlet when it is left unattended or is not in use

## TIMER

---

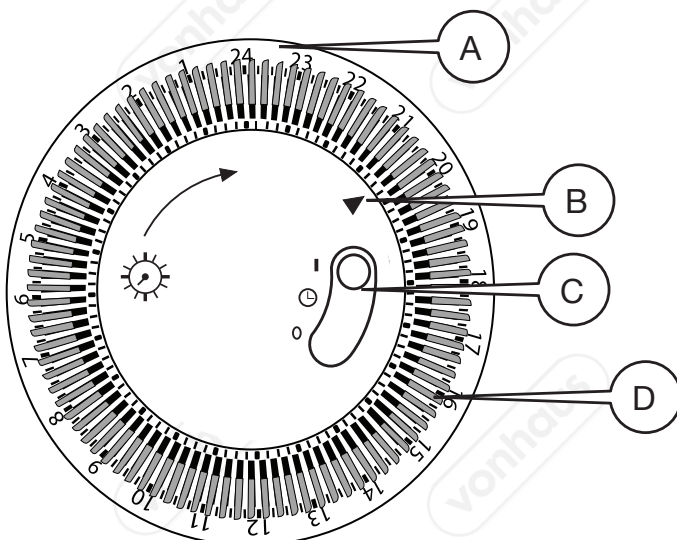

- A:** CLOCK (24 HOUR)
- B:** LIVE TIME ARROW
- C:** TIMER SWITCH
- D:** SEGMENTS



## TIMER SETTING OPERATION

**NOTE:** This is a 24 hours timer. There are 96 segments, each segment represents 15 mins.

**1.** Firstly, turn the clock “A” clockwise to align with arrow “B” to match the current time

**2.** Segments which are pushed outwards will represent the time where the heater will be turned ON. Segments which are pushed inwards will represent the time where the heater will be turned OFF.

**NOTE:** To set the heater to turn on at 8pm and turn off at 9pm, push 4 segments between 20 and 21 outwards (**Fig 1**).

**3.** Move the timer switch to symbol “🕒” to enable the timer (**Fig 2**).

**4.** If the timer switch is set at “I” position, the unit starts working non-stop ignoring any timer setting. If the timer switch is set at “0” position, the unit stays off ignoring any timer setting.

**NOTES:** The timer setting does not reset itself after the Unit has been switched off, but any time you unplug the Unit, the clock stops updating the live time and at next turn-on the live time must be set again as indicated in point “1”.

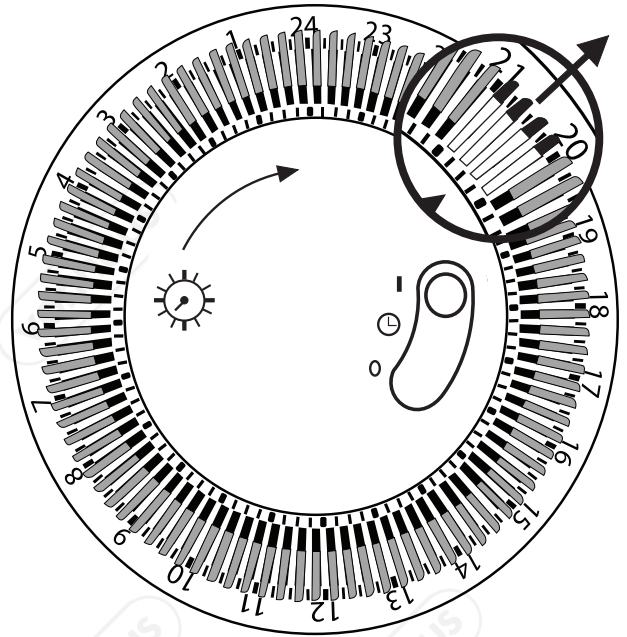

Fig 1

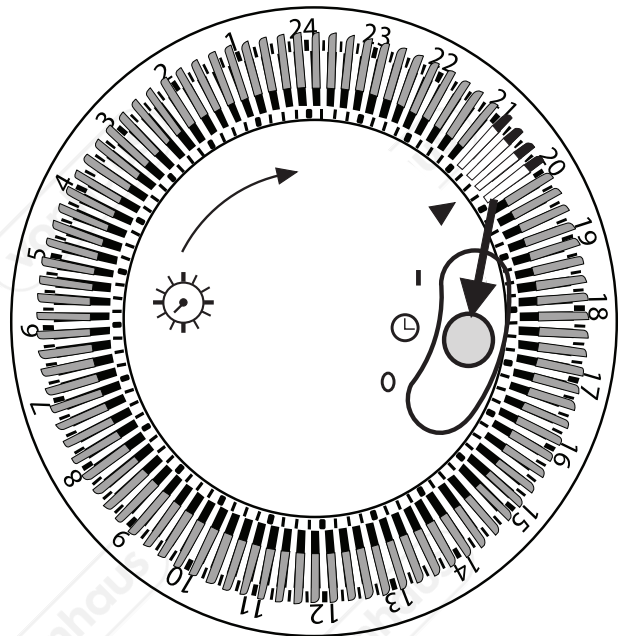

Fig 2



## SAFETY FEATURES

---

This Radiator is fitted with an overheat protection switch (thermal cut-out) which will power off the appliance automatically in case of overheating. Should this occur, unplug the appliance and allow to cool fully for approximately 30 minutes.

Follow the operation instructions to restart the appliance after removing the source of the overheating (poor ventilation, item covering the Radiator etc.). The Radiator should function normally. Should the problem persist, please contact DOMU Brands Customer Services.

To avoid damage and to regulate the temperature, this Radiator is fitted with

a thermostatic safety device. The safety device will activate and cut out the power to the Radiator once a certain temperature is reached. The Radiator will start again once the temperature has lowered.

The Radiator is also fitted with a tip switch which will cut off the power to the Radiator if it is knocked over. Should this happen, disconnect at the mains and allow to cool fully before attempting to move the Radiator. Inspect the Radiator for damage. If - and only if - the Radiator is free from damage, plug back into the mains. The Radiator should function normally.

## MAINTENANCE

---

**CAUTION:** Switch off the Radiator and disconnect the from the power socket. Wait for the Radiator to cool completely before cleaning.

Vacuum-clean the Vents to remove dust from these areas.

To remove dust on external surfaces, wipe the Radiator with a damp (not wet) lint-free cloth rinsed in hot soapy water only.

**CAUTION:** Do not use any harsh detergent or abrasive cleaners.

**WARNING!** Do not spray with liquids or submerge in any liquid or water.

**WARNING!** Do not attempt to clean the inside of the Radiator. Do not attempt to open the casing at any time. There are no user-serviceable parts.



## THANK YOU

Thank you for purchasing your product/appliance.

Should you require further assistance with your

purchase, you can contact us at

**support@domu.co.uk**

VonHaus is a registered trademark of DOMU Brands Ltd. Made in China for DOMU Brands. M24 2RW.

EN

**DISPOSAL INFORMATION** Please recycle where facilities exist. Check with your local authority for recycling advice.

**CUSTOMER SERVICE** If you are having difficulty using this product and require support, please contact **support@domu.co.uk**

**WARRANTY** To register your product and find out if you qualify for a free extended warranty please go to

**[www.vonhaus.com/warranty](http://www.vonhaus.com/warranty)**.

Please retain a proof of purchase receipt or statement as proof of the purchase date. The warranty only applies if the product is used solely in the manner indicated in the warnings page of this manual, and all other instructions have been followed accurately. Any abuse of the product or the manner in which it is used will invalidate the warranty. Returned goods will not be accepted unless re-packaged in its original packaging and accompanied by a relevant and completed returns form. This does not affect your statutory rights. No rights are given under this warranty to a person acquiring the appliance second-hand or for commercial or communal use.

**COPYRIGHT** All material in this instruction manual are copyrighted by DOMU Brands. Any unauthorised use may violate worldwide copyright, trademark, and other laws.